

# SAN MATEO FOSTER CITY SCHOOL DISTRICT FACILITIES DEVELOPMENT

1410 South Amphlett Blvd., San Mateo, CA 94402  
Office (650) 312-7690 FAX (650) 312-7696

## GEORGE HALL MPR AND SUPPORT ROOMS PROJECT #19-143

### ADDENDUM NO. 3

**Date:** November 24, 2021

**Project:** #19-143 George Hall MPR and Support Rooms Project  
**DSA #:** 01-119574 41-26

**Owner:** San Mateo Foster City School District  
1170 Chess Drive  
Foster City, CA 94404

Notice is hereby given to all prospective bidders that plans and specifications on the subject project are modified as hereinafter set forth. This addendum shall be attached to and form a part of the plans and specifications. All bidders must acknowledge receipt of this addendum on the Bid Form. In case of difference with previous addenda or communications, this addendum takes precedence.

It is the responsibility of all bidders to notify all subcontractors from whom they request bids and from whom they accept bids of all changes contained in this addendum.

#### **3.1 Notice to Bidders**

1. A new Bid Form.

#### **3.2 RFIs – Questions and Answers**

1. **Question:** Is this project Base Bid plus Alternate?  
**Answer:** No, it will be Base Bid plus AV Allowance only.
2. **Q:** Please provide pre-qualified MEP's?  
**A:** MEP's do not need to be pre-qualified. This project MEP's are under a million dollars.
3. **Q:** Is this a PLA project?  
**A:** This is NOT a PLA project.

4. **Q:** PRE-BID RFI 11 – Turf pad thickness?  
**A:** See attached **PRE-BID RFI 11 response and detail 6/L4.2 re-issued.**
5. **Q:** PRE-BID RFI 16 – Sun shade devices 08 41 13 - 2.05?  
**A:** See attached **PRE-BID RFI 16 response.**
6. **Q:** PRE-BID RFI 17-21 – AV, ALS questions  
**A:** See attached **PRE-BID RFI 17-21 responses.**
7. **Q:** Substitution Request 1 – 07 26 13 Weather Barrier (Delta-Fassade SA).  
**A:** **Rejected – pending additional info given.**
8. **Q:** Substitution Request 2 – 07 26 13 Weather Barrier (Air-Shield SMP by W.R. Meadows).  
**A:** **Rejected**
9. **Q:** Substitution Request 3 – 03 30 00 Waterproofing Admix (MasterLife 300C & 300D from Master Builders Solutions).  
**A:** **Approved**
10. **Q:** Substitution Request 4 – 09 67 23 Resinous Flooring (Florock, ....)  
**A:** **Rejected – pending additional info given.**
11. **Q:** Substitution Request 5 – 09 67 23 MCM panels (Alpolic MCM).  
**A:** **Not applicable.**

### **3.3 SPECIFICATIONS**

1. **SPECIFICATION SECTION 10 14 54 - EXTERIOR SIGNS**  
A. Delete the following paragraph 2.01 Exterior Signs – Individual Cast Letters
2. **SPECIFICATION SECTION 10 14 19 - DIMENSIONAL LETTERS**  
A. The following specification section is hereby issued. See attached.

### **3.4 DRAWINGS**

1. **SHEET ‘A10.91 SIGNAGE DETAILS**  
The following drawing is hereby reissued with these changes:  
A. Detail 12 - BUILDING SIGN – Add notes to define dimensional letter
2. **SHEET ‘LD0.0 IRRIGATION DEMOLITION’**  
The following drawing is hereby reissued with these changes:  
A. Demolition Site Plan - Remove (3) existing trees

3. **SHEET ‘L1.1 TREE PLANTING PLAN’**

The following drawing is hereby reissued with these changes:

A. Planting Site Plan - Plant (3) trees

4. **SHEET ‘L2.1 SHRUB PLANTING PLAN’**

The following drawing is hereby reissued with these changes:

A. Landscape Legend – Revise Lawn (Artificial) notes

5. **SHEET ‘L3.1 LANDSCAPE IRRIGATION PLAN’**

The following drawing is hereby reissued with these changes:

A. Irrigation Site Plan - Repair existing irrigation

6. **SHEET ‘L4.21 LANDSCAPE CONSTRUCTION AND PLANTING DETAILS’**

The following drawing is hereby reissued with these changes:

A. Detail 6 Artificial Turf Detail – Revise notes to clarify and specify Turf components

**Reminder Bid Date December 2, 2021 at 2:00pm. At the District Office 1170 Chess Dr. Foster City, CA 94404.**

**Attachments:**

Attachment A - **New Bid Form**

Attachment B – **RFI 11, RFI 16, RFI 17, RFI 18, RFI 19, RFI 20, RFI 21 Response**

Attachment C – **Re-issued drawings L0.0, L1.1, L2.1, L3.1, L4.2, A10.91**

Attachment D - **Spec Section 10 41 19 Dimensional Letters**

End of Addendum



**SAN MATEO FOSTER CITY  
SCHOOL DISTRICT**  
1170 CHESS DR.,  
FOSTER CITY, CA 94404

**DSA #01-119574  
FILE #41-26**

---

**PRE-BID RFI 11**

**SITE: GEORGE HALL ELEMENTARY SCHOOL,  
130 SAN MIGUEL WAY, SAN MATEO, CA 94403**  
**PROJECT : MULTIPURPOSE BUILDING AND SITE WORK**

Gary Chen  
Senior Project Manager

3486 Investment Blvd, Suite B, Hayward, CA 94545  
P 650.508.1700 C 650.863.9240  
F 650.508.1708 Bid Fax 650.508.1705  
E gchen@rodanbuilders.com  
rodanbuilders.com

HAYWARD + CONCORD

**QUESTION :**  
**Can you confirm the thickness of pad below the artificial turf?**

**submitted  
11.11.21**

**Pad thickness to be 3/4" inch with Field Turf Nutmeg Lush 1 5/8" turf with Anti-microbial silica sand fill.**

**Peter Larimer  
MTWgroup  
11/23/21**



**SAN MATEO FOSTER CITY  
SCHOOL DISTRICT**  
1170 CHESS DR.,  
FOSTER CITY, CA 94404

**DSA #01-119574  
FILE #41-26**

---

**PRE-BID RFI 16**

**SITE: GEORGE HALL ELEMENTARY SCHOOL,  
130 SAN MIGUEL WAY, SAN MATEO, CA94403**  
**PROJECT : MULTIPURPOSE BUILDING AND SITE WORK**

Rob Ritter  
Project Manager/Estimator

5353 Napa Vallejo Highway  
American Canyon, CA 94503  
(707) 257-7111 (Office)  
(707) 327-4348 (Direct Line)  
(707) 732-1801 (Mobile)  
(707) 647-7111 (Fax)  
Email: rritter@rsglazing.com



**QUESTION :**

The storefront specs 2.05 Shading Devices mentions Kawneer interior light shelf as shading device but drawings all show interior roller shades. Do you know if these Kawneer light shelves are to be used at all in project?

submitted  
11.22.21

**RESPONSE :**

This project has no interior light shelves.  
Specification section 08 41 13 - 2.05 Shading devices, shall be deleted.



Cal Coast Telecom

## REQUEST FOR INFORMATION



### Request for Information Submitted To:

Judy Krall  
**HMC Architects**  
333 W. San Carlos Street, Studio 750  
San Jose, CA 95110  
408-977-9160  
judy.krall@hmcarchitects.com

Date: November 23, 2021  
RFI No.: 01  
CCT Job Quote No.: Q21221  
Submitted By: Nathan Hocking  
Phone: (408) 454-7221  
Email: nathan@cctcom.net

### Project:

George Hall Elementary School  
Multipurpose Building and Site Work  
130 San Miguel Way  
San Mateo, CA 94403

ITEM	DESCRIPTION
<b>Question</b> <del>No. 01</del> <b>PRE-BID</b> <b>RFI 17</b>	Reference: Drawing Sheet T2.10 – Key Note 4, 8, 9, Symbols  ,  ,  and AV cabinet.  Question: Who is responsible for providing the AV devices and cabling shown/referenced on the drawing sheet? If the contractor is responsible, will a scope of work, spec and system diagrams be provided?
<b>RFI Response</b>	AV CABLING & DEVICES WILL BE PART OF ALLOWANCE. SCOPE WILL BE CLARIFIED AT A LATER DATE.
<b>Question</b> <del>No. 02</del> <b>PRE-BID</b> <b>RFI 18</b>	Reference: Spec Section 275100 ALL-IN-ONE CLASSROOM AUDIO SYSTEM, Drawing Sheet T2.10  Question: I am not able to locate the Classroom audio systems on the drawings. Which rooms should receive the Classroom audio system?
<b>RFI Response</b>	THIS SCOPE IS NOT PART OF PROJECT, DELETE SPECIFICATION SECTION 275100
<b>Question</b> <del>No. 03</del> <b>PRE-BID</b> <b>RFI 19</b>	Reference: Drawing Sheet T2.10 – Assistive Listening Device Schedule - Classroom  Question: Is the Listen Technologies LKS-8-A1 an acceptable product for the Classroom ALS portable system?
<b>RFI Response</b>	TBD
<b>Question</b> <del>No. 04</del>	Reference: Drawing Sheet T2.10 – Assistive Listening Device Schedule



Cal Coast Telecom

<b>PRE-BID RFI 20</b>	<b>Question: The Schedule states “Each Room that requires an ALS system shall have a Listen RF transmitter (LT-800-072 or equal) and a microphone. Does the Listen Technologies LKS-8-A1 portable system satisfy this requirement for the Classroom system or is it needed in addition to the transmitter and microphone?</b>
<b>RFI Response</b>	<b>NO ALS SYSTEM IN ROOMS 17, 18, 19, 20 OR ANY OTHER. ELIMINATE THIS SCOPE.</b>
<b>Question <del>No. 05</del> PRE-BID RFI 21</b>	<b>Reference: Drawing Sheet T2.10 – Assistive Listening Device Schedule</b>  <b>Question: The Schedule states “Each Room that requires an ALS system shall have a Listen RF transmitter (LT-800-072 or equal) and a microphone. Does the Listen Technologies LCS-120-01 Wi-Fi/RF Base System satisfy this requirement for the Multipurpose room system or is it needed in addition to the transmitter and microphone?</b>
<b>RFI Response</b>	<b>ALS SYSTEM IS ONLY REQUIRED IN ONE ROOM : MULTIPURPOSE ROOM A01 .</b>

**SECTION 10 14 19**  
**DIMENSIONAL LETTERS**

**PART 1 - GENERAL**

**1.01 SECTION INCLUDES**

- A. Cut exterior dimensional letters of metal composition.

**1.02 SUBMITTALS**

- A. Product Data: Submit product data for specified products. Include material details for each sign specified.
- B. Shop Drawings: Submit shop drawings showing layout, profiles, and product components, including dimensions, anchorage, and accessories.
- C. Samples: Submit supplier's standard color chart for selection purposes and selected colors for verification purposes.
- D. Installation: Submit supplier's installation instructions.
- E. Closeout Submittals per Division 01.
- F. Submit operation and maintenance data for installed products, including precautions against harmful cleaning materials and methods.
- G. Submit warranty documents specified herein.

**1.03 QUALITY ASSURANCE**

- A. Supplier: Obtain all products in this section from a single supplier.
- B. Installer: Installation shall be performed by installer specialized and experienced in work similar to that required for this project.

**1.04 DELIVERY, STORAGE, AND HANDLING**

- A. Comply with requirements of Division 01.
  - 1. Comply with manufacturer's ordering instructions and lead time requirements to avoid construction delays.
  - 2. Deliver products in manufacturer's original, unopened, undamaged containers with identification labels intact.
  - 3. Store products protected from weather, temperature, and other harmful conditions as recommended by supplier.
  - 4. Handle products in accordance with manufacturer's instructions.



# HMC Architects

## 1.05 WARRANTY

- A. Project Warranty: Comply with requirements of Division 01.
- B. Manufacturer's Warranty: Submit manufacturer's standard warranty document executed by authorized company official.
  - 1. Warranty Period: One year from product ship date. Warranty specifically excludes letter mounting substrate.

## PART 2 - PRODUCTS

### 2.01 SIGNAGE SYSTEMS

- A. Acceptable Manufacturers
  - 1. ASI-Modulex, Dallas, TX.
  - 2. A.R.K. Ramos, Oklahoma City, OK.
  - 3. Gemini Incorporated, Cannon Falls, MN.
- B. Or equal as approved in accordance with Division 01, General Requirements for substitutions.

### 2.02 CUT METAL LETTERS - DIMENSIONAL LETTERS

- A. Graphic Material: ASI - LPS (Cut Metal Letters) Series or equal.
  - 1. Material: Aluminum.
- B. Fabricated Letter:
  - 1. Letterstyle: As indicated on drawings.
  - 2. Height: 15-inches, unless noted otherwise.
  - 3. Depth: 2-inches.
  - 4. Thickness: As indicated on Drawings.
  - 5. Finish: Baked Enamel, both sides.
  - 6. Color: As selected by Architect.
- C. Mounting Method: F-3 Mounting, aluminum clips with threaded insert for stud mount. No visible fasteners.

### 2.03 FABRICATION - GENERAL

- A. General: Comply with requirements indicated for materials, thicknesses, finishes, colors, designs, shapes, sizes, and details of construction.
- B. Conceal fasteners if possible; otherwise, locate fasteners where they will be inconspicuous.
- C. Create signage to required sizes and layout. Comply with requirements indicated for design, dimensions, finish, color, and details of construction.

## PART 3 - EXECUTION

### 3.01 EXAMINATION

- A. Site Verification of Conditions: Verify installation conditions previously established under other sections are acceptable for product installation in accordance with manufacturer's instructions.
- B. Scheduling of installation by Owner or its representative implies that substrate and conditions are prepared and ready for product installation. Proceeding with installation implies installer's acceptance of substrate and conditions.

### 3.02 INSTALLATION

- A. Install letters in accordance with manufacturer's written installation instructions.
- B. Install letters in locations indicated using mounting methods specified and free from distortion, warp, or defect adversely affecting appearance.
- C. Install letters level, plumb, and at heights indicated per mounting specified.
- D. Install signs within the following tolerances and in accordance with manufacturer's recommendations.
- E. Exterior Signs: Within 1 inch vertically and horizontally of intended location.

### 3.03 CLEANING, PROTECTION, AND REPAIR

- A. Repair scratches and other damage which might have occurred during installation. Replace components where repairs were made but are still visible to the unaided eye from a distance of 10 feet.
- B. Remove temporary coverings and protection to adjacent work areas. Clean installed products in accordance with manufacturer's instructions prior to Owner's acceptance. Remove construction debris from project in accordance with provisions in Division 01.

## END OF SECTION

2 PRE-BID ADDENDUM 0



RELATIVE SHOWN ABOVE E  
DATE: 10/04/2021  
SHEET: 001 OF 010

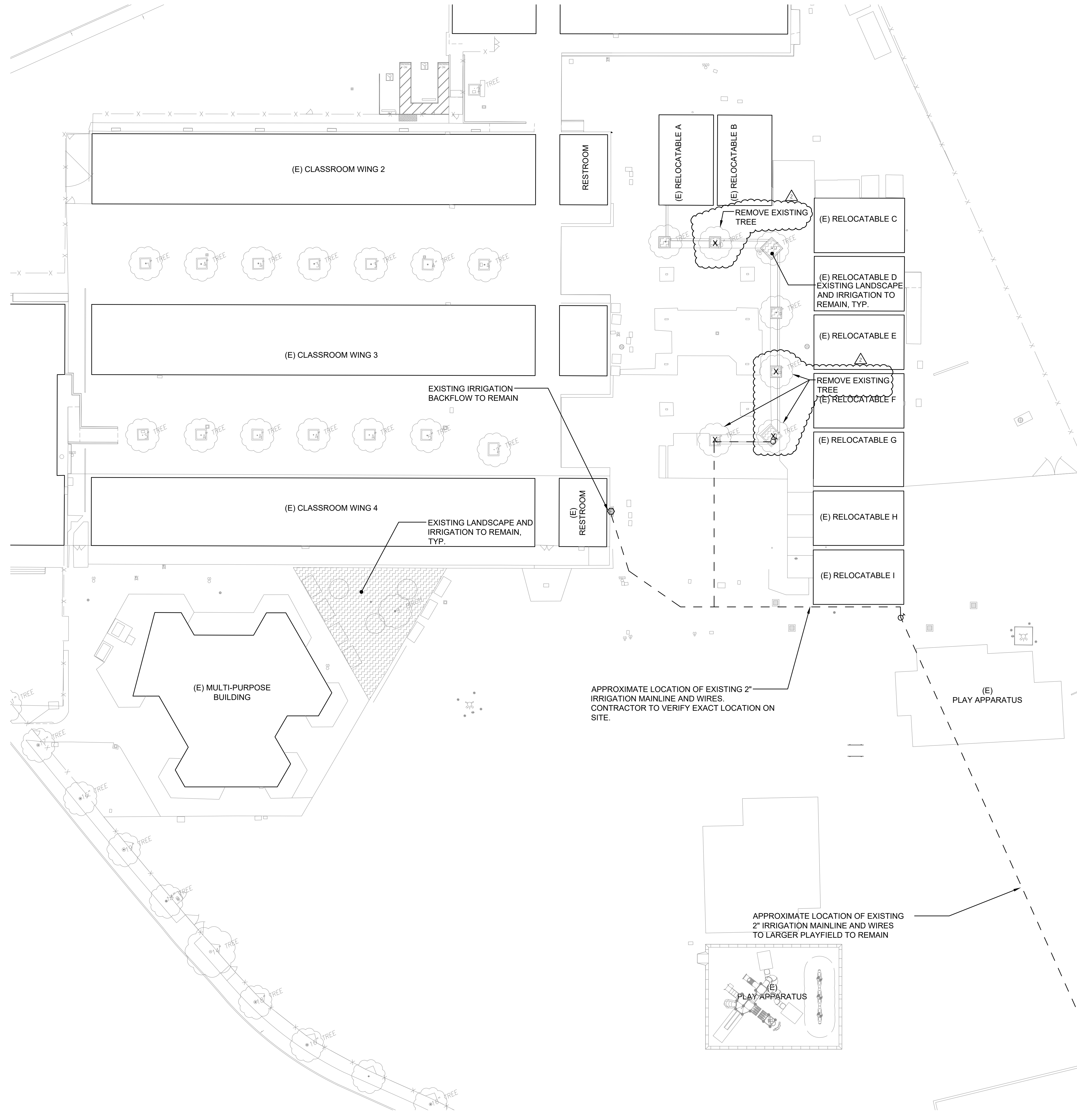

KEY	IRRIGATION DEMOLITION LEGEND
	EXISTING TREE TO REMAIN
	EXISTING TREE TO BE REMOVED
	EXISTING LANDSCAPE AND SPRINKLER AREAS TO REMAIN
	EXISTING BACKFLOW PREVENTION DEVICE TO REMAIN
	EXISTING AUTOMATIC CONTROL VALVE TO REMAIN
	EXISTING IRRIGATION MAINLINE TO REMAIN

PRE-CONSTRUCTION SPRINKLER IRRIGATION NOTES

- PRIOR TO START OF CONSTRUCTION CONTRACTOR REQUIRED TO CONTACT:  
NAME, TITLE: PETER LARIMER, MTW GROUP  
PHONE NUMBER: 916-369-3990  
TO SET UP A MEETING ON SITE TO OPERATE THE EXISTING SPRINKLER IRRIGATION SYSTEM AND DISCUSS THE MODIFICATIONS THAT ARE TO BE MADE TO THE EXISTING SYSTEM TO ACCOMMODATE FOR THE NEW CONSTRUCTION.
- CONTRACTOR TO OPERATE AND PROGRAM EXISTING SPRINKLER IRRIGATION SYSTEM THAT IS TO REMAIN IN ORDER TO PROVIDE WATER TO THE EXISTING LANDSCAPE TO REMAIN.
- CONTRACTOR TO REMOVE ALL EXISTING PIPE AND SPRINKLER HEADS WHEN THEY ARE IN NEW PLANTING AREAS.
- CONTRACTOR TO RESTORE AND REPAIR ANY EXISTING SPRINKLER IRRIGATION SYSTEM OR EXISTING LANDSCAPE WHICH IS IN AREAS TO REMAIN THAT IS DAMAGED BY NEW WORK.
- ALL WORK TO EXISTING SPRINKLER IRRIGATION SYSTEM TO BE COMPLETED PRIOR TO SITE DEMOLITION.

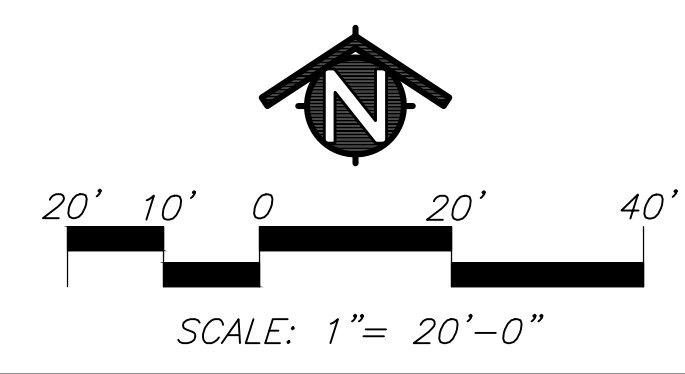

AGENCY  
APPROVAL:  
DSA #01-119574  
FILE #41-26

SAN MATEO FOSTER CITY  
SCHOOL DISTRICT  
1170 CHESS DR.,  
FOSTER CITY, CA 94404

HMC Architects

3542004-000

333 WEST SAN CARLOS STREET, STUDIO 750  
SAN JOSE, CA 95110  
408 977 9160 / www.hmcarchitects.com

**ISSUE**

DESCRIPTION	DATE
2 ADDENDUM #3	11.24.2021

20-30

**MTW** group  
LANDSCAPE ARCHITECTURE  
AND PLANNING  
2707 K Street, Suite 201  
Sacramento, CA 95816  
916 369-3990

Peter D. Larimer C-5284

FACILITY:  
GEORGE HALL ELEMENTARY SCHOOL  
130 SAN MIGUEL WAY, SAN MATEO, CA 94403

PROJECT:  
MULTIPURPOSE BUILDING AND SITE WORK

SHEET NAME:  
IRRIGATION DEMOLITION PLAN

**DSA BACKCHECK**

DATE: 10.04.2021	PROJ NO: 3542-004
SHEET:	

**LD0.0**



ALL LINES SHOWN ABOVE THIS DATE ARE FOR INFORMATION ONLY. DO NOT SCALE OR COPY THIS SHEET. ORIGINAL DATE: 11/24/2021

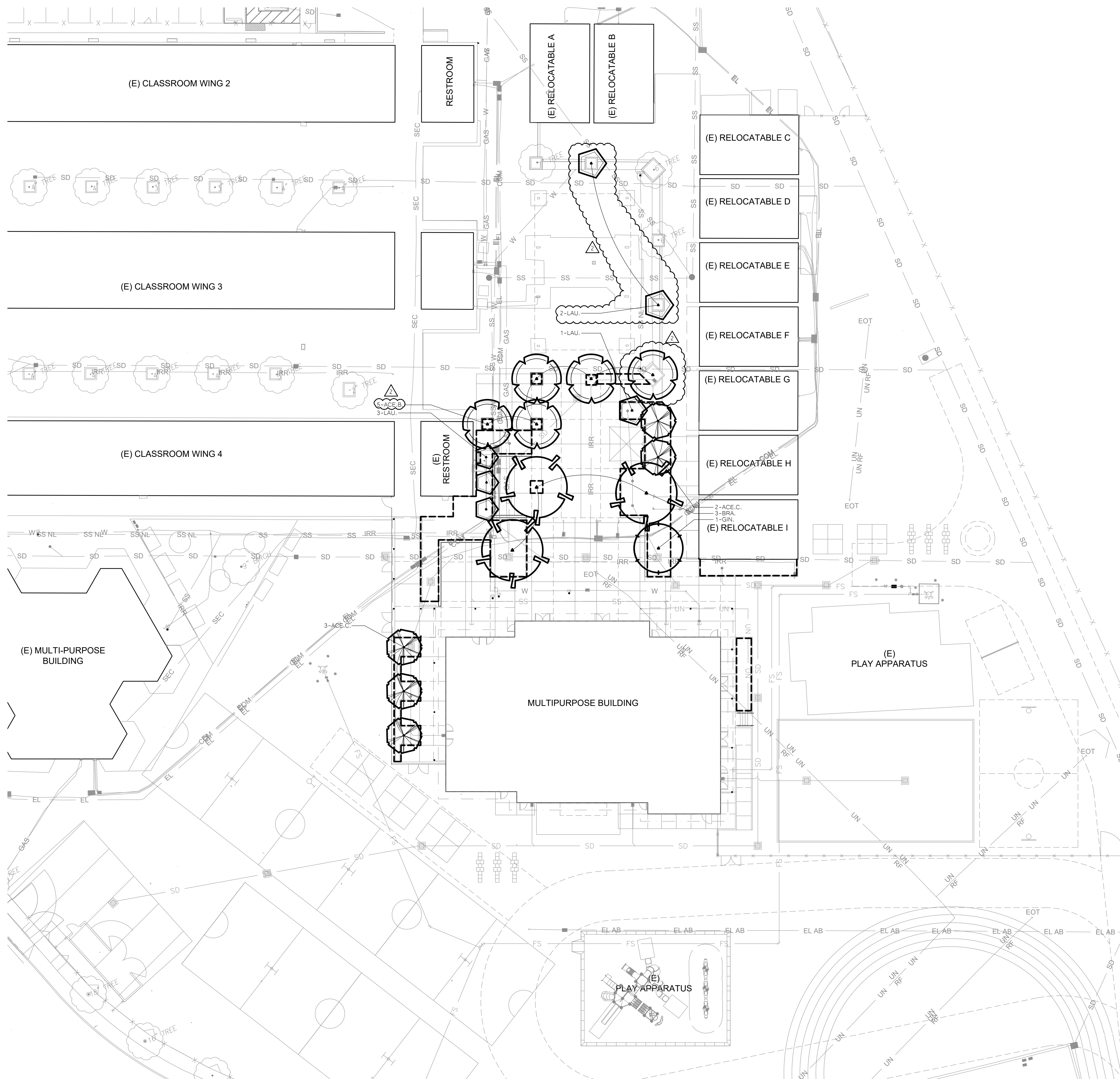

NOTE: SEE SHEET L5.1 FOR SHADING CALCULATIONS.

KEY

TREES - NOT ALL SYMBOLS SHOWN

ROOT BARRIER, INSTALL WHERE SHOWN ON PLANS  
SEE DETAIL L4.2-4

PLANT QUANTITY

PLANT KEY

EXISTING TREES TO REMAIN

LANDSCAPE LEGEND

PLANT MATERIAL LIST			
SIZE	QUANTITY	KEY	BOTANICAL NAME ... COMMON NAME
TREES:			
24" BOX	4	ACE.B.	ACER BUERGERIANUM ... TRIDENT MAPLE
24" BOX	5	ACE.C.	ACER CIRCINATUM ... VINE MAPLE
24" BOX	3	BR.A.	BRACHYTHON ACERIFOLIUS ... FLAME TREE
24" BOX	1	GIN.	GINKGO BILOBA "SARTOGA" ... MAINDENHAIR TREE
24" BOX	4	LAU.	LAURUS NOBILIS ... SWEET BAY

### GENERAL LANDSCAPE REQUIREMENTS/NOTES

- NO PLANTING SHALL BE STARTED UNTIL SPRINKLER IRRIGATION SYSTEM HAS BEEN TESTED BY CONTRACTOR IN PRESENCE OF OWNER'S REPRESENTATIVE AND NOTED DEFICIENCIES CORRECTED.
- NO PLANTING SHALL BE STARTED UNTIL SOIL PREPARATION AND FINISH GRADING OPERATIONS HAVE BEEN COMPLETED AND APPROVED BY THE OWNER'S REPRESENTATIVE.
- QUANTITIES SHOWN ON PLANT MATERIAL LIST ARE APPROXIMATE. PROVIDE QUANTITIES INDICATED ON LANDSCAPE PLAN.
- PLANT MATERIAL IS SUBJECT TO APPROVAL OF OWNER'S REPRESENTATIVE.
- SEE SHEET L4.2 FOR PLANTING INSTALLATION DETAILS.

#### ENVIRONMENTAL REQUIREMENTS:

GENERAL: PROCEED WITH WORK IN ORDERLY AND TIMELY MANNER TO COMPLETE INSTALLATION OF LANDSCAPING WITHIN CONTRACT LIMITS.

#### PROTECTION:

EXISTING CONSTRUCTION: EXECUTE WORK IN AN ORDERLY AND CAREFUL MANNER TO PROTECT NEW CONCRETE WALKS, WORK OF OTHER TRADES, AND OTHER IMPROVEMENTS.

EXISTING UTILITIES: DETERMINE LOCATION OF UNDERGROUND UTILITIES AND PERFORM WORK IN A MANNER WHICH WILL AVOID POSSIBLE DAMAGE. HAND EXCAVATE, AS REQUIRED, TO MINIMIZE POSSIBILITY OF DAMAGE TO UNDERGROUND UTILITIES. MAINTAIN GRADE STAKES SET BY OTHERS UNTIL REMOVAL IS MUTUALLY AGREED UPON BY ALL PARTIES CONCERNED. BE RESPONSIBLE FOR PROTECTION OF EXISTING UTILITIES WITHIN CONSTRUCTION AREA; REPAIR DAMAGE TO UTILITIES THAT OCCUR AS A RESULT OF OPERATIONS OF THIS WORK.

LANDSCAPING: PROTECT LANDSCAPE WORK AND MATERIALS FROM DAMAGE DUE TO LANDSCAPE OPERATIONS, OPERATIONS BY OTHER CONTRACTORS AND TRADES AND TRESPASSERS. MAINTAIN PROTECTION DURING INSTALLATION AND MAINTENANCE PERIODS. TREAT, REPAIR OR REPLACE DAMAGED LANDSCAPE WORK AS DIRECTED AT NO ADDITIONAL COST TO CONTRACT.

ADVERSE CONDITIONS: WHEN CONDITIONS DETRIMENTAL TO SOD OR PLANT GROWTH ARE ENCOUNTERED, SUCH AS RUBBLE FILL, ADVERSE DRAINAGE CONDITIONS, OR OBSTRUCTIONS, NOTIFY OWNER'S REPRESENTATIVE BEFORE STARTING WORK.

#### PLANTING AND TURF INSTALLATION SEASONS AND CONDITIONS

NO WORK SHALL BE DONE WHEN GROUND IS FROZEN, SNOW COVERED, TOO WET OR IN AN OTHERWISE UNSUITABLE CONDITION FOR AMENDING SOIL, FINISH GRADING OR PLANTING.

#### SOIL TESTING/SOIL IMPROVEMENT:

SEE SPECIFICATIONS 32 90 00, SECTION 3.02 SOIL TESTING AND SECTION 3.03 PREPARATION.

#### SOIL PERCOLATION

EXCAVATE 10 PLANTING PITS IN RANDOM AREAS OF SITE. FILL EXCAVATED PLANTING PITS WITH WATER TO 1/2 DEPTH OF PIT. PITS SHOULD DRAIN WITHIN 4 HOURS. IF PLANTING PITS DO NOT DRAIN, NOTIFY INSPECTOR IMMEDIATELY. PLANTING SHALL NOT BE STARTED UNTIL OWNER'S REPRESENTATIVE HAS RESOLVED A METHOD TO REMEDY DRAINAGE ISSUE.

#### PLANT MATERIAL STANDARDS

PLANTS SHALL BE IN ACCORDANCE WITH AMERICAN NATIONAL STANDARDS INSTITUTE (ANSI) ANSI Z60.1- AMERICAN STANDARD FOR NURSERY STOCK, EXCEPT AS OTHERWISE STATED IN SPECIFICATIONS OR SHOWN ON DRAWINGS. WHERE DRAWINGS OR SPECIFICATIONS ARE IN CONFLICT WITH ANSI Z60.1, DRAWINGS AND SPECIFICATIONS SHALL PREVAIL. PRUNE, THIN OUT AND SHAPE TREES IN ACCORDANCE WITH ANSI STANDARD HORTICULTURAL PRACTICE. PRUNE TREES TO RETAIN REQUIRED HEIGHT AND SPREAD, UNLESS OTHERWISE DIRECTED BY LANDSCAPE ARCHITECT. DO NOT CUT TREE LEADERS, AND REMOVE ONLY INJURED OR DEAD BRANCHES FROM FLOWERING TREES.

#### EXISTING LANDSCAPE AND SPRINKLER IRRIGATION SYSTEM

WORK LIMITS OF THIS PROJECT EXTEND INTO AREAS THAT WERE PREVIOUSLY DEVELOPED UNDER OTHER CONTRACTS. PRIOR TO START OF WORK, CONTRACTOR SHALL MEET WITH OWNER'S REPRESENTATIVE TO LOCATE ALL CONNECTIONS CALLED FOR ON DRAWINGS. WORK LIMITS/FENCING SHALL BE LAID OUT BY CONTRACTOR AND VERIFIED BY OWNER'S REPRESENTATIVE. FENCE TO BE INSTALLED AND IRRIGATION SYSTEM SHALL BE TESTED WITH CONTRACTOR, INSPECTOR, AND OWNER'S REPRESENTATIVE. PRESENT. DEFICIENCIES SHALL BE NOTED AT THIS TIME AND ARE THE RESPONSIBILITY OF OWNER. AT COMPLETION OF WORK, SYSTEM WILL AGAIN BE TESTED. DEFICIENCIES NOTED AT THIS TIME THAT WERE NOT NOTED PREVIOUSLY WILL BE RESPONSIBILITY OF CONTRACTOR. EXISTING LANDSCAPE THAT HAS BEEN DAMAGED DUE TO CONSTRUCTION SHALL BE RESTORED TO ORIGINAL CONDITION BY CONTRACTOR AT NO ADDITIONAL COST TO OWNER. PRIOR TO MAKING ANY CONNECTION TO MAIN LINE, CONTRACTOR SHALL NOTIFY OWNER 1 WEEK IN ADVANCE SO ADJUSTMENTS TO EXISTING WATERING PROGRAMS CAN BE MADE.

AGENCY  
APPROVAL:  
DSA #01-119574  
FILE #41-26



SAN MATEO FOSTER CITY  
SCHOOL DISTRICT  
1170 CHESS DR.,  
FOSTER CITY, CA 94404

HMC Architects

3542004-000

333 WEST SAN CARLOS STREET, STUDIO 750  
SAN JOSE, CA 95110  
408 977 9160 / www.hmcarchitects.com

### ISSUE

DESCRIPTION	DATE
2 ADDENDUM #3	11.24.2021

20-30

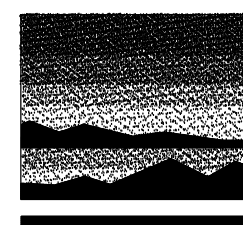

**MTW** group  
LANDSCAPE ARCHITECTURE  
AND PLANNING  
2707 K Street, Suite 201  
Sacramento, CA 95816  
916 265-2990

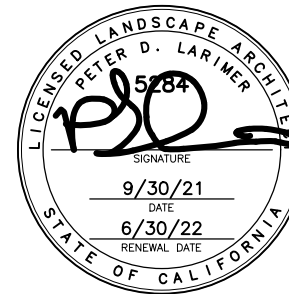

Peter D. Larimer

C-5284

FACILITY:  
GEORGE HALL ELEMENTARY SCHOOL  
130 SAN MIGUEL WAY, SAN MATEO, CA 94403

PROJECT:  
MULTIPURPOSE BUILDING AND SITE WORK

SHEET NAME:  
TREE PLANTING PLAN

### DSA BACKCHECK

DATE: 10.04.2021	PROJ NO: 3542-004
SHEET:	

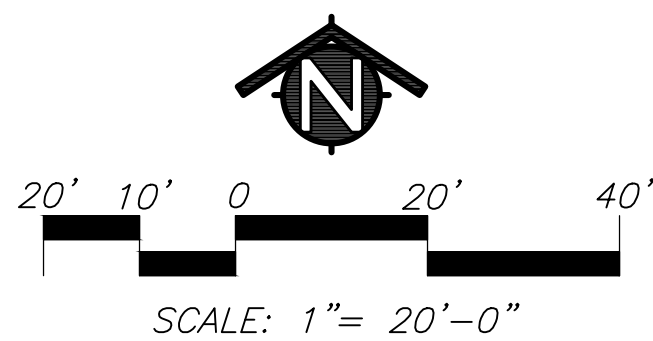

PLEASE RECYCLE

L1.1



REL LINE SHOWN ABOVE IS  
BASED ON 2017 LOT  
DATA. SEE ORIGINAL PAGE 2/2

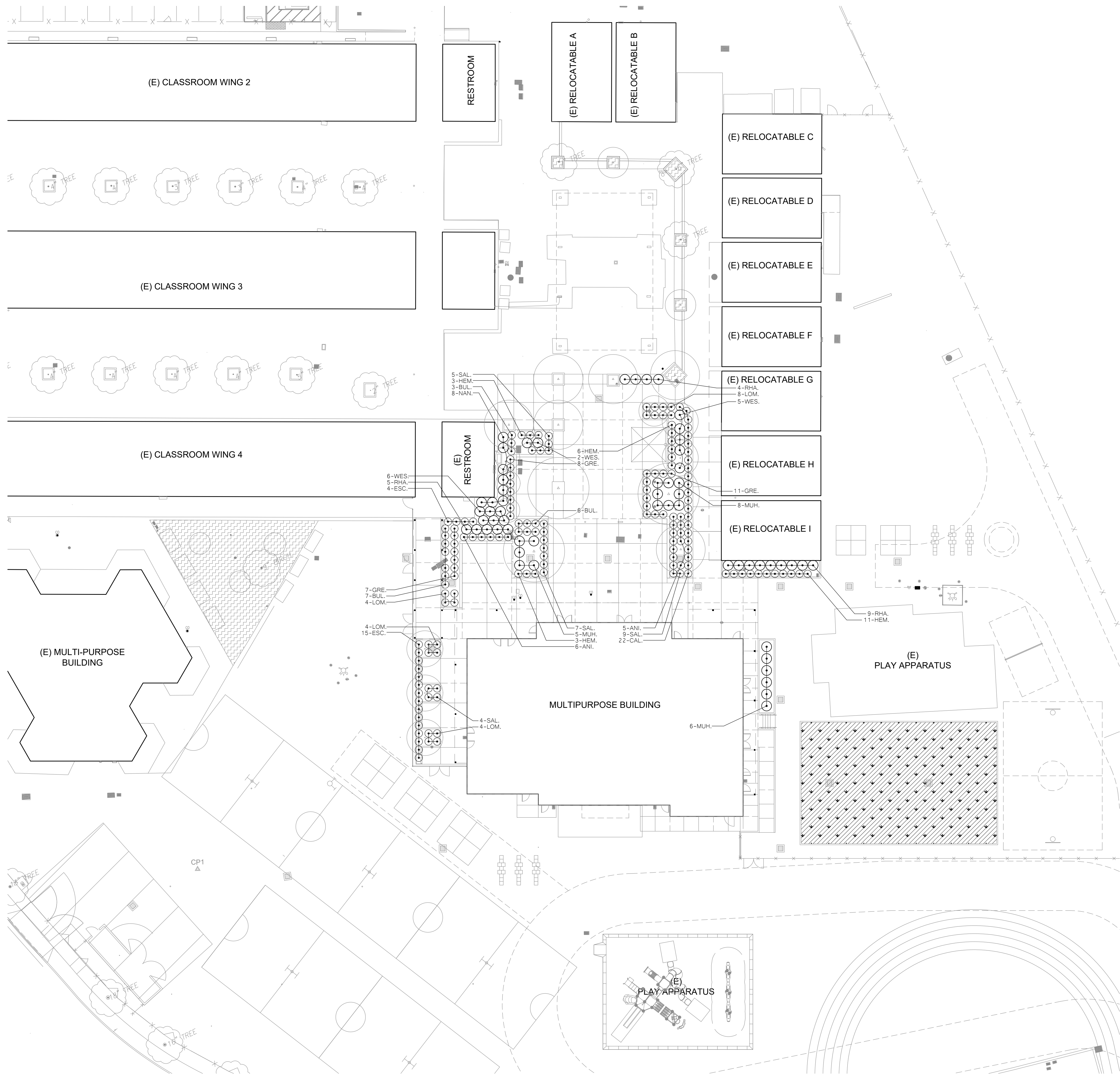



ALL LINES SHOWN ABOVE 15' DATE: 11/24/2021 SHEET: 001-119574-001

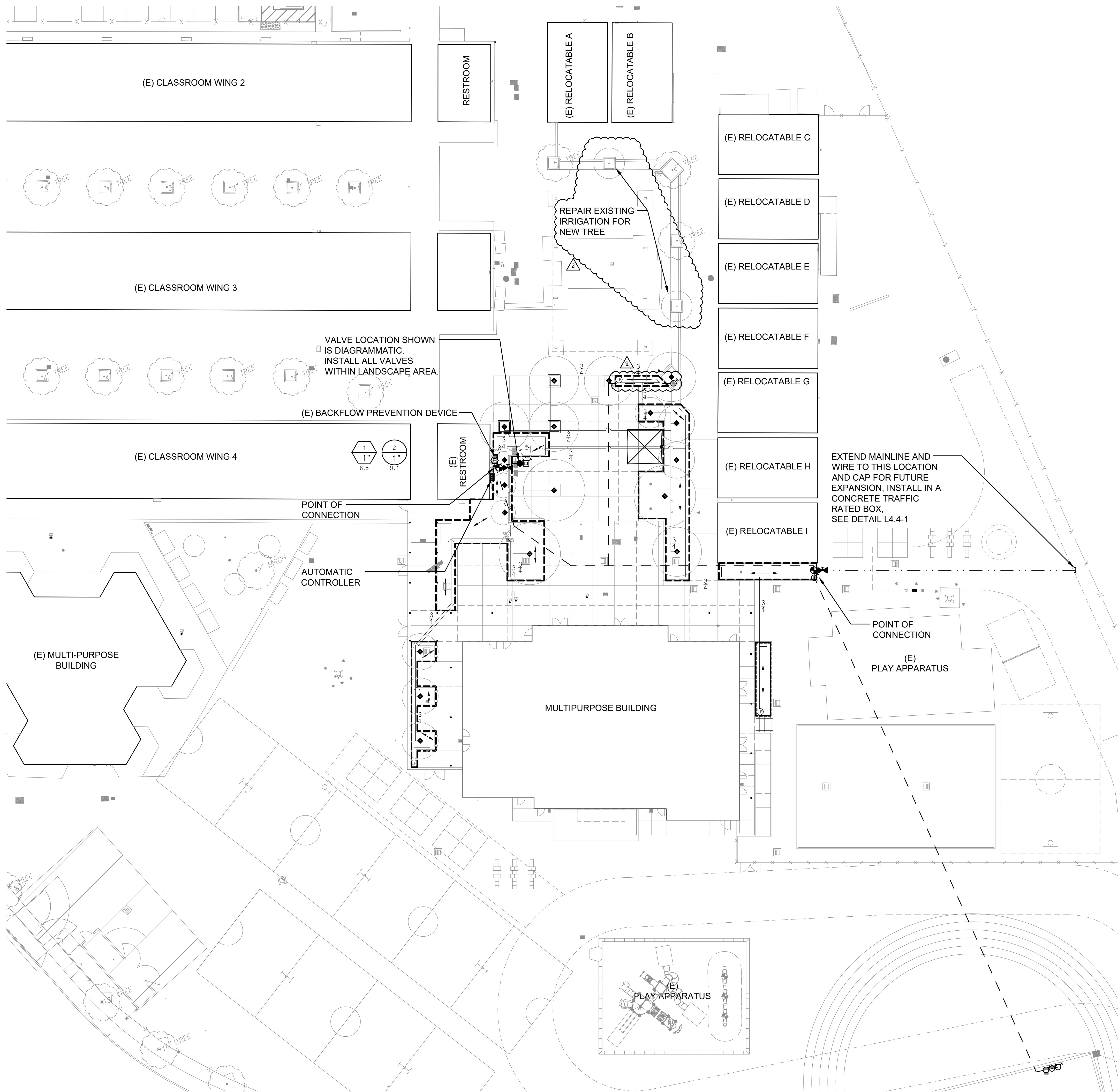

KEY	SPRINKLER IRRIGATION LEGEND
■	<b>AUTOMATIC CONTROLLER:</b> HUNTER A2C-1200-M 12-STATION BASE UNIT CONTROLLER, GRAY STEEL WALL MOUNT COORDINATE 110V SERVICE AND POWER CONNECTION WITH ELECTRICAL SUB-CONTRACTOR.
●	<b>POINT OF CONNECTION:</b> IRRIGATION SYSTEM OPERATING WATER PRESSURE: 40 PSI MAXIMUM FLOW IS 50 GPM  CONTRACTOR SHALL LOCATE EXISTING BACKFLOW PREVENTION DEVICE INDICATED ON CIVIL SHEETS. CONNECT AT THIS POINT AND EXTEND AS INDICATED ON DRAWINGS.
⊗	<b>EXISTING BACKFLOW PREVENTION DEVICE:</b>
⌵	<b>GATE VALVE:</b> TYPE: NIBCO NO T-113 WITH A NON-RISING STEM AND HANDWHEEL. GATE VALVE INSTALLED IN A VALVE BOX WITH TOP OF BOX SET FLUSH TO FINISH GRADE. GATE VALVE TO BE LINE SIZE.
---	<b>PRESSURE MAIN LINE:</b> TYPE: 2" SIZE, ASTM D1785, PVC SCHEDULE 40.  TRENCH DEPTH: IN PLANTED AREAS: 24" MINIMUM COVER. UNDER PAVED AREAS: 24" MINIMUM COVER. PVC SCHEDULE 40 SLEEVES ARE REQUIRED FOR ALL PIPING UNDER PAVEMENT.
---	<b>EXISTING PRESSURE MAIN LINE:</b>
---	<b>LATERAL LINE:</b> TYPE: ASTM D1785, PVC SCHEDULE 40, SOLVENT WELD ALL UNSIZED PIPE SHALL BE 3/4" SIZE. TRENCH DEPTH: IN PLANTED AREAS: BUBBLER HEADS: 12" MINIMUM COVER. UNDER PAVED AREAS: 24" MINIMUM COVER. PVC SCHEDULE 40 SLEEVES ARE REQUIRED FOR ALL PIPING UNDER PAVEMENT.
●	<b>AUTOMATIC CONTROL VALVE:</b> RAINBIRD PEB SERIES OR APPROVED EQUAL. VALVE SHALL HAVE PRESSURE REGULATION OPTION.
◆	<b>TREE BUBBLER HEADS (TWO HEADS PER SYMBOL):</b> RAINBIRD: 1402 BUBBLER NOZZLE WITH INLINE CHECK VALVE.
⊞	<b>AUTOMATIC DRIP IRRIGATION VALVE/FILTER/PRESSURE REGULATOR:</b> RAINBIRD CONTROL ZONE KIT MODEL KCZ-100-PRB-LC.
⬅➡	<b>SUBSURFACE INLINE DRIP SYSTEM:</b> NETAFIM TUBING TO BE TECHLINE CV AND IS TO BE INSTALLED IN THE DIRECTION OF THE ARROW AS SHOWN ON PLAN. TECHLINE TO BE INSTALLED 4" BELOW GRADE. PVC SCHEDULE 40 LATERAL LINES SHOWN ON THE PLAN, NETAFIM TECHLINE CV NOT SHOWN. NETAFIM DRIP TUBING SPACING: SHRUB/GROUNDCOVER PLANTER AREAS: 18" ROW SPACING (0.4 GPH @ 18" SPACING) TECHLINE CV TUBING NOT TO EXCEED 400' IN A SINGLE RUN.
⊞	<b>MANUAL LINE FLUSHING VALVE IN BOX:</b> MANUAL LINE FLUSHING VALVE TO BE INSTALL ON THE PVC PIPE IN AN EMITTER BOX BELOW GRADE.
⊞	INDICATES CONTROL VALVE AND STATION NUMBER
⊞	INDICATES CONTROL VALVE SIZE
⊞	INDICATES GALLONS PER MINUTE

- SPRINKLER IRRIGATION NOTES**
- COMPOSITE BASE SHEET: PROPOSED IMPROVEMENTS SHOWN ON DRAWINGS ARE SUPERIMPOSED ON A COMPOSITE BASE SHEET. THE COMPOSITE BASE SHEET IS A COMPILATION OF ARCHITECTURAL, ENGINEERING, AND OTHER DATA THAT IS PROVIDED. THE LANDSCAPE ARCHITECT SHALL NOT BE HELD LIABLE FOR CHANGES, INACCURACIES, OMISSIONS, OR ERRORS PERTAINING TO THE COMPOSITE BASE SHEET. CONTRACTOR SHALL BE RESPONSIBLE FOR REVIEWING THESE DOCUMENTS. ANY DISCREPANCIES NEED TO BE BROUGHT TO THE ATTENTION OF THE DESIGN TEAM AND RESOLVED PRIOR TO CONTINUATION OF WORK.
  - DESIGN PRESSURE SHOWN ON PLANS HAS BEEN FURNISHED BY WATER COMPANY OR WATER DISTRICT SERVING SITE. VERIFY PRESSURE ON-SITE PRIOR TO THE INSTALLATION OF ANY SPRINKLER IRRIGATION EQUIPMENT. IF THERE IS A DISCREPANCY, NOTIFY OWNER'S REPRESENTATIVE IMMEDIATELY IN WRITING SO ADJUSTMENTS CAN BE MADE BY LANDSCAPE ARCHITECT. FAILURE TO REPORT DISCREPANCIES AND CONTINUANCE OF WORK WILL RESULT IN ALL RE-DESIGN COSTS BEING CHARGED TO CONTRACTOR.
  - DETERMINE LOCATION OF UNDERGROUND UTILITIES. DAMAGE CAUSED BY INSTALLATION OF THIS WORK SHALL BE REPAIRED TO SATISFACTION OF GOVERNING AGENCY OR OWNER AT NO ADDITIONAL COST TO THE CONTRACT.
  - SPRINKLER OVER SPRAY SHALL NOT BE ALLOWED ON PUBLIC SIDEWALKS, BUILDING WALLS OR FENCES. MINIMUM OVERSPRAY MAY OCCUR IN PARKING AREAS. USE ADJUSTABLE NOZZLES WHENEVER POSSIBLE TO CONTROL SPRINKLER OVERSPRAY.
  - ALL LOCAL CODES AND ORDINANCES SHALL BE COMPLIED WITH. IF THERE IS A CONFLICT, NOTIFY OWNER'S REPRESENTATIVE IMMEDIATELY.
  - TESTING:  
A. PRESSURE TEST ALL UNDERGROUND PIPING AS FOLLOWS:  
SYSTEMS WITH BOOSTER PUMP:  
MAIN LINE - AT 100 PSI FOR 4 HOURS.  
LATERAL LINES - AT 100 PSI FOR 2 HOURS.  
SYSTEMS WITH OUT BOOSTER PUMP:  
MAIN LINE - AT STATIC PSI FOR 4 HOURS.  
LATERAL LINES - AT STATIC PSI FOR 2 HOURS.  
B. COVERAGE TEST: NOTE: PRIOR TO REQUESTING COVERAGE TEST, INSURE ALL HEADS ARE SET PLUMB, NOZZLES ARE ADJUSTED PROPERLY AND SYSTEM HAS BEEN CHECKED FOR AUTOMATION. REQUEST OWNER'S REPRESENTATIVE'S PRESENCE ON-SITE WHEN SPRINKLER SYSTEM IS COMPLETELY INSTALLED AND FULLY AUTOMATIC. PROVIDE ADEQUATE PERSONNEL AT THIS MEETING TO ADJUST AND FINE TUNE SYSTEM TO SATISFACTION OF OWNER'S REPRESENTATIVE.
  - LAYOUT ALL WORK PRIOR TO TRENCHING OPERATIONS TO DETERMINE IF MINOR MODIFICATIONS OR ADJUSTMENTS WILL BE REQUIRED.
  - INSTALL ALL SPRINKLER HEADS PERPENDICULAR TO SLOPES OR GRADE.
  - CONTROL WIRE SHALL BE UF-14, COLOR FOR LEAD AND WHITE FOR COMMON. SPLICES SHALL BE PERMITTED AT VALVE BOX LOCATIONS ONLY.
  - PROVIDE AND INSTALL AUTOMATIC CONTROLLER AND UF-14 CONTROL WIRE. ELECTRICAL SUBCONTRACTOR SHALL PROVIDE 110V SERVICE AND SERVICE HOOKUP FROM POWER SOURCE TO AUTOMATIC CONTROLLER.
  - COORDINATE ALL WORK WITH OTHER TRADES SO PROGRESS OF WORK IS NOT INTERRUPTED AND CAN BE COMPLETED IN A TIMELY MANNER.
  - NO PLANTING SHALL BE STARTED UNTIL ALL SPRINKLER WORK HAS BEEN TESTED AND APPROVED IN PRESENCE OF OWNER'S REPRESENTATIVE.
  - FOR SPRINKLER IRRIGATION INSTALLATION DETAILS, SEE SHEET NO. L4.3-L4.4.

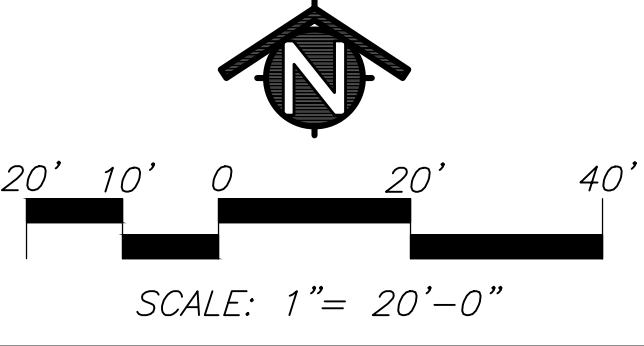

AGENCY  
APPROVAL:  
DSA #01-119574  
FILE #41-26

SAN MATEO FOSTER CITY  
SCHOOL DISTRICT  
1170 CHESS DR.,  
FOSTER CITY, CA 94404

HMC Architects

3542004-000

333 WEST SAN CARLOS STREET, STUDIO 750  
SAN JOSE, CA 95110  
408 977 9160 / www.hmcarchitects.com

ISSUE

DESCRIPTION	DATE
2 ADDENDUM #3	11.24.2021

20-30

MTW group  
LANDSCAPE ARCHITECTURE  
AND PLANNING  
2707 K Street, Suite 201  
Sacramento, CA 95816  
916 368-3990

Peter D. Larimer C-5284

FACILITY:  
GEORGE HALL ELEMENTARY SCHOOL  
130 SAN MIGUEL WAY, SAN MATEO, CA 94403

PROJECT:  
MULTIPURPOSE BUILDING AND SITE WORK

SHEET NAME:  
LANDSCAPE IRRIGATION PLAN

DSA BACKCHECK

DATE: 10.04.2021	PROJ NO: 3542-004
SHEET:	

L3.1

PLEASE RECYCLE ♻️



ALL DIMENSIONS SHOWN ABOVE THE SHEET UNLESS NOTED OTHERWISE

NOTE:  
1. PAINT METAL HANDRAILS BLUE TO MATCH EXTERIOR CANOPY COLUMN COLOR

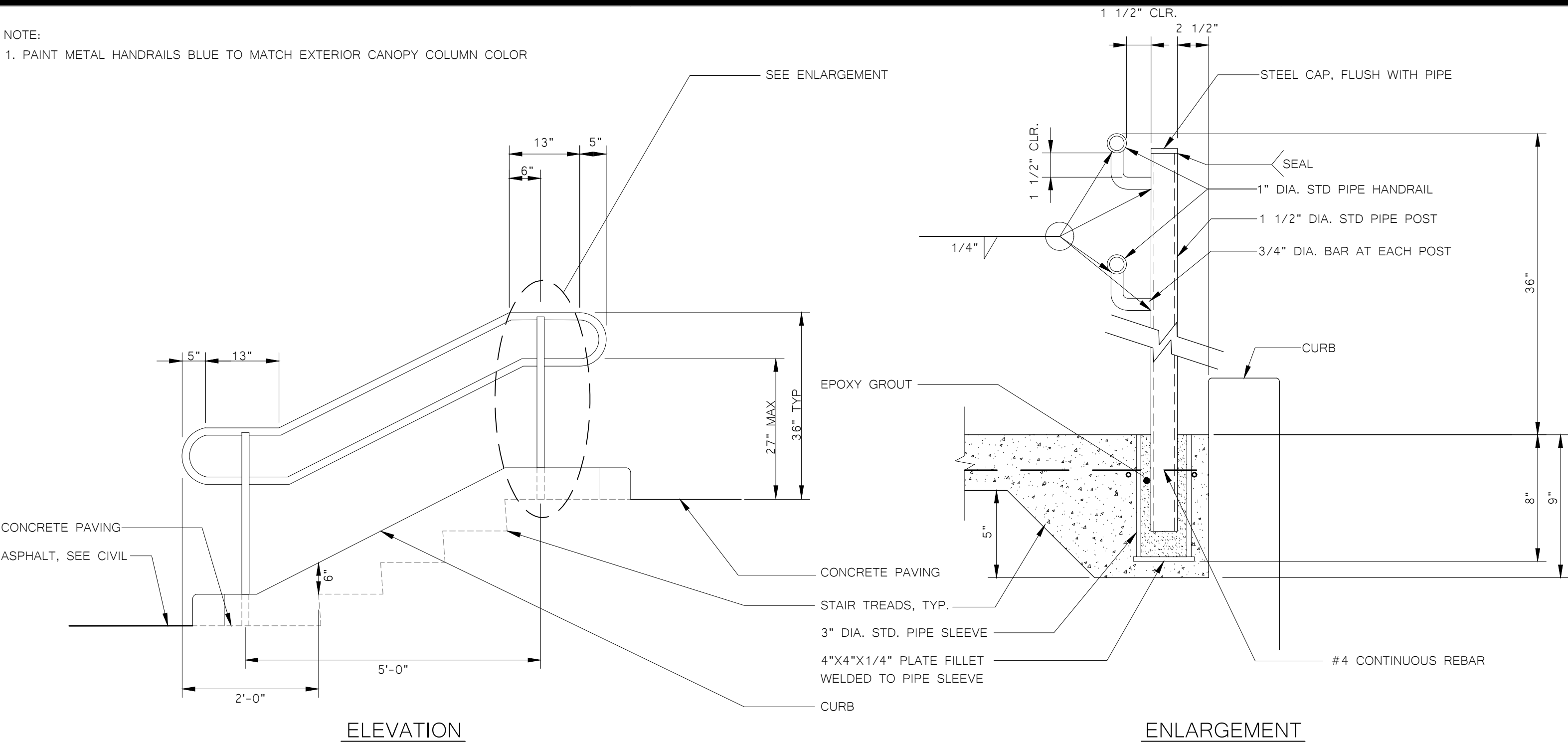

1 HANDRAIL AT STAIRS INSTALLATION DETAIL

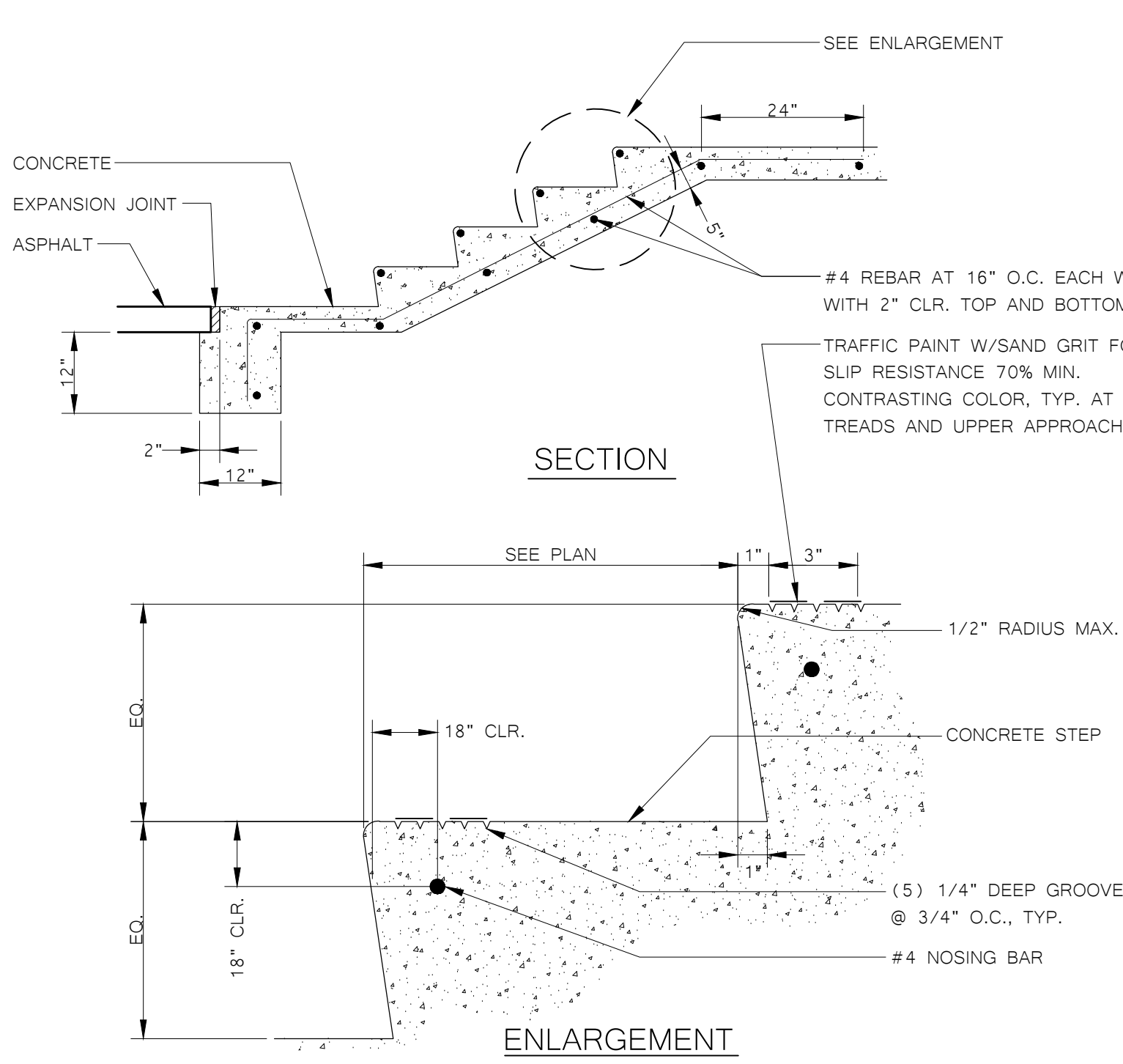

2 STAIRS SECTION AND NOSING DETAIL

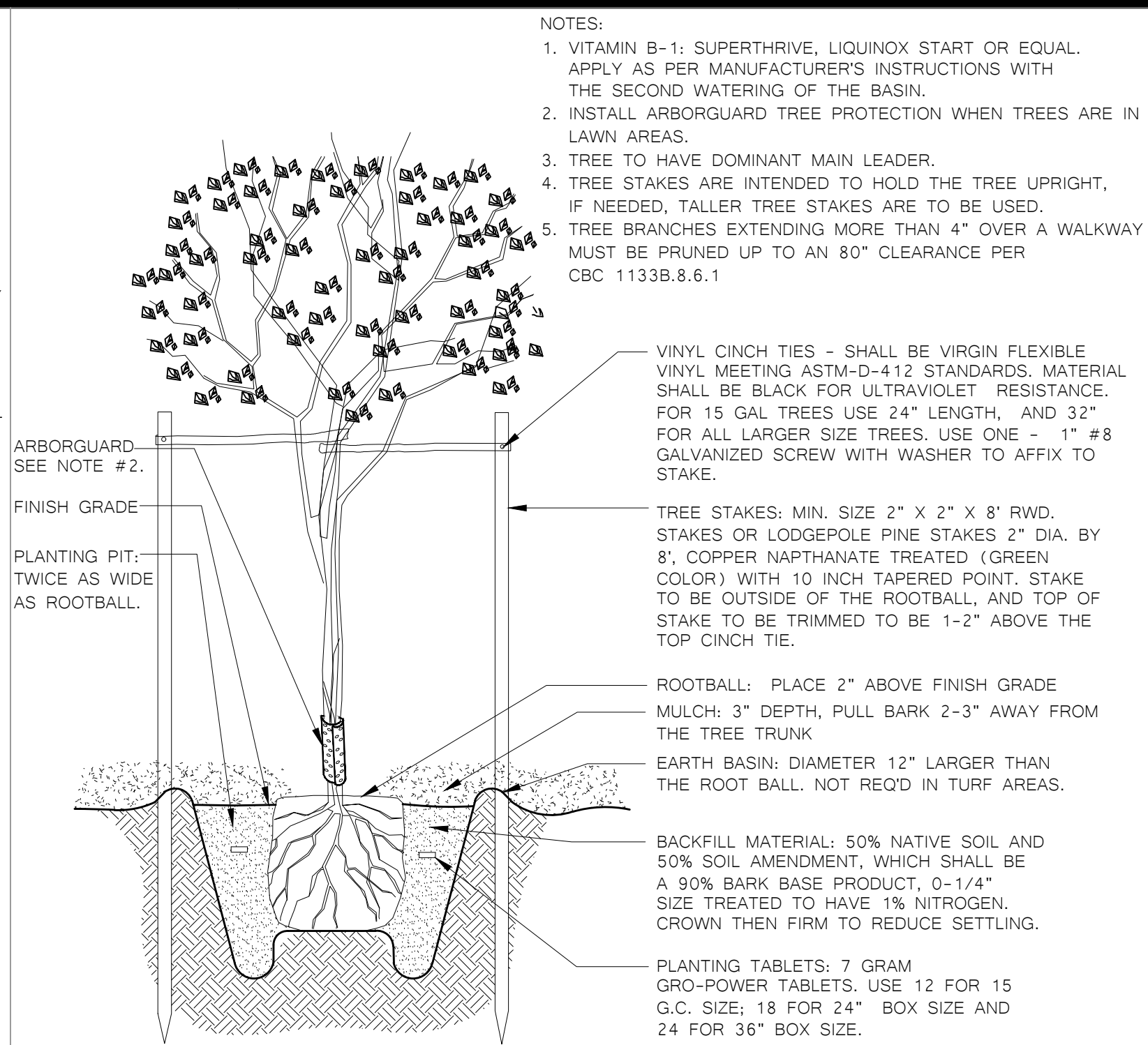

3 TREE PLANTING AND STAKING DETAIL

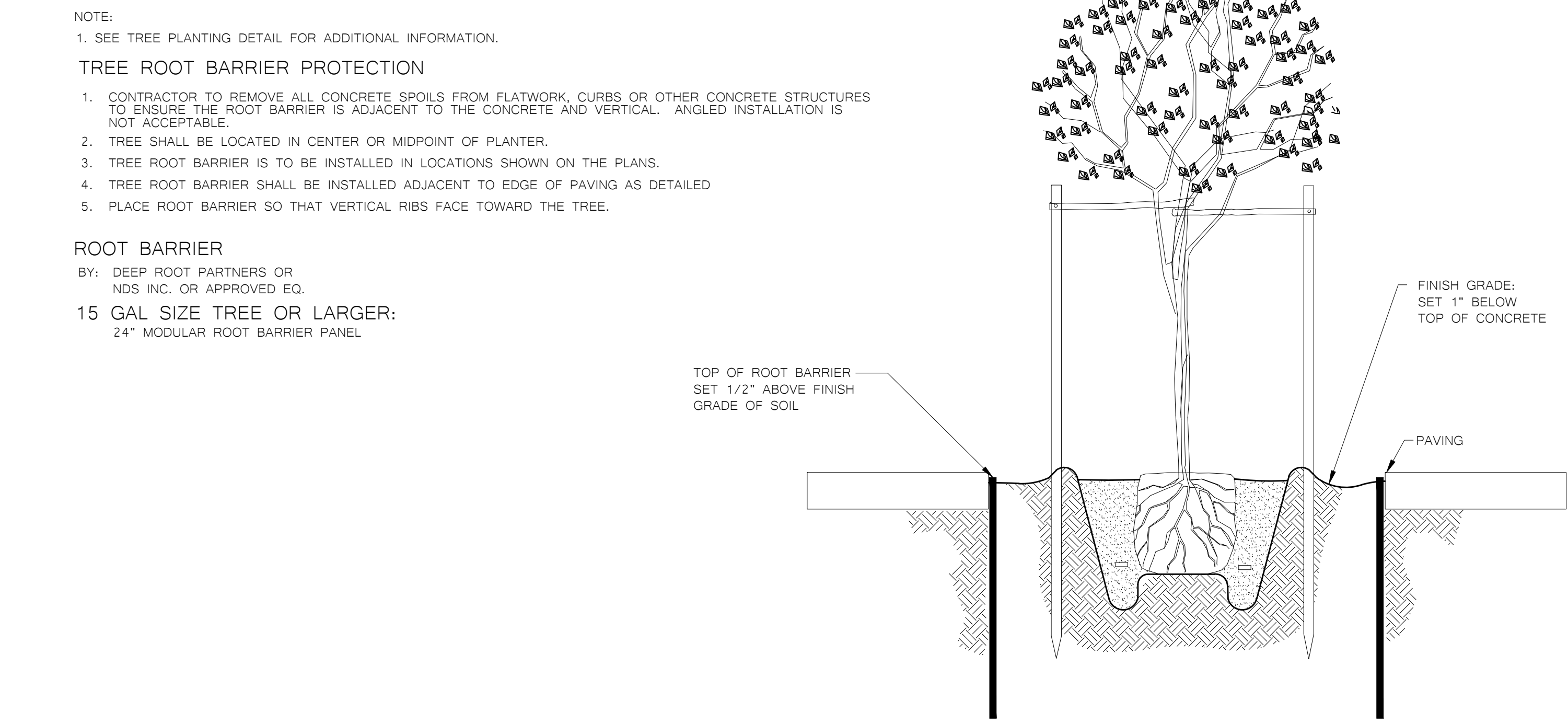

4 ROOT BARRIER CONTROL DETAIL

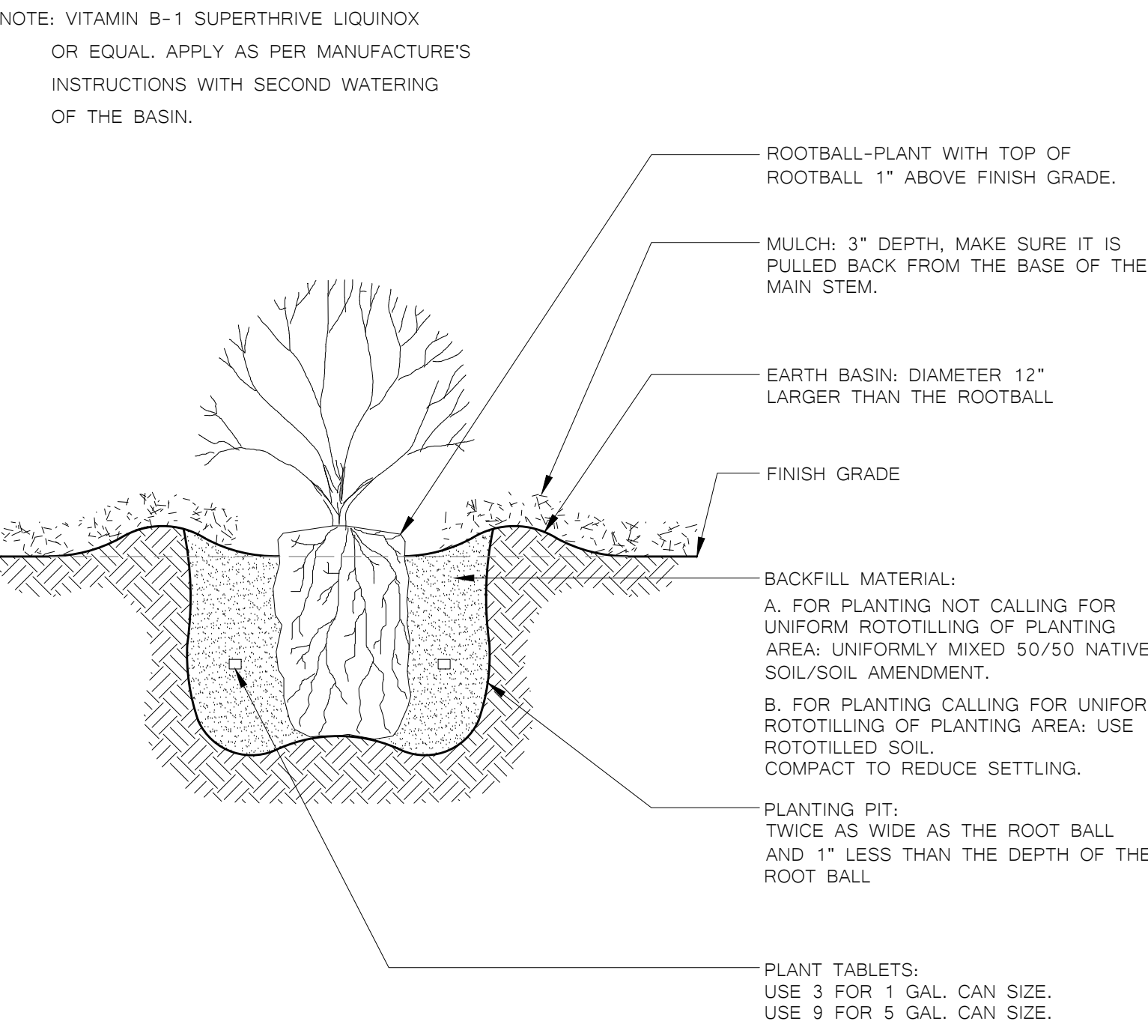

5 SHRUB PLANTING DETAIL

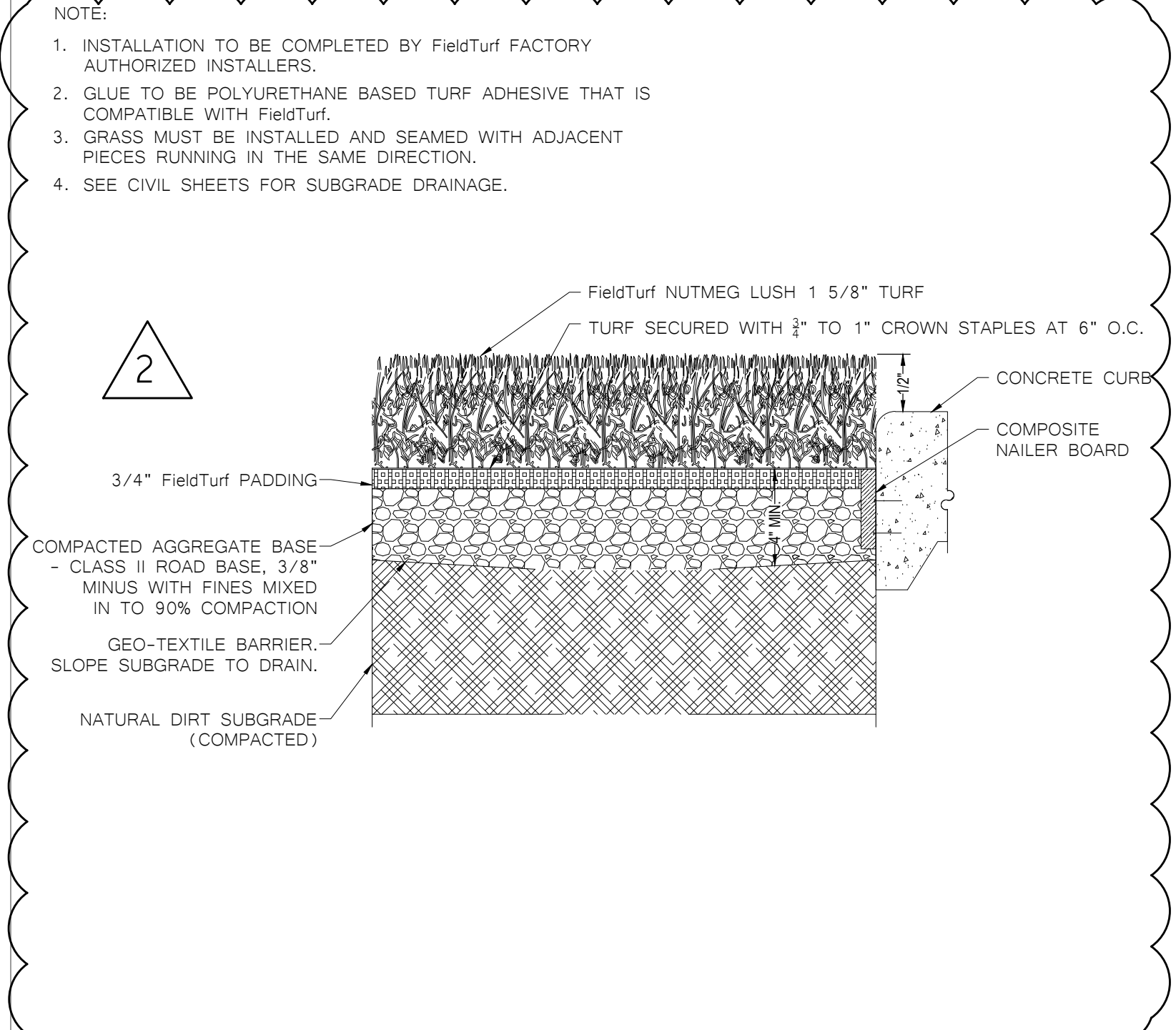

6 ARTIFICIAL TURF DETAIL

NOTES:  
1. FINISH GRADE OF SOIL TO BE 1" BELOW ADJACENT HARDSCAPE FOR BOTH LAWN AREAS AND PLANTER BED AREAS  
2. BARK MULCH DEPTH DOES NOT DICTATE THE ELEVATION OF THE FINISH GRADE  
3. BARK MULCH TO BE FEATHERED DOWN TO 1" DEPTH, 12" FROM EDGE OF HARDSCAPE

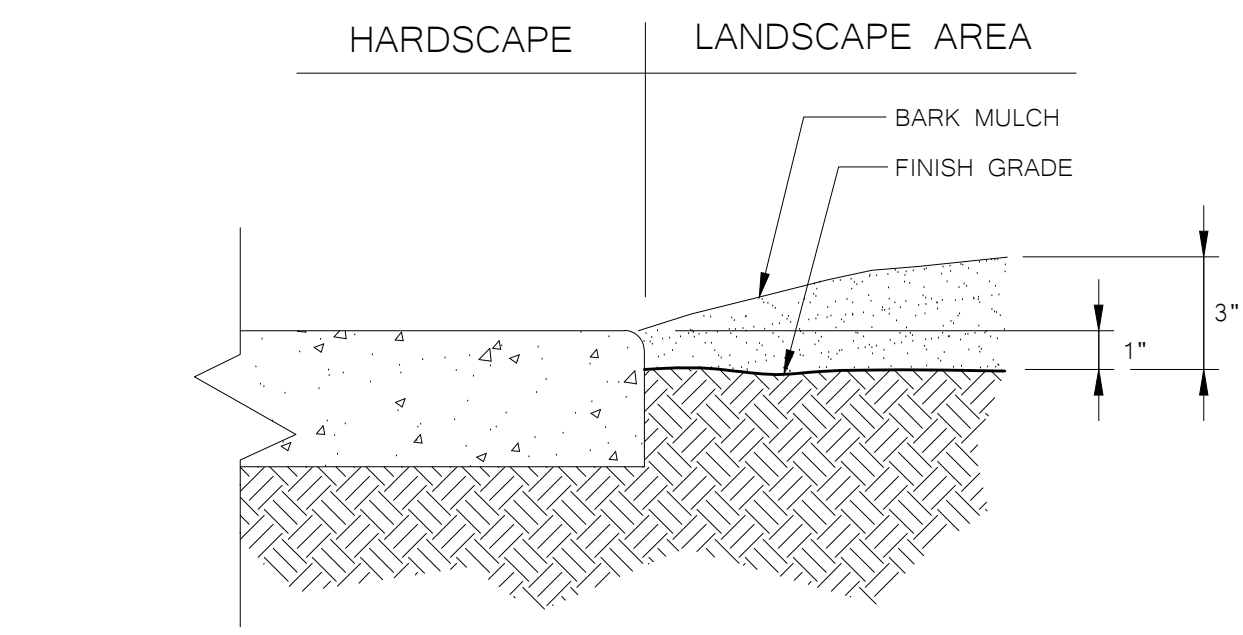

7 LANDSCAPE GRADE ADJACENT TO HARDSCAPE DETAIL

AGENCY  
APPROVAL:  
DSA #01-119574  
FILE #41-26

SAN MATEO FOSTER CITY  
SCHOOL DISTRICT  
1170 CHESS DR.,  
FOSTER CITY, CA 94404

HMC Architects

3542004-000

333 WEST SAN CARLOS STREET, STUDIO 750  
SAN JOSE, CA 95110  
408 977 8160 / www.hmcarchitects.com

ISSUE	
DESCRIPTION	DATE
1 PRE-BID ADDENDUM	11.05.2021
2 ADDENDUM #3	11.24.2021

20-30  
MTW group  
LANDSCAPE ARCHITECTURE  
AND PLANNING  
2707 K Street, Suite 201  
Sacramento, CA 95816  
916 268-2990  
Peter D. Larimer  
C-5284

FACILITY:  
GEORGE HALL ELEMENTARY SCHOOL  
130 SAN MIGUEL WAY, SAN MATEO, CA 94403

PROJECT:  
MULTIPURPOSE BUILDING AND SITE WORK

SHEET NAME:  
LANDSCAPE CONSTRUCTION AND PLANTING DETAILS

DSA BACKCHECK

DATE: 10.04.2021  
PROJ NO: 3542-004  
SHEET:

L4.2