

GROUND LEVEL ROOM SCHEDULE

Number	Name	Area
	UPPER GYM	2,354 SF
	TLT	49 SF
	COATS	49 SF
	TLT	22 SF
	TLT	21 SF
	TLT	26 SF
	TLT	24 SF
	CRAWL SPACE	1,178 SF
	CRAWL SPACE	11,971 SF
	COATS	44 SF
	STAIRS	139 SF
001	CLASSROOM	808 SF
001	ELEVATOR	59 SF
001	ELEV. LANDING	57 SF
002	CLASSROOM	804 SF
003	MECHANICAL ROOM	1,150 SF
004	CORRIDOR	843 SF
005	MUSIC ROOM	1,324 SF
005A	PRACTICE	79 SF
005B	PRACTICE	77 SF
005C	PRACTICE	78 SF
006	PIANO	153 SF
008	STORAGE	384 SF
009	STORAGE	18 SF
010	CORRIDOR	528 SF
011	BOYS	110 SF
012	GIRLS	118 SF
013	BALCONY	429 SF
015	CORRIDOR	404 SF
S-1	STAIRS	52 SF
S-3	STAIRCASE	336 SF
S-4	STAIRCASE	237 SF
S-5	STAIRCASE	128 SF

GROSS BUILDING AREA

Level	Gross Square Feet	Net Square Feet
BASEMENT LEVEL	4,585 SF	3,409 SF
GROUND LEVEL	9,899 SF	6,904 SF
LEVEL 1	25,130 SF	21,667 SF
LEVEL 2	17,242 SF	14,487 SF
LEVEL 3	2,257 SF	1,585 SF
	59,113 SF	48,052 SF

NOTE:
NET SQUARE FEET (NSF) FOR EACH LEVEL ABOVE INCLUDES ALL SPACES UNLESS NOTED BELOW.

- MECHANICAL SPACES INCLUDING ELECTRICAL CLOSETS, TELEPHONE CLOSETS, SECURITY CLOSETS, CUSTODIAL SPACES, AND MECHANICAL ROOMS
- STORAGE ROOMS
- SHAFTS, CHASES, AND WALL CAVITIES
- ELEVATORS ON ALL BUT ONE LEVEL

AREA LEGEND

- CIRCULATION
- CLASSROOM
- COMMON SPACE
- MECHANICAL
- RESTROOM
- STORAGE



BASEMENT LEVEL ROOM SCHEDULE		
Number	Name	Area
	ELEVATOR	42 SF
B01	GYM	2,454 SF
B02	CRAWL SPACE	575 SF
B03	VESTIBULE	558 SF
BN1	ELEV. LANDING	50 SF
S-3	STAIRCASE	266 SF
S-5	STAIR	80 SF

GROSS BUILDING AREA		
Level	Gross Square Feet	Net Square Feet
BASEMENT LEVEL	4,585 SF	3,409 SF
GROUND LEVEL	9,899 SF	6,904 SF
LEVEL 1	25,130 SF	21,667 SF
LEVEL 2	17,242 SF	14,487 SF
LEVEL 3	2,257 SF	1,585 SF
	59,113 SF	48,052 SF

NOTE:
NET SQUARE FEET (NSF) FOR EACH LEVEL ABOVE INCLUDES ALL SPACES UNLESS NOTED BELOW.

- MECHANICAL SPACES INCLUDING ELECTRICAL CLOSETS, TELEPHONE CLOSETS, SECURITY CLOSETS, CUSTODIAL SPACES, AND MECHANICAL ROOMS
- STORAGE ROOMS
- SHAFTS, CHASES, AND WALL CAVITIES
- ELEVATORS ON ALL BUT ONE LEVEL

AREA LEGEND

- CIRCULATION
- COMMON SPACE
- MECHANICAL

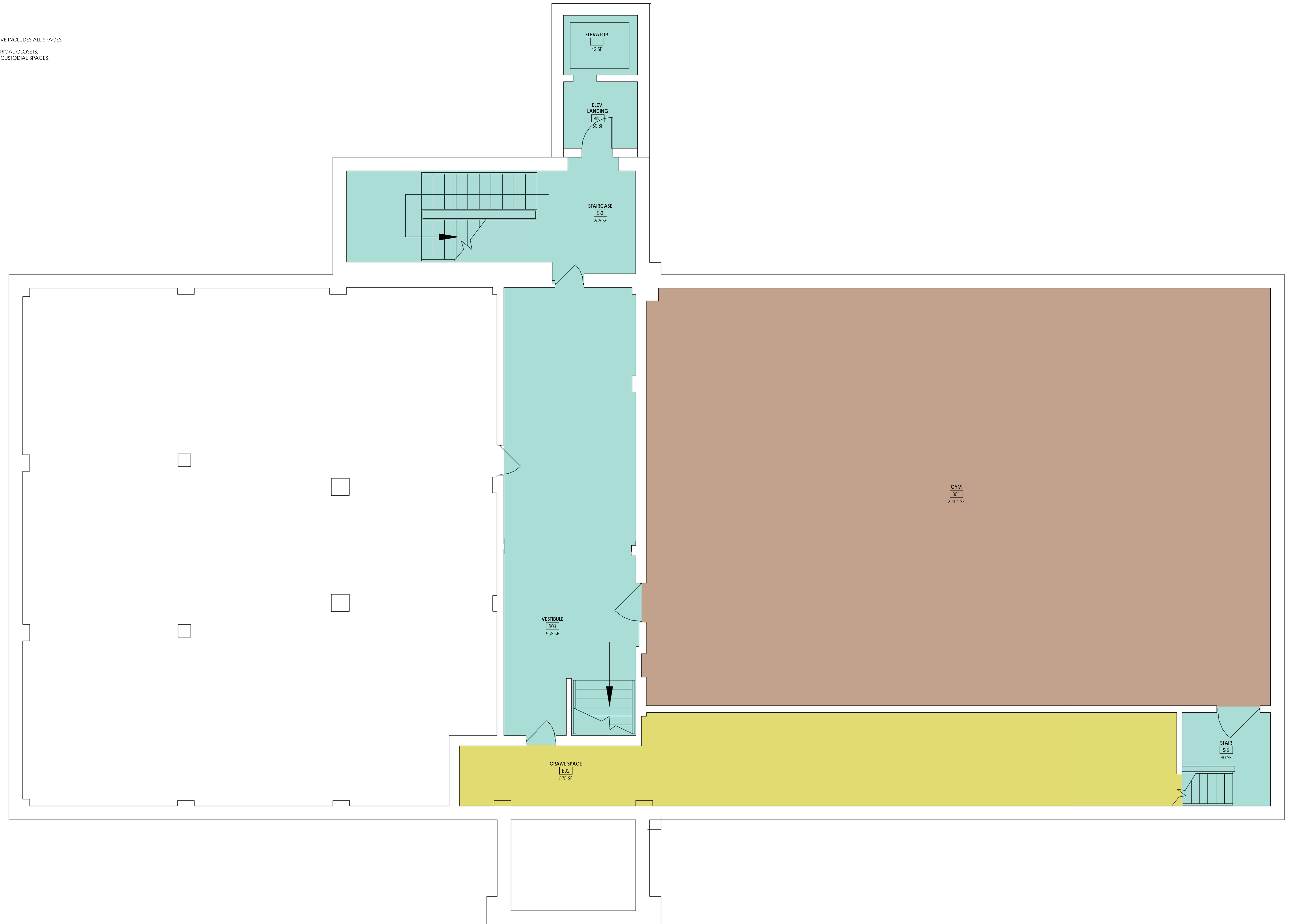

LEVEL ONE ROOM SCHEDULE		
Number	Name	Area
	TLT	22 SF
	TLT	23 SF
	STORAGE	20 SF
	COATS	47 SF
	TLT	22 SF
	TLT	23 SF
	STORAGE	20 SF
	COATS	47 SF
	TLT	38 SF
	TLT	40 SF
	STORAGE	20 SF
	TLT	23 SF
	TLT	21 SF
	COATS	47 SF
	STORAGE	20 SF
	TLT	23 SF
	TLT	22 SF
	COATS	47 SF
	STORAGE	20 SF
	TLT	23 SF
	TLT	21 SF
	COATS	47 SF
	STORAGE	20 SF
	TLT	23 SF
	TLT	21 SF
	COATS	50 SF
	STORAGE	20 SF
	TLT	23 SF
	TLT	21 SF
	COATS	47 SF
	CLOSET	53 SF
	CLOSET	52 SF
101	1ST GRADE	705 SF
102	SPECIAL ED	711 SF
103	KINDERGARTEN	711 SF
104	2ND GRADE	722 SF
105	1ST GRADE	721 SF
106	1ST GRADE	715 SF
107	KINDERGARTEN	715 SF
108	2ND GRADE	715 SF
110	LIBRARY	1,500 SF
111	CAFETERIA	2,618 SF
112	FACULTY DINING	205 SF
113	KITCHEN/DINING	812 SF
114A	STORAGE	91 SF
114B	TLT	46 SF
119	GIRLS	180 SF
120	BOYS	170 SF
121	CORRIDOR	809 SF
121A	JANITOR	34 SF
122	WORKROOM	148 SF
124	RECEPTION	286 SF
125	PRINCIPAL	264 SF
126	CONFERENCE ROOM	169 SF
129	CORRIDOR	3,080 SF
131	OFFICE	89 SF
132A	HVAC	62 SF
134	BOYS	108 SF
135	CORRIDOR	810 SF
136	GIRLS	110 SF
138	STAGE	798 SF
139	AUDITORIUM	1,875 SF
212	VESTIBULE	194 SF
B04	ELEV.	42 SF
IN1	ELEV. READING	50 SF
IN4	MDF ROOM	83 SF
S-3	STAIRS	298 SF
S-5	STAIR	123 SF
S-8	STAIR CASE	191 SF

GROSS BUILDING AREA		
Level	Gross Square Feet	Net Square Feet
BASEMENT LEVEL	4,585 SF	3,409 SF
GROUND LEVEL	9,899 SF	6,904 SF
LEVEL 1	25,130 SF	21,667 SF
LEVEL 2	17,242 SF	14,487 SF
LEVEL 3	2,257 SF	1,585 SF
	59,113 SF	48,052 SF

NOTE:
NET SQUARE FEET (NSF) FOR EACH LEVEL ABOVE INCLUDES ALL SPACES UNLESS NOTED BELOW:
• MECHANICAL SPACES INCLUDING ELECTRICAL CLOSETS, TELEPHONE CLOSETS, SECURITY CLOSETS, CUSTODIAL SPACES, AND MECHANICAL ROOMS
• STORAGE ROOMS
• SHAFTS, CHASES, AND WALL CAVITIES
• ELEVATORS ON ALL BUT ONE LEVEL

AREA LEGEND

- ADMINISTRATION
- CIRCULATION
- CLASSROOM
- COMMON SPACE
- FOOD SERVICE
- MECHANICAL
- OFFICE
- RESTROOM
- STORAGE



LEVEL THREE ROOM SCHEDULE		
Number	Name	Area
3N1	ELEV. LANDING	50 SF
232	ELEV.	42 SF
302	COMPUTER ROOM	797 SF
303	FILE SERVER	54 SF
304	ITENERANT CLASSROOM	276 SF
304A	STORAGE	22 SF
305	OFFICE	146 SF
A01	FAN ROOM	170 SF
S-3	STAIRCASE	263 SF
S-4	STAIRCASE	53 SF

GROSS BUILDING AREA		
Level	Gross Square Feet	Net Square Feet
BASEMENT LEVEL	4,585 SF	3,409 SF
GROUND LEVEL	9,899 SF	6,904 SF
LEVEL 1	25,130 SF	21,667 SF
LEVEL 2	17,242 SF	14,487 SF
LEVEL 3	2,257 SF	1,585 SF
	59,113 SF	48,052 SF

NOTE:
NET SQUARE FEET (NSF) FOR EACH LEVEL ABOVE INCLUDES ALL SPACES UNLESS NOTED BELOW:

- MECHANICAL SPACES INCLUDING ELECTRICAL CLOSETS, TELEPHONE CLOSETS, SECURITY CLOSETS, CUSTODIAL SPACES, AND MECHANICAL ROOMS
- STAIRCASES
- SHAFTS, CHASES, AND WALL CAVITIES
- ELEVATORS ON ALL BUT ONE LEVEL

AREA LEGEND

- CIRCULATION
- CLASSROOM
- MECHANICAL
- OFFICE
- STORAGE

