



**MEASURE K** SCHOOL BONDS  
Building for 21st Century Learning

# Measure K

## Bond Program Update

December 15, 2011

Long Beach Unified School District

CITIZENS' BOND OVERSIGHT COMMITTEE





- I. Current Projects Update
- II. Project Development Update



# I. Current Projects Update

## Jessie Elwin Nelson Middle School

### Project Summary:

- New 6-8 Middle School in the Poly Planning Area off of 20<sup>th</sup> Street and Cherry Avenue
- 31 Classrooms (89,288 S.F.)
- Library/Media Center, Gymnasium, Multipurpose Room, Other Support Facilities including a Soccer Field and Hard Court Areas
- \$12.9M State Funds received

### Project Status:

- Construction Phase: Approximately 94% complete
- Anticipated school opening: September 2012

### Upcoming Activities:

- Recommendations on new Boundary
- Commissioning and testing of systems in progress
- Furniture and Equipment
- Close Out and Certification



### Project Team:

- *Architect:* WestGroup Design
- *Contractor:* McCarthy Building Companies, Inc.
- *Inspector:* Knowland Inspection Services

### Budget:

- Estimated Total Project Budget: \$61.04M
- Estimated Construction Budget: \$45.41M
- Dollars Expended as of (10/31/11): \$50.10M



# I. Current Projects Update

## Jessie Elwin Nelson Middle School

### Construction Progress Photos



Aerial view of site





## II. Current Projects Update

Jessie Elwin Nelson Middle School



View of Main Entry / Bldg. A



View of Main Entry / Bldg. A



Courtyard between Bldg. A and B



Courtyard between Bldg. D and E

Construction Progress Photos

Long Beach Unified School District



## II. Current Projects Update

Jessie Elwin Nelson Middle School



Building A Courtyard



Courtyard between Bldg. C and D

Construction Progress Photos



Bldg. C Corridor



## II. Current Projects Update

Jessie Elwin Nelson Middle School



Typical classroom



Typical classroom

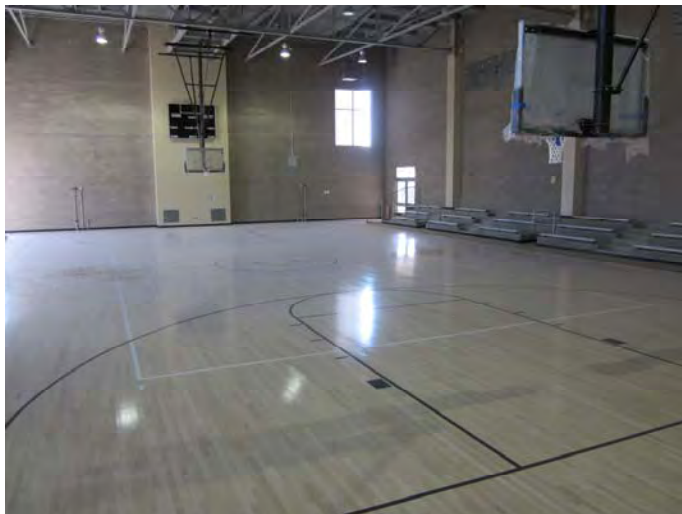

Gymnasium



Multi-Purpose Room

Construction Progress Photos

Long Beach Unified School District





# I. Current Projects Update

Ernest S. McBride, Sr. High School

## Project Summary:

- New High School in the Millikan Planning Area.
- 43 Classrooms (150,000 S.F.)
- Self-Contained Athletics Programs
- Two Grant Applications Approved:
  - Health/Medical  
Grant: \$1.5M  
Matching Contribution: \$1.5M
  - Engineering Design  
Grant: \$1.5M  
Matching Contribution: \$1.5M

## Project Status:

- Demolition Contract: Completed
- Waterline Relocation: Completed
- Main Buildings: Construction started 7/1/11 and is approximately 16% complete
- Anticipated school opening: September 2013



## Project Team:

- *Architect:* LPA, Inc.
- *Contractor (Demo & Abatement):* A to Z
- *Contractor (Waterline Relocation):* Excel Paving
- *Contractor (Main Buildings):* Hensel Phelps
- *Inspector (Main Buildings):* Knowland Inspection Services

## Budget:

- Estimated Total Project Budget: \$101.08M
- Estimated Construction Budget: \$74.77M
- Dollars Expended as of (10/31/11): \$11.63M





# I. Current Projects Update

Ernest S. McBride, Sr. High School



Site Plan



# I. Current Projects Update

Ernest S. McBride, Sr. High School



Bldg. A



Bldg. B



Bldg. F



Central Plant

Construction Progress Photos

Long Beach Unified School District





# I. Current Projects Update

Ernest S. McBride, Sr. High School



Bldg. A



Bldg. A

Construction Progress Photos



Bldg. F Corridor

Long Beach Unified School District





# I. Current Projects Update

Ernest S. McBride, Sr. High School



Bldg. C



Bldg. F

Construction Progress Photos



Bldg. C

Long Beach Unified School District



# I. Current Projects Update

## Roosevelt Elementary School New Construction

### Project Summary:

- Existing 64,000 S.F. facility in the Poly Planning area
- Built in 1935 with additions in 1945 and 1966
- 3.8 Acre Site
- Facilities Master Plan recommended complete campus replacement
- New Elementary School will be approximately 99,000 S.F and provide 47 classrooms
- On-site parking structure for staff

### Project Status:

- Master Planning and Conceptual Design: Completed
- Design Development: Underway
- Target school re-opening: January 2015 (1)

### Upcoming Activities:

- Agencies review meetings

Notes:

(1) Subject to additional evaluation during Design Development Phase



### Project Team:

*Architect:* Ghataode Bannon Architects, LLP  
*Pre-Construction Consultant:* Tilden Coil Constructors

### Budget:

- Estimated Total Project Budget: \$51.83M
- Estimated Construction Budget: \$38.66M
- Dollars Expended as of (10/31/11): \$781K





# I. Current Projects Update

## Roosevelt Elementary School New Construction







# I. Current Projects Update

## Roosevelt Elementary School New Construction





# I. Current Projects Update

## Roosevelt Elementary School New Construction







# I. Current Projects Update

## Roosevelt Elementary School New Construction







# I. Current Projects Update

## Roosevelt Elementary School New Construction





# I. Current Projects Update

## Roosevelt Elementary School New Construction







# I. Current Projects Update

## Roosevelt Elementary School New Construction







# I. Current Projects Update

## Cabrillo High School Pool

### Project Summary:

- New 40 meter pool and associated support facilities for Cabrillo High School
- Campus build out was completed in 2000
- Scope will include:
  - Addressing access and parking
  - New campus marquee sign
  - Computer lab HVAC upgrade

### Project Status:

- Construction Documents: Completed
- DSA Approval: Underway
- Anticipated Pool opening: Summer 2013

### Upcoming Activities:

- DSA Back Check/Approval
- Lease-Leaseback negotiation



### Project Team:

- *Architect:* PJHM Architects, Inc.
- *Pre-Construction Consultant:* C.W. Driver

### Budget:

- Estimated Total Project Budget: \$16.45M
- Estimated Construction Budget: \$12.00M
- Dollars Expended as of (10/31/11): \$785K



# I. Current Projects Update

## Cabrillo High School Pool



Birds-eye view from the southwest portion of the new pool facility



# I. Current Projects Update

## Cabrillo High School Pool



Birds-eye view from the northeast portion of the new pool facility





# I. Current Projects Update

## Cabrillo High School Pool



View of new pool facility looking toward Locker Building and Ticket/Concession Building



# I. Current Projects Update

## Jordan High School Major Renovation

### Project Summary:

- Existing facilities built in 1930's and 1940's with additions built in the 1950's through 1990's
- 26.89 acre site with approximately 301,663 S.F. of permanent buildings and additional 31,680 S.F. of portable structures
- Facilities Master Plan recommends a Major Renovation
- Master Plan capacity is 3,600 students



### Project Status:

- North Long Beach Initiative: Completed
- Master Planning: Underway
- Construction target start: May 2014 (may likely be phased construction over several years)

### Upcoming Activities:

- Interim housing and construction phasing studies

### Project Team:

- *Architect:* NTD Architects
- *Pre-Construction Consultant:* McCarthy Building Companies

### Budget:

- Estimated Total Project Budget: \$158.27M
- Estimated Construction Budget: \$105.80M
- Dollars Expended as of (10/31/11): \$857K



# I. Current Projects Update

## New H.S. #2 at the Former Browning Site

### Project Summary:

- New High School #2 at the Browning school site off of Hill Street and Redondo Avenue located in the Wilson Planning Area
- 10.258 Acre Site
- Master Plan capacity is 800 students
- Educational programs being considered include: hospitality, tourism, recreation, and people movement



### Project Status:

- Site and Property Investigations: Completed
- Master Planning: Underway
- High School Planning Committee: Completed
- Anticipated school opening: September 2016

### Project Team:

- *Architect:* NAC Architecture
- *Pre-Construction Consultant:* TBD

### Budget:

- Estimated Total Project Budget: \$63.26M
- Estimated Construction Budget: \$44.90M
- Dollars Expended as of (10/31/11): \$242K





# I. Current Projects Update

District Wide Projects – AB300 Building  
Newcomb K-8 AB300/New Construction

## Project Summary:

- Existing 69,000 S.F. facility in the Millikan Planning Area
- Built in 1962 and 1964
- 13.5 Acre Site
- Original scope of work includes AB300 Seismic Retrofit and Major Renovation/Addition (Facility Master Plan)
- Current recommended scope of work is a Complete Campus Replacement
- New 105,000 S.F. facility will include 46 classrooms

## Project Status:

- Master Planning: Complete
- Conceptual Design: Underway
- Target School re-opening: September 2015 (1)

## Upcoming Activities:

- Site traffic studies

Notes:

(1) Subject to additional evaluation during Conceptual Design Phase



## Project Team:

- *Architect:* Westgroup Designs, Inc.
- *Pre-Construction Consultant:* Turner Construction Company

## Budget:

- Estimated Total Project Budget: \$53.87M
- Estimated Construction Budget: \$38.23M
- Dollars Expended as of (10/31/11): \$754K



# I. Current Projects Update

District Wide Projects – AB300 Building  
Newcomb K-8 AB300/New Construction

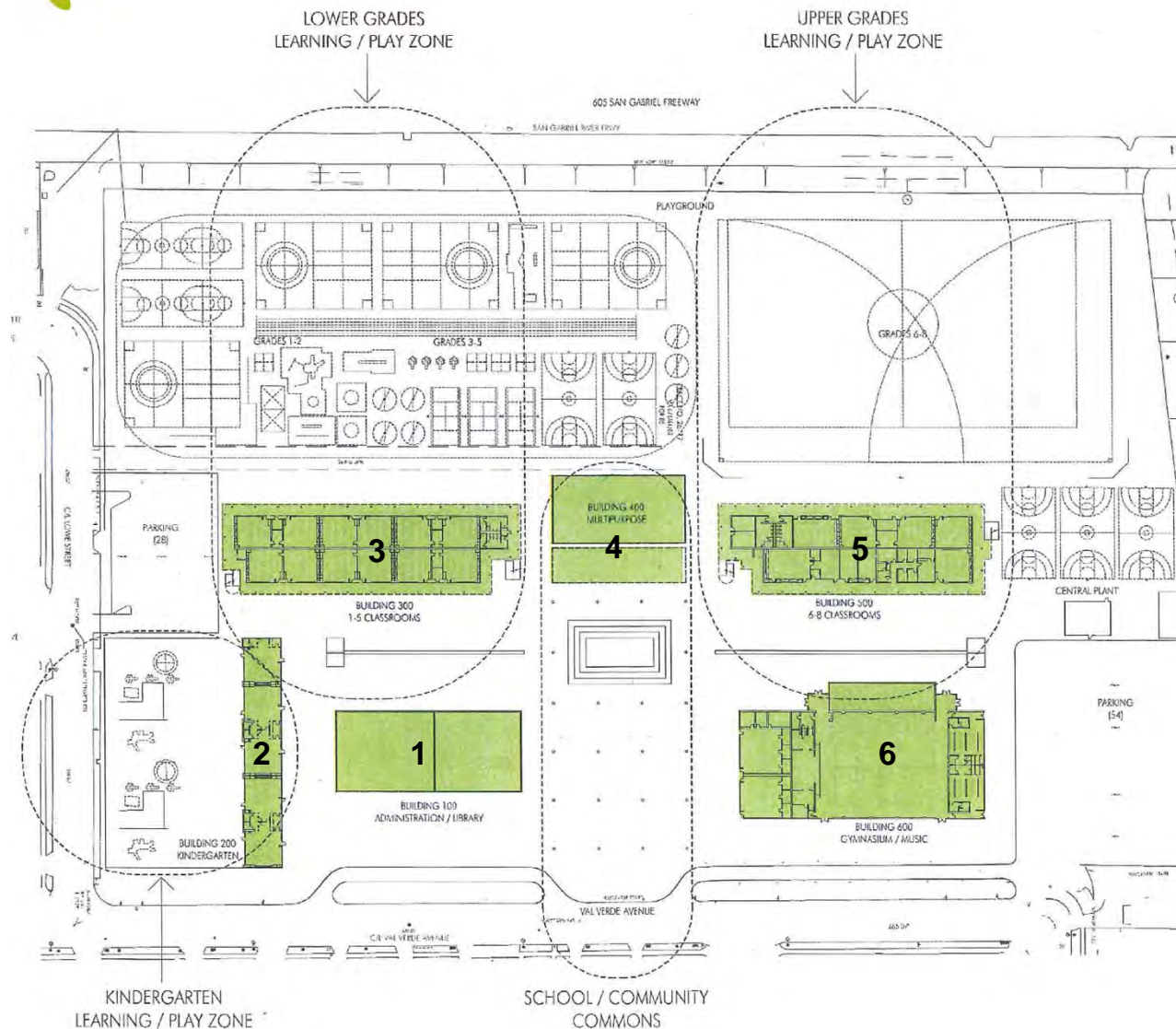

## Building Legend:

- 1) Administration/  
Library
- 2) Kindergarten
- 3) Grades 1-5
- 4) Multipurpose  
Room/Cafeteria
- 5) Grades 6-8
- 6) Gymnasium

**Proposed Site Plan**



# I. Current Projects Update

## District Wide Projects – Deportabilization DOH Portable Removal Phase 1

### Project Summary:

- Remove DOH (Department of Housing) Buildings at 14 Sites:
  - Addams E.S.
  - Grant E.S.
  - Hamilton M.S
  - Harte E.S.
  - Keller E.S.
  - Kettering E.S.
  - Beach H.S. (Former Long Beach School for Adults
  - McKinley E.S.
  - Robinson K-8
  - Signal Hill E.S.
  - Stephens M.S.
  - Webster E.S.
  - Willard E.S.
  - Wilson H.S.

### Project Status:

- Removal: Completed 9/24/11
- Project Close-out: Underway



### Project Team:

- *Architect:* Lionakis Architects
- *Contractor:* Norm Wilson & Sons, Inc. (2 Sites)
- *Contractor:* DOJA, Inc. (12 Sites)

### Budget:

- Estimated Total Project Budget: \$513K
- Estimated Construction Budget: \$300K
- Dollars Expended as of (10/31/11): \$395K





# I. Current Projects Update

## District Wide Projects – Deportabilization Lakewood DOH Portable Removal

### Project Summary:

- Remove DOH (Department of Housing) Building (40'x72') at Lakewood High School



### Project Status:

- Design Development: Complete
- Construction Documents: Complete
- Bid/Procurement: Pending
- Anticipated Removal: Spring 2012

### Project Team:

- *Architect:* MSP Architects
- *Contractor:* TBD

### Budget:

- Estimated Total Project Budget: \$96K
- Estimated Construction Budget: \$55K
- Dollars Expended as of (10/31/11): \$16.3K



# I. Current Projects Update

## District Wide Projects – Deportabilization Portable Removal Phase 1

### Project Summary:

- Removal of portable buildings at the following sites:
  - Lindbergh M.S.
  - Stephens M.S.



### Project Status:

- Design Development: Completed
- Construction Documents: Completed
- Anticipated Removal: Winter 2011-12

### Project Team:

- *Architect:* NAC Architecture
- *Contractor:* Oceanstate Development, Inc.

### Budget:

- Estimated Total Project Budget: \$488K
- Estimated Construction Budget: \$325K
- Dollars Expended as of (10/31/11): \$35.7K





# I. Current Projects Update

## District Wide Projects – Building System Improvements Boiler Replacement Phase 1

### Project Summary:

- Replacement of 24 Boilers at the following sites:
  - Bancroft M.S.
  - Gant E.S.
  - Kettering E.S.
  - Lakewood H.S.
  - Beach H.S. (Former Long Beach School for Adults)
  - Lowell E.S.
  - McKinley E.S.
  - Millikan H.S.
  - Tincher Preparatory School
  - Wilson H.S.

### Project Status:

- Site Assessment: Completed
- Construction Documents: Completed
- DSA Approval: Underway
- Anticipated Construction: Summer 2012



### Project Team:

*Architect:* Ruhnau Ruhnau Clarke Architects

*Contractor:* TBD

### Budget:

Estimated Total Project Budget: \$3.39M

Estimated Construction Budget: \$2.43M

Dollars Expended as of 10/31/11): \$284K



# I. Current Projects Update

## District Wide Projects – Building System Improvements Lighting and Ceiling Replacement Phase 1

### Project Summary:

- Removal and replacement of all ceilings and light fixtures at the following sites:
  - Adams E.S.
  - Bryant E.S.
  - Lee E.S.
  - Lincoln E.S.
  - McKinley E.S.
  - Rogers M.S.
  - Stephens M.S.
  - Washington M.S.
  - Willard E.S.



### Project Team:

- *Architect:* CSDA Architects
- *Contractor:* TBD

### Budget:

- Estimated Target Project Budget: \$16.31M
- Estimated Construction Budget: \$11.59M
- Dollars Expended as of (10/31/11): \$706K

### Project Status:

- Site Assessment: Completed
- Design Development: Completed
- Construction Documents: Project currently on hold pending review of scope



### Project Summary:

- ADA Improvements at the following sites:
  - Stephens M.S.  
Accessibility upgrades to various portable classroom buildings
  - King E.S.  
Accessibility upgrades to the Administration Building



### Project Status:

- Design Phase: Completed
- Construction Documents: Completed
- DSA Approval: Completed
- Construction Anticipated: Summer 2012

### Project Team:

- *Architect:* NAC Architecture
- *Contractor:* TBD

### Budget:

- Estimated Total Project Budget: \$796K
- Estimated Construction Budget: \$500K
- Dollars Expended (as of 10/31/11): \$86.9K





# I. Current Projects Update

## District-Wide Projects – DSA Certification

### Project Summary:

- DSA Certification of 389 Applications identified to date
- 155 Applications are now Certified (complete)
- 234 Applications are under evaluation with 10 Applications at DSA for Certification
- 5 District sites are “Clear”:
  - Bancroft M.S.
  - Jordan Freshman Academy
  - Longfellow E.S.
  - Los Cerritos E.S.
  - Naples E.S.

### Project Status:

- Ongoing strategic planning with DSA-LA and State Architect



### Project Team:

- *Architect:* FTA Architect, TBD
- *Inspector:* Dynamic Engineering
- *Material Testing and Inspection:* Twining Labs
- *Contractor:* TBD

### Budget:

- Estimated Total Project Budget: \$5.2M
- Estimated Construction Budget: \$3.0M
- Dollars Expended (as of 10/31/11): \$121.6K



#### District-Wide Technology Projects

- **Core Switch and UPS Replacement Phase II**  
Replace core switch and UPS at remaining 34 sites that were not covered by ERATE Funds.  
Budget: \$850,000
- **Edge Switch Replacement**  
Replace edge switches at all 84 Measure K eligible sites.  
Budget: \$7,000,000
- **Telecommunications**  
Replace phone switch and handsets at all 84 Measure K eligible sites.  
Budget: \$7,000,000
- **Wireless Data Communication**  
Install wireless access points at all 84 Measure K eligible sites.  
Budget: \$11,797,388 (1)
- **Intercom and Clock System**  
Replacement and new installation of intercom and clock system at all 84 Measure K eligible sites.  
Budget: \$5,000,000
- **Security Technology and Infrastructure**  
Upgrade security technology and infrastructure at all High School Sites  
Budget: \$1,500,000

**Notes:**

(1)Current budget may not be sufficient for all sites



#### Project Status:

- Finalize technology/system specifications
- Developing procurement and implementation schedule

#### Project Team:

- *Contractor:* TBD

#### Budget:

- Estimated Total Project Budget: 33.1M



#### Wireless Data Communication Implementation

- Current Conditions:
  - 3 School sites (Washington MS, Hill MS, and Jefferson MS) currently have wireless coverage for most or all of their campus.
  - 3 School sites (Marshall MS, Lowell MS, and Longfellow ES) are requesting wireless survey to start process of purchasing wireless equipment and devices for their site.
- Common Core State Standards (CCSS) for Electronic Assessments:
  - District will use Smarter Balanced Assessment Consortium (SBAC) to establish parameters.
  - Assessments will be developed for English language arts and mathematics for grades 3-8 and 11.
  - “Paper and pencil” options for 3 years to support states that do not have sufficient infrastructure to make a complete transition at the onset.
- Phased Implementation Strategy (1)
  - Wireless Assessments
  - District-Wide Implementation
    - Phase I (2012/13): Pilot Projects at 1 Elementary, 2 Middle Schools, and 1 High School
    - Phase II (2012/13): 11 High Schools
    - Phase III (2013/14): 12 Middle Schools and 25 Elementary Schools
    - Phase IV (2013/14): 11 Middle Schools and 20 Elementary Schools

**Notes:**

(1) Current budgets may not be sufficient to complete all sites.





## II. Project Development Update

### District-Wide Projects – AB300 Projects

#### Project Summary:

- Seismic upgrade to buildings identified on the State's AB 300 report.
- Seismic Mitigation Program's recent revisions to promote participation.
- Proposed Projects include:
  - Hill MS Gymnasium
  - Hamilton MS Gymnasium
  - Hoover MS Gymnasium
  - Bancroft MS Gymnasium
  - Lakewood HS
- Scope of work is limited to seismic upgrade and subject to confirmation with DSA.



#### Project Status

- Project scope development
- A/E Selection

#### Project Team:

- *Architect:* TBD
- *Contractor:* TBD

#### Budget:

- Estimated Total Project Budget: TBD



## II. Project Development Update

### New High School #3 (JFA Site)

#### Project Summary

- Existing 58,352 S.F. facility in the Jordan Planning Area
- Built in 2001
- 8.5 Acre Site
- Facility Master Plan recommendation to move students to Jordan High School
- Convert Jordan Freshman Academy (JFA) to a small High School
- Educational programs being considered include: computer science, technology engineering, and mathematics

#### Project Status

- Facility Assessment: Underway
- Evaluating scope options and target school opening date
- A/E Selection: Underway



#### Project Team:

- *Architect:* TBD

#### Budget:

- Estimated Total Project Budget: \$5.0M
- Estimated Construction Budget: \$3.75M
- Dollars Expended as of (10/31/11): \$0



This Presentation along with  
Citizens' Oversight Committee  
information is available at:

[www.lbschools.net](http://www.lbschools.net)