

Transportation Bldg

GENERAL NOTES

- 1. All equipment shall be installed in accordance with the manufacturer's instructions.
- 2. All equipment shall be installed in accordance with the manufacturer's instructions.
- 3. All equipment shall be installed in accordance with the manufacturer's instructions.

EQUIPMENT KEYNOTES

KEYNOTE	DESCRIPTION
1	...
2	...
3	...
4	...
5	...
6	...
7	...
8	...
9	...
10	...
11	...
12	...
13	...
14	...
15	...
16	...
17	...
18	...
19	...
20	...
21	...
22	...
23	...
24	...
25	...
26	...
27	...
28	...
29	...
30	...
31	...
32	...
33	...
34	...
35	...
36	...
37	...
38	...
39	...
40	...
41	...
42	...
43	...
44	...
45	...
46	...
47	...
48	...
49	...
50	...

ALSC



TRANSPORTATION BUILDING

MEAD SCHOOL DISTRICT

PERMIT SET

NO.	DATE	DESCRIPTION
1
2
3
4
5
6
7
8
9
10
11
12
13
14
15
16
17
18
19
20
21
22
23
24
25
26
27
28
29
30
31
32
33
34
35
36
37
38
39
40
41
42
43
44
45
46
47
48
49
50

OVERALL FURNITURE & EQUIPMENT PLAN

A810.1

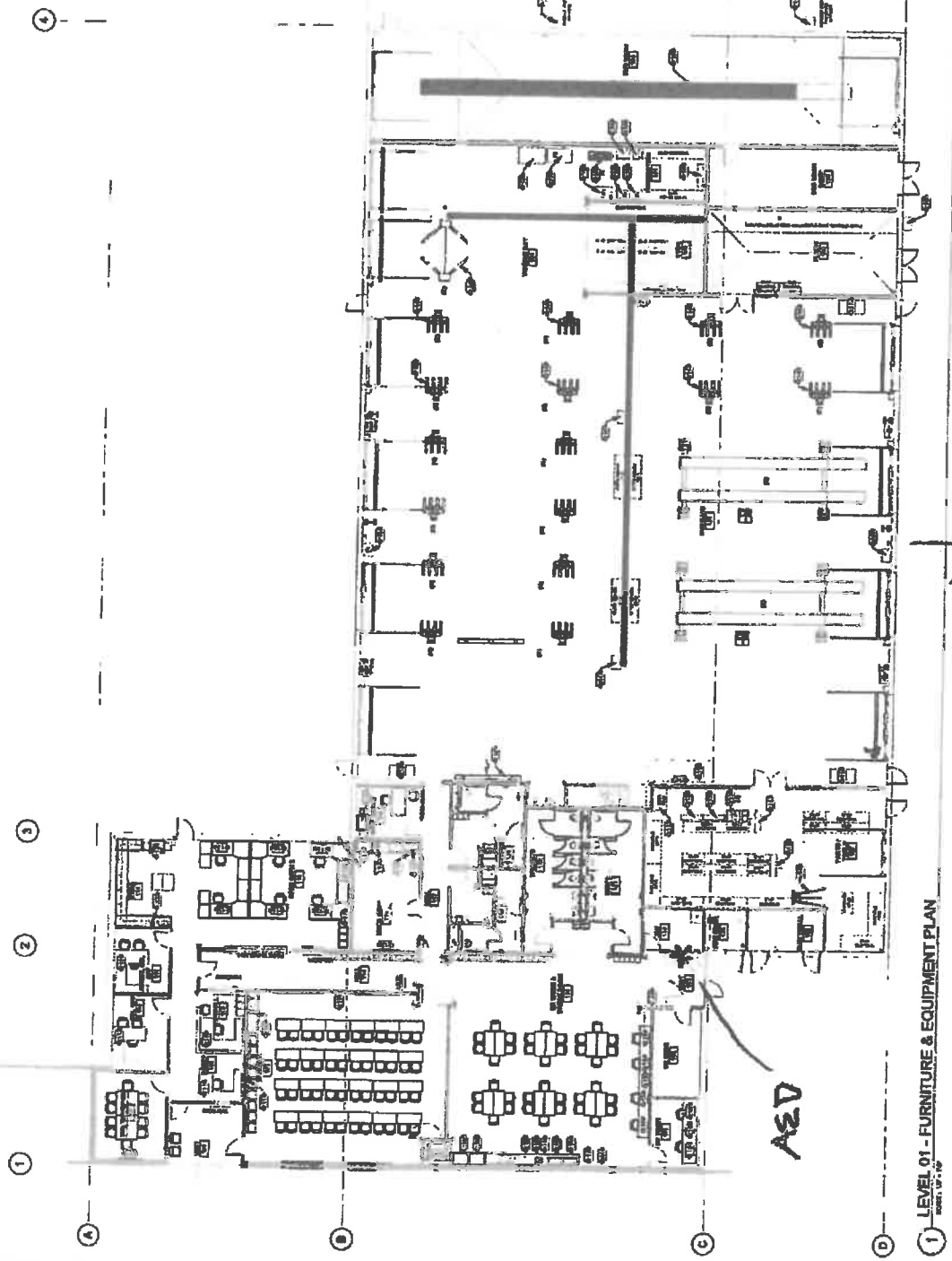

Bus Parking

LEVEL 01 - FURNITURE & EQUIPMENT PLAN