



**ROCKFORD BOARD OF EDUCATION
INVITATION FOR BID ON SUPPLIES, MATERIALS, EQUIPMENT OR SERVICES
FOR SCHOOL DISTRICT NO. 205
ROCKFORD, ILLINOIS**

IFB No. **IFB No. 22-49 Administration Building Lower-Level Renovations**

DATE: **May 5, 2022**

RE: **ADDENDUM NO. 2**

To All Bidders:

Included are modifications, clarifications and/or corrections for the Project Manual and are hereby made a part of the contract documents. Please attach this addendum to the Project Manual(s) in your possession. Please note the receipt of this addendum on the bid form. Bidders shall review changes to all portions of this work as changes to one portion may affect the work of another.

If you plan to hand deliver your IFB submission on the due date, please note you must check in on the 1st floor prior to coming to the bid opening. Please allow time for this as late submission will not be accepted.

Refer all questions relative to the business aspect, Instructions to Bidders, Special Conditions, and questions concerning the technical aspect of the documents to the Director of Purchasing by email at purchasingdeptstaff@rps205.com.

ROCKFORD BOARD OF EDUCATION

By: Dane Youngblood
Director of Purchasing

ADMINISTRATION BUILDING BASEMENT RENOVATION
ROCKFORD PUBLIC SCHOOLS 205
ROCKFORD, ILLINOIS

LARSON & DARBY GROUP

4949 Harrison Avenue, Suite 100
815/484-0739

ARCHITECTURE-ENGINEERING-INTERIORS

Rockford, IL 61108
FAX 815.229.9867

TO: ALL BIDDERS

RE: ADDENDUM #2

Changes to Bidding Documents Dated April 13, 2022

PROJECT: ADMINISTRATION BUILDING BASEMENT RENOVATION
ROCKFORD PUBLIC SCHOOLS 205
ROCKFORD, ILLINOIS

PROJECT NO.: RPS IFB 22-49, RPS PROJECT NO. 2112
LDG PROJECT 30186

DATE: May 5, 2022

Please attach this Addendum to the Project Manual and Drawings for the referenced project. Take the changes to the Project Manual and Drawings into consideration in preparing your Bid.

Bidders shall make note in writing on Bid Form that this Addendum has been taken into consideration. Failure to do so may be sufficient cause to reject the Bid.

LARSON & DARBY GROUP

By _____

Ged Trias, AIA

This Addendum consists of 2 pages, plus materials itemized herein.

I. CLARIFICATIONS

A. Access Control Work: Work of this contract includes furnishing and installing access control devices such as card readers and electric strikes, and connecting to Owner's existing access control system.

II. RESPONSES TO BIDDER QUESTIONS

- A. Question: Drawing E1.1 shows new floor boxes. Can you provide the details of the floors construction, is there a raised floor that we will have access to run our conduits thru, is it concrete slab that will need to be cut and patched, if so who will be cutting/patching concrete floors? L&D Response: Existing floor is a concrete slab on grade. Cutting and patching shall be included in the Contract. Contractor to determine which trade performs cutting and patching.
- B. Question: Drawing 2.1 Opening Schedule shows door 027B in Conference room with electric strike, Request to exit and card reader, but no work is shown on the electrical drawings. Do you want us to include the electrical/LV in our proposal? L&D Response: Yes.
- C. Question: Can you please confirm the location to the first floor existing panel 'EM1-S1' for the emergency lighting circuits? This panel is called out on drawing E2.1 at the

ADMINISTRATION BUILDING BASEMENT RENOVATION
ROCKFORD PUBLIC SCHOOLS 205
ROCKFORD, ILLINOIS

bottom of the Device Symbols Legend, but I do not see if shown on the drawings. L&D Response: See revised Drawing E2.1, issued herewith.

III. ADDITIONS OR CHANGES TO THE DRAWINGS:

- A. Drawing A1.1 Revised Basement Floor Plan: Refer to undesignated existing door on west wall of Alcove 033 into Mechanical Room: Add Card Reader and Electric Strike to this opening.
- B. Drawing A2.1, Opening Schedule: Add Card Reader and Electric Strike to opening 027A.

REISSUED DRAWINGS: The following revised Drawings, which replace previous issues of the Drawings, are issued herewith:

E1.1, and E2.1.

END OF ADDENDUM #2



- DRAWING NOTES:**
- PROVIDE OUTLETS FOR WALL MOUNTED DISPLAY OR INTERACTIVE WHITE BOARD, VERIFY MOUNTING HEIGHT WITH ARCHITECT AND DISTRICT. REFER TO DETAIL ON DRAWING E3.0.
 - PROVIDE OUTLETS FOR PRESENTATION STATION TO CONTROL DISPLAY OR INTERACTIVE WHITE BOARD, VERIFY MOUNTING HEIGHT WITH ARCHITECT AND DISTRICT. REFER TO DETAIL ON DRAWING E3.0.
 - PROVIDE FLUSH FLOOR BOX WITH RECESSED OUTLETS. PROVIDE TWO (2) DUPLEX RECEPTACLES AND TWO (2) DATA JACKS. WIREMOLD RESOURCE RFB SERIES. PROVIDE WITH COVER TYPE TO MATCH FLOORING. COLOR SELECTION BY ARCHITECT. CONTRACTOR SHALL SAW CUT AND PATCH FLOOR AS REQUIRED. PROVIDE TWO (2) 1" CONDUITS FOR POWER AND DATA.
 - AFTER DEMOLITION CONTRACTOR SHALL TURN OFF ALL ABANDONED CIRCUIT BREAKERS FOR REUSE. UPON PROJECT COMPLETION UPDATE PANELBOARD DIRECTORIES.
 - CONTRACTOR TO PROVIDE RACEWAY PROVISIONS FOR CARD ACCESS SYSTEM (CARD READERS, ELECTRIC STRIKE, AND DOOR POSITION SWITCH) AND INSTALL AND COORDINATE WITH THEIR SECURITY CONTRACTOR.

GENERAL NOTES:

THE MINIMUM WIRE SIZE SHALL BE #12 AWG. PROVIDE DEDICATED NEUTRALS; NO COMMON NEUTRALS ARE PERMITTED.

THE MINIMUM CONDUIT SIZE FOR HOMERUNS AND BRANCH FEEDS SHALL BE 3/4" 1/2" CONDUIT SHALL BE ACCEPTABLE FOR BRANCH WIRING FOR SINGLE CIRCUITS ONLY. ALL BRANCH CIRCUITS SHALL TERMINATE AT 20A-1P CIRCUIT BREAKERS IN PANELBOARD INDICATED UNLESS SPECIFICALLY INDICATED OTHERWISE.

THE CONTRACTOR SHALL UPSIZE CONDUCTORS AND CONDUITS (OVER 75'-0" IN LENGTH) TO COMPENSATE FOR VOLTAGE DROP.

THE CONTRACTOR SHALL PROVIDE ALL PENETRATIONS, SLEEVES AND SEALANT AS REQUIRED THRU PARTITIONS TO ACCOMMODATE ANY CONDUITS / RACEWAYS, CABLING, ETC. ALL PENETRATIONS THRU RATED WALL ASSEMBLY(IES) MUST MEET THE UL RATING OF THE WALL SYSTEM(S).

REFER TO ARCHITECTURAL PLANS FOR ADDITIONAL INFORMATION REGARDING MOUNTING HEIGHTS AND EXACT LOCATIONS OF ALL ELECTRICAL DEVICES BEFORE ROUGH-IN.

THE CONTRACTOR SHALL VERIFY EXACT EQUIPMENT LOCATIONS, LOAD INFORMATION, VOLTAGE, AMPERAGE, CONNECTION TYPE, ETC. WITH EQUIPMENT BEING SUPPLIED PRIOR TO ROUGH-IN.

ALL CIRCUITING NUMBERS ARE CONNECTED TO PANEL "LP" UNLESS SPECIFICALLY INDICATED OTHERWISE.

DEVICE SYMBOLS LEGEND:

SYMBOL	DESCRIPTION
X	EXISTING ELECTRICAL EQUIPMENT OR DEVICE TO REMAIN.
XRR	EXISTING ELECTRICAL EQUIPMENT OR OUTLET TO BE REMOVED, RELOCATED AND JUNCTION BOX REMOVED AND WALL PATCHED.
XR	EXISTING ELECTRICAL EQUIPMENT OR OUTLET RELOCATED (NEW LOCATION).
XO	NEW ELECTRICAL EQUIPMENT INSTALLED OVER EXISTING OUTLET.

HOMERUN ALL POWER BRANCH CIRCUITS TO EXISTING PANEL "RP-B-N" UNLESS INDICATED OTHERWISE. CIRCUIT NUMBERS INDICATED ARE FOR REFERENCE PURPOSES ONLY IN ORDER TO INDICATE GROUPING.

HOMERUN ALL DATA CABLING TO EXISTING IDF IN ROOM 029. FIELD VERIFY EXACT LOCATION PRIOR TO ROUGH-IN.

HOMERUN ALL FIRE ALARM CABLING TO EXISTING NOTIFIER, ONLY FIRE ALARM CONTROL PANEL LOCATED ON FIRST FLOOR AT WEST VESTIBULE. CURRENTLY SERVICED BY CINTAS.

CONTRACTOR SHALL INSTALL ALL BACKBOXES FOR RECEPTACLES, SWITCHES, VOICE, AND DATA OUTLETS FLUSH IN WALLS AND CEILINGS. PROVIDE ALL CUTTING, PATCHING, AND FISH WALLS AS REQUIRED. NOTIFY ARCHITECT OF ISSUES PRIOR TO SURFACE MOUNTING ANY BOXES. WHEN ALLOWED, CONTRACTOR SHALL PROVIDE APPROVED SURFACE RACEWAY SYSTEMS (WIREMOLD OR HUBBELL).

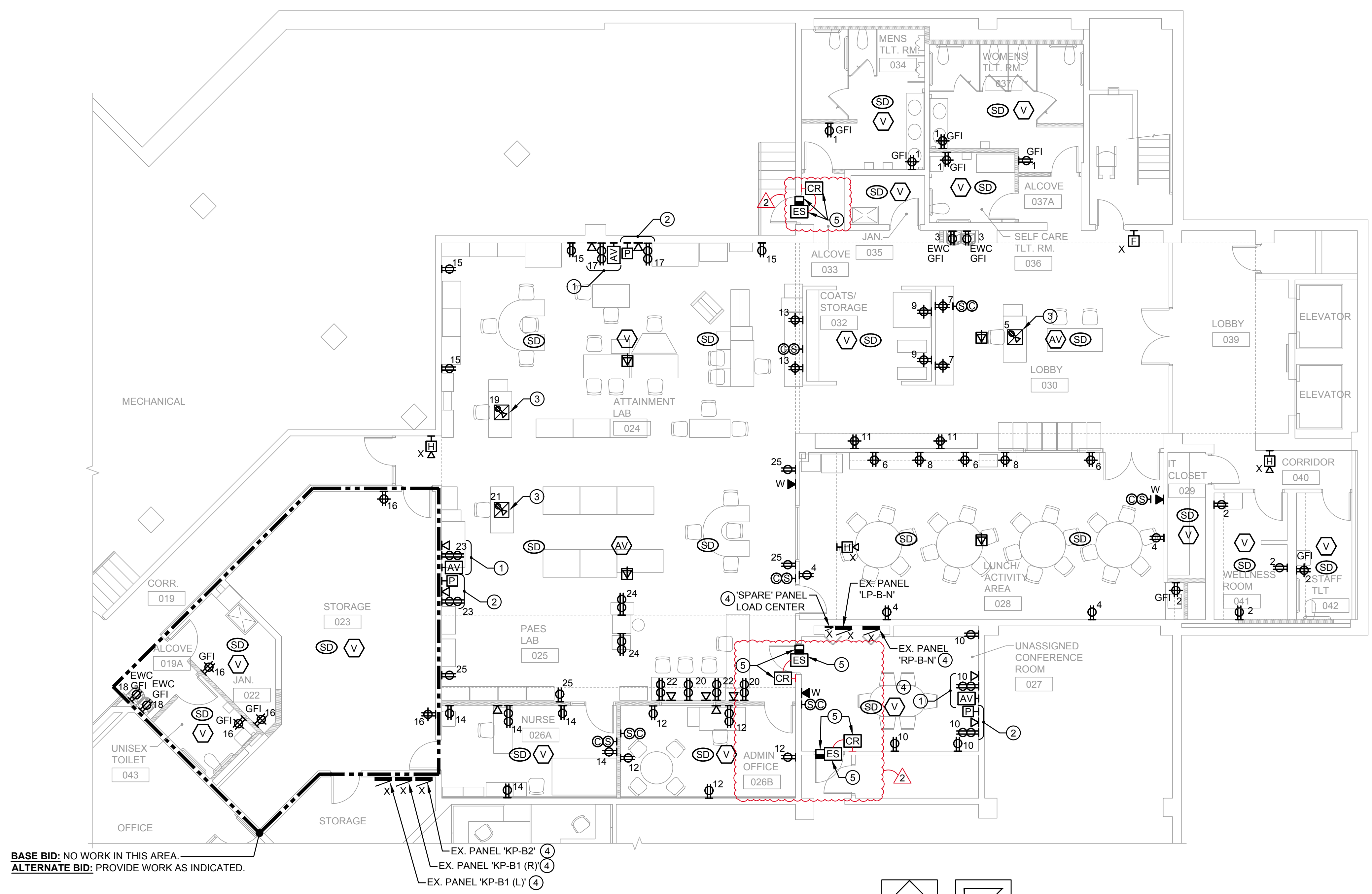

BASE BID: NO WORK IN THIS AREA
 ALTERNATE BID: PROVIDE WORK AS INDICATED.

BASEMENT - POWER PLAN
 SCALE: 1/8" = 1'-0"

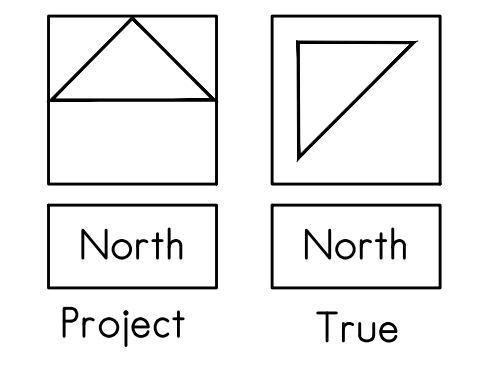

AN ADMIN. BASEMENT RENOVATION FOR:
RPS DISTRICT 205 IFB 22-49 P2112
 501 7TH ST. ROCKFORD, ILLINOIS 61104

COPYRIGHT 2022
 All drawn and written information appearing herein shall not be duplicated, disclosed, or otherwise used without the written consent of Larson & Darby Group

ISSUED FOR:	DATE:
RFI RESPONSES	05-05-22
DRWN: RMS	CHK'D: SJS
	APPRVD: SJS

DATE: 04-13-2022
PROJECT NUMBER: 30186
SHEET NUMBER: E1.1



- DRAWING NOTES:**
- "NL" DENOTES NIGHTLIGHT ON 24/7 AND CONNECTED TO EXISTING EMERGENCY POWER PANEL WITH GENERATOR BACK-UP.
 - PROVIDE NIGHT CONTROLS WITH DIMMING AND SCENE CONTROLLER. LIGHTING TO OPERATE 'ON' UPON OCCUPANCY SINCE THESE LIGHTS ARE LOCATED IN THE PATH OF EGRESS.
 - ALL TYPE "AN" LIGHTING FIXTURES ARE NIGHT ENABLED. CONTRACTOR SHALL INTERCONNECT FIXTURES WITH PLENUM RATED CATEGORY 5 CABLE.

- GENERAL NOTES:**
- THE MINIMUM WIRE SIZE SHALL BE #12 AWG. PROVIDE DEDICATED NEUTRALS; NO COMMON NEUTRALS ARE PERMITTED.
- THE MINIMUM CONDUIT SIZE FOR HOMERUNS AND BRANCH FEEDS SHALL BE 3/4" 1/2" CONDUIT SHALL BE ACCEPTABLE FOR BRANCH WIRING FOR SINGLE CIRCUITS ONLY. ALL BRANCH CIRCUITS CIRCUITS SHALL TERMINATE AT 20A-1P CIRCUIT BREAKERS IN PANELBOARD INDICATED UNLESS SPECIFICALLY INDICATED OTHERWISE.
- THE CONTRACTOR SHALL UPSIZE CONDUCTORS AND CONDUITS (OVER 75'-0" IN LENGTH) TO COMPENSATE FOR VOLTAGE DROP.
- THE CONTRACTOR SHALL PROVIDE ALL PENETRATIONS, SLEEVES AND SEALANT AS REQUIRED THRU PARTITIONS TO ACCOMMODATE ANY CONDUITS / RACEWAYS, CABLING, ETC. ALL PENETRATIONS THRU RATED WALL ASSEMBLY(IES) MUST MEET THE UL RATING OF THE WALL SYSTEM(S).
- REFER TO ARCHITECTURAL PLANS FOR ADDITIONAL INFORMATION REGARDING MOUNTING HEIGHTS AND EXACT LOCATIONS OF ALL ELECTRICAL DEVICES BEFORE ROUGH-IN.
- THE CONTRACTOR SHALL VERIFY EXACT EQUIPMENT LOCATIONS, LOAD INFORMATION, VOLTAGE, AMPERAGE, CONNECTION TYPE, ETC. WITH EQUIPMENT BEING SUPPLIED PRIOR TO ROUGH-IN.
- ALL CIRCUITING NUMBERS ARE CONNECTED TO PANEL "LP-BN" UNLESS SPECIFICALLY INDICATED OTHERWISE.

- DEVICE SYMBOLS LEGEND:**
- | SYMBOL | DESCRIPTION |
|--------|---|
| X | EXISTING ELECTRICAL EQUIPMENT OR DEVICE TO REMAIN. |
| XRR | EXISTING ELECTRICAL EQUIPMENT OR OUTLET TO BE REMOVED, RELOCATED AND JUNCTION BOX REMOVED AND WALL PATCHED. |
| XR | EXISTING ELECTRICAL EQUIPMENT OR OUTLET RELOCATED (NEW LOCATION). |
| XO | NEW ELECTRICAL EQUIPMENT INSTALLED OVER EXISTING OUTLET. |

ALL UNMARKED LIGHTING FIXTURES ARE TYPE "AN" UNLESS INDICATED OTHERWISE - TYPICAL.

HOMERUN ALL NORMAL LIGHTING BRANCH CIRCUITS TO EXISTING PANEL "LP-BN" AND EMERGENCY LIGHTING CIRCUITS TO EXISTING PANEL "EM1-S1" (ON FIRST FLOOR). CIRCUIT NUMBERS INDICATED ARE FOR REFERENCE PURPOSES ONLY IN ORDER TO INDICATE GROUPING.



CONNECT TO EXISTING CORRIDOR LIGHTING CIRCUIT

BASE BID: NO WORK IN THIS AREA
 ALTERNATE BID: PROVIDE WORK AS INDICATED.

APPROXIMATELY LOCATION OF PANEL "EM1-S-1" ON FIRST FLOOR

TELEPHONE EQUIPMENT ROOM

BASEMENT - LIGHTING PLAN

SCALE: 1/8" = 1'-0"

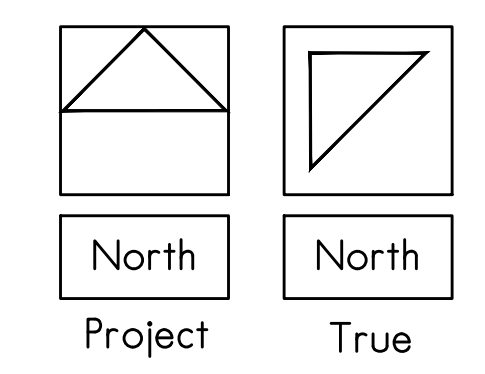

LIGHTING CONTROLS SCHEDULE:

AREA SERVED	VACANCY SENSOR	OCCUPANCY SENSOR	TIME-CLOCK	DIMMING	DAYLIGHTING	SCENES	REMARKS
OFFICES AND CONFERENCE ROOMS	✓			✓			
TOILETS, JANITOR, AND STORAGE ROOMS		✓					
LOBBY, ATTAINMENT LAB AND PAES LAB		✓		✓		✓	PROVIDE WITH TWO SCENES PER AREA AND PROGRAMMED PER OWNER REQUIREMENTS.

AN ADMIN. BASEMENT RENOVATION FOR:

RPS DISTRICT 205 IFB 22-49 P2112
 501 7TH ST. ROCKFORD, ILLINOIS 61104

COPYRIGHT 2022
 All drawn and written information appearing herein shall not be duplicated, disclosed, or otherwise used without the written consent of Larson & Darby Group

ISSUED FOR:	DATE
RFI RESPONSES	05-04-22
RFI RESPONSES	05-05-22
DRWN:	CHK'D:
RMS	SJS
APPRVD:	SJS

DATE: 04-13-2022
PROJECT NUMBER: 30186
SHEET NUMBER: E2.1