

**POCATELLO/CHUBBUCK
SCHOOL DISTRICT NO. 25
Bannock County, Idaho**

**Administration Offices
3115 Pole Line Road
Pocatello, Idaho 83201**

Addendum No. 1

February 15, 2018

RE: Invitation to Bid, Carpet and Cove Base for Various District Buildings
School District No. 25
Pocatello, Idaho 83201

FROM: Renae Bentley
Business Services
3115 Poleline Road
Pocatello, Idaho 83201
(208) 235-3220
bentlere@sd25.us

This Addendum becomes a part of the Contract Documents and modifies the original Bidding Specifications, as noted below.

Change: Project 1 - Ellis Elementary: Add to the scope of work the additional square footage, Room #46 not shown on the original drawing. The cost of the additional square footage of materials is to be included in the bid response. ± 20,388 sf

Vendor is responsible for obtaining the correct measurement sizes for all materials. The measurements on the building drawings and bid sheet are approximate sizes only.

Signature and return of this form acknowledges receipt of Addendum No. 1.

Failure to return the signed Addendum No. 1 may subject the bidder to disqualification.

Signed: _____ Date: _____

Name & Title: _____

Company: _____

NO OTHER CHANGES
END OF ADDENDUM No.1 – February 15, 2018, rlb

ELLIS ELEMENTARY SCHOOL
 CARPET REPLACEMENT FY 2018
 (Approximately) 21,271 SQ FT

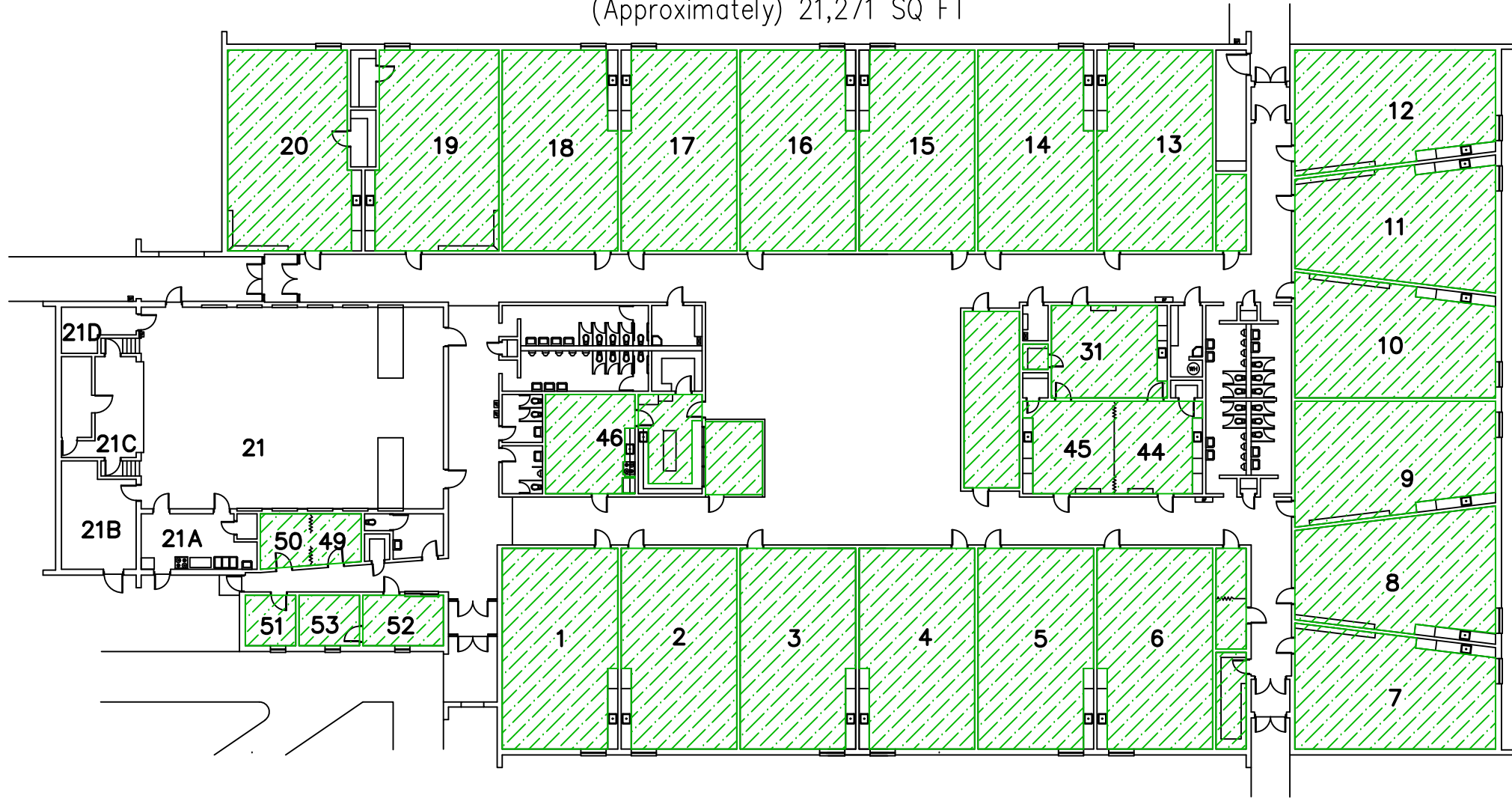

MAIN FLOOR PLAN

SCALE: 1/16" = 1'-0"

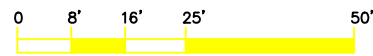

MAIN FLOOR
 GROSS SQUARE FEET: 36,221

LEGEND

ROOM NAME
 DISTRICT ROOM NUMBER
 SCHOOL ROOM NUMBER
 ROOM/ AREA SQUARE FOOTAGE

