

**POCATELLO/CHUBBUCK
SCHOOL DISTRICT NO. 25
Bannock County, Idaho**

SPECIFICATIONS

FOR

**ASPHALT REMOVAL AND REPLACEMENT/ ASPHALT OVERLAY AND ASPHALT SEAL
COATING AT VARIOUS SCHOOLS**

**PROJECT No. 1 Highland High School Asphalt Patching II, 1800 Bench Rd.
PROJECT No. 2 Highland High School Seal Coating, 1800 Bench Rd.
PROJECT No. 3 Alameda Middle School Asphalt Patching II, 845 McKinley
PROJECT No. 4 Jefferson Elementary School Asphalt Patching I, 1455 Gwen Dr.
PROJECT No. 5 Jefferson Elementary School Seal Coating, 1455 Gwen Dr.**

BID OPENING

**April 28, 2016
11:30 A.M.**

**POCATELLO/CHUBBUCK
SCHOOL DISTRICT NO. 25
Bannock County, Idaho**

INVITATION TO BID

**ASPHALT REMOVAL AND REPLACEMENT/ ASPHALT OVERLAY AND ASPHALT SEAL
COATING AT VARIOUS SCHOOLS**

Sealed bids will be received by a representative of the Board of Trustees of School District No. 25, Bannock County, Idaho at 3115 Poleline Road, Pocatello, Idaho, 83201, until 11:30 a.m., April 28, 2016, for Asphalt Removal and Replacement/ Asphalt Overlay and Asphalt seal Coating at Various Schools.

Specifications or additional details, (including bid forms), may be secured at 3115 Poleline Road, Pocatello, Idaho, 83201. A pre-bid conference will be held at 2:00 p.m. on Wednesday, April 20, 2016, at the Maintenance Department, 185 Maple St Pocatello, Idaho 83201. All bids must be on the forms furnished, all blank spaces filled in, and signed with the name and address of the Bidder. No unqualified bids will be read.

Each bid shall be accompanied by a certified check, cashier's check, or a bidder's bond, (executed by a qualified surety company with the power to do business in the State of Idaho), in the sum of not less than five percent (5%) of the total bid, made payable to School District No. 25, Pocatello, Bannock County, Idaho. This surety shall be forfeited by the bidder in the event of failure to enter into a contract. Compliance with Idaho Public Works Law is required. Personal or Company checks will not be accepted.

The Board of Trustees reserves the right to reject any/or all bids, or to waive any informalities, or to accept the bid or bids deemed best for School District No. 25, Pocatello, Bannock County, Idaho.

Paul Vitale, Clerk
SCHOOL DISTRICT NO. 25

To be published on the dates of:

April 14, 2016
April 21, 2016

IDAHO STATE JOURNAL

INSTRUCTIONS TO BIDDERS

BIDS:

Sealed "BIDS" will be received on or before the time and date set forth under "INVITATION TO BID".

The owner reserves the right to accept or reject any part or all bids.

Bidders submitting a "Bid" on this work will be required to figure and furnish everything as called for by these specifications and the requirements of the "Bid" sheet.

All bids shall be in a sealed envelope addressed to the Board of Trustees of School District No. 25, 3115 Pole Line Road, Pocatello, Idaho. The following shall be written on the exterior of the envelope:

"BIDS FOR ASPHALT REMOVAL AND REPLACEMENT/ ASPHALT OVERLAY AND ASPHALT
SEAL COATING AT VARIOUS SCHOOLS TO BE OPENED ON
APRIL 28, 2016 AT 11:30 A.M."

BIDS NOT DELIVERED BY CONTRACTORS AT TIME OF BID OPENING MUST BE RECEIVED IN MAIL NO LATER THAN 4:00 PM ON APRIL 27, 2016 THE DAY BEFORE THE BID OPENING.

EXAMINATION OF THE SITE AND DOCUMENTS:

A pre-bid conference will be held at 2:00 p.m. on Wednesday, April 20, 2016 at the Maintenance Department, 185 Maple St. Pocatello, Id. 83201.

Refer all questions to Mr. Randy Gwynn, School Plant Coordinator at (208) 233-2604. Contact with other district staff, Board of Trustees, or Administration, will be by written permission only.

Before submitting a proposal the bidder shall:

- A. Carefully examine the specifications.
- B. Visit the worksite.
- C. Be fully informed of existing conditions and limitations.
- D. Include in his bid, sums sufficient to cover all items required by the contract, and shall rely entirely upon his own examinations in making his proposal.

INTERPRETATIONS:

Should a bidder find discrepancies in or omissions from the specifications, or be in doubt as to their meaning, he should at once notify the Owner, who will send written instructions or addenda to all bidders. The owner will not be responsible for oral interpretations. Questions received less than 48 hours before time for bid opening cannot be answered. All addenda issued during the time of bidding will be incorporated in the contract.

EVIDENCE OF QUALIFICATIONS:

Upon request of the owner, a bidder whose bid is under consideration for award of the contract shall submit, promptly, satisfactory evidence of his financial resources, his experiences, and the organization and equipment he has available for performance of the contract.

HOLD HARMLESS AGREEMENTS:

The District expects your work to conform to professional standards. The contractor is expected to hold the District harmless for all damages or claims arising out of the work performed by the contractor. The District will not agree to hold the contractor harmless for damages or claims.

LAWS AND ORDINANCES:

The contractor hereby binds himself to protect and save harmless the owner from all damages arising from the violation of any and all Federal, State, County, City, and all other laws, rules, regulations, in the performance of the terms of the contract.

CONTRACTOR'S LICENSE:

In compliance with Idaho Laws, the contractor must be registered with the State of Idaho, and hold the required Public Works Contractor's License before obtaining the contract documents and before submitting a bid for this work.

INSURANCE:

All contractors who provide goods or services to the District are required to provide the District with certificates of insurance for General Liability, Auto Liability, Workers Compensation, and Professional Liability if applicable.

The General Liability and/or Professional Liability certificate must name the District as an additional insured under the contractor's policy.

Certificates are to be provided to the District prior to any work commencing on District property. This would include the placement of any equipment or materials at the work site

Minimum Insurance Limits

General Liability	\$1,000,000 per occurrence
	\$1,000,000 products and completed operations
	\$1,000,000 annual aggregate

Auto Liability	\$1,000,000 per occurrence
----------------	----------------------------

Worker' Compensation Statutory

OBJECTIONS:

Written objections to specifications or bid procedures must be received by the clerk, secretary, or other authorized official of the District at least one (1) business day before the date and time upon which bids are scheduled to be received, per Idaho Code Section 68-2806(c).

PERFORMANCE BOND:

The successful bidder will be required to furnish a 100% performance bond when entering into the contract work, per Idaho Code Section 54-1926, "...conditioned upon the faithful performance of the contract in accordance with the plans, specifications and conditions thereof."

PAYMENT BOND:

The successful bidder will be required to furnish a 100% payment bond when entering into the contract work, per Idaho Code Section 54-1926, "solely for the protection of persons supplying labor or materials, or renting, leasing, or otherwise supplying equipment to the contractor or his subcontractors in the prosecution of the work provided for in such contract."

5% RETAINAGE:

The Owner will retain 5% of the Contractor's earned sum to ensure faithful performance. This 5% will be released to the Contractor upon receipt of approval from State of Idaho.

BID GUARANTEE:

As a guarantee that, if awarded the contract, the bidder will execute same and furnish bond. Each bid will be accompanied by a Certified check, Cashier's Check, or Bid Bond for not less than five percent (5%) of the base bid payable to the Owner. NO PERSONAL OR COMPANY CHECKS WILL BE ACCEPTED.

OWNER/CONTRACTOR AGREEMENT:

The Agreement for the work will be written on a District provided Form of Agreement between Owner and Contractor where the basis of payment is a stipulated sum.

CHANGES IN THE WORK:

The owner, without invalidating the contract, may order extra work or make changes by altering, adding to or deducting from the work, the contract sum being adjusted accordingly. All such work shall be executed under the conditions of the original contract, except that any claim for extension of the time caused thereby shall be adjusted at the time of ordering such change.

The total allowance for combined overhead and profit for changes shall be included in the total cost to the owner and shall be based on the following schedule: A. For the Contractor, 10% over cost.; B. For the Sub-Contractor, 15% over cost to be divided 10% for Sub-Contractor and 5% for Contractor; and C. For any Sub-Subcontractor, 15% over cost to be divided 5% for Contractor, 5% for Sub-Contractor, and 5% for Sub-Subcontractor.

EMPLOYMENT OF RESIDENTS OF IDAHO:

In compliance with Idaho Laws, Section 44-1001 and 44-1002 Idaho Code, the contractor must employ ninety-five percent 95% bona fide Idaho residents as employees on any such contracts except where under such contracts fifty (50) or less persons are employed the contractor may employ ten percent (10%) nonresidents, provided however, in all cases such employers must give preference to the employment of bona fide Idaho residents in the performance of such work.

EQUIPMENT:

The contractor shall provide all labor, materials, tools, and equipment, etc. necessary for the complete and substantial execution of everything described in the specifications.

STORAGE OF MATERIALS:

The contractor shall make arrangements and coordinate with the Maintenance Department, for storage of materials. Any damages of life or property caused by storage of materials on the above indicated place shall be paid for by the contractor, who shall hold the owner harmless for any damages concerning the same.

SUPERVISION:

The supervision of this work will be done by the Maintenance Department.

INSPECTION OF WORK:

The representative of the owner shall at all times have access to the work wherever it is in preparation or progress and the contractor shall provide facilities for such access and for inspection.

FORM WH5:

Per Idaho Code Section 54-1904A, within thirty (30) days of award of bid, the contractor shall file with the State Tax Commission a form WH-5, Public Works Contract Report.

WARRANTY:

Manufacturer shall warrant products, projects under normal use to be free from defects in materials and workmanship for a period of one year from date of installation and completion of project.

Warranty shall cover repair or replacement of areas determined defective upon inspection.

CLEAN UP:

The contractor shall at all times keep the premises free from accumulations of waste material or rubbish caused by his employees or work, and at the completion of the work he shall remove all his rubbish from and about the building and all tools and surplus materials and shall leave his work clean. In case of dispute, the owner shall remove the rubbish and surplus materials and charge the cost to the contractor.

DELIVERY AND START OF WORK:

The time frame for this project to be completed is between June 6, 2016 and August 1, 2016.

LIQUIDATED DAMAGES:

Contractor shall be required to pay Owner as liquidated damages the sum of \$200 for each day, after the scheduled completion date, that the project is unfinished.

PAYMENT:

Application of payments dated on or prior to the 25th of the month, payment shall be made by the 15th of the following month. Applications for payments dated after the 25th of the month, shall be made within 30 days.

BID:

The following universal specifications are being used as a guideline. Alternate bids for equal equipment will be considered. Substitutions or major alternations must be indicated upon the proposal sheet at the time of the bid submission.

Bids must be based upon conditions at the site and these specifications. Bids shall be submitted in accordance with the requirements shown on the bid form.

BID EVALUATION CRITERIA:

Contractor selection on this project will be evaluated based on the following:

- 1) Price;
- 2) Contractor reputation for quality of work with current customers or past performance with District 25. (Please list all asphalt jobs/contracts greater than \$10,000 performed in the past two years if contractor has not performed one for the District in past 5 years);
- 3) Vendor ability to best match the listed criteria as specified.

GENERAL SPECIFICATIONS

ASPHALT PATCHING

SCOPE OF WORK - The contractor shall furnish and install all materials, labor, equipment, and other necessary items for the installation of the asphalt paving as specified herein.

The asphalt paving shall be installed in the areas in strict accordance with specifications A-2 of the Asphalt Institute to a thickness of two or more inches as specified and all materials and methods of preparation shall conform to the requirements of these specifications.

Preparation of Existing Asphalt Paving Grounds - The entire existing asphalt paving grounds shall receive pavement as called for within these specifications. The patch areas shall be cut out in a straight line. All pot holes and low spots shall be prepared and brought to level with asphalt patch, SS-1H tack coat. Low areas next to buildings are to be raised to provide proper drainage away from buildings. Areas adjacent to walls, lawns, and curbs shall be tapered down to the finish grade so that the two inch asphalt concrete mat does not extend above the adjacent concrete or lawn. If unusual excavating conditions are encountered, stop work and notify owner.

The grounds that call for asphalt overlay shall be covered with an asphalt mat to a thickness of two or more inches. This mat shall be laid in strict accordance with these specifications and with specifications A-2 of the Asphalt Institute. The asphalt paving mixture shall be mixed in a batching plant which has the approval of the State of Idaho Highway Department.

The maximum size of aggregate to be used in the Asphalt concrete mixture shall be 5/8" or 1/2" fine material, and shall be well graded to the point where 0.8% will pass a No. 200 sieve. The aggregate with the asphalt cement shall be mixed in the batching plant and heated to a temperature of 300 degrees F. and shall be delivered to the job and placed at a temperature of not less than 225 degrees F.

The mixture shall be spread with a power screed, where possible, which shall spread the mix evenly over the compacted sub-base. The mat shall then be rolled with power roller weighing not less than ten tons. The thickness of the mat after rolling shall be one or two or more inches as specified and shall not vary in thickness more than 1/4" either way from the specified thickness. Any low spots shall be immediately remedied by cutting out the course at such spots and replacing it with fresh, hot mixture which shall be immediately compacted to conform to the surrounding area.

DESCRIPTION - This item shall consist of asphalt patching in those areas disturbed in the existing street by the contractor's construction activities, as well as for matching back purposes where radii are changed, or blending into new curb and gutter, alleyways, etc. Asphalt patching shall be in conformance with these specifications and the specific type of patching material used shall be approved by the School Plant Coordinator.

CONSTRUCTION METHODS AND MATERIALS

(a) **General Construction:** Asphalt patching shall be under the direction of the School Plant Coordinator.

(b) **Equipment:** The contractor may use any type of mixing, spreading, hauling, compacting, etc. equipment he may desire or has at his disposal provided the equipment is in satisfactory condition, is of the correct type for the job, and is of such capacity that the construction schedule can be maintained unless construction conditions or situations prevent or restrict usage of the equipment as to size, weight, or its ability to be detrimental to existing topography, structures, utilities, etc. while working.

(c) **Asphalt Patching I:** Asphalt patching shall consist of placement of 4" of 3/4" crushed aggregate and 3" of hot mix mat with all depths understood to be compacted depths. Prior to placing the patching profile the existing material shall be compacted. The contractor shall seek approval from the School Plant Coordinator of his patching material and method prior to actual placement.

(d) **Asphalt Patching II:** Asphalt patching shall consist of placement of geotextile fabric 2002, 12" of 2" minus sub-base aggregate, 3" of 3/4" crushed aggregate and 3" of hot mix mat with all depths understood to be compacted depths. Prior to placing the patching profile the existing material shall be compacted. The contractor shall seek approval from the School Plant Coordinator of his patching material and method prior to actual placement.

Contractor shall cut the existing asphalt in straight lines; remove the asphalt and base material to match the profile of the patching specification.

All areas to be patched shall be kneaded up exposing a good edge. The fabric shall be placed, and then granular material shall then be placed and compacted. Next, the existing oil mat edge shall be cleaned and tack-coated and the asphalt material laid in, compacted and blended into the existing old oil or curb and gutter edge, etc., making a presentable and durable patch.

Asphalt patching will not be done on poor sub-grade conditions and it shall be up to the determination of the School Plant Coordinator if such conditions are encountered of how and by what means the condition or situation can be rectified.

METHOD OF MEASUREMENT

Asphalt patching shall be measured by the square foot for each square foot of pavement placed and compacted in the areas shown on the plans or as directed by the School Plant Coordinator.

BASIS OF PAYMENT

The accepted quantity of this item will be paid for at the contract price per unit completed as called for on the proposal sheet, which price shall be full compensation for the furnishing of all materials, labor, equipment, tools, or any other work necessary to complete this item in conformance with the plans and these specifications or as directed by the School Plant Coordinator.

PROJECT No. 1 – Highland High School Asphalt Patching II, 1800 Bench Rd.

DESCRIPTION OF WORK: Approx. – One area 450sf of Asphalt Patching II (Area of construction to be determined at walk-thru and as indicated on attached plans)

Contractor shall use specification for Asphalt Patch II where required.
Contractor shall use specification for Asphalt Patch I where required.
Contractor shall sweep and clean asphalt roadways of all dirt and debris.
Contractor shall remove all excess materials from job site leaving job clean and presentable.

All area dimensions are approximate and not intended to be precise. In order to reduce or eliminate change orders, it will be necessary for the bidder to complete field verification of site and dimensions

PROJECT No. 2 – Highland High School Seal Coating, 1800 Bench Rd.

DESCRIPTION OF WORK: Approx. – 286,293sf

Contractor shall clean and sweep area of all dirt and debris to be seal coated.
Contractor shall rout cracks to 3/16 inch wide minimum. Rout larger cracks containing vegetation to minimum of one inch deep. Crack sealant applied minimum 3405 Federal Specifications. Product shall be Maxwell or equal.
Contractor shall furnish and install (2) coats asphalt slurry seal on entire area, as per manufacturer's recommendations. (Tuff-Coat or equal)
Contractor shall sweep and clean area of all dirt and debris.
Contractor shall remove all excess materials from job site leaving job clean and presentable.
Contractor shall re-paint the parking lines, numbered parking stalls and Handicapped Logo's. Acrylic Waterborn traffic paint, 4 inch yellow line (2) coat system.

All area dimensions are approximate and not intended to be precise. In order to reduce or eliminate change orders, it will be necessary for the bidder to complete field verification of site and dimensions

PROJECT No. 3 – Alameda Middle School Asphalt Patching II, 845 McKinley

DESCRIPTION OF WORK: Approx. – Asphalt Patching II (Area of construction are three options as indicated on attached plans)

- Area A – approx. 3,500sf**
- Area B – approx. 5,525sf**
- Area C – approx. 7,460sf**

Contractor shall use specification for Asphalt Patch II but no new subbase is to be figured for this work.
Contractor shall remove existing asphalt and install gravel as needed to allow for paving to be installed at original grades before overlays. Once existing asphalt is removed, Contractor will proof roll existing subbase and soft spots will be dealt with at that time.
Contractor shall sweep and clean asphalt roadways of all dirt and debris.
Contractor shall remove all excess materials from job site leaving job clean and presentable.

All area dimensions are approximate and not intended to be precise. In order to reduce or eliminate change orders, it will be necessary for the bidder to complete field verification of site and dimensions

PROJECT No. 4 – Jefferson Elementary School Asphalt Patching II, 1455 Gwen Dr.

DESCRIPTION OF WORK: Approx. – Three areas 949sf of Asphalt Patching II (Area of construction to be determined at walk-thru and as indicated on attached plans)

Contractor shall use specification for Asphalt Patch II.
Contractor shall sweep and clean asphalt roadways of all dirt and debris.
Contractor shall remove all excess materials from job site leaving job clean and presentable.

All area dimensions are approximate and not intended to be precise. In order to reduce or eliminate change orders, it will be necessary for the bidder to complete field verification of site and dimensions

PROJECT No. 5 – Jefferson Elementary Seal Coating, 1455 Gwen Dr.

DESCRIPTION OF WORK: Approx. – 76,356sf

Contractor shall clean and sweep area of all dirt and debris to be seal coated.
Contractor shall rout cracks to 3/16 inch wide minimum. Rout larger cracks containing vegetation to minimum of one inch deep. Crack sealant applied minimum 3405 Federal Specifications. Product shall be Maxwell or equal.
Contractor shall furnish and install (2) coats asphalt slurry seal on entire area, as per manufacturer's recommendations. (Tuff-Coat or equal)
Contractor shall sweep and clean area of all dirt and debris.
Contractor shall remove all excess materials from job site leaving job clean and presentable.
Contractor shall re-paint the parking lines, **numbered parking stalls** and Handicapped Logo's. Acrylic Waterborn traffic paint, 4 inch yellow line (2) coat system.

All area dimensions are approximate and not intended to be precise. In order to reduce or eliminate change orders, it will be necessary for the bidder to complete field verification of site and dimensions



BIDDER CERTIFICATION FORM

1. **Debarment and Suspension** – In submitting this bid proposal, we hereby certify that we have not been suspended or in any way excluded from Federal procurement actions by any Federal Agency. We fully understand that if information contrary to this certification subsequently becomes available, such evidence may be grounds for non-award or nullification of a bid contract.
2. **Anti-Collusion** – In submitting this bid proposal, we hereby certify this proposal was developed and prepared without any collusion with any competing bidder or District employee. The content of this proposal has not been disclosed to any competing or potentially competing bidder prior to the proposal due date and time. Furthermore, no action to persuade any person, partnership or corporation to submit or withhold a bid has been made.
3. **Anti-Lobbying** – In submitting this bid proposal, we hereby certify that to the best of our knowledge and belief, no appropriated Federal funds have been paid or will be paid by or on behalf of person associated with this proposal to any person for influencing or attempting to influence and officer or employee of any agency, a member of Congress, an office or employee of Congress or an employee of a member of Congress in connection with the awarding of any Federal contract, the making of any Federal grant, the making of any Federal loan, the entering into of any cooperative agreement and the extension, continuation, renewal, amendment or modification of any Federal contract, grant, loan or cooperative agreement.
4. **National Sexual Offender Registry** – In submitting this bid proposal, you certify to the District that your company will prohibit any persons in your employ who are registered or required to register under the Idaho Sex Offender Registration Act from participation in company business with the District if such participation would require them to be present on school property. You certify further that you have cross checked such employees against the National Sex Offender Registry found at the following web link: <http://www.nsopr.gov/>

Signed: _____

Name & Title: _____

Company: _____

Address: _____

City & State: _____

Date: _____

BID RESPONSE SHEET

Board of Trustees
School District No. 25
3115 Pole Line Road
Pocatello, ID 83201

Date: _____

We, _____ propose to furnish all labor, materials, tools, and equipment and complete all work called for by these specifications in connection with Asphalt Removal and Replacement/ Asphalt Overlay and Asphalt Seal Coating at Various Schools under the supervision of the School Plant Coordinator, for the sum of:

- PROJECT No. 1 Highland High School – Asphalt patch \$ _____**
- PROJECT No. 2 Highland High School – Seal Coating \$ _____**
- PROJECT No. 3 Alameda Middle School – Asphalt replacement**
 - Area A \$ _____**
 - Area B \$ _____**
 - Area C \$ _____**
- PROJECT No. 4 Jefferson Elementary School – Asphalt pat. \$ _____**
- PROJECT No. 5 Jefferson Elementary School – Seal Coat \$ _____**

Cost of Asphalt Patching I per sq. ft. _____

Cost of Asphalt Patching II per sq. ft. _____

Work can begin June 6, 2016 and must be completed by August 1, 2016.

Owner reserves the right to do all the projects or only the projects that fit within our budget. Bids will be awarded to the lowest responsible bid for each Project.

Workers Compensation & Employee Liability Insurance: Expiration Date: _____

CONTRACTOR'S ADDRESS & LICENSE NUMBER:

_____ Name	_____
_____ Address	Public Works Contractor License Number
_____ City, State Zip	_____
_____ Date	Authorized Signature and Title
_____ Phone	
_____ Fax	_____ FEIN #

Attached, if applicable, is a listing of subcontractors names and addresses which will be used for this project.

Attached is our Affidavit of Alcohol and Drug-Free Worksite, as pursuant to Idaho Code 72 - 1717.

CONTRACTOR'S AFFIDAVIT
CONCERNING ALCOHOL AND DRUG-FREE WORKPLACE

STATE OF _____

COUNTY OF _____

Pursuant to the Idaho Code, Section 72-1717, I, the undersigned, being duly sworn, depose and certify that named contractor is in compliance with the provisions of Idaho Code section 72-1717; that named contractor provides a drug-free workplace program that complies with the provisions of Idaho Code, title 72, chapter 17 and will maintain such program throughout the life of a state construction contract and that named contractor shall subcontract work only to subcontractors meeting the requirements of Idaho Code, section 72-1717(1)(a).

Name of Contractor

Address

City and State

By: _____
(Signature)

Subscribed and sworn to before me this _____ day of _____, _____.

Commission expires:

NOTARY PUBLIC, residing at

HIGHLAND HIGH SCHOOL

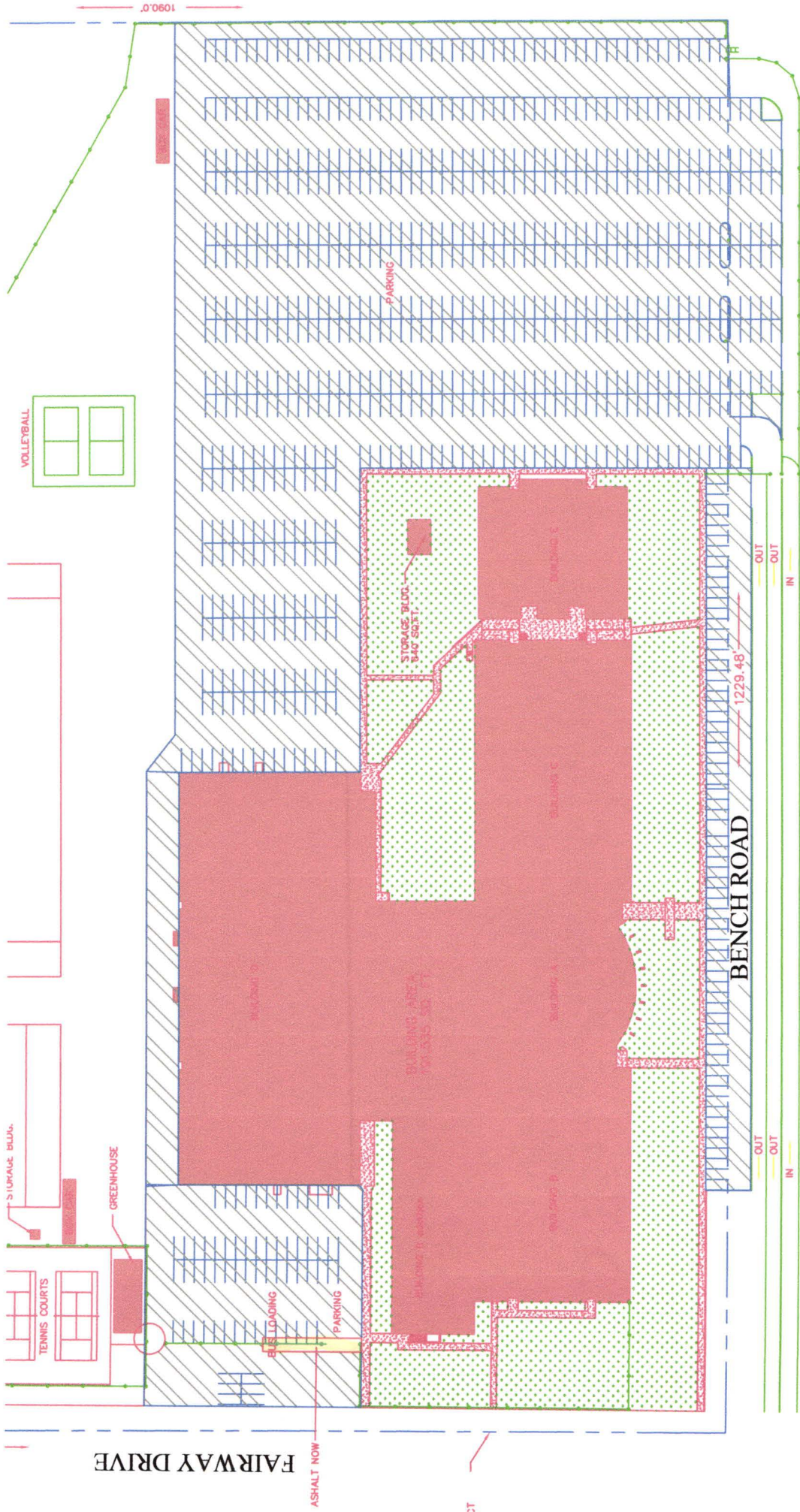



ASPHALT PATCH
6' WIDE 75' LONG

REBUILD ASPHALT
CURB

01.26.2016 10:08

McKIN

1320.6'

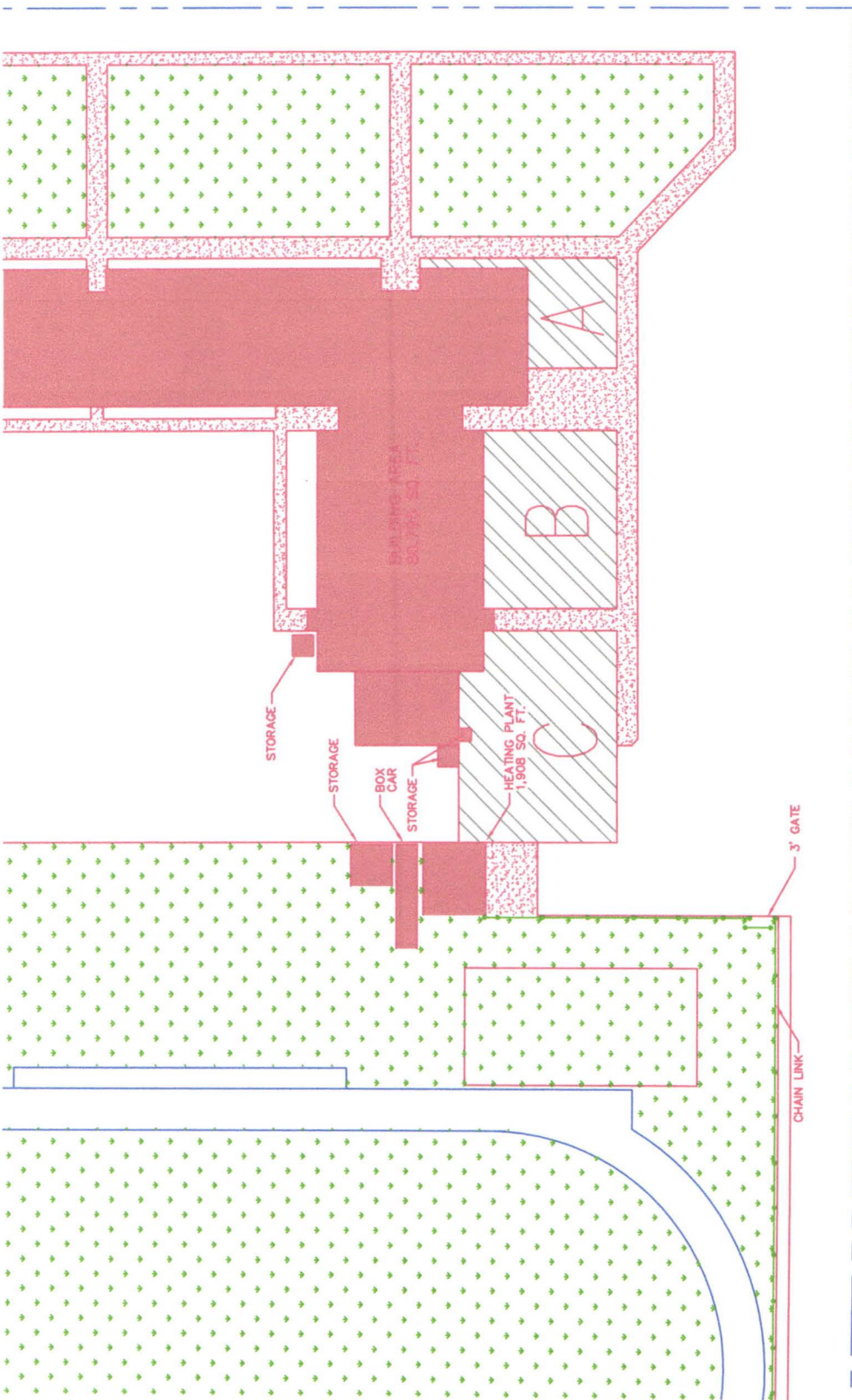

MARLU

1321.0'

SCHOOL DISTRICT PROPERTY LINE

ALAMEDA MIDDLE SCHOOL

JEFFERSON ELEMENTARY SCHOOL

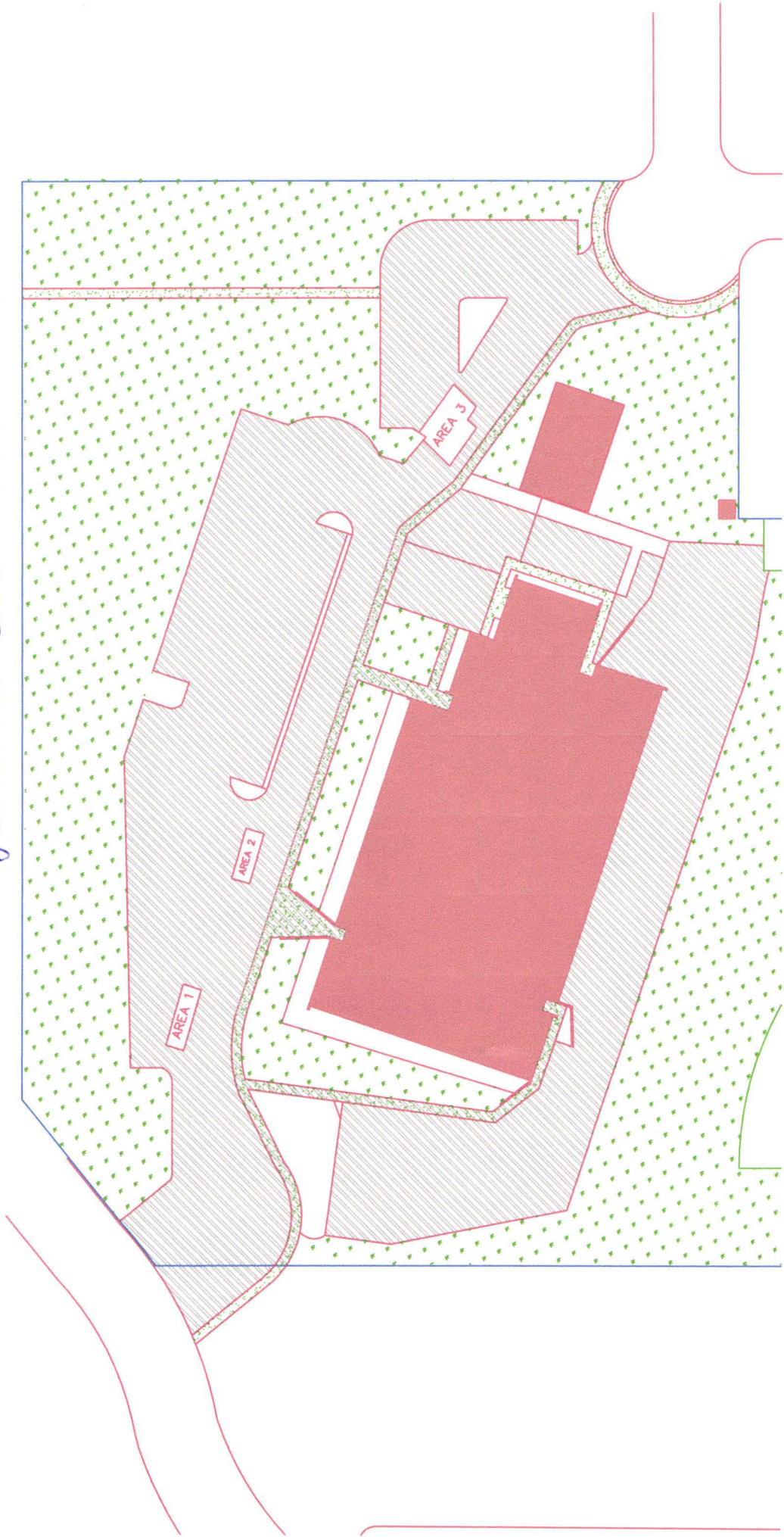

AREA 1



AREA 2



AREA 3

