

PROJECT TITLE: REFINISH GYMNASIUM HARDWOOD FLOOR – EAST LYME MIDDLE SCHOOL

EAST LYME BOARD OF EDUCATION
INVITATION TO BID

REFINISH GYMNASIUM HARDWOOD FLOOR – EAST LYME MIDDLE SCHOOL

1. The East Lyme Board of Education (BOE) is requesting bids from contractors to refinish the main gymnasium hardwood floor at the East Lyme Middle School at 31 Society Road, East Lyme, CT. Bid specifications can be obtained on the East Lyme Public Schools website current bids - <https://www.eastlymeschools.org/offices/business/purchasing-bids-and-rfps>
2. The bids are due by 2pm on Thursday, April 7, 2022.
3. The bid forms can be mailed to the East Lyme Board of Education, P.O. Box 220, East Lyme, CT 06333 Attn: Facilities Director (provided the bids are received in the office by the bid time), dropped off at the Facilities Department office, or shipped via express service to Facilities Director, East Lyme Central Office, 165 Boston Post Rd. East Lyme, CT 06333. Mark the exterior envelope: ELMS Gym Floor Bids
4. Any bids submitted/received after the due date & time will not be considered.
5. The bids need to be signed and submitted on the bid forms attached to this document.
6. This project is not anticipated to be a prevailing wage contract.
7. The work will be conducted during a limited timeframe. The contractor may start work at 7:00 AM on Thursday, June 16, 2022. The floor must be ready for regular use by Monday, July 25, 2022. Work will not be conducted on Saturdays, Sundays nor Independence Day, July 4.
8. Any questions about this project must be received before 4pm on Monday, April 4, 2022. Questions should be emailed to the Facilities Director at Christian.lund@elpsk12.org.

PROJECT TITLE: REFINISH GYMNASIUM HARDWOOD FLOOR – EAST LYME MIDDLE SCHOOL

CONTRACT TERMS AND CONDITIONS

The contract signed by the East Lyme Board of Education (BOE) and the Contractor will bind both parties to the terms and conditions listed in these bid documents, unless specified otherwise.

SPECIFIC CONDITIONS

1. The BOE is requesting a lump sum base price to refinish the approximate 126’x86’-10” (10,941 square feet) hardwood gymnasium floor at East Lyme Middle School at 31 Society Road, East Lyme, CT 06333.
2. The specific work includes the following:
 - a. Sand existing surface to bare wood. Ensure smooth, level surface exists across the floor. Apply sealer compatible with paint and topcoat.
 - b. Apply basketball court lines and other lines specified. See attached image and enclosed description.
 - c. Apply four (4) coats of Bona SuperSport HD water-based polyurethane. Contractor may propose an alternative water-based polyurethane product of equivalent or superior specifications and quality.
3. It is the contractor’s responsibility to measure the site on their own to confirm the square footage of the gymnasium floor and the condition of the existing surface.
4. Work Hours shall be 0700-1600 (Monday-Friday). Saturday hours and after-hours work may be authorized upon request. Two business days advance notice is required. Any deviations from these hours require advance approval from the Facilities Director.
5. All work shall be conducted in accordance with National Wood Flooring Association specifications for refinishing gymnasium floors. Contractor shall also comply with coating manufacturing specifications for preparation, application, curing, and cleanup of its product(s).
6. Contractor shall utilize proper controls to minimize dust. Contractor shall ensure work surface and surrounding surfaces are clean and free of sawdust at the end of the project.
7. The contractor warrants the work for up to one year in that if there are any imperfections or faulty work, the contractor shall come back and correct the issue at no charge to the customer.
8. Contractor shall protect adjacent work and structures not included in the contract. Contractor shall restore to original condition any damaged surfaces. Contractor is responsible for disposal of all waste generated during the project.

PROJECT TITLE: REFINISH GYMNASIUM HARDWOOD FLOOR – EAST LYME MIDDLE SCHOOL

9. Bleachers may remain installed in gymnasium with work being conducted around them in the closed position.
10. Pre-bid site visit may be scheduled during normal working hours by contacting the Head Custodian, Peter Coombs, 860-691-5504.

Gymnasium Line Painting

1. Prior to starting work, the contractor shall photograph or otherwise document the location, color and widths of all lines currently on the floor. This will include painted lines and lines applied using tape.
2. Main basketball court lines— repaint the main full length basketball court as originally applied with the following modifications:
 - a. Keep the existing line layout for the main court. An excerpt of the original layout blueprint is included below.
 - b. Remove the maroon paint from inside the foul line circles and leave it unpainted.
 - c. Narrow the maroon painted exterior sidelines/baselines from their existing width to a width of 2 feet on all four sides.
 - d. Apply a new logo in center court. Logo shall be a standard East Lyme logo. A similar, sample image is included below. An electronic image file of the final logo will be provided to the winning contractor upon project award.



3. Half-court basketball courts – repaint the two half-court basketball courts as originally applied.
4. Repaint the yellow main Volleyball court.
5. Repaint the 3 smaller blue Pickleball/badminton courts on each side.
6. Repaint the 2 green volleyball courts on each side.

See image of original basketball court line configuration on last page of this document.

GENERAL CONDITIONS

PROJECT TITLE: REFINISH GYMNASIUM HARDWOOD FLOOR – EAST LYME MIDDLE SCHOOL

11. The successful bidder will submit to the BOE proof that the East Lyme Board of Education is an additionally insured. Providing an insurance certificate is not proof enough. The BOE will need a copy of Additional insured endorsement or a copy of the actual policy that lists the East Lyme Board of Education as additionally insured. At no time should the Contractor perform work for the BOE without an active insurance policy with the BOE named as an Additional Insured.
12. The minimum insurance requirements that the Contractor must maintain while working on East Lyme BOE/Town property and/or within the BOE/Town's right of ways are as follows:
 - **General Liability:** \$1,000,000 each occurrence; \$2,000,000 aggregate
 - **Automobile Liability:** \$1,000,000 combined single limit for each accident
 - **Workers' Compensation:** Shall be in accordance with State of Connecticut requirements at the time of the contract. The policy must contain a waiver of subrogation in favor of the Town of East Lyme/BOE, executed by the insurance company
 - **Umbrella/Excess Liability:** \$5,000,000 each occurrence; \$5,000,000 aggregate and providing coverage over the Commercial General Liability, Commercial Automobile Liability and the Employer Liability section of the Workers Compensation coverage.

The BOE of East Lyme, its officers (both elected and appointed), employees, and agents shall be named as additional insured on all policies. Thirty (30) days' notice of cancellation is required and must be provided to the East Lyme BOE via certified mail.

13. The Contractor will perform the work in line with acceptable industry standards for this kind of work, and in accordance with manufacturer specifications/instructions.
14. The Contractor will submit one invoice at the end of their work.
15. The BOE of East Lyme agrees to process the invoice as soon as possible but no later than 30 days from the date of the invoice.
16. Pursuant to Section 12-412 of the Connecticut General Statutes, municipalities are exempt from the payment of excise, transportation and sales taxes imposed by the Federal Government and/or the State. Such taxes must not be included in Bid prices. The BOE can provide a tax-exempt certificate to the Vendor if requested.
17. The Contractor, in contracting with the BOE of East Lyme and its respective officers, agents and servants, agrees to indemnify, defend and save harmless from and against any and all claims, damages, losses, litigation expenses, counsel fees and compensation arising out of any injuries (including death) sustained by, or alleged to have been sustained by, the servants, employees or agents of the BOE and its respective officers, agents and servants, or of the Contractors or of any participant or spectator, and from injuries (including death) sustained by, or alleged to have been

PROJECT TITLE: REFINISH GYMNASIUM HARDWOOD FLOOR – EAST LYME MIDDLE SCHOOL

sustained by, the public or any persons on or near the site or on any other person or damage to property, real or personal, including property of the BOE and their respective officers, agents, and servants, caused in whole or in part by the acts or omission of the Contractor or any participant or spectator or anyone directly or indirectly employed or working for the Contractor while engaged in the activity in the BOE of East Lyme.

18. The bidder agrees and warrants that in the submission of this sealed bid, they will uphold East Lyme Public School's commitment to following Connecticut State and Federal law ensuring full compliance. East Lyme Public Schools prohibits harassment and discrimination on the basis of race, color, religious creed, age, marital status, military or veteran status, national origin, sex, ancestry, sexual orientation, or past or present physical or mental disability in accordance with Titles VI, VII of the Civil Rights Act of 1964, which affirms that no person or group of persons is excluded from participation, denied benefits, or otherwise subjected to discrimination or permits discrimination under any program or activity or any service rendered to the public, on the grounds of race, color, creed, religion, national origin, sex, age or disability. Title IX of the Education Amendments Act of 1973; Section 504 of the Rehabilitation Act of 1973; the Americans with Disabilities Act of 1991; and applicable state laws. Unless it is shown by such bidder that such disability prevents performance of that which must be done to successfully fulfill the terms of this sealed bid or in any manner which is prohibited by the laws of the United States or the State of Connecticut.

PROJECT TITLE: REFINISH GYMNASIUM HARDWOOD FLOOR – EAST LYME MIDDLE SCHOOL

EAST LYME PUBLIC SCHOOLS

BID FORM

REFINISH GYMNASIUM HARDWOOD FLOOR – EAST LYME MIDDLE SCHOOL

FROM: _____ (Bidder)

TO: East Lyme Public Schools

Attn: Facilities Director

165 Boston Post Road

East Lyme, CT 06333

The undersigned proposes to furnish through his bid price all charges, including all supervision, technical personnel, labor, materials, equipment, tools, appurtenances, services, and anything else necessary to perform and complete this Contract pursuant to the Contract specifications for the prices as listed below:

Lump Sum for Contract _____ **(Written in numbers)**

_____ **(Written in words)**

The undersigned agrees to complete the above referenced work in the time allotted based on the bid documents for the above referenced bid prices.

Signature _____

Main Contact # _____

Print Name _____

Address _____

Email Address _____

PROJECT TITLE: REFINISH GYMNASIUM HARDWOOD FLOOR – EAST LYME MIDDLE SCHOOL

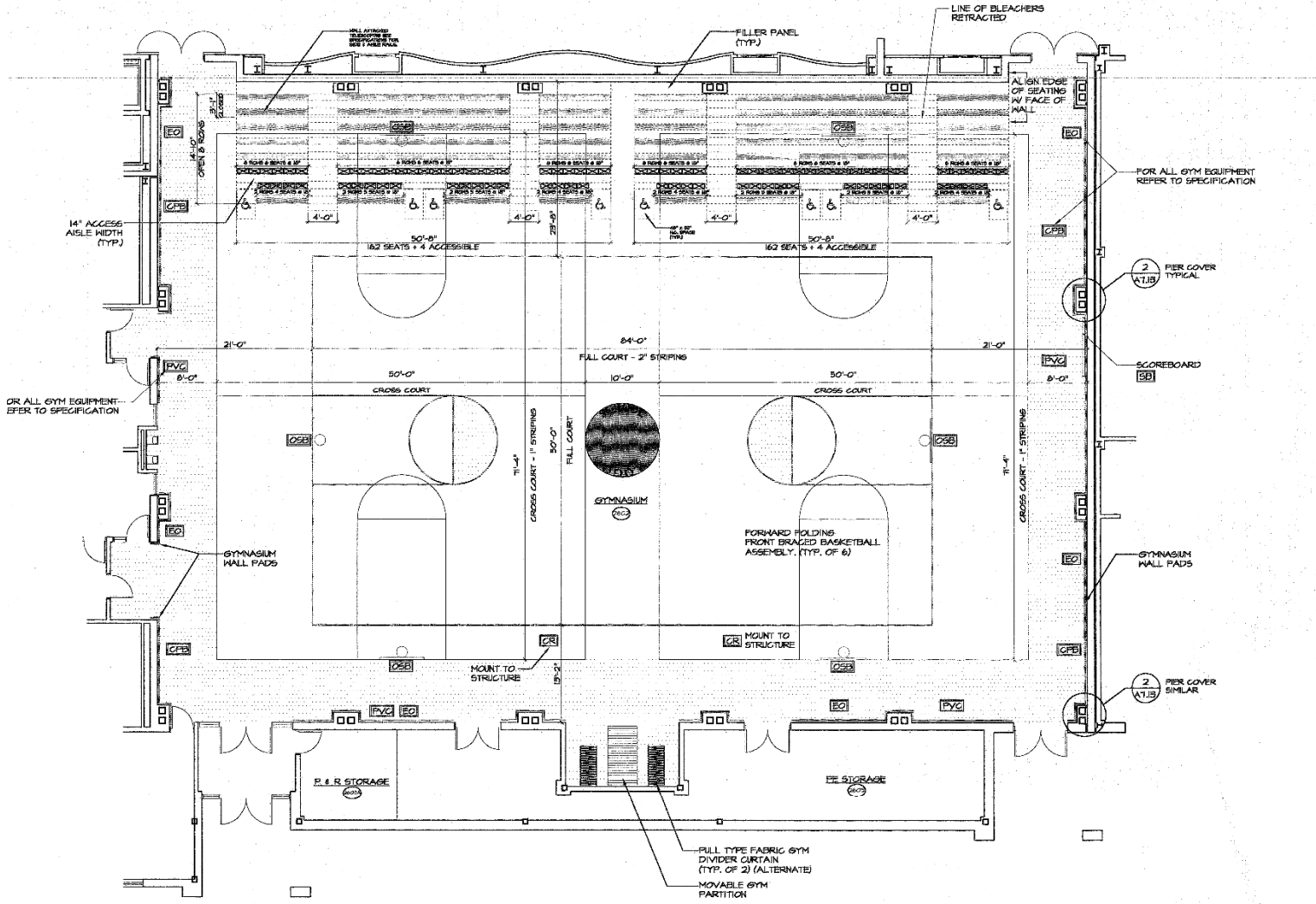

1 GYMNASIUM PLAN
A7.13 SCALE 1/8" = 1'-0"

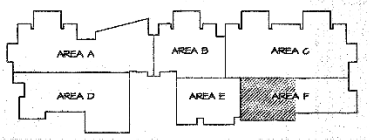

STATE PROJECT NO. 045-054N
PHASE TWO - ARCHITECTURAL, M/E/P
**EAST LYME
MIDDLE SCHOOL**
SOCIETY ROAD
EAST LYME, CONNECTICUT

LARGE SCALE PLANS
GYMNASIUM

DATE: 02/28/2000		REVISIONS	
DRAWN BY: KFM	NO. 1	DATE 12/1/00	DESCRIPTION ISSUE FOR BID
SCALE: 1/8" = 1'-0"			
REVIEWED BY:			
PROJECT NO. 490101			
91010155.DWG			

SHEET NO.
A7.13