

# COACHELLA VALLEY UNIFIED SCHOOL DISTRICT PALM VIEW ELEMENTARY SCHOOL

SEPTEMBER, 21 2017

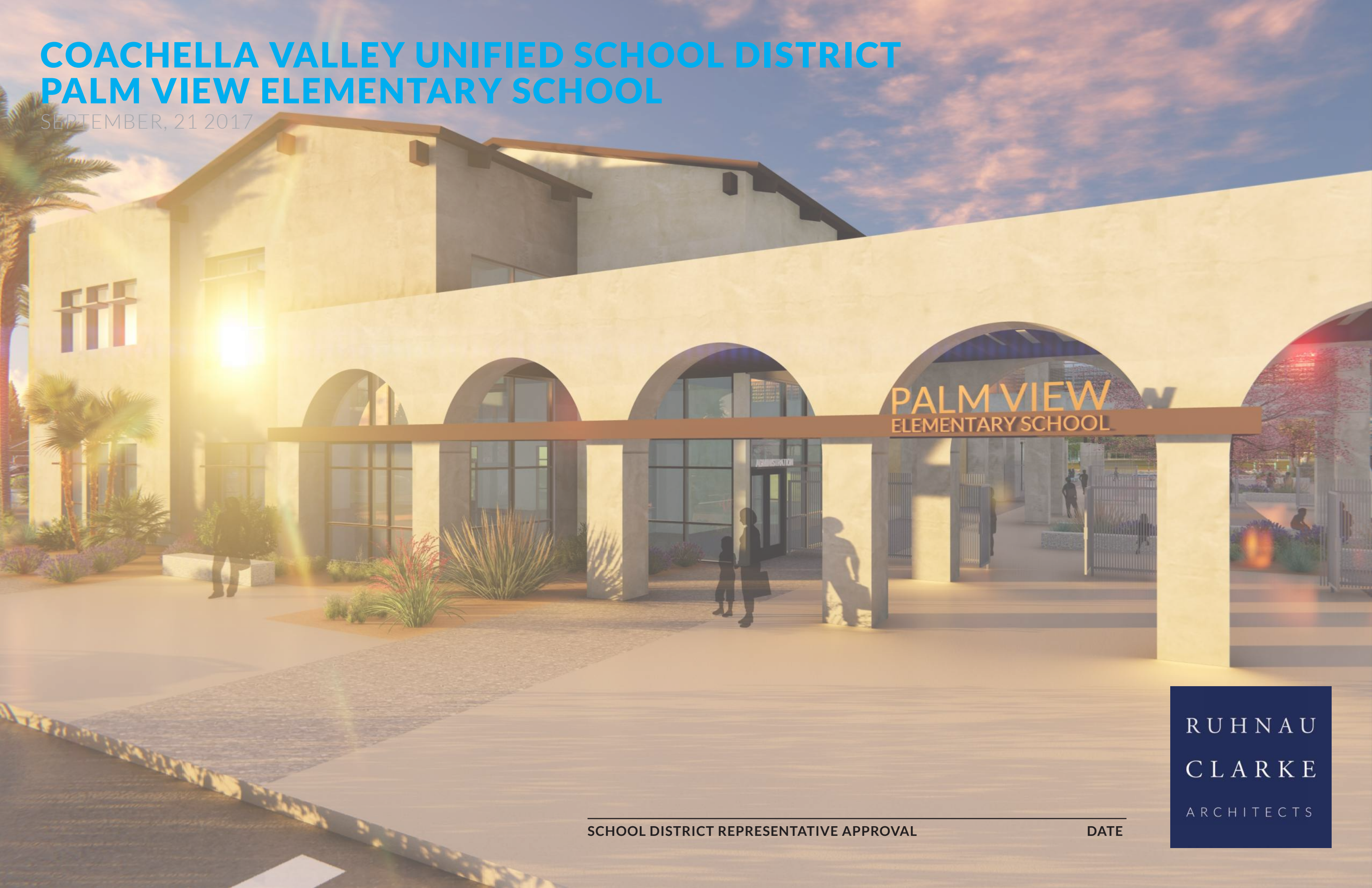

RUHNAU  
CLARKE  
ARCHITECTS

SCHOOL DISTRICT REPRESENTATIVE APPROVAL

DATE



# PALM VIEW ELEMENTARY SCHOOL

EXISTING SITE AERIAL

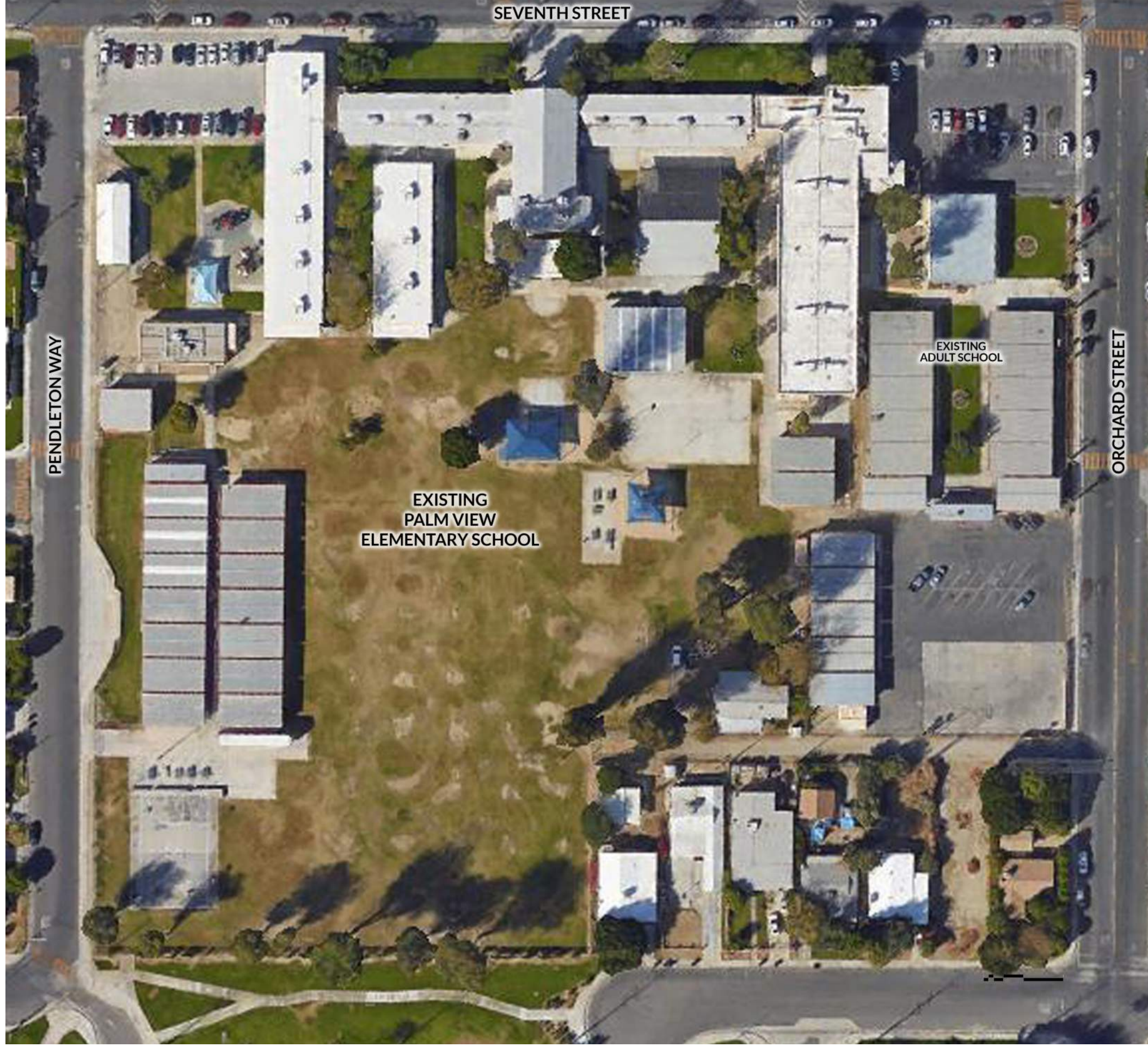



# PALM VIEW ELEMENTARY SCHOOL



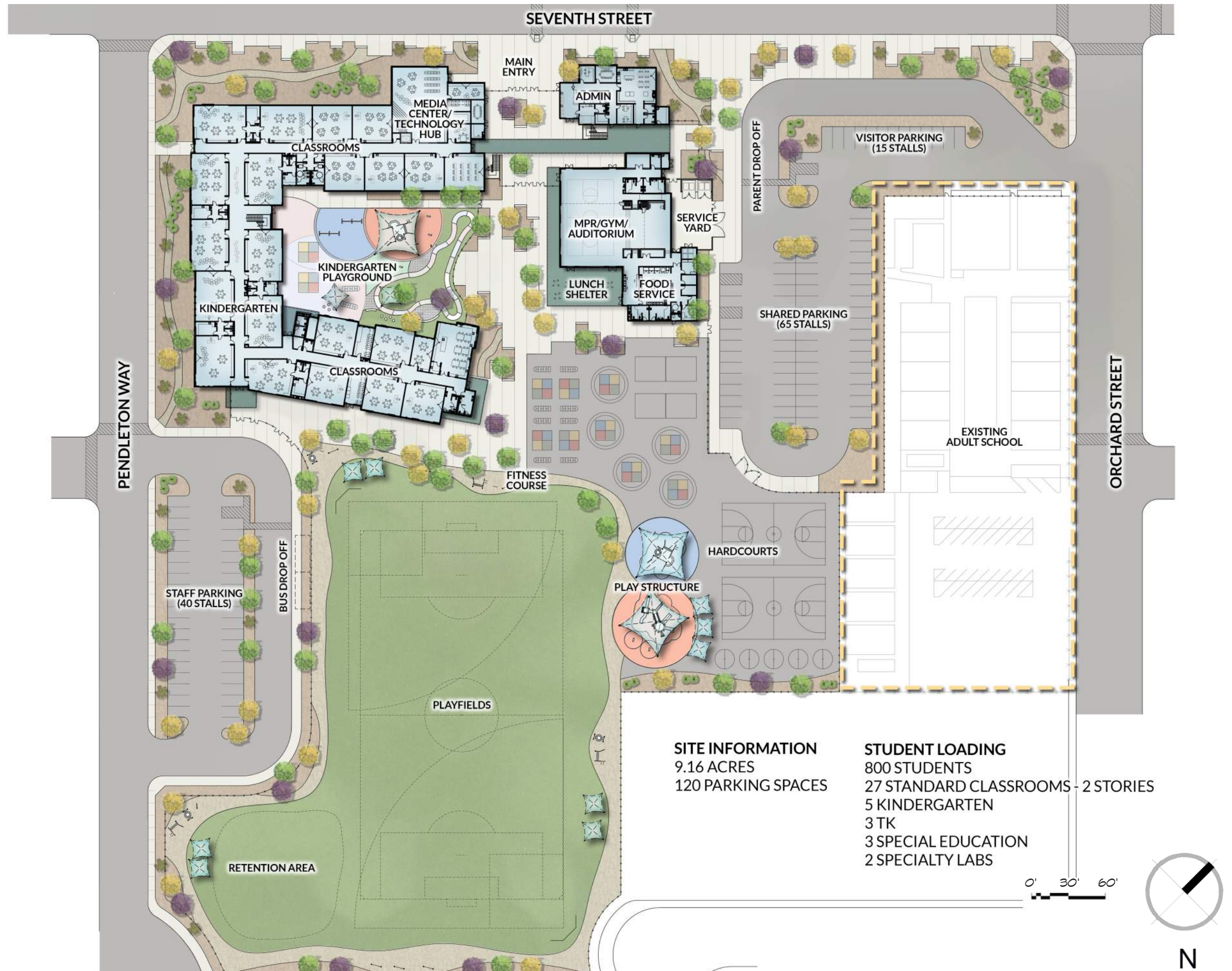







## SITE PLAN





# PALM VIEW ELEMENTARY SCHOOL

FIRST FLOOR

-  Main Entry/ Exit
-  Secondary Exit
-  Transitional Kindergarten CR
-  Kindergarten CR
-  1st Grade CR
-  2nd Grade CR
-  Media Center/ Technology Hub
-  Commons/ Lab
-  Special Ed. CR
-  Support
-  A.S.E.S After School Program Storage
-  Utility

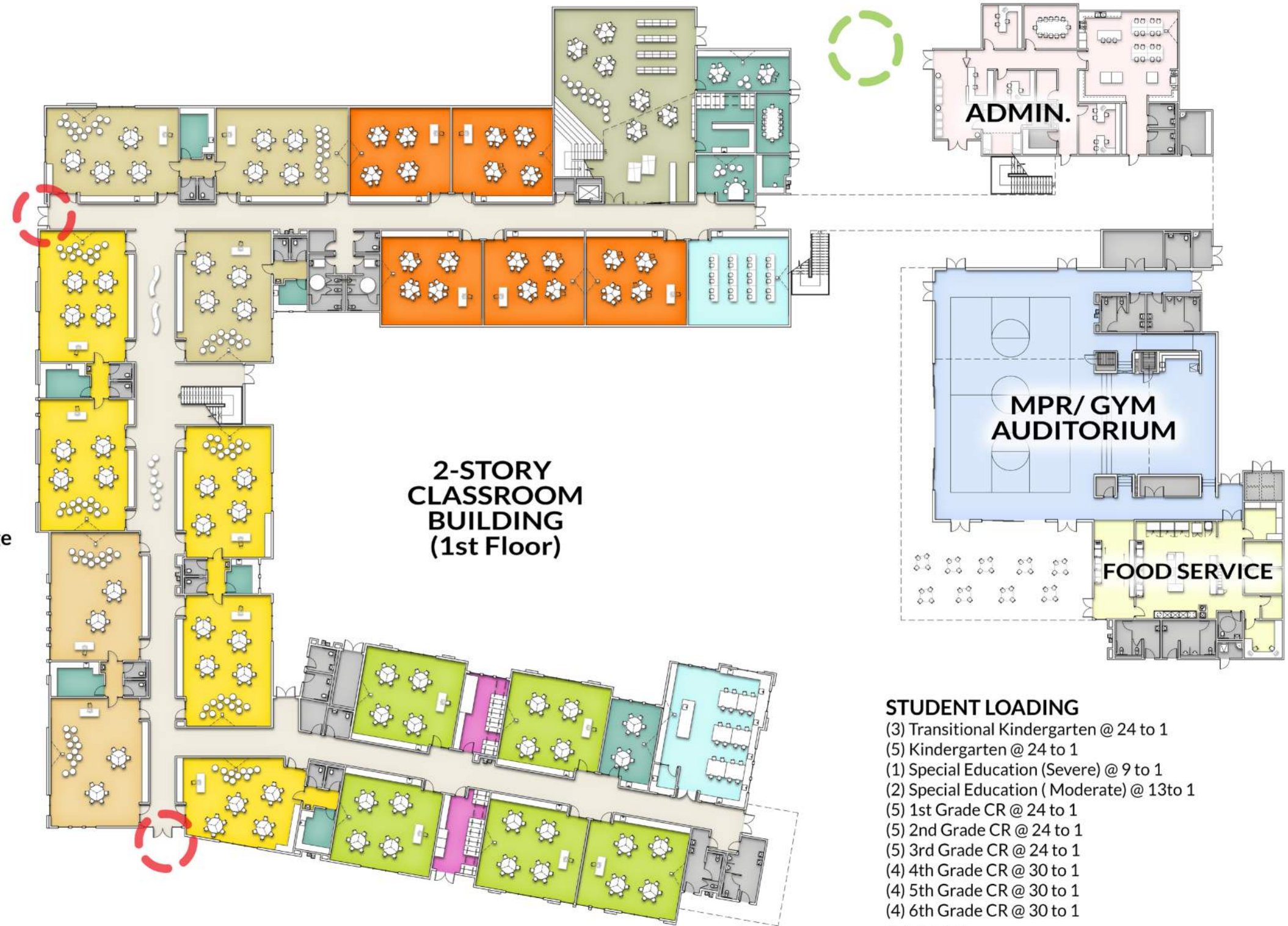

**PALM VIEW  
ELEMENTARY  
SCHOOL**  
SECOND FLOOR

- 3rd Grade CR
- 4th Grade CR
- 5th Grade CR
- 6th Grade CR
- Commons/ Lab
- Support
- Utility

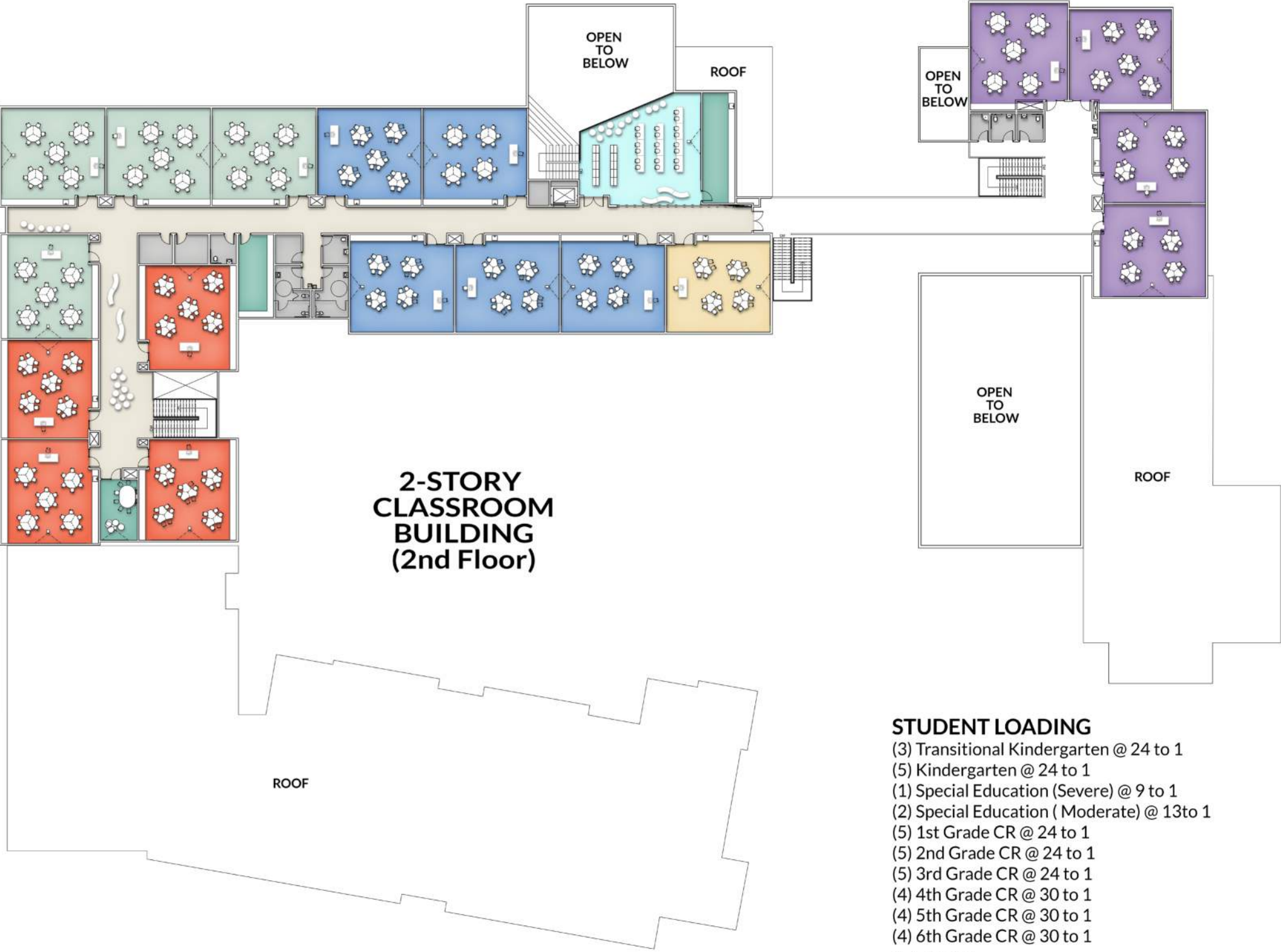

- STUDENT LOADING**
- (3) Transitional Kindergarten @ 24 to 1
  - (5) Kindergarten @ 24 to 1
  - (1) Special Education (Severe) @ 9 to 1
  - (2) Special Education (Moderate) @ 13 to 1
  - (5) 1st Grade CR @ 24 to 1
  - (5) 2nd Grade CR @ 24 to 1
  - (5) 3rd Grade CR @ 24 to 1
  - (4) 4th Grade CR @ 30 to 1
  - (4) 5th Grade CR @ 30 to 1
  - (4) 6th Grade CR @ 30 to 1
- Total 38 Classrooms**

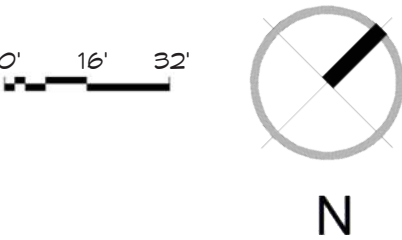





**PALM VIEW  
ELEMENTARY  
SCHOOL**  
NORTH AERIAL  
VIEW





PALM VIEW  
ELEMENTARY  
SCHOOL  
WEST AERIAL  
VIEW





PALM VIEW  
ELEMENTARY  
SCHOOL  
SOUTH AERIAL  
VIEW



PALM VIEW  
ELEMENTARY  
SCHOOL  
MAIN ENTRY







**PALM VIEW  
ELEMENTARY  
SCHOOL**  
SEVENTH STREET  
VIEW





PALM VIEW  
ELEMENTARY  
SCHOOL  
AUDITORIUM  
COURTYARD





PALMVIEW  
ELEMENTARY  
SCHOOL  
STUDENT  
YARD



**PALM VIEW  
ELEMENTARY  
SCHOOL**  
KINDERGARTEN  
PLAYGROUND







**PALM VIEW  
ELEMENTARY  
SCHOOL**  
KINDERGARTEN  
PLAYGROUND





**PALM VIEW  
ELEMENTARY  
SCHOOL**  
HARDCOURTS





**PALM VIEW  
ELEMENTARY  
SCHOOL**  
INTERIOR CONCEPT  
ADMINISTRATION





**PALM VIEW  
ELEMENTARY  
SCHOOL**  
INTERIOR CONCEPT  
MEDIA CENTER



**PALM VIEW  
ELEMENTARY  
SCHOOL**  
INTERIOR CONCEPT  
AUDITORIUM





# PALM VIEW ELEMENTARY SCHOOL

## INTERIOR CONCEPT TYPICAL CLASSROOM

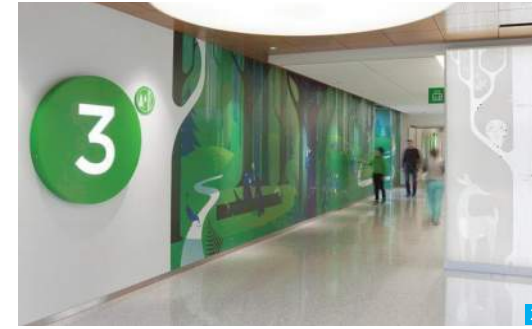
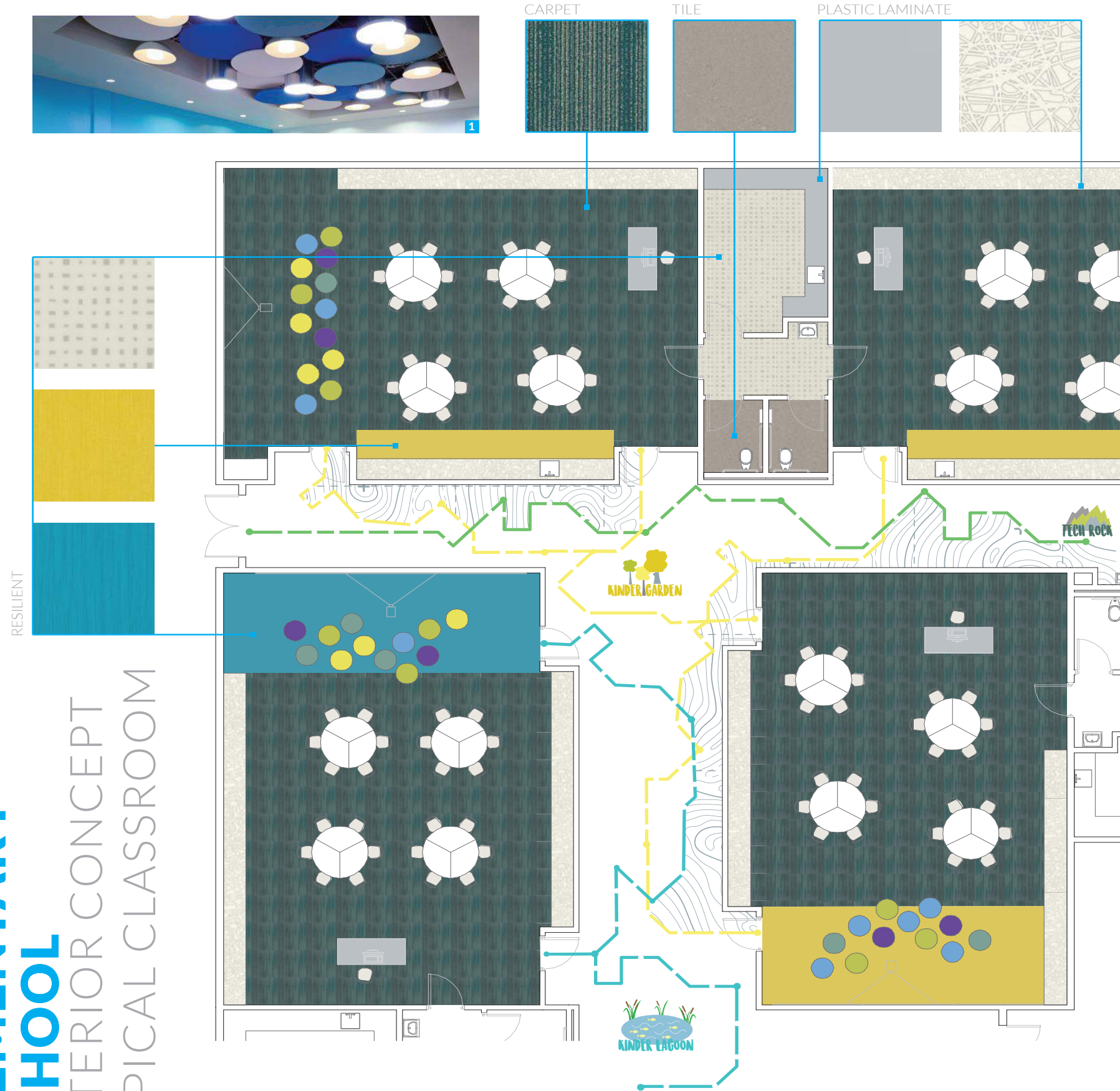

1. Specialty ceiling at labs adds playful element
2. Wayfinding in corridors corresponds to grade name e.g., Kinder Lagoon, Tech Rock
3. Floor graphics represent 'find your learning' map that leads to grade villages with learning elements like distance and contours
4. Wood in corridors adds warmth and highlights ceilings
5. Integrated reading nooks on second floor represent opportunity to lounge and promote learning in corridors





**PALM VIEW  
ELEMENTARY  
SCHOOL**

TYPICAL HALLWAY







RUHNAU  
CLARKE  
ARCHITECTS