

LODI UNIFIED SCHOOL DISTRICT

2022 Paving Project(s) – Phase III

PROJECT NUMBER: 0949-8249

DSA #:02-118898

Bear Creek High School

PROJECT NUMBER: 0941-8241

DSA #:02-118900

Delta Sierra Middle School

ADDENDUM NO. 2

February 18, 2022

Owner: Lodi Unified School District
1305 E. Vine Street
Lodi, CA 95240

Engineer: Warren Consulting Engineers, Inc.
1117 Windfield Way
El Dorado Hill, CA 95762

Project Manager: Capital Program Management, Inc.
1851 Heritage Lane, Suite 210
Sacramento, CA 95815

This Addendum has been prepared to clarify, modify, delete, or add to the drawings and/or specifications for the above referenced project, and revisions to items listed here shall supersede description thereof prior to the above stated date. All conditions not specifically referenced here shall remain the same. It is the obligation of the Prime Contractor to make subcontractors aware of any items herein that may affect submitted bids.

Acknowledge receipt of this addendum by inserting its number and date in the bidding documents. Failure to do so may subject bidder to disqualification.

All addenda items refer to the plans and specifications unless specifically noted otherwise.

TOTAL PAGES IN THIS ADDENDUM (including attachments): 3

PART A - BIDDING AND CONTRACT REQUIREMENTS

- 2.1 The bid date has not changed. Bids are due Thursday, February 24, 2022 by 2:00:00 p.m. at the Maintenance and Operations Building at 880 N. Guild Ave. Lodi California 95240.

PART B – TECHNICAL REQUIREMENTS

N/A

PART C - DRAWINGS

- 2.2 See Attached Sheet A-11 As Built Sprinkler Irrigation Plan Campus Area for Bear Creek High School – Information for turf areas affected by new parking lot scope.

PART D - ATTACHMENTS

- 2.3 Sheet A-11 Bear Creek High School As Built Sprinkler Irrigation Plan Campus Area – (1 Page)

End of Addendum

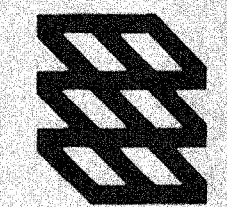

7300 Folsom Blvd. #200
Sacramento, CA 95826
916 381 0127

DENNIS TSUBOI & ASSOCIATES
LANDSCAPE ARCHITECTURE
ENVIRONMENTAL PLANNING
7300 Folsom Boulevard, Suite 202
Sacramento, California 95826
Telephone (916) 381-3700
CONSULTANT

BEAR CREEK HIGH SCHOOL
LODI UNIFIED SCHOOL DISTRICT
THORNTON ROAD, STOCKTON, CALIFORNIA

OSA - STRUCTURAL SAFETY SECTION

OSA - ACCESS COMPLIANCE SECTION

STATE FIRE MARSHAL

REVISIONS		
NO.	DESCRIPTION	DATE APPD

DATE NOV. 11 1988

JOB NO. 3193.00

SHEET TITLE
**SPRINKLER
IRRIGATION PLAN
CAMPUS AREA**

SHEET NO.

A-11

OF
SHEET OF TOTAL

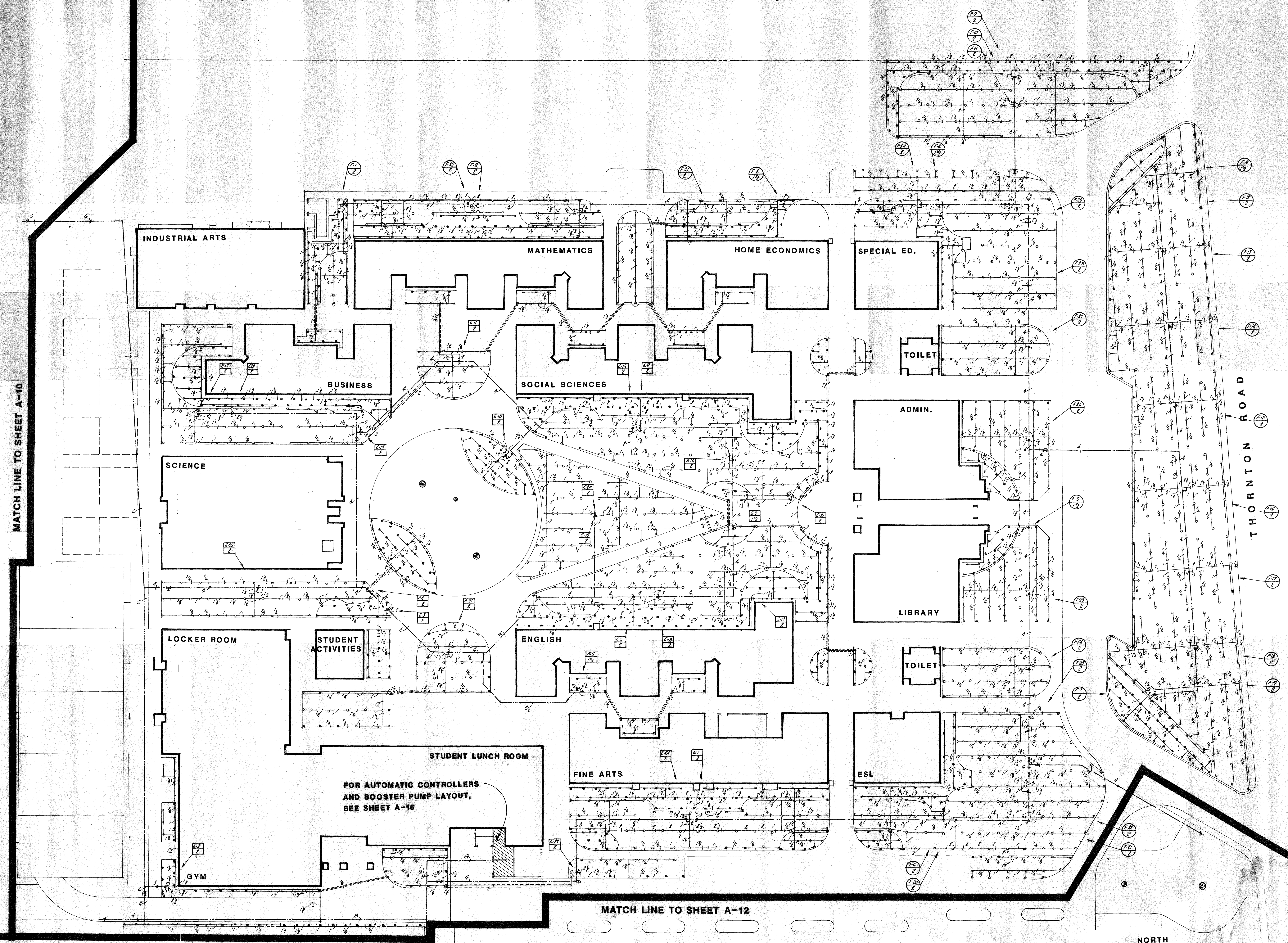

BIDDERS NOTE: THE PORTION OF SPRINKLER IRRIGATION SYSTEM TO BE DEDUCTED AND INCLUDED AS PART OF DEDUCTIVE ALTERNATE ITEM NO. 2 IS ALL THE LATERAL LINES AND SPRINKLER HEADS DOWN STREAM OF ALL AUTOMATIC CONTROL VALVES FROM "P" AND "P" CONTROLLER. MAIN LINE, AUTOMATIC CONTROL VALVES, GATE VALVES, QUICK CLOSURE VALVES, CONTROL WIRE AND AUTOMATIC CONTROLLER "P" AND "P" TO REMAIN A PART OF BASE BID.

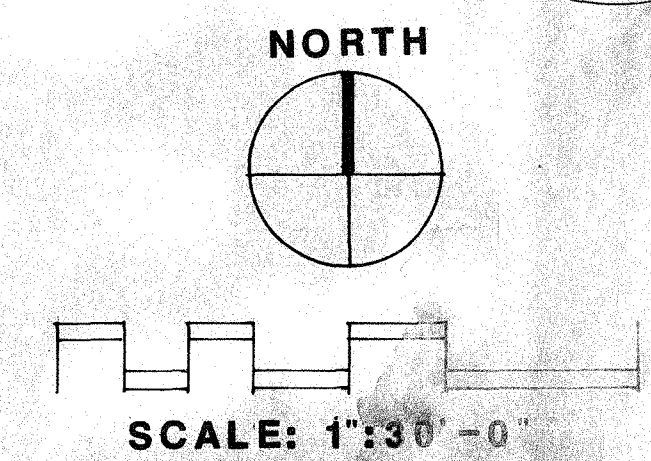

FOR SPRINKLER IRRIGATION LEGEND AND NOTES, SEE SHEET A-13
FOR SPRINKLER IRRIGATION DETAILS, SEE SHEET A-14

TB	
I	O
ARCH	