

# Aurora

2020-21 Annual Report

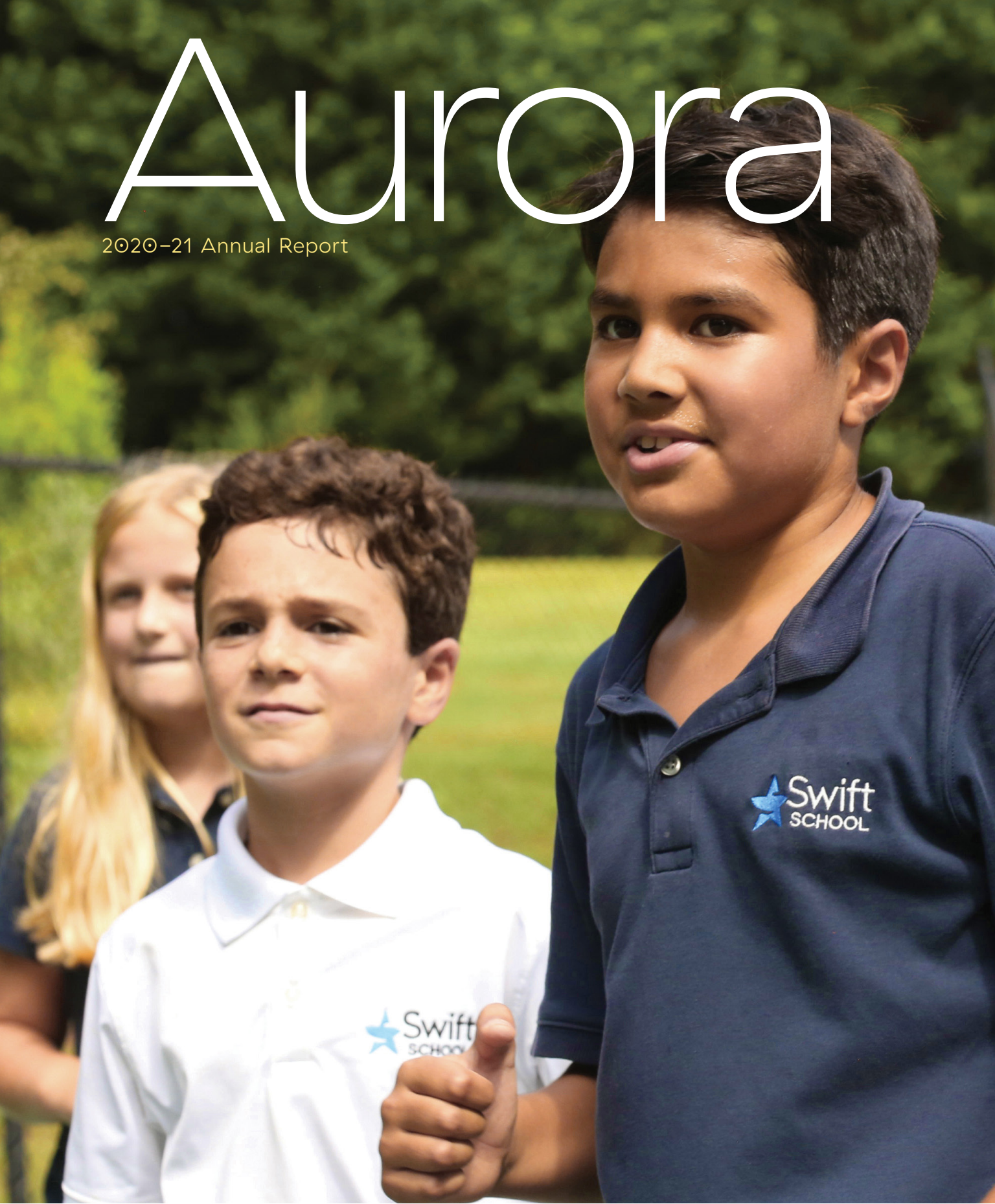



A photograph of three students in school uniforms sitting on the floor. A boy in a white polo shirt is holding an orange tablet. Two other students, a girl in a blue t-shirt and a boy in a blue t-shirt, are looking at the tablet. The boy in the foreground is pointing at the screen. They are all wearing school uniforms with 'Swift School' logos. The background shows a gymnasium floor and blue mats.

# Table of Contents

04	A Letter of Gratitude
06	Professional Development
08	Growth Assessment
09	Student Profile
10	Portrait of Success
11	Class of 2021
12	Master Plan Update
14	Swift Supporters
18	GA Goal Supporters



## Greetings Swift Family,

Any look back at the 2020–21 school year, whether six months later or six years from now, will prominently include the words “Covid” and “pandemic.” To say it was a challenging year for all of us would be an epic understatement, as it would to say how proud I am of our community for its resilience. It has become commonplace for teachers and staff to go the extra mile to ensure that learning continues despite layers of safety measures. While the fall of 2021 brought some measures of relief, we look forward to the day when school looks more like we knew it pre-pandemic.

My own review of the past year-plus includes pride in not only our tenacity but much progress and growth as well.

- ★ We have hired an additional counselor to proactively address the collective mental health needs of our students as a result of the learning and social disruption caused by the pandemic.
- ★ We are growing the STEAM program with intention, via learning tools acquired through the success of the Swift Fund, which reached a new height of 77% parent participation in 2020–21.
- ★ Also thanks to support of the Swift Fund, we upgraded technology both for the last-resort option of remote learning and smoother, more robust delivery of content in the classrooms.
- ★ We have broadened our curriculum to introduce Drama and Italian language education, and we have reimaged music and added an after-school club for percussion.

Swift students will have more areas to shine and more opportunities to emphasize the right-brain strengths of their dyslexic minds.

I look enthusiastically forward to continuing and growing the Swift mission. We consistently hear from alumni families about the transformation in their students facilitated by their years at Swift. If you have fond memories of your Swift School experience, I hope you will take time to share them with me. We will be sharing these stories of gratitude far and wide, and I look forward to hearing many more examples of The Swift Effect® in 2022 and beyond.

With gratitude and all best wishes,

*Chris Roman*



Swift students will  
have more areas  
to shine, more  
opportunities  
to emphasize  
the right-brain  
strengths of their  
dyslexic minds.



# Gratitude, Growth, & Comradery

I worked very hard at implementing the many strategies I was taught. I excelled academically, socially, and most importantly, my confidence soared. You prepared me with the work ethic I needed to be successful outside of the classroom.

Dear Dyslexia.

Now that I'm a confident, successful, high school senior, ready to conquer the many challenges that come my way, I would like to make you aware of several things.

First, I do think it is ironic that I am finally opening up to you in October, which as you already know, is Dyslexia awareness month. What I also think you should know is that YOU, yes YOU, make learning difficult for more than 40 million American adults and children. Unfortunately, only about 2 million are aware that YOU are their problem, and they struggle year after year thinking they are less than, or not as smart as their peers.

My younger self might never forgive you for the anxiety I felt every time it was my turn to read out loud in the classroom. Dyslexia, don't you know that kids can be really mean? Still there YOU were, "My Goliath", mixing up my letters and numbers when it was my turn to read. It was very obvious that I was going to have to work much harder just to keep up, and so that's what I did. I was determined to do well. I was also lucky enough to be one of the 2 million that were aware that YOU, Mr. Dyslexia, were my problem. I was not less than. I just had an obstacle to overcome, and so I did.

In 5th grade my dad got a new job and my family relocated to Atlanta. According to Elizabeth, Swift School is the reason God placed us in Atlanta. It was here where my parents found a school that was very supportive of students who had different learning styles. Wow, I hit the



Antonio Hundley, William Brown, and Collin Moonan, (L-R) during their Swift School years.



jackpot on so many levels. I quickly made friends, and I realized there were so many bright kids that were just like me. I worked hard at implementing the many strategies I was taught, and I excelled academically, socially, and most importantly my confidence soared.

I truly believe for the first time that YOU were NO Goliath, just one of the many hurdles that would come my way. Armed with the right tools, I was able to live with you and learn from you. Although it was a difficult battle during my younger years, I still wouldn't have wanted it any other way. I learned some very important lessons from our time together. You prepared me with the work ethic I needed to be successful outside of the classroom.

During middle school I started spending a lot of time playing golf with my dad. Quickly, I realized that for me, golf is not just a hobby. I was hooked. When I proudly got accepted to Mount Vernon, one of Atlanta's more competitive schools, I was determined to earn a spot on their golf team. I worked diligently at golf practice, went home and practiced some more. I was ecstatic when I made the team. It didn't stop there. I kept working at it and the following year, I was playing on the varsity team as a freshman. My dedication to the team since then has helped me to win several tournaments, receive the coaches award, and to be chosen as the Senior team captain.

I never thought I would be saying this, but thank you, Dyslexia. You made me work extremely hard and taught me how capable I am when I put my mind to achieving a goal. With your help, I have been able to turn troubles into strengths and to be empathetic to others who are battling their own Goliath. For this, I will be forever grateful.

Thank you for all you have done.  
William Lee Brown

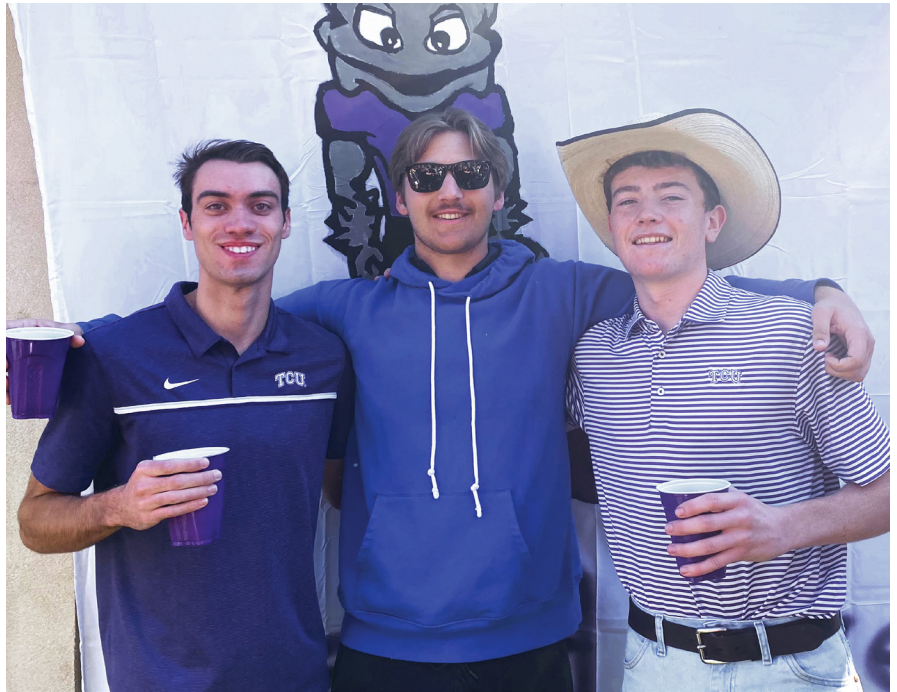

### Where Are They Now?

Collin Moonan (left) and William Brown (right) are both current undergraduates at Texas Christian University in Fortworth. Antonio Hundley (middle) is a current student at Baylor University in Houston. The three Swift friends recently reunited at the TCU/Baylor football game to enjoy the comradery, share their successes, and describe how they continue to grow after attending Swift School.



# Faculty Professional Development

Professional development differentiates a Swift education from other options. As a school specialized in the remediation of Dyslexia, thousands of hours of professional development are invested into the Swift School Faculty. Ongoing mentorship from seasoned colleagues serves to support new teachers. As a result our faculty is highly trained, educated, and prepared to deliver instruction using practices designed for our learners. This translates directly to student achievement and success.

## Professional Development in Instructional Approaches and Curriculum used at Swift

- ★ Orton–Gillingham Associate (OGA) and Certified Level Coursework (OGA)
- ★ Orton–Gillingham Practicums (OGA) — Classroom Educator, Associate, and Certified Levels
- ★ Orton–Gillingham Approach (OGA) — Workshops (Lesson Planning, Phonological/Phonemic Awareness, Error Correction, Writing, Morphology, etc.)
- ★ Woodin Math Workshops & Training 1–8
- ★ Wit & Wisdom — Workshops & Training 1–8
- ★ The Writing Revolution — Leading the Revolution & Advancing Thinking Through Writing I

## Research and Outreach

- ★ Swift Institute Presentations (2020–2021) — *Experience Dyslexia, What is Dyslexia?, What is Structured Literacy?, The Impact of Social Emotional Learning on Behavior, Language Processing, Technology in the Classroom, Multisensory Math, Understanding Psychological Assessments, Prevent the Summer Slide*
- ★ Orton–Gillingham Subscriber, Classroom Educator, Associate, and Certified Level Coursework
- ★ Orton–Gillingham Practicums — Classroom Educator, Associate, and Certified Level

## Professional Symposiums (in no particular order)

- ★ IDA– International Dyslexia Conference (Virtual)
- ★ OGA National Conference (Virtual)
- ★ National Business Officers Association Conference (NBOA) Virtual
- ★ Southern Association of Independent Schools (SAIS) Annual Conference (in-person)
- ★ ISM Strategic Planning with emphasis on Strategic Financial Planning (Facilities, Financial Aid, Long-Range Planning, COVID Response, etc.)
- ★ ISM Pandemic Briefing with Medical Experts for Independent Schools (Virtual) – bi-monthly all of 2020 and 2021.
- ★ KSU Independent School Symposium
- ★ Women’s Leadership Institute (SAIS) Virtual (April, 2021)
- ★ Think Quest (Gordon Hwang) Aug.–Sept. 2020 and Team Retreat (Sept. 2020)
- ★ The Reading League Annual Conference (Nov. 2020)
- ★ Diversity, Equity, and Inclusion Workshop (July 2021)
- ★ Georgia Technology Conference (Nov. 2020)



# Learning Enhancements

**May 2019** – Natalie Felix receives Fellow status from The Academy of Orton–Gillingham Practitioners and Educators (OGA)

**July 2019** – Wit & Wisdom Professional Development began and continues to be delivered to all Lower Division, Speech & Language Pathologists, and Middle Division Language Arts teachers.

**October 2019** – Recognized by the Academy of Orton Gillingham Practitioners and Educators (OGA) as an Accredited Training Program – OGA Associate Level

**August 2020** – Swift hires a full-time drama instructor

**April 2021** – Recognized by the Academy of Orton Gillingham Practitioners and Educators (OGA) Swift becomes an Accredited Training Program – OGA Certified Level

**May 2021** – With the class of 2021, the number of Swift graduates jumps to 109.

**June 2021** – Swift added a summer Multisensory Math Clinic for rising 5th and 6th graders.

**August 2021** – Wit and Wisdom was expanded to encompass grades 1–8.

**August 2021** – A formal onboarding procedure was implemented with all new Associates within the Lower Division. Professional development training in all academic programming, social-emotional, and behavioral programs is taking place to properly prepare new teachers to teach our students.

**August 2021** – Swift School Lower Division Teacher, Mandy Menshon, is consulting with Lower Division teachers to support math instruction.

**August 2021** – Swift hires a full-time Orton Gillingham Fellow, a part-time foreign language teacher, and a part-time STEAM instructor

**August 2021** – Afterschool STEAM club began.

**August 2021** – Percussion and Chorus club is continued.

**August 2021** – Swift School sponsors the Dyslexia Dash

**August 2021** – Swift School sponsors the International Dyslexia Association Conference.

**August 2021** – Swift hires an additional counselor to better support social-emotional learning.

## Professional Preparedness

**60%** of Swift School's faculty have earned graduate and postgraduate degrees in the fields of reading, language acquisition, learning differences, early childhood education, elementary education, science education, mathematics, speech and language pathology, educational leadership, guidance and counseling, psychology, business administration, and other related fields.

**75%** of Swift Faculty have completed the 70-hour Associate Level course (as of December 2021.) The remaining 25% are either completing the course during the 2021–2022 school year or during the two-week intensive course in June of 2022.

## Current Level of OGA Credentials & Ongoing Coursework/Practicum

- 1** Fellow Member
- 1** Fellow-in-Training Member
- 1** Certified Member
- 6** Associate Level Members
- 11** Classroom Educator Members
- 6** Associate Level Practicum Trainees (2021–2022)
- 5** Associate Level Coursework Attendees (2021–2022)
- 5** Associate Level Coursework Attendees (Summer 2022)





# Growth

MAP\* Growth Assessment (formerly Northwest Evaluation Association, NWEA) is one aspect of Swift's comprehensive assessment plan.

## MAP Growth Facts

### Nationally Normed ★

comparing student achievement and growth to others in the same grade nationally

### Computer Adaptive ★

test questions adapt to the student's performance level

### Rauch UniTs (RIT Scores) ★

track growth through the year and across grade levels

The graphs depict Fall/Spring performance in reading and mathematics in the 2020–21 academic year.



Caution when interpreting:

These graphs depict the performance of a small group of diverse students.

\*Measurement of Academic Progress

# Assessment

## MAP Growth Assessment: Mathematics

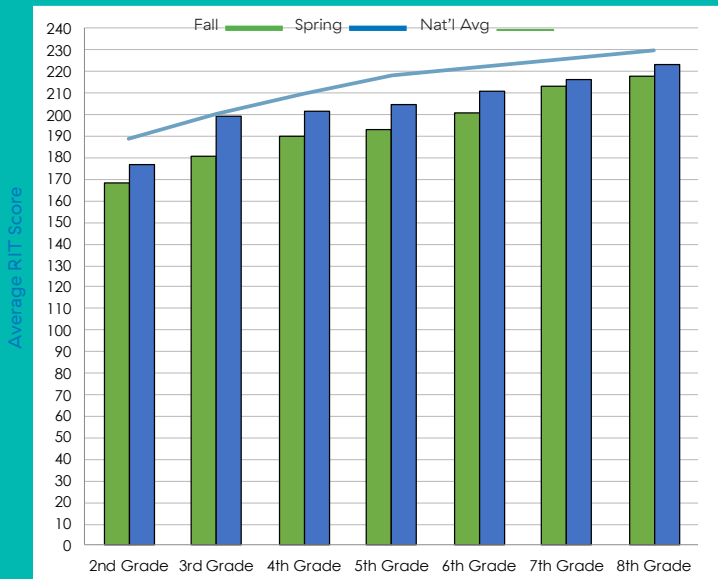

### Fall to Spring Growth

Domains assessed include Numbers and Operations, Algebraic Thinking, Measurement and Data, Geometry, Statistics and Probability.

## MAP Growth Assessment: Reading

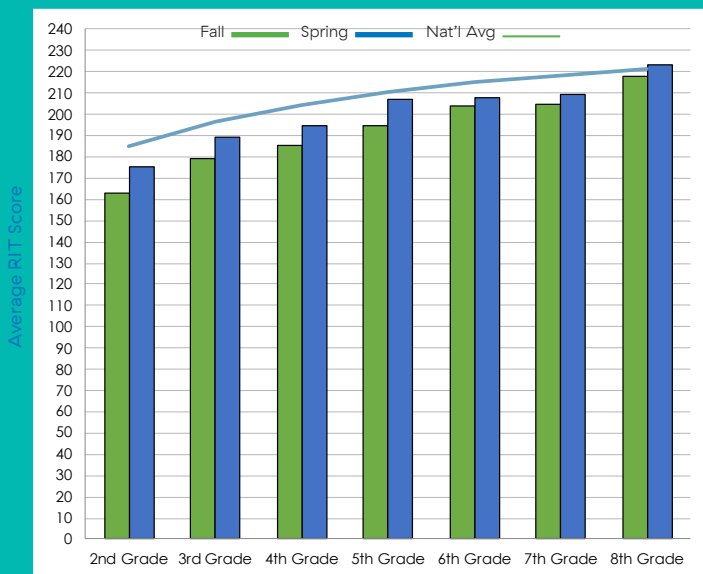

### Fall to Spring Growth

Domains assessed encompass Literature, Informational Text, and Vocabulary.

## Student Profile

### Student Averages

Average # of school years  
8th graders are enrolled 4.5

Average # of school years  
1–7th graders spend here 2.7

Average Lower Division  
Student to Teacher Ratio 6:1

Average Lower Division  
Student to Teacher Ratio 8:1

### Student Diversity by Race

7% Asian

7% Black/African American

1% Middle Eastern

1% Native American

76% White

1% Two or More Races

6% Race Not Listed

### 2021 Graduating Class

Private High Schools 83%

Public High Schools 17%

Cumulative enrollment  
since 1998 2,810

Number of graduates  
since 2013 108





# Portrait of Success

Swift is an incredible learning environment. Our understanding of dyslexia, immersive approach, highly trained and caring teachers, total school experience, and continuous tracking of results all serve a singular and very important purpose. That is to build the educational foundation for Swift students to reach their full potential—inside and outside the classroom, around the world, now and for the rest of their lives.

The Swift Effect® empowers students in a transformative, immersive, and positive environment where students learn to:



## Leverage Strengths

Swift students learn to utilize tools and strategies that enable them to reach their full potential.



## Unlock Confidence

Swift students build a deep understanding and acceptance of their strengths and challenges, resulting in a steadfast belief in themselves.



## Advocate Relentlessly

Swift students develop the resilience and determination to speak up for themselves and their learning needs.



## Embrace Responsibility

Swift students exhibit empathy and model citizenship through their actions and words, becoming positive contributors to their communities and the world.



## Celebrate Success

Swift students move forward prepared, empowered, and ready to thrive.



# Class of 2021 Shines On!

We take a moment to reflect back to our 8th Grade Class of 20–21. All throughout last year, uncertainty seemed to overshadow everything. Students who normally looked forward to dances, athletics, and overnight field trips were, instead, dealing with unusual school restrictions (like masks and limited social interactions) and periods of virtual learning.

Despite it all, many in this group managed to stay positive, encourage peers, and better themselves. Several students were inducted into the National Junior Honor Society (NJHS) for their perseverance and hard work (Ava, Avery, Grace, Jacob, Lily). Our Shining Stars received unique recognition: an engraved star placed on our Shining Star Wall in remembrance of their time at Swift (Avery, Chase, Frank, Jacob, Jake).

We recognized students who stood out as role models (Kate for her determination and Avery for his citizenship). The Director's Award, voted on by

all faculty, was presented to Lily who demonstrated significant academic and personal growth. Lily was also the recipient of this year's NJHS Outstanding Achievement Award (OAA) which included a scholarship grant!

As the now 9th grade students move forward, their Swift family wishes them the very best on their personal and academic journey. We would remind them of the lessons their teachers worked to instill in them — to work hard, to not ever be afraid to try, and to take risks in ways that make them better students, better friends, and better citizens.

Your Swift Family believes in you! Stay positive and keep learning. And, from the famous words of Winston Churchill, “Never, never, never give up.”



Congratulations  
to our brilliant,  
Class of 2021!  
We wish you  
bright years and  
lifelong learning.



Dear Swift Family,

The 2020-21 school year will be remembered by most of the world for the Covid pandemic and the isolation and uncertainty that resulted from it. While the past year-plus could absolutely be defined by unprecedented challenges, at Swift School there is reason to look back on it with fondness. While staying on-campus and in-school for the majority of the year is usually not a reason for celebration, in 2020-21 the Swift community's relentless commitment to learning in-person is indeed a commendable accomplishment. Relentless was one of the rallying cries for the faculty last year.

In addition, our community's support of the Swift Fund reached new heights in recent history with a parent participation rate of 77%, and the completion of nearly all pledge payments for the Paving the Path capital campaign. Indeed, support for the Swift Fund facilitated upgraded technology throughout the school, from Chromebooks and iPads to 75" LCD monitors to replace projectors and smartboards, from document cameras and animation stations to robot kits, STEAM lab equipment, and internet security filters. Learning at Swift School was dramatically enhanced by the generosity of our community.

We are humbled and grateful for everyone's generosity, especially during such a challenging time for all of us. The Swift School is stronger because of your living, breathing, loving demonstration that adversity brings out the best in us.

With our sincere gratitude,

Scott Frank  
Chair, Board of Trustees

Chris Pomar  
Head of School

# New Campus Entrance In Design and Approval Phase

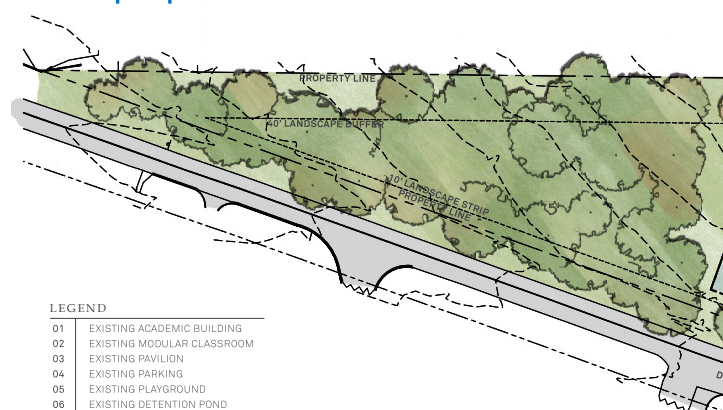

Swift School  
Master Plan  
Roswell, Georgia

Following-up on the Paving the Path campaign update from the last *Aurora* magazine, the capital improvements originally planned to reconfigure the campus entrance have been updated.

After pausing the timing of the project at the onset of the pandemic, the Swift School board of trustees chose to look at alternative ideas for a new entryway. Originally designed to cut a new entrance into the campus from Dogwood Road, that plan was rejected after the cost of extensive radical grading, detention pond relocation and retaining walls construction was deemed too expensive for the scope of this project. And in addition to other factors, the Dogwood Road entrance did not serve the school as well as initially proposed.

A new entrance to campus is being proposed that will achieve several beneficial goals while avoiding the complexity and premium cost of building uphill that the Dogwood Road entrance would necessitate:

ery



The campus “gateway” will remain on Grimes Bridge Road, but will move west, farther away from the traffic light and intersection at Dogwood Road, so the entry and exit to campus will be less disruptive to local traffic. It will employ a single entry but include two egress lanes, one for left turns and one for right turns leaving the campus. The entry and exit will no longer be reversed, so we will finally do away with our “dyslexic driveway.”

The new driveway will feature the ability to double-stack cars in the U-shaped drive at arrival and departure times, further reducing the traffic impact on Grimes Bridge Road.

This plan results in a new playground space, more than twice as large as the current playground, which will be adjacent to the student buildings and will not require crossing an active driveway to reach, ensuring safety and eliminating passerby traffic noise from Grimes Bridge Road.

Further ensuring safety, the U-shaped drive will be gated at its beginning and end, which will create a completely pedestrian border to the playground. The two gates will be opened only for AM and PM carpool use.

Visitors, deliveries, and other school-day traffic will have the ability to come and go without breaking through a carpool queue or interfering with playground access. A large net gain in on-campus parking will be realized as well.

The Plan allows for areas for future campus improvement and expansion to be accessed without the need to disrupt the school’s primary entrance and exit.

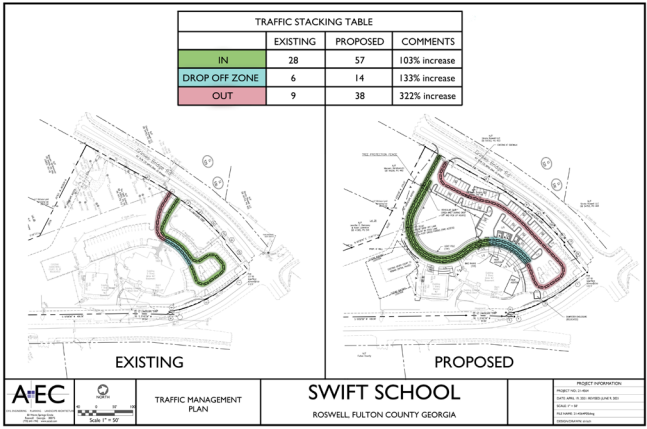

See above for a rendering of the campus master plan showing the driveway project. Pending civic approvals and materials procurement, the bulk of construction will take place in the summer of 2022 or 2023. Stay tuned for more updates, and please reach out to Head of School Chris Pomar, [cpomar@theswiftschool.org](mailto:cpomar@theswiftschool.org) with any questions about this plan or future campus development.



# Swift Supporters Shine

Thank you to everyone who made a charitable contribution to Swift from July 1, 2020 to June 30, 2021. Every effort has been made to provide complete and accurate information. If errors or omissions have occurred, please accept our most sincere apology and inform the Advancement office at [advancement@theswiftschool.org](mailto:advancement@theswiftschool.org)

## **Cosmic** \$25,000 and above

Loulie and Frank Reese

## **Galaxy** \$15,000–\$24,999

Pat and Mike Wright

## **Interstellar** \$10,000–\$14,999

Elizabeth and Kevin Brown

Mrs. Kelly Phillips and

Dr. Richard Phillips

The Coca-Cola Company

## **Celestial** \$5,000–\$9,999

Kelly Fox and John Bratton

Nancy and Karl Brown

Judie and Scott Conner

Ellyn and Paul Foltz

Jacki and John Green –

In honor of Kristen Green

Dr. and Mrs. Scott R. Solomon

Dr. Sue Straeter

## **Constellation** \$2,500–\$4,999

The Doak Family

Kathy and Dan Giannini

Erinn and Brad Goldman –

In honor of Elise Goldman

Tena and James Hargrove –

In honor of Josh Hargrove

Monica and Scott Hickman

Michele and David Hirsch

Kim Huffman

Rixey Jones and Donald Paul

Pam and Chris Pomar

The Thompson Family

Connie and Rich Wendlek

## **Nova** \$1,500–\$2,499

Automatic Data Processing Inc

Laura and Jay Bonds

Barbara Doran

Marie and Scott Frank

The Herndon Family

Laine and Scott Kilburn

Tracie and Adam Maloney

Pfizer

Josie Redwine

Nell and Pat Thomas –

In honor of Patrick Griffith

The Von Eyser Family

Mary Welch

## **Meteor** \$1,000–\$1,499

Rebecca and Brian Block

Mr. and Mrs. Jeff Block –

In honor of Caroline

and Davis Block

Tiffany and Craig Charette

Daniela Demaria

Kathryn and Kris Fletcher

Eric French and Summer Viljoen

Karrie and James Fuerst

Ms. Janice Marks

The Grimes Family

Nanci and Robert Halper

Regan and Jeffrey Kudlata

Lexis Nexis

The Maynard Family

Reed and Randall McCroskey

Gina and Nicholas Murray

Roberta and Eric Osorio

Alicia LoCicero and Andre Padial

The Pena Peguero Family

Pitney-Bowes

Connie and Andrew Pope

Diana and Barry Simmons

Sophia and Jim Tidwell

Mr. and Mrs. Bo Trotter –

In honor of Collier Brown

Turner Broadcasting

Meredith Weaver

Dana and Andrew Webber

## **Aurora** \$500–\$999

Galit and Michael Allemeier

Amber and Chad Bowman

Ms. Kathryn O. Captain

The Colbert Family

Mary Jo Corsetti

Mr. and Mrs. Robert Dietz –

In honor of Katherine Herr

Dr. Caroline and Dr. Andrew Dott

Kim and Ken Dunwody

Fannie Mae

The Fleming Family

Mr. and Mrs. Larry Gruber

The Guy Family –

In honor of Joe Guy

The Herr Family

Karen and Grace Holt

Dr. Stephen Kloder

Sarah Vance and Matthew Knetchel –

In honor of Abigayle Grace Knetchel

Lands' End School Rewards

Kimberly and David Lucas

Claire and Wes McLean

Paloma and Jose Medina

Jennifer and Ben Owens

The Paz Family

Gloria and Charlie Pollack  
 The Runnels Family –  
   In honor of Anna Runnels  
 The Schnell Family–  
   In honor of Henry Schnell  
 Jayne Waters  
 Mr. and Mrs. James C. Whitley –  
   In honor of Ben  
   and Grace Gibson  
 GA and DK Wood –  
   In honor of Ella Rumble

**Astronomer** Up to \$499

Anonymous ①  
 Michele and Lee Allum  
 Amazon Smile  
 Mrs. Eunice Anderson  
 Ellen and David Ascher  
 Grace Battle –  
   In honor of Will Battle  
 Roni and Jim Battoglia  
 Jessica and Grant Belden –  
   In honor of Asher and Ava Belden  
 Carla and Scott Birnbaum –  
   In honor of Hannah Birnbaum  
 Amy and Chris Bitler –  
   In honor of Zach and Tyler Bitler  
 The Blumentritt Family  
 Tammy and Robert Bogdan –  
   In honor of Julia Bogdan  
 Grae and Joshua Brown –  
   In honor of Bennett Brown  
 Kathy and Bob Brown  
 Christine and Mark Buckis –  
   In honor of Rich Wendlek  
 Megan and Fred Carty  
 Stephanie and Jim Charanis  
 Ashley and Joel Charlton  
 Donna and Sam Cherry  
 Mr. R. W. Chick  
 Mr. and Mrs. Patrick Cline  
 Nancy Cochran

Jessica and Tye Colclough –  
   In honor of Landon Colclough  
 Clarence and Barbara Collins  
 Jessica Cramer  
 Joe, Ginger and Cat Crane  
 Ken and Paige Cressman  
 Marisa R. Crissey  
 Mr. and Mrs. Eric Cross  
 Lindsey and Tyler Daniell  
 Amber and Bryan Davidson –  
   In honor of Aria Davidson  
 Tammy Davis  
 Denise and Seth Deitchman  
 Christy and Mike Dickson  
 Mary Jane Dillon  
 Jason Dorris –  
   In honor of Jacob Dorris  
 Jennifer Dorris –  
   In honor of Jacob Dorris  
 The Doulfikhar Family  
 Mary Lu and Jack Duke  
 Tiffany and Randall Duncan  
 Andi and David Dunkerley  
 Julie Eden  
 Amanda and Gil Edwards  
 Mrs. Katherine Escobedo –  
   In honor of Liam R. Warren  
 Farand Espaillat  
 Robin and Jeff Farmer  
 The Felix Family  
 Peggy Fitzgerald  
 Emily and Brian Ford  
 Mr. and Mrs. Jerry Fox  
 Shannon and Thierry Francois  
 Amy and Michael Garcia  
 General Mills–Box Tops  
 Kathryn Gibson  
 Rachel Grade  
 Dr. and Mrs. Marc Greenstein –  
   In honor of Ethan Greenstein  
 Elizabeth Goldberg and  
 Scott Greenwald

Ambra and Andrew Groslimond  
 Lindsey and Jay Guidry  
 Hartford Fire Insurance Company  
 Ms. Deirdre Hastings –  
   In honor of Emma Hastings  
 Kerra Hicks and Edward Norwood  
 Mrs. Mary A. O’Keefe Hoag –  
   In honor of Elise A. Goldman  
 Muriel Huttenbach  
 IBM Matching Grants Program  
 Sandee Isaacs  
 Harriet and Brice Ivy  
 Stacey Jackson  
 The Janowski Family  
 Suzanne and David Jennings –  
   In honor of Cameron Jennings  
 Mr. and Mrs. Philip Jennings  
 Beth and Nate Johnson  
 Ron and Mike Johnson –  
   In honor of Camden Johnson  
 Ms. Zina Jordan  
 Suja and Michael Joseph  
 Melissa and Dave Jozefov  
 Lynn and Jeff Kaplin  
 Alison Katz  
 Keiley Listermann  
 Andrea and Bobby Killingsworth  
 Deborah Kloder  
 Kathy and Steve Knetchel  
 Katherine and Larry Knight  
 Katy and Jeff Kopach  
 Kroger  
 The Lanes  
 Leanne and James Lapp  
 Beth and Micah Levin –  
   In honor of Hailey Levin  
 Lifetouch  
 Princess and Dean London  
 Lou and Silas Lyon  
 Michael Lytle  
 Rachel and Mark Mandell



Merrilee and Jon Martin –  
In honor of Grant Garcia  
Kristin and Steve Martin  
Greta Massey  
Sissy and Jonathan Massie  
Amanda and Daniel McCormick  
Jill A. McGuire  
The McSorley Family  
Jennifer and Jeff Mello  
Mandy Menshon  
Carol and Laurence Miller –  
In honor of Claire Farmer  
Martha and Chris Moore  
Jane and Barry Moss  
Michael and Victoria Napolitano  
The Neuringer Family  
Ms. Rochelle L. Neuringer –  
In honor of Addie Neuringer  
Lea and Scott Niederhauser  
Heather and Brian Niemeyer  
Catherine Nixon  
Kate and Mike Norris  
Sarah and Tim O'Grady  
Linda and Jeff Pace  
Lauren Peet  
Mr. and Mrs. Phil Pennell –  
In honor of Bennett Brown  
Mr. and Mrs. John Patrick Pignetti  
Robert and Saenia Pittman  
Hallie Poindexter  
Judge and Mrs. Tom Pope  
Jen and Jeff Porfiro –  
In honor of Joey Porfiro  
Keith Retterer  
Retta Retterer  
Mrs. Mary Ann Richmond –  
In honor of Cameron Jennings  
Jenny Rieck  
Angela and David Robertson  
Randa and Cedric Robinson –  
In honor of Randall Robinson

Bonnie Ryan  
Kelei and Jason Sabatino  
Stasy and Karl Schmidt –  
In honor of Joe Schmidt  
Dr. Robert J. Schwensfeir Jr.–  
In honor of Elise A. Goldman  
Katie and Michael Sklar  
Mr. Donald W. Smith  
Amy and Justin Snyder  
The Spina Family  
Kathy and Mark Sweeney  
The Tai Family  
Colleen and Eric Thaiss –  
In honor of Caroline Thaiss  
Bo Thomas  
Suzi and Ellis Thorp  
Mr. and Mrs. Thorp –  
In honor of Olivia Thorp  
Rayne and Doug Towns  
Kristen and Ryan Van Arnam  
Mr. and Mrs. Phil Vance –  
In honor of Abigayle Grace  
Knetchel  
Emily and Eric Volpe –  
In honor of Charlie and Henry  
Volpe  
Voya Financial  
Maxann and Archie Wanamaker  
Eliza and Aaron Warmus  
Jen and Michael Warren  
Shelby L. Warren  
Kelly Weaver  
Dr. and Mrs. Larry S. Webber –  
In honor of Lindsey Webber  
Karen and Keith Wellman  
Leslie Whitten  
Stacey Wronker  
Heather Hastings and  
Christian Zsilavetz

### Grandparent Donors + Their Grandchildren

Mrs. Eunice Anderson  
*Harvin Pittman*  
Mr. and Mrs. Jeff Block  
*Caroline Block*  
*Davis Block*  
Kathy and Bob Brown  
*Conrad Brown*  
Ms. Kathryn O. Captain  
*Avery Pope*  
Nancy Cochran  
*Ella French*  
Clarence and Barbara Collins  
*Caroline Hegwood*  
Mr. and Mrs. Robert Dietz  
*Katherine Herr*  
Mary Jane Dillon  
*Lucy Dillon*  
*Owen Dillon*  
Dr. Caroline and Dr. Andrew  
Dott  
*Alex Jackson*  
Mrs. Katherine Escobedo  
*Liam R. Warren*  
Mr. and Mrs. Jerry Fox  
*Elizabeth Bratton*  
*Grayson Bratton*  
Kathy and Dan Giannini  
*Charlie Volpe*  
*Henry Volpe*  
Mr. and Mrs. Larry Gruber  
*Teagan Thompson*  
Ms. Deirdre Hastings  
*Emma Hastings*  
Mrs. Mary A. O'Keefe Hoag  
*Elise Goldman*  
Mr. and Mrs. Philip Jennings  
*Cameron Jennings*  
Ron and Mike Johnson  
*Camden Johnson*  
Ms. Zina Jordan  
*Elise Goldman*

Andrea and Bobby Killingsworth

*Mary Emma Hicks*

Katherine and Larry Knight

*Weston McLean*

Merrilee and Jon Martin

*Grant Garcia*

Carol and Laurence Miller

*Claire Farmer*

Jane and Barry Moss

*Harper Mandell*

Ms. Rochelle L. Neuringer

*Addie Neuringer*

Mr. and Mrs. Phil Pennell

*Bennett Brown*

Judge and Mrs. Tom Pope

*Avery Pope*

Mrs. Mary Ann Richmond

*Cameron Jennings*

Dr. Sue Straeter

*Chloe Cappola*

Nell and Pat Thomas

*Patrick Griffith*

Mr. and Mrs. Thorp

*Olivia Thorp*

Mr. and Mrs. Bo Trotter

*Collier Brown*

Mr. and Mrs. Phil Vance

*Abigayle Grace Knetchel*

Dr. and Mrs. Larry S. Webber

*Lindsey Webber*

Mr. and Mrs. James C. Whitley

*Ben Gibson*

*Grace Gibson*

GA and DK Wood

*Ella Rumpel*

#### Gifts Made In Memory of Ronald D. Hegwood

Clarence and Barbara Collins

Mary Lu and Jack Duke

Peggy Fitzgerald

Muriel Huttenbach

Katy and Jeff Kopach

Lou and Silas Lyon

Keith Retterer

Retta Retterer

Bo Thomas

Kelly Weaver

#### Gifts Made In Memory of Charles Russell Hopson

Mr. R. W. Chick

Kathy and Steve Knetchel

Mr. Donald W. Smith

#### Corporations And Matching Gift Companies

Amazon Smile

Automatic Data Processing Inc

Fannie Mae

General Mills–Box Tops

Hartford Fire Insurance

Company

IBM Matching Grants Program

Kroger

Lands' End School Rewards

Lexis Nexis

Lifetouch

Pfizer

Pitney–Bowes

The Coca–Cola Company

Turner Broadcasting

Voya Financial

## Rich and Kelly Phillips Tuition Assistance Fund

Established in 2020 by Emeritus Board Chair Dr. Richard Phillips and his wife, Kelly, Swift School's first named endowment fund creates a permanent source of income for the school's financial assistance program. Recipients will have demonstrated financial need as determined by the school. Proceeds from the fund help keep the school accessible to students of all financial backgrounds.





Thank you to the Swift School community for participating in the Georgia GOAL scholarship program, allowing deserving Georgia students to attend Swift School. Swift appreciates those who continue to make this tuition assistance program strong and choose to provide a child with a life-changing education at Swift.

For more information on GOAL including information on how to participate, please visit [www.goalscholarship.org](http://www.goalscholarship.org)

# GEORGIA GOAL

## SCHOLARSHIP PROGRAM, INC.

### GOAL 2021 Donors

Rebecca and Brian Block  
 Nancy and David Brown  
 Laura Ries and Scott Brown  
 Margaret and Patrick Carroll  
 Judie and Scott Conner  
 Denise and Seth Deitchman  
 Jennifer and Patrick Doak  
 Tiffany and Randall Duncan  
 Brenda Morales and Ashby Foltz  
 Elynn and Paul Foltz  
 Marie and Scott Frank  
 Laura and Andrew Fuqua  
 Karrie and James Fuerst  
 Kathy and Dan Giannini  
 Erinn and Brad Goldman  
 Susanne and Robert Gray  
 Faith and Marc Greenstein  
 Donna and Doug Henderson  
 Monica and Scott Hickman  
 Beth Salisbury and  
 Nathaniel Johnson  
 Michael and Ronald Johnson  
 Regan and Jeffrey Kudlata  
 Georgina and Bradley Lewis  
 Kristin and Steve Martin  
 Ellen and Kenneth Medved  
 Judith and Robert Murphy  
 Scott and Lea Niederhauser  
 Shayna and Anthony Nuzzo  
 Kristine and Mark Parsons  
 Rixey Jones and Donald Paul  
 Rosemarie and Herbert Paul  
 Kelly and Richard Phillips  
 Loulie and Frank Reese  
 Elizabeth Rohan and  
 Stephen Shanahan  
 Susan and Stephen Slifer  
 Kathryn and Scott Solomon  
 Maria and Alvaro Teran  
 Laura Green and John Thielman  
 Rayne and Douglas Towns  
 Catherine and James Trotter  
 Jodi and Todd Turnquist  
 Amy and Richard Van Haveren  
 Sheri and Michael Verroi  
 Erica Creahan and Michael Von Eyser  
 Eliza and Aaron Warmus  
 Dana and Howard Webber  
 Laura and Stephen Willson  
 Pat and Mike Wright

### GOAL 2022 Donors\*

Rebecca and Brian Block  
 Lindsey and Matthew Bronikowski  
 Nancy and David Brown  
 Laura Ries and Scott Brown  
 Margaret and Patrick Carroll  
 Judie and Scott Conner  
 Marion and Matthew Cooper  
 Jacob Davis  
 Denise and Seth Deitchman  
 English and Blake DiStefano  
 Brenda Morales and Ashby Foltz  
 Elynn and Paul Foltz  
 Marie and Scott Frank  
 Karrie and James Fuerst  
 Kathy and Dan Giannini  
 Erinn and Brad Goldman  
 Susanne and Robert Gray  
 Faith and Marc Greenstein  
 Tena and James Hargrove  
 Monica and Scott Hickman  
 Beth Salisbury and  
 Nathaniel Johnson  
 Michael and Ronald Johnson  
 Regan and Jeffrey Kudlata  
 Kristin and Steve Martin  
 Claire and Troy McLean  
 Shayna and Anthony Nuzzo  
 Jennifer and Benjamin Owens  
 Kristine and Mark Parsons  
 Rixey Jones and Donald Paul  
 Rosemarie and Herbert Paul  
 Maite Miranda-Paz  
 and Ezequiel Paz  
 Loulie and Frank Reese  
 Elizabeth Rohan and  
 Stephen Shanahan  
 Josie Redwine and Reza Tajer  
 Maria and Alvaro Teran  
 Laura Green and John Thielman  
 Rayne and Douglas Towns  
 Catherine and James Trotter  
 Jodi and Todd Turnquist  
 Amy and Richard Van Haveren  
 Sheri and Michael Verroi  
 Erica Creahan and Michael Von Eyser  
 Eliza and Aaron Warmus  
 Joseph Waters  
 Dana and Howard Webber  
 Donna and George Wood  
 Pat and Mike Wright

*\*Names reflect applications made prior to November 2021*

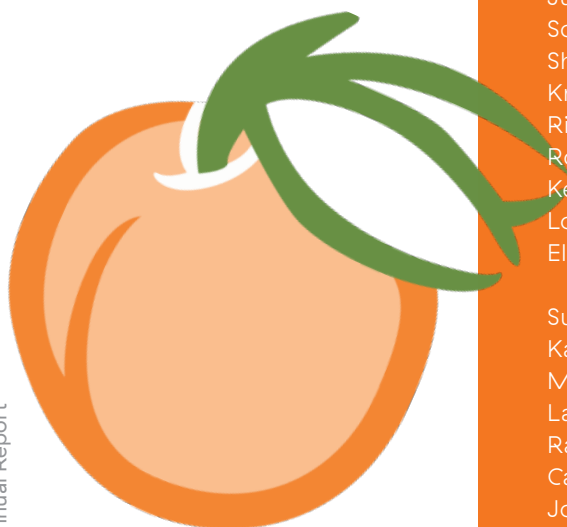





“Swift saved us all. The public school was not giving her the support she needed. Her level of frustration was off the charts. The stress on our family was too much. Swift worked with us when she was struggling, built her confidence, and gave her the support she needed to be successful.”

—Glenda, whose daughter attended Swift from 4th to 8th grade





300 Grimes Bridge Road  
Roswell, GA 30075

[theswiftschool.org](http://theswiftschool.org)

Presorted  
Standard  
US Postage  
PAID  
Permit #3259  
Atlanta, GA

#### Board of Trustees

Scott Frank, Chair  
Scott Conner, Vice Chair  
Josie Redwine, Secretary  
Michael Wright, Treasurer  
Elizabeth Brown  
Kristen Delaney  
Kelly Fox  
Daniel Giannini  
John F. Green  
Teka Grimes  
Linda Herndon  
Kim Huffman  
G. Scott Kilburn  
Donald Paul  
Sue M. Straeter, Ed.D  
Robert Gray, Emeritus  
Jeff Kudlata, Emeritus  
Richard Phillips, Emeritus  
Gail Swift, Emerita

At Swift, students acquire the gift of literacy through training and practice. Surrounded by caring teachers and supportive peers, students are taught to embrace who they are and nurture their innate gifts. They gain the knowledge, skills, and confidence to thrive in life. **Success with dyslexia starts here.**

