

40% < 10' HIGH

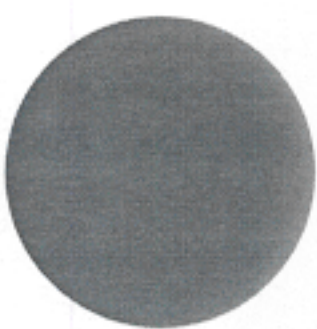

40% 10'-20' HIGH

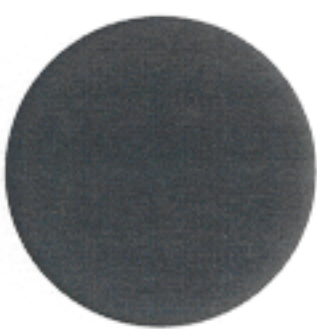

40% > 20' HIGH



>15% BUT <20%

SLOPE ANALYSIS NOTE:
THE APPROXIMATE 40% AND GREATER
SLOPE WAS DETERMINED USING
AUTODESK'S "CIVIL 3D" VERSION 2016



NORTH



SCALE: 1" = 20'

BASIS OF BEARINGS: WASHINGTON
NORTH ZONE NAD '83 (TALUS DIV. A
VOL 201, PGS 38-50)

VERTICAL DATUM
BENCHMARK BASED ON A DAVID EVANS AND ASSOCIATES SURVEY FOR KING
COUNTY AND THE CITY OF ISSAQUAH IN 1989. BENCHMARK HELD WAS
STATION "TELV". ORIGINAL ELEVATION (NGVD 29) = 502.90 HAS BEEN
CONVERTED TO NAVD 88 BY CORPSCON v5.11. CONVERTED ELEVATION OF
STATION "TELV" = 506.52 (NAVD 88)

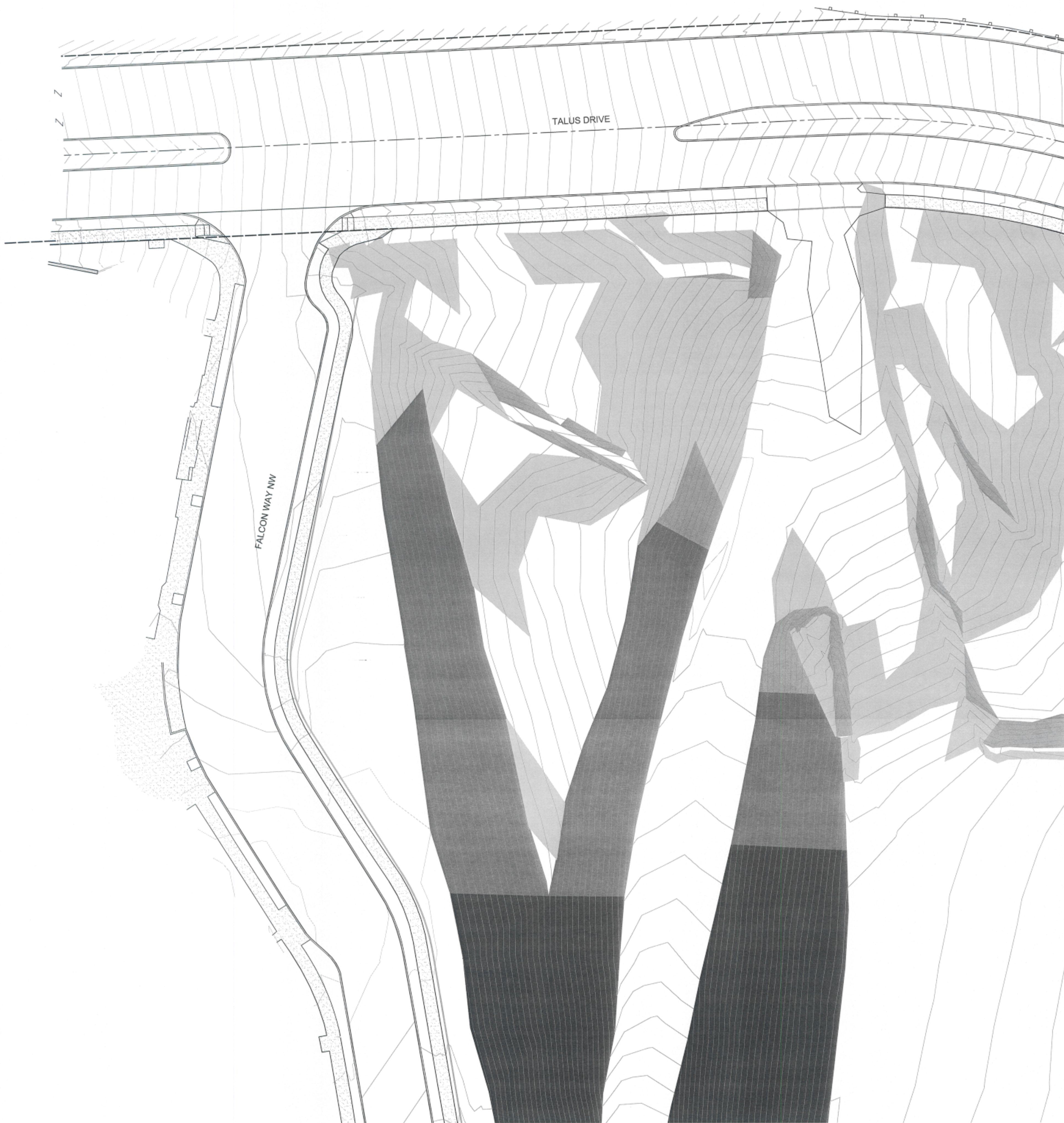

SEE SHEET 3 OF 5

SEE SHEET 2 OF 5

SEE SHEET 4 OF 5

OF
5

1

SHEET NO.

ISDX0000-0001

PROJECT NO.

FIRST SUBMITTAL DATE: 10/22/18

SCALE: HORIZ. 1" = 20' VERT.:

STAMP NOT VALID
UNLESS SIGNED AND DATED



7-2-19

REVIEWED BY:		DATE	REVISION
▲	NO.	DATE	REVISION
▲	1	12/05/18	ADDRESSED CLIENT COMMENTS / ADDED APPROX 40% SLOPE
▲	2	12/05/18	ADDRESSED CLIENT COMMENTS / ADDED APPROX 40% SLOPE
▲	3	12/19/18	ADDED TREE IDENTIFICATION NUMBERS PER CLIENT REQUEST
▲	4	1/08/19	REVISED TITLE NOTES PER UPDATED TITLE REPORT
▲	5	7/01/19	UPDATED 40% SLOPE ANALYSIS (ADDED SHEETS 1-5 OF 5)

DESIGNED:

DATE:		BY	CK
12/05/18	KBPE	DAR	
12/19/18	KBPE	DAR	
1/08/19	KBPE	DAR	
7/01/19	KBPE	DAR	

CADD: KBPE

PARCEL 17B
40% SLOPE ANALYSIS

ISSAQUAH SCHOOL DISTRICT
TALUS 17B PROPERTY

CITY OF ISSAQUAH,

WASHINGTON



DAVID EVANS
AND ASSOCIATES INC.
20300 Woodinville Snohomish Rd NE
Woodinville Washington 98072
Phone: 425.415.2000



STAMP NOT VALID
UNLESS SIGNED AND DATED

FIRST SUBMITTAL DATE: 10/22/18
SCALE: HORIZ. 1"=20' VERT. 1"=20'

PROJECT NO.
ISDX0000-0001

SHEET NO.
2



7-2-19

REVIEWED BY:		DATE:	BY	CK
NO.	DATE	REVISION		
1	12/05/18	ADDRESSED CLIENT COMMENTS / ADDED APPROX 40% SLOPE	KEP	DAR
2	12/05/18	ADDRESSED CLIENT COMMENTS / ADDED APPROX 40% SLOPE	KEP	DAR
3	12/19/18	ADDED THREE IDENTIFICATION NUMBERS PER CLIENT REQUEST	KEP	DAR
4	1/08/19	REVISED TITLE NOTES PER UPDATED TITLE REPORT	KEP	DAR
5	7/01/19	UPDATED 40% SLOPE ANALYSIS (ADDED SHEETS 1-5 OF 5)	KEP	DAR

DESIGNED:

CADD: KBP

PARCEL 17B
40% SLOPE ANALYSIS

ISSAQUAH SCHOOL DISTRICT
TALUS 17B PROPERTY

CITY OF ISSAQUAH, WASHINGTON



DAVID EVANS
AND ASSOCIATES INC.
20300 Woodville Snohomish Rd NE
Woodinville Washington 98072
Phone: 425.415.2000

40% < 10' HIGH

40% 10'-20' HIGH

40% > 20' HIGH

>15% BUT <20%

SLOPE ANALYSIS NOTE:
THE APPROXIMATE 40% AND GREATER
SLOPE WAS DETERMINED USING
AUTODESK'S "CIVIL 3D" VERSION 2016



BASIS OF BEARINGS: WASHINGTON
NORTH ZONE NAD '83 (TALUS DIV. A
VOL 201, PGS 38-50)

VERTICAL DATUM
BENCHMARK BASED ON A DAVID EVANS AND ASSOCIATES SURVEY FOR KING
COUNTY AND THE CITY OF ISSAQUAH IN 1989. BENCHMARK HELD WAS
STATION "TELV". ORIGINAL ELEVATION (NGVD 29) = 502.90 HAS BEEN
CONVERTED TO NAVD 88 BY CORPSCON v5.11. CONVERTED ELEVATION OF
STATION "TELV" = 506.52 (NAVD 88)

SEE SHEET 1 OF 5

FALCON WAY NW

FALCON WAY NW

SEE SHEET 2 OF 5

POR SE 1/4 SEC 29, TWP 24 N, RGE 6 E, W.M.

5 FO 4 LEENS SEE

OF
5

3

SHEET NO.

ISDX0000-0001

PROJECT NO.

FIRST SUBMITTAL DATE: 10/22/18
SCALE: HORIZ. 1"=20' VERT.:

STAMP NOT VALID
UNLESS SIGNED AND DATED



7-2-18

REVIEWED BY:		DATE:	BY	CK
NO.	DATE	REVISION		
1	12/05/18	ADDRESSED CLIENT COMMENTS / ADDED APPROX 40% SLOPE	KBP	DAR
2	12/05/18	ADDRESSED CLIENT COMMENTS / ADDED APPROX 40% SLOPE	KBP	DAR
3	12/19/18	ADDED TREE IDENTIFICATION NUMBERS PER CLIENT REQUEST	KBP	DAR
4	1/08/19	REVISED TITLE NOTES PER UPDATED TITLE REPORT	KBP	DAR
5	7/01/19	UPDATED 40% SLOPE ANALYSIS (ADDED SHEETS 1-5 OF 5)	KBP	DAR

DESIGNED:

CADD: KBP

PARCEL 17B
40% SLOPE ANALYSIS

ISSAQUAH SCHOOL DISTRICT
TALUS 17B PROPERTY

CITY OF ISSAQUAH,

WASHINGTON



DAVID EVANS
AND ASSOCIATES INC.
20300 Woodinville Snohomish Rd NE
Woodinville Washington 98072
Phone: 425.415.2000

SEE SHEET 2 OF 5

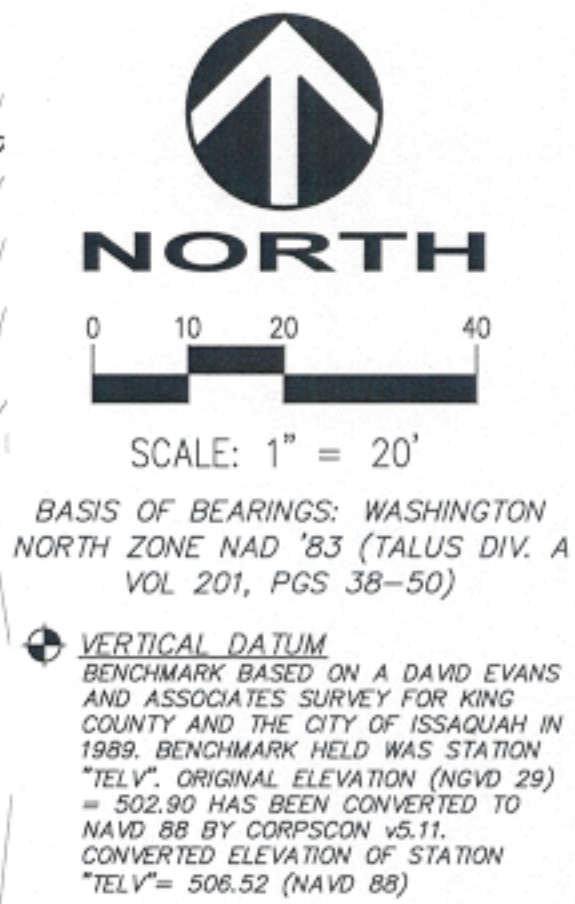
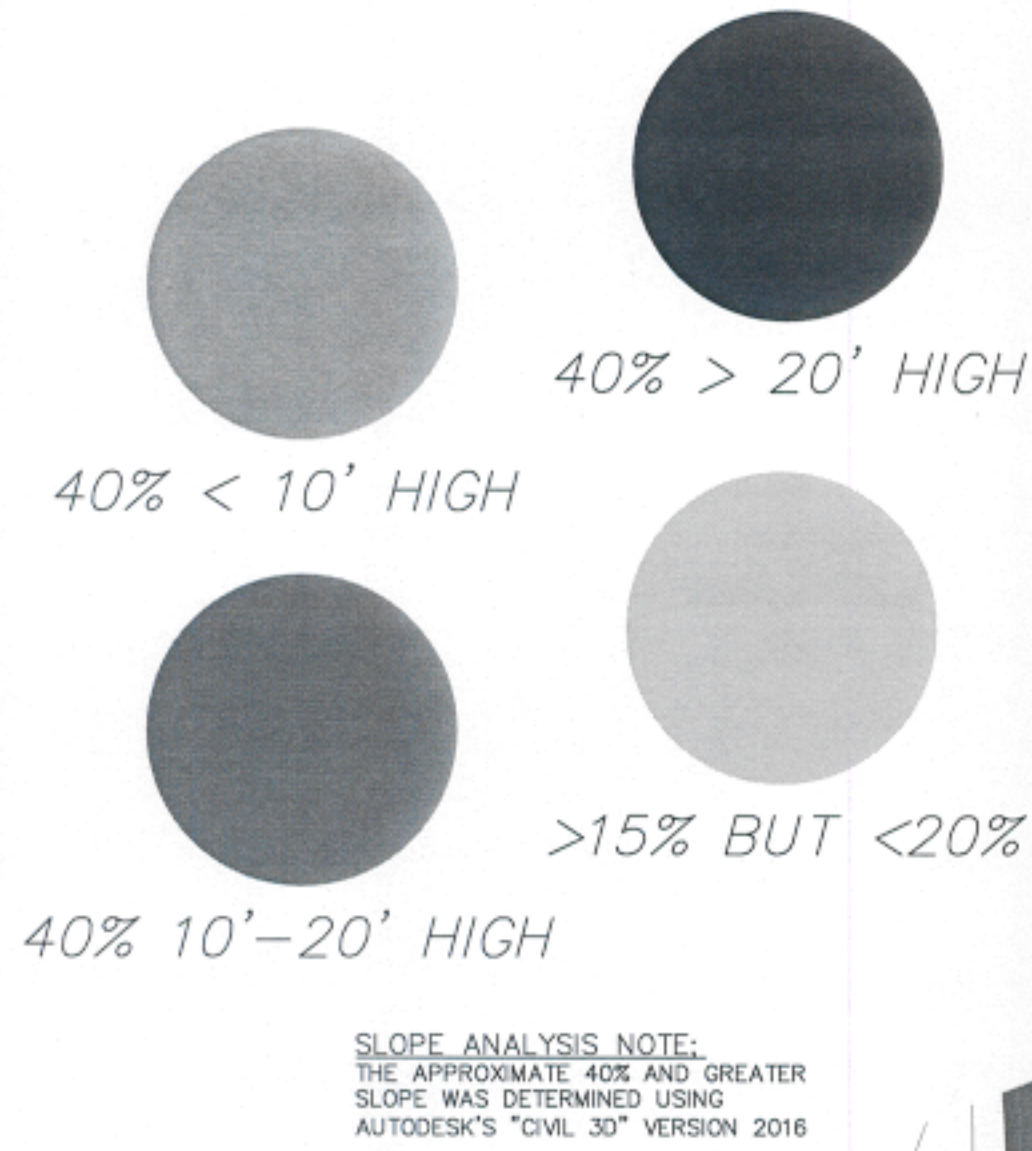

SEE SHEET 3 OF 5

POR SE 1/4 SEC 29, TWP 24 N, RGE 6 E, W.M. 5 FO 9 LEENS 3ES



OF 5

4

STAMP NOT VALID
UNLESS SIGNED AND DATED

FIRST SUBMITTAL DATE: 10/22/18

SCALE: HORIZ. 1" = 20' VERT.:

PROJECT NO.
ISDX0000-0001

SHEET NO.

REVIEWED BY:

NO.	DATE	REVISION
1	12/05/18	ADDRESSED CLIENT COMMENTS / ADDED APPROX 40% SLOPE
2	12/05/18	ADDRESSED CLIENT COMMENTS / ADDED APPROX 40% SLOPE
3	12/19/18	ADDED TREE IDENTIFICATION NUMBERS PER CLIENT REQUEST
4	1/08/19	REVISED TITLE NOTES PER UPDATED TITLE REPORT
5	7/01/19	UPDATED 40% SLOPE ANALYSIS (ADDED SHEETS 1-5 OF 5)

DATE:

BY	CK
KBP	DAR
KBP	DAR
KBP	DAR
KBP	DAR
KBP	DAR

DESIGNED:

CADD: KBP

PARCEL 17B
40% SLOPE ANALYSIS

ISSAQUAH SCHOOL DISTRICT
TALUS 17B PROPERTY

CITY OF ISSAQUAH,

WASHINGTON

DAVID EVANS
AND ASSOCIATES INC.

20300 Woodinville Snohomish Rd NE
Woodinville Washington 98072
Phone: 425.415.2000

40% < 10' HIGH 40% 10'-20' HIGH 40% > 20' HIGH

>15% BUT <20%

SLOPE ANALYSIS NOTE:
THE APPROXIMATE 40% AND GREATER
SLOPE WAS DETERMINED USING
AUTODESK'S "CIVIL 3D" VERSION 2016



SCALE: 1" = 20'

BASIS OF BEARINGS: WASHINGTON
NORTH ZONE NAD '83 (TALUS DIV. A
VOL 201, PGS 38-50)

VERTICAL DATUM
BENCHMARK BASED ON A DAVID EVANS AND ASSOCIATES SURVEY FOR KING
COUNTY AND THE CITY OF ISSAQUAH IN 1989. BENCHMARK HELD WAS
STATION "TEL". ORIGINAL ELEVATION (NGVD 29) = 502.90 HAS BEEN
CONVERTED TO NAVD 88 BY CORPSCON v5.11. CONVERTED ELEVATION OF
STATION "TEL" = 506.52 (NAVD 88)

RENTON - ISSAQUAH ROAD (SR 900)

POR SE 1/4 SEC 29, TWP 24 N, RGE 6 E, W.M.

SEE SHEET 4 OF 5

SEE SHEET 2 OF 5

SEE SHEET 7 OF 7

STAMP NOT VALID
UNLESS SIGNED AND DATED
FIRST SIGNATURE DATE: 10/22/18
SCALE: HORIZ. 1" = 20' VERT. 1" = 20'
PROJECT NO.
ISDX0000-0001
SHEET NO.
5



REVIEWED BY:			DATE:		BY	CK
NO.	DATE	REVISION				
1	12/05/18	ADDRESSED CLIENT COMMENTS / ADDED APPROX 40% SLOPE	KBP	DAR		
2	12/05/18	ADDRESSED CLIENT COMMENTS / ADDED APPROX 40% SLOPE	KBP	DAR		
3	12/19/18	ADDED TREE IDENTIFICATION NUMBERS PER CLIENT REQUEST	KBP	DAR		
4	1/08/19	REVISED TITLE NOTES PER UPDATED TITLE REPORT	KBP	DAR		
5	7/01/19	UPDATED 40% SLOPE ANALYSIS (ADDED SHEETS 1-5 OF 5)	KBP	DAR		

DESIGNED:

CADD: KBP

PARCEL 17B
40% SLOPE ANALYSIS

ISSAQUAH SCHOOL DISTRICT
TALUS 17B PROPERTY

CITY OF ISSAQUAH,

WASHINGTON



DAVID EVANS
AND ASSOCIATES INC.
20300 Woodinville Snohomish Rd NE
Woodinville Washington 98072
Phone: 425.415.2000