

**Kings Canyon Unified School District**  
Trustee Area Redistricting - Scenario 1

ODELL Planning & Research, Inc.  
Environmental Planning • School Facility Planning • Demographics

Total Population	46,938
Ideal	6,705
Deviation Range	524
Total Deviation %	7.8%

	TA1	TA2	TA3	TA4	TA5	TA6	TA7
Population	6,675	6,978	6,456	6,454	6,752	6,780	6,843
Deviation	-30	273	-249	-251	47	75	138
Deviation %	-0.5%	3.9%	-3.9%	-3.9%	0.7%	1.1%	2.0%

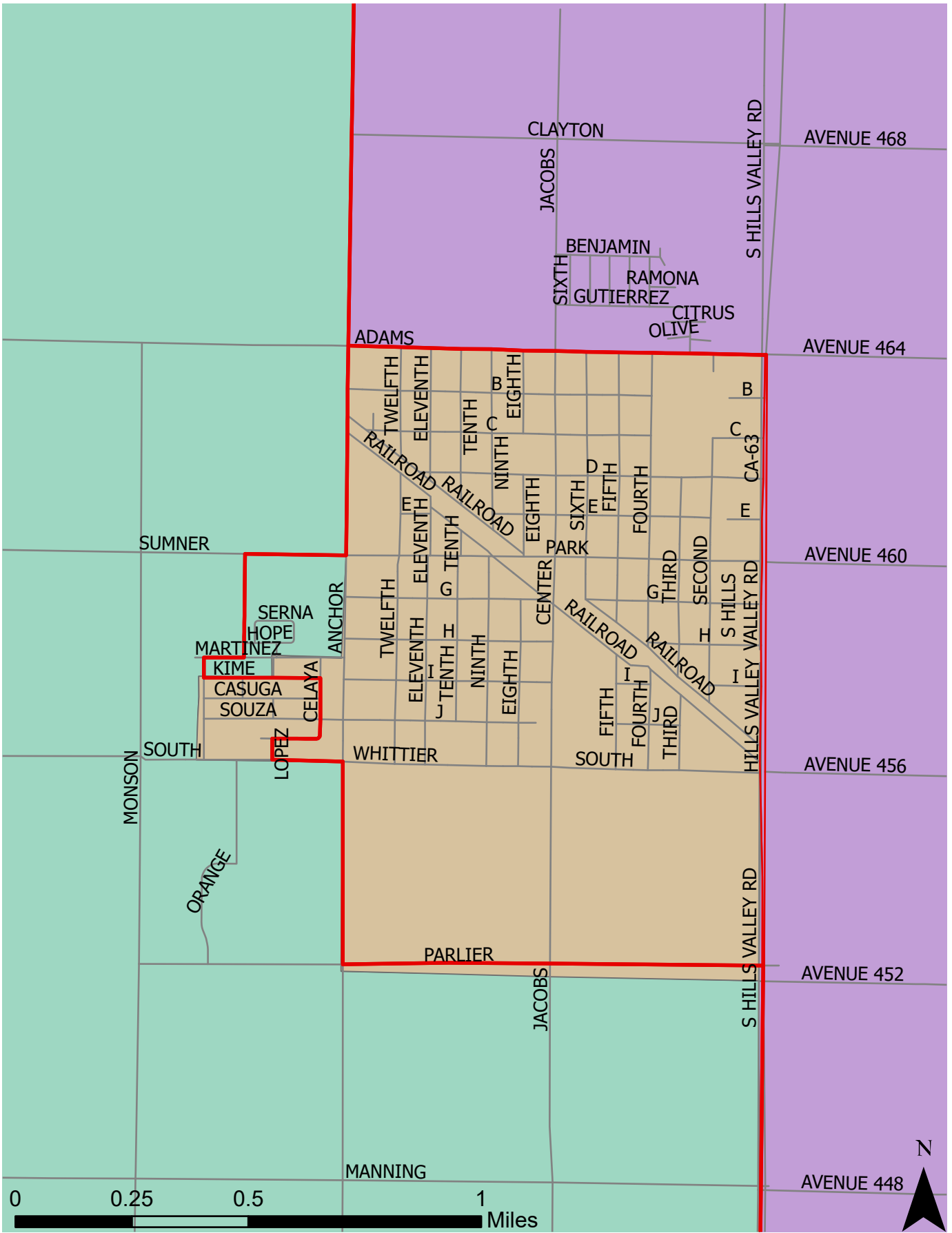
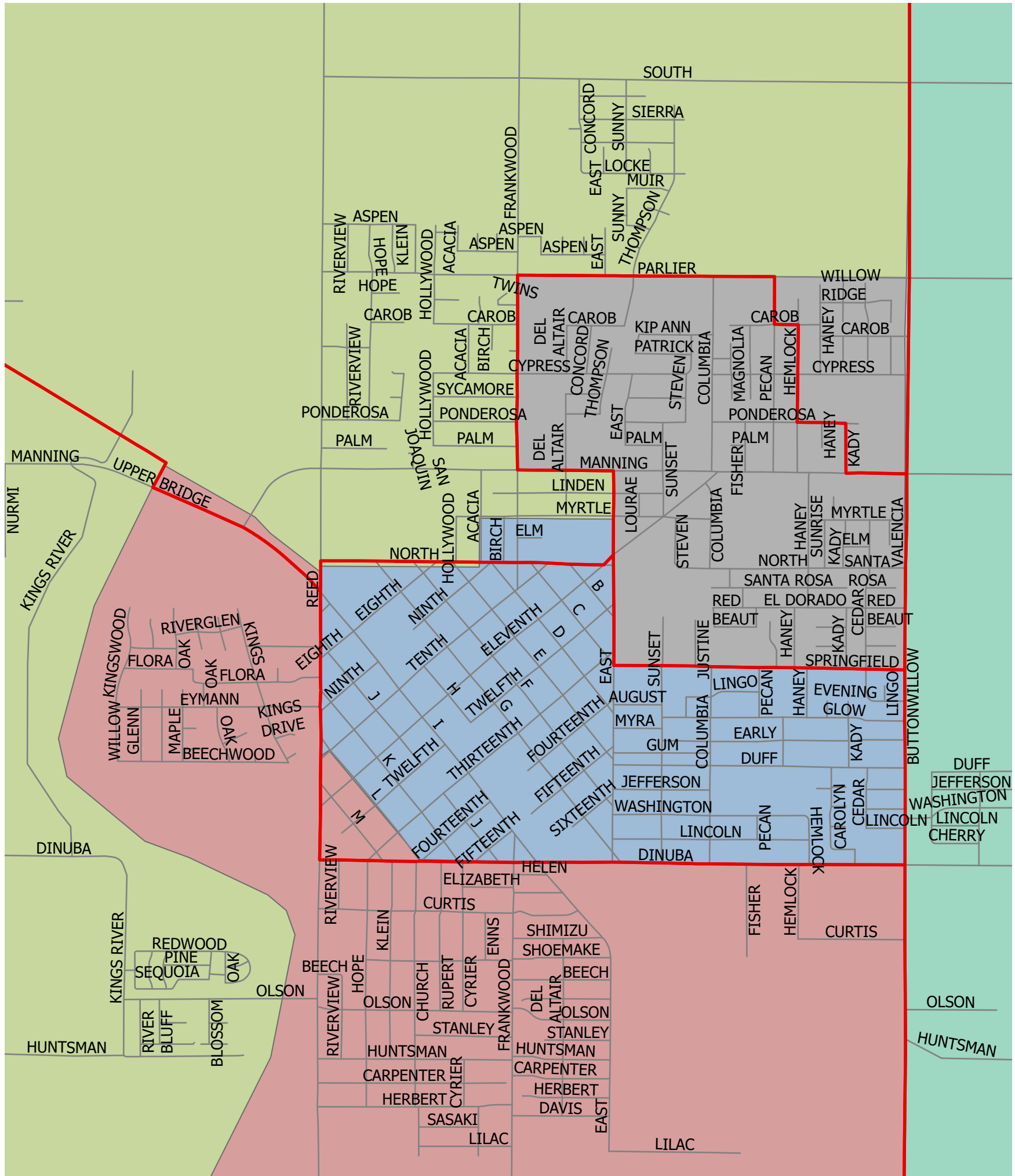

- Existing Trustee Areas
- Trustee Area 1
- Trustee Area 2
- Trustee Area 3
- Trustee Area 4
- Trustee Area 5
- Trustee Area 6
- Trustee Area 7

**Kings Canyon Unified School District**  
**Trustee Area Redistricting - Scenario 1**