

# Facilities, Planning and Construction

## December 9, 2019



# Haslet Renovation to Administrative Annex

Renovation to include the following departments:

- Parent Involvement & Student/Family Support
- Career & Technical Education
- Curriculum Coordinators and Professional Development
- Curriculum Warehouse
- Special Ed – Secondary AIM

# Haslet Renovation to Administrative Annex

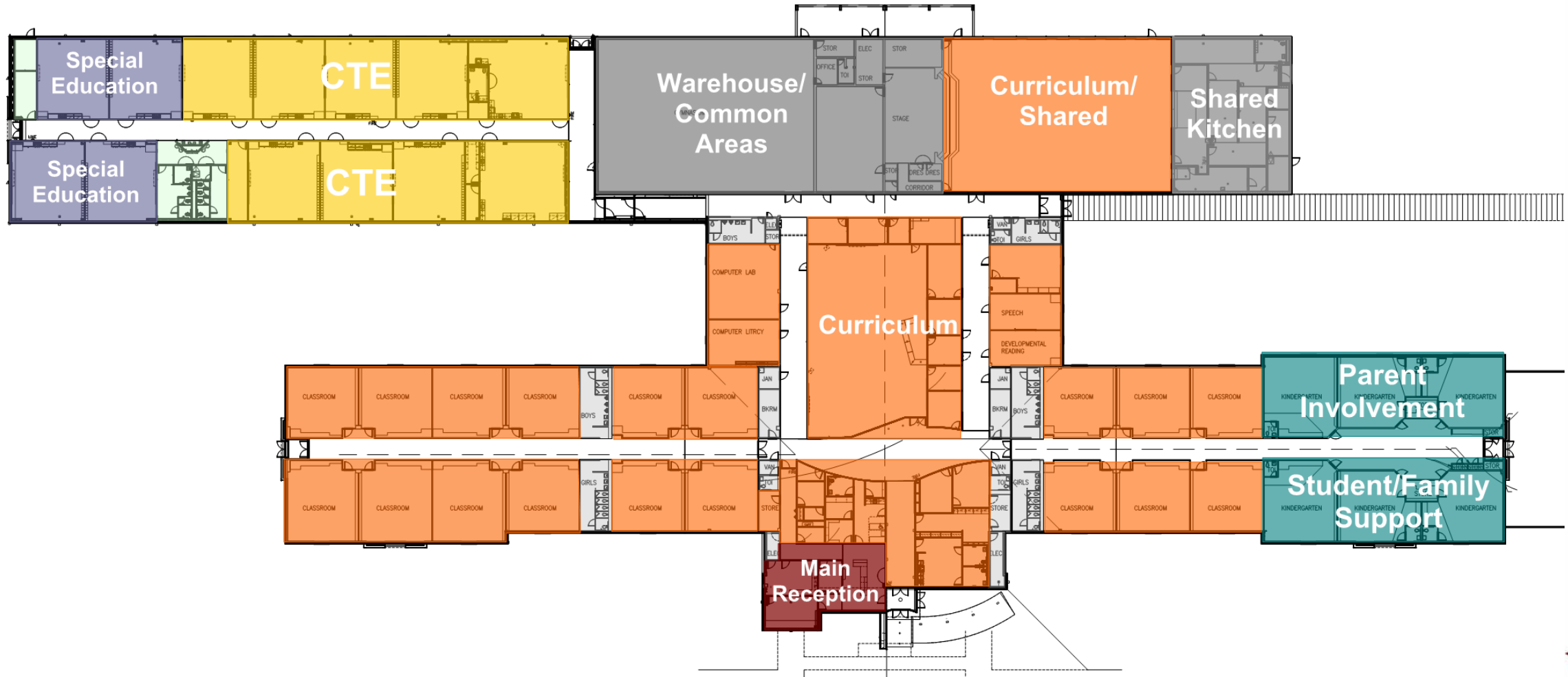

This map is to show the programmatic use (by color) for each department.

# Construction Update:

- Byron Nelson Field House - Complete
- Byron Nelson HS Additions/Renovations
- NHS PAC and Softball/Baseball Field House
- NISD Aquatic Center
- Eaton HS Addition – Phase 2
- Haslet Replacement Elementary School









BYRON NELSON HIGH SCHOOL  
ATHLETIC FIELD HOUSE















# Byron Nelson HS Addition

















# V.R. Eaton HS Addition











NORTHWEST HIGH SCHOOL  
BASEBALL/SOFTBALL ATHLETIC FACILITY























# Haslet ES Replacement











[www.nisdtxconstruction.org](http://www.nisdtxconstruction.org)