

MSDA Drop-Off & Parking Map Guide

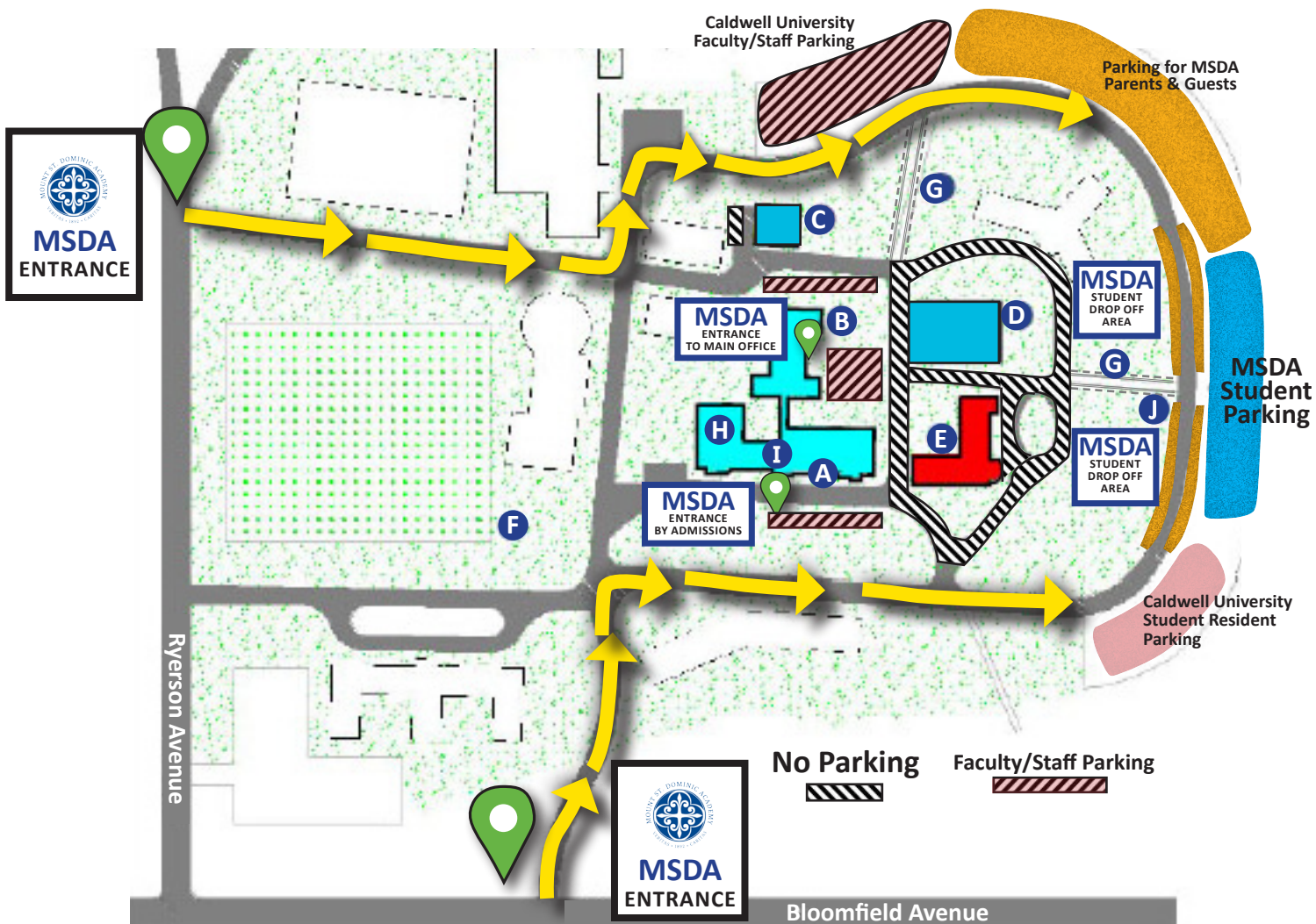

Drop Off/Pick Up Guidelines

- There are **TWO main entrances** to Mount St. Dominic Academy: Bloomfield Avenue and Ryerson Avenue
 - Enter at the **Bloomfield Avenue** Entrance, then turn right at the 4-way stop sign. Proceed on the lower loop road to the parking area and student drop off/pick up area.
 - Enter from **Ryerson Avenue**, then turn left at the intersection. Proceed on the loop road to parking areas and student drop off/pickup area.
 - Parents may use the gravel spaces on the sides of the loop road near the Gazebo to pull off and wait for students.
- **Absolutely NO PARKING** anywhere near the Motherhouse/Convent or St. Catherine of Siena Infirmary.
- Prior to 7:40am, parents may drop off students directly in front of the Athletic Center.
- After 7:40am, parents must use the loop road to drop students off in front of the gazebo.
- Students with a medical excuse provided by the school nurse may be dropped off in front of the Athletic Center or Admissions.
- Beginning at 3:15pm, students may be picked up on the inner road between the school and the Athletic Center.

MAP KEY

- A** MSDA Building - Rosary Hall
- B** MSDA Building - Aquinas Hall / Main Office Entrance
- C** Angelica Hall
- D** Athletic Center
- E** Sisters of St. Dominic Motherhouse
- F** Athletic Field
- G** Walkway to/from Gazebo and/or Parking
- H** Doris M. Byrne Performing Arts Center
- I** MSDA Building - Rosary Hall / Admissions Entrance
- J** Gazebo



MSDA Campus Safety

The safety of our students is a top priority. All students/parents/family members who are driving students to school are expected to adhere to the following:

- There are **TWO main entrances** to Mount St. Dominic Academy: Bloomfield Avenue and Ryerson Avenue.
 - Enter at the **Bloomfield Avenue** Entrance, then turn right at the 4-way stop sign. Proceed on the lower loop road to the parking areas and student drop off/pick up area.
 - Enter from **Ryerson Avenue**, then turn left at the intersection. Follow the loop road to parking areas and student drop off/pick up area.
 - Parents/Visitors may use the gravel spaces on the sides of the loop road to pull off and wait for students.

Drop Off/Pick Up Guidelines

- Drive slowly and pay attention to students walking, driving, and parking.
- Be mindful that our students are new and inexperienced drivers.
- The Campus Loop Road is the primary road for picking up and dropping off students.
- Pull up and wait in the line that leads to the gazebo. Be patient and exercise caution when pulling out after you have dropped off/picked up your student.
- If you are waiting for a student, pull over and park on the side gravel spaces on the Loop Road and/or parking spots that are not near student spaces. Refrain from using the student parking lot to park, wait for students, or turn around.
- The faculty and staff parking area between the Athletic Center and Aquinas Hall/MSDA Main Entrance across from Athletic Center should not be used to drop off/pick up students or to turn around between 7:40am and 3:15pm.
- Prior to 7:40am, parents may drop off students directly in front of the Athletic Center.
- After 7:40am, parents must use the campus loop road to drop students off in front of the gazebo.
- Students with a medical excuse provided by the school nurse may be dropped off in front of the Athletic Center or Admissions.
- Beginning at 3:15pm, parents may pick up students directly in front of the Athletic Center.

See [CAMPUS MAP](#) (link to PDF)