

FELSTED SCHOOL

Felsted, Essex CM6 3LL
01371 822600

Chair of Governors:	Robert Brown chairman@felsted.org
Governors:	John Davies , OBE, MA Bobbi Davy James Nicholson , DM, MA, MB BChir, FRCPCB Oliver Stocken , CBE James Tibbitts , MA, FCT Chair of House & Finance Committee Jane Crouch , BA, MA Chair of Governance Committee William Sunnucks , MA, ACA, MBA Rev Nic Stuchfield , MA Ann Carrington , LLB, LLM, JP Geoffrey Boulton , BA Chair of Education Committee Julia Abel Smith , DL, MA Mike Beale Stephen Wolfe , BSc, MRICS, IRRV Patricia Wardell , BA Lucilla Poston , CBE, PhD, FMedSci Alison Sefton , BSc
Headmaster:	Christopher Townsend , BA 01371 822606 hmpa@felsted.org
Bursar:	Andrew Clayton , BA, MBA 01371 822621 burspa@felsted.org
Senior Deputy Head:	George Masters , BA 01371 822708 dhpa@felsted.org
Deputy Head (Academic):	Sarah Capewell , MA 01371 822678 dhpaacademic@felsted.org
Assistant Head (Academic):	Lorne Stefanini , MA 01371 822678 dhpaacademic@felsted.org
Assistant Head (Staff & Co-Curricular):	Rebecca Purdy , BA, MEd 01371 822694 coadmin@felsted.org
Director of Global Education:	Daniel Emerson , MA 01371 822748 dpe@felsted.org
Designated Safeguarding Lead:	N F S O'Brien , MA 01371 820133 nfsob@felsted.org
Prep School Headmaster:	Simon James , BA 01371 822610 hmsprep@felsted.org

Senior Management Team

HEADMASTER'S OFFICE

Headmaster: C J Townsend, BA

PA: Sarah Webb

01371 822606

hmpa@felsted.org

Reception: Claire Eastlake and Dawn Jones

01371 822600

reception@felsted.org

SENIOR DEPUTY HEAD'S OFFICE

Senior Deputy Head: G W S Masters, BA

PA: Michelle Wells

01371 822708

dhpa@felsted.org

Joint Common Room Secretaries:

01371 822690

Tricia Williamson and Maxine Cowell

crsec@felsted.org

Assistant Head (Staff & Co-Curricular): R J Purdy, BA, MEd

Co-Curricular Administrator: Suzy Jevons

01371 822694

coadmin@felsted.org

Designated Safeguarding Lead: N F S O'Brien, MA

07581 498869

nfso@felsted.org

Senior HM: S Barrett, BSc

01371 822770

sb@felsted.org

Head of Wellbeing: L Page, UKCP, MBACP reg

01371 822673

wellbeing@felsted.org

Director of Digital Strategy: G E Dean, BA

01371 822695

ged@felsted.org

Director of Performing Arts: M C Donaldson, BA

Administrator: Sarah Penrose

01371 822655

mpaadmin@felsted.org

Director of Sport: C S Knightley, BA

Sports Administrator: Maxine Cowell

sportsadmin@felsted.org

Senior Management Team

ACADEMIC OFFICE

Deputy Head (Academic): S R Capewell, MA	01371 822678
Assistant Head (Academic): L K Stefanini, MA	
PA: Fiona Pemberton	dhpaacademic@felsted.org
Director of Teacher Development: B S Roberts Jones, BSc, MEd	bsrj@felsted.org
Director of Reports: R L Feldman, MSc	01371 822675 rlf@felsted.org
Timetabler: J M Jevons, BA	dhpaacademic@felsted.org
Director of Exams: A L F Simpson, BSc	01371 822657
Exams Officer: Kelly Cleaver	exams@felsted.org
Director of Professional Guidance: L M Scofield, BA	01371 822668 careersadmin@felsted.org
Director of International Baccalaureate: K L Woodhouse, BSc	01371 822666 klw@felsted.org

BURSAR'S OFFICE

Bursar: A G Clayton, BA, MBA	01371 822621 burspa@felsted.org
Director of Global Education: D P Emmerson, MA	01371 822748 dpe@felsted.org
Director of Development: C N Love, MA	01371 822649 cni@felsted.org

Houses

GEPP'S (A)

HM	M L McIlvenna	01371 822700	mlm@felsted.org
AHM	N J Phillips	01371 822702	njp@felsted.org
Resident Tutor	L J Mann	01371 822703	ljm@felsted.org
Matron	L Hayden	01371 822653	Matrona@felsted.org
	House Mobile	07764 332927	

STOCKS'S (B)

HM	A L Salmon	01371 822710	als@felsted.org
AHM	L Macey	01371 822713	lm@felsted.org
Resident Tutor	A M J Little		amjl@felsted.org
Matron	K Harvey	01371 822714	kh@felsted.org
	House Mobile	07764 332930	

WINDSOR'S (C)

HM	C H Palmer	01371 822720	chp@felsted.org
AHM	L M Keable	01371 822722	lmk@felsted.org
Resident Tutor	R J Thear	01371 822738	rat@felsted.org
Matron	S Howard	01371 822724	Matronc@felsted.org
	House Mobile	07764 332931	

MONT'S (D)

HM	A Le Chevalier	01371 822730	alc@felsted.org
AHM	J E R Gallian	01371 822732	jerg@felsted.org
Matron	L E Impey	01371 822734	lei@felsted.org
	House Mobile	07764 332932	

ELWYN (E)

HM	T P C Galvin	01371 822740	tpcg@felsted.org
AHM	A J A Pask	01371 822742	ajap@felsted.org
Resident Tutor	M W J Redding	01371 822743	mwjr@felsted.org
Matron	A Stevens	01371 822744	matrone@felsted.org
	House Mobile	07764 332933	

FOLLYFIELD (G)

HM	S D Wilson	01371 822750	sdw@felsted.org
AHM	L Willis	01371 822752	lw@felsted.org
Resident Tutor	R Perez Cabrera	01371 822753	rpc@felsted.org
Matron	W M Hookway	01371 822754	wmh@felsted.org
	House Mobile	07876 442823	

Houses

DEACON'S (H)

HM	B J Bury	01371 822760	bjb@felsted.org
AHM	C J Wukics	01371 822762	cjw@felsted.org
Resident Tutor	W B Bayliss-Brown		wbbb@felsted.org
Matron	J Jarred	01371 822704	matronh@felsted.org
	House Mobile	07764 332941	

MANOR (M)

HM	C M Phillips	01371 822790	cmp@felsted.org
AHM	K Moir-Smith	01371 822759	kms@felsted.org
Matron	T Camp	01371 822734	matronm@felsted.org
	House Mobile	07918 619244	

GARNETTS (N)

HM	S Barrett	01371 822770	sb@felsted.org
AHM	A T Mohindru	01371 822772	atm@felsted.org
Resident Tutor	A McCaughern		ajmc@felsted.org
Matron	A Howes	01371 822774	matronn@felsted.org
	House Mobile	07764 332943	

THORNE (T)

HM	C Donaldson	01371 822707	cd@felsted.org
AHM	A N Fazekas	01371 822717	anf@felsted.org
Resident Tutor	M Trucco		mt@felsted.org
Matron	C Gormley	01371 822718	matront@felsted.org
	House Mobile	07918 755037	

Chaplaincy

Chaplain	Rev'd Nigel Little	07730 412647	rev@felsted.org
----------	--------------------	--------------	-----------------

Common Room

To email members of staff, use their initials@felsted.org

Art

E A M Jackson, BA

eamj@felsted.org

J N Buniak, MA

A V Warner, BA

Business

A T Mohindru, LLB

atm@felsted.org

E Grant, BSc

J K Peddy, BSc

Classics

E M McLaren, MA (Roberts Society Co-ordinator)

emm@felsted.org

S R Capewell, MA (*Deputy Head, Academic*)

E J Clark, BA

A J Quinlan, BA

Computer Science

E J Abeggen, BSc

eja@felsted.org

M W J Redding (*Head of ICT Services*)

A A Ross, BSc

Design and Technology

M A Pitts, BEng

map@felsted.org

W B Bayliss-Brown, BA

H K Pheloung, BA ~

Drama

M C Donaldson, BA (Director of Performing Arts)

mcd@felsted.org

L Macey, BA

L J Mann, BA

Economics

F M Barrett, BBS

fmb@felsted.org

M L McIlvenna, BA, MEd †

S D Wilson, BA †

English and Media

E L Predebon, MA

elp@felsted.org

Z A Ball, MA

G J Catchpole, PGCE

M R Crossley, BA

L E Fell, BA

C M James, BA (*Head of Project Qualifications*)

R J Purdy, BA, MEd (*PSHE, Assistant Head - Staff & Co-Curricular*)

H A Sunshine, BA

N M Sunshine-Harris, BA (*Professional Guidance & Support*)

Common Room

Geography

G R Stringer, BSc

grs@felsted.org

T P C Galvin, BSc †

A McCaughern, BSc

K Moir-Smith, BA

History & Politics

R Pathak, BA

rp@felsted.org

B R Maude-Barker, MA

L M Scofield, BA (*Director of Professional Guidance*)

lms@felsted.org

Dr T Strange, PhD

Mathematics

M J Campbell, MSc

mjc@felsted.org

J C Andrews, MEng

C Donaldson, BSc †

R L Feldman, MSc (*Director of Reports*)

J M Jevons, BA (*Timetabler*)

H V Lavin, BSc

A Munns, MA

N Pritchard, BSc

Modern Languages

L J Robertson, MA (French and German)

ljr@felsted.org

A N Fazekas, MA (German)

F Sanchez del Rio, Licenciatura (Spanish, Editor of 'The Felstedian')

T M Catmur, BA (*French*)

R Grant, BA (*Spanish*)

N F S O'Brien, MA (*Spanish, EAL*) (*DSL*)

R Perez Cabrera, MA (*Spanish*) (*Round Square Co-ordinator*)

G O N Scholz, BSc (*German*)

M Trucco, MA (*Italian and French*)

J M White, BA (*Spanish*)

N Escudero Melgar (*Spanish Language Assistant*)

M Lecareaux (*French Language Assistant*)

C Luebbert (*German Language Assistant*)

Music

W J Warns, MA, DipABRSM, FNCM (Director of Music)

wjw@felsted.org

R J Thear, BA

C L J McGlone, BA

Common Room

Physical Education and Sport

L Willis, BSc, MS

(Director of Girls' Sport & Head of Girls' Hockey)

lw@felsted.org

N J Phillips, BA *(Head of Boys' Hockey)*

S Barrett, BSc *(Senior HM)* †

B J Bury, BA †

J E R Gallian *(Director of Cricket)*

C S Knightley, BA *(Director of Sport)*

A Le Chevalier, PGCE *(Director of Rugby)* †

C E Rudd, BSc *(Head of Girls' Cricket)*

N J Lockhart, ECB3, EH2 *(Head of Grounds & Cricket Professional)*

R Marriott-Cox *(Director of Tennis)*

J R Westwood *(Director of Hockey)*

A A Cox, BA (GRA)

M H Anthony (GRA)

Project Qualifications

C M James, BA

cmj@felsted.org

PSHE

R J Purdy, BA, MEd

(English, Assistant Head - Staff & Co-Curricular)

rjp@felsted.org

Psychology

V L Smith, MEd

M Cacace, BA *(Head of IB Core)*

vls@felsted.org

Science

H J Mollison, BSc, MEd (Head of Science, Chemistry)

hjm@felsted.org

L E Barden, BSc (Chemistry)

K J Farr, MSc (Biology)

D T Smith, BSc (Physics)

L T Barrett, BSc *(Chemistry)*

J Entwistle, BSc *(Biology)*

C H Palmer, MA *(Physics)* †

A J A Pask, BSc *(Chemistry)*

A V Price, MA *(Physics)*

A L F Simpson, BSc *(Biology, Director of Exams)*

R Warner, MSc *(Biology)*

R L Williams, BSc *(Biology)*

K L Woodhouse, BSc *(Physics, Director of IBDP)*

Common Room

Theology, Ethics and Philosophy

B S Roberts Jones, BSc, MEd

bsrj@felsted.org

L M Keable, BA

Dr S R Lambert, PhD

Rev'd N J Little, BA (*Chaplain, i/c Charities*)

G W S Masters, BA (*Senior Deputy Head*)

L K Stefanini, BSc, MA (*Assistant Head, Academic*)

Wellbeing Centre

L Page, UKCP, MBACP reg

C J Croll, Counselling Skills

R K S Love, BSc

Support for Learning

J W Hipkin, BA, MEd

jwh@felsted.org

S J Beale, BA

C M Dungey, RSciTech

N J Johnson, CDip

E L Masters, MA

C M Phillips, MCILIP †

A L Salmon, BA, MEd †

J C Turner Jones, BA

EAL

D K Guerrero, BA, Dip TEFLA

dkg@felsted.org

CCF

Maj C H Palmer, MA (CCF Contingent Commander)

chp@felsted.org

Maj L W Jay

Duke of Edinburgh's Awards & Educational Visits

D L Whittock

dlw@felsted.org

Library

N S Howorth, BA, DipLib, MCLIP

nsh@felsted.org

† = HM

~ = Maternity Leave

Peripatetic Teaching Staff

Drums & Percussion

C C Apps, BMus (*Drums/Percussion*)

R Farrer, LGSM (*Drums/Percussion*)

N M Gregory, BMus (*Drums/Percussion*)

A Morris (*Drums/Percussion*)

Guitar

S Laney, Dip CPM (*Guitar Electric & Acoustic*)

A Staples (*Guitar and Bass*)

R Thear, BA (*Guitar Electric & Acoustic*)

Music Technology

J C Lapham, BA (MSET, QTLS)

Piano/Organ

J Arnold, BMus, ARCM, LGSM (*Piano*)

S Brennan, BMus, Mmus (*Piano*)

S Edwards, GCLCM, ABRSM (*Piano*)

J Lam, BMus, LRSM (*Piano*)

V Manning, Cert Mus Ed, ALCM (*Piano*)

A Reece, MA (*Piano*)

W J Warns, MA DipABRSM, FNCM (*Organ*)

C Wood, Prof Cert, RAM, LRAM, ARCM (*Piano*)

Strings

P Barton, GRSM (*Violin*)

A Carey, BMus (*Violin*)

L Creasey, BA (*Harp*)

C Ellis, BA, ARAM, LRAM (*Cello/Alexander Technique*)

H Rouse, Mus TCM, PG Perf TCM (*Viola*)

Vocal

K B Heard, BA, PGDip, MMus

F Wright, LLB, Cert ABRSM

Peripatetic Teaching Staff

Woodwind & Brass

S Aitken, GRSM, Dip RAM, LRAM, ARCM, FTCL (*Trombone/Tenor Horn/Tuba*)

S Brennan, BAMus, MMus (*Flute*)

A Bushby, MA (*Recorder*)

G Gerrard, GTCL, LTCL (*Oboe*)

J Plackett, BA LTCL, ALCM (*Clarinet/Recorder*)

C Shead, BMus (*Trumpet*)

A E Skinner, BA, LRAM, PGCE, Dip ABRSM, ARSM (*Recorder*)

W Yeomans, GCLCM (*Saxophone*)

LAMDA

K J Charters, MA

T Eastal, AISTD

A L Moor, BA

Mandarin

Dr H-C Chou, PhD

Regular Weekly Events – Autumn Term 2021

All activities listed below have priority at the times stated.

Where there are conflicts between activities listed below, the activity in **bold** has priority.

Mondays	8.30 am - 8.45 am	Headmaster's Assembly (Chapel)
	8.30 am - 8.45 am	House Staff Team Meetings (All Houses)
	10.50 am - 11.00 am	CR Briefing (BKA)
	4.15 pm - 5.50 pm	Orchestra (L6 & U6)
		Co-Curricular Activities (Years 9 & 10)
		DT Coursework (Years 10-U6)
		Art Department Open (Years 10-U6)
	4.45 pm - 5.45 pm	Deputy Head's Detention
	5.45 pm - 6.30 pm	Andrew Society (U6)
Tuesdays	8.30 am - 8.45 am	Tutorials
	2.00 pm - 5.00 pm	Sport
	2.00 pm - 6.00 pm	Art & DT Coursework (Years 10-U6)
	4.30 pm - 5.30 pm	L6 Gold DofE
	5.30 pm - 6.30 pm	Senior Steel Band (Years 9 & 10)
	5.45 pm - 6.30 pm	Roberts Society
	6.30 pm - 7.30 pm	Senior Steel Band (Years 11-U6)
Wednesdays	8.30 am - 8.45 am	Chapel
	4.15 pm - 5.30 pm	Year 10 A/B Sport
		Year 9 Leadership/CCF/DofE
		Year 10 Current Affairs & Culture
		Specialised Applications Workshop for 6th Form
		Peer Counselling
	4.30 pm - 5.30 pm	Art Workshop (Years 10-U6)
	4.30 pm - 6.30 pm	Years 11, L6 & U6 A/B Sport
	5.15 pm - 6.15 pm	
	5.45 pm - 6.30 pm	Med Soc
Thursdays	8.30 am - 8.45 am	Tutorials
	8.50 am - 10.45 am	Sport
	4.55 pm - 5.45 pm	MUN
	5.45 pm - 6.30 pm	EAL Support Session (Year 10)
Fridays	8.30 am - 8.45 am	Chapel
	3.00 pm - 4.55 pm	CCF (Sixth Form)
	3.15 pm - 4.15 pm	Year 9 A/B Sport
	3.30 pm - 5.00 pm	CCF (Years 10 & 11)
		Charitable Service (Years 9, 10 & 11)
	3.30 pm - 5.00 pm	DofE (Years 10 & 11)

Regular Weekly Events – Autumn Term 2021

Fridays	4.00pm - 6.00 pm	Careers Drop-in Clinic (Careers Library)
	4.15 pm - 5.45 pm	Art Coursework (Years 10-U6) DT Coursework
	4.45 pm - 5.45 pm	Deputy Head's Detention Peer Counselling
	5.00pm - 6.15 pm	Life Drawing (Sixth Form)
Saturdays	12.15pm - 12.30 pm	Tutorials
	1.30 pm - 4.00 pm	Art Department Open

Meal Times

Breakfast	7.30 am - 8.20am	All Boarders
Lunchtime	12.55 pm	Year 9
	1.05 pm	Year 10
	1.10 pm	Year 11
	1.20 pm	Sixth Form
Supper	6.15 pm	U6
	6.30 pm - 7.15 pm	Years 9-L6
Sunday Brunch	10.30 am - 12.00 pm	All Boarders

Abbreviations for venues:

CC	Cromwell Centre	LRH	Lord Riche Hall
CRDR	Common Room Dining Room	MC	Medical Centre
CRSR	Common Room Sitting Room	BAK	Barbara Karan Auditorium
GH	Grignon Hall	SH	Sports Hall
HT	Hunt Theatre	6FC	Sixth Form Centre

Timetable – Week A

	8.30-8.45	8.50-9.45	9.50-10.45	BREAK	11.15-12.10	12.15-1.10	LUNCH	2.10-3.00	3.05-3.55	Co-Curricular & Private Study Time
		1	2		3	4		5	6	
Monday	Headmaster's Assembly									
Tuesday	Tutorials									
Wednesday	Chapel									
Thursday	Tutorials									4.00-4.50 Period 7
Friday	Chapel									
Saturday	House Assemblies					12.15-12.30 Tutorials				

Timetable – Week B

	8.30-8.45	8.50-9.45 1	9.50-10.45 2	BREAK	11.15-12.10 3	12.15-1.10 4	LUNCH	2.10-3.00 5	3.05-3.55 6	Co-Curricular & Private Study Time
Monday	Headmaster's Assembly									
Tuesday	Tutorials									
Wednesday	Chapel									
Thursday	Tutorials									4.00-4.50 Period 7
Friday	Chapel									
Saturday	House Assemblies					12.15-12.30 Tutorials				

Mon 6

- 10.00 am Girls' Hockey v Marlborough: 1st XI (H)
11.00 am L6 Arrive (Houses)
 2.00 pm Girls' Hockey: Senior Pre-Season Training
-

Tue 7

- 8.50 am L6 Lessons (Periods 1- 4) commence
 (IB students: Group 4 Project)
 9.00 am Girls' Hockey: Junior Pre-Season Training
11.00 am Year 9 Arrive (Houses)
 2.00 pm Girls' 1st XI vs. Robins (The Front)
 2.00 pm L6 Sports Sessions commence
2.30 pm U6 Return (Testing - Cromwell Centre)
4.00 pm Year 11 Return (Testing - Cromwell Centre)
5.00 pm Year 10 Return (Testing - Cromwell Centre)
-

Wed 8

- 8.15 am Day Pupils Return**
 8.30 am House Assemblies
**9.00 am Beginning of Term Chapel Service followed by
 Headmaster's Assembly**
 10.15 am Tutorials for all year groups
 10.45 am Common Room Briefing (LRH)
11.15 am Normal Routine commences for all year groups
-

Thu 9

For away fixtures, the first time shown is the departure time from Felsted, with the kick-off time in brackets
 School Office No.: 01371 822600 : website: www.felsted.org

Fri 10

7.00 pm U6 BBQ (Garnetts)

Sat 11

12.30 pm Boys' Rugby v Haileybury: U16A, U16B, U15A, U15B
(A: 3.00 pm)

1.00 pm Girls' Hockey v Ipswich: U15A, U15B (A: 2.00 pm)

2.00 pm Girls' Hockey v Ipswich: 1st XI, 2nd XI (H)

2.00 pm Girls' Hockey v Ipswich: U14A, U14B (A: 3.00 pm)

3.00 pm Girls' Hockey v Ipswich: U14/U15C (H)

3.00 pm Boys' Rugby v Haileybury: 1st XV, 2nd XV, U14A, U14B (H)

3.15 pm Girls' Hockey v Ipswich: CCA (H)

Sun 12

Fifteenth Sunday after Trinity

2.00 pm Boys' Tennis v PSOBLTA: 1st (H)

Mon 13

Individual Music and LAMDA Lessons Commence

**2.00 pm Deadline for School Prefect Applications to
Deputy Headmaster's Office**

4.00 pm-6.00 pm Gap Year Roadshow (6FC)

Tue 14

8.30 am Year 9 Academic Briefing (BKA)

8.30 am U6 Academic Briefing (GH)

Wed 15

8.50 am Year 9 Young Film Academy (GH)

Thu 16

For away fixtures, the first time shown is the departure time from Felsted, with the kick-off time in brackets

School Office No.: 01371 822600 : website: www.felsted.org

Fri 17

Sat 18

- 11.00 am Girls' Hockey v Forest: 1st XI (A: 2.00pm)
12.15 pm Boys' Rugby v St John's Leatherhead: 1st XV, 2nd XV,
3rd XV, U14A, U14B, U14C (A: 3.00pm)
12.15 pm Girls' Hockey v Forest: 2nd XI (A: 3.00pm)
2.00 pm Girls' Hockey v Forest: U14A, U14B (H)
3.00 pm Girls' Hockey v Forest: U15A, U15B (H)
3.00 pm Boys' Rugby v St John's Leatherhead: U16A, U16B, U15A,
U15B, U15C (H)
-

Sun 19

Sixteenth Sunday after Trinity

- 2.00 pm Boys' Tennis v Old Felstedians: 1st (H)
-

Mon 20

Tue 21

L6 Induction: Thriftwood Trip (all day)

8.30 am Year 11 Academic Briefing (BKA)

Wed 22

Boys' Rugby: Schools' Cup Round 1

Thu 23

10.45 am CCF 24hr Exercise (Colchester) departs

For away fixtures, the first time shown is the departure time from Felsted, with the kick-off time in brackets

School Office No.: 01371 822600 : website: www.felsted.org

Fri 24

12.00 pm CCF 24hr Exercise (Colchester) returns

8.50 am Period 1

9.35 am Period 2

10.15 am Break

10.45 am Period 3

11.30 am Period 4

12.10 pm Period 5

1.00 pm Exeat begins

Sat 25**Exeat**

Sun 26*Seventeenth Sunday after Trinity***Exeat****6.00 pm Houses open. Boarders return by 9.00 pm**

Mon 27

U6 In Class Assessments

8.15 am Day pupils return

8.30 am Whole School Chapel Service

Tue 28

U6 In Class Assessments

8.30 am Year 10 Academic Briefing (BKA)

3.00 pm Boys' Rugby v New Hall: 1st XV (H)

5.00 pm Governors' Governance Committee Meeting

Wed 29

U6 In Class Assessments

9.00 pm Year 11 Progress Reports: Teacher Deadline

Thu 30

U6 In Class Assessments

4.00 pm Flu vaccinations (Years 7-11)

9.00 pm PDR Targets: Teacher Deadline

For away fixtures, the first time shown is the departure time from Felsted, with the kick-off time in brackets

School Office No.: 01371 822600 : website: www.felsted.org

Fri 1

U6 In Class Assessments

5.00 pm Girls' Hockey v Haileybury: 1st XI (A: 7.00 pm)

Sat 2

10.00 am Governors' Strategy Meeting

12.15 pm Girls' Hockey v Haileybury: 2nd XI (A: 2.00 pm)

12.15 pm Girls' Hockey v Haileybury: CCA, CCB (A: 3.15 pm)

12.15 pm Boys' Rugby v Gresham's: 1st XV, 2nd XV, U16A,
U16B (A: 3.00 pm)

2.00 pm Girls' Hockey v Haileybury: U15A, U15B (H)

2.30 pm Boys' Rugby v Eltham College: U15A, U15B, U14A, U14B (H)

3.15 pm Girls' Hockey v Haileybury: U14A, U14B (H)

Sun 3

Eighteenth Sunday after Trinity

8.30 am Year 10 Geography Trip (Sheringham) departs

Mon 4

5.30 pm Year 10 Geography Trip (Sheringham) returns

7.00 pm Felsted Parents' Group (CRDR)

Tue 5

8.30 am L6 Academic Briefing (BKA)

1.00 pm Boys' Rugby v Ipswich: U15A, U15B, U14A, U14B
(A: 3.00pm)

3.00 pm Boys' Rugby v Ipswich: 1st XV, 2nd XV, U16A, U16B (H)

9.00 pm Year 11 Progress Reports: Tutor Deadline

Wed 6

9.00 pm U6 Progress Reports: Teacher Deadline

Thu 7

National Poetry Day: 'Choice'
HoDs' Away Day

**7.30 pm Butler Lecture by Laura Bates:
'The Everyday Sexism Project' (GH)**

For away fixtures, the first time shown is the departure time from Felsted, with the kick-off time in brackets

School Office No.: 01371 822600 : website: www.felsted.org

Fri 8

- 11.00 am Governors' Education Committee Meeting
5.00 pm Careers Seminar (Careers Library)
7.30 pm U6, L6 & Year 11 Music Scholars' Concert (BKA)
-

Sat 9

- 12.15 pm Boys' Rugby v Oundle: 1st XV, 2nd XV, U15A, U15B
(A: 3.00pm)
12.15 pm Girls' Hockey v The Leys: U15B, U14B (A: 2.00pm)
12.45 pm Girls' Hockey v The Leys: U15A, U14A (A: 3.15pm)
2.30 pm Girls' Hockey v The Leys: 1st XI, CCA (H)
3.00 pm Boys' Rugby v Oundle: U16A, U16B, U14A, U14B (H)
3.45 pm Girls' Hockey v The Leys: 2nd XI, CCB (H)
-

Sun 10

Nineteenth Sunday after Trinity

Mon 11

Tue 12

Boys' Rugby: Schools' Cup Round 2

8.30 am Year 11 Academic Briefing (BKA)

7.30 pm Years 9-U6: Angles present 'Our White Skoda Octavia' (HT)

9.00 pm U6 Progress Reports: Tutor Deadline

Wed 13

2.00 pm Spring Term Calendar Deadline

4.00 pm Early Finish: Contemporary Boarders and Day Pupils
may depart

4.30 pm L6 Virtual Parents' Meeting

Thu 14

8.30 am Sports' Photographs

4.00 pm Period 7 cancelled

4.30 pm House Part Song Competition (Chapel)

7.30 pm House Unison Song Competition (LRH)

For away fixtures, the first time shown is the departure time from Felsted, with the kick-off time in brackets

School Office No.: 01371 822600 : website: www.felsted.org

Fri 15

8.50 am Period 1

9.35 am Period 2

10.15 am Break

10.45 am Period 3

11.30 am Period 4

12.10 pm Period 5

1.00 pm Half Term begins2.00 pm Jazz Band performing for Friends of Felsted
(Memorial Hall)**2.00 pm L6 Virtual Parents' Meeting**

Sat 16

Half Term

Sun 17*Twentieth Sunday after Trinity*

Half Term

Half Term

Mon 18

Half Term
GH Out of Use

Tue 19

Half Term
GH Out of Use

Wed 20

Half Term
GH Out of Use

Thu 21

Half Term
GH Out of Use

Fri 22

Half Term
GH Out of Use

Sat 23

Half Term
GH Out of Use

Sun 24

Twenty-first Sunday after Trinity
Half Term
GH Out of Use

For away fixtures, the first time shown is the departure time from Felsted, with the kick-off time in brackets
School Office No.: 01371 822600 : website: www.felsted.org

Half term

Mon 25

GH Out of Use

Tue 26

Half Term

GH Out of Use

Wed 27

Half Term

GH Out of Use

Thu 28

Half Term

GH Out of Use

Fri 29

Half Term

GH Out of Use

Sat 30

Half Term

GH Out of Use

Sun 31

Fourth Sunday before Advent

British Summertime ends

Half Term

GH Out of Use

6.00 pm Houses Open: Boarders return by 9.00pm

Regular Activity Times are listed
on pp12 & 13 of this Calendar

Mon 1

GH Out of Use

8.15 am Day pupils return

9.00 am Public Exam: IGCSE English Language Paper 1

Tue 2

GH Out of Use

8.30 am Year 9 Academic Briefing (BKA)

9.00 am Public Exam: IGCSE Maths Paper 1

7.30 pm Butler Lecture by Katherine Hill (Chapel)

Wed 3

GH Out of Use

5.00 pm Governors' House and Finance Committee Meeting

9.00 pm Year 10 Progress Reports: Teacher Deadline

Thu 4

Safi Partnership Workshop

GH Out of Use

9.00 am Public Exam: IGCSE Maths Paper 2

For away fixtures, the first time shown is the departure time from Felsted, with the kick-off time in brackets

School Office No.: 01371 822600 : website: www.felsted.org

Fri 5

GH Out of Use

5.00 pm Careers Seminar (Careers Library)

Sat 6

GH Out of Use

8.50 am Period 1

9.50 am Period 2

10.50 am Period 3

11.45 am Break

12.15 pm Tutorials

12.30 pm Lunch

11.45 am Boys' Rugby v Framlingham College: 1st XV, 2nd XV,
3rd XV, U16A, U16B (A: 2.30pm)

11.45 am Girls' Hockey v Bedford: U15B, U14A (A: 1.45pm)

12.45 pm Girls' Hockey v Bedford: U15A, U14B (A: 2.45pm)

1.00 pm Girls' Hockey v Bedford: 1st XI (H)

2.00 pm Girls' Hockey v Bedford: 2nd XI, CCA (H)

2.30 pm Boys' Rugby v Framlingham College: U15A, U15B, U14A,
U14B (H)

Sun 7

Third Sunday before Advent

GH Out of Use

8.30 am L6 Geography Trip (London and Gilwell Park) departs

Mon 8

GH Out of Use
L6 Geography Trip

Tue 9

GH Out of Use

Boys' Rugby: Schools' Cup Round 3 (1st XV)

5.30 pm L6 Geography Trip returns

8.30 am U6 Academic Briefing (BKA)

9.00 pm Year 10 Progress Reports: Tutor Deadline

Wed 10

GH Out of Use

4.00 pm Technical Rehearsal: 'My Fair Lady' (GH)

9.00 pm Year 9 Progress Reports: Teacher Deadline

Thu 11

GH Out of Use

Armistice Day

8.30 am Technical Rehearsal: 'My Fair Lady' (GH)

For away fixtures, the first time shown is the departure time from Felsted, with the kick-off time in brackets

School Office No.: 01371 822600 : website: www.felsted.org

Fri 12

GH Out of Use
Flu vaccinations (Years 7-11)

4.00 pm Technical Rehearsal: 'My Fair Lady' (GH)
6.00 pm Governors' Seminar

Sat 13

All Boarders' In Weekend

GH Out of Use

8.50 am Period 1
9.50 am Period 2
10.50 am Period 3
11.45 am Break
12.15 pm Tutorials
12.30 pm Lunch

10.00 am Governors' Board Meeting
11.45 am Boys' Rugby v RHS: 1st XV, 2nd XV, 3rd XV, U16A, U16B
(A: 2.30pm)
12.30 pm Girls' Hockey v New Hall: 2nd XI, U15A (A: 1.30pm)
1.30 pm Girls' Hockey v New Hall: 1st XI (A: 2.30pm)
2.00 pm Girls' Hockey v New Hall: U14A, U14B (H)
2.30 pm Boys' Rugby v RHS: U15A, U15B, U14A, U14B (H)
3.00 pm Girls' Hockey v New Hall: U15B (H)

Sun 14

Second Sunday before Advent

Remembrance Sunday

10.15 am Felsted Village Act of Remembrance (Memorial Hall)
10.45 am Remembrance Service (Chapel)
2.00 pm Technical Rehearsal: 'My Fair Lady' (GH)

Regular Activity Times are listed
on pp12 & 13 of this Calendar

Mon 15

4.00 pm Dress Rehearsal: 'My Fair Lady' (GH)

Tue 16

Boys' Rugby: Schools' Cup Round 3 (U15)

8.30 am Year 11 Academic Briefing (BKA)

1.00 pm Boys' Rugby v The Leys: U15A (A: 2.30 pm)

2.15 pm Boys' Rugby v The Leys: 1st XV, 2nd XV, U16A, U16B (H)

4.00 pm Dress Rehearsal: 'My Fair Lady' (GH)

9.00 pm Year 9 Progress Reports: Tutor Deadline

Wed 17

7.30 pm Performance: 'My Fair Lady' (GH)

9.00 pm L6 Progress Reports: Teacher Deadline

Thu 18

7.30 pm Performance: 'My Fair Lady' (GH)

For away fixtures, the first time shown is the departure time from Felsted, with the kick-off time in brackets

School Office No.: 01371 822600 : website: www.felsted.org

Fri 19

- 1.30 pm Performance: 'My Fair Lady' (GH)**
5.00 pm Careers Seminar (Careers Library)
6.30 pm Lord Riche Society Reception (BKA)
7.30 pm Performance: 'My Fair Lady' (GH)
-

Sat 20

- 12.00 pm Girls' Hockey v Framlingham: 1st XI, CCA (A: 2.00pm)
12.15 pm Boys' Rugby v King's Ely: 1st XV, U16A (A: 2.30pm)
1.00 pm Girls' Hockey v Framlingham: 2nd XI, U14A (A: 3.00pm)
2.00 pm Girls' Hockey v Framlingham: U15A, U15B (H)
2.30 pm Boys' Rugby v King's Ely: U15A, U14A (H)
3.00 pm Girls' Hockey v Framlingham: CCB, U14B (H)
- 7.30 pm Performance: 'My Fair Lady' (GH)**
-

Sun 21

Christ the King

Mon 22

Tue 23

Boys' Rugby: Schools' Cup Round 4

8.30 am Year 10 Academic Briefing (BKA)

9.00 pm L6 Progress Reports: Tutor Deadline

Wed 24

4.00 pm Early Finish: Contemporary Boarders and Day Pupils
may depart

4.30 pm U6 Virtual Parents' Meeting

Thu 25

For away fixtures, the first time shown is the departure time from Felsted, with the kick-off time in brackets

School Office No.: 01371 822600 : website: www.felsted.org

Fri 26

8.50 am Period 1

9.35 am Period 2

10.15 am Break

10.45 am Period 3

11.30 am Period 4

12.10 pm Period 5

1.00 pm Exeat begins

2.00 pm U6 Virtual Parents' Meeting

Sat 27

Exeat

Sun 28

Advent Sunday

Exeat

6.00 pm Houses Open. Boarders return by 9.00pm

Mon 29

Year 11 Mock Exams

8.15 am Day pupils return
8.30 am Whole School Chapel Service

Tue 30

St Andrew's Day
Year 11 Mock Exams

8.30 am L6 Academic Briefing (BKA)

Wed 1

Year 11 Mock Exams
ABRSM Practical Music Examinations

Thur 2

Year 11 Mock Exams
ABRSM Practical Music Examinations

7.00 pm Senior Choir to sing for Blesma Carol Service
(Chelmsford Cathedral)

For away fixtures, the first time shown is the departure time from Felsted, with the kick-off time in brackets

School Office No.: 01371 822600 : website: www.felsted.org

Fri 3

Year 11 Mock Exams

5.00 pm Careers Seminar (Careers Library)

6.00 pm Girls' Hockey v Bishop's Stortford College: 1st XI (H)

Sat 4

Year 11 Mock Exams

11.45 am Boys' Rugby v Norwich: U15A, U15B, U14A, U14B (A: 2.15 pm)

1.15 pm Girls' Hockey v Bishop's Stortford College: U14A, U14B,
U15/U14C (A: 2.30 pm)

2.00 pm Girls' Hockey v Bishop's Stortford College: 1st XI, CCA (H)

2.15 pm Boys' Rugby v Norwich: 1st XV, 2nd XV, U16A, U16B (H)

2.15 pm Girls' Hockey v Bishop's Stortford College: U15A, U15B
(A: 3.30 pm)

3.00 pm Girls' Hockey v Bishop's Stortford College: 2nd XI, CCB (H)

Sun 5

Second Sunday of Advent

Mon 6

Tue 7

LAMDA Exams

Boys' Rugby: Schools' Cup Quarter Finals

8.30 am Year 9 Academic Briefing (BKA)

Wed 8

LAMDA Exams

4.00 pm HE & Careers Fair (GH, BKA and Ruggles-Brise)

9.00 pm Year 11 Mock Reports: Teacher Deadline

Thu 9

For away fixtures, the first time shown is the departure time from Felsted, with the kick-off time in brackets

School Office No.: 01371 822600 : website: www.felsted.org

Fri 10

7.30 pm Autumn Concert (Chapel)

Sat 11

1.45 pm Boys' Rugby: House Matches

1.45 pm Girls' Hockey: House Matches

Sun 12

Third Sunday of Advent

5.00 pm FPS Carol Service (Chapel) followed by Reception (LRH)

Mon 13

6.00 pm FPS Christmas Feast (LRH)

Tue 14

8.30 am Year 11 Mock Exam Results to Pupils

8.30 am U6 Academic Briefing (BKA)

2.00 pm Steeps

4.00 pm Senior Chapel Choir Rehearsal (Chapel)

6.15 pm House Receptions

7.30 pm Carol Service (Chapel)**9.00 pm Year 11 Mock Reports: Tutor Deadline**

Wed 15

8.30 am Breakfast

9.30 am House Assemblies

10.00 am Lists**11.15 am Whole School Carol Service (Chapel)**

12.30 pm Christmas Lunch (LRH)

2.00 pm Term Ends

Wed 22

6.30 pm Carols Around the Christmas Tree (LRH Courtyard)

For away fixtures, the first time shown is the departure time from Felsted, with the kick-off time in brackets

School Office No.: 01371 822600 : website: www.felsted.org

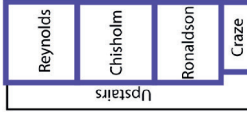
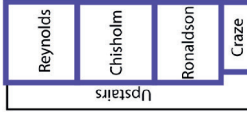
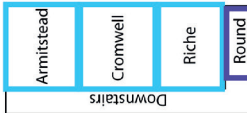

KEY

Biology
Physics
Chemistry
History
Psychology
Geography
Classics
MFL
Maths
Drama & Theatre Stud
English

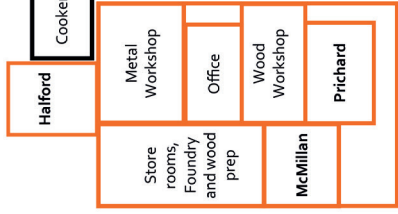

Downstairs (D&T)

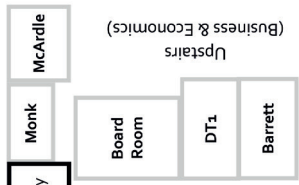

DoFE



Upstairs (Business & Economics)

Computer Centre

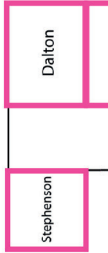
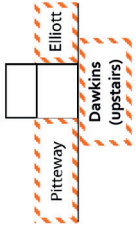

Upstairs

Reekie Building

Downstairs

Upstairs

- Business & Economics
- Art/History of Art
- Religious Studies
- Design Technology
- ICT
- Sport
- Music
- Support for Learning
- ESL

Craven

O'Gorman

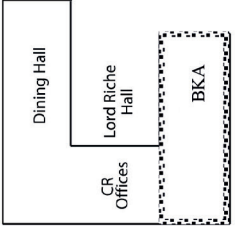
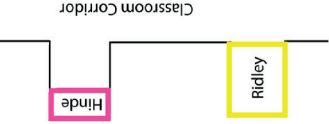

Sixth Form Centre

SFL

EAL

School House (Rear)

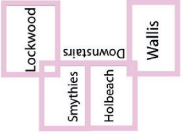
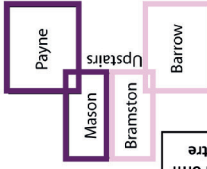

Dutch Block

Rendall

Grignon Hall



R.S. Centre

Ruggles-Brise

Butler

Library

Term Dates

Spring Term 2022: Wednesday 5 January to Friday 25 March (1.00 pm)
Staff INSET Day: Wednesday 5 January
Boarders return by 9.00 pm on Wednesday 5 January
Day Pupils return by 8.15 am on Thursday 6 January

Exeat: 1.00 pm Friday 21 January to
9.00 pm Sunday 23 January (Boarders return)
Lessons re-commence Monday 24 January

Half Term: 1.00 pm Friday 11 February to
9.00 pm Sunday 20 February (Boarders return)
Lessons re-commence Monday 21 February

Exeat: 1.00 pm Friday 11 March to
9.00 pm Sunday 13 March (Boarders return)
Lessons re-commence Monday 14 March

Summer Term 2022: Wednesday 20 April to Friday 1 July
Staff INSET Day: Tuesday 19 April
Boarders return by 9.00 pm on Tuesday 19 April
Day pupils return by 8.15 am on Wednesday 20 April

Exeat: 12.30 pm Saturday 30 April to
9.00 pm on Monday 2 May (Boarders return)
Lessons re-commence Tuesday 3 May

Half Term: 1.00 pm Friday 27 May to
9.00 pm Sunday 5 June (Boarders return)
Lessons re-commence Monday 6 June

Term Dates

Autumn Term 2022:	Monday 5 September to Friday 16 December
	Staff INSET Days: Wednesday 31 August – Friday 2 September
	L6 return by 11.00am on Monday 5 September
	U6 return by 5.00pm on Tuesday 6 September
	Year 9 (& new Year 10) by 11.00am on Tuesday 6 September
	Years 10 & 11 by 8.00 pm on Tuesday 6 September
	Day Pupils return by 8.15 am on Wednesday 7 September
Exeat:	1.00 pm Friday 30 September to 9.00 pm Sunday 2 October (Boarders return) Lessons re-commence Monday 3 October
Half Term:	1.00pm Friday 21 October to 9.00 pm Sunday 6 November (Boarders return) Lessons re-commence Monday 7 November
Exeat:	1.00 pm Friday 25 November to 9.00 pm Sunday 27 November (Boarders return) Lessons re-commence Monday 28 November

Useful Contacts

Reception
(all general enquiries and to report an absence)
01371 822600 reception@felsted.org

Reception is open
Monday to Friday in term time between 8.00 am and 6.00 pm
Saturday between 9.00 am and 1.00 pm (excluding EXEAT)

Academic Office	01371 822678	dhpacademic@felsted.org
Admissions	01371 822605	senioradmissions@felsted.org
	01371 822608	internationaladmissions@felsted.org
Bookshop	01371 822635	bookroom@felsted.org
Bursary/Accounts	01371 822621	burspa@felsted.org
Careers	01371 822668	careersadmin@felsted.org
Catering	01371 822650	caterer@felsted.org
Chaplain	07730 412647	chaplain@felsted.org
Co-Curricular	01371 822694	coadmin@felsted.org
Common Room Secretary	01371 822690	crsec@felsted.org
Deputy Head's Office	01371 822708	dhpa@felsted.org
Director of IB	01371 822666	klw@felsted.org
Director of Sport	01371 822760	csk@felsted.org
Director of Girls' Sport	01371 822752	lw@felsted.org
Director of		
Global Education	01371 822748	dpe@felsted.org
Domestic Services	01371 822630	domestic@felsted.org
Duke of Edinburgh's Award	01371 822768	dlw@felsted.org
Exams	01371 822657	exams@felsted.org
ICT Support	01371 822698	ict@felsted.org
Library	01371 822667	library@felsted.org
Support for Learning	01371 822778	jwh@felsted.org
Tailor's Shop	01371 822636	tailors@felsted.org
Transport	01371 822639	transport@felsted.org