



School Radon Testing Reporting Form

According to Minnesota Statute 123B.571 subd. 3, a school district that has tested its school buildings for the presence of radon shall report the results of its tests to the Department of Health. Please use this form to submit information about the most recent round or cycle of testing conducted for each building.

Instructions

1. Complete one form for each building tested. In this case, a building is defined as an occupied facility with a unique address. This includes administrative buildings.
2. Include this form, raw data (e.g. laboratory report) and a building map.
3. Submit this form when all work is completed for a round of testing. This includes reporting to the school board, and follow-up testing and post-mitigation testing, if applicable.
4. Email information to health.indoorair@state.mn.us.

Contact Information

Name: Wendy German	
Mailing Address: 7362 East Point Douglas Rd S, Cottage Grove, MN 55016	
Phone: 320-224-1908	Email: wgerman@sowash.co.org

Initial Radon Testing Information

School Building Name: Central Park ECFE	
School District & District Number: South Washington County Schools - District 833	
Building Address: 8595 Central Park Place, Woodbury, MN 55125	
Test Kit Manufacturer: Air Chek	Device Name: Pro Chek
Date of Kit Retrieval (DD/MM/YY): 03/29/19	Length of Test (days): 3
How many rooms were tested? 10	
Does the test period include weekends? <input type="checkbox"/> Yes <input checked="" type="checkbox"/> No	
Does the test period include school breaks or holidays? <input type="checkbox"/> Yes <input checked="" type="checkbox"/> No	

SCHOOL RADON TESTING REPORTING FORM

Were all frequently-occupied ground contact rooms tested?¹ Yes No
 If no, did you attempt to test all frequently occupied ground contact rooms, meaning test kits were placed in all these rooms? Yes No

How many rooms had results ≥ 4 pCi/L?: 0

Were the results reported at a school board meeting? Yes No *scheduled for upcoming meeting*

Follow-up Testing, Mitigation, & Post-Mitigation Testing

If one or more rooms tested ≥ 4 pCi/L, please answer the questions below:

How many rooms had follow-up testing?:

Number of rooms with follow-up results	≥ 4 pCi/L:	< 4 pCi/L:
--	-----------------	------------

Of the rooms that had test results ≥ 4 pCi/L, how many rooms were:

mitigated by HVAC balancing or operational changes? :

mitigated by installation of active soil depressurization?:

addressed through other corrective measures?²:

What was the cost of the installation and/or HVAC service work, to mitigate radon? \$

What is the known or anticipated annual operating cost of mitigation (estimate)? \$

After radon mitigation, how many rooms were retested?:

Post mitigation results (# of rooms)	≥ 4 pCi/L:	< 4 pCi/L:
--------------------------------------	-----------------	------------

¹ This includes classrooms, offices, break rooms, laboratories, cafeterias, libraries, auditoriums, gymnasiums, etc. It includes rooms on grade and rooms above unoccupied spaces that are in contact with the ground, such as rooms above storage rooms, crawl spaces, tunnels, and boiler rooms. If only a sample or portion of rooms were tested, then respond with 'no'.

² 'Other corrective measures' could include moving staff out of a room and making a room unoccupied or trying to seal radon entry points.

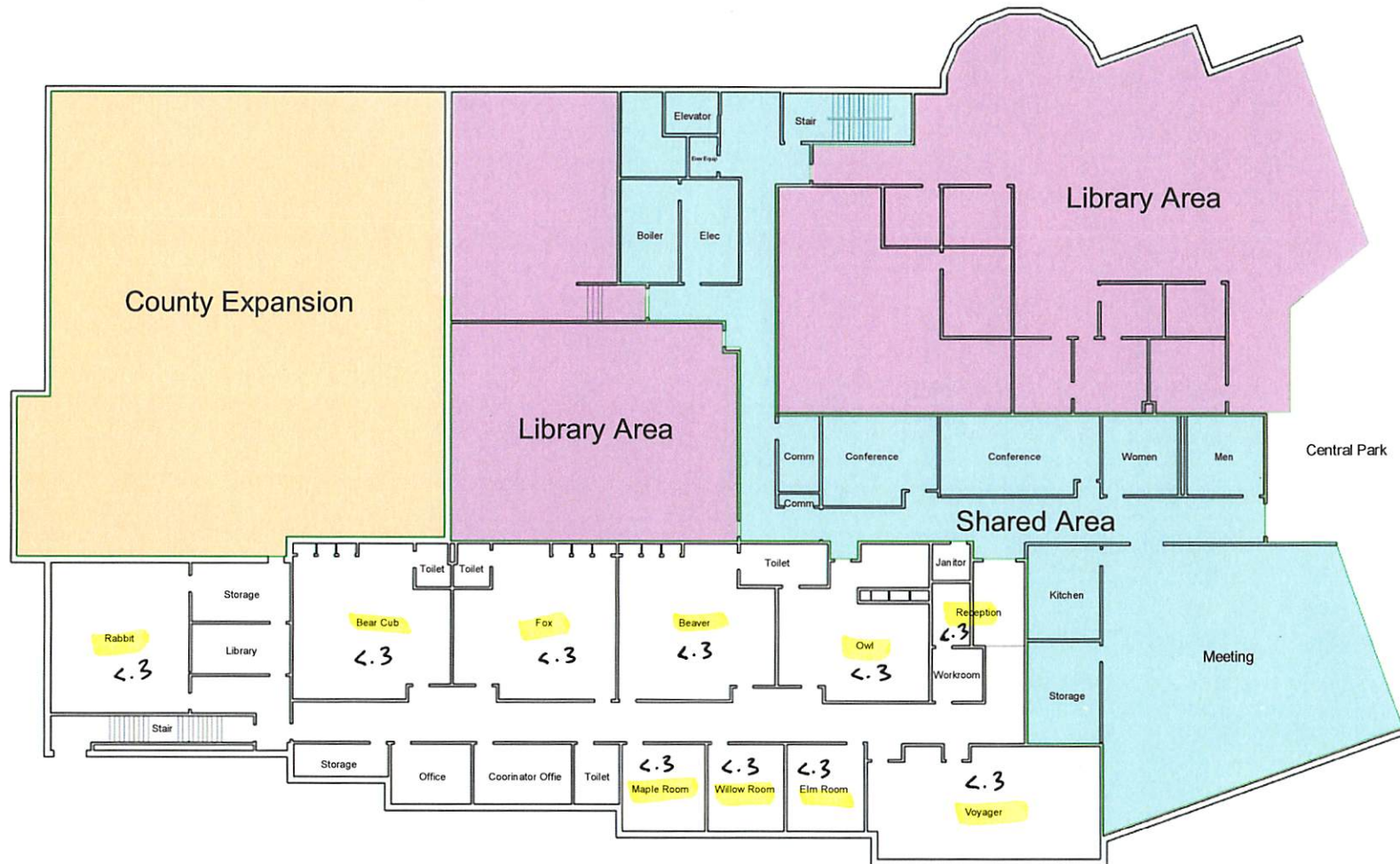

Central Park ECCE

Building Floor Plan

School Year 2018 / 2019

6/6/2017



April 3, 2019

**** LABORATORY ANALYSIS REPORT ****

Radon test result report for:

CENTRAL PARK

Kit #	Room Id	Started	Ended	pCi/L	Analyzed
9197480	BEAR CUB	2019-03-26 @ 12:00 pm	2019-03-29 @ 11:00 am	< 0.3	2019-04-03
9197487	BEAVER	2019-03-26 @ 12:00 pm	2019-03-29 @ 11:00 am	< 0.3	2019-04-03
9197478	ELM ROOM	2019-03-26 @ 12:00 pm	2019-03-29 @ 11:00 am	< 0.3	2019-04-03
9197489	FOX	2019-03-26 @ 12:00 pm	2019-03-29 @ 11:00 am	< 0.3	2019-04-03
9197488	MAPLE	2019-03-26 @ 12:00 pm	2019-03-29 @ 11:00 am	< 0.3	2019-04-03
9197470	OWL	2019-03-26 @ 12:00 pm	2019-03-29 @ 11:00 am	< 0.3	2019-04-03
9197483	RABBIT	2019-03-26 @ 12:00 pm	2019-03-29 @ 11:00 am	< 0.3	2019-04-03
9197490	RECEPTION	2019-03-26 @ 12:00 pm	2019-03-29 @ 11:00 am	< 0.3	2019-04-03
9197479	VOYAGER	2019-03-26 @ 12:00 pm	2019-03-29 @ 11:00 am	< 0.3	2019-04-03
9197477	WILLOW	2019-03-26 @ 12:00 pm	2019-03-29 @ 11:00 am	< 0.3	2019-04-03

Air Chek 1936 Butler Bridge Rd, Mills River, NC 28759-3892 Phone: (828) 684-0893 Fax: (828) 684-8498