

**APPLICATION FOR DESIGNATED AGENT APPROVAL
 REGULATED ACTIVITIES PERMITTED UNDER SECTION 12 OF
 THE INLAND WETLANDS & WATERCOURSES REGULATIONS**

FOR OFFICIAL USE ONLY:	File #: <u>PA 171</u>	Date Received: <u>5/18/21</u>	
	Street Address of Proposed Activity: <u>1130 Farmington Ave</u>		
	Zone: <u>R-10</u>	Acreage/Lot Area _____	Parcel/Lot# _____
	Application Fee: _____	Surcharge Fee: _____	Affidavit Fee: _____

Applicant's Interest in Property: Owner

Description of Proposed Activity: Shed placement (10' x 14')

Distance to nearest wetland soil or watercourse:

<u>155</u>	Feet to wetland soil	<u>140</u>	Total sq ft of disturbance
<u>7700</u>	Feet to watercourse	<u>140</u>	Total sq ft of disturbance

Measures proposed by the applicant to minimize impact on the wetland and/or watercourse:

N/A

The undersigned applicant certifies the following:

- (1) the proposed activity does and will not constitute a significant impact activity as defined in the regulations
- (2) best management practices shall be used so as to ensure continued compliance with governing laws and regulations
- (3) there are no prudent alternatives to the proposed activity that have a less adverse impact on Wetlands and Watercourses.

The undersigned warrants the truth of all statements contained herein and in all supporting documents to the best of his/her knowledge and belief. Furthermore, the applicant agrees that submission of this document constitutes permission and consent to Commission and Staff inspections of the site. *Note: Notice is hereby given the Connecticut Department of Public Health must be notified by applicants for any project located within a public water supply aquifer protection area or watershed area. (CTDPH website at <http://www.dph.state.ct.us>)*

The undersigned also acknowledges their responsibility if this application is approved to publish notice of approval within ten (10) days in a newspaper having a general circulation in town. Applicant will submit proof of publication to the Planning & Zoning Office.

Applicant's Initials acknowledging responsibility for publication M

Noelle Leong
Record Owner's Name

- same -
Applicant's Name

1136 Farmington Ave
Street

Street

West Hartford CT 06107
City State Zip

City State Zip

860-810-9382
Telephone #

Telephone #

Contact Person:

- same -
Name

Applicant's Signature

Street

Signature of Owner/Authorized Agent

City State Zip

Telephone #

noellemarie@hotmail.com
Email Address

Authorized Agent Action:

After considering the standards set forth in Section 12 of the Town of West Hartford Inland Wetlands and Watercourses Regulations, the authorized agent determines the following:

Application Approved: 5/21/26 Designated Agent Signature: 

Conditions of Approval:

Application Denied: _____ Designated Agent Signature: _____

Note: If application is denied the applicant may apply to the Inland Wetlands and Watercourses Agency (IWWA) for a permit.

APPROXIMATE CH. ENCROACHMENT

ESKA M. GINOUVES

M/F

320.57 N17-15-30W

569-13-43W

75.13

138

159

140

50' PORCH

PROPOSED HOUSE

1ST FL. EL. 145.0

5' PORCH

8' PORCH

SMUDGE

1945

40' BL

SAET 1957

SPACED BIT CONC DELIVERY

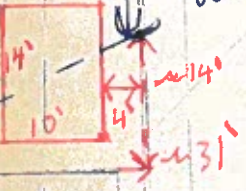

Approximate wetlands boundary

PIPE 61.0 I

CONTRACTOR

48" RCP

54" RCP

142

143

1136 Farmington Ave. Wetlands Map

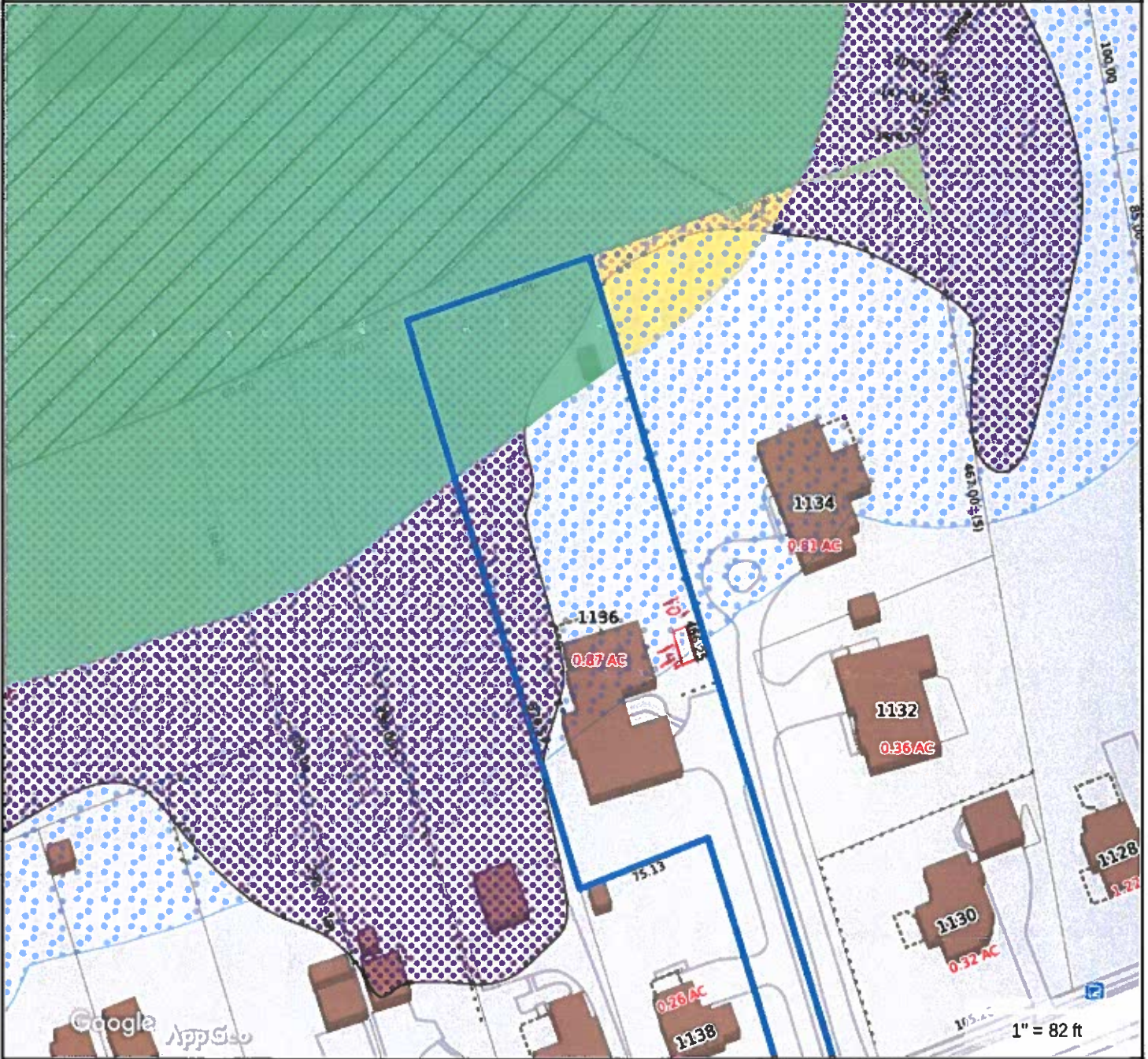

Property Information

Property ID 1891 2 1136 0001
Location 1136 FARMINGTON AVENUE
Owner LEONG NOELLE



MAP FOR REFERENCE ONLY
 NOT A LEGAL DOCUMENT

Town of West Hartford, CT makes no claims and no warranties, expressed or implied, concerning the validity or accuracy of the GIS data presented on this map.

Geometry updated 7/17/2020
 Data updated Daily