

**Auditorium/Music/Science Addition  
Dedication and Open House**



**One O'Clock  
the afternoon of  
Sunday, October 10, 1999**

**Rossville Consolidated School District**

### Board of Education

Bob Combs, President  
Tom Kulupka, Vice President  
Bev Miller, Secretary  
Gary Lee, Past President  
Jane Mohler, Past Secretary  
Ed Butler, Past Member

### District Building Corporation

John (Jack) Spear, President  
Joe Burkle, Secretary  
Ken Miller, Member  
Jim Schlatter, Member  
Craig Michael, Member

### School Administration

Charles E. Whitlock, Superintendent  
Kenneth J. Steeb, High School Principal  
Ken Cushman, Elementary Principal

### Architect & Engineers

The Scholer Corporation  
Lafayette, IN

James E. Wilson, Project Architect  
Dennis Andrews,  
Construction Administrator

### Construction Manager

Construction Control, Inc.  
Fort Wayne, IN

Beth Ann Gibson, Project Manager  
Gary Barbknecht,  
On-Site Construction Manager

**T**he School District would like to express sincerest thanks to the Rossville School Community. Without your support, this facility would not have been possible. Thanks also to everyone who had anything to do with the completion of the project... especially the Board of Education, The Building Corporation, Constructional Control, Inc., The Scholer Corporation and Gary Barbknecht. Gary was at Rossville throughout the construction phase being responsible for coordinating and overseeing the project.

# Program

1:00 pm..... Facility Tours and Refreshments

1:50 pm..... Formal Program - Part 1

Pledge of Allegiance - Brooke Emery

National Anthem - RHS Choir

Introductions - Superintendent Charles Whitlock

Musical Performance - Rossville Choirs

2:30 pm..... Facility Tours and Refreshments

3:25 pm..... Formal Program - Part 2

Introductions

Musical Performance - Rossville Bands

4:00 pm..... New Facility Tours and Refreshments

## Rossville Consolidated School District



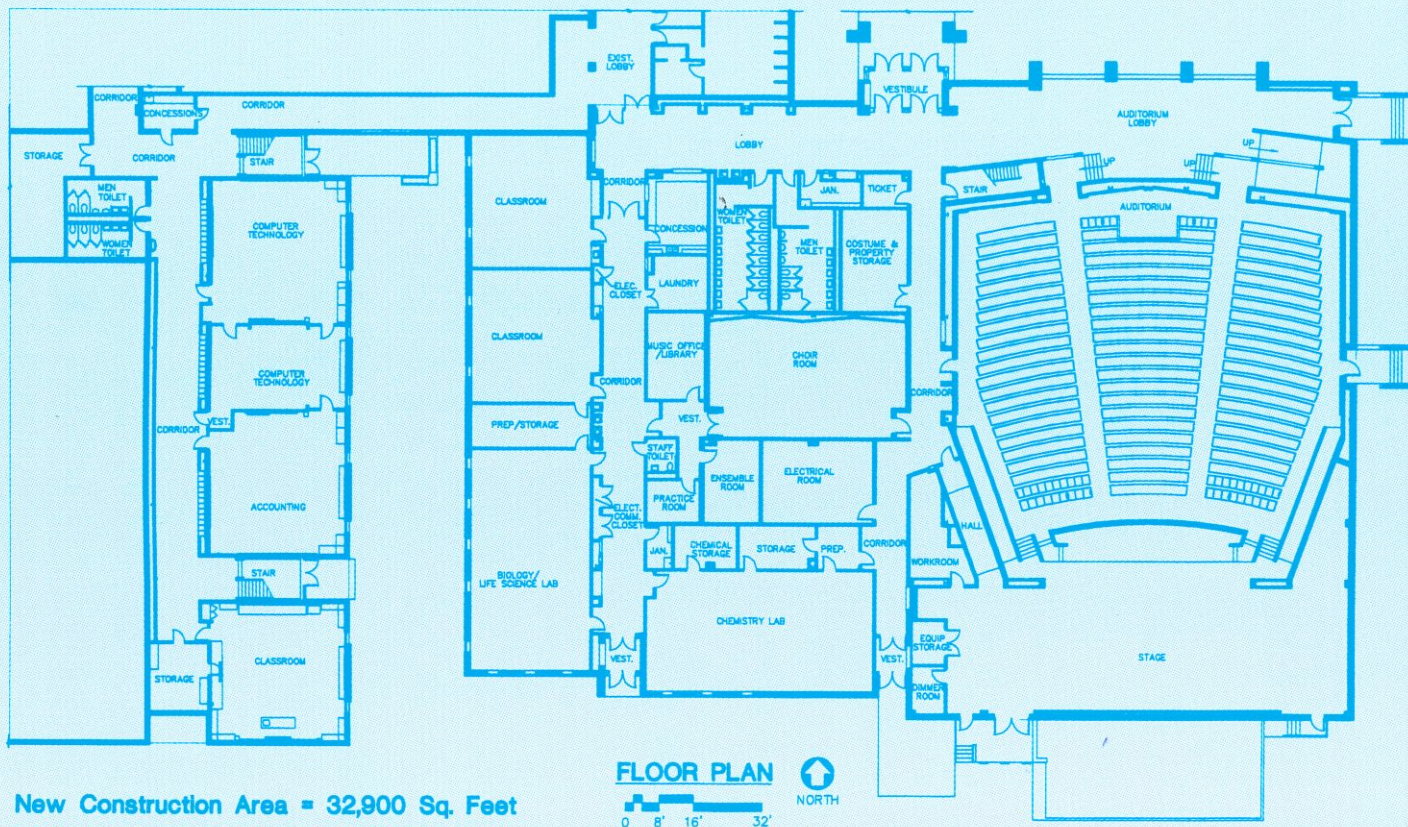

New Construction Area = 32,900 Sq. Feet

Total Construction Cost = \$4,366,000.00

**ACADEMIC AND AUDITORIUM ADDITION**  
**ROSSVILLE CONSOLIDATED SCHOOL DISTRICT**  
 Rossville, Indiana

**SCHOLER CORPORATION**  
 Architecture-Engineering-Interiors  
 Lafayette, Indiana