

COLOR KEY: BUILDING ADDITIONS & RENOVATION:

= EXISTING

= NEW ADDITION (PROPOSED)

= RENOVATIONS - HEAVY

= RENOVATIONS - LIGHT

**Classroom Renovations (Typical Renovations):**  
Existing Classrooms typically Renovated to include:  
-Improved & more flexible use instruction space.  
-Updated furniture; flexible, collaborative, user friendly.  
-Lighting & Mechanical system upgrades.  
-Teaching wall upgrades; white boards replace chalk boards; electrical upgrades for technology & instruction.  
-Upgrades to finishes; walls, floors & ceilings, with respect to historic features/materials where present.

**Toilet Room Renovations:**  
Toilet room renovations for ADA accessibility, updated fixtures & finishes. New stalls, fixtures, & finishes. ADA compliant spaces.

**Classroom / Lab Space Renovations:**  
Existing Classrooms typically Renovated to include:  
-Improved & more flexible use instruction space.  
-Updated furniture; flexible, collaborative, user friendly.  
-Lighting & Mechanical system upgrades.  
-Teaching wall upgrades; white boards replace chalk boards; electrical upgrades for technology & instruction.  
-Upgrades to finishes; walls, floors & ceilings, with respect to historic features/materials where present.

**Multi-Level Accessibility Addition:**  
New vertical Elevator & stair addition to improve building circulation, & provide accessibility to 4th floor classrooms.

**Pool Area Renovation:**  
Re-purpose space for mechanical or educational support space(s) per pool relocation - new addition.

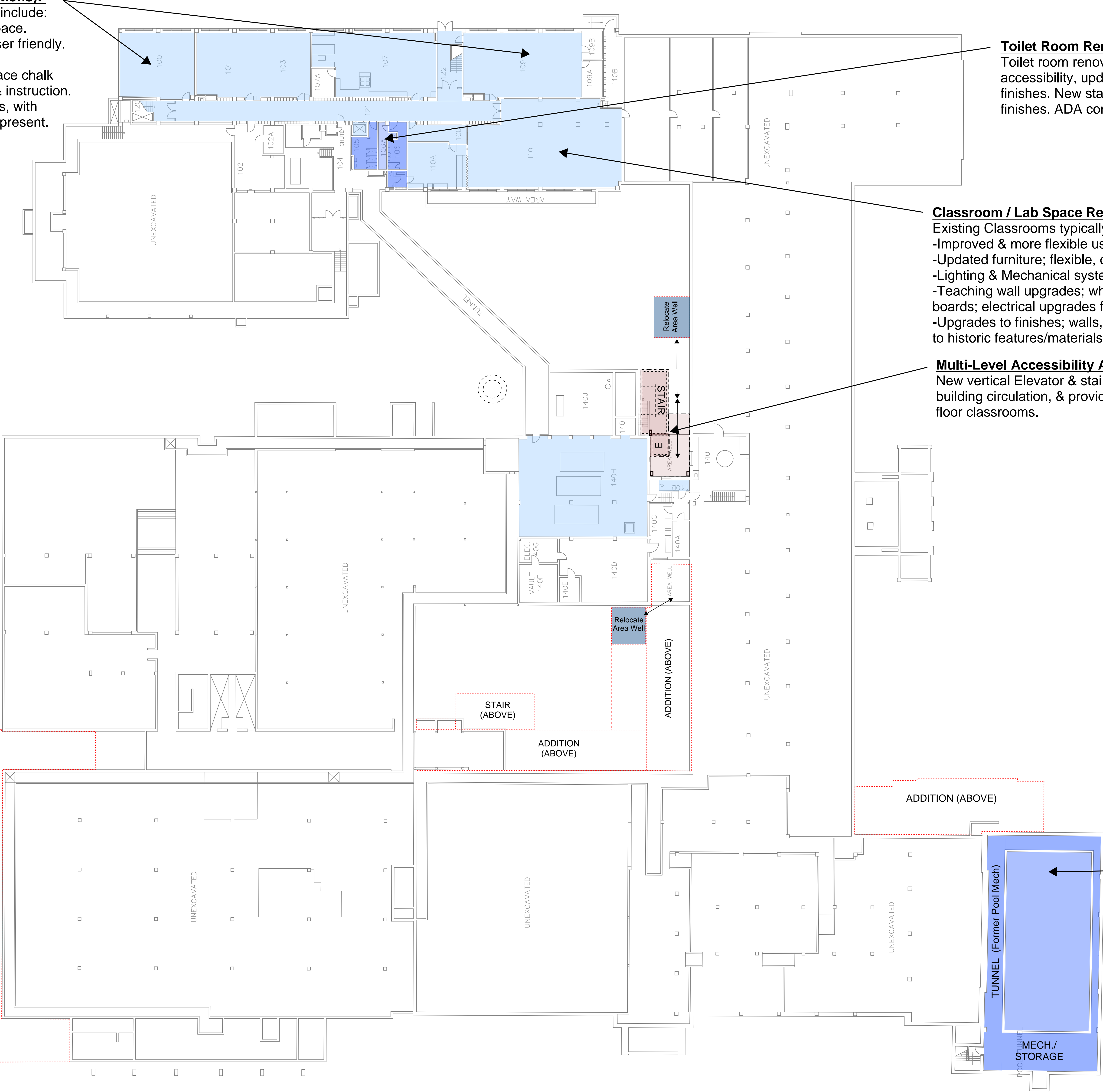

Lower Level Plan

BASEMENT PLAN

Madison West High School



COLOR KEY: BUILDING ADDITIONS & RENOVATION:

- = EXISTING
- = NEW ADDITION (PROPOSED)
- = RENOVATIONS - HEAVY
- = RENOVATIONS - LIGHT

**Small Gym Classroom Conversion & Renovations:**

Convert existing undersized & remote gym & locker room space to new classroom / instructional space(s). Provide classrooms right-sized for curriculum use, with support & collaborative space capabilities. Renovate high volume space & add exterior windows &/or skylights for daylighting.

**Interior Courtyard (Exterior) Space Renovations:**

Existing Courtyard will be reduced by new additions. Paving & landscaping will be revised & enhanced for more user-friendly collaborative space(s); drainage improved.

**Cafeteria Space Renovations:**

Existing Cafeteria space renovated for updated finishes, furniture, ceilings, lighting & mechanical systems.

**Applied Technology Lab & Classroom Renovations:**

Facility spaces will be renovated to update finishes, accessibility, & equipment as feasible, plus:

- Update instructional spaces & technology capabilities
- Improve electrical, lighting, plumbing fixtures/systems
- Improve mechanical & exhaust systems.

**Existing Space Renovations for Instructional Use:**

Restore classroom / lab space for instructional use,by relocating current weight room & athletic dept. spaces.

**New Pool & Athletic Facilities Addition (Lower Level Plan):**

New athletic & support facilities addition to consolidate athletic spaces/facilities on west end of building. New locker room facilities, including gender neutral changing, & added team locker room spaces. ADA compliant gender & GN toilet rooms. Larger weight room & Fitness Center spaces with storage. Athletic & general storage; mechanical space(s). Elevator & Stairs to above levels (2).

**Classroom Renovations (Typical Renovations):**

Existing Classrooms typically Renovated to include:

- Improved & more flexible use instruction space.
- Updated furniture; flexible, collaborative, user friendly.
- Lighting & Mechanical system upgrades.
- Teaching wall upgrades; white boards replace chalk boards; electrical upgrades for technology & instruction.
- Upgrades to finishes; walls, floors & ceilings, with respect to historic features/materials where present.

**Toilet Room Renovations:**

Toilet room renovations for ADA accessibility, updated fixtures & finishes. New stalls, fixtures, & finishes. ADA compliant spaces; gender neutral facilities.

**Classroom Renovations:**

Existing Classrooms typically Renovated:

- Improved & flexible instruction space.
- Updated furniture; flexible/collaborative.
- Lighting & Mechanical system upgrades.
- Teaching wall, finish, & MEP upgrades.

**Multi-Level Accessibility Addition:**

New vertical Elevator & stair addition to improve building circulation, & provide accessibility to 4th floor classrooms.

**Toilet Room Additions/Renovations:**

New ADA compliant & gender neutral toilet rooms more centrally located.

**Circulation & Accessibility:**

New accessible corridor link to elevator; circulation option to congested corridors.

**Welcome Center Renov:**

Relocate W.C. to be more visible, user friendly, & accessible. Renovate space for admin. or student services use.

**Accessibility & Circulation Addition:**

New corridor connectors to improve flow, congestion, supervision, & accessibility.

**Welcome Center (WC) Relocation:**

New Welcome Center with improved visibility, secured entrance, visitor space.

**Multi-Level Accessibility Addition:**

Elevator & stair addition; accessibility to Fine Arts classrooms.

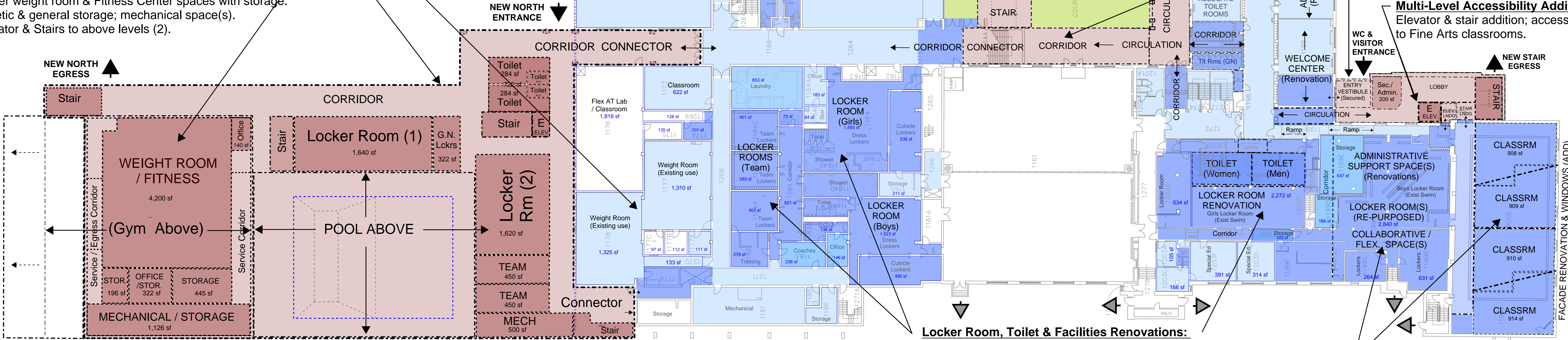

**Locker Room, Toilet & Facilities Renovations:**

Pool & athletic locker rooms to be heavily renovated for accessibility, & to meet current athletic & student use needs. New lockers, fixtures, spaces, & finishes. ADA accessibility, gender neutral facilities, & spaces for Title 9 equity req's.

**Pool & Locker Room Space Renovations:**

Renovate abandoned pool area & locker room spaces for education & admin. usage.

FIRST FLOOR PLAN

Madison West High School

Ash St., Madison, WI

ZAS Project # 180125.00 | 06 - 26 - 2020

**zimmerman**  
ARCHITECTURAL STUDIOS, INC.

2122 W. Mount  
Vernon Avenue  
| Milwaukee,  
WI 53233 |  
zastudios.com



COLOR KEY: BUILDING ADDITIONS & RENOVATION:

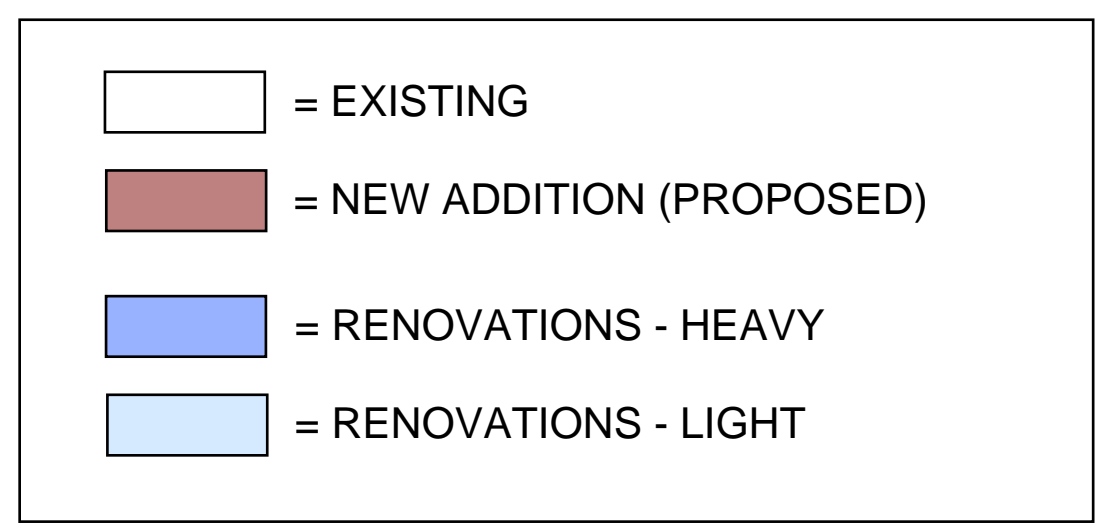

**Connector Bridge Renovation (2nd level):**

Retain existing bridge structure & location. Re-clad structure with new thermally efficient exterior wall panels & glass framing systems. New insulated roof to improve thermal performance; expansion joints. Update finishes.

**Library/LMC Relocation to Original Location:**

Relocate library to original location. Convert & renovate existing library space(s) for multiple new instructional classroom & support spaces. Provide flexible use classrooms with multiple student based instruction capabilities; flexible furniture & enhanced technology capabilities. Collaborative space/connectivity options.

**New Stair & Circulation Addition (to below):**

New corridor connection & egress stair to below. Support office or smaller meeting / collaborative spaces.

**Toilet Room Renovations:**

Toilet room renovations for ADA accessibility, updated fixtures & finishes. New stalls, fixtures, & finishes. ADA compliant spaces; gender neutral facilities.

**Accessibility & Circulation Addition Spaces:**

New Elevator & stair connection for accessibility to levels above & below (2 levels).

**New Pool & Athletic Facilities Addition (Lower Level Plan):**

New athletic & support facilities addition to consolidate athletic spaces/facilities on west end. New south lobby entrance connecting to the existing small lobby space. New 8 lane competition pool with internal diving well, & expanded deck area. Pool locker room facilities, including gender neutral & changing, & small community locker room spaces. Two (2) station dividable gym with full main cross court. ADA compliant gender & GN toilet rooms. Pool equipment storage room, & concessions. Elevator & Stairs to above & below levels (2).

NEW WEST  
EGRESS

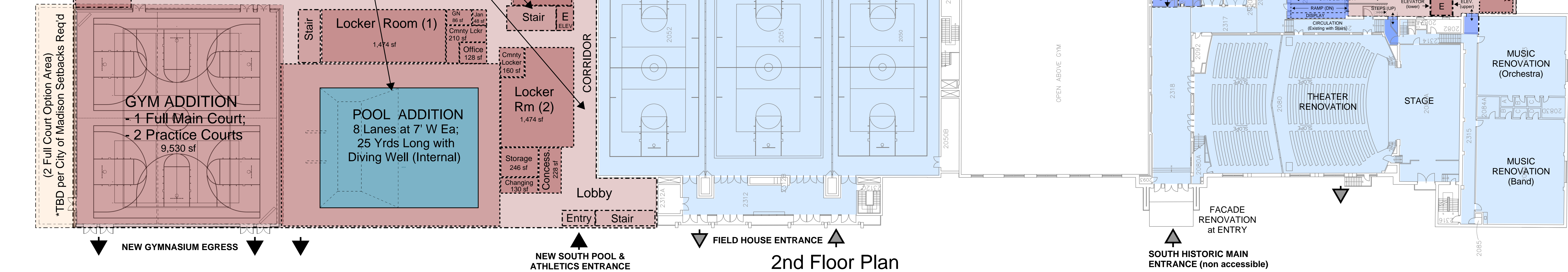

SECOND FLOOR PLAN

Madison West High School



COLOR KEY: BUILDING ADDITIONS & RENOVATION:

= EXISTING

= NEW ADDITION (PROPOSED)

= RENOVATIONS - HEAVY

= RENOVATIONS - LIGHT

**Classroom Renovations (Typical Renovations):**

Existing Classrooms typically Renovated to include:

- Improved & more flexible use instruction space.
- Updated furniture; flexible, collaborative, user friendly.
- Lighting & Mechanical system upgrades.
- Teaching wall upgrades; white boards replace chalk boards; electrical upgrades for technology & instruction.
- Upgrades to finishes; walls, floors & ceilings, with respect to historic features/materials where present.

**Toilet Room Renovations:**

Toilet room renovations for ADA accessibility, updated fixtures & finishes. New stalls, fixtures, & finishes. ADA compliant spaces; gender neutral facilities.

**Classroom Renovations:**

Existing Classrooms typically Renovated:

- Improved & flexible instruction space.
- Updated furniture; flexible/collaborative.
- Lighting & Mechanical system upgrades.
- Teaching wall, finish, & MEP upgrades.

**Multi-Level Accessibility Addition:**

New vertical Elevator & stair addition to improve building circulation, & provide accessibility to 4th floor classrooms.

**Circulation & Accessibility:**

New accessible corridor link to elevator; shared collaborative space (small group).

**Collaborative Space:**

Shared collaborative space (small group).

**Science Classroom Renovations:**

Science rooms to receive "Heavy" Renovations, including:

- Improved/ flexible use instruction space.
- Updated furniture; flexible & collaborative.
- Lighting & Mechanical system upgrades.
- Teaching wall upgrades; white boards; electrical upgrades for technology/instruction.
- Upgrades to finishes; walls, floors & ceilings.
- Lab hoods & specific equipment (as feasible).

**Multi-Level Accessibility Addition:**

Elevator & stair addition; Flex. room.

**New Stair & Circulation Addition (to below):**

New corridor connection & egress stair to below.  
Support office or smaller meeting / collaborative spaces.

**Accessibility & Circulation Addition Spaces:**

New Elevator & stair connection for accessibility to levels below (2 levels below).

**New Pool & Athletic Facilities Addition (Upper Level Plan):**

New athletic & support facilities addition to consolidate athletic spaces/facilities on west end. Spectator seating balcony & observation deck with retractable bleachers (flexible floor use). New ADA compliant gender & GN toilet rooms. Coaches observation / meeting room. Athletic storage; mechanical. Elevator & Stairs to above levels (2).

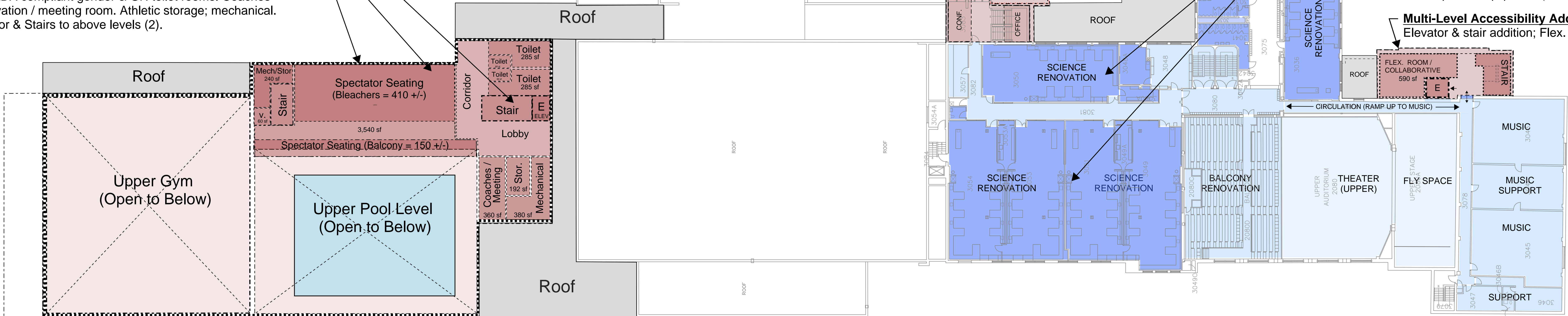

NEW POOL & ATHLETIC FACILITY ADDITION

3rd Floor Plan



COLOR KEY: BUILDING ADDITIONS & RENOVATION:

= EXISTING

= NEW ADDITION (PROPOSED)

= RENOVATIONS - HEAVY

= RENOVATIONS - LIGHT

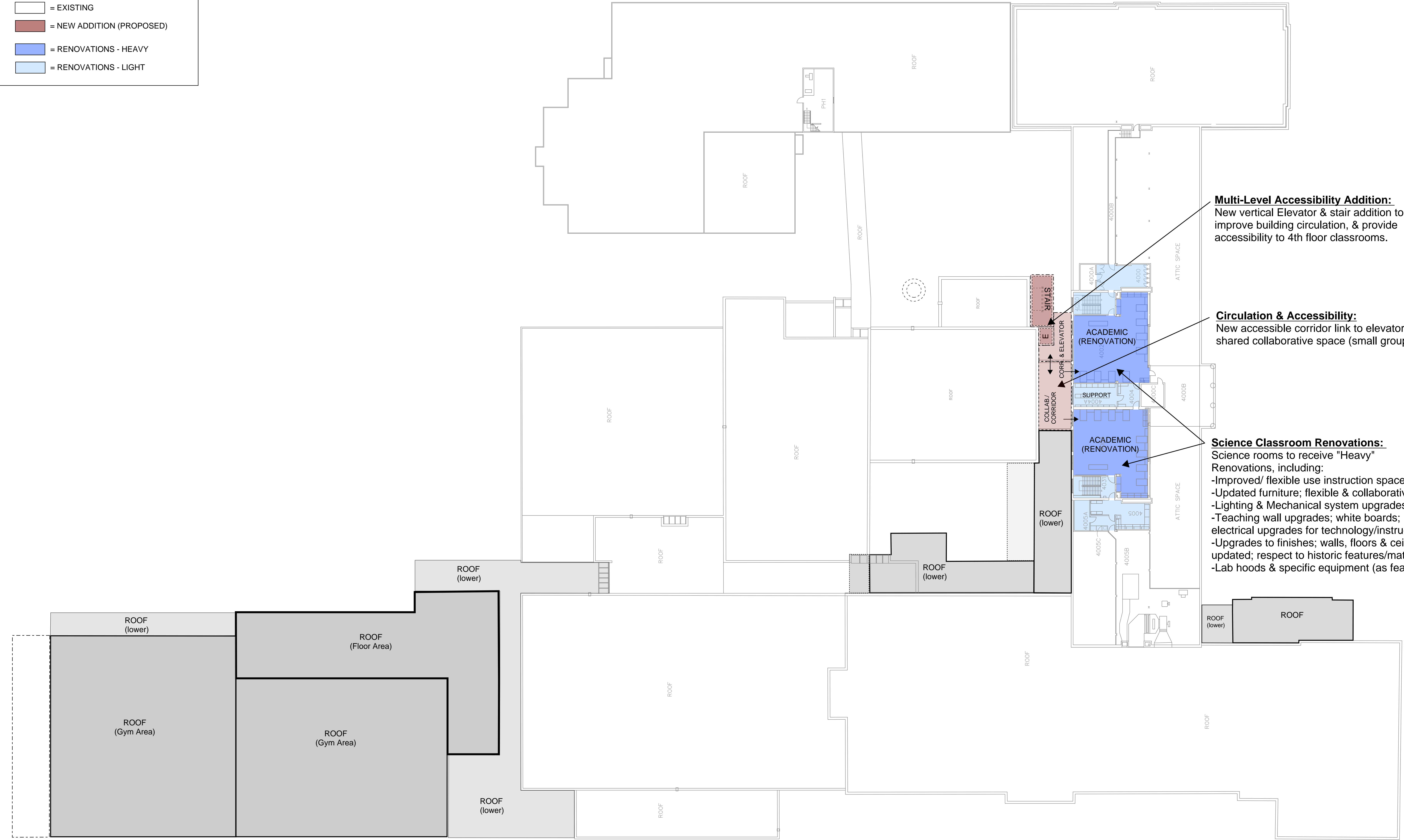

**Multi-Level Accessibility Addition:**  
New vertical Elevator & stair addition to improve building circulation, & provide accessibility to 4th floor classrooms.

**Circulation & Accessibility:**  
New accessible corridor link to elevator; shared collaborative space (small group).

**Science Classroom Renovations:**  
Science rooms to receive "Heavy" Renovations, including:  
-Improved/ flexible use instruction space.  
-Updated furniture; flexible & collaborative.  
-Lighting & Mechanical system upgrades.  
-Teaching wall upgrades; white boards; electrical upgrades for technology/instruction.  
-Upgrades to finishes; walls, floors & ceilings updated; respect to historic features/materials.  
-Lab hoods & specific equipment (as feasible).

4th Floor Plan