

2020 Referenda

Future Ready

MADISON METROPOLITAN SCHOOL DISTRICT 

Public Information Presentation



Excellence
Belonging Creativity
Racial Equity & Social Justice
Voice Focus



How many schools scored in each category?

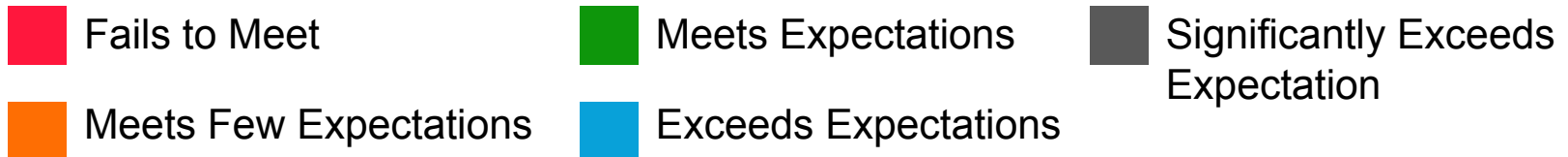
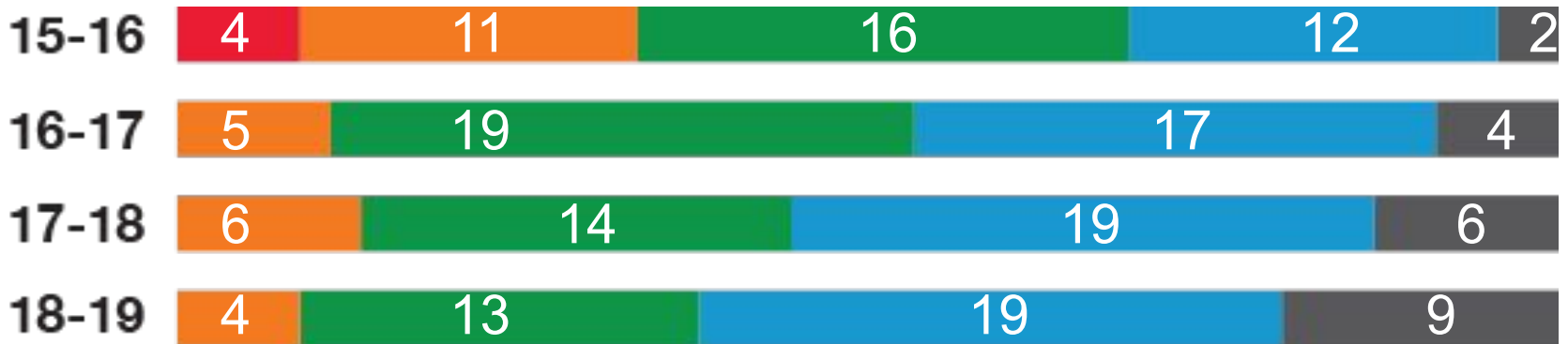

You spoke, we listened...



50 Input Sessions

Includes Targeted, Informational and Open Community



4456 Responses
to Community Survey

Includes MMSD families, students, staff and community members



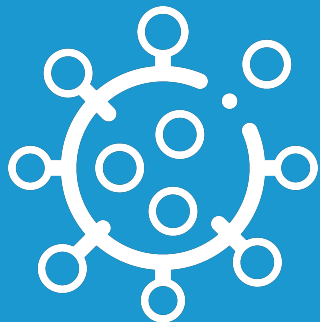

In light of COVID-19, we have deeply explored whether this is the right time to ask our community for this investment. We know we're living in a different world than we were one year ago.



Q1 ▶



\$33M Operating Referendum

Continue our momentum in equitable opportunities, rich programming and retaining high-quality staff

Q2 ▶



\$317M Facilities Referendum

Most pressing building projects in support of our academic vision



Question 1



Operating Referendum



Shall the Madison Metropolitan School District, Dane County, Wisconsin be authorized to exceed the revenue limit specified in Section 121.91, Wisconsin Statutes, by \$6,000,000 for 2020-2021 school year; by an additional \$8,000,000 (for a total \$14,000,000) for 2021-2022 school year; by an additional \$9,000,000 (for a total of \$23,000,000) for the 2022-23 school year; and by an additional \$10,000,000 (for a total of \$33,000,000) for the 2023-2024 school year and thereafter, for recurring purposes consisting of operational and maintenance expenses?



An operating referendum can accelerate our positive academic momentum

Recurring revenue authority could allow for investments in:



Full-Day 4K



Daily world
language
in middle
school



Programming
in arts, music,
and science/
technology



Attracting
and
retaining
high-quality
teachers



Strategic equity
projects, such as: Early
College STEM Academy,
historically accurate and
culturally relevant curriculum,
restorative justice, etc.



Unknown revenues from the state...

Now more than ever public education funding is at risk and local control will matter.



Future Ready

Ask: \$33M Operating Referendum

Yr 4 estimated total mill rate impact \$0.96



\$27 per year incremental
increase for every \$100,000 in
home value over 4 years



Question 2

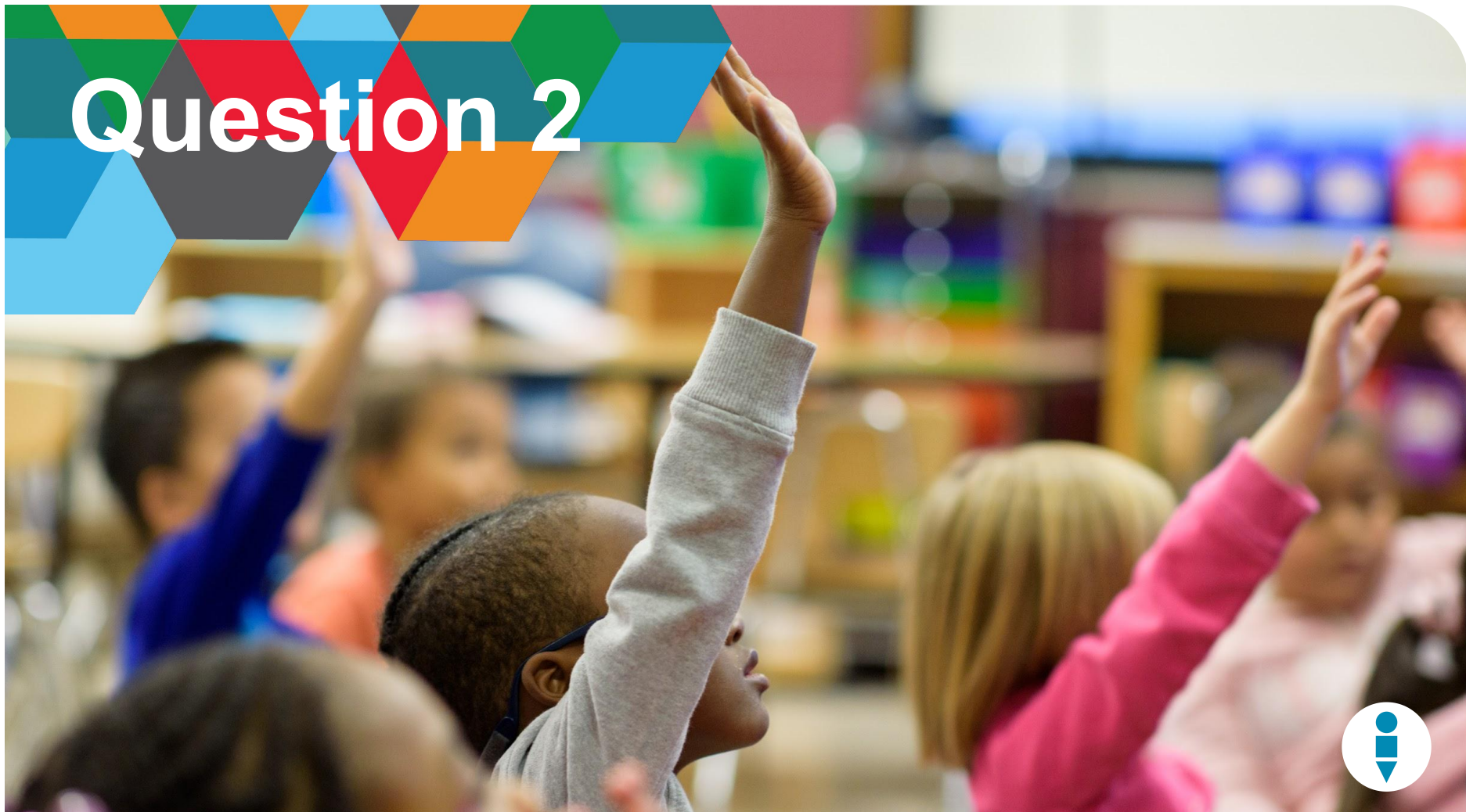



Q2 ► Facilities Referendum

Shall the Madison Metropolitan School District, Dane County, Wisconsin be authorized to issue pursuant to Chapter 67 of the Wisconsin Statutes, general obligation bonds in an amount not to exceed \$317,000,000 for the public purpose of paying the cost of a school building and facility improvement project consisting of: renovations and additions at all four high schools, including safety and security improvements, plumbing/heating and cooling, science labs and classrooms, athletic, theatre, and environmental sustainability improvements; land acquisition for and construction of a new elementary school located near Rimrock Road to relocate an existing elementary school; remodeling the district owned Hoyt School to relocate Capital High; and acquisition of furnishings fixtures and equipment?

A \$317M facilities referendum will allow us to:

Invest in significant renovations that will transform learning environments in our four main high schools, we will impact a third of our students and every attendance area.

Move our Capital High Eastside and Westside students out of temporary spaces not meant for high school instruction into a school building we own, Hoyt School, and renovate Hoyt to meet their needs.

Build a new elementary school in the Rimrock area to give underserved students and families a much-needed school in their neighborhood.

- Moving out of a leased school space in Monona, saving on lease costs

Reduce the carbon footprint of our facilities and operations, leading to a future with cleaner and operationally more efficient facilities.

Future Ready

Ask: **\$317M**

Facility Referendum

- Support environmentally sustainable projects with positive returns on investment.
 - \$2M increase on facilities ask for environmental projects has no material impact on the mill rate.
- Average mill rate increase is estimated to be \$0.44, paid off over 22 years.



\$50 per year for
every \$100,000
in home value.



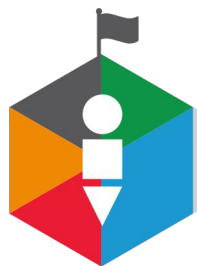

2020 Referenda

Future Ready

Q1 & Q2 Ask: \$350M

Yr 4 estimated total mill rate impact \$1.51



\$60 increase for every \$100,000
in home value in yr 1,
accumulates to **\$130** in yr 4.



2020 Referenda

Future Ready

Q1



Operating

Q2



Capital





2020 Referenda

Future Ready





REFERENDUM APPENDIX

Additional information as needed

Investments in public schools has not recovered from 2011-13; prior to COVID-19 forecasting predicted less than 2% State revenue growth ongoing, now 20-21 and 21-22 forecasting is less than 1%.

History of Annual Change in Revenue Limit + 'Per-Pupil Categorical Aid'

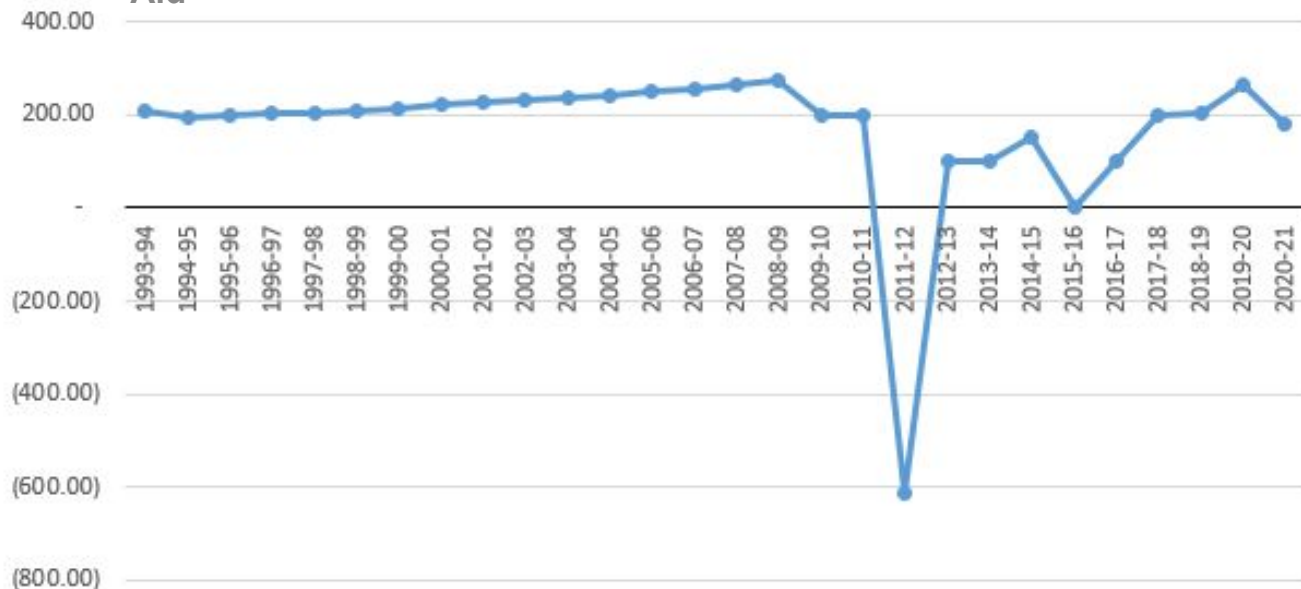



MMSD facing \$40M+ in budget reductions, or 100 teachers lost per year, over the next 4 years. Projections might get worse.

	2020-21	2021-22	2022-23	2023-24	2024-25
	State Budget	2021-23 State Budget unknown	2021-23 State Budget unknown	2023-25 State Budget unknown	2023-25 State Budget unknown
General Fund Revenues (Major Sources):					
(State) Revenue Limit Adjustment: <i>Assumes +\$200/pupil in future budgets; 27,000 FTE</i>	\$4.8 M	\$5.4 M	\$5.4 M	\$5.4 M	\$5.4 M
(State) Categorical Aid per pupil: <i>Assumes 27,000 FTE</i>	\$0.0 M	\$0.0 M	\$0.0 M	\$0.0 M	\$0.0 M
(State) Special Education Reimbursement Aid Increase	\$2.8 M	\$0.0 M	\$0.0 M	\$0.0 M	\$0.0 M
(Local) Recurring Referenda Authority:	\$0.0 M	\$0.0 M	\$0.0 M	\$0.0 M	\$0.0 M
Recurring Revenue Subtotal:	\$7.6 M	\$5.4 M	\$5.4 M	\$5.4 M	\$5.4 M
Budget Components:					
+ Steps / Lanes Increases: <i>Includes 15% payroll benefits (FICA, etc.)</i>	\$5.3M	\$5.3M	\$5.3M	\$5.3M	\$5.3M
+ Base Wage %: <i>1% 20/21; Assumes 2% ongoing</i>	\$2.5 M	\$4.7 M	\$4.8 M	\$4.9 M	\$5.0 M
+ Health Insurance Premium Increase: <i>Assumes 0% 20-21; 4% increase 21-22 forward</i>	\$0.0 M	\$3.4 M	\$3.4 M	\$3.4 M	\$3.4 M
+ Strategic Equity Projects:	\$1.0 M	\$2.0 M	\$2.0 M	\$2.0 M	\$2.0 M
+ Required Allowances (OE, 2x, etc.)	\$2.3 M	\$2.5 M	\$2.5 M	\$2.5 M	\$2.5 M
Expenditure Subtotal	\$11.1 M	\$17.9 M	\$18 M	\$18.1 M	\$18.2 M
Under these assumptions, the GAP ranges:	(\$3.5 M)	(\$12.5 M)	(\$12.6 M)	(\$12.7 M)	(\$12.8 M)

2019-20 MILL RATE COMPARISON Dane County School Districts

Fund

- 10 GENERAL FUND
- 38 Non-Referendum Debt Service Fund
- 39 Referendum Approved Debt Service Fund
- 41 Capital Expansion Fund
- 80 COMMUNITY SERVICE FUND

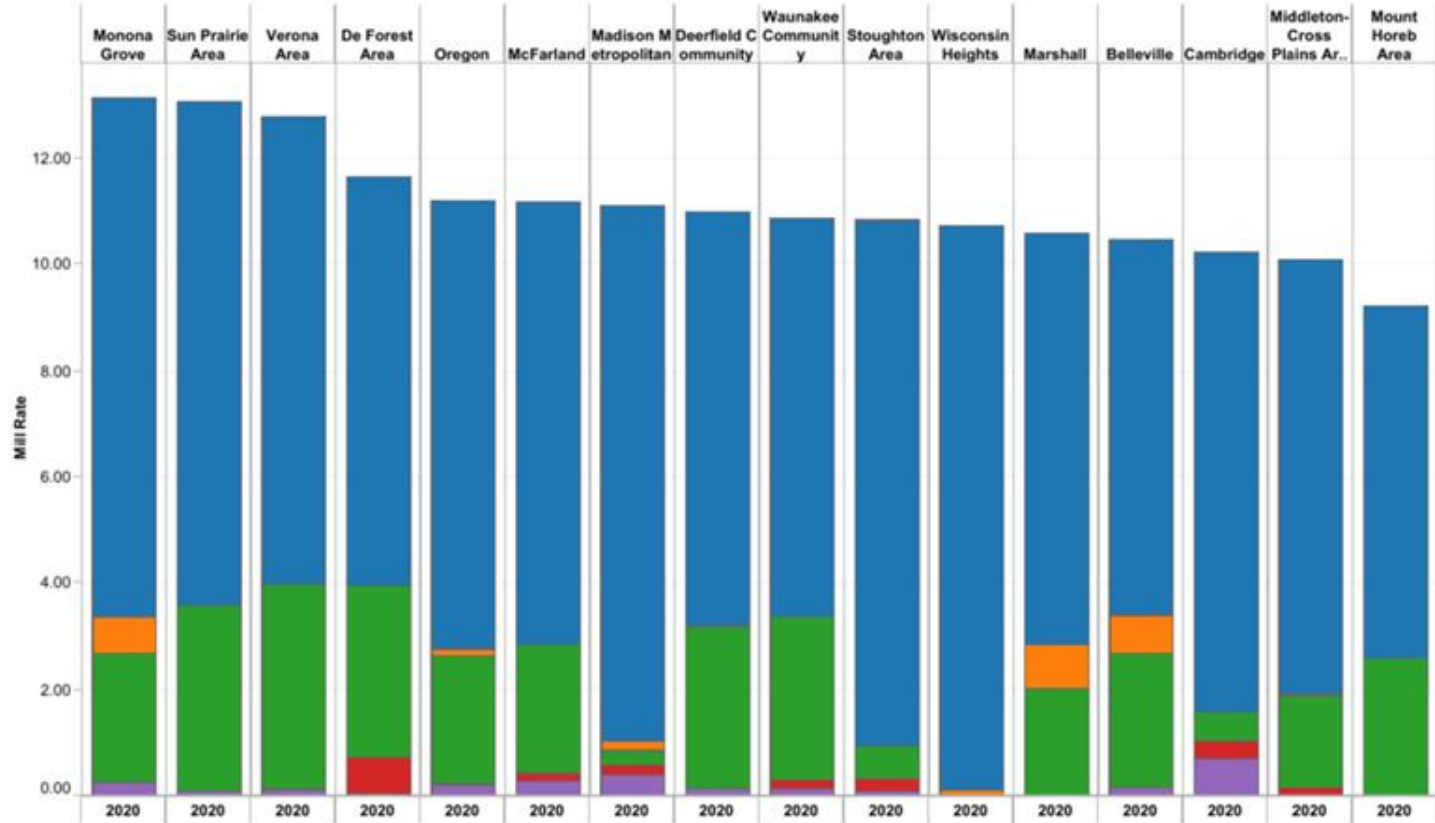

Cumulative reduction from October proposal, \$312 for the ave. homeowner.

	Facilities	Operating Yr 4	Total
Starting Ask	\$200/year	\$346	
Revised Ask (\$6M)	\$140/year	\$328	
Cumulative Savings (over 4 years)	\$240	\$72	\$312

Based on community feedback, restructured the capital debt to gradually implement the bond repayments over time AND decreased the 20/21 operating referendum to lower first year increases.

Facilities + Operations Financial Impact Mill Rate Projections

Mill Rate by Type

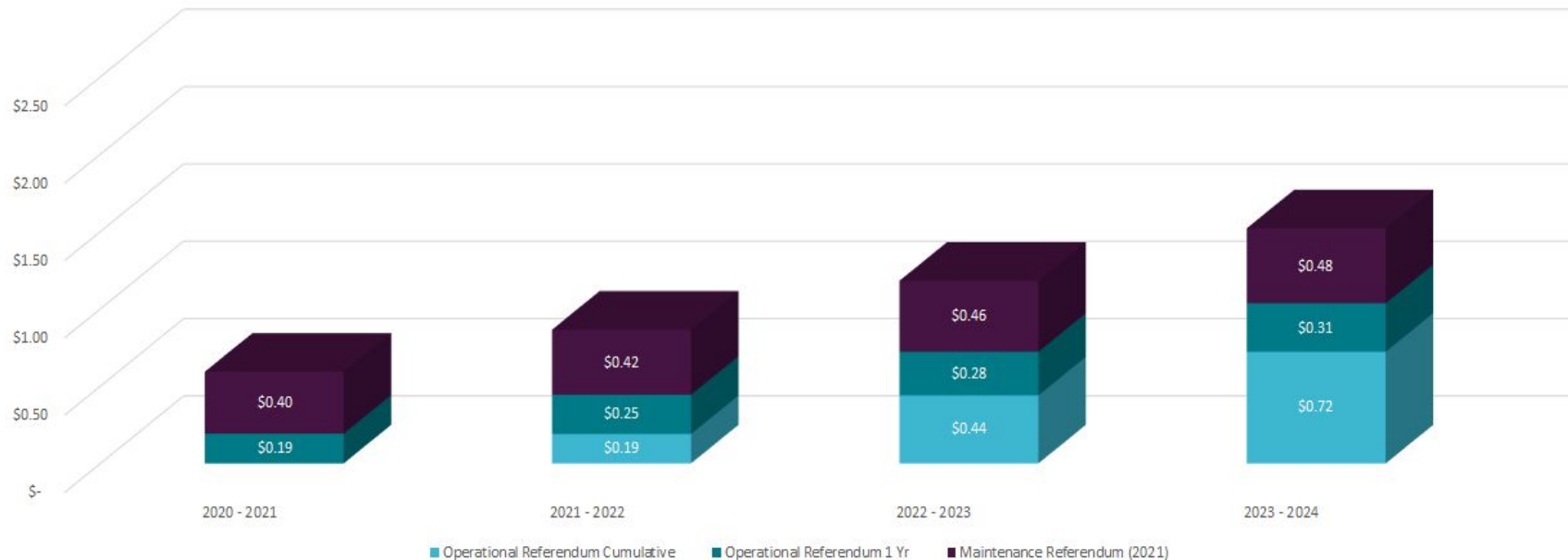

Facilities + Operations Financial Impact Average Homeowner Property Tax Projections

Average Home Impact

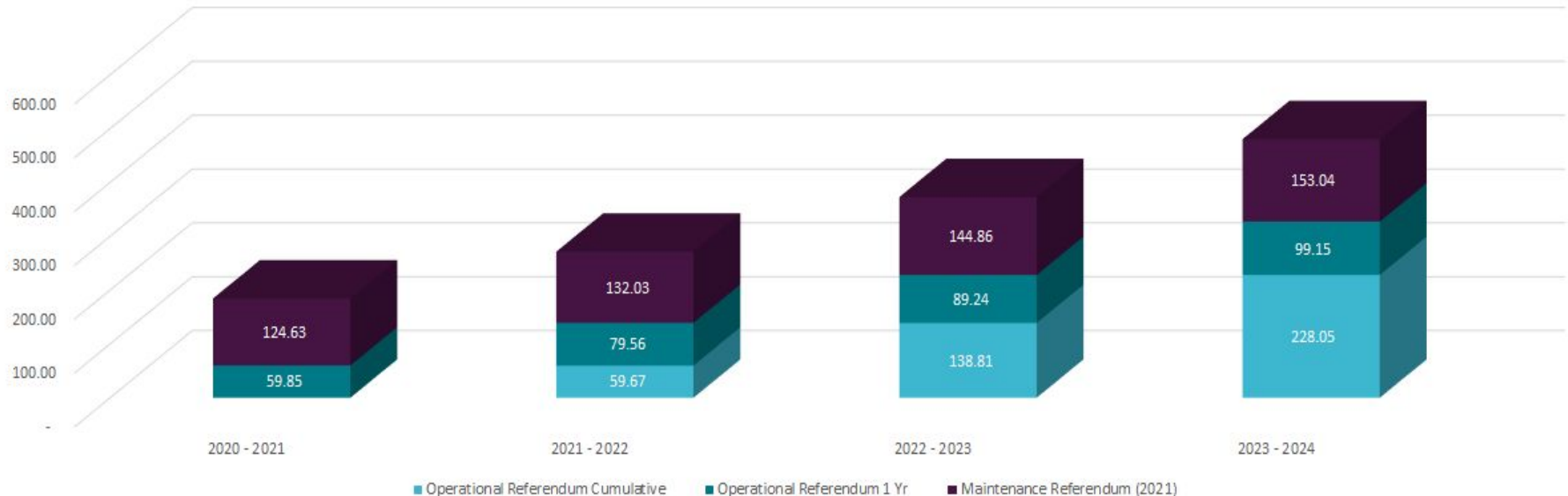

MMSD Facility Condition Index - 2017

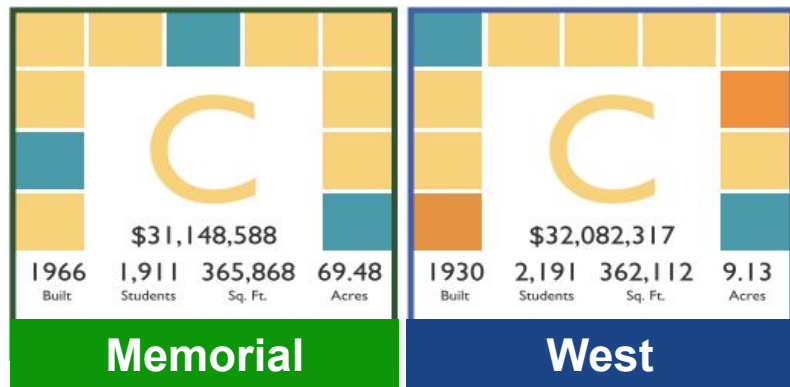
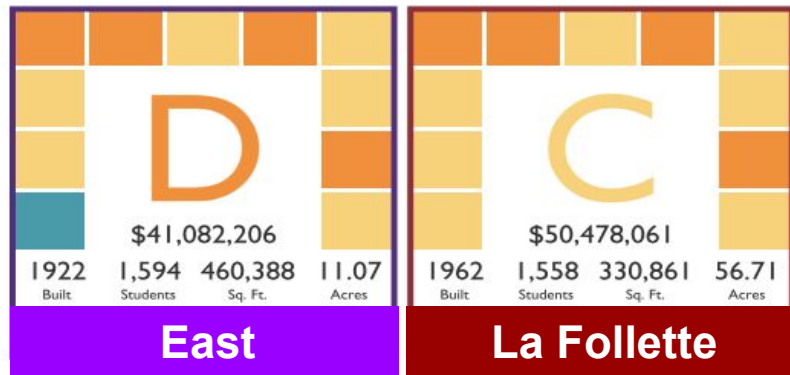
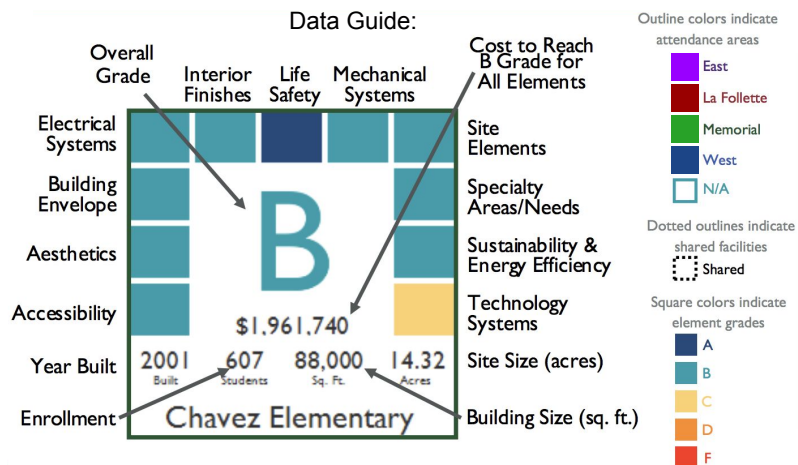

West HS - Additions and Improvements

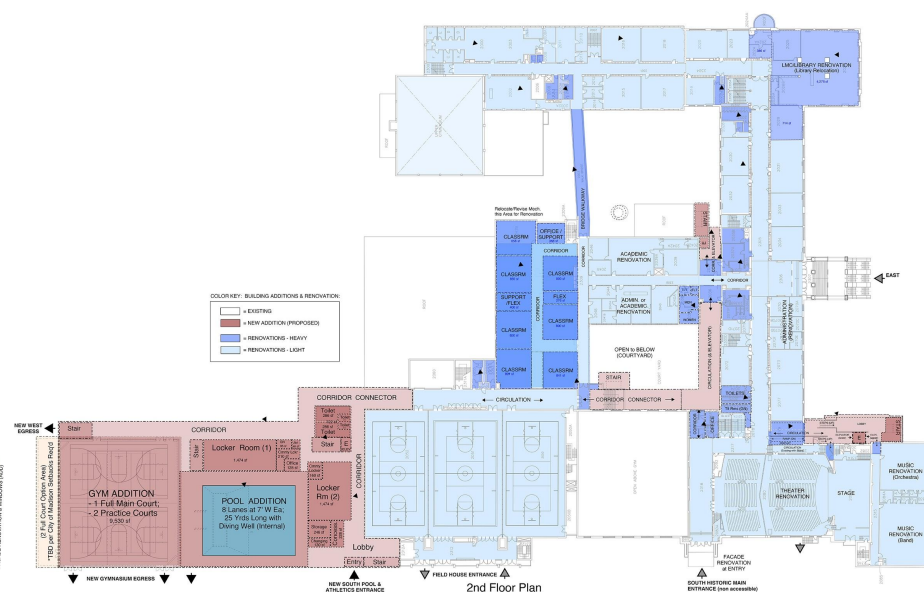
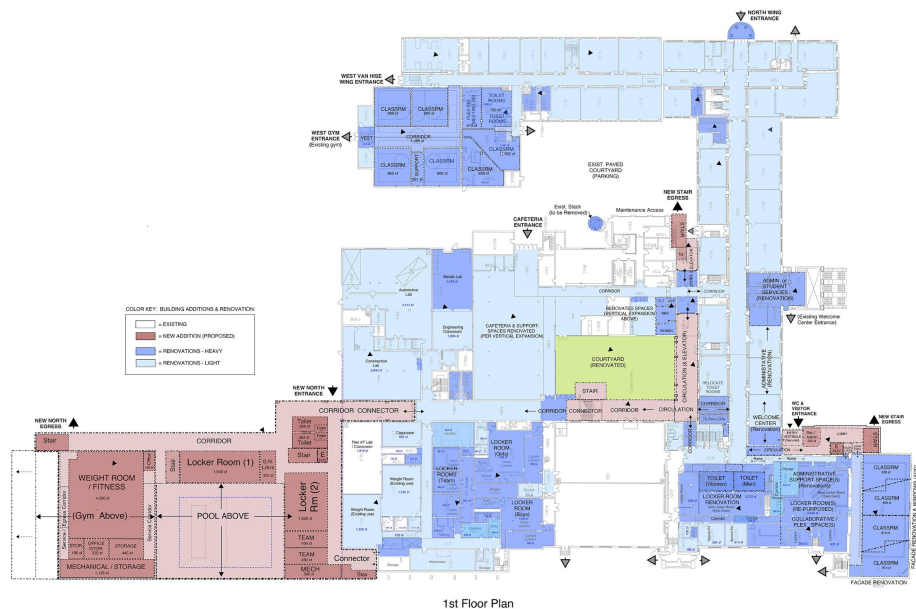

West HS - Historic Ash St. Entrance



MADISON METROPOLITAN
SCHOOL DISTRICT 

Link to [Full Schematic](#)

Memorial - Fine Arts Center and Common Spaces

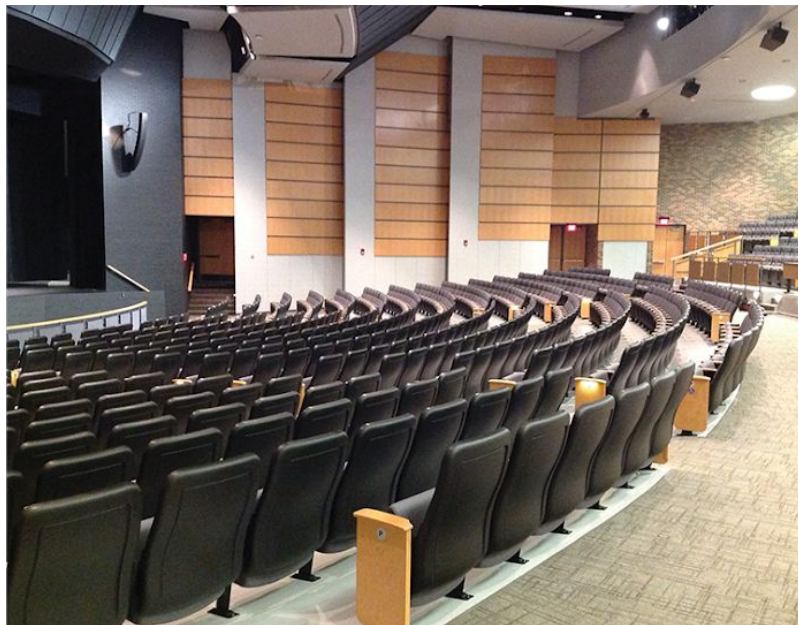

La Follette HS - Additions and Improvements

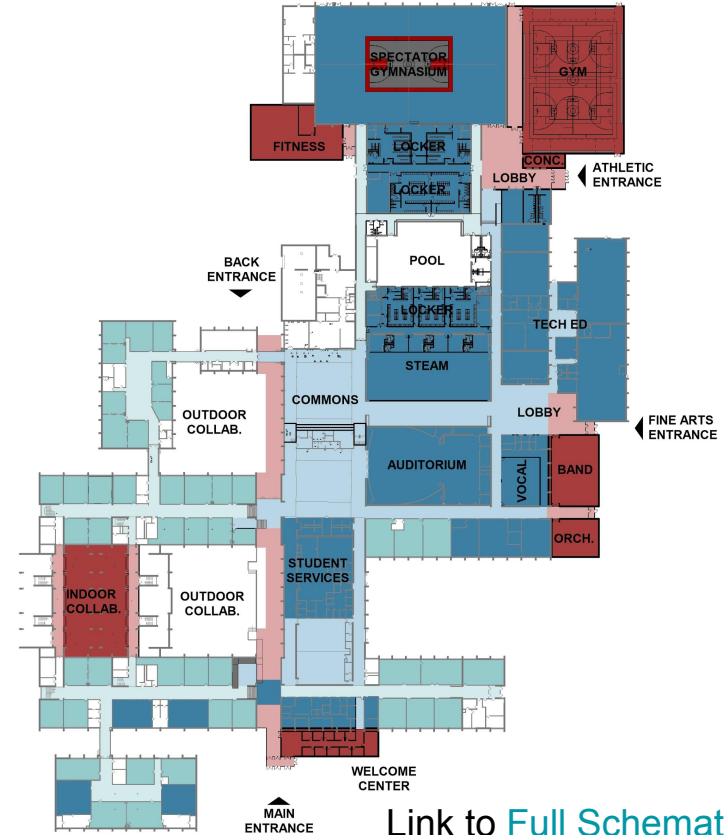
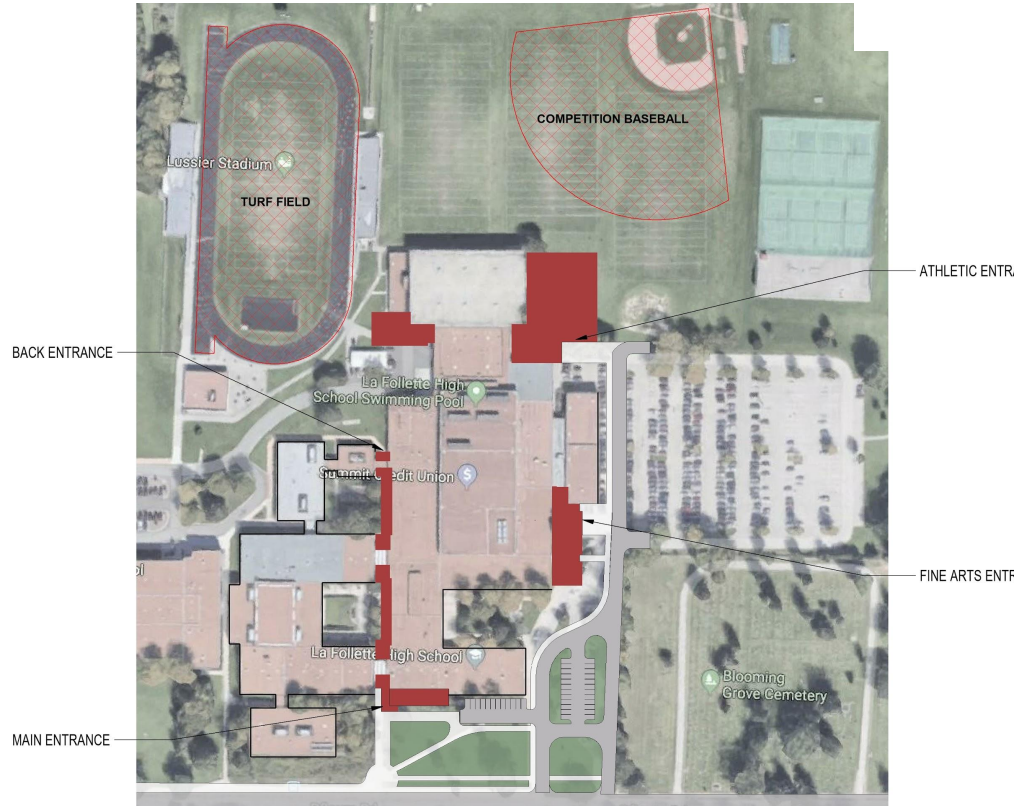

Link to [Full Schematic](#)

La Follette HS - New Entry and Common Space



East HS - Renovations & Improvements

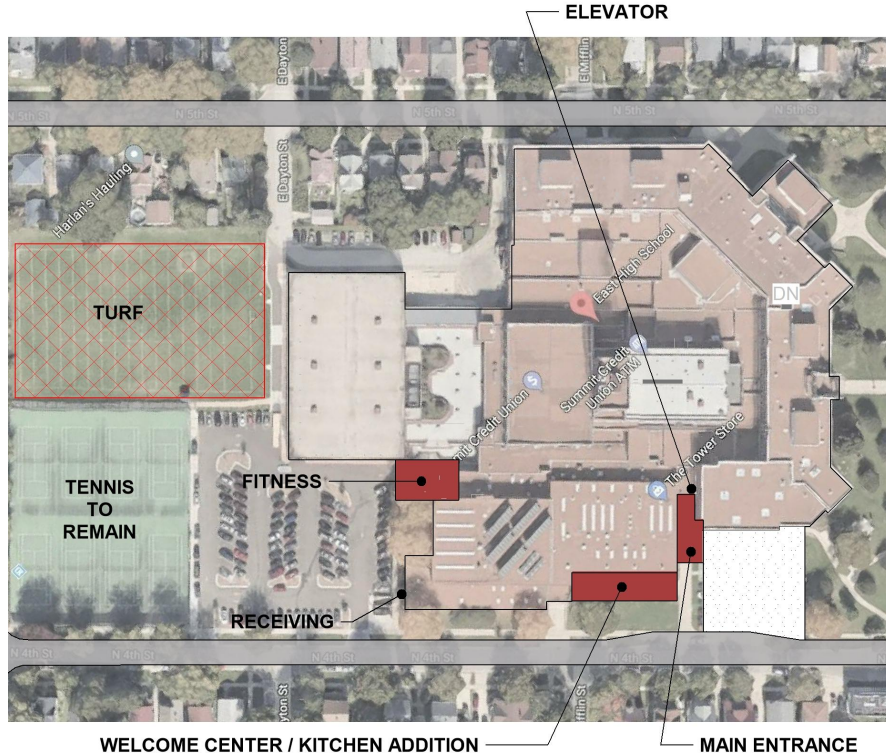

Link to [Full Schematic](#)

East HS - Renovations & Improvements

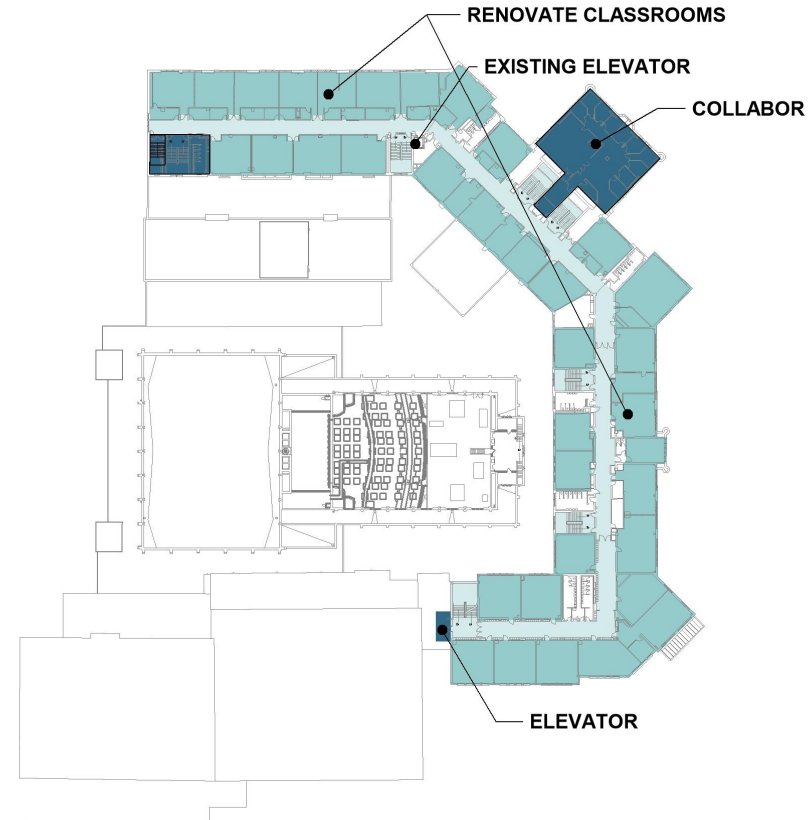
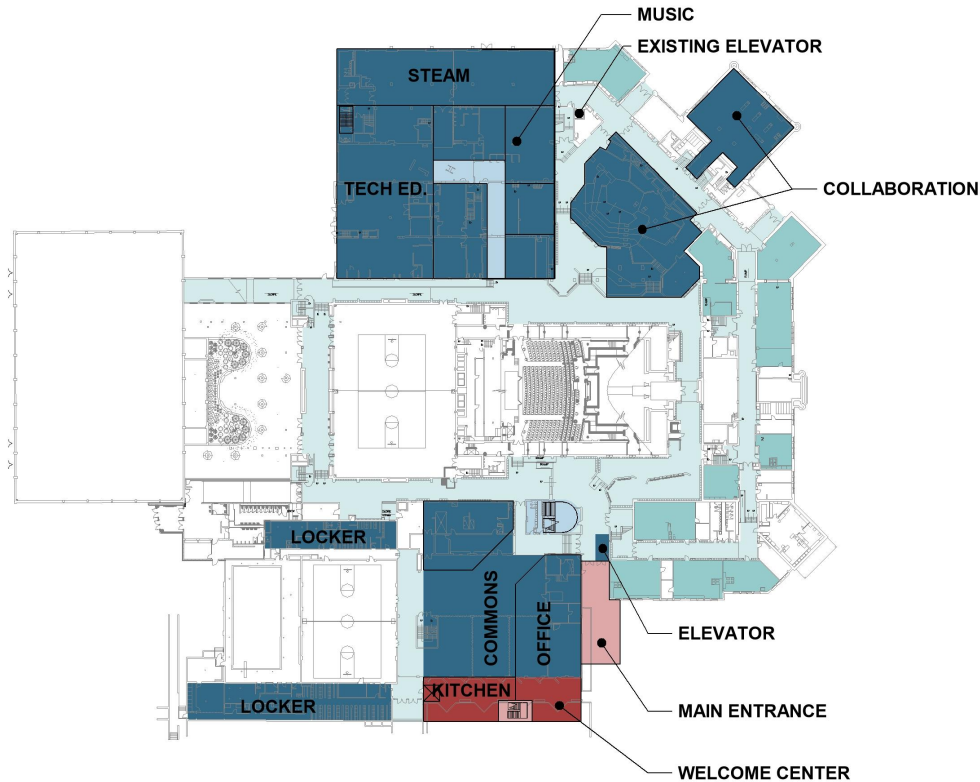

East HS - Renovations & Improvements

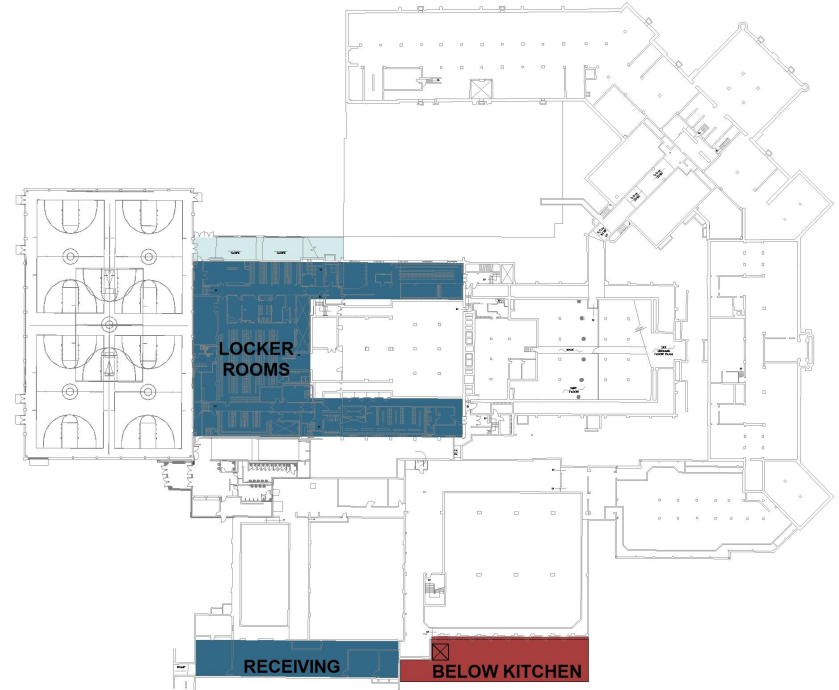

A New Home for Capital High

Student-driven vision for future of Capital High Unifying Capital High East and West

- One site would improve Capital High's ability to serve its students
- Hoyt School would allow Capital to serve more students over time, up to 300
- Hoyt School would be renovated for twenty-first century learning: Enhanced instructional spaces (science & arts labs), large common areas, full gym, industrial kitchen, and onsite childcare
- Kitchen would allow for upgraded lunch options



Elementary Strategy

Students and Projected Development in Rimrock area

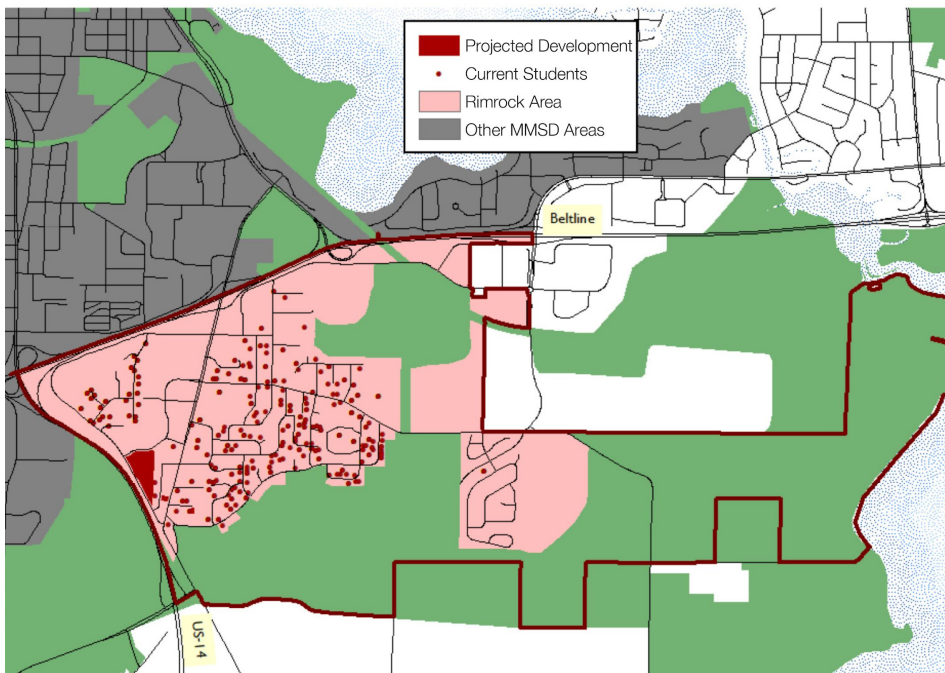

We believe it is time to build a **new elementary school in the Rimrock area.**

This area is home to 150 Nuestro Mundo Community School students and 260 Frank Allis Elementary School students.

We're looking toward actions that would benefit both Nuestro Mundo students and Frank Allis students.

Current MMSD Efforts:

- Geothermal Site
- Solar Projects in progress
- Fleet Purchasing
- Outdoor Learning Spaces
- Sustainable Food Practices





Referendum Planning: Improving Sustainable and Healthy High Schools

Environmentally Responsible Improvements

- Energy related improvements and renewable energy
- Water use and waste management
- Integrated learning opportunities

Focus on Student and Staff Wellness

- Wellness spaces
- Optimized (health-based) learning environments

Community Friendly

- Design informed by all stakeholders

Existing Conditions



Fluorescent Lights and Poorly Insulated Ceiling Enclosure



1947 Kewanee Steam Boiler

Existing Conditions



1960's Vintage Air Handling Unit and
Poorly Insulated Windows



Dated Inefficient Plumbing Fixtures

Components of Current Master Plan



LED Lighting/Natural Light
Energy Efficient Design



100 kw PV (Photovoltaic) Array

Components of Current Recommendations

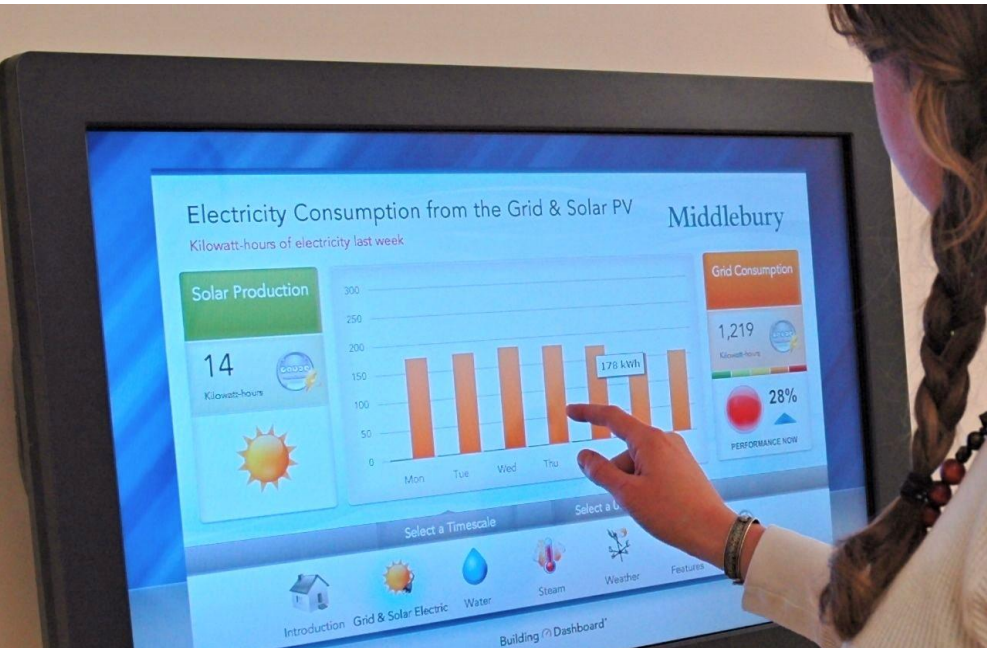

Integrated Learning Opportunities



New Efficient Mechanical Systems

Additional Scope Considerations

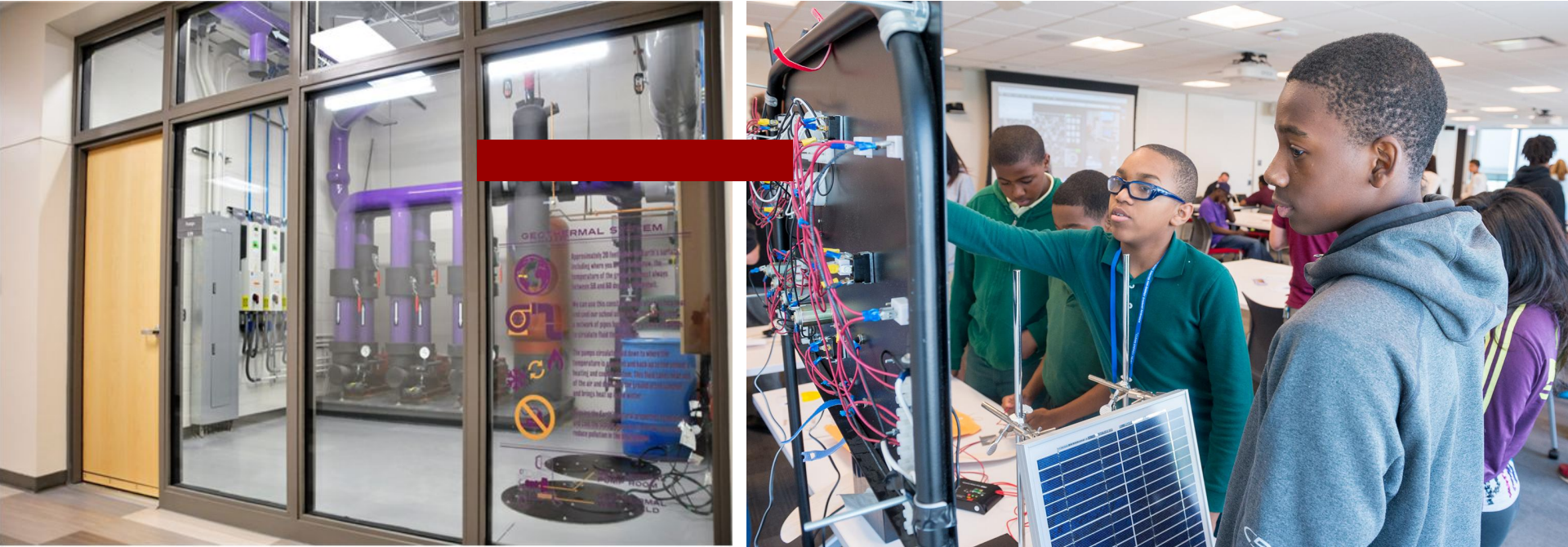

Prototype Carbon Neutral Learning Spaces - Capsule Classrooms

Cost Saving Summary

	Base Scope	Efficiency Improvement	Expected ROI (Return on Investment)
Mechanical	Boiler Replacement and Controls Upgrade	30% - 35% (heating gas load)	5-8 yrs
Lighting	LED Lighting and Lighting Controls Upgrade	30% - 40% (lighting electricity load)	4-6 yrs