



Nottingham Elementary School

project advisory team

April 20, 2021 3:30pm – 5:30pm

design meeting #5

TEAM



Becky Hagan
Nottingham Elementary School Principal

Travis Stanford
Associate Superintendent for Operations

Max Buja
Director of Planning and Construction

Noel Moreno
Project Manager

Kris Drosche
Project Manager



Brandon Ross
Partner

Melissa Turnbaugh
Partner

Jorge Tiscareño
Design Principal

Daniel De La Garza
Principal / Senior Designer

Philip Stewart
Senior Project Manager

Juan Valdez
Project Manager

PAT TEAM

Campus Principal

Becky Hagan

Assistant Principal

Sherrie Folger

Parents

Tara Cunningham-Baker
Kristin Anderson

Campus Staff

Kelli Atkinson
Sabrina Lay

PTA President

Linda Dang

HOA Representatives

Ysella Kaseman
Peter DallePezze
Cassie McClung

CIT Members

Watson Potter
Wayne Watson
Courie Anderson
Sarah Davidson
Tonya Spell
Megan Kessler
Claire Mercaldo
Payton Kingsley
Sarah Dale
Sabrina Lay
Melanie Marshall
Thomas Debesse
Jeanette Choy
Kelly Borally
Stacey Zubair

Business Representative

James Warren

PAT #5 Meeting AGENDA

5 min	PAT Charge & Process, Project Overview, Schedule, Guiding Principals
10 min	PAT #4 Recap – Site and Floor Plan Development
20 min	Present Site & Floor Plan Refinements
20 min	Review Exterior Concept Options and Refinements
30 min	Break Out Group Discussions on Exterior and Regroup
20 min	Interior Images Recap for Next PAT
5 min	Next Steps

SUPERINTENDENT PROJECT ADVISORY TEAM (PAT) CHARGE

GOAL

- The goal of the PAT is to ensure that parents, staff and community members have the opportunity to take part in the planning and design of new schools.
- The PAT will meet as needed throughout the project, from initial planning, through design to the start of construction.
- The PAT concludes its work once construction begins.

CHARGE

- Each Project Advisory Team's (PAT) members are charged with **providing input into planning and design development** for their school's new construction or major renovation project in the 2017 Bond Program.
- The PAT members will **serve as communicators** to and from the community during the design phases of the project and participate in discussions that will lead to recommendations.
- Recommendations will not regard standards, programs, policies, and pedagogy.
- These recommendations will be reached through consensus, and be presented to the Board of Trustees.



THOUGHTFUL EXPLORATION



HANDS ON ENGAGEMENT



INFORMED AND COLLABORATIVE DECISION MAKING

OVERALL PROJECT SCOPE

REPLACEMENT NOTTINGHAM ES
min 750 STUDENT CAPACITY
+/- 105,000 GSF

REPLACE SCHOOL ON EXISTING CAMPUS
WHILE EXISTING SCHOOL IS OPERATIONAL

OPENING OF FALL 2023



DESIGN LENS FILTERS

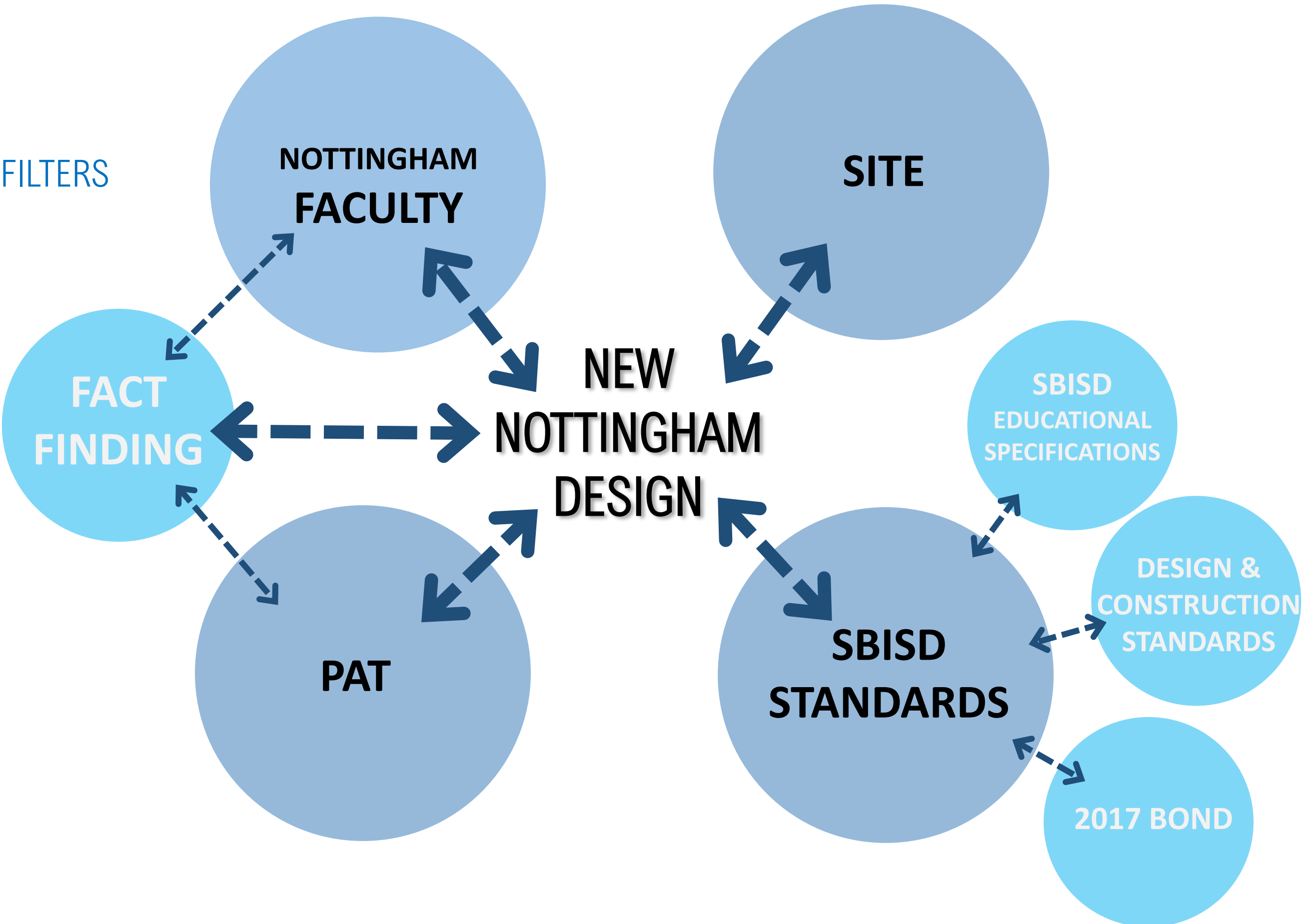

PAT GUIDING PRINCIPLES

We take these with us moving forward



OVERALL PROJECT SCHEDULE

Design																Construction																		
2020				2021								2022								2023														
O	N	D	J	F	MR	AP	MY	JN	JY	AU	S	O	N	D	J	F	MR	AP	MY	JN	JY	AU	S	O	N	D	J	F	MR	AP	MY	JN	JY	AU

Pre Design

- Fact Finding
- Surveys

Schematic Design

- PAT #1
- PAT #2
- PAT #3
- PAT #4

Design Development

- PAT #5
- PAT #6

Construction Documents

- PAT #7

Permitting

Construction

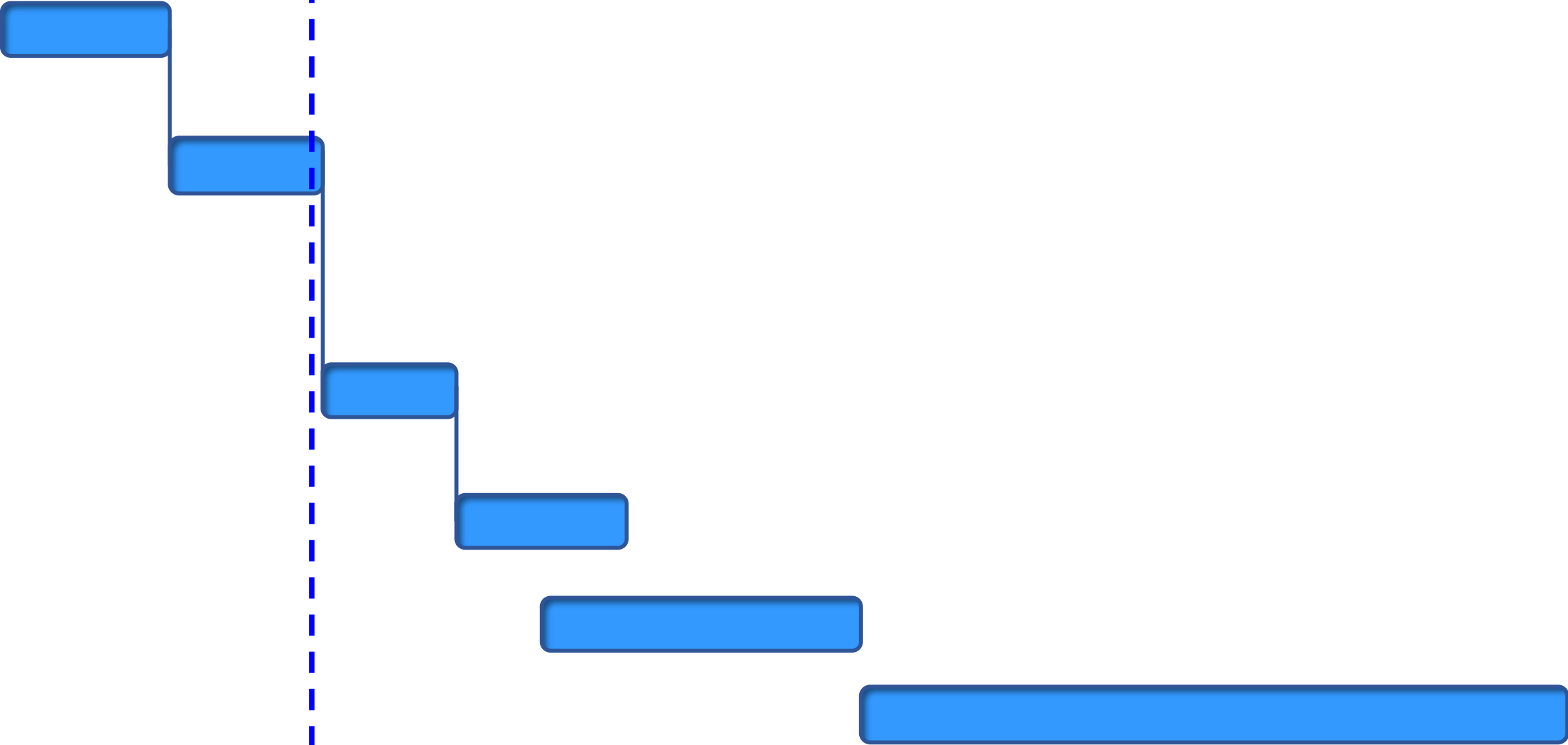

PAT SCHEDULE DETAIL (meetings 3:30 PM - 5:30 PM)

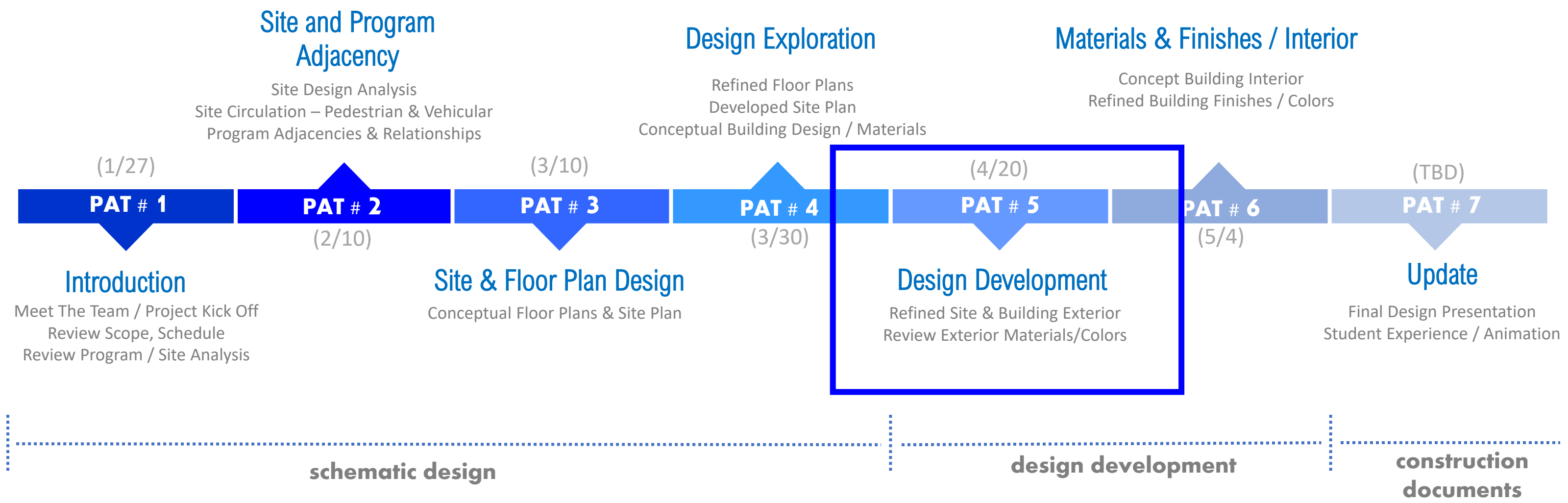

PAT BUILDING DESIGN PROCESS

SITE

FLOOR PLAN

BUILDING

✓
PAT # 1



✓
PAT # 2

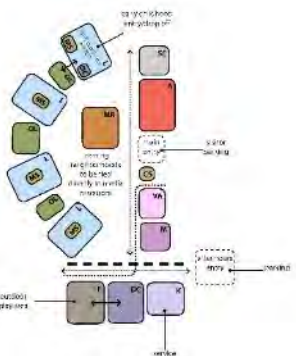
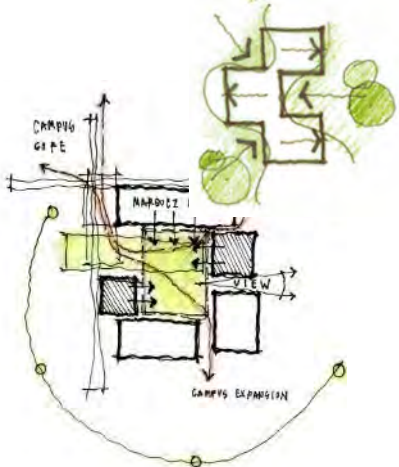

✓
PAT # 3



✓
PAT # 4

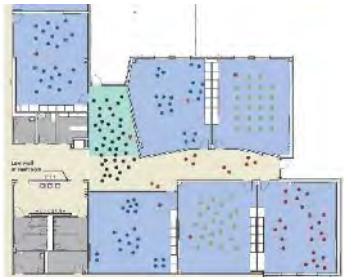

PAT # 5



PAT # 6



conceptualize

develop

refine

schematic design

design development

PAT #4 RIGHT DIRECTION POLL

Poll Result

Are we heading in the right direction for the New Nottingham Elementary design after PAT#4?

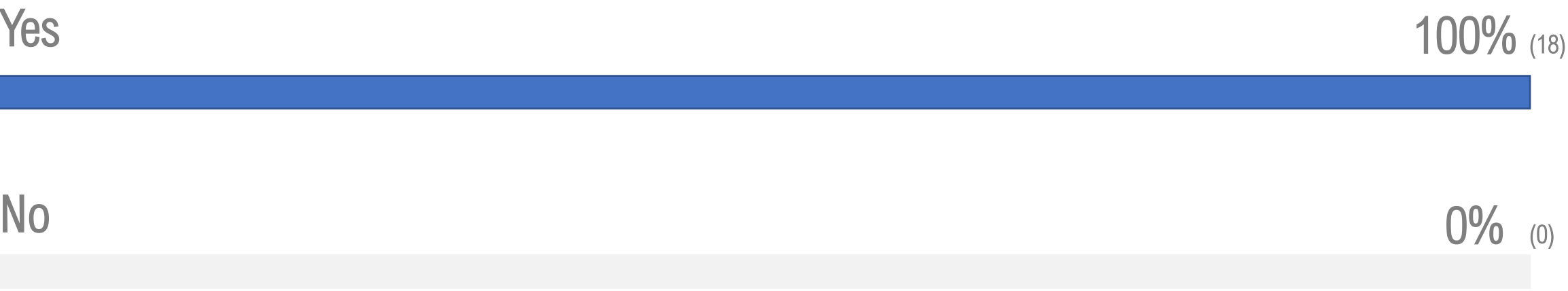

** 6 PAT members did not vote

PAT#4 Recap

WE discussed refined site plan concept BASED ON PAT #3 FEEDBACK

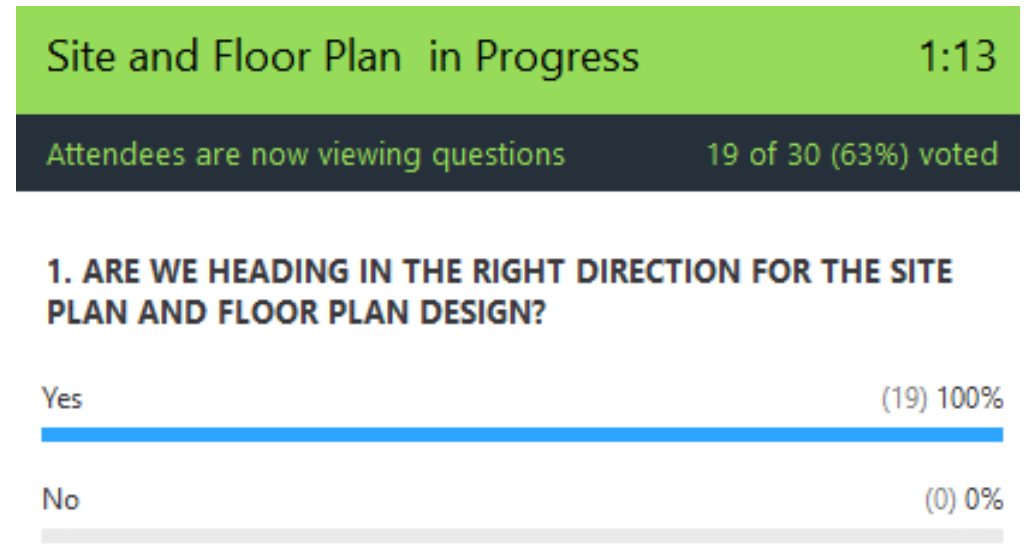

Site and Floor Plan Refinement

DEVELOPED SITE PLAN CONCEPT: overall site plan

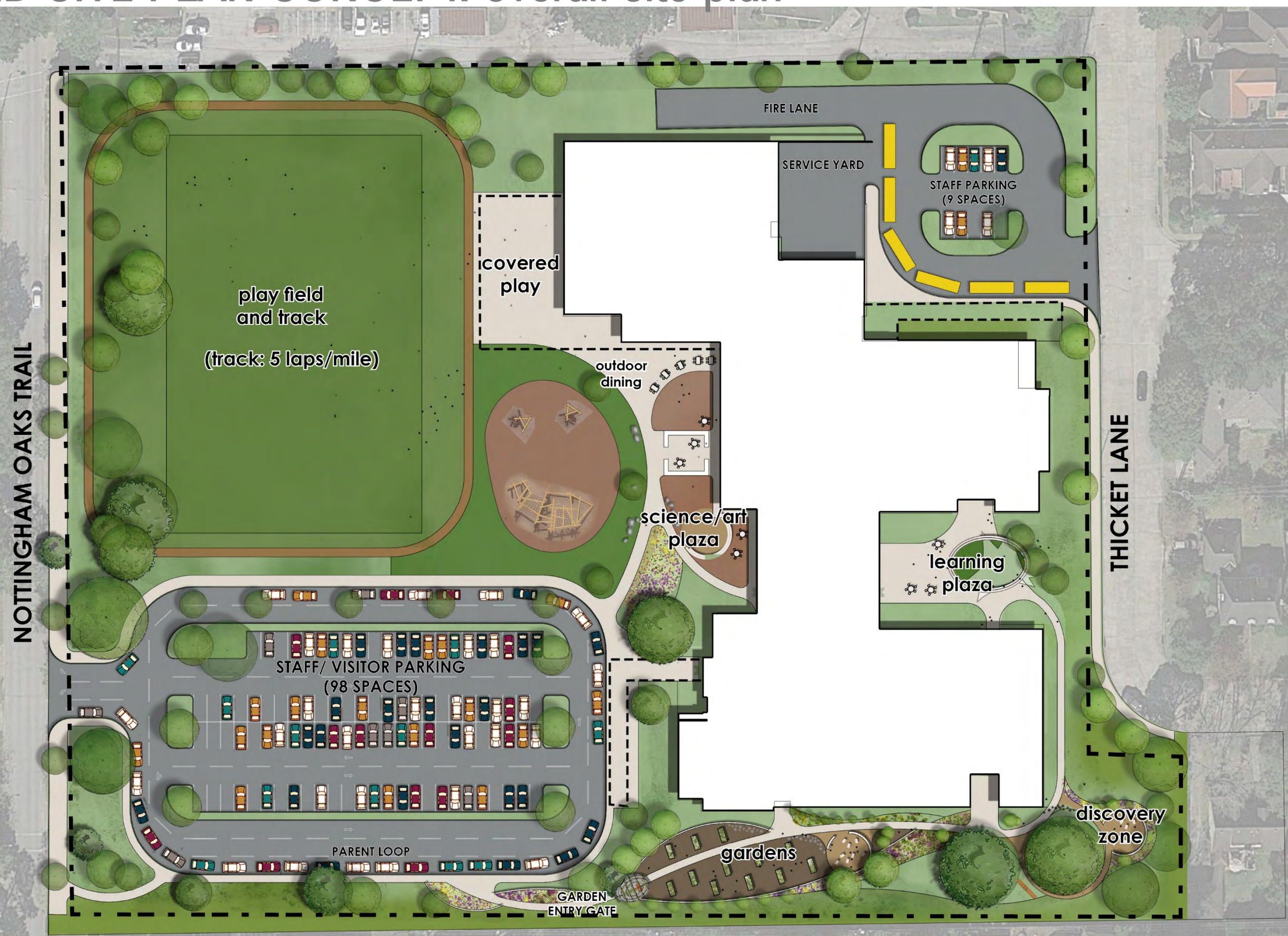

DEVELOPED SITE PLAN CONCEPT: pedestrian flow

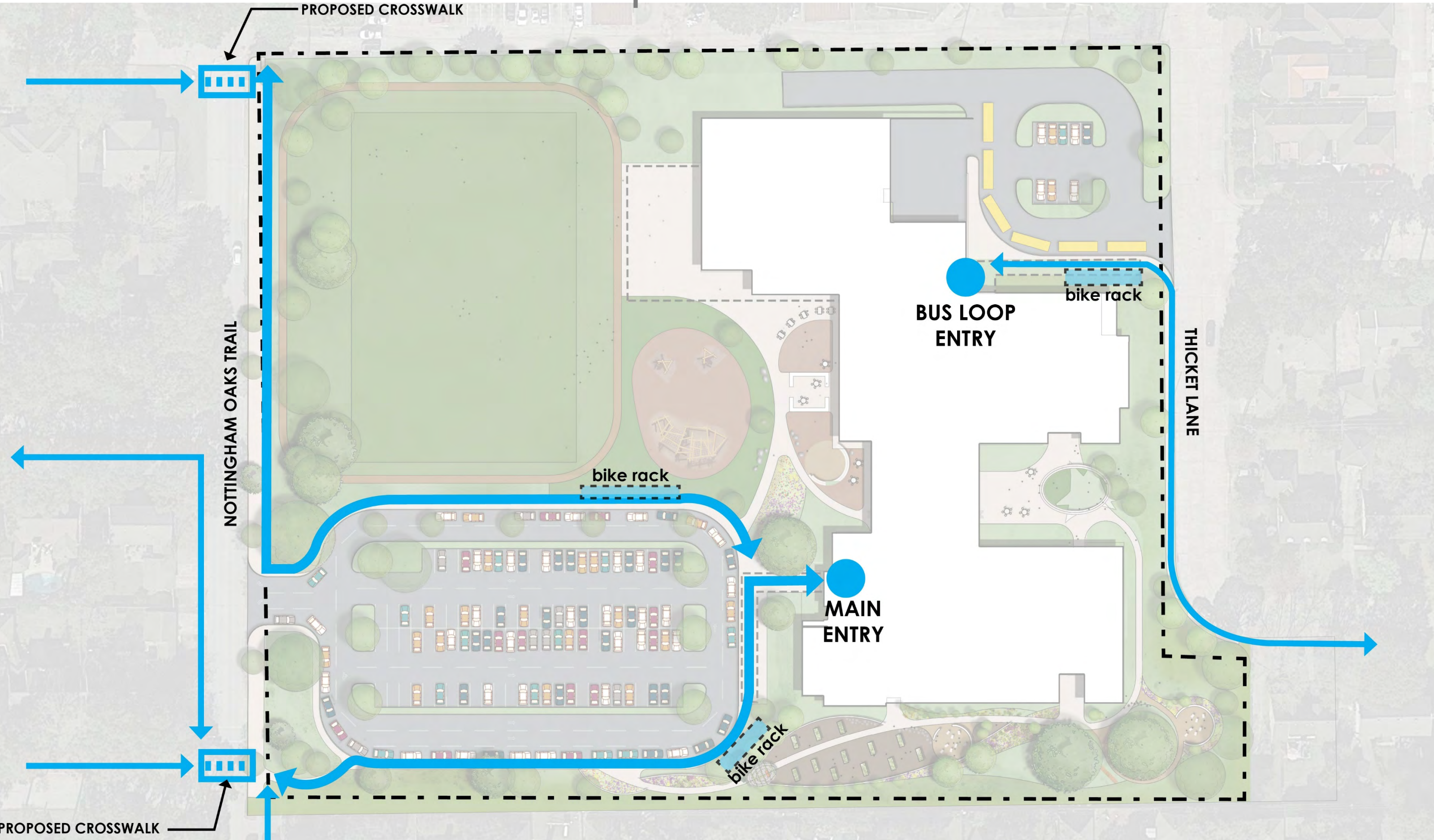

NOTTINGHAM ELEMENTARY SCHOOL

DEVELOPED SITE PLAN CONCEPT: traffic flow

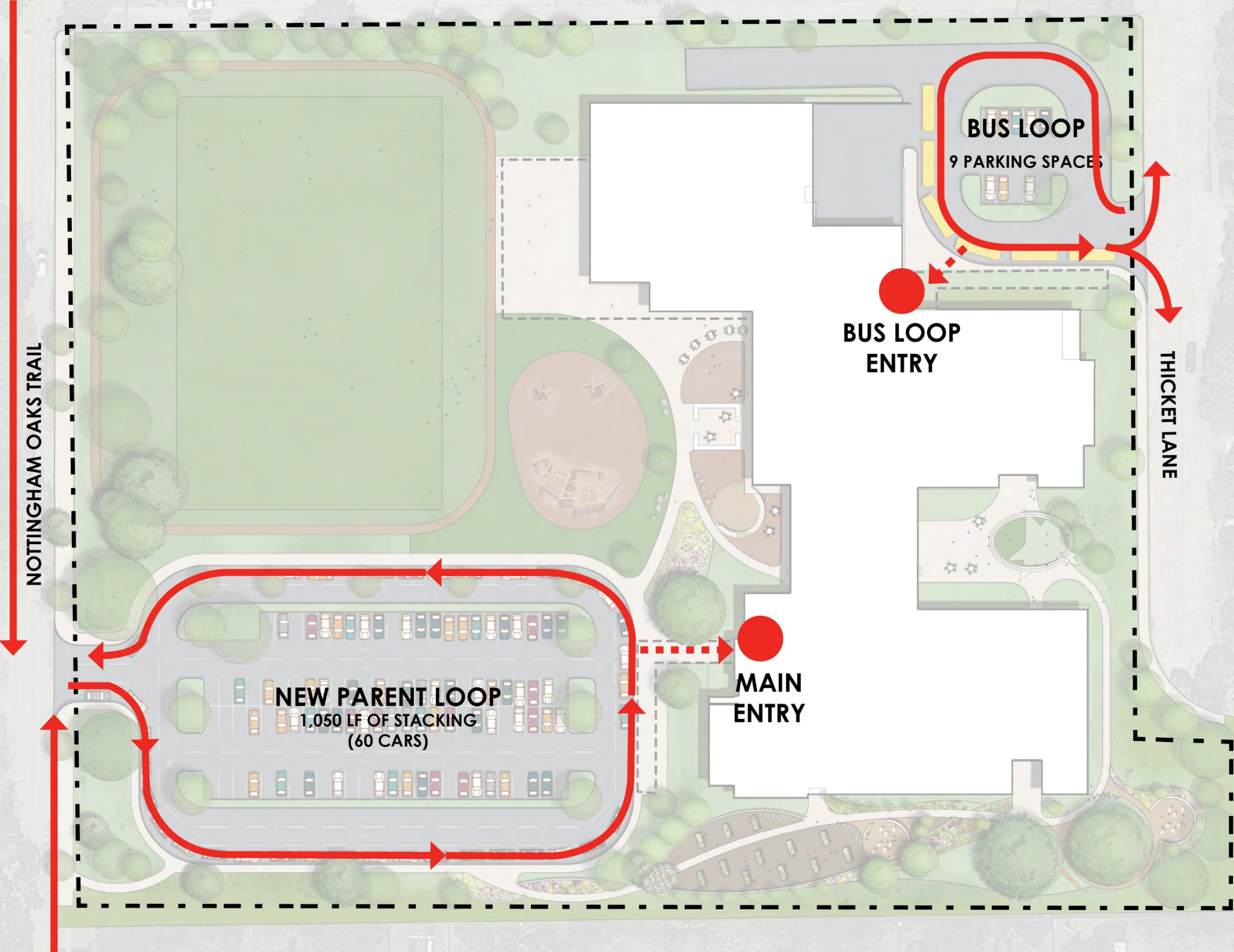

DEVELOPED SITE PLAN CONCEPT: parent loop

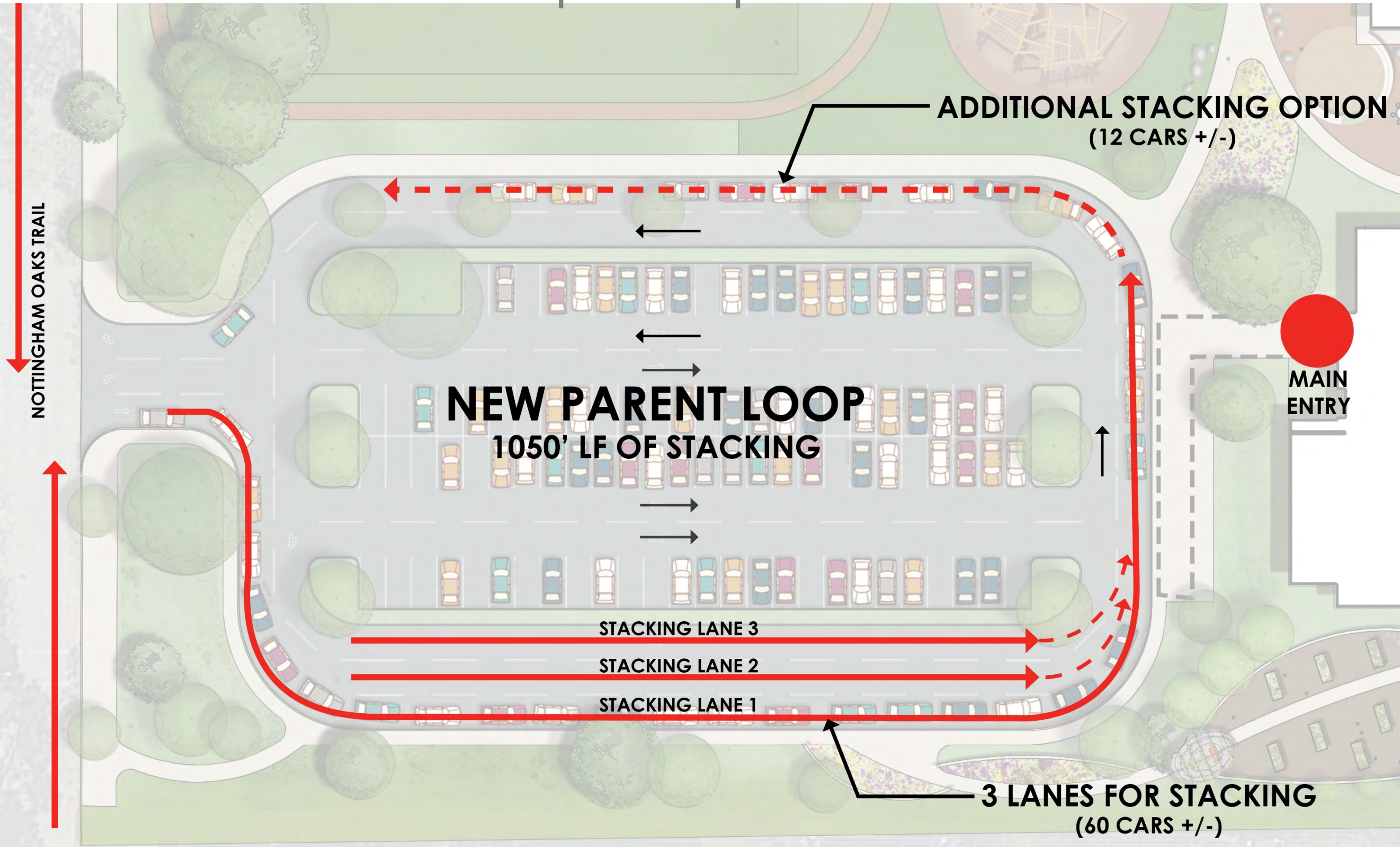

DEVELOPED SITE PLAN CONCEPT: parent loop: existing

NOTTINGHAM OAKS TRAIL

EXISTING LOOP
400' LF OF STACKING
(20 CARS)

DEVELOPED SITE PLAN CONCEPT: outdoor space fencing

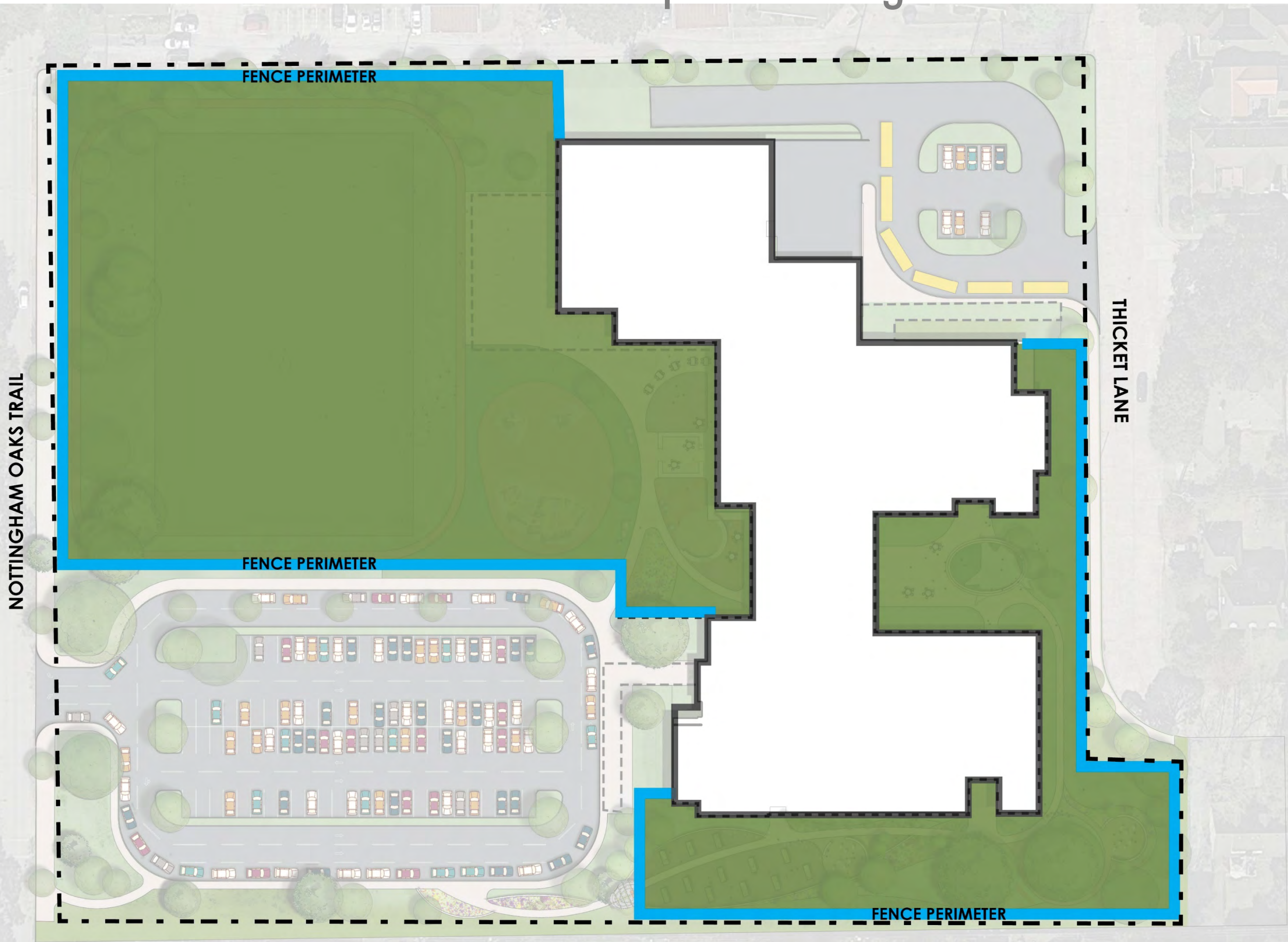

DEVELOPED SITE PLAN CONCEPT: outdoor space



DEVELOPED FLOOR PLANS: first floor



DEVELOPED FLOOR PLANS: first floor



DEVELOPED FLOOR PLANS: first floor



DEVELOPED FLOOR PLANS: first floor



DEVELOPED FLOOR PLANS: second floor

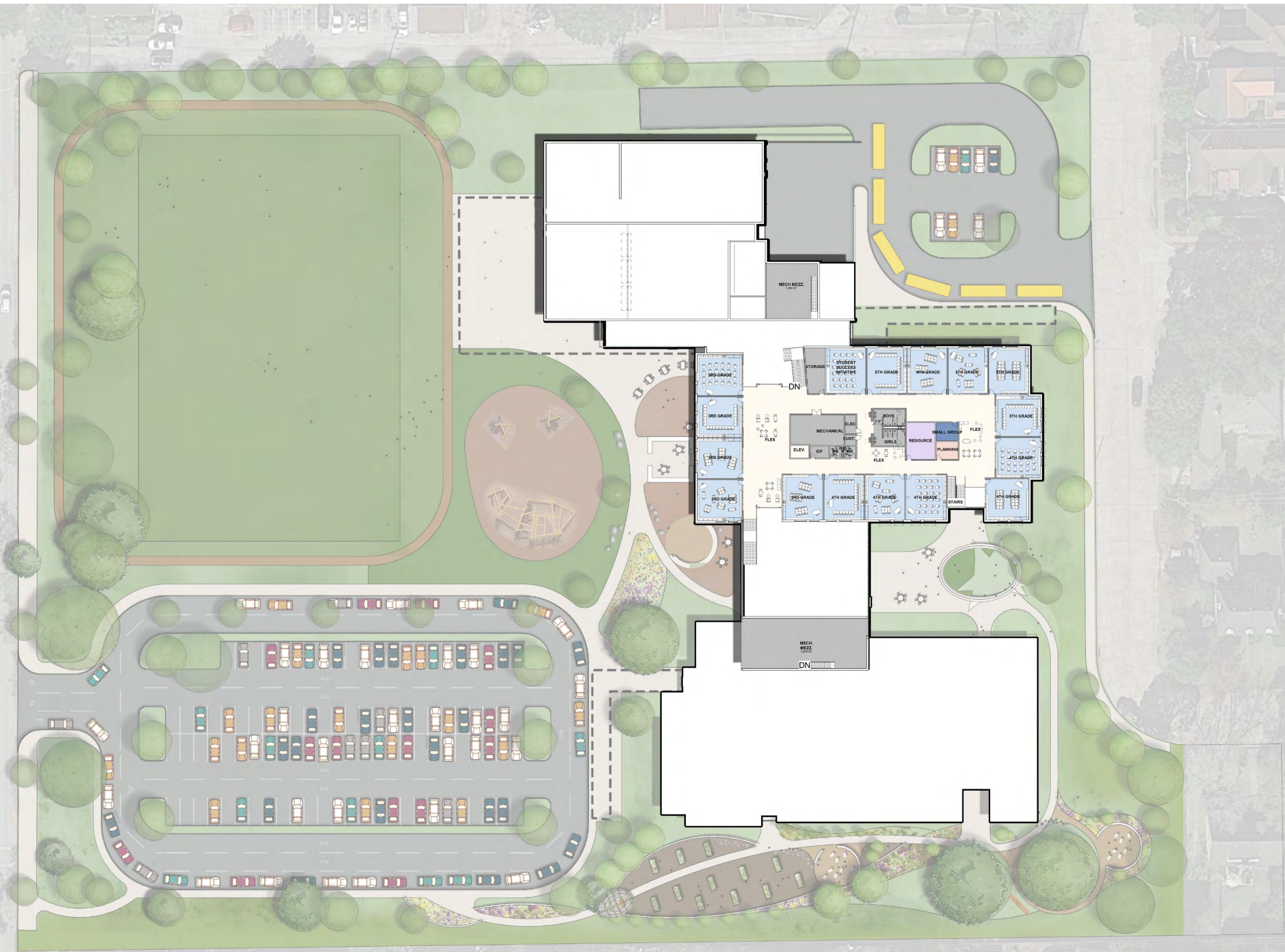

DEVELOPED FLOOR PLANS: second floor



Review Exterior Development

Exterior Character

Spirit Images 1

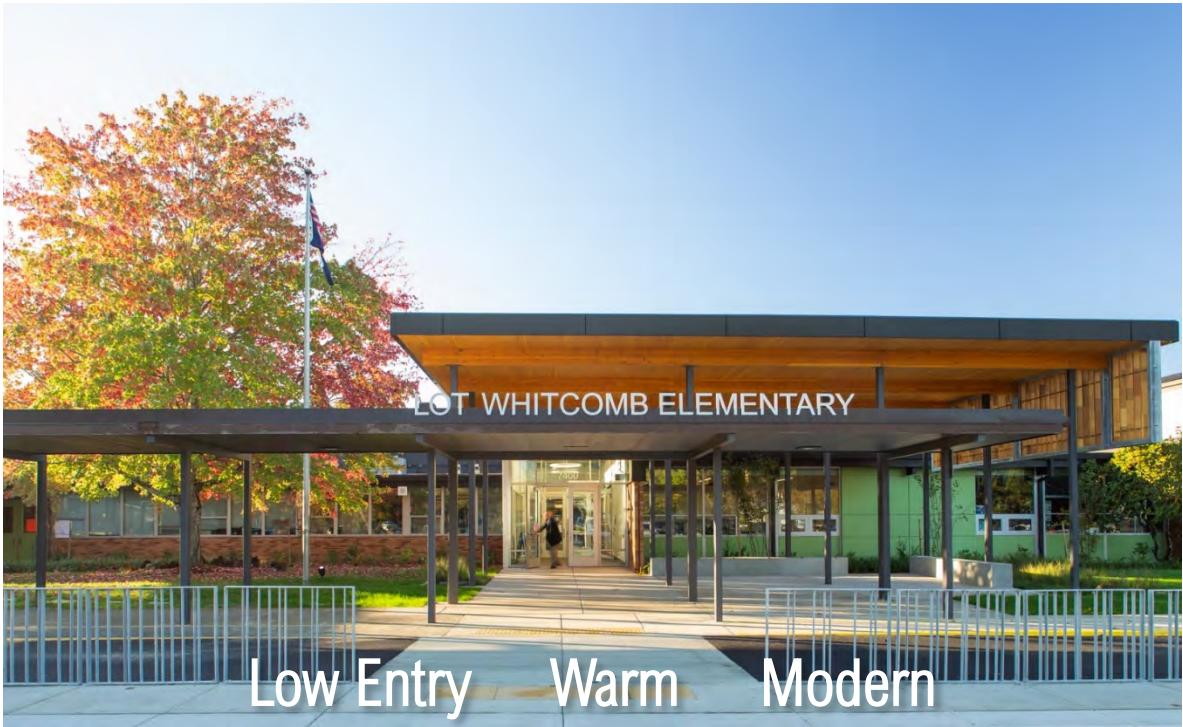

Warm (wood and brick finishes, warm tone colors)



Low Entry (simple canopy, exposed columns, wood soffit)



Modern (clean lines, ample glazing, simple modern materials)

Exterior Character



Low Entry Metal and Wood Striking Facade



Metal and Wood (exterior wood and metal panel finishes)



Low Entry (simple canopy, exposed columns, wood soffit)



Striking Facade (expressive unique design)

Exterior Character



Low Entry Warm Natural Wood



Warm, Natural (natural warm finishes like wood, brick, stone)



Low Entry (simple canopy, exposed columns, wood soffit)



Wood (wall and soffit material)

EXTERIOR DEVELOPMENT: **OPTION 1**



NOTTINGHAM ELEMENTARY SCHOOL

EXTERIOR DEVELOPMENT: **OPTION 2**



NOTTINGHAM ELEMENTARY SCHOOL

EXTERIOR DEVELOPMENT: **OPTION 1**



NOTTINGHAM ELEMENTARY SCHOOL

EXTERIOR DEVELOPMENT: **OPTION 2**



NOTTINGHAM ELEMENTARY SCHOOL

EXTERIOR DEVELOPMENT: **OPTION 1**



NOTTINGHAM ELEMENTARY SCHOOL

EXTERIOR DEVELOPMENT: **OPTION 2**



NOTTINGHAM ELEMENTARY SCHOOL

EXTERIOR DEVELOPMENT: **OPTION 1**



NOTTINGHAM ELEMENTARY SCHOOL

EXTERIOR DEVELOPMENT: **OPTION 2**



NOTTINGHAM ELEMENTARY SCHOOL

EXTERIOR DEVELOPMENT: **OPTION 1**



EXTERIOR DEVELOPMENT: **OPTION 2**



NOTTINGHAM ELEMENTARY SCHOOL

EXTERIOR DEVELOPMENT: **OPTION 1**



NOTTINGHAM ELEMENTARY SCHOOL

EXTERIOR DEVELOPMENT: **OPTION 2**



NOTTINGHAM ELEMENTARY SCHOOL

EXTERIOR DEVELOPMENT: OPTIONS REVIEW



OPTION 1



OPTION 2



EXTERIOR DEVELOPMENT: OPTIONS REVIEW



OPTION 1



OPTION 2



SMALL GROUP DISCUSSIONS

EXTERIOR DEVELOPMENT DISCUSSION

BREAKOUT GROUPS (remain in zoom)

Group 1 – Jorge/Juan

Group 2 – Phillip / Melissa

Group 3 – Daniel / Brandon

Breakout Group Discussions: (20 minutes total)

Regroup, Discuss, Poll 15 minutes

Exterior Images Recap & Vote

OPTION 1



OPTION 2



COMING UP ON PAT #6...

May 4, 2021 3:30 PM – 5:30 PM

Materials & Finishes

Refined Building Interior
Refined Building Finishes / Colors

PAT # 6

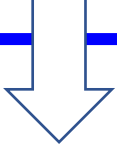

PAT # 7



NEXT STEPS

Closing Remarks

ARE WE HEADING IN THE RIGHT DIRECTION FOR THE NEW NOTTINGHAM DESIGN AFTER PAT #5?

Next PAT meeting

May 4, 2021 3:30 PM – 5:30 PM

Materials & Finishes / Interior

Concept Building Interior
Refined Building Finishes / Colors



Thank you!

Nottingham Elementary School