



WEST HARTFORD

Inland Wetlands and Watercourses Agency
Town of West Hartford - Department of Community Development
50 South Main Street, Room 214, West Hartford, CT 06107
P: (860) 561-7555 www.westhartfordct.gov

APPLICATION FOR DESIGNATED AGENT APPROVAL REGULATED ACTIVITIES PERMITTED UNDER SECTION 12 OF THE INLAND WETLANDS & WATERCOURSES REGULATIONS

FOR OFFICE USE ONLY:

File #: V67 Date Received: 4.16.21

Street Address of Proposed Activity: 100 Mountain Terrace Rd.

Zone: _____ Acreage/Lot Area _____ Parcel/Lot# _____

Application Fee: _____ Surcharge Fee: _____ Affidavit Fee: _____

Applicant's Interest in Property: Homeowner

Description of Proposed Activity: Installation of 24' round above-ground pool in backyard, with approximately 50% of pool area placed within area designated "150' Regulated Wetlands". Total pool area is 500 sq ft. Half of that will be in 150' regulated wetlands area 250 sq ft

Distance to nearest wetland soil or watercourse:

<u>140</u>	Feet to wetland soil	<u>250</u>	Total sq ft of disturbance
_____	Feet to watercourse	_____	Total sq ft of disturbance

Measures proposed by the applicant to minimize impact on the wetland and/or watercourse:

The undersigned applicant certifies the following:

- (1) the proposed activity does and will not constitute a significant impact activity as defined in the regulations
- (2) best management practices shall be used so as to ensure continued compliance with governing laws and regulations
- (3) there are no prudent alternatives to the proposed activity that have a less adverse impact on Wetlands and Watercourses.

The undersigned warrants the truth of all statements contained herein and in all supporting documents to the best of his/her knowledge and belief. Furthermore, the applicant agrees that submission of this document constitutes permission and consent to Commission and Staff inspections of the site. *Note: Notice is hereby given the Connecticut Department of Public Health must be notified by applicants for any project located within a public water supply aquifer protection area or watershed area. (CTDPH website at <http://www.dph.state.ct.us>)*

The undersigned also acknowledges their responsibility if this application is approved to publish notice of approval within ten (10) days in a newspaper having a general circulation in town. Applicant will submit proof of publication to the Planning & Zoning Office.

Applicant's Initials acknowledging responsibility for publication _____

Penelope Carmichael
Record Owner's Name

Penelope Carmichael
Applicant's Name

100 Mountain Terrace Road
Street

100 Mountain Terrace Road
Street

West Hartford Ct 06107
City State Zip

West Hartford Ct 06107
City State Zip

516 375 7851
Telephone #

516 375 7851
Telephone #

Contact Person:

Penelope Carmichael
Name

Penelope Carmichael
Applicant's Signature

100 Mountain Terrace Road
Street

Penelope Carmichael
Signature of Owner/Authorized Agent

West Hartford Ct 06107
City State Zip

516 375 7851
Telephone #

PMC617@hotmail.com
Email Address

Authorized Agent Action:

After considering the standards set forth in Section 12 of the Town of West Hartford Inland Wetlands and Watercourses Regulations, the authorized agent determines the following:

Application Approved: 4/15/21 Designated Agent Signature: [Signature]

Conditions of Approval:

Application Denied: _____ Designated Agent Signature: _____

Note: If application is denied the applicant may apply to the Inland Wetlands and Watercourses Agency (IWWA) for a permit.

100 Mountain Terrace Road Wetlands Map

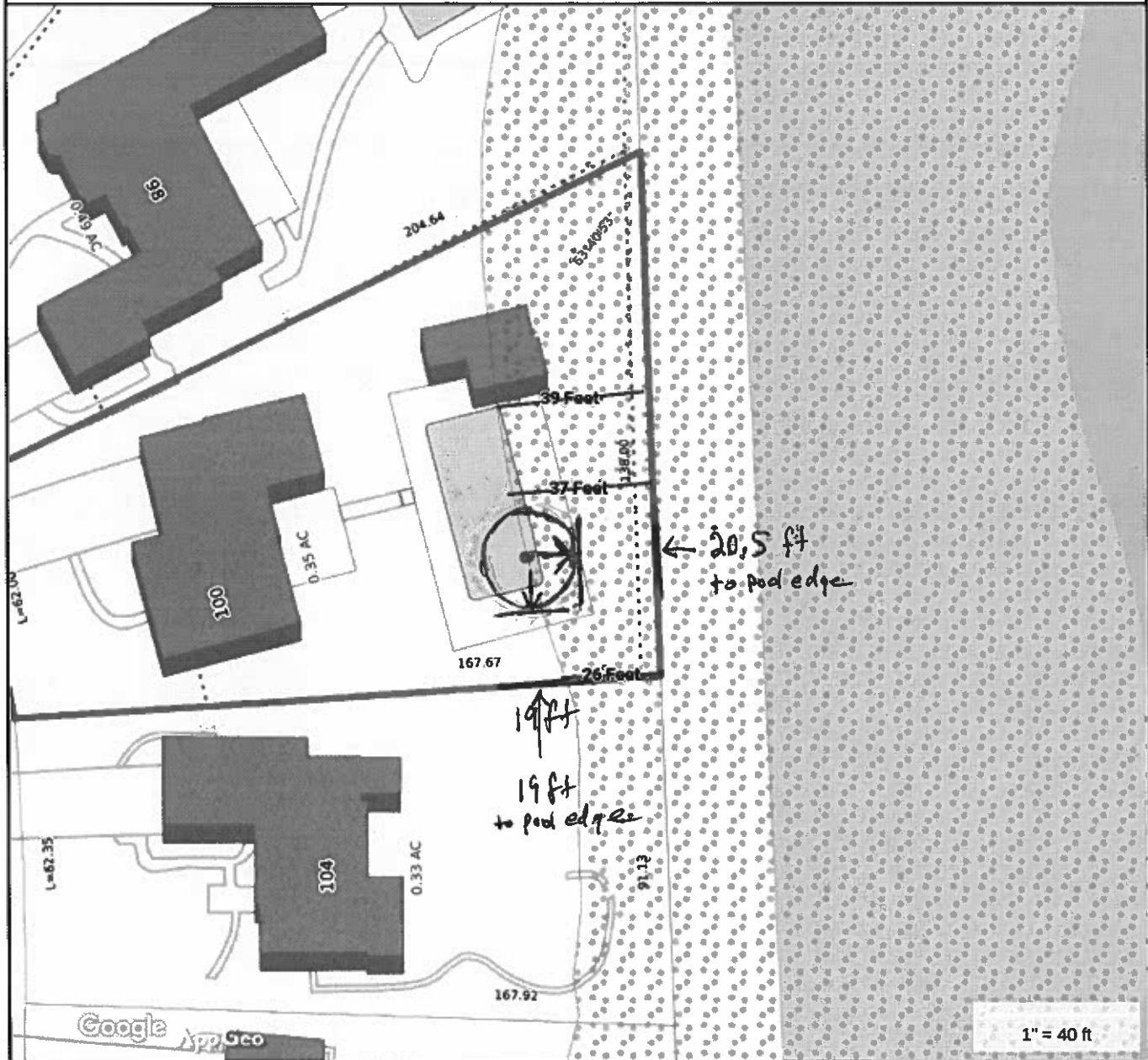

Property Information

Property ID 3731 2 100 0001
 Location 100 MOUNTAIN TERRACE ROAD
 Owner CARMICHAEL PENELOPE



MAP FOR REFERENCE ONLY
 NOT A LEGAL DOCUMENT

Town of West Hartford, CT makes no claims and no warranties, expressed or implied, concerning the validity or accuracy of the GIS data presented on this map.

Geometry updated 7/17/2020
 Data updated Daily

Print map scale is approximate.
 Critical layout or measurement activities should not be done using this resource.





