

New Student Registration Instructions

Please collect all documents and save them electronically

- You are required to upload ALL necessary documents into the Registration System. Please note enrollment documents required on the document below [UPLOAD ALL DOCUMENTS UNDER THE PROOF OF RESIDENCY BUTTONS](#)
- Complete the Educational History Form, the Medical Form and the Native Language form also and have ready to upload into the Registration system. [UPLOAD ALL DOCUMENTS UNDER THE PROOF OF RESIDENCY BUTTONS](#)
- VIEW- [Map of Elementary School Zones](#) to determine the school that your student will attend

Access the OSSD Registration Gateway at this URL-

https://regcas.ossdms.org/cas_OceanSpringsMS/login

Click on the Registration Gateway Button to create an account

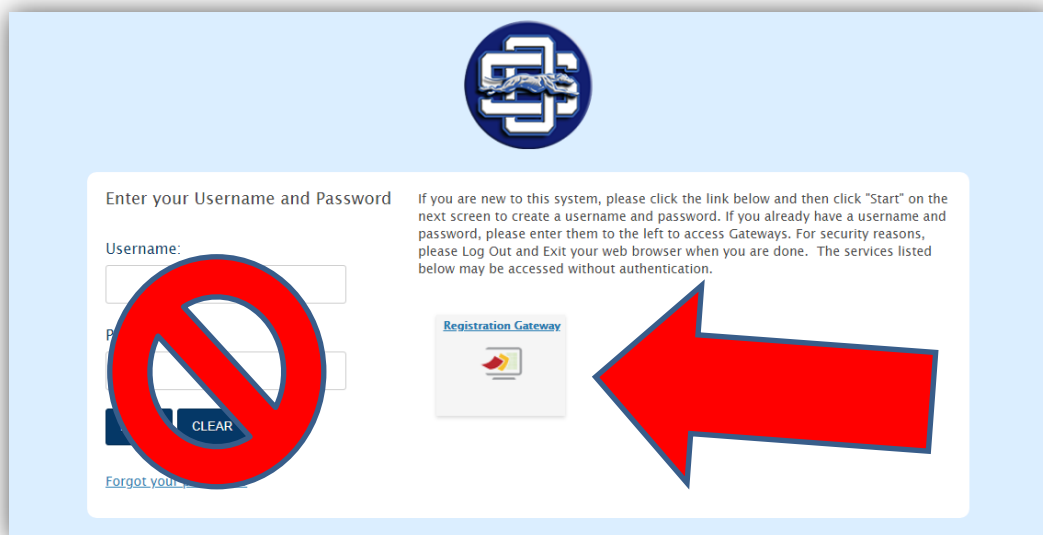

Click Start

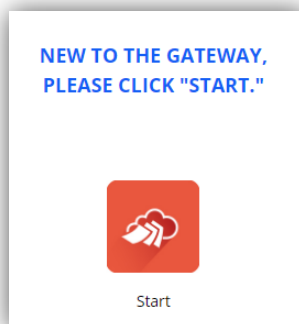

Before You Get Started

Registration Gateway

0-19%

20-39%

40-59%

60-79%

80-100%

Dear Parent/Guardian,

Welcome to our New Student Registration portal. You must complete the entire registration process for your student to be enrolled. On the last page of this process, you can schedule a required meeting with the school. You will be given a list of documents to bring to your meeting at school. You must bring these documents or you may be asked to return later with them.

Please check the "I'm ready to begin" box and then click "Save and Next". We look forward to meeting you and your student.

I'm ready to begin

SAVE AND NEXT

**Click the box –
I'm ready to
begin and Save
and Next**

Create or Edit My Account

Registration Gateway

0-19%

20-39%

40-59%

60-79%

80-100%

Username *

cwilson1966

Email address (needed if you forget your password)

cwilson@osdms.org

Password *

.....

Challenge Question (in case you forget password) *

What is your mother's maiden name? ▼

Confirm Password *

.....

Challenge Answer (ANSWER IS CASE SENSITIVE) *

jabour

SAVE AND NEXT

**Create your
Account-Click
Save and Next-
Begin the
Registration
Process**

Please contact the registrar at the school your student will be attending if you have any questions

Oak Park Elementary 228-875-5847

Magnolia Park Elementary 228-875-4263

Pecan Park Elementary 228-875-2851

Ocean Springs Upper Elementary 228-875-4367

Ocean Springs Middle School 228-872-6210

Ocean Springs High School 228-875-0333