



Convergent Technology Partners
 6197 Miller Rd, Suite 4
 Swartz Creek, MI 48473
 810-720-3820
 Fax 810-720-3886

E-mail: info@ctpartners.net
 Website: www.ctpartners.net

ADDENDUM

Client / Address	Troy School District 4420 Livernois, Troy MI	Project / Location	Classroom Technology
Date Issued	April 5, 2021	Project Number	9925

A1-1 NOTICE: The bid documents are amended herein which adds to and/or supersedes conflicting or additional information in the Request for Proposal.

1. Work covered by this Addendum shall be subject to the Introduction, Terms and Conditions and Technical Specifications.
2. Acknowledge this Addendum on the Cost Analysis Worksheet and include the cost of the work herein specified in the Bid.
3. Notice: The required electronic copies of the proposal must be in every way a duplicate of the hard copy. Provide the electronic copy in separate PDFs by tabular section as required by the hard copy. Failure to provide a duplicate of all information in both formats will be grounds for non-compliance and disqualification.

A1-2 Mandatory Pre-bid Meeting and Site Survey

Attendees: Troy Schools – Alan Wilson, CTP – Eric Helsel, Bidders - Tel Systems, VSC, Inacomp TSG, Tierney

1. Reviewed examples of typical spaces/rooms.
2. Atypical spaces such as gymnasium stages to be bid as typical rooms, any changes required will use unit pricing and change orders after award.
3. All spaces listed in RFP Attachment 1 to be included in proposals.
4. Each building to be walked prior to installation for verification of display locations.
5. Note: Martell, Costello, Troy Union and Schroeder Elementary Schools have metal walls - see attached photo. Consider 10% - 15% of all classrooms in the project to have the same wall type.
6. Diagrams/schematics of existing systems attached.

Attachments:

1. Metal wall photos
2. Wiring diagrams/schematics

End of Addendum 1

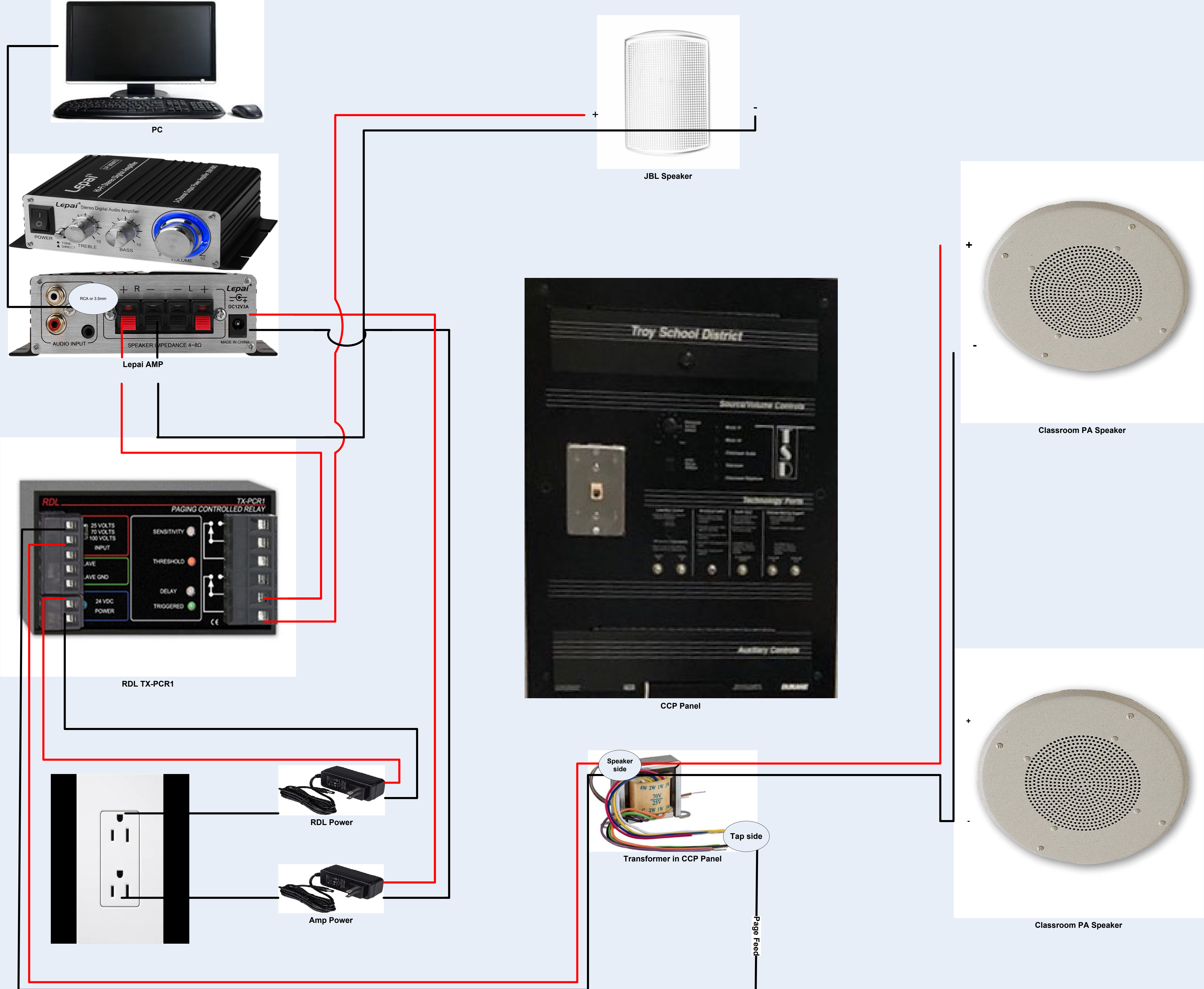

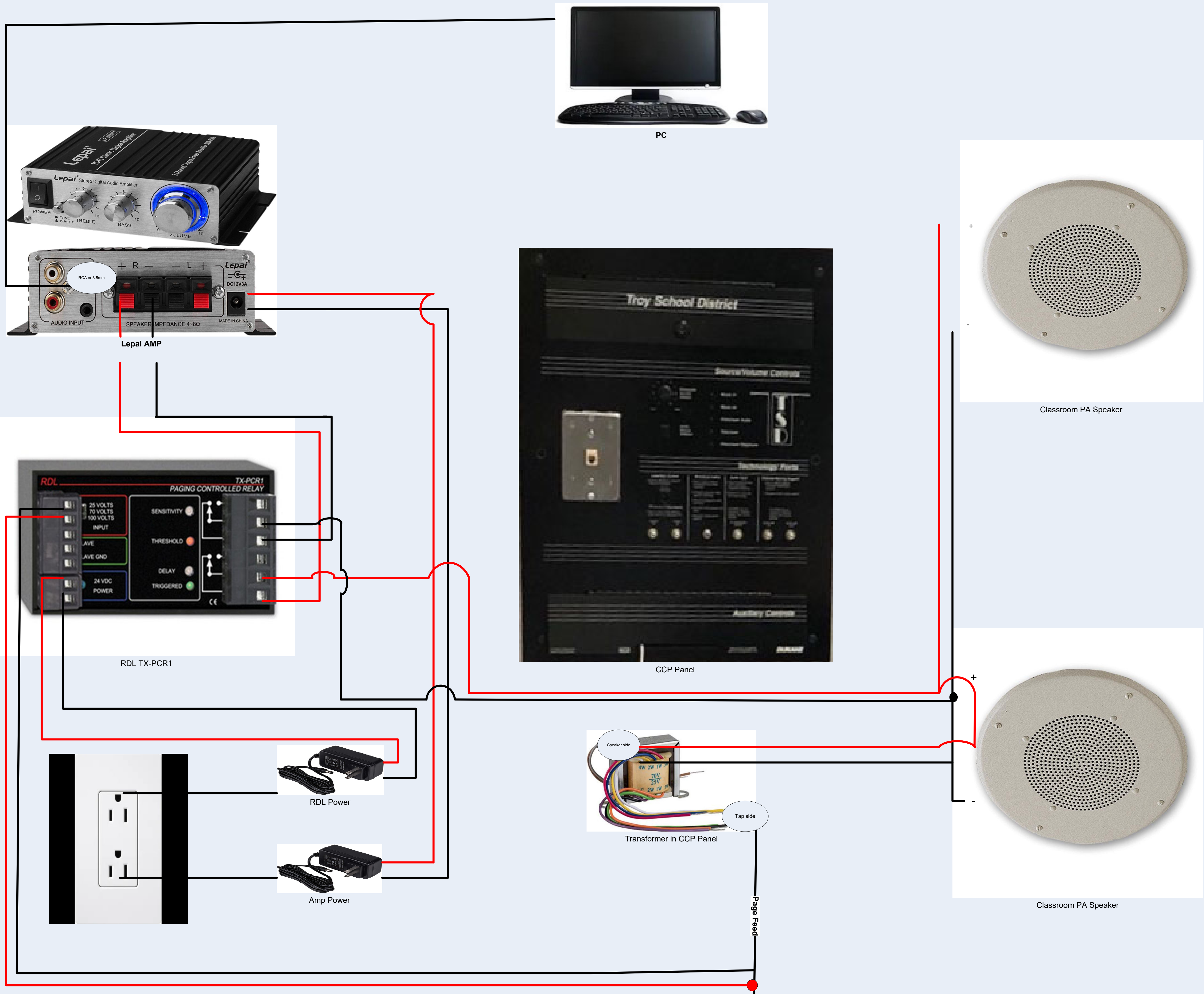

PC

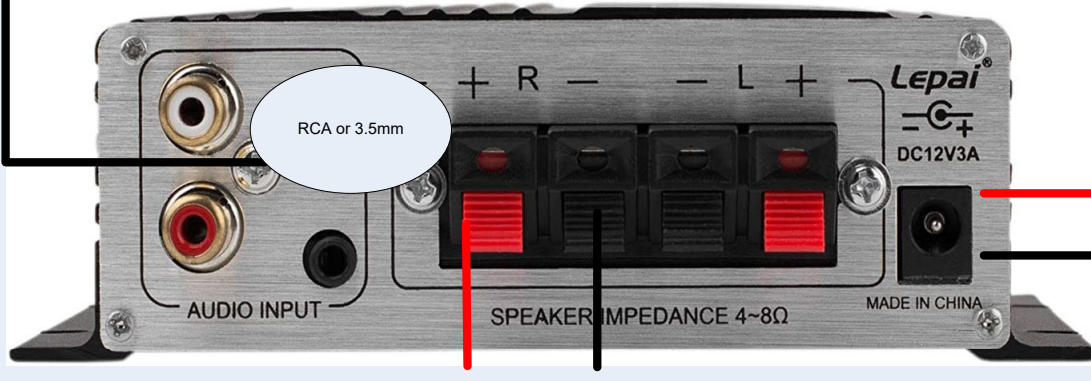

Lepai AMP

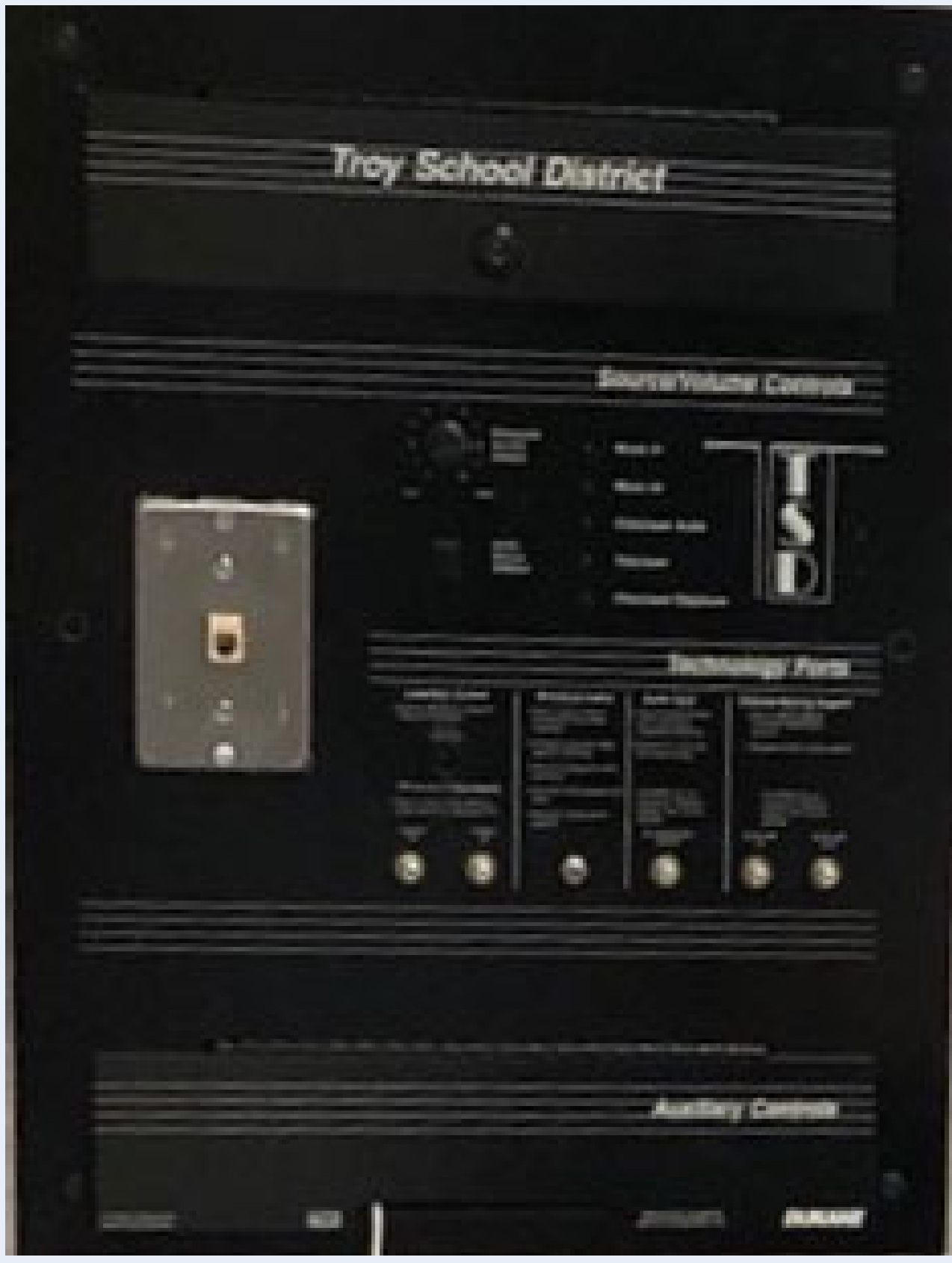

CCP Panel



Classroom PA Speaker

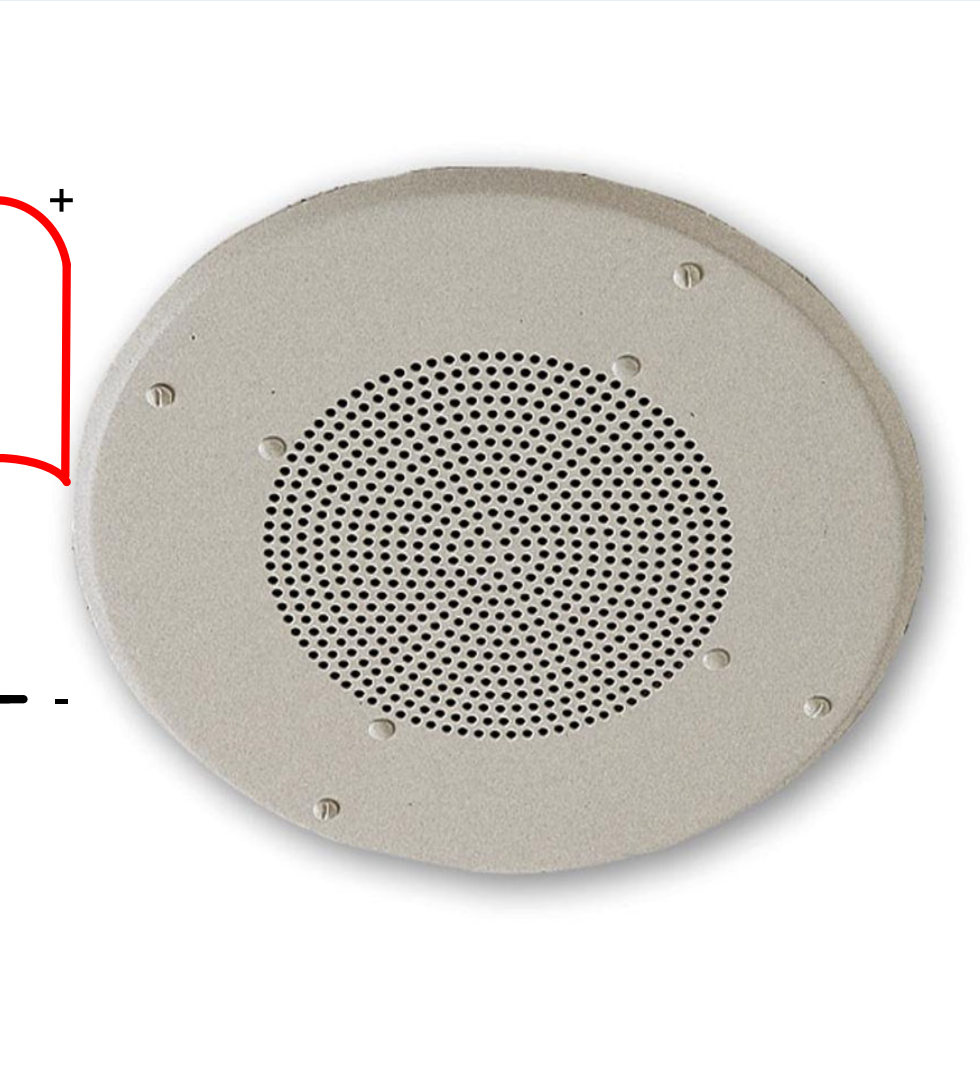

Classroom PA Speaker



RDL TX-PCR1



RDL Power



Amp Power

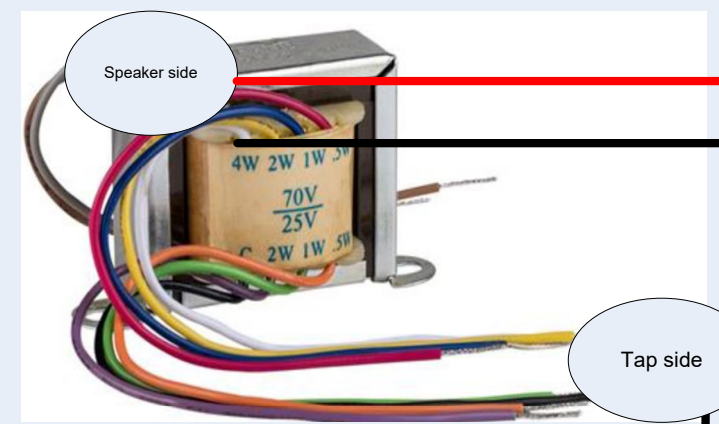

Transformer in CCP Panel

Page Feed

THE DATACOM GROUP, INC.
 3979 Holt Rd. 888-505-DATA
 Holt, MI 48842

Notes:

Drawn by: Brian Hillard
 Date: 12-18-20
 Scale: NTS

Troy School District
 District Wide Paging Classroom Local Audio
 and PA Configuration # 2
 Valcom IP6000 Class Connection

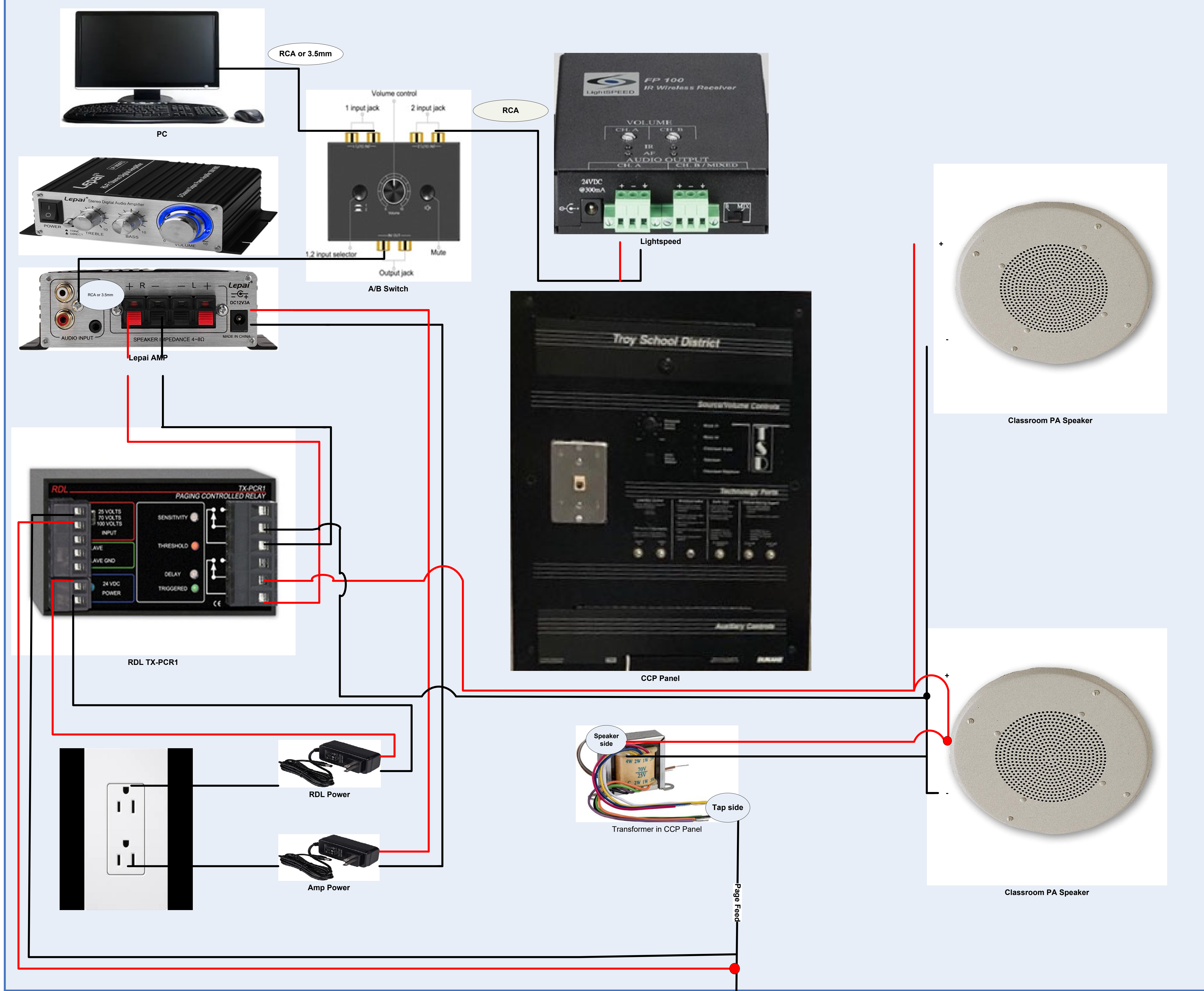

Notes:

Drawn by: Brian Hillard
 Date: 12-18-20
 Scale: NTS

Troy School District
 District Wide Paging Classroom Local Audio
 and PA Configuration # 3
 Valcom IP6000 Class Connection

Press button to Mute local audio

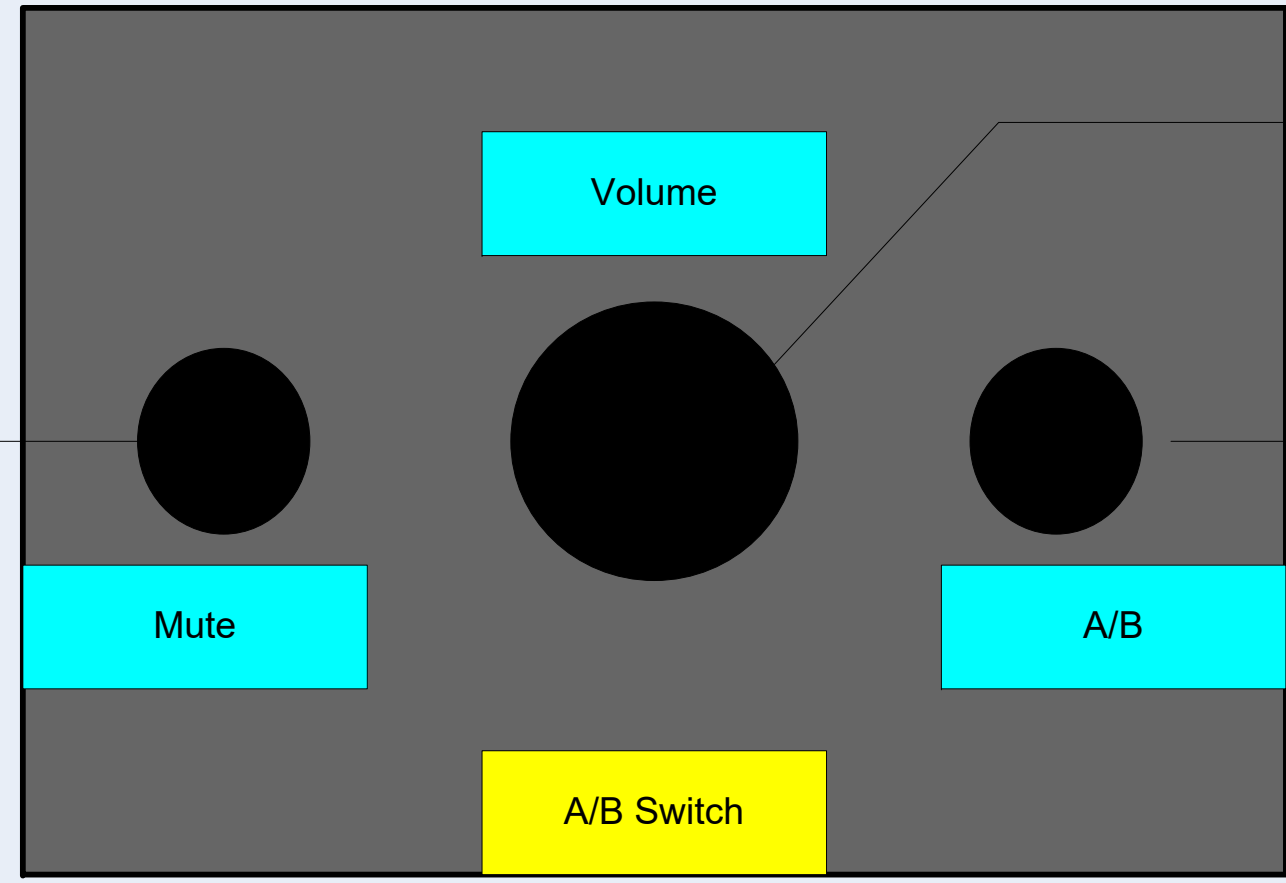

Turn Volume Knob to between 50% and 70% for normal operation

Press button to Toggle between Microphone or PC

Set switch to:
25v for config 1
70v for config 2 & 3

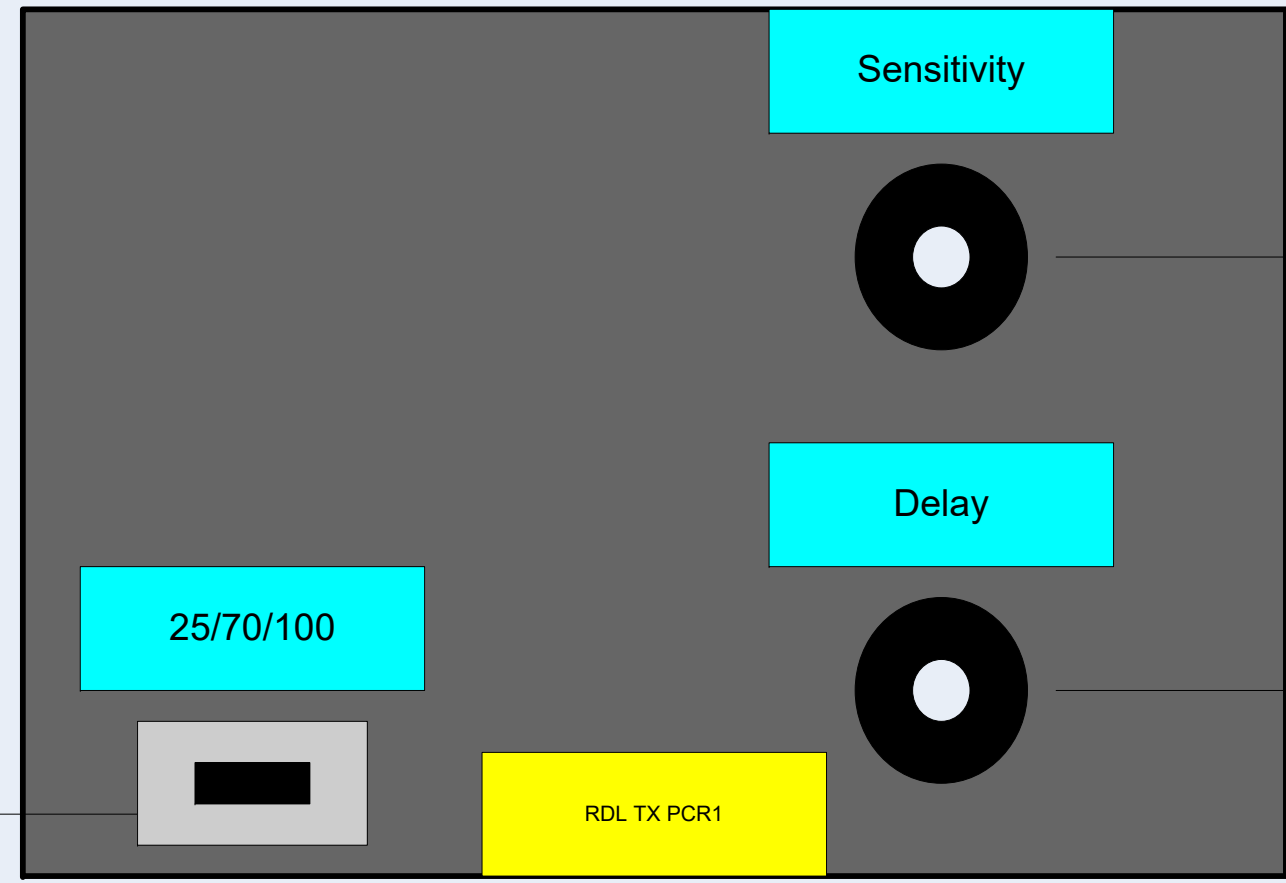

To return to Base settings
Turn Sensitivity potentiometer all the way counter clockwise gently until it stops
Turn Sensitivity ¼ to ½ turn clockwise

To return to Base settings
Turn Delay potentiometer all the way counter clockwise gently until it stops
Turn Delay ¼ turn clockwise

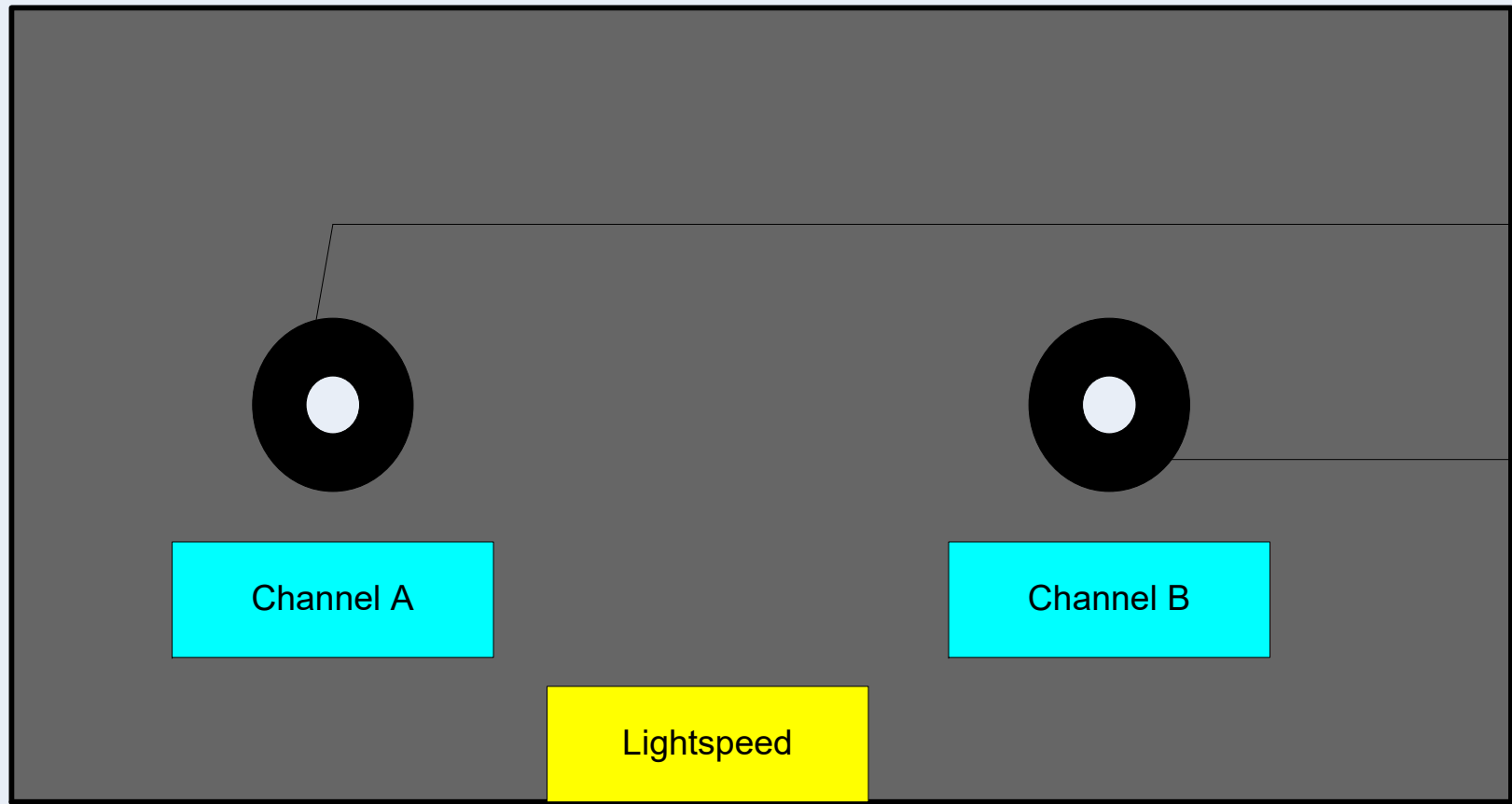

To return to Base settings
Turn Channel A potentiometer all the way clockwise gently until it stops
Turn Channel A counter clockwise until bottom of screw slot is pointing at 10 and 4 o'clock

Channel B is Unused

Set Volume to 50% or greater for normal operation

Press to turn Amp
power on or off

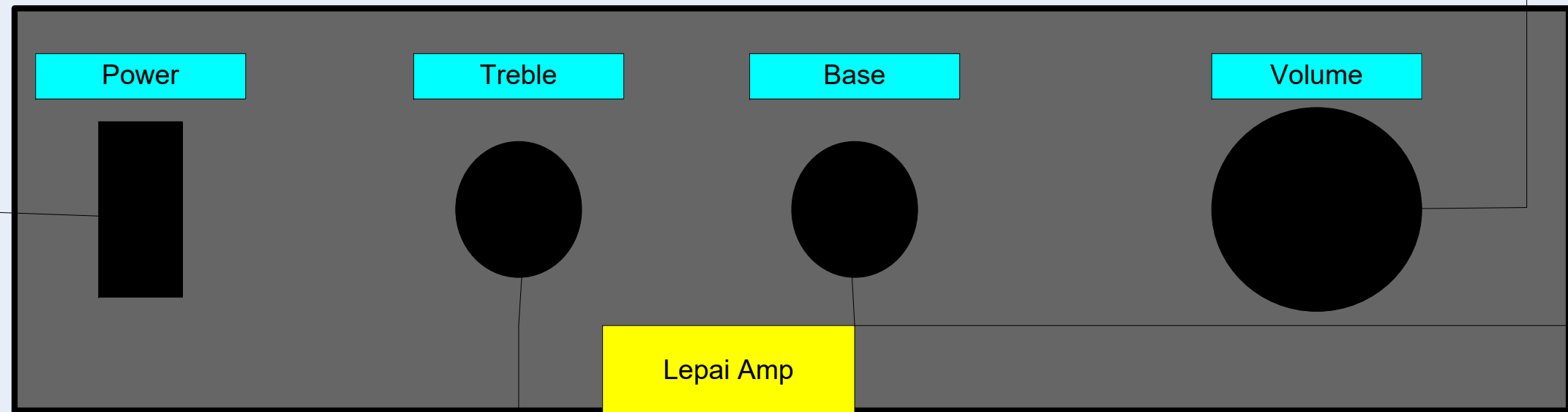

Set Base to 0 for normal operation

Set Treble to 0 for normal operation

Notes:

Drawn by: Brian Hillard
Date: 12-18-20
Scale: NTS

Troy School District
District Wide Paging Classroom Local Audio
Equipment Adjustments
Valcom IP6000 Class Connection

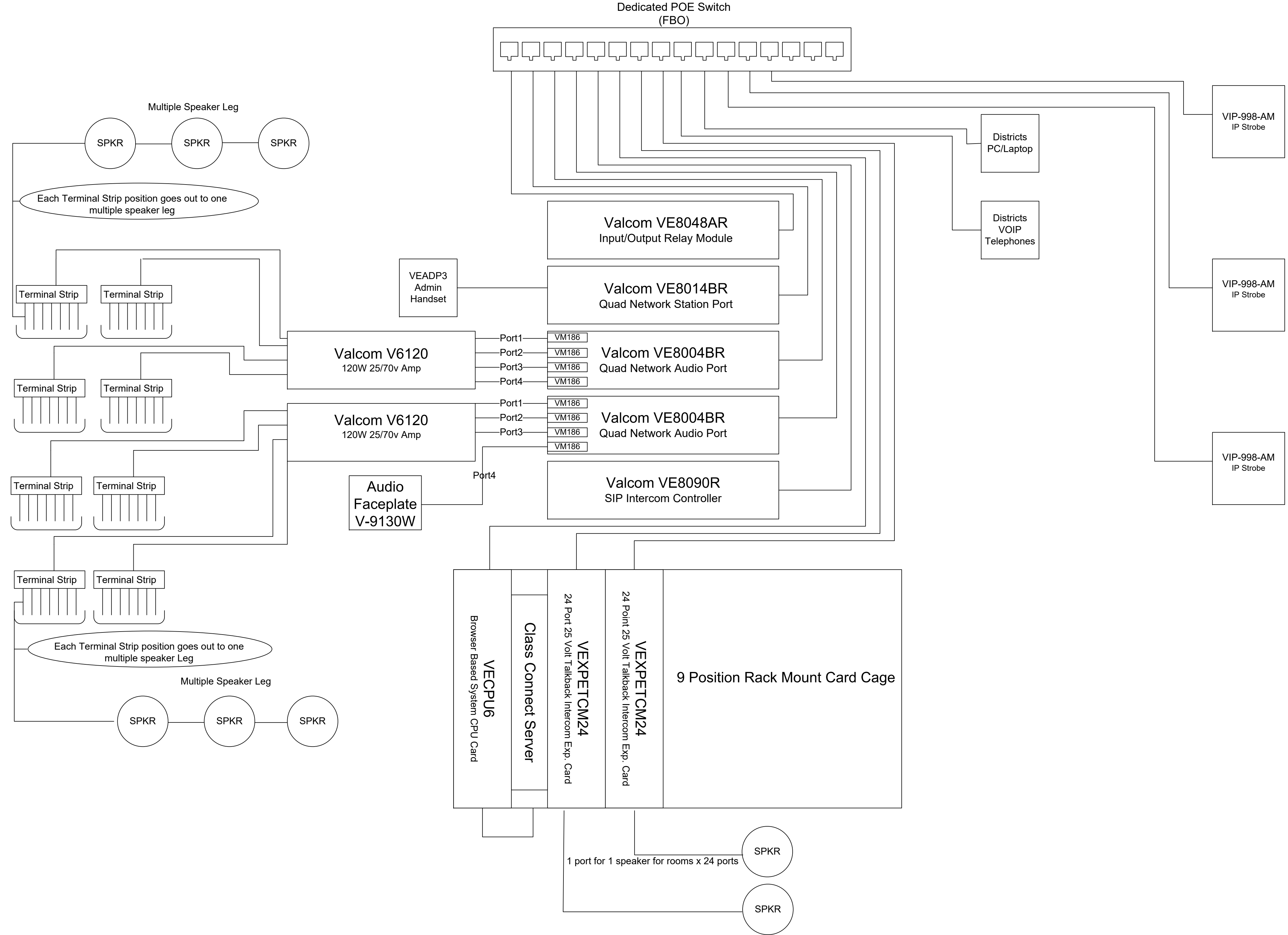

Notes:

Drawn by: Brian Hillard
 Date: 12-18-20
 Scale: NTS

Troy School District
 District Wide Paging Typical Riser Diagram
 Valcom Class Connection

5th Grade

Sophisticated Readers of Fantasy...

Research the setting.

Ask about po
who has it, evi
kinds of po



Grade 5 Science

YET

STORM DEFENDER



possible product or process

they're not there

2

HITAGITI!