

LODI UNIFIED SCHOOL DISTRICT

2021 Paving Projects– Phase III

PROJECT NUMBER: 0949-8249

DSA #:02-118898

Bear Creek High School

PROJECT NUMBER: 0941-8241

DSA #:02-118900

Delta Sierra Middle School

ADDENDA NO. 2

March 22, 2021

Owner: Lodi Unified School District
1305 E. Vine Street
Lodi, CA 95240

Engineer: Warren Consulting Engineers, Inc.
1117 Windfield Way
El Dorado Hill, CA 95762

Project Manager: Capital Program Management, Inc.
1851 Heritage Lane, Suite 210
Sacramento, CA 95815

This Addenda has been prepared to clarify, modify, delete, or add to the drawings and/or specifications for the above referenced project, and revisions to items listed here shall supersede description thereof prior to the above stated date. All conditions not specifically referenced here shall remain the same. It is the obligation of the Prime Contractor to make subcontractors aware of any items herein that may affect submitted bids.

Acknowledge receipt of this addendum by inserting its number and date in the bidding documents. Failure to do so may subject bidder to disqualification.

All addenda items refer to the plans and specifications unless specifically noted otherwise.

TOTAL PAGES IN THIS ADDENDUM (including attachments): 4

LODI UNIFIED SCHOOL DISTRICT

2021 Paving Projects – Phase III

PROJECT NUMBER: 0949-8249

DSA #:02-118898

Bear Creek High School

PROJECT NUMBER: 0941-8241

DSA #:02-118900

Delta Sierra Middle School

ADDENDA No. 2

PART A - BIDDING AND CONTRACT REQUIREMENTS

2.1 The bid date has not changed. Bids are due Thursday, March 25, 2021 by 2:00:00 p.m. at the Maintenance and Operations Building at 880 N. Guild Ave. Lodi California 95240.

PART B - TECHNICAL REQUIREMENTS

2.2 N/A

PART C - DRAWINGS

2.3 Bear Creek High School – Project #0949-8249 – DSA #02-118898. **Add** Sheet A-11 – As-Built Sprinkler Irrigation Plan Campus Area in its entirety.

PART D – RESPONSES TO CONTRACTOR QUESTIONS

2.4 **Question:** Is a Field Office for the inspector required for this contract?

Response: No.

2.5 **Question:** Is a Project identification sign required at each site for this contract?

Response: No.

2.6 **Question:** Is temporary perimeter fencing required for this contract?

Response: Temporary perimeter fencing is required for both sites.

2.7 **Question:** On sheet C3.1 Delta Sierra MS shows the HC stalls as concrete, however the note identifies as paving. Please clarify.

Response: The HC stalls are to be concrete, Type 3 Paving.

2.8 **Question:** Is there an as-built drawing of the existing irrigation layout at Bear Creek HS?

Response: See attached as-built sprinkler irrigation plan sheet A-11 for Bear Creek HS.

LODI UNIFIED SCHOOL DISTRICT

2021 Paving Projects – Phase III

PROJECT NUMBER: 0949-8249

DSA #:02-118898

Bear Creek High School

PROJECT NUMBER: 0941-8241

DSA #:02-118900

Delta Sierra Middle School

ADDENDA No. 2

2.9 **Question:** Per the drawings, it states the area to be lime at 12" vs the Geotech Report states lime or cement. Can it be either product?

Response: No, per the bid documents, 12" of lime is required.

2.10 **Question:** Is lime treatment to be part of the base bid?

Response: Yes, lime treatment is part of base bid.

PART E – List of Attachments

2.11 Attached is sheet A-11, As-built Sprinkler Irrigation Plan Campus Area.

End of Addendum

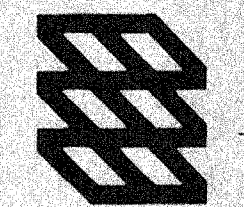

7300 Folsom Blvd. #200
Sacramento, CA 95826
916 381 0127

DENNIS TSUBOI & ASSOCIATES
LANDSCAPE ARCHITECTURE
ENVIRONMENTAL PLANNING
7300 Folsom Boulevard, Suite 202
Sacramento, California 95826
Telephone (916) 381-3700
CONSULTANT

BEAR CREEK HIGH SCHOOL
LODI UNIFIED SCHOOL DISTRICT
THORNTON ROAD, STOCKTON, CALIFORNIA

OSA - STRUCTURAL SAFETY SECTION

OSA - ACCESS COMPLIANCE SECTION

STATE FIRE MARSHAL

REVISIONS		
NO.	DESCRIPTION	DATE APPD

DATE NOV. 11 1988

JOB NO. 3193.00

SHEET TITLE
**SPRINKLER
IRRIGATION PLAN
CAMPUS AREA**

SHEET NO.

A-11

OF
SHEET OF TOTAL

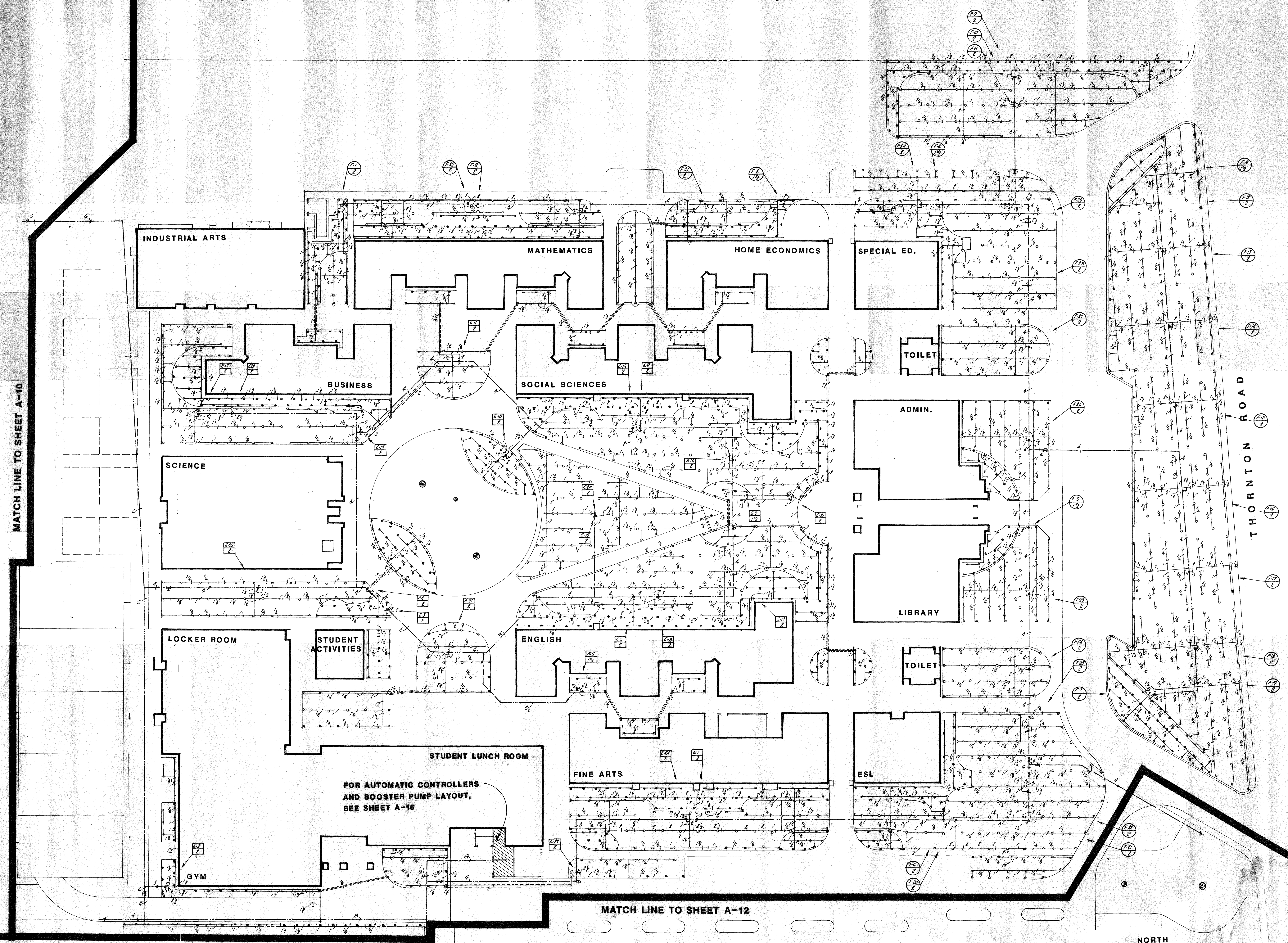

BIDDERS NOTE: THE PORTION OF SPRINKLER IRRIGATION SYSTEM TO BE DEDUCTED AND INCLUDED AS PART OF DEDUCTIVE ALTERNATE ITEM NO. 2 IS ALL THE LATERAL LINES AND SPRINKLER HEADS DOWN STREAM OF ALL AUTOMATIC CONTROL VALVES FROM "P" AND "P" CONTROLLER. MAIN LINE, AUTOMATIC CONTROL VALVES, GATE VALVES, QUICK CLOSURE VALVES, CONTROL WIRE AND AUTOMATIC CONTROLLER "P" AND "P" TO REMAIN A PART OF BASE BID.

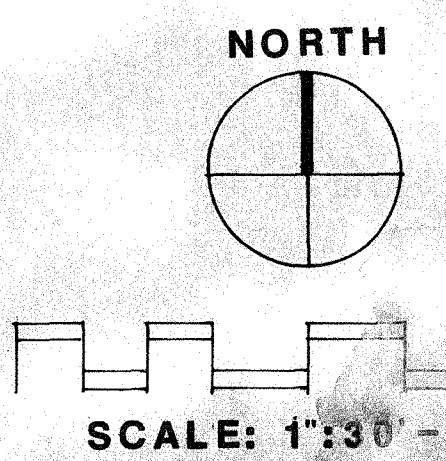

FOR SPRINKLER IRRIGATION LEGEND AND NOTES, SEE SHEET A-13
FOR SPRINKLER IRRIGATION DETAILS, SEE SHEET A-14

MATCH LINE TO SHEET A-10

MATCH LINE TO SHEET A-12

THORNTON ROAD

TB
I
O
ARCH