



Ferndale High School

Design Advisory Committee – Meeting #1

August 13, 2019

Let's imagine a new **Ferndale High School »**



Agenda



Why are we here?

What is the role of the Design Advisory Committee?

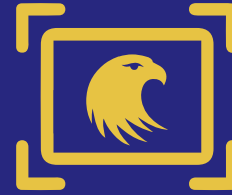

Project Snapshot

Learn about the basics of the Ferndale High School project and why a modernized school is needed.



What is visioning?

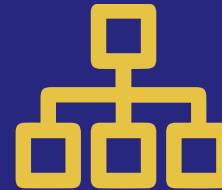

Emerging Themes

We care what you think! Let's imagine your school.

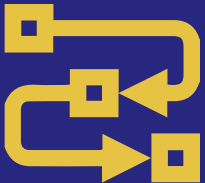

Next Steps

What comes next after the visioning process.



Follow Us

Keep up to date with the project online.



Why are we here?

The role of the Design Advisory Committee,
and why your involvement is critical



Group Activity

NORMS based on the FOUR CORNERS activity



1. Value the unique gifts each person brings to our group.

From Norths...Our Warriors

2. Show up, be visible, be present and engaged.

3. Empower others through example and intention.

From Souths...Our Healers

4. Pay attention to what has heart and meaning.

5. Extend the arms of acceptance, recognition, and acknowledgment.

From Easts...Our Visionaries

6. Tell the truth without blame or judgment.

7. Exercise personal creativity and allow others to do the same.

From Wests...Our Teachers

8. Be open to new ideas rather than attached to outcomes.

9. Be comfortable with states of not knowing.



Project Snapshot

Learn about the basics of the Ferndale High School project



How many
students?

Current student
population is

1192

Designing for
the future of

1600

How big will the
school be?

+/- 191,000 sq. feet

How many
floors?

2-3 floors



What will the building look like?

We don't know! That's what this process is about.

Where will students be during school construction?

At Ferndale H.S.

When will the “new” high school open?

Fall 2023

Ferndale High School Site





What is Visioning?

Who participates in the process?



Design Advisory Committee (DAC)

Committee members selected from interested students, community, and district staff.

Executive Committee

District administrators, building leadership, planners and architects.



What is the goal of the visioning process?

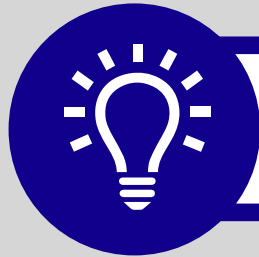

**Visioning
Process**

**Determines the educational
and aspirational goals for
the project.**



**Ed-Spec
Process**

**Determines the detailed
functional and spatial
requirements for the
project.**

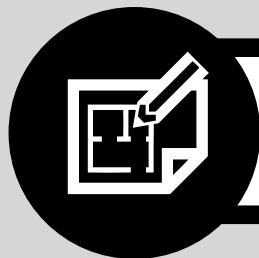

**School Design &
Development**

**Determines
what the school
will look like
and how it will
function.**



Instruction drives construction.

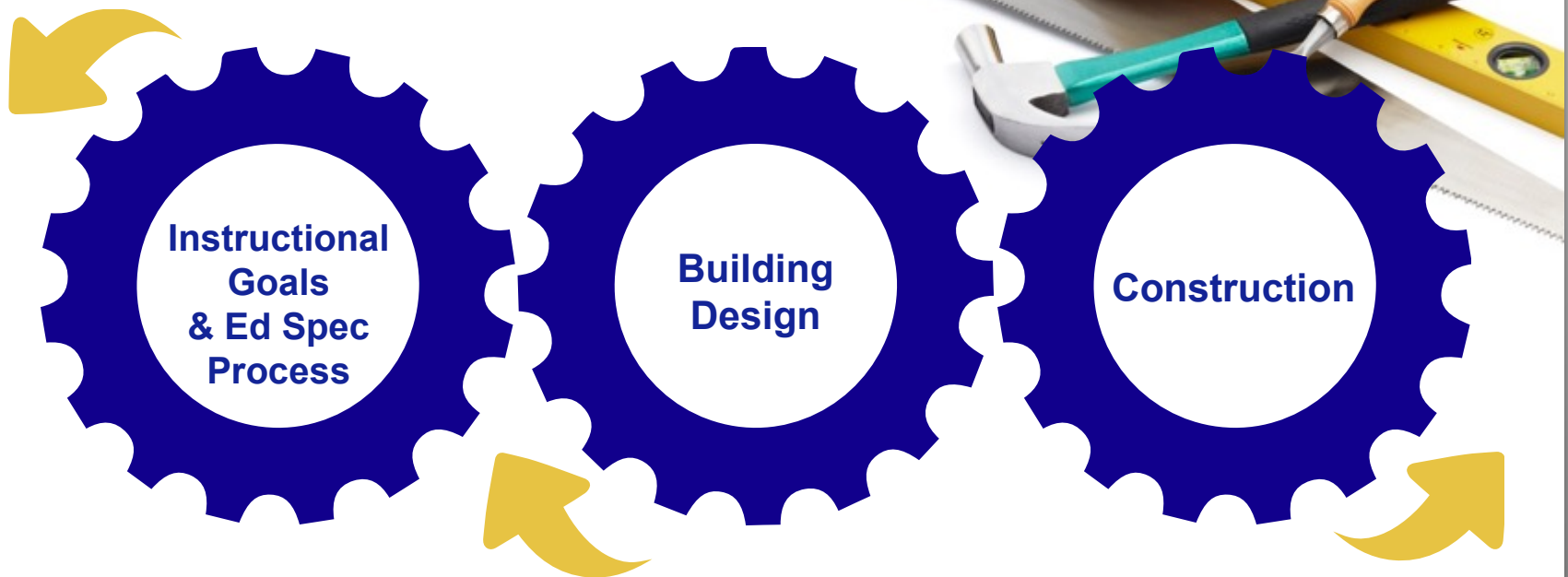



Let's take a break

We'll reconvene in 10 minutes.

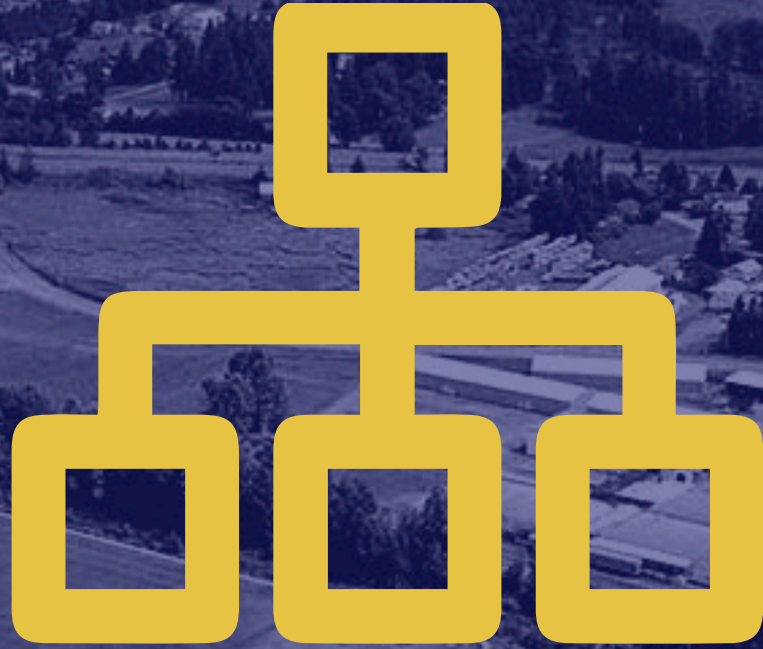

Emerging Themes

Themes collected from the Town Hall meeting

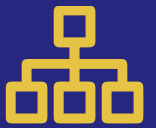

Wishes and Wonders

What are your hopes and dreams for this school? If you had **one wish** what would it be? And if you had **one wonder** what would it be?

"I wish for highly functional, flexible, and adaptable learning spaces."

"I wonder if the new school will be adaptable to future growth and technology."

"I wish that the school is inclusive of all cultures represented in the district."

"I wonder how much of the existing building will be kept."

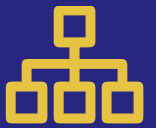

Keep, Stop, Start

As you think about your existing and new school environments, what would you like to **keep**, **stop**, and **start** doing?

“Start improving and controlling site access.”

“Keep Ferndale character and an inclusive culture.”

“Stop the poor traffic flow and limit onsite parking.”

- Ferndale community member



Ferndale High School Design Advisory Committee

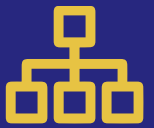

"How will we ensure that we fully represent all the different cultures throughout the project? It provides a sense for young people."

"I'd like to see an accelerated timeline for construction. Lessens the impact to the community."

"The timeline seems long. Can we finish it sooner?"

"The 'back side' of FHS May be viable to I-5 south bound traffic. Would love to see the design be such to welcome and draw people to check out our City"

"I hope we can honor the Lummi/Salish culture in some of the design."

"If we are budgeting on the low range for \$/student and \$/sf, how do we know we won't end up with higher costs later in design?"

"Initial Site Design - What was the initial site plan that was used for the GCCM application?"

"How many square feet is the building going to be? Cost perspective"

"Is the area big enough. What about the bus garage is that staying?"

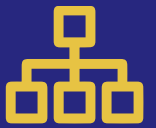

"Building Reuse/Remodel Does Dykeman feel any of the buildings (Gym) could be remodeled to loosen up the budget? It seems tight."

"Where is the proposed building site of the new school?"

"I hope that student safety is highly considered during the entire planning and building process. Because of the amount of school shootings that are frequently occurring throughout the country."

"Has the location changed from the original plan? Worried this could impact the view in my neighborhood."

"What measures will be put in place to ensure the students are not parking or using our neighborhood for smoke breaks? We live in a safe place and great neighborhood with small kids."

"This school must be a community resource. Add value to the community and the students education."

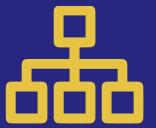

Making sense of it all



With your table group, organize community comments into the following categories:

**PROGRAMS &
EDUCATION**

DESIGN

COMMUNITY

**FHS
CULTURE**

**SAFETY &
SECURITY**

OTHER

...and feel free to add comments of your own!

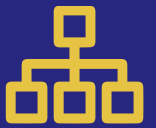

- **Themes** capture both direct and subtle insights of voices heard to date.
- **Outliers** capture the unique voices that were not part of general themes.

What have we missed?

Themes capture both direct and subtle insights of voices heard to date.

- **What did you notice about the themes? What did you notice about the outliers?**
- A school community is wonderfully complex, however that complexity can cause oversights.
- **Are there any key ideas that are not included yet?**
- As members of Ferndale School District, did you see any themes that were misinterpreted and/or misstated?



Next Steps

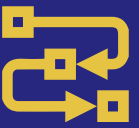

- **Alexandria Area High School**, *Minnesota*
- **Ernest McBride Sr. High School**, *California*
- **Marine Science Magnet High School**, *Connecticut*
- **Vashon Island High School**, *Washington*
- **Joplin Interim High School**, *Missouri*
- **Kathlyn Joy Gilliam Academy**, *Texas*
- **Sammamish High School**, *Washington*

Design Advisory Committee Meeting #2 (high school tours!): August 26, 2019



Follow the Project

Keep up to date with the project at:
[\[web URL here\]](#)