



8612 Eagle Creek Parkway, Savage, MN 55378
Tel: (952) 746-5880 ♦ Fax: (952) 746-5882
Mailbox@FieldConsultingInc.com
www.FieldConsultingInc.com

Independent School District #191
200 Burnsville Pkwy
Burnsville, MN 55337
Attn: Mr. Glenn Simon

RE: Lead in Drinking Water Sampling
SITE: Edward Neill Elementary
DATE: January 2019

Dear Glenn Simon,

Field Environmental Consulting, Inc. (FIELD ENVIRONMENTAL) appreciates the opportunity to provide results for lead in drinking water sampling conducted at Edward Neill Elementary.

Initial sampling (“first draw”) was completed on Wednesday, October 31, 2018*. One (1) out of the sixty-two (62) initial first draw samples collected at Edward Neill Elementary School was above the recommended limit of 20 ppb. Provided with results, ISD #191 removed the tap, a kettle located in the kitchen, from service.

Analysis was conducted by Pace Analytical Services, Inc. of Minneapolis, Minnesota using EPA Method 200.8 ICPMS for determination of trace elements in drinking water.

PREPARED and REVIEWED BY:

Field Environmental Consulting, Inc.

Amy Weinzierl (CSP #27824)
Environmental Health and Safety Manager
amy@fieldconsultinginc.com
952-746-5880

*sampling was performed by ISD #191 Health & Safety Supervisor

LEAD IN THE WATER TESTING**BUILDING: Edward Neill UL****DATE 10/31/2018**

TYPE OF FAUCET WC - water cooler DF - drinking fountain S - Sink K - Kettle BF - Bottle Filler

Lead < = 20 ppb, **Lead > 20 ppb (Action Level)**, ND= None Detected

	LABEL	BUILDING	ROOM/LOCATION	TYPE OF FAUCET	LEAD RESULT (ppb or µg/L)
1	01	EN	1	S	ND
2	02	EN	1	DF	ND
3	03	EN	3	S	5.2
4	04	EN	3	DF	2.9
5	05	EN	4	S	2.0
6	06	EN	4	DF	ND
7	07	EN	Staff Lounge	S	ND
8	08	EN	Kitchen west wall Left tap	S	1.4
9	09	EN	Kitchen west wall Right tap	S	1.6
10	10	EN	Kitchen by stoves Left tap	HW	4.1
11	11	EN	Kitchen by stoves Right tap	K	58.2
Kettle Removed					
12	12	EN	Left WC in hallway by classroom 5	WC	ND
13	13	EN	Right WC in hallway by classroom 5	WC	ND
14	14	EN	6	S	8.3
15	15	EN	6	DF	5.9
16	16	EN	7	S	6.2
17	17	EN	7	DF	6.0
18	18	EN	8	S	5.9
19	19	EN	8	DF	1.4
20	20	EN	9	S	0.67
21	21	EN	9	DF	ND
22	22	EN	10	S	0.76
23	23	EN	10	DF	ND
24	24	EN	Left WC in hallway by classroom 10	WC	ND

LEAD IN THE WATER TESTING**BUILDING:Edward Neill UL 2****DATE 10/31/2018**

TYPE OF FAUCET WC - water cooler DF - drinking fountain S - Sink K - Kettle BF - Bottle Filler

Lead < = 20 ppb, Lead > 20 ppb (Action Level), ND= None Detected

	LABEL	BUILDING	ROOM/LOCATION	TYPE OF FAUCET	LEAD RESULT (ppb or µg/L)
1	25	EN	Right WC in hallway by classroom 10	WC	ND
2	26	EN	11	S	1.0
3	27	EN	11	DF	ND
4	28	EN	12	S	0.50
5	29	EN	12	DF	0.78
6	30	EN	13	S	1.1
7	31	EN	13	DF	0.67
8	32	EN	14	S	1.4
9	33	EN	14	DF	1.5
10	34	EN	15	S	1.9
11	35	EN	15	DF	1.2
12	36	EN	Left WC in hallway by classroom 15	WC	ND
13	37	EN	Right WC in hallway by classroom 15	WC	ND
14	38	EN	Multi-purpose Room, South	S	0.68
15	39	EN	Multi-purpose Room, North	DF	ND
16	40	EN	16	S	1.2
17	41	EN	16	DF	ND
18	42	EN	17	S	0.83
19	43	EN	17	DF	ND
20	44	EN	18	S	0.80
21	45	EN	18	DF	ND
22	46	EN	Speech Therapy	S	2.8
23	47	EN	19	S	1.2
24	48	EN	19	DF	ND

LEAD IN THE WATER TESTING**BUILDING: Edward Neill UL 3****DATE 10/31/2018**

TYPE OF FAUCET WC - water cooler DF - drinking fountain S - Sink K - Kettle BF - Bottle Filler

Lead < = 20 ppb, **Lead > 20 ppb (Action Level)**, ND= None Detected

	LABEL	BUILDING	ROOM/LOCATION	TYPE OF FAUCET	LEAD RESULT (ppb or µg/L)
1	49	EN	20	S	1.4
2	50	EN	20	DF	0.75
3	51	EN	21	S	2.6
4	52	EN	21	DF	1.2
5	53	EN	Left WC in hallway by classroom 21	WC	ND
6	54	EN	Right WC in hallway by classroom 21	WC	ND
7	55	EN	22	S	4.6
8	56	EN	22	DF	1.6
9	57	EN	Nurses Office	S	ND
10	58	EN	Sp Ed	S	8.6
11	59	EN	Sp Ed	DF	ND
12	60	EN	DSL Left	S	ND
13	61	EN	DSL Right	S	1.6
14	62	EN	Media Workroom	S	0.63

Edward Neill



1st Floor

Edward Neill

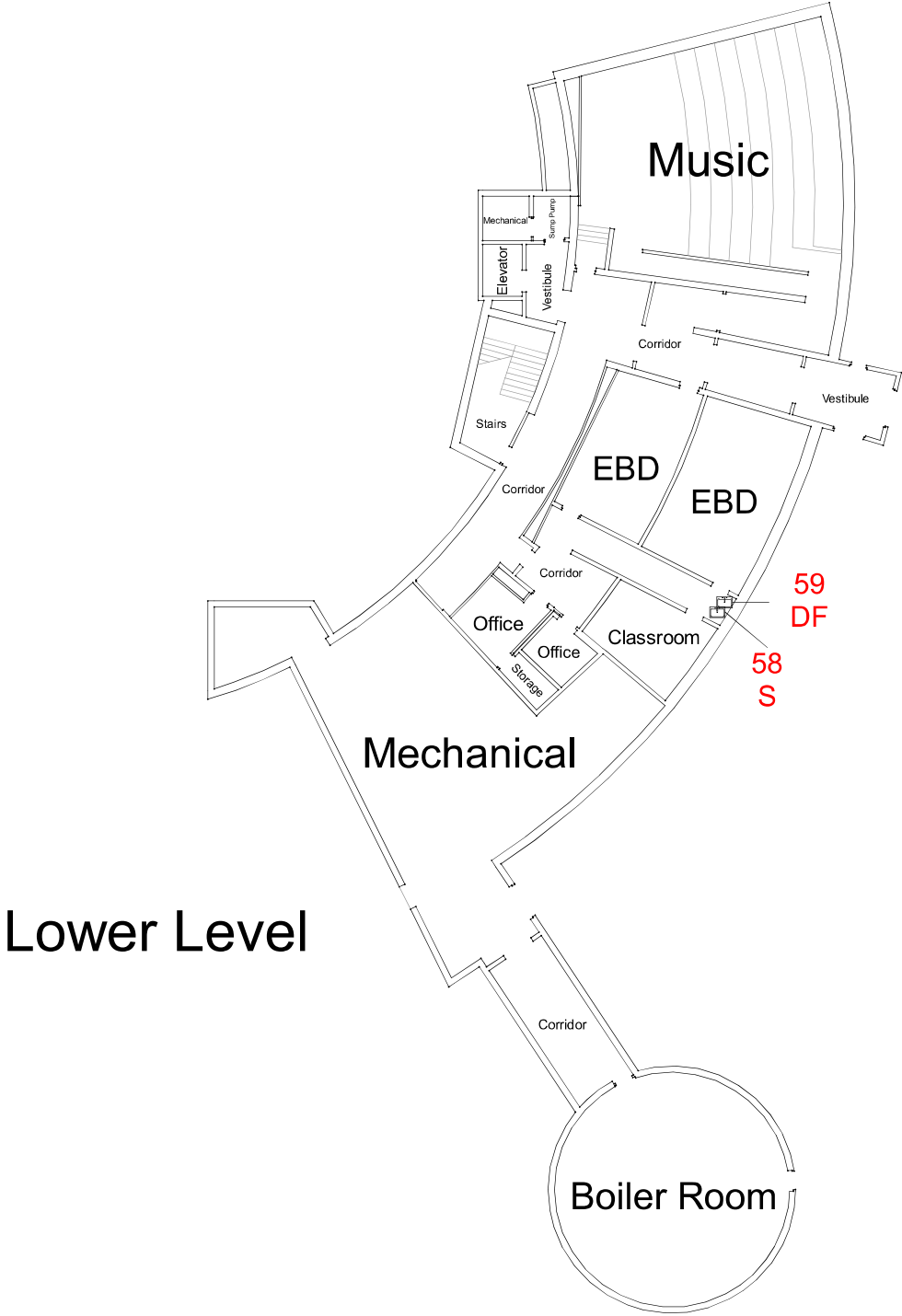

Lower Level