



8612 Eagle Creek Parkway, Savage, MN 55378

Tel: (952) 746-5880 ♦ Fax: (952) 746-5882

Mailbox@FieldConsultingInc.com

www.FieldConsultingInc.com

Independent School District #191
200 Burnsville Pkwy
Burnsville, MN 55337
Attn: Mr. Glenn Simon

RE: Lead in Drinking Water Sampling
SITE: Hidden Valley Elementary
DATE: January 2019

Dear Glenn Simon,

Field Environmental Consulting, Inc. (FIELD ENVIRONMENTAL) appreciates the opportunity to provide results for lead in drinking water sampling conducted at Hidden Valley Elementary.

Initial sampling ("first draw") was completed on Friday, October 26, 2018*. Two (2) out of the seventy-two (72) initial first draw samples collected at Hidden Valley Elementary School were above the recommended limit of 20 ppb. Provided with results, ISD #191 cleaned aerators for the identified taps. After aerator cleaning was completed, ISD #191 re-sampled identified taps on November 29, 2018. Re-sampling results were below the recommended limit of 20 ppb.

Analysis was conducted by Pace Analytical Services, Inc. of Minneapolis, Minnesota using EPA Method 200.8 ICPMS for determination of trace elements in drinking water.

PREPARED and REVIEWED BY:

Field Environmental Consulting, Inc.

A handwritten signature in blue ink that reads "Amy Weinzierl".

Amy Weinzierl (CSP #27824)
Environmental Health and Safety Manager
amy@fieldconsultinginc.com
952-746-5880

*sampling was performed by ISD #191 Health & Safety Supervisor

LEAD IN THE WATER TESTING**BUILDING: Hidden Valley UL****DATE 10/26/2018**

TYPE OF FAUCET WC - water cooler DF - drinking fountain S - Sink K - Kettle BF - Bottle Filler

Lead < = 20 ppb, **Lead > 20 ppb (Action Level)**, ND= None Detected

	LABEL	BUILDING	ROOM/LOCATION	TYPE OF FAUCET	LEAD RESULT (ppb or µg/L)
1	01	HV	East side of kitchen	S	1.3
2	02	HV	Center	S	ND
3	03	HV	West side of kitchen	S	2.9
4	04	HV	Between bathrooms outside of the gym	WC	ND
5	05	HV	K4	S	1.4
6	06	HV	K4	DF	1.1
7	07	HV	K3	S	ND
8	08	HV	K3	DF	ND
9	09	HV	K2	S	2.0
10	10	HV	K2	DF	ND
11	11	HV	K1	S	ND
12	12	HV	K1	DF	ND
13	13	HV	Main office work room	S	17.2
14	14	HV	Main office work room	DF	ND
15	15	HV	Nurse's office	S	1.3
16	16	HV	Nurse's office	DF	1.6
17	17	HV	Computer Lab	S	ND
18	18	HV	Computer Lab	DF	1.4
19	19	HV	101	S	ND
20	20	HV	101	DF	ND
21	21	HV	102	S	ND
22	22	HV	102	DF	ND
23	23	HV	103	S	3.4
24	24	HV	103	DF	ND

LEAD IN THE WATER TESTING**BUILDING: Hidden Valley UL****DATE 10/26/2018**

TYPE OF FAUCET WC - water cooler DF - drinking fountain S - Sink K - Kettle BF - Bottle Filler

Lead < = 20 ppb, **Lead > 20 ppb (Action Level)**, ND= None Detected

	LABEL	BUILDING	ROOM/LOCATION	TYPE OF FAUCET	LEAD RESULT (ppb or µg/L)
1	25	HV	104	S	3.7
2	26	HV	104	DF	ND
3	27	HV	WC in hallway outside 104	WC	ND
4	28	HV	105	S	1.4
5	29	HV	105	DF	ND
6	30	HV	106	S	ND
7	31	HV	106	DF	ND
8	32	HV	107	S	ND
9	33	HV	107	DF	1.2
10	34	HV	108	S	ND
11	35	HV	108	DF	ND
12	36	HV	WC in hallway outside 109	WC	ND
13	37	HV	109	S	ND
14	38	HV	109	DF	1.8
15	39	HV	110	S	2.1
16	40	HV	110	DF	ND
17	41	HV	111	S	ND
18	42	HV	111	DF	ND
19	43	HV	112	S	50.1
43-Resample 11/29/2018					5.5
20	44	HV	112	DF	ND

LEAD IN THE WATER TESTING**BUILDING: Hidden Valley, LL****DATE: 10/26/2018**

TYPE OF FAUCET WC - water cooler DF - drinking fountain S - Sink K - Kettle BF - Bottle Filler

Lead <= 20 ppb, **Lead > 20 ppb (Action Level)**, ND= None Detected

	LABEL	BUILDING	ROOM/LOCATION	TYPE OF FAUCET	LEAD RESULT (ppb or µg/L)
1	45	HV	Media Ctr AV workroom	S	7.9
2	46	HV	WC outside of Art room	WC	ND
3	47	HV	212	S	1.3
4	48	HV	212	DF	ND
5	49	HV	211	S	2.3
6	50	HV	211	DF	1.2
7	51	HV	210	S	3.7
8	52	HV	210	DF	1.2
9	53	HV	209	S	31.8
53- Resample 11/29/2018					14.9
10	54	HV	209	DF	1.6
11	55	HV	208	S	2.0
12	56	HV	208	DF	1.6
13	57	HV	207	S	3.8
14	58	HV	207	DF	ND
15	59	HV	206	S	ND
16	60	HV	206	DF	1.3
17	61	HV	205	S	2.7
18	62	HV	205	DF	ND
19	63	HV	204	S	3.4
20	64	HV	204	DF	1.4
21	65	HV	203	S	3.9
22	66	HV	203	DF	ND
23	67	HV	202	S	ND
24	68	HV	202	DF	1.1

LEAD IN THE WATER TESTING**BUILDING: Hidden Valley LL****DATE 10/26/2018**

TYPE OF FAUCET WC - water cooler DF - drinking fountain S - Sink K - Kettle BF - Bottle Filler

Lead < = 20 ppb, **Lead > 20 ppb (Action Level)**, ND= None Detected

	LABEL	BUILDING	ROOM/LOCATION	TYPE OF FAUCET	LEAD RESULT (ppb or µg/L)
1	69	HV	201	S	ND
2	70	HV	201	DF	ND
3	71	HV	Staff Lounge	S	2.3
4	72	HV	Hallway outside room 204	WC	ND

Hidden Valley Elementary



Upper Level

Hidden Valley Elementary

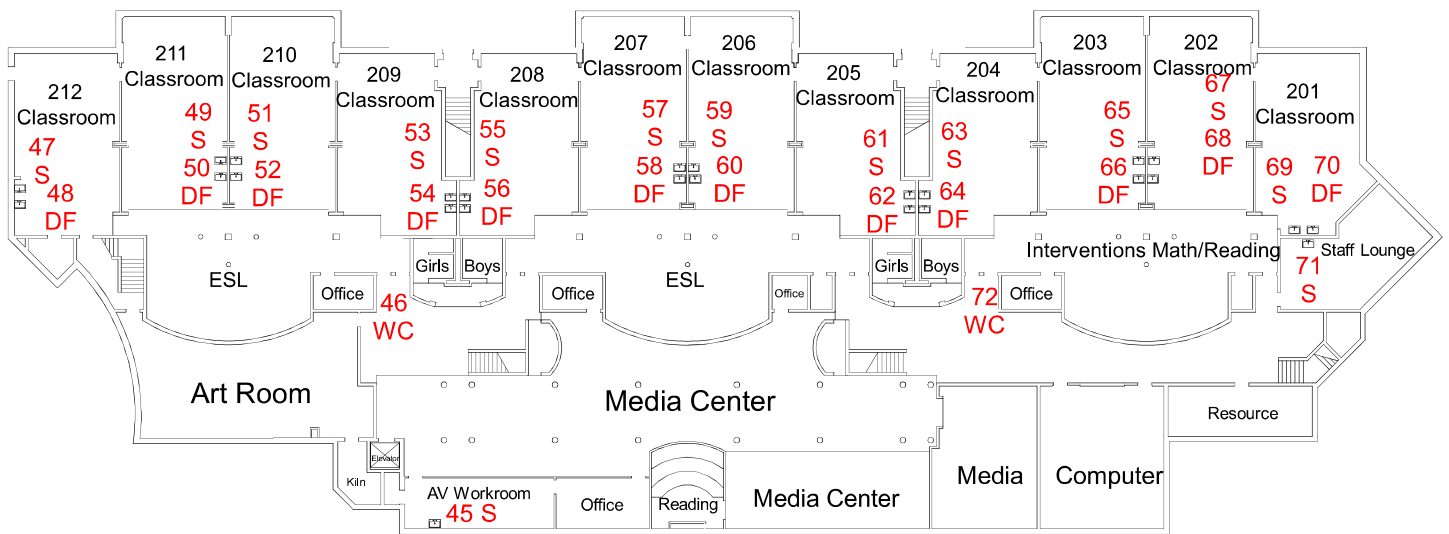

Lower Level