



8612 Eagle Creek Parkway, Savage, MN 55378
Tel: (952) 746-5880 ♦ Fax: (952) 746-5882
Mailbox@FieldConsultingInc.com
www.FieldConsultingInc.com

Independent School District #191
200 Burnsville Pkwy
Burnsville, MN 55337
Attn: Mr. Glenn Simon

RE: Lead in Drinking Water Sampling
SITE: Gideon Pond Elementary
DATE: January 2019

Dear Glenn Simon,

Field Environmental Consulting, Inc. (FIELD ENVIRONMENTAL) appreciates the opportunity to provide results for lead in drinking water sampling conducted at Gideon Pond Elementary.

Initial sampling ("first draw") was completed on Wednesday, October 31, 2018⁺. All sixty-six (66) initial first draw samples collected at Gideon Pond Elementary were below the recommended limit of 20 ppb. (or µg/L).

Analysis was conducted by Pace Analytical Services, Inc. of Minneapolis, Minnesota using EPA Method 200.8 ICPMS for determination of trace elements in drinking water.

PREPARED and REVIEWED BY:

Field Environmental Consulting, Inc.

A handwritten signature in cursive script, appearing to read "Amy Weinzierl".

Amy Weinzierl (CSP #27824)
Environmental Health and Safety Manager
amy@fieldconsultinginc.com
952-746-5880

*sampling was performed by ISD #191 Health & Safety Supervisor

LEAD IN THE WATER TESTING**BUILDING: Gideon Pond LL 1****DATE 10/31/2018**

TYPE OF FAUCET WC - water cooler DF - drinking fountain S - Sink K - Kettle BF - Bottle Filler

Lead < = 20 ppb, **Lead > 20 ppb (Action Level)**, ND= None Detected

	LABEL	BUILDING	ROOM/LOCATION	TYPE OF FAUCET	LEAD RESULT (ppb or µg/L)
1	01	GP	101	S	1.3
2	02	GP	101	DF	ND
3	03	GP	102	S	1.5
4	04	GP	102	DF	ND
5	05	GP	104	S	0.82
6	06	GP	104	DF	ND
7	07	GP	105	S	0.60
8	08	GP	105	DF	0.75
9	09	GP	107	S	1.3
10	10	GP	107	DF	ND
11	11	GP	108	S	0.95
12	12	GP	108	DF	ND
13	13	GP	118	S	3.6
14	14	GP	WC in hallway outside girls bathroom across from gym	WC	ND
15	15	GP	WC in hallway outside boys bathroom across from gym RT	WC	ND
16	16	GP	WC in hallway outside boys bathroom across from gym LT	WC	ND
17	17	GP	122 left tap	S	15.2
18	18	GP	122 center tap	S	5.5
19	19	GP	122 right tap	S	7.7
20	20	GP	Kitchen north wall, left tap	S	ND
21	21	GP	Kitchen north wall, right tap	S	ND
22	22	GP	Kitchen tap in island	S	1.3
23	23	GP	Kitchen south wall tap	S	6.8

LEAD IN THE WATER TESTING**BUILDING: Gideon Pond UL 1****DATE 10/31/2018**

TYPE OF FAUCET WC - water cooler DF - drinking fountain S - Sink K - Kettle BF - Bottle Filler

Lead < = 20 ppb, Lead > 20 ppb (Action Level), ND= None Detected

	LABEL	BUILDING	ROOM/LOCATION	TYPE OF FAUCET	LEAD RESULT (ppb or µg/L)
1	24	GP	214	S	3.4
2	25	GP	214	DF	ND
3	26	GP	213	S	2.6
4	27	GP	213	DF	ND
5	28	GP	212	S	1.2
6	29	GP	212	DF	ND
7	30	GP	211	S	1.5
8	31	GP	211	DF	ND
9	32	GP	Workroom	S	1.9
10	33	GP	WC in hallway outside 211	WC	ND
11	34	GP	WC in hallway outside 210	WC	1.1
12	35	GP	210	S	1.5
13	36	GP	210	DF	ND
14	37	GP	209	S	0.98
15	38	GP	209	DF	ND
16	39	GP	208	S	0.89
17	40	GP	208	DF	ND
18	41	GP	207	S	1.1
19	42	GP	207	DF	ND
20	43	NO SAMPLE COLLECTED			
21	44	GP	WC in hallway outside 207 Right	WC	ND
22	45	GP	206	S	1.0
23	46	GP	206	DF	ND
24	47	GP	205	S	3.4

LEAD IN THE WATER TESTING**BUILDING: Gideon Pond UL 2****DATE 10/31/2018**

TYPE OF FAUCET WC - water cooler DF - drinking fountain S - Sink K - Kettle BF - Bottle Filler

Lead < = 20 ppb, Lead > 20 ppb (Action Level), ND= None Detected

	LABEL	BUILDING	ROOM/LOCATION	TYPE OF FAUCET	LEAD RESULT (ppb or µg/L)
1	48	GP	205	DF	ND
2	49	GP	204	S	1.4
3	50	GP	204	DF	ND
4	51	GP	203	S	1.8
5	52	GP	203	DF	ND
6	53	GP	Nurse's office	S	1.1
7	54	GP	Main Office Conference Room	S	3.8
8	55	NO SAMPLE COLLECTED			
9	56	GP	WC in hallway outside 218	WC	1.1
10	57	GP	218	S	1.0
11	58	GP	218	DF	ND
12	59	GP	219	S	2.5
13	60	GP	217	S	1.4
14	61	GP	217	DF	ND
15	62	GP	216	S	0.94
16	63	GP	216	DF	ND
17	64	GP	215	S	3.7
18	65	GP	215	DF	ND
19	66	GP	WC in hallway outside north boys bathroom Left	WC	ND
20	67	GP	WC in hallway outside north boys bathroom Right	WC	ND
21	68	GP	223	S	1.5
22	69	GP	223	DF	ND

Gideon Pond

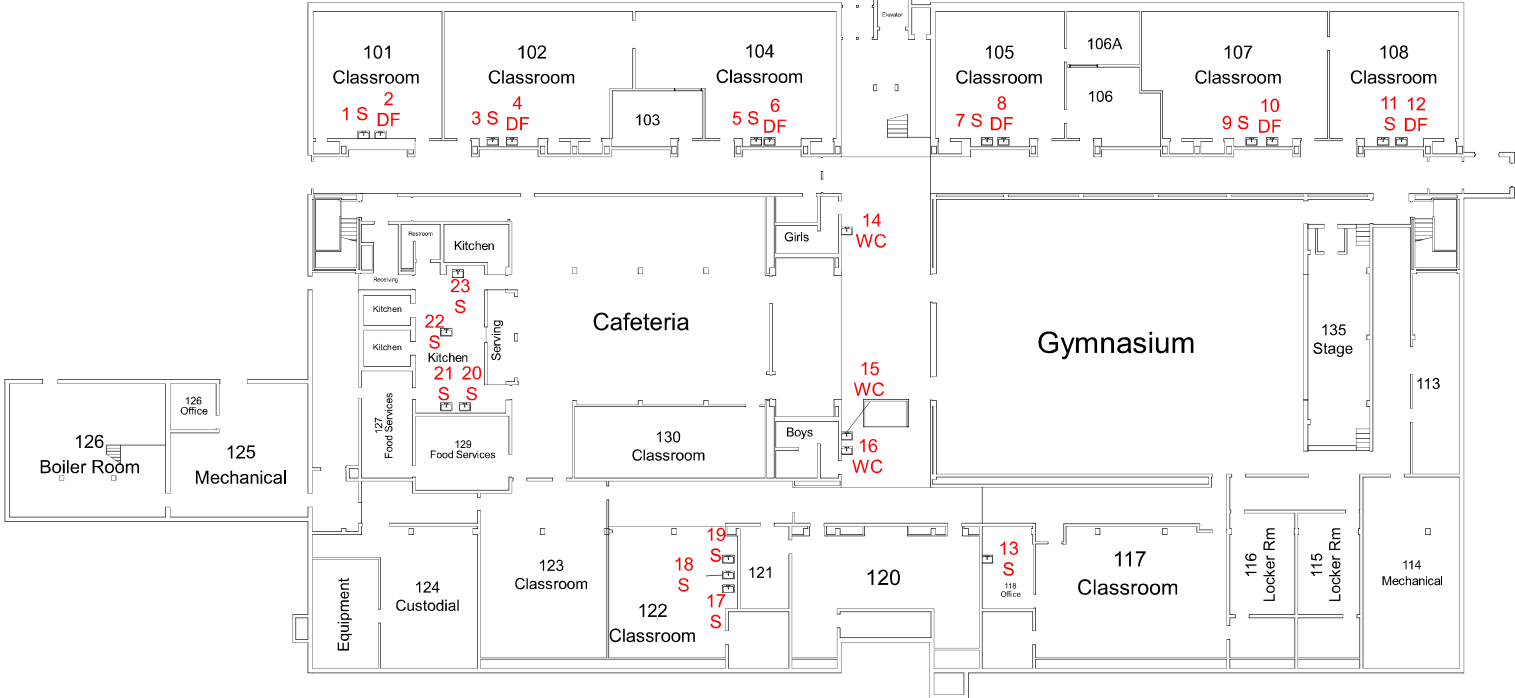

First Floor

Gideon Pond

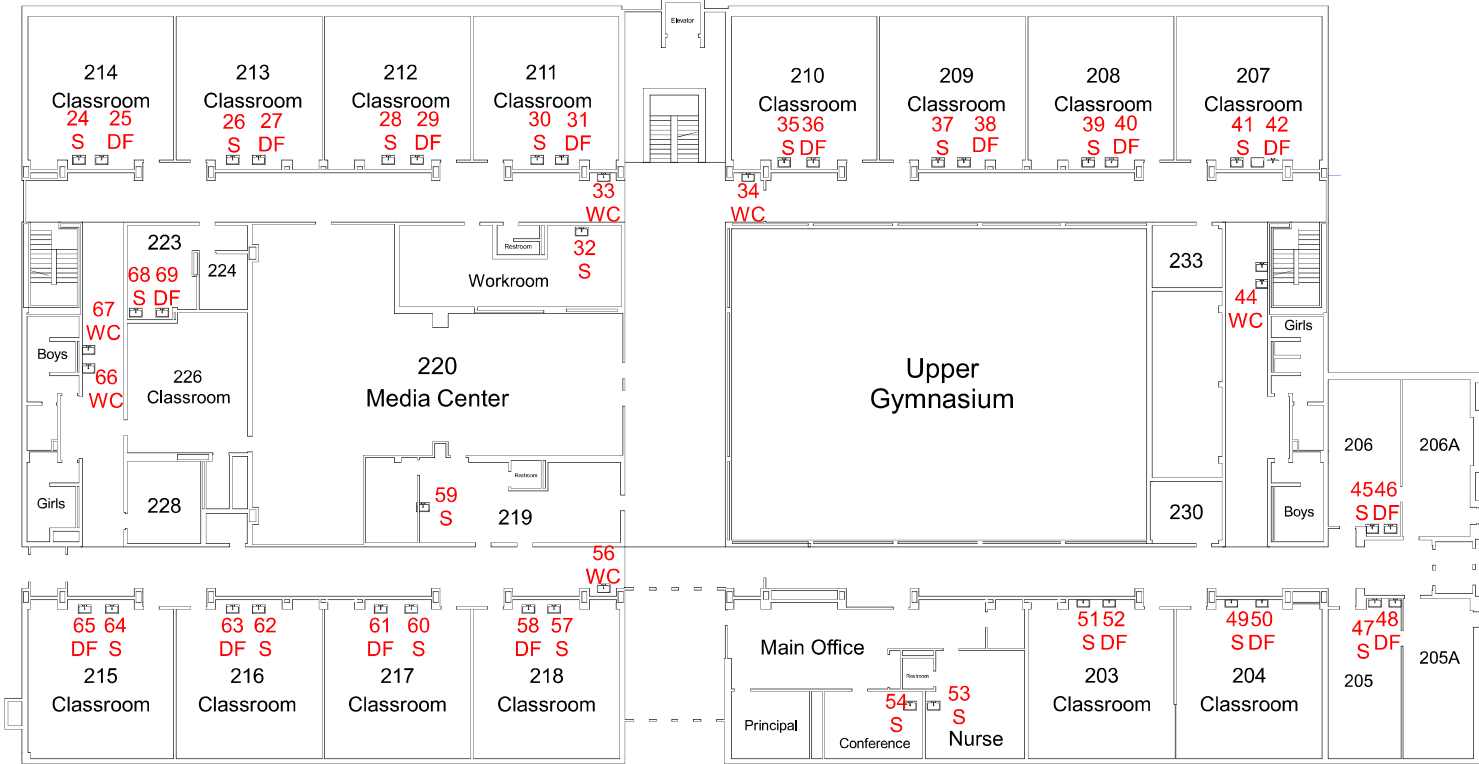

Second Floor