



8612 Eagle Creek Parkway, Savage, MN 55378

Tel: (952) 746-5880 ♦ Fax: (952) 746-5882

Mailbox@FieldConsultingInc.com

www.FieldConsultingInc.com

Independent School District #191

200 Burnsville Pkwy

Burnsville, MN 55337

Attn: Mr. Glenn Simon

RE: Lead in Drinking Water Sampling

SITE: Vista View Elementary

DATE: January 2019

Dear Glenn Simon,

Field Environmental Consulting, Inc. (FIELD ENVIRONMENTAL) appreciates the opportunity to provide results for lead in drinking water sampling conducted at Vista View Elementary.

Initial sampling ("first draw") was completed on Tuesday, October 30, 2018*. Two (2) out of the sixty-seven (67) initial first draw samples collected at Vista View Elementary were above the recommended limit of 20 ppb. Provided with results, ISD #191 cleaned aerators for the identified taps. After aerator cleaning was completed, ISD #191 re-sampled identified taps on November 29, 2018. Re-sampling results were below the recommended limit of 20 ppb for the water cooler located in the hallway outside room 213. However, results for sample sink located in classroom 115 were remained above the recommended limit. After reviewing results, ISD #191 re-cleaned the aerator and re-sampled this tap using initial and thirty (30) second flush sampling methods on Friday, December 14, 2018. Re-sampling results were below the recommended limit of 20 ppb.

Analysis was conducted by Pace Analytical Services, Inc. of Minneapolis, Minnesota using EPA Method 200.8 ICPMS for determination of trace elements in drinking water.

PREPARED and REVIEWED BY:

Field Environmental Consulting, Inc.

A handwritten signature in cursive script that reads "Amy Weinzierl".

Amy Weinzierl (CSP #27824)

Environmental Health and Safety Manager

amy@fieldconsultinginc.com

952-746-5880

*sampling was performed by ISD #191 Health & Safety Supervisor

LEAD IN THE WATER TESTING
BUILDING: VISTA VIEW LL 1
DATE 10/30/2018

TYPE OF FAUCET WC - water cooler DF - drinking fountain S - Sink K - Kettle BF - Bottle Filler

Lead <= 20 ppb, Lead > 20 ppb (Action Level), ND= None Detected

	LABEL	BUILDING	ROOM/LOCATION	TYPE OF FAUCET	LEAD RESULT (ppb or µg/L)
1	01	V V	101	S	1.9
2	02	V V	101	DF	ND
3	03	V V	102	S	1.2
4	04	V V	102	DF	ND
5	05	V V	104	S	9.5
6	06	V V	104	DF	ND
7	07	V V	105	S	1.5
8	08	V V	105	DF	ND
9	09	V V	107	S	2.7
10	10	V V	107	DF	ND
11	11	V V	108	S	3.9
12	12	V V	108	DF	ND
13	13	V V	WC in hallway outside girls bathroom across from gym	WC	ND
14	14	V V	WC in hallway outside boys bathroom across from gym Rt	WC	ND
15	15	V V	WC in hallway outside boys bathroom across from gym Lt	WC	ND
16	16	V V	115	S	133
16- Resample 11/29/2018					494
16- Initial Resample/ 30 Second Flush 12/14/18					.99/.44
17	17	V V	115	DF	1.0
18	18	V V	118 Tap to the left	S	17.1
19	19	V V	118 Tap to the center	S	16.8
20	20	V V	118 Tap to the right	S	11.6
21	21	NO SAMPLE COLLECTED			
22	22	NO SAMPLE COLLECTED			
23	23	V V	Kitchen, by ovens, right tap	K	1.2
24	24	V V	Kitchen, by ovens, center tap	HW	ND
25	25	V V	Kitchen, by ovens, left tap	S	0.55

LEAD IN THE WATER TESTING**BUILDING: VISTA VIEW UL 1****DATE 10/30/2018**

TYPE OF FAUCET WC - water cooler DF - drinking fountain S - Sink K - Kettle BF - Bottle Filler

Lead < = 20 ppb, Lead > 20 ppb (Action Level), ND= None Detected

	LABEL	BUILDING	ROOM/LOCATION	TYPE OF FAUCET	LEAD RESULT (ppb or µg/L)
1	26	V V	201	S	1.2
2	27	V V	201	DF	ND
3	28	V V	202	S	1.7
4	29	V V	202	DF	ND
5	30	V V	203	S	9.1
6	31	V V	203	DF	ND
7	32	V V	221	S	1.7
8	33	V V	204	S	1.7
9	34	V V	204	DF	ND
10	35	V V	WC in hallway outside room 204	WC	4.7
11	36	V V	WC in hallway outside room 205	WC	10.6
12	37	V V	205	S	5.7
13	38	V V	205	DF	ND
14	39	V V	206	S	5.0
15	40	V V	206	DF	ND
16	41	V V	207	S	1.7
17	42	V V	207	DF	ND
18	43	V V	208	S	1.1
19	44	V V	208	DF	ND
20	45	V V	WC in hallway outside south student bathroom Left	WC	1.0
21	46	V V	WC in hallway outside south student bathroom Right	WC	ND
22	47	V V	209	S	2.5
23	48	V V	209	DF	ND
24	49	V V	210	S	1.1

LEAD IN THE WATER TESTING**BUILDING: VISTA VIEW UL 2****DATE 10/30/2018**

TYPE OF FAUCET WC - water cooler DF - drinking fountain S - Sink K - Kettle BF - Bottle Filler

Lead < = 20 ppb, **Lead > 20 ppb (Action Level)**, ND= None Detected

	LABEL	BUILDING	ROOM/LOCATION	TYPE OF FAUCET	LEAD RESULT (ppb or µg/L)
1	50	V V	210	DF	ND
2	51	V V	211	S	3.8
3	52	V V	211	DF	ND
4	53	V V	212	S	0.81
5	54	V V	212	DF	ND
6	55	V V	Nurse's Office	S	2.1
7	56	V V	WC in hallway outside the Main Office	WC	ND
8	57	V V	WC in hallway outside room 213	WC	93.5
57- Resample 11/29/2018					11.0
9	58	V V	213	S	2.2
10	59	V V	213	DF	ND
11	60	V V	217	S	2.9
12	61	V V	214	S	2.1
13	62	V V	214	DF	ND
14	63	V V	215	S	1.3
15	64	V V	215	DF	ND
16	65	V V	216	S	1.0
17	66	NO SAMPLE COLLECTED			
18	67	V V	219	S	15.5
19	68	NO SAMPLE COLLECTED			
20	69	V V	WC in hallway outside north student bathroom Left	WC	ND
21	70	V V	WC in hallway outside north student bathroom Right	WC	ND
22	71	V V	220	S	3.9

Vista View

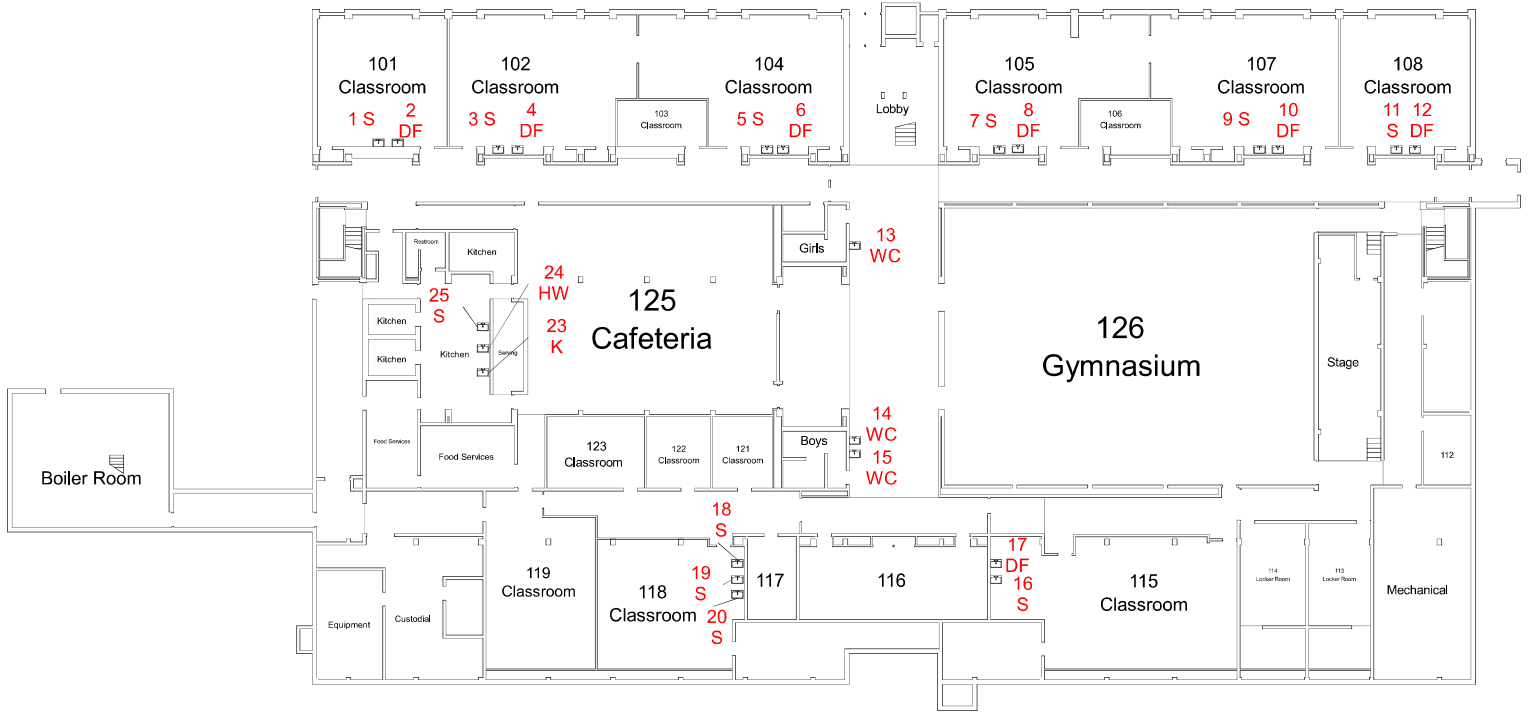

First Floor

Vista View

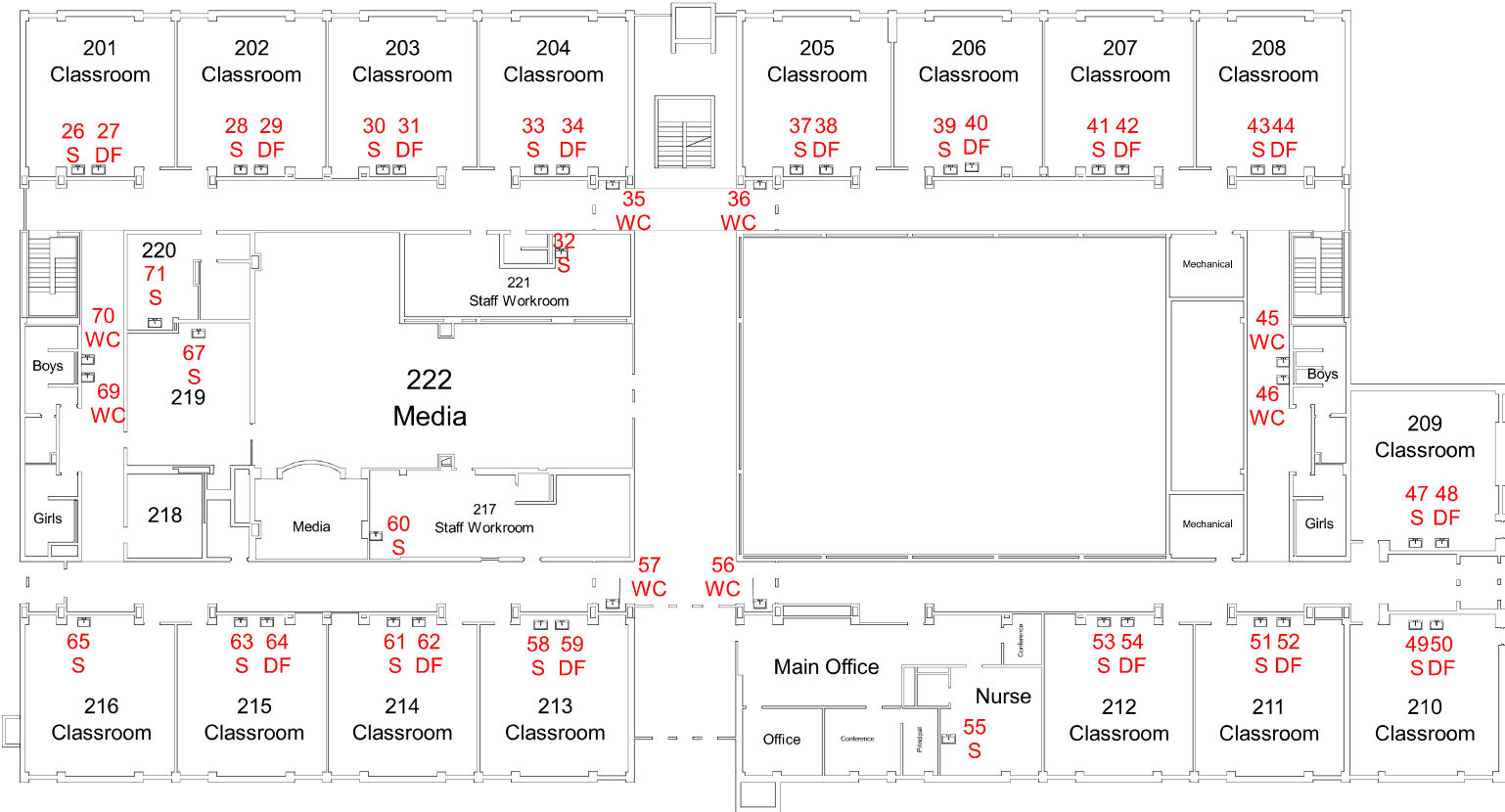

Second Floor