



8612 Eagle Creek Parkway, Savage, MN 55378
Tel: (952) 746-5880 ♦ Fax: (952) 746-5882
Mailbox@FieldConsultingInc.com
www.FieldConsultingInc.com

Independent School District #191
200 Burnsville Pkwy
Burnsville, MN 55337
Attn: Mr. Glenn Simon

RE: Lead in Drinking Water Sampling
SITE: Sioux Trail Elementary
DATE: January 2019

Dear Glenn Simon,

Field Environmental Consulting, Inc. (FIELD ENVIRONMENTAL) appreciates the opportunity to provide results for lead in drinking water sampling conducted at Sioux Trail Elementary.

Initial sampling (“first draw”) was completed on Thursday, November 1, 2018*. One (1) out of the sixty-five (65) initial first draw samples collected at Sioux Trail Elementary was above the recommended limit of 20 ppb. Provided with results, ISD #191 cleaned the aerator for the identified tap. After aerator cleaning was completed, ISD #191 re-sampled the identified tap on November 29, 2018. The re-sampling result was below the recommended limit of 20 ppb.

Analysis was conducted by Pace Analytical Services, Inc. of Minneapolis, Minnesota using EPA Method 200.8 ICPMS for determination of trace elements in drinking water.

PREPARED and REVIEWED BY:

Field Environmental Consulting, Inc.

Amy Weinzierl (CSP #27824)
Environmental Health and Safety Manager
amy@fieldconsultinginc.com
952-746-5880

*sampling was performed by ISD #191 Health & Safety Supervisor

LEAD IN THE WATER TESTING**BUILDING: SIOUX TRAIL LL 1****DATE 11/1/2018**

TYPE OF FAUCET WC - water cooler DF - drinking fountain S - Sink K - Kettle BF - Bottle Filler

Lead < = 20 ppb, Lead > 20 ppb (Action Level), ND= None Detected

	LABEL	BUILDING	ROOM/LOCATION	TYPE OF FAUCET	LEAD RESULT (ppb or µg/L)
1	01	NO SAMPLE COLLECTED			
2	02	NO SAMPLE COLLECTED			
3	03	ST	Kitchen by stoves, right	S	ND
4	04	ST	Kitchen by stoves, left	S	2.4
5	05	ST	101	S	0.66
6	06	ST	101	DF	ND
7	07	ST	102	S	0.59
8	08	ST	102	DF	ND
9	09	ST	104	S	0.56
10	10	ST	104	DF	ND
11	11	ST	111	S	1.0
12	12	ST	WC outside girls bathroom across from gym	WC	ND
13	13	ST	WC outside boys bathroom across from gym, right	WC	ND
14	14	ST	WC outside boys bathroom across from gym, left	WC	ND
15	15	ST	105	S	1.8
16	16	ST	105	DF	2.0
17	17	ST	107	S	0.78
18	18	ST	107	DF	2.0
19	19	ST	108	S	0.66
20	20	NO SAMPLE COLLECTED			
21	21	ST	116	S	2.1
22	22	ST	117	S	2.0
23	23	ST	117	DF	0.68

LEAD IN THE WATER TESTING**BUILDING: SIOUX TRAIL UL 1****DATE 11/1/2018**

TYPE OF FAUCET WC - water cooler DF - drinking fountain S - Sink K - Kettle BF - Bottle Filler

Lead < = 20 ppb, Lead > 20 ppb (Action Level), ND= None Detected

	LABEL	BUILDING	ROOM/LOCATION	TYPE OF FAUCET	LEAD RESULT (ppb or µg/L)
1	24	ST	201	S	1.1
2	25	ST	201	DF	ND
3	26	ST	202	S	0.57
4	27	ST	202	DF	ND
5	28	ST	203	S	1.1
6	29	NO SAMPLE COLLECTED			
7	30	ST	204	S	1.6
8	31	ST	204	DF	1.0
9	32	ST	WC outside room 204	WC	1.2
10	33	NO SAMPLE COLLECTED			
11	34	ST	205	S	2.3
12	35	ST	205	DF	ND
13	36	ST	206	S	1.7
14	37	ST	206	DF	ND
15	38	ST	207	S	1.7
16	39	ST	207	DF	0.55
17	40	ST	208	S	0.72
18	41	NO SAMPLE COLLECTED			
19	42	ST	WC outside girls bathroom, west, left	WC	0.91
20	43	ST	WC outside girls bathroom, west, right	WC	ND
21	44	ST	209	S	0.94
22	45	ST	209	DF	ND
23	46	ST	210	S	2.3
24	47	ST	210	DF	ND

LEAD IN THE WATER TESTING**BUILDING: SIOUX TRAIL UL 2****DATE 11/1/2018**

TYPE OF FAUCET WC - water cooler DF - drinking fountain S - Sink K - Kettle BF - Bottle Filler

Lead < = 20 ppb, **Lead > 20 ppb (Action Level)**, ND= None Detected

	LABEL	BUILDING	ROOM/LOCATION	TYPE OF FAUCET	LEAD RESULT (ppb or µg/L)
1	48	ST	211	S	1.1
2	49	ST	211	DF	0.92
3	50	ST	212	S	0.64
4	51	ST	212	DF	ND
5	52	ST	Main Office Workroom	S	12.5
6	53	ST	Nurse's Office	S	1.3
7	54	NO SAMPLE COLLECTED			
8	55	ST	WC outside room 213	WC	18.2
9	56	ST	213	S	ND
10	57	ST	213	DF	ND
11	58	ST	221	S	5.2
12	59	ST	214	S	0.81
13	60	ST	214	DF	ND
14	61	ST	215	S	1.3
15	62	NO SAMPLE COLLECTED			
16	63	ST	216	S	1.0
17	64	ST	216	DF	ND
18	65	ST	217	S	1.3
19	66	ST	218	S	34.6
66-Resample 11/29/2018					12.8
20	67	ST	218	DF	3.0
21	68	ST	WC outside girls bathroom, east, left	WC	ND
22	69	ST	WC outside girls bathroom, east, right	WC	ND
23	70	ST	219	S	12.0

Sioux Trail



First Floor

Sioux Trail

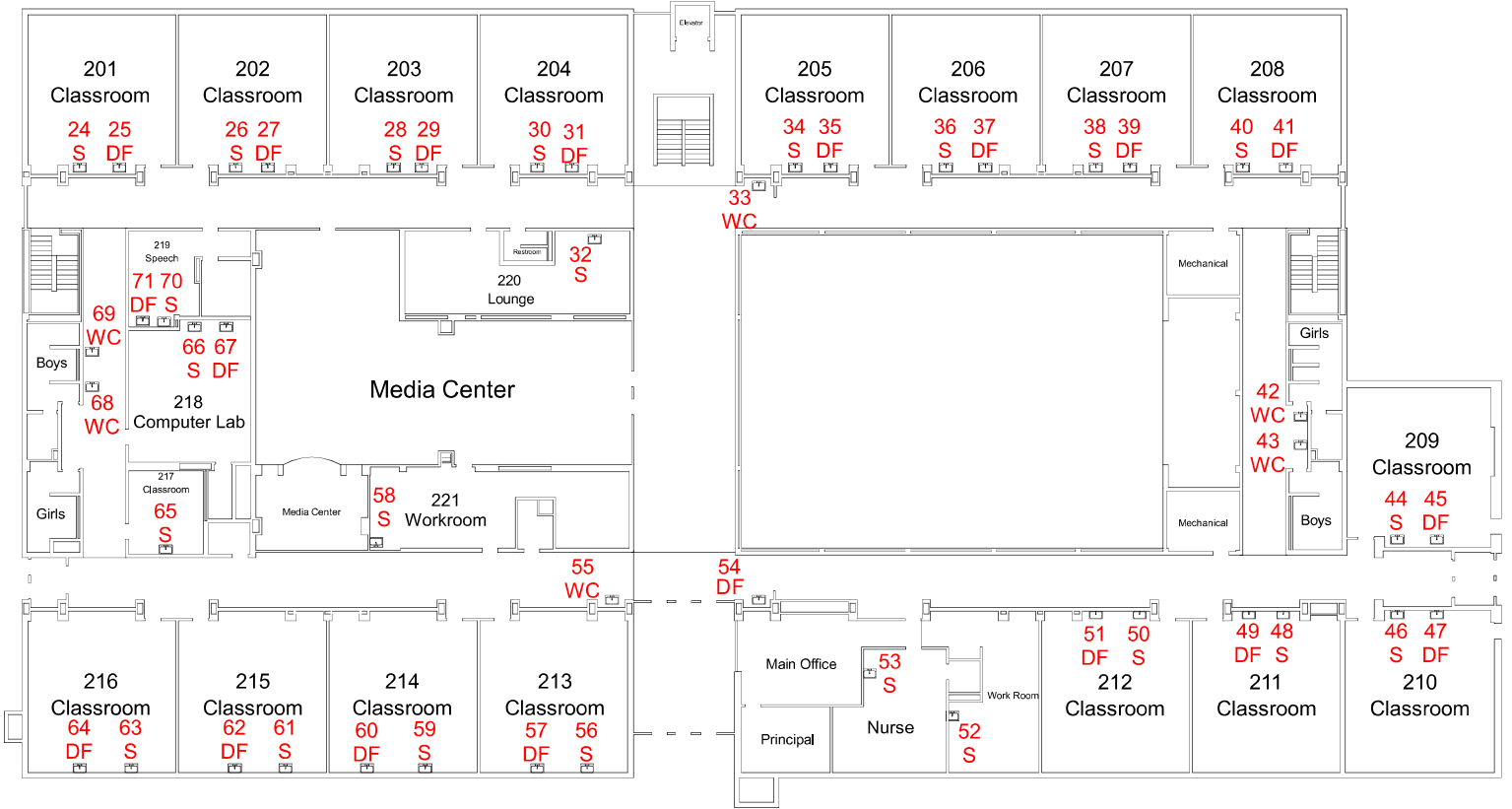

Second Floor