

FELSTED SCHOOL

Felsted, Essex CM6 3LL
01371 822600

Chair of Governors:	Robert Brown chairman@felsted.org
Governors:	John Davies , OBE, MA Bobbi Davy James Nicholson , DM, MA, MB BChir, FRCPCH Oliver Stocken , CBE James Tibbitts , MA, FCT Chair of House & Finance Committee Jane Crouch , BA, MA Chair of Governance Committee William Sunnucks , MA, ACA, MBA Rev Nic Stuchfield , MA Ann Carrington , LLB, LLM, JP Geoffrey Boulton , BA Chair of Education Committee Julia Abel Smith , DL, MA Mike Beale Stephen Wolfe , BSc, MRICS, IRRV Patricia Wardell , BA Lucilla Poston , CBE, PhD, FMedSci Alison Sefton , BSc
Headmaster:	Christopher Townsend , BA 01371 822606 hmpa@felsted.org
Bursar:	Andrew Clayton , BA, MBA 01371 822621 burspa@felsted.org
Senior Deputy Head:	George Masters , BA 01371 822708 dhpa@felsted.org
Deputy Head (Academic):	Sarah Capewell , MA 01371 822678 dhpaacademic@felsted.org
Assistant Head (Academic):	Lorne Stefanini , MA 01371 822678 dhpaacademic@felsted.org
Assistant Head (Staff & Co-Curricular):	Rebecca Purdy , BA, MEd 01371 822694 coadmin@felsted.org
Director of Global Education:	Daniel Emmerson , MA 01371 822748 dpe@felsted.org
Designated Safeguarding Lead:	N F S O'Brien , MA 01371 820133 nfsob@felsted.org
Prep School Headmaster:	Simon James , BA 01371 822610 hmsprep@felsted.org

Senior Management Team

HEADMASTER'S OFFICE

Headmaster: C J Townsend, BA

PA: Sarah Webb

01371 822606

hmpa@felsted.org

Reception: Claire Eastlake and Dawn Jones

01371 822600

reception@felsted.org

SENIOR DEPUTY HEAD'S OFFICE

Senior Deputy Head: G W S Masters, BA

PA: Michelle Wells

01371 822708

dhpa@felsted.org

Joint Common Room Secretaries:

01371 822690

Tricia Williamson and Maxine Cowell

crsec@felsted.org

Assistant Head (Staff & Co-Curricular): R J Purdy, BA, MEd

Co-Curricular Administrator: Suzy Jevons

01371 822694

coadmin@felsted.org

Designated Safeguarding Lead: N F S O'Brien, MA

07581 498869

nfso@felsted.org

Senior HM: S Barrett, BSc

01371 822770

sb@felsted.org

Head of Wellbeing: L Page, UKCP, MBACP reg

01371 822673

wellbeing@felsted.org

Director of Digital Strategy: G E Dean, BA

01371 822695

ged@felsted.org

Director of Performing Arts: M C Donaldson, BA

Administrator: Sarah Penrose

01371 822655

mpaadmin@felsted.org

Director of Sport: C S Knightley, BA

Sports Administrator: Maxine Cowell

sportsadmin@felsted.org

Senior Management Team

ACADEMIC OFFICE

Deputy Head (Academic): S R Capewell, MA 01371 822678

Assistant Head (Academic): L K Stefanini, MA

PA: Fiona Pemberton

dhpaacademic@felsted.org

Director of Teacher Development: B S Roberts Jones, BSc, MEd bsrj@felsted.org

Director of Reports: R L Feldman, MSc

01371 822675

rfl@felsted.org

Timetabler: J M Jevons, BA

dhpaacademic@felsted.org

Director of Exams: A L F Simpson, BSc

01371 822657

Exams Officer: Kelly Cleaver

exams@felsted.org

Director of Professional Guidance: L M Scofield, BA

01371 822668

Professional Guidance Administrator: Helen Reid

careersadmin@felsted.org

Director of International Baccalaureate: K L Woodhouse, BSc

01371 822666

klw@felsted.org

BURSAR'S OFFICE

Bursar: A G Clayton, BA, MBA

01371 822621

PA: Tracy Eastop

burspa@felsted.org

Director of Global Education: D P Emmerson, MA

01371 822748

dpe@felsted.org

Director of Development: C N Love, MA

01371 822649

cnl@felsted.org

Houses

GEPP'S (A)

HM	M L McIlvenna	01371 822700	mlm@felsted.org
AHM	N J Phillips	01371 822702	njp@felsted.org
Resident Tutor	L J Mann	01371 822703	ljm@felsted.org
Matron	L Hayden	01371 822653	Matrona@felsted.org
	House Mobile	07764 332927	

STOCKS'S (B)

HM	A L Salmon	01371 822710	als@felsted.org
AHM	L Macey	01371 822713	lm@felsted.org
Resident Tutor	A M J Little		amjl@felsted.org
Matron	K Harvey	01371 822714	kh@felsted.org
	House Mobile	07764 332930	

WINDSOR'S (C)

HM	C H Palmer	01371 822720	chp@felsted.org
AHM	L M Keable	01371 822722	lmk@felsted.org
Resident Tutor	R J Thear	01371 822738	rat@felsted.org
Matron	S Howard	01371 822724	Matronc@felsted.org
	House Mobile	07764 332931	

MONT'S (D)

HM	A Le Chevalier	01371 822730	alc@felsted.org
AHM	J E R Gallian	01371 822732	jerg@felsted.org
Matron	L E Impey	01371 822734	lei@felsted.org
	House Mobile	07764 332932	

ELWYN (E)

HM	T P C Galvin	01371 822740	tpcg@felsted.org
AHM	A J A Pask	01371 822742	ajap@felsted.org
Resident Tutor	M W J Redding	01371 822743	mwjr@felsted.org
Matron	A Stevens	01371 822744	matrone@felsted.org
	House Mobile	07764 332933	

FOLLYFIELD (G)

HM	S D Wilson	01371 822750	sdw@felsted.org
AHM	L Willis	01371 822752	lw@felsted.org
Resident Tutor	R Perez Cabrera	01371 822753	rpc@felsted.org
Matron	W M Hookway	01371 822754	wmh@felsted.org
	House Mobile	07876 442823	

Houses

DEACON'S (H)

HM	B J Bury	01371 822760	bjb@felsted.org
AHM	C J Wukics	01371 822762	cjw@felsted.org
Resident Tutor	W B Bayliss-Brown		wbbb@felsted.org
Matron	J Jarred	01371 822704	matronh@felsted.org
	House Mobile	07764 332941	

MANOR (M)

HM	C M Phillips	01371 822790	cmp@felsted.org
AHM	K Moir-Smith	01371 822759	kms@felsted.org
Matron	T Camp	01371 822734	matronm@felsted.org
	House Mobile	07918 619244	

GARNETTS (N)

HM	S Barrett	01371 822770	sb@felsted.org
AHM	A T Mohindru	01371 822772	atm@felsted.org
Resident Tutor	A McCaughern		ajmc@felsted.org
Matron	A Howes	01371 822774	matronn@felsted.org
	House Mobile	07764 332943	

THORNE (T)

HM	C Donaldson	01371 822707	cd@felsted.org
AHM	A N Fazekas	01371 822717	anf@felsted.org
Resident Tutor	M Trucco		mt@felsted.org
Matron	C Gormley	01371 822718	matront@felsted.org
	House Mobile	07918 755037	

Chaplaincy

Chaplain	Rev'd Nigel Little	07730 412647	rev@felsted.org
----------	--------------------	--------------	-----------------

Common Room

To email members of staff, use their initials@felsted.org

Art

E A M Jackson, BA

J N Buniak, MA

A V Warner, BA

eamj@felsted.org

Business

A T Mohindru, LLB

E Grant, BSc

J K Peddy, BA

atm@felsted.org

Classics

E M McLaren, MA (Roberts Society Co-ordinator)

S R Capewell, MA (*Deputy Head, Academic*)

E J Clark, BA

A J Quinlan, BA

emm@felsted.org

Computer Science

E J Abegglen, BSc

M W J Redding (*Head of ICT Services*)

A A Ross, BSc

eja@felsted.org

Design and Technology

M A Pitts, BEng

W B Bayliss-Brown, BA

H K Pheloung, BA

map@felsted.org

Drama

M C Donaldson, BA (Director of Performing Arts)

L Macey, BA

L J Mann, BA

mcd@felsted.org

Economics

F M Barrett, BBS

M L McIlvenna, BA, MEd †

S D Wilson, BA †

fmb@felsted.org

English and Media

E L Predebon, MA

Z A Ball, MA

G J Catchpole, PGCE

M R Crossley, BA

L E Fell, BA

C M James, BA (*Head of Project Qualifications*)

R J Purdy, BA, MEd (*PSHE, Assistant Head - Staff & Co-Curricular*)

H A Sunshine, BA

N M Sunshine-Harris, BA (*Professional Guidance & Support*)

elp@felsted.org

Common Room

Geography

G R Stringer, BSc

grs@felsted.org

T P C Galvin, BSc †

A McCaughern, BSc

K Moir-Smith, BA

History & Politics

R Pathak, BA

rp@felsted.org

B R Maude-Barker, MA

L M Scofield, BA (*Director of Professional Guidance*)

lms@felsted.org

Dr T Strange, PhD (*Andrew Society Co-ordinator*)

Mathematics

M J Campbell, MSc

mjc@felsted.org

J C Andrews, MEng

C Donaldson, BSc †

R L Feldman, MSc (*Director of Reports*)

J M Jevons, BA (*Timetabler*)

H V Lavin, BSc

A Munns, MA

N Pritchard, BSc

Modern Languages

L J Robertson, MA (French and German)

ljr@felsted.org

A N Fazekas, MA (German)

F Sanchez del Rio, Licenciatura (Spanish, Editor of 'The Felstedian')

T M Catmur, BA (*French*)

R Grant, BA (*Spanish*)

N F S O'Brien, MA (*Spanish, EAL*) (*DSL*)

R Perez Cabrera, MA (*Spanish*) (*Round Square Co-ordinator*)

G O N Scholz, BSc (*German*)

M Trucco, MA (*Italian and French*)

J M White, BA (*Spanish*)

N Escudero Melgar (*Spanish Language Assistant*)

M Lecareaux (*French Language Assistant*)

C Luebbert (*German Language Assistant*)

Music

W J Warns, MA, DipABRSM, FNCM (Director of Music)

wjw@felsted.org

C L J McGlone, BA

R J Thear, BA

Common Room

Physical Education and Sport

L Willis, BSc, MS

(Director of Girls' Sport & Head of Girls' Hockey)

lw@felsted.org

N J Phillips, BA *(Head of Boys' Hockey)*

S Barrett, BSc *(Senior HM)* †

B J Bury, BA †

J E R Gallian *(Director of Cricket)*

C S Knightley, BA *(Director of Sport)*

A Le Chevalier, PGCE *(Director of Rugby)* †

C E Rudd, BSc *(Head of Girls' Cricket)*

N J Lockhart, ECB3, EH2 *(Head of Grounds & Cricket Professional)*

R Marriott-Cox *(Director of Tennis)*

J R Westwood *(Director of Hockey)*

A A Cox, BA (GRA)

M H Anthony (GRA)

Project Qualifications

C M James, BA

cmj@felsted.org

PSHE

R J Purdy, BA, MEd

(English, Assistant Head - Staff & Co-Curricular)

rjp@felsted.org

Psychology

V L Smith, MEd

vls@felsted.org

M Cacace, BA *(Head of IB Core)*

Science

H J Mollison, BSc, MEd (Head of Science, Chemistry)

hjm@felsted.org

L E Barden, BSc (Chemistry)

K J Farr, MSc (Biology)

D T Smith, BSc (Physics)

L T Barrett, BSc *(Chemistry)*

J Entwistle, BSc *(Biology)*

C H Palmer, MA *(Physics)* †

A J A Pask, BSc *(Chemistry)*

A V Price, MA *(Physics)*

A L F Simpson, BSc *(Biology, Director of Exams)*

R Warner, MSc *(Biology)* ~

R L Williams, BSc *(Biology)*

K L Woodhouse, BSc *(Physics, Director of IBDP)*

Common Room

Theology, Ethics and Philosophy

B S Roberts Jones, BSc, MEd
(Director of Teacher Development)

bsrj@felsted.org

L M Keable, BA

Dr S R Lambert, PhD

Rev'd N J Little, BA (*Chaplain, i/c Charities*)

G W S Masters, BA (*Senior Deputy Head*)

L K Stefanini, BSc, MA (*Assistant Head, Academic*)

Wellbeing Centre

L Page, UKCP, MBACP reg

wellbeing@felsted.org

C J Croll, Counselling Skills

R K S Love, BSc

Support for Learning

J W Hipkin, BA, MEd

jwh@felsted.org

S J Beale, BA

C M Dungey, RSciTech

N J Johnson, CDip

E L Masters, MA

C M Phillips, MCILIP †

A L Salmon, BA, MEd †

J C Turner Jones, BA

J E Wright

EAL

D K Guerrero, BA, Dip TEFLA

dkg@felsted.org

CCF

Maj C H Palmer, MA (CCF Contingent Commander)

chp@felsted.org

Maj L W Jay

Duke of Edinburgh's Awards & Educational Visits

D L Whittock

dlw@felsted.org

Library

N S Howorth, BA, DipLib, MCLIP

nsh@felsted.org

† = HM

~ = Maternity Leave

Peripatetic Teaching Staff

Drums & Percussion

C C Apps, BMus (*Drums/Percussion*)

R Farrer, LGSM (*Drums/Percussion*)

N M Gregory, BMus (*Drums/Percussion*)

A Morris (*Drums/Percussion*)

Guitar

S Laney, Dip CPM (*Guitar Electric & Acoustic*)

A Staples (*Guitar and Bass*)

R Thear, BA (*Guitar Electric & Acoustic*)

Music Technology

J C Lapham, BA (MSET, QTLS)

Piano/Organ

J Arnold, BMus, ARCM, LGSM (*Piano*)

S Brennan, BMus, Mmus (*Piano*)

S Edwards, GCLCM, ABRSM (*Piano*)

J Lam, BMus, LRSM (*Piano*)

V Manning, Cert Mus Ed, ALCM (*Piano*)

A Reece, MA (*Piano*)

W J Warns, MA, DipABRSM, FNCM (*Organ*)

C Wood, Prof Cert, RAM, LRAM, ARCM (*Piano*)

Strings

P Barton, GRSM (*Violin*)

A Carey, BMus (*Violin*)

L Creasey, BA (*Harp*)

C Ellis, BA, ARAM, LRAM (*Cello/Alexander Technique*)

Vocal

K B Heard, BA, PGDip, MMus

F Wright, LLB, Cert ABRSM

Peripatetic Teaching Staff

Woodwind & Brass

S Aitken, GRSM, Dip RAM, LRAM, ARCM, FTCL (*Trombone/Tenor Horn/Tuba*)

S Brennan, BAMus, MMus (*Flute*)

A Bushby, MA (*Recorder*)

G Gerrard, GTCL, LTCL (*Oboe*)

J Plackett, BA LTCL, ALCM (*Clarinet/Recorder*)

C Shead, BMus (*Trumpet*)

A E Skinner, BA, LRAM, PGCE, Dip ABRSM, ARSM (*Recorder*)

W Yeomans, GCLCM (*Saxophone*)

LAMDA

K J Charters, MA

T Eastal, AISTD

A L Moor, BA

Mandarin

Dr H-C Chou, PhD

School Prefects

Heads of School:	Esma Jasarevic Kit Morley-Jacob Alex Oakley
Deputy Heads of School:	Dominic Bird Elise Bury Paul Hunold Peter Jessa Nyah Mohindru Lydia Townsend
School Prefects:	Sana Abu-Jabir Aiganym Amirbay Eloise Barber Charles Bromfield Sophia Clarke Dzhamilya Dyussenova Pauline Fontein Taylor Gordon Emily Green James Harding Dylan Hughes Leo Jagger Anna Jewell Helene Krautkraemer Rosie Manson Hugo Morley Margarita Myakova Barnes Oakley Deborah Oakley Hugo Peddy Max Raeburn Nicholas Scofield Annabel Sheppard Emily Taylor Maya Vocke Jemima White Hugo Whitten Tom Wisbey Titus Zangemeister

Heads of Houses

Gepp's	Pierre Garino & Dennis King
Stocks's	Izzy Copeland
Windsor's	Tom Wisbey
Mont's	William Baxter
Elwyn's	Oscar Dias
Follyfield	Jasmine Taulo
Deacon's	Ben Hewett
Manor	Molly Jeremiah
Garnetts	Sophia Clarke
Thorne	Francesca Minnis

Captains

Girls' Cricket	Lydia Townsend & Rose Simmons
Boys' Cricket	TBA
Girls' Tennis	Jessica Baxter
Boys' Tennis	Jacob Smith
Senior Aegon	Sam Constantino
Girls' Hockey	Angharad Wade-Jones
Boys' Hockey	Walter Forsey & Dylan Hughes
Netball	Elise Bury
Rugby	Hugo Morley
Girls' Squash	Jessica Baxter
Boys' Squash	George Sweeting
Polo	David Ying
Badminton	Titus Zangemeister
Golf	Leo Bonser
Football (1st)	Hugo Whitten
Football (2nd)	Jacob Smith
Swimming	Esma Jasarevic
Leader of the Orchestra	Charles Campbell-Peek
Drama	Lily Ball & Jude Leng
CCF	
RSM - Cadet WO1	Louis Stewart
CSM - Cadet WO2	Max Raeburn
CSM - Cadet WO2	Hugo Whitten

Regular Weekly Events – Spring Term 2022

All activities listed below have priority at the times stated.

Where there are conflicts between activities listed below, the activity in **bold** has priority.

Mondays	8.30 am - 8.45 am	Headmaster's Assembly (Chapel)
	8.30 am - 8.45 am	House Staff Team Meetings (All Houses)
	10.50 am - 11.00 am	CR Briefing (LRH)
	4.15 pm - 5.50 pm	Orchestra (Years 9-U6)
		Drama Rehearsals (Years 9-10)
		Co-Curricular Activities (Years 9-11)
		DT Coursework (Years 10-U6)
		Sports Scholars (Years 9-11)
		Art Department Open (Years L6 & U6)
	4.45 pm - 5.45 pm	Deputy Head's Detention
	5.45 pm - 6.30 pm	Andrew Society (U6)
	7.45 pm	Roberts Society
Tuesdays	8.30 am - 8.45 am	Tutorials
	2.00 pm - 5.00 pm	Sport
	2.00 pm - 6.00 pm	Art & DT Coursework (Years 10-U6)
	4.15 pm - 5.15 pm	Year 9 Art Scholars
	4.30 pm - 5.30 pm	L6 Gold DofE
		Drama Rehearsals (Years 9-10)
	5.30 pm - 6.30 pm	Senior Steel Band (Years 9 & 10)
	6.30 pm - 7.30 pm	Senior Steel Band (Years 11-U6)
Wednesdays	8.30 am - 8.45 am	Chapel
	4.15 pm - 5.30 pm	Year 10 A/B Sport
		Year 9 Leadership/CCF/DofE
		Year 10 Current Affairs & Culture
		Specialised Applications Workshop for 6th Form
		Peer Counselling
	4.30 pm - 5.30 pm	Art Workshop (Years 10-U6)
	4.30 pm - 6.30 pm	Years 11, L6 & U6 A/B Sport
	5.15 pm - 6.15 pm	Years 11, L6 & U6 A/B Sport
	5.45 pm - 6.30 pm	Med Soc
Thursdays	8.30 am - 8.45 am	Tutorials
	8.50 am - 10.45 am	Sport
	4.55 pm - 5.45 pm	MUN
	5.45 pm - 6.45 pm	Senior Chapel Choir (Years 9-U6)
		EAL Support Session (Year 10)

Regular Weekly Events – Spring Term 2022

Fridays	8.30 am - 8.45 am	Chapel
	3.00pm - 4.55 pm	CCF (Sixth Form)
	3.15pm - 4.15 pm	Year 9 A/B Sport
	3.30pm - 5.00 pm	CCF (Years 10 & 11)
		Drama Rehearsals (Years 9 & 10)
		Charitable Service (Years 9-11)
	3.30pm - 5.00 pm	DofE (Years 10 & 11)
	4.00pm - 6.00 pm	Careers Drop-in Clinic (Careers Library)
	4.15 pm - 5.45 pm	Art Coursework (Years 10-U6)
		DT Coursework (Years 10 & 11)
	4.45 pm - 5.45 pm	Deputy Head's Detention
		Peer Counselling
	5.00pm - 6.15 pm	Life Drawing (Sixth Form)
		Jazz Band (Years 9-U6)
Saturdays	12.15pm - 12.30 pm	Tutorials
	1.30 pm - 4.00 pm	Art Department Open

Meal Times

Breakfast	7.30 am - 8.20am	All Boarders
Lunchtime	12.55 pm	Year 9
	1.05 pm	Year 10
	1.10 pm	Year 11
	1.20 pm	Sixth Form
Supper	6.15 pm	U6
	6.30 pm - 7.15 pm	Years 9-L6
Sunday Brunch	10.30 am - 12.00 pm	All Boarders

Abbreviations for venues:

CC	Cromwell Centre	LRH	Lord Riche Hall
CRDR	Common Room Dining Room	MC	Medical Centre
CRSR	Common Room Sitting Room	BKA	Barbara Karan Auditorium
GH	Grignon Hall	SH	Sports Hall
HT	Hunt Theatre	6FC	Sixth Form Centre

Timetable – Week A

	8.30-8.45	8.50-9.45	9.50-10.45	BREAK	11.15-12.10	12.15-1.10	LUNCH	2.10-3.00	3.05-3.55	Co-Curricular & Private Study Time
		1	2		3	4		5	6	
Monday	Headmaster's Assembly									
Tuesday	Tutorials									
Wednesday	Chapel									
Thursday	Tutorials									4.00-4.50 Period 7
Friday	Chapel									
Saturday	House Assemblies					12.15-12.30 Tutorials				

Timetable – Week B

	8.30-8.45	8.50-9.45 1	9.50-10.45 2	BREAK	11.15-12.10 3	12.15-1.10 4	LUNCH	2.10-3.00 5	3.05-3.55 6	Co-Curricular & Private Study Time
Monday	Headmaster's Assembly									
Tuesday	Tutorials									
Wednesday	Chapel									
Thursday	Tutorials									4.00-4.50 Period 7
Friday	Chapel									
Saturday	House Assemblies					12.15-12.30 Tutorials				

Mon 3

Bank Holiday

Tue 4

3.00 pm Girls' Netball Pre-season Training: U19

Wed 5

Staff INSET (see separate programme)

3.00 pm Girls' Netball Pre-season Training

6.00 pm Houses Open. Boarders return by 9.00 pm

Thu 6

U6 IB Mock Exams

8.15 am Day Pupils Return

8.30 am House Assemblies

**9.00 am Beginning of Term Service followed by Headmaster's
Assembly (Chapel)****9.50 am Normal routine resumes**

For away fixtures, the first time shown is the departure time from Felsted, with the kick-off time in brackets

School Office No.: 01371 822600 : website: www.felsted.org

Fri 7

U6 IB Mock Exams

4.45 pm House Quiz Competition: Follyfield v Thorne (Ridley)

5.15 pm Explore (Chaplaincy Centre)

Sat 8

U6 IB Mock Exams

12.15 pm Girls' Netball v Framlingham: U15A, U15B, 15C (A: 2.00pm)

12.15 pm Boys' Hockey v The Perse: U14A, U14B, U14C (A: 1.30pm)

1.00 pm Girls' Netball v Framlingham: U14A, U14B, U14C (A: 3.00pm)

1.00 pm Boys' Hockey v The Perse: 1st, 2nd, 3rd (A: 2.45pm)

2.00 pm Girls' Netball v Framlingham: 1st, 2nd, 3rd, 4th (H)

2.00 pm Boys' Hockey v The Perse: U16A, U15A (H)

3.15 pm Boys' Hockey v The Perse: U16B, U15B (H)

Sun 9

First Sunday of Epiphany

Mon 10

U6 Mock Exams

4.30 pm Visiting Production: 'Broke' by The Paper Birds (HT)

7.30 pm Visiting Production: 'Broke' by The Paper Birds (HT)

Tue 11

U6 Mock Exams

8.30 am Year 11 Academic Briefing (BKA)

1.00 pm Boys' Hockey v Bedford: U15 ISHC Round 1 (A: 3.00pm)

4.45 pm L6 IB Careers Workshop (6FC)

Wed 12

U6 Mock Exams

10.45 am Library Committee Meeting (Library)

Thu 13

U6 Mock Exams

For away fixtures, the first time shown is the departure time from Felsted, with the kick-off time in brackets

School Office No.: 01371 822600 : website: www.felsted.org

Fri 14

Commonwealth Day

U6 Mock Exams

- 4.45 pm House Quiz Competition:
Manor v Gepp's, Elwyn's v Stocks's (Ridley)
- 5.00 pm Careers Seminar (6FC)
- 5.15 pm Explore (Chaplaincy Centre)
-

Sat 15

U6 Mock Exams

- 12.15 pm Girls' Netball v Haileybury: 1st, 3rd (A: 2.00pm)
- 1.15 pm Girls' Netball v Haileybury: 2nd, 4th (A: 3.00pm)
- 1.15 pm Boys' Hockey v Bishop's Stortford: 1st, 3rd (A: 2.30pm)
- 1.15 pm Boys' Hockey v St Albans: U16A, U16B (H)
- 2.00 pm Girls' Netball v Haileybury: U15A, U15B, U15C, U14A, U14B, U14C (H)
- 2.15 pm Boys' Hockey v Bishop's Stortford: U14A, U14B (H)
- 2.30 pm Boys' Hockey v Bishop's Stortford: 2nd, 4th (A: 3.45pm)
- 3.30 pm Boys' Hockey v Bishop's Stortford: U15A, U15B (H)
-

Sun 16

Second Sunday of Epiphany

Mon 17

U6 A Level Mock Exams

Public Exam: Year 11 Practical Drama (HT)

Tue 18

U6 A Level Mock Exams

8.30 am L6 Drama Students Component 2 Compulsory Workshop
(London)

8.30 am L6 Academic Briefing (BKA)

Wed 19

U6 A Level Mock Exams

3.30 pm Boys' Hockey v Kimbolton: U19 ISHC Round 1 (H)

4.00 pm Early finish: Contemporary Boarders and Day Pupils
may depart

4.30 pm Year 11 Virtual Parents' Meeting

9.00 pm U6 IB Mock Report: Teacher Deadline

Thu 20

For away fixtures, the first time shown is the departure time from Felsted, with the kick-off time in brackets

School Office No.: 01371 822600 : website: www.felsted.org

Fri 21

8.50 am Period 1

9.35 am Period 2

10.15 am Break

10.45 am Period 3

11.30 am Period 4

12.15 pm Period 5

1.00 pm Lunch (Exeat begins)**2.00 pm Year 11 Virtual Parents' Meeting**

Sat 22**Exeat**

Sun 23*Third Sunday of Epiphany***Exeat****6.00 pm Houses open. Boarders return by 9.00pm**

Mon 24

- 8.15 am Day pupils return**
8.30 am Whole School Chapel Service
2.00 pm Singing Workshop with Deke Sharon (by invitation) (BKA)
-

Tue 25

- 8.30 am U6 Academic Briefing (BKA)
4.30 pm HODs' Meeting (CRDR)
6.00 pm Governance Committee Meeting (Bury)
9.00 pm U6 IB Mock Report: Tutor Deadline
-

Wed 26

Australia Day

- 7.30 am Sixth Form Politics Trip Westminster departs
10.45 am Library Committee Meeting (Library)
6.00 pm External UCAS Deadline
9.00 pm U6 A Level Mock Report: Teacher Deadline
-

Thu 27

Holocaust Memorial Day

- 9.00 am House Unison Song Rehearsals (LRH)**
4.30 pm House Part Song Competition (Chapel)
7.30 pm House Unison Song Competition (LRH)
-

For away fixtures, the first time shown is the departure time from Felsted, with the kick-off time in brackets
School Office No.: 01371 822600 : website: www.felsted.org

Fri 28

- 4.45 pm House Quiz Competition:
Mont's v Windsor's, Deacon's v Garnetts (Ridley)
- 5.15 pm Explore (Chaplaincy Centre)
- 7.30 pm Live Lounge (Cromwell Centre)
-

Sat 29

Open Morning: Year 7 Entry (2023-25)

- 11.45 am Boys' Hockey v Bedford: 3rd, 4th, U16A (A: 1.45pm)
- 12.30 pm Boys' Hockey v Bedford: 1st, 2nd (A: 3.15pm)
- 12.30 pm Boys' Hockey v Bedford: U16B (A: 2.45pm)
- 1.00 pm Boys' Hockey v Bedford: U15C, U14C (H)
- 2.00 pm Boys' Hockey v Bedford: U14A, U14B (H)
- 2.30 pm Girls' Netball House Matches
- 3.00 pm Boys' Hockey v Bedford: U15A, U15B (H)
- 7.00 pm Internationalism Dinner (LRH)
-

Sun 30

Fourth Sunday of Epiphany

- 7.00 am Boys' Rugby 7s v Seaford: U18 (A)
-

Regular Activity Times are listed
on pp14 & 15 of this Calendar

Mon 31

Tue 1

Chinese New Year

8.30 am Year 9 Academic Briefing (BKA)

9.30 am Visit to Felsted Mission Foodbank

9.00 pm U6 A Level Mock Report: Tutor Deadline

Wed 2

Thu 3

7.00 pm Library Event

7.45 pm Charity Dodgeball Competition in aid of Felsted School
Charity Partners

For away fixtures, the first time shown is the departure time from Felsted, with the kick-off time in brackets

School Office No.: 01371 822600 : website: www.felsted.org

Fri 4

4.45 pm House Quiz Competition: Quarter Final (Ridley)

5.00 pm Careers Seminar (6FC)

5.15 pm Explore (Chaplaincy Centre)

7.30 pm Felsted Music Presents: Numbers (BKA)

Sat 5

11.45 am Boys' Hockey v St Albans: U14A, U14B (A: 1.15 pm)

12.30 pm Boys' Hockey v St Albans: 1st, 2nd (A: 2.30 pm)

12.15 pm Upjohn Declamation (GH)

1.45 pm Girls' Netball v RHS: 1st, 2nd, 3rd, 4th (A: 3.15 pm)

2.00 pm Girls' Netball v RHS: U15A, U15B, U15C, U14A, U14B, U14C (H)

2.00 pm Boys' Hockey v St Albans: U16A, U16B (H)

3.15 pm Boys' Hockey v St Albans: U15A, U15B (H)

Sun 6

Fifth Sunday of Epiphany

7.00 am Boys' Rugby 7s v Norwich: U18, U16 (A)

Mon 7

LAMDA Exams

U6 IB Language B Oral Exams (MFL)

Felsted Charity Partners' Valentine's Fund Raising Week

6.30 pm L6 Futures Virtual Talk

Tue 8

LAMDA Exams

U6 IB Language B Oral Exams (MFL)

8.30 am Year 10 Academic Briefing (BKA)

1.15 pm Boys' Hockey v Haileybury: 1st, 3rd (A: 3.00pm)

3.00 pm Boys' Hockey v Haileybury: U14A, U14C (H)

Wed 9

LAMDA Exams

U6 IB Language Oral Exams (MFL)

10.45 am Library Committee Meeting (Library)

2.00 pm Summer Term Calendar Deadline4.00 pm Early Finish: Contemporary Boarders and Day Pupils
may depart**4.30 pm Year 9 Virtual Parents' Meeting**

Thu 10

LAMDA Exams

U6 IB Language B oral exams (MFL)

For away fixtures, the first time shown is the departure time
from Felsted, with the kick-off time in brackets

School Office No.: 01371 822600 : website: www.felsted.org

Fri 11

International Day of Women and Girls in Science

U6 IB Language B Oral Exams (MFL)

8.50 am Period 1

9.35 am Period 2

10.15 am Break

10.45 am Period 3

11.30 am Period 4

12.15 pm Period 5

1.00 pm Lunch (Half Term begins)**2.00 pm Year 9 Virtual Parents' Meeting**

Half Term

Sun 20

Second Sunday before Lent

Half Term

7.00 am Boys' Rugby 7s v Ipswich: U18 (A)

6.00 pm Houses open. Boarders return by 9.00 pm

Mon 21

U6 IB Language B Oral Exams (MFL)

8.15 am Day pupils return

Tue 22

U6 IB Language B Oral Exams (MFL)

8.30 am Year 10 Academic Briefing (BKA)

9.30 am Visit to Felsted Mission Foodbank

Wed 23

U6 IB Language B Oral Exams (MFL)

10.45 am Library Committee Meeting (Library)

5.00 pm Governors' House & Finance Committee Meeting (Bury)

9.00 pm Year 10 Progress Report: Teacher deadline

Thu 24

U6 IB Language B Oral Exams (MFL)

6.00 pm Holy Communion (Voluntary) (Chapel)

For away fixtures, the first time shown is the departure time from Felsted, with the kick-off time in brackets

School Office No.: 01371 822600 : website: www.felsted.org

Fri 25

U6 IB Language B Oral Exams (MFL)

Felsted MUN Conference Set-up (GH, 6FC, HT)

- 9.00 am Felsted Musician of the Year Competition begins
3.30 pm Year 9 Talk: 'We need to talk' – Managing addictive behaviour by Iain Mahony (GH)
4.45 pm House Quiz Competition: Quarter Final (Ridley)
5.15 pm Explore (Chaplaincy Centre)
7.30 pm Felsted Musician of the Year Final
-

Sat 26

Felsted MUN Conference Set-up
(BKA, Ruggles-Brise, Boardroom)

- 11.45 am Boys' Hockey v Merchant Taylors': U14A, U14B (A: 1.00pm)
12.15 pm Girls' Netball v The Perse: 1st, 2nd, 3rd, 4th (A: 1.45pm)
12.15 pm Boys' Hockey v Merchant Taylors': 3rd, U16B (A: 2.15pm)
12.45 pm Boys' Hockey v Merchant Taylors': 1st, 2nd (H)
1.30 pm Boys' Hockey v Merchant Taylors': U16A (A: 3.30pm)
2.00 pm Girls' Netball v The Perse: U15A, U15B, U14A, U14B (H)
2.00 pm Boys' Hockey v Merchant Taylors': U15A, U15B (H)
3.15 pm Boys' Hockey v Merchant Taylors': U15C, U14C (H)
-

Sun 27

*Sunday before Lent***Felsted MUN Conference 2022**
(GH, 6FC, HT, BKA, Ruggles-Brise, Boardroom)

Regular Activity Times are listed
on pp14 & 15 of this Calendar

Mon 28

Felsted MUN Conference 2022
(GH, 6FC, HT, BKA, Ruggles-Brise, Boardroom)

Tue 1

St David's Day
Shrove Tuesday

8.30 am L6 Academic Briefing (BKA)
9.00 pm Year 10 Progress Report: Tutor Deadline

Wed 2

Ash Wednesday

10.45 am Library Committee Meeting (Library)
9.00 pm Year 11 Progress Report: Teacher Deadline

Thu 3

World Book Day (25th Anniversary)

8.30 am Sports' Photographs
9.30 am Safi Coffee Schools' Workshop visit to 'Lincoln & York'
departs

For away fixtures, the first time shown is the departure time from Felsted, with the kick-off time in brackets

School Office No.: 01371 822600 : website: www.felsted.org

Fri 4

- 12.30 pm U9 Hockey Tournament
 - 3.30 pm Swing into Spring Rehearsals (LRH)
 - 4.45 pm House Quiz Competition: Semi Final (Ridley)
 - 5.00 pm Careers Seminar (6FC)
 - 5.15 pm Explore (Chaplaincy Centre)
 - 7.00 pm Equality and Diversity Committee Event (BKA)
 - 8.00 pm Safi Coffee Schools' Workshop visit to 'Lincoln & York' returns
-

Sat 5

- 12.15 pm Girls' Netball v Ipswich: U15A, U15B, U15C, U14A, U14B, U14C (A: 2.00pm)
 - 12.15 pm Boys' Hockey v Framlingham: U15A, U15B (A: 2.15pm)
 - 1.15 pm Boys' Hockey v Framlingham: 3rd, 4th (A: 3.15pm)
 - 2.00 pm Girls' Netball v Ipswich: 1st, 2nd, 3rd, 4th (H)
 - 2.00 pm Boys' Hockey v Framlingham: 1st, 2nd (H)
 - 3.15 pm Boys' Hockey v Framlingham: U14A, U14B (H)

 - 3.00 pm Swing into Spring Rehearsals (LRH)
 - 5.45 pm Swing into Spring (LRH)**
-

Sun 6

First Sunday of Lent

Polo: National Senior Schools Arena Championships

- 7.00 am Boys' Rugby 7s v Worth: U18, U16 (A)
-

Regular Activity Times are listed on pp14 & 15 of this Calendar

Mon 7

Tue 8

Public Exam: A Level Drama Component 3 Practical (HT)

8.30 am U6 Academic Briefing (BKA)

4.30 pm HODs' Meeting (CRDR)

9.00 pm Year 11 Progress Report: Tutor Deadline

Wed 9

Non-Uniform Day in aid of Felsted School Charity Partners

7.00 am Boys' Rugby 7s v Surrey: U18 (A)

5.00 pm Chase the Moon Run (Olympic Park, London)

Thu 10

7.30 am CCF Range Day at Fingringhoe

7.30 pm Garnetts and Windsor's Show (HT)

For away fixtures, the first time shown is the departure time from Felsted, with the kick-off time in brackets

School Office No.: 01371 822600 : website: www.felsted.org

Fri 11

LAMDA Exams

8.50 am Period 1

9.35 am Period 2

10.15 am Break

10.45 am Period 3

11.30 am Period 4

12.15 pm Period 5

1.00 pm Lunch (Exeat begins)

Sat 12**Exeat**

Sun 13**Exeat***Second Sunday of Lent*

Polo: National Junior Schools Arena Championship

7.00 am Boys' Rugby 7s v Queen Elizabeth Barnet: U16 (A)

Mon 14

British Science Week
L6 Internal Exams (GH)**8.15 am Day pupils return**

Tue 15

Feeder Schools' Science Day
Year 11 Oral Exams (MFL)
L6 Internal Exams (GH)8.30 am Year 9 Academic Briefing (BKA)

Wed 16

L6 Internal Exams (GH)

10.45 am Library Committee Meeting (Library)

Thu 17

St Patrick's Day
L6 Internal Exams (GH)

5.00 pm Felsted Mission Council AGM (Felsted)

7.00 pm Years 9 & 10 Productions: Musical Theatre Showcase
& 'Ruckus in the Garden' by David Farr (HT)

For away fixtures, the first time shown is the departure time from Felsted, with the kick-off time in brackets
School Office No.: 01371 822600 : website: www.felsted.org

Fri 18

- L6 Internal Exams (GH)
- 12.30 pm U11 Hockey Tournament
- 3.00 pm Combat Cadet (STANTA) Bodney Camp departs (8 students)
- 4.45 pm House Quiz Competition: Final (GH)
- 5.15 pm Explore (Chaplaincy Centre)
- 6.00 pm Governors' Seminar (Bury)
- 7.00 pm Years 9 & 10 Productions: Musical Theatre Showcase & 'Ruckus in the Garden' by David Farr (HT)

Sat 19

- Open Morning: Year 7 entry (2023-25)**
- Combat Cadet (STANTA) Bodney Camp
- 10.00 am Governors' Board Meeting (Bury)
- 12.30 pm Girls' Netball v The Leys: U15A, U15B, U15C, U14A, U14B, U14C (A: 2.00pm)
- 12.30 pm Boys' Hockey v The Leys: U15B, U14B (A: 1.15pm)
- 1.30 pm Boys' Hockey v The Leys: U16B (A: 3.00pm)
- 1.30 pm Boys' Hockey v The Leys: U15A, U14A (A: 2.30pm)
- 2.00 pm Girls' Netball v The Leys: 1st, 2nd, 3rd, 4th (H)
- 2.30 pm Boys' Hockey v The Leys: 1st, 3rd (H)
- 3.45 pm Boys' Hockey v The Leys 2nd: U16A (H)
- 7.00 pm Years 9 & 10 Productions: Musical Theatre Showcase & 'Ruckus in the Garden' by David Farr (HT)

Sun 20

- Third Sunday of Lent*
- 5.00 pm Combat Cadet (STANTA) Bodney Camp returns

Regular Activity Times are listed on pp14 & 15 of this Calendar

Mon 21

ABRSM Exams

6.00 pm Boys' Rugby: Rosslyn Park National Schools 7s: U18s depart

9.00 pm Year 11 Report: HM Deadline**9.00 pm U6 Report: HM Deadline**

Tue 22

ABRSM Exams

Boys' Rugby: Rosslyn Park National Schools 7s

8.30 am Year 10 Academic Briefing (BKA)

1.15 pm Boys' Hockey v Haileybury: U14A, U14C (A: 3.00pm)

3.00 pm Boys' Hockey v Haileybury: 1st, 3rd (H)

6.00 pm Boys' Rugby: Rosslyn Park National Schools 7s: U16s depart

7.00 pm LAMDA Presentation Evening (HT)

Wed 23

Boys' Rugby: Rosslyn Park National Schools 7s

5.00 pm Governors' House and Finance Committee Meeting

6.30 pm Boys' Rugby U18s return

7.00 pm LAMDA Presentation Evening

9.00 pm L6 Exam Report: Teacher Deadline

Thu 24

Boys' Rugby: Rosslyn Park National Schools 7s

11.00 am Years 10-U6 Drama Students' Trip: 'Small Island'
(The National Theatre, London)

6.00 pm Boys' Rugby U16s return

6.30 pm Felsted Sports' Dinner (LRH)

For away fixtures, the first time shown is the departure time from Felsted, with the kick-off time in brackets

School Office No.: 01371 822600 : website: www.felsted.org

Fri 25

The Annunciation

8.05 am Senior Chapel Choir Rehearsal (Chapel)

8.30 am Whole School Chapel Service

9.00 am Gold DofE Practice Expedition (Dartmoor) departs

9.00 am Period 1

9.40 am Period 2

10.20 am Period 3

11.30 am House Assemblies

12.00 pm Lists (GH)

12.00 pm CCF Silver DofE Practice Expedition (Rendlesham Forest) departs

1.00 pm Lunch (Term ends)

Sat 26

Gold DofE Practice Expedition (Dartmoor)

CCF Silver DofE Practice Expedition (Rendlesham Forest)

Sun 27

Fourth Sunday of Lent

Mothing Sunday

British Summertime begins

Gold DofE Practice Expedition (Dartmoor)
(returns Mon 28 March, 11.00 pm)

CCF Silver DofE Practice Expedition (Rendlesham Forest)
(returns Mon 28 March, 12.00 am)

Regular Activity Times are listed
on pp14 & 15 of this Calendar

Sports Hall

Beaulah
Hodgson

Art
Macrae

Art Block

KEY

Biology
Physics
Chemistry
History
Psychology
Geography
Classics
MFL
Maths
Drama & Theatre Stud
English

Telfer

Strutt

Munby

Hulton

Hose Allison
Rayleigh
Science Block
Gilchrist
Chittock

Courtauld
Upstairs
Bickersteth
Chetwood

Armitstead
Cromwell
Riche
Round
Downstairs

Reynolds
Chisholm
Ronaldson
Craze
Upstairs

Halford
Cookery
Monk
McArdle
Metal Workshop
Office
Wood Workshop
Prichard
Store rooms, Foundry and wood prep
McMillan
Board Room
DT1
Barrett
DofE
Shepherd
Upstairs (Business & Economics)

Downstairs (D&T)

Computer Centre

Pittway
Elliott
Dawkins (upstairs)

Stephenson
Dalton
Upstairs

- Business & Economics
- Art/History of Art
- Religious Studies
- Design Technology
- ICT
- Sport
- Music
- Support for Learning
- ESL

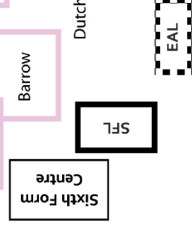
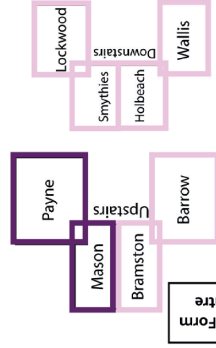
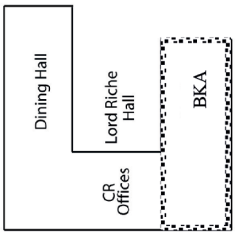
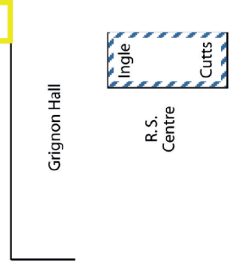
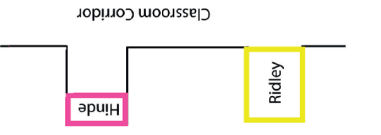
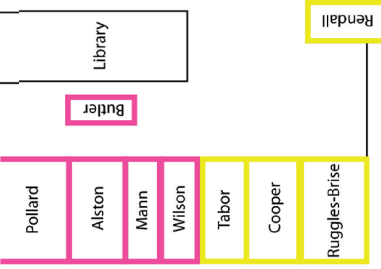

Dutch Block

School House (Rear)

Term Dates

Summer Term 2022: Wednesday 20 April to Friday 1 July

Staff INSET Day: Tuesday 19 April

Boarders return by 9.00 pm on Tuesday 19 April

Day pupils return by 8.15 am on Wednesday 20 April

Exeat: 12.30 pm Saturday 30 April to
9.00 pm on Monday 2 May (Boarders return)
Lessons re-commence Tuesday 3 May

Half Term: 1.00 pm Friday 27 May to
9.00 pm Sunday 5 June (Boarders return)
Lessons re-commence Monday 6 June

Autumn Term 2022: Monday 5 September to Friday 16 December

Staff INSET Days: Wednesday 31 August – Friday 2
September

L6 return by 11.00 am on Monday 5 September

U6 return by 5.00 pm on Tuesday 6 September

Year 9 (& new Year 10) by 11.00 am on
Tuesday 6 September

Years 10 & 11 by 8.00 pm on Tuesday 6 September

Day Pupils return by 8.15 am on Wednesday 7 September

Exeat: 1.00 pm Friday 30 September to
9.00 pm Sunday 2 October (Boarders return)
Lessons re-commence Monday 3 October

Half Term: 1.00 pm Friday 21 October to
9.00 pm Sunday 6 November (Boarders return)
Lessons re-commence Monday 7 November

Exeat: 1.00 pm Friday 25 November to
9.00 pm Sunday 27 November (Boarders return)
Lessons re-commence Monday 28 November

Term Dates

Spring Term 2023:	Tuesday 10 January to Friday 24 March Staff INSET Day: Monday 9 January Boarders return by 9.00 pm on Monday 9 January Day Pupils return by 8.15 am on Tuesday 10 January
Exeat:	1.00 pm Friday 27 January to 9.00 pm Sunday 29 January (Boarders return) Lessons re-commence Monday 30 January
Half Term:	1.00 pm Friday 10 February to 9.00 pm Sunday 19 February (Boarders return) Lessons re-commence Monday 20 February
Exeat:	1.00 pm Friday 10 March to 9.00 pm Sunday 12 March (Boarders return) Lessons re-commence Monday 13 March

Useful Contacts

Reception
(all general enquiries and to report an absence)
01371 822600 reception@felsted.org

Reception is open
Monday to Friday in term time between 8.00 am and 6.00 pm
Saturday between 9.00 am and 1.00 pm (excluding EXEAT)

Academic Office	01371 822678	dhpacademic@felsted.org
Admissions	01371 822605	senioradmissions@felsted.org
	01371 822608	intadmissions@felsted.org
Bookshop	01371 822635	bookroom@felsted.org
Bursary/Accounts	01371 822621	burspa@felsted.org
Careers	01371 822668	careersadmin@felsted.org
Catering	01371 822650	caterer@felsted.org
Chaplain	07730 412647	chaplain@felsted.org
Co-Curricular	01371 822694	coadmin@felsted.org
Common Room Secretary	01371 822690	crsec@felsted.org
Deputy Head's Office	01371 822708	dhpa@felsted.org
Director of IB	01371 822666	klw@felsted.org
Director of Sport	01371 822760	csk@felsted.org
Director of Girls' Sport	01371 822752	lw@felsted.org
Director of		
Global Education	01371 822748	dpe@felsted.org
Domestic Services	01371 822630	domestic@felsted.org
Duke of Edinburgh's Award	01371 822768	dlw@felsted.org
Exams	01371 822657	exams@felsted.org
ICT Support	01371 822698	ict@felsted.org
Library	01371 822667	library@felsted.org
Support for Learning	01371 822778	jwh@felsted.org
Tailor's Shop	01371 822636	tailors@felsted.org
Transport	01371 822639	transport@felsted.org