

# CAMPUS ACCESS WEEKDAYS 7:45am to 2:15pm, 3:45pm—7:00pm

All **GREEN** areas are accessible by parent ID card holders without an invitation, appointment, or escort:

- Admissions Office
- Advancement & Development Office
- Cashier
- Director of Facilities Office
- Food Service Office
- Main Guard House
- Parent Parking Lot when dropping off, picking up, or visiting for school business
- PTA Bookstore
- PTA Office
- School Nurse
- Tiger Shop
- Transportation Office

Bus parking lot open during drop-off and pick-up times only.

## General Drop Off:

7:35am - 7:50am,

## K/A only:

8:10am - 8:30am,

1:10pm - 1:40pm

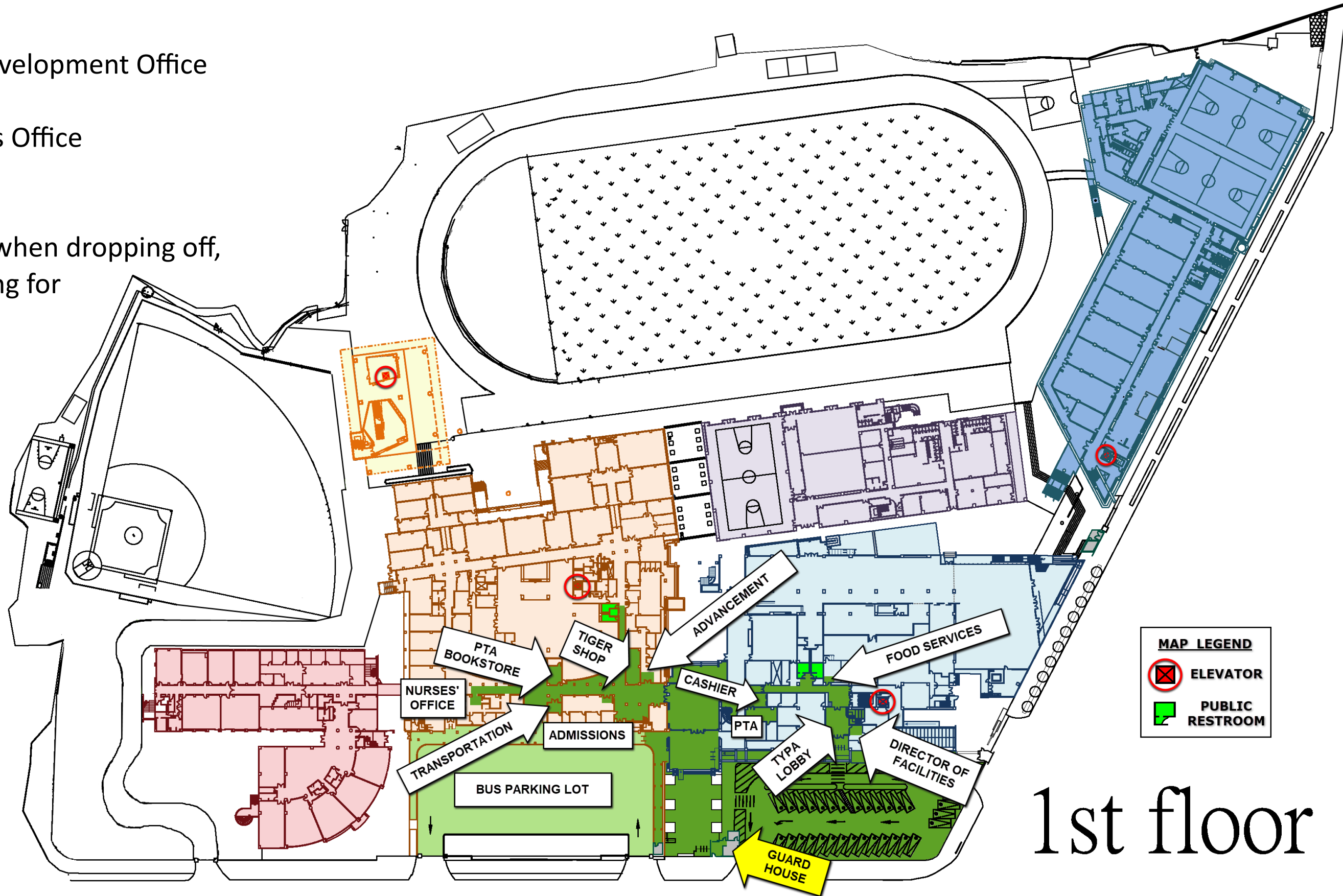

# 1st floor

# CAMPUS ACCESS WEEKENDS 8:00am to 6:00pm

All **GREEN** areas are accessible by parent ID card holders without an invitation, appointment, or escort:

- Cafeteria (when open and for purchases only, no dining areas available) and cafeteria restrooms (only when cafeteria is open)
- Libraries (open posted hours only)
- Lower Field\*
- Main Guard House
- Middle School Courtyard
- Parent Parking Lot
- Upper Field\*

*\*Outdoor sports fields are available for casual, unstructured use when not in use by TAS, TYPA, or a renter. LS and US basketball courts are not available.*

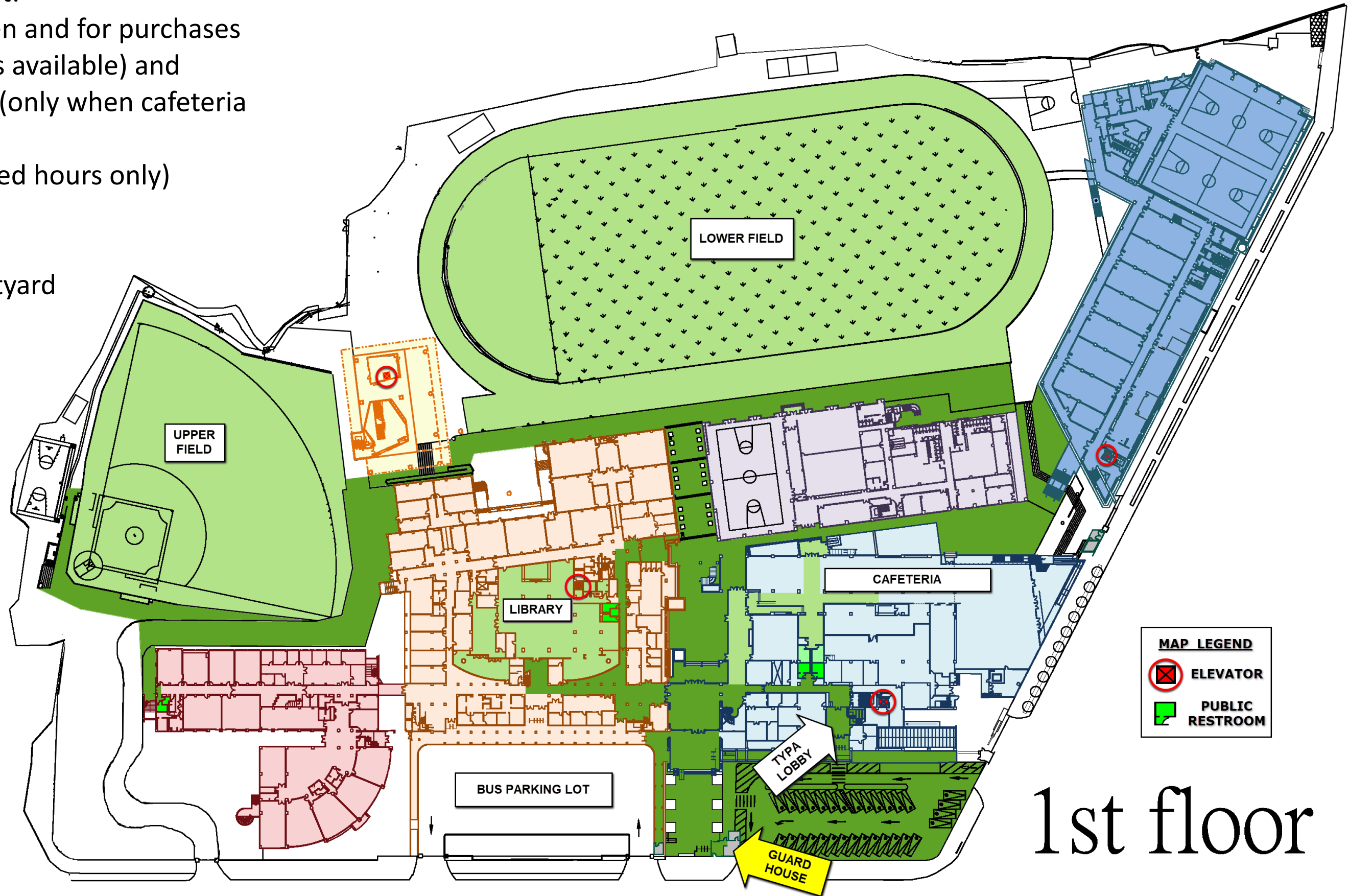

1st floor