



Carrollton-Farmers Branch

Independent School District

BAC / CAC – Bond Update

September 21, 2020

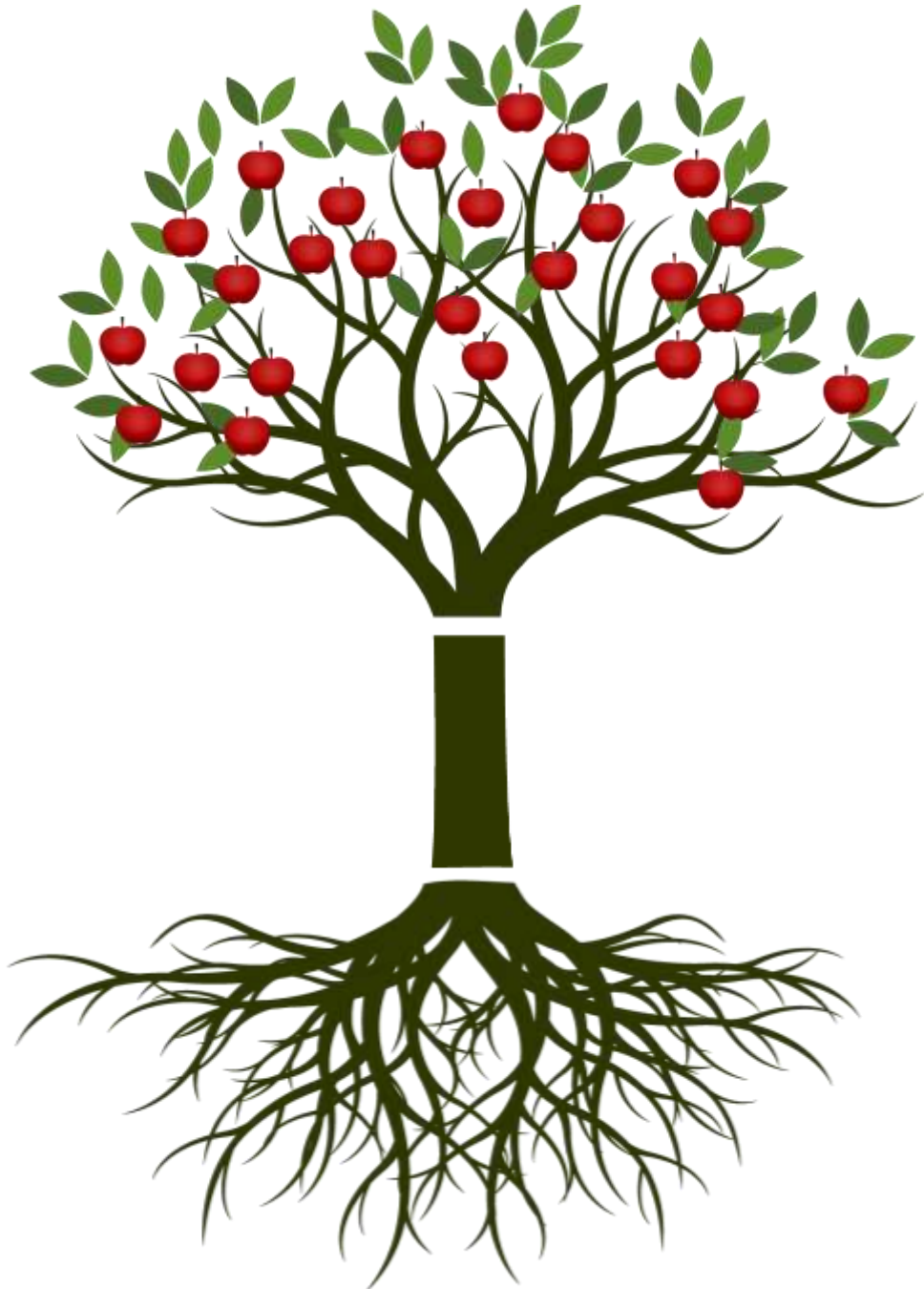

INTRODUCTION

AGENDA

- CFB – Life of a Bond Project (10min)
- LPA – McWhorter & Sheffield (15min)
- Huckabee – Field & Turner (15min)
- VLK – Perry (15min)
- LPA - Smith (10min)
- Intermission (2min)
- CFB & LPA – Ed Spec and Vision (20min)
- CFB - Review remaining work (5min)
- Questions and Answers (15min)



LIFE OF A BOND PROJECT

**CITIZEN'S FACILITY
ADVISORY COMMITTEE**

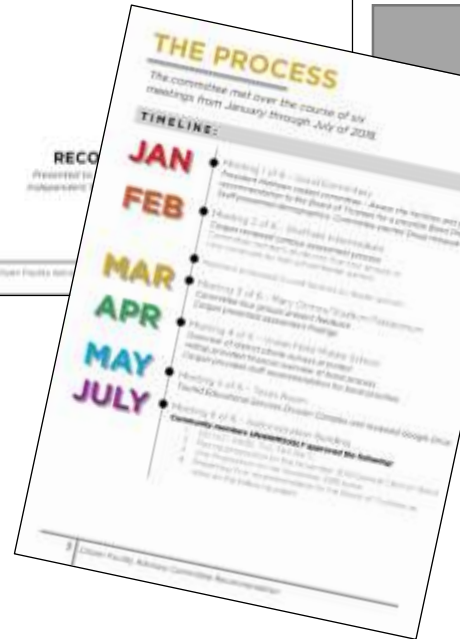
[illegible][illegible][illegible]

Hire Design Partner



ROOTS
CAPITAL PLANNING

- *2018 Bond
- *Collaborative Vision 2030
- *BAC Facility Assessments
- *Security Assessment

**ROOTS
PARTNERS**

- *Campus Stakeholder Committee
 - *BAC
 - *Architects
- 

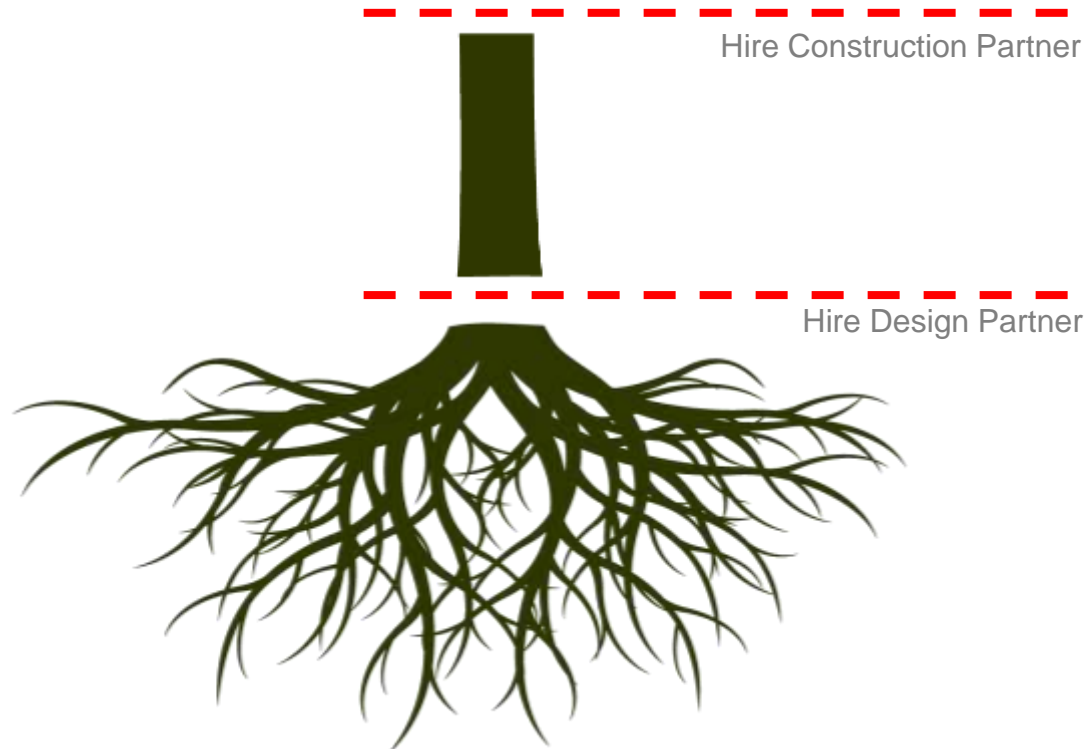

TRUNK
PRE-DESIGN (CONCEPT)

- *Program Documents
- *Concept Diagrams
- *Project Estimate

ROOTS
CAPITAL PLANNING

- *2018 Bond
- *Collaborative Vision 2030
- *BAC Facility Assessments
- *Security Assessment

TRUNK
PARTNERS

- *Architects & Design Partners
- *Campus Stakeholder Committee
- *Focus Groups
- *Facility / Maintenance
- *CMAR

ROOTS
PARTNERS

- *Campus Stakeholder Committee
- *BAC
- *Architects

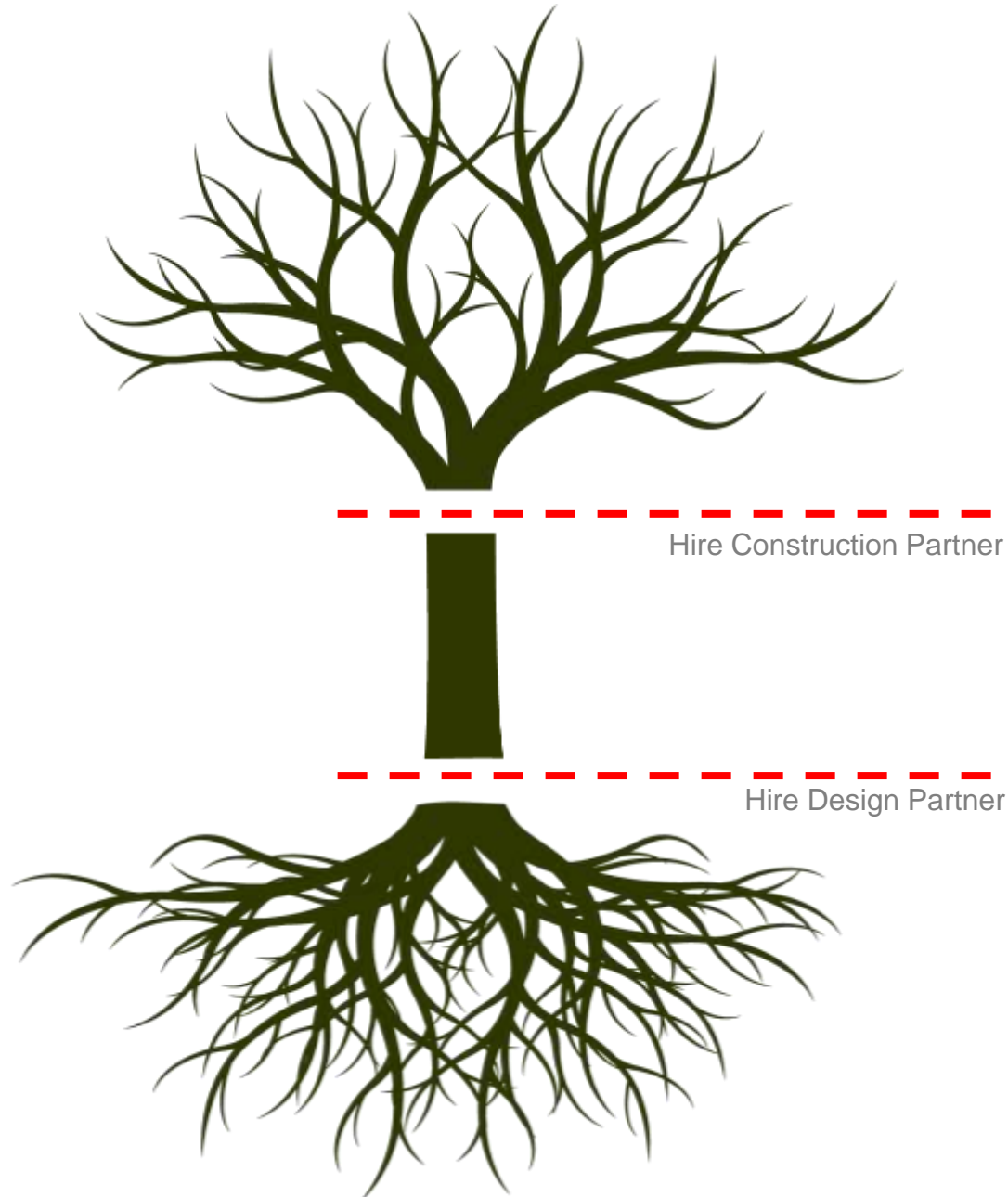

SECONDARY BRANCHES DOCUMENTATION (DD & CD)

- *Construction Documents
- *GMP

MAJOR BRANCHES SCHEMATIC DESIGN

- *SD Booklet
- *Project Estimate

TRUNK PRE-DESIGN (CONCEPT)

- *Program Documents
- *Concept Diagrams
- *Project Estimate

ROOTS CAPITAL PLANNING

- *2018 Bond
- *Collaborative Vision 2030
- *BAC Facility Assessments
- *Security Assessment

SECONDARY BRANCHES PARTNERS

- *Architects & Design Partners
- *Campus Stakeholder Committee
- *Focus Groups
- *Facility / Maintenance
- *CMAR

MAJOR BRANCHES PARTNERS

- *Architects & Design Partners
- *Campus Stakeholder Committee
- *Focus Groups
- *Facility / Maintenance
- *CMAR

TRUNK PARTNERS

- *Architects & Design Partners
- *Campus Stakeholder Committee
- *Focus Groups
- *Facility / Maintenance
- *CMAR

ROOTS PARTNERS

- *Campus Stakeholder Committee
- *BAC
- *Architects

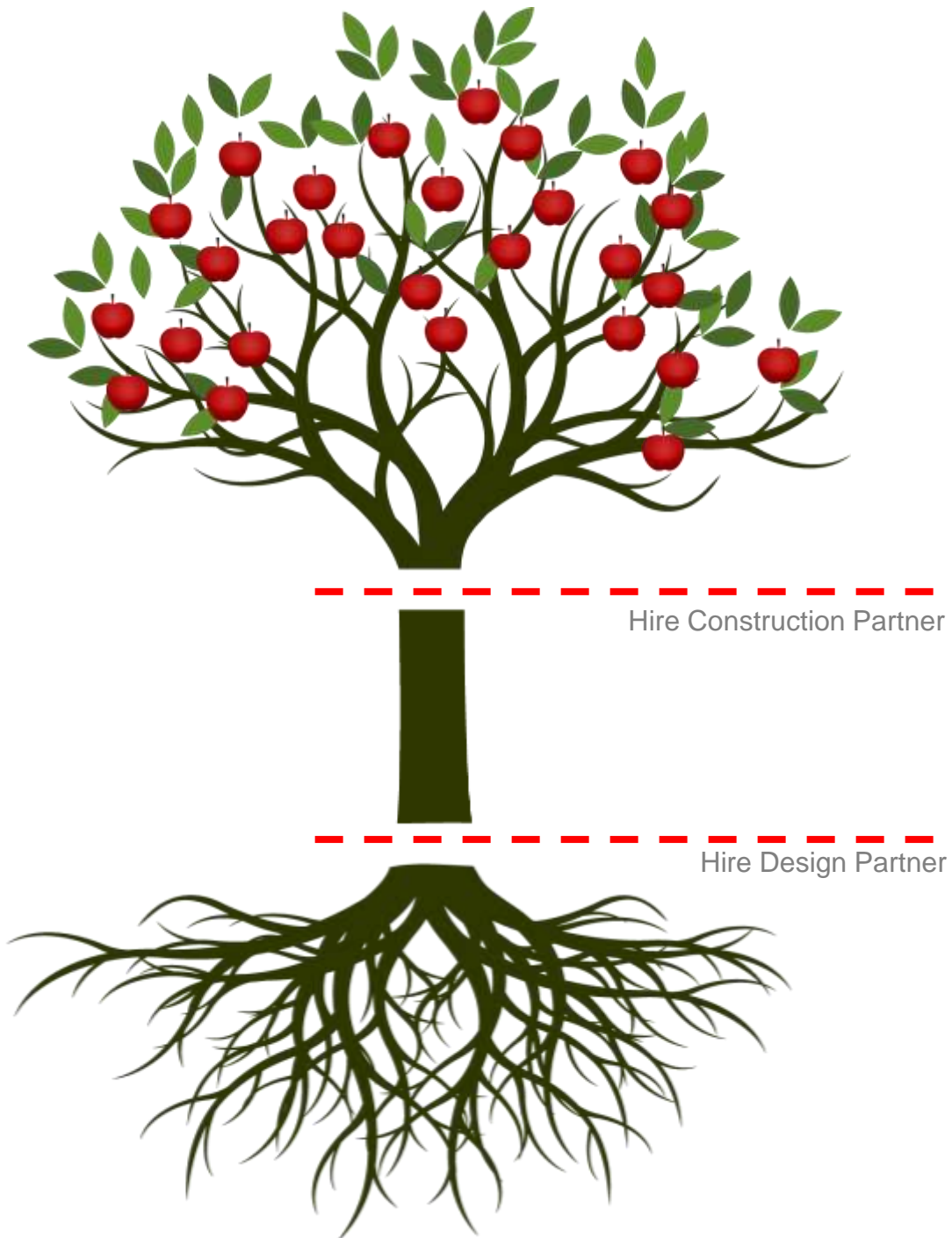

LEAVES & FRUIT CONSTRUCTION

*Facility Construction

SECONDARY BRANCHES DOCUMENTATION (DD & CD)

*Construction Documents
*GMP

MAJOR BRANCHES SCHEMATIC DESIGN

*SD Booklet
*Project Estimate

TRUNK PRE-DESIGN (CONCEPT)

*Program Documents
*Concept Diagrams
*Project Estimate

ROOTS CAPITAL PLANNING

*2018 Bond
*Collaborative Vision 2030
*BAC Facility Assessments
*Security Assessment

LEAVES & FRUIT CONSTRUCTION

*Architects & Design Partners
*Facility / Maintenance
*CMAR

SECONDARY BRANCHES PARTNERS

*Architects & Design Partners
*Campus Stakeholder Committee
*Focus Groups
*Facility / Maintenance
*CMAR

MAJOR BRANCHES PARTNERS

*Architects & Design Partners
*Campus Stakeholder Committee
*Focus Groups
*Facility / Maintenance
*CMAR

TRUNK PARTNERS

*Architects & Design Partners
*Campus Stakeholder Committee
*Focus Groups
*Facility / Maintenance
*CMAR

ROOTS PARTNERS

*Campus Stakeholder Committee
*BAC
*Architects

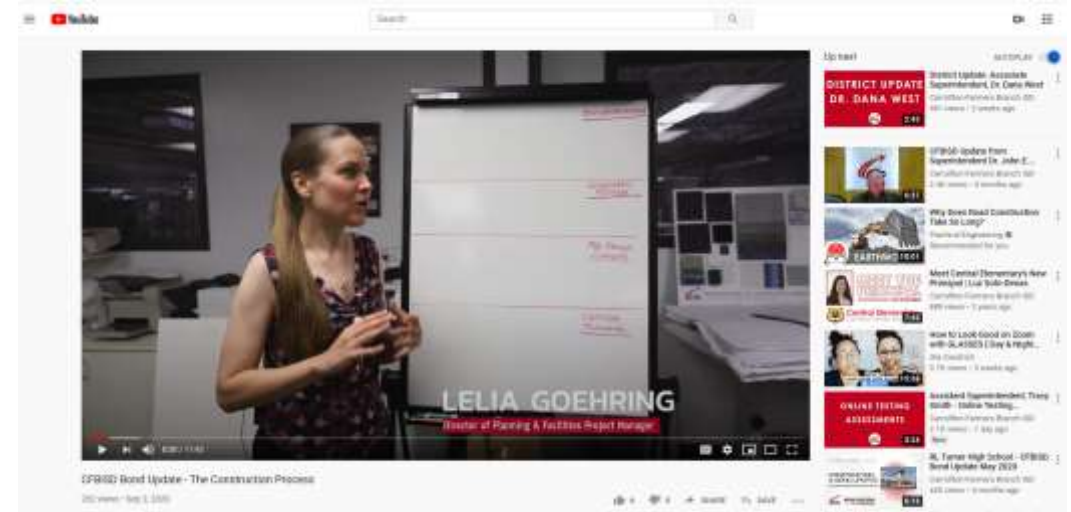
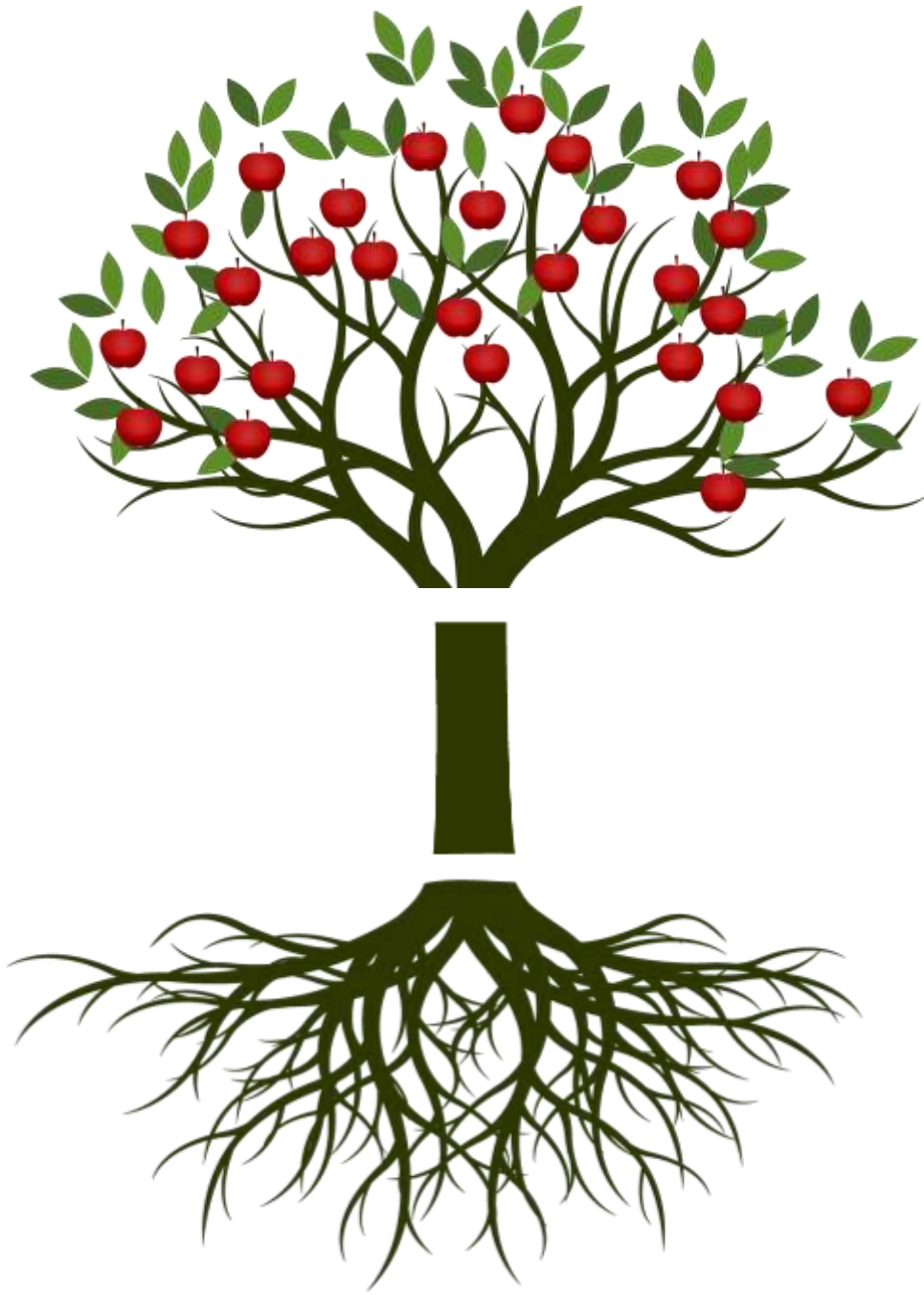

<https://www.youtube.com/watch?v=MW-kzFBJKXY>

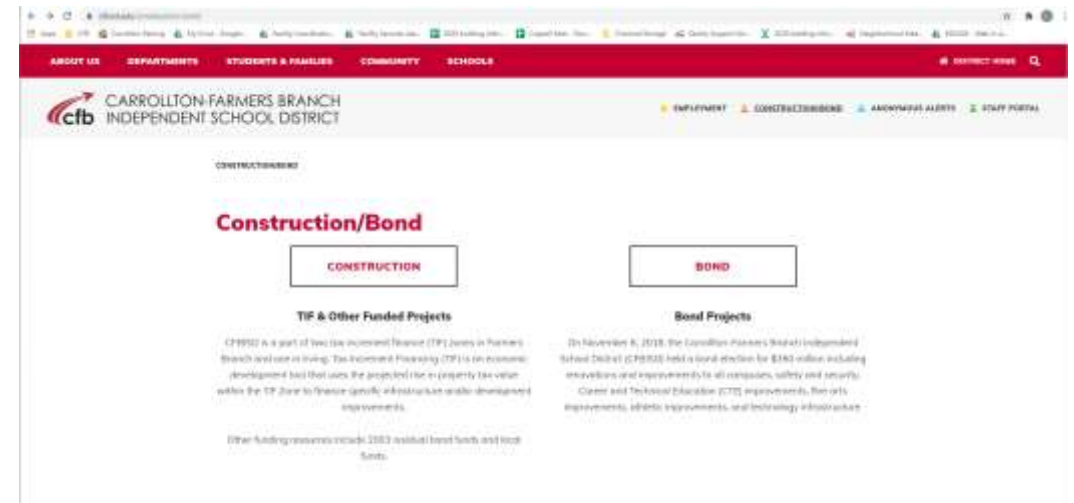

<https://www.cfbisd.edu/construction-bond>



JACKSON
CONSTRUCTION





Changing Lives by Design

Craig Drone, AIA LEED AP
Studio Director



Changing Lives by Design

Kate Mraw, RID/ALEP
Design Director



Changing Lives by Design

Lorenzo Navarrete, AIA
Sr. Project Manager



JACKSON
CONSTRUCTION

Lanny Jones
Project Manager



Kathryn S. McWhorter Elementary

Carrollton-Farmers Branch ISD

McWhorter ES



BETTER PROCESS | BETTER RESULTS



CONSTRUCTION

*Weekly Meetings
Campus Walks & Board/BAC Updates*

10

DOCUMENTATION (DD & CD) MEETINGS

*September – December 2019
Weekly Design Meetings
4 Design Review Presentations
Board Presentations (10/3, 11/7, 12/5, 1/5/20)
BAC Presentation (11/13)*

8+

SCHEMATIC DESIGN WORKSHOPS

*August 2019
Design Review Meetings (4)
City Jurisdiction Meetings
Teacher Design Meeting
Community & PTA Presentation
Board Presentation 9/5
Coordination Meetings*

10

PRE-DESIGN DISCUSSIONS

*June – July 2019
Educational Space Programming (Library, Dining, Wayfinding)
MEP, Roofing, Technology Meeting
School Leadership
Environmental Committee
Site Walks*

14

BAC & CAC PRESENTATIONS

*January – July 2019 6 CAC Meetings & 8 Board Meetings
June Board / BAC Workshop*



Overview Project Schedule



Kathryn S. McWhorter Elementary
Carrollton-Farmers Branch ISD

LPA



feb	mar	apr	may	jun	jul	aug	sept	oct	nov	dec	jan	feb	mar	apr	may	jun	jul	aug	sept	oct	nov	dec
				program		sd	dd	cd			bidding + permitting			construction				Fall 2020 move in!				

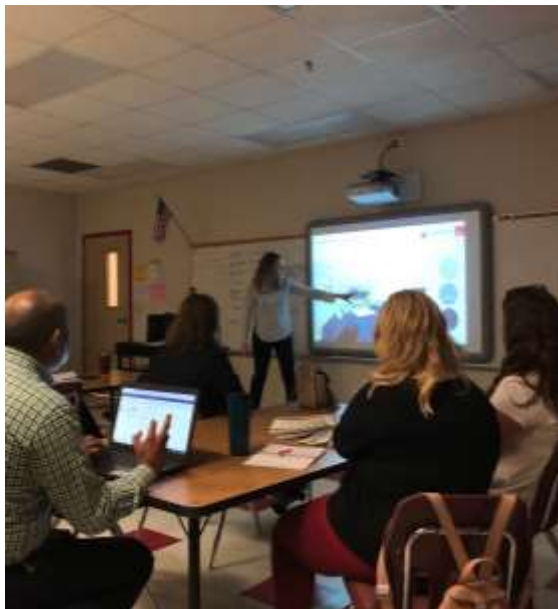

- Pre-Design / Programming
- Schematic Design
- Design Development
- Construction Documents
- Permitting
- Construction
- Occupancy

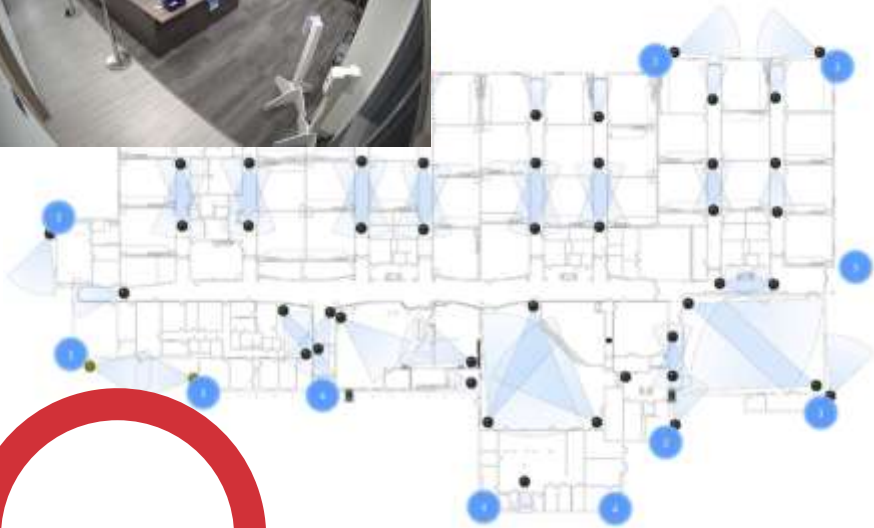

Systems Updates

- Replacing Existing Camera Systems
- Card Readers
- Video Intercom
- Burglar Alarm
- Bell/Clock/PA

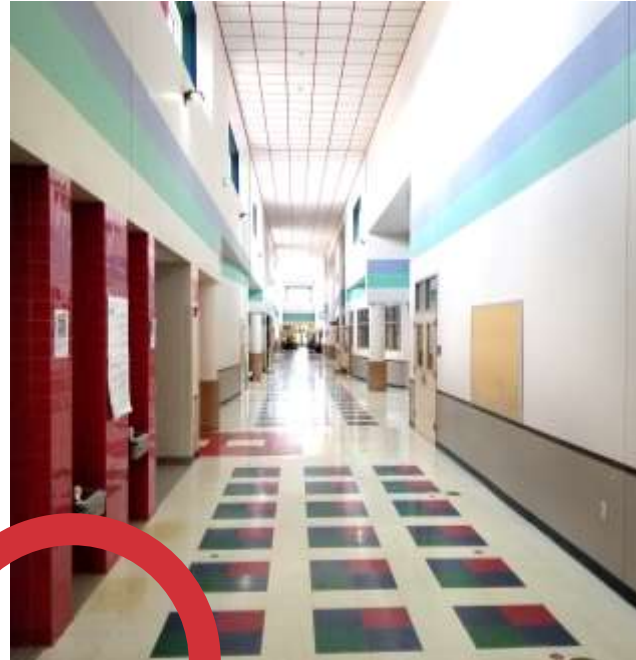

Design Improvements

- Exterior Reimaging
- Landscaping Improvements
- Bollards at Entry
- Library Design Updates and Innovation Center
- Corridor Improvements
- Administrative Office Improvements
- Dining Commons/Cafeteria/Gymnasium Improvements
- New Marquee

Inspiration



Wayfinding



Brand



Exterior Improvements



Sheffield Elementary

Carrollton-Farmers Branch ISD



CONSTRUCTION

Starting Construction Phase November 2020

20

DOCUMENTATION (DD & CD) MEETINGS

December 2019 – May 2020

Bi-Weekly Design Meetings

5 Focus Group Meetings

2 Design Review Presentations (02/17, 04/23)

13

SCHEMATIC DESIGN WORKSHOPS

September – December 2019

4 Design Review Meetings

7 Focus Group Meetings

- Digital, Physical, Special Education, Admin,

Library, Kitchen Maintenance and Technology

BAC Presentation (11/13/19)

Board Presentation (11/14/19)

6

PRE-DESIGN DISCUSSIONS

June – August 2019

BAC/Board Workshop and Architect Kick-off (06/12/19)

3 Educational Workshops (07/05, 07/19, and 8/21/19)

2 District Team Meetings (08/21, 09/05/2019)

Site Walks

14

BAC & CAC PRESENTATIONS

January – July 2019 6 CAC Meetings & 8 Board Meetings

Monthly BAC Meetings



BETTER PROCESS | BETTER RESULTS

Overall Project Schedule

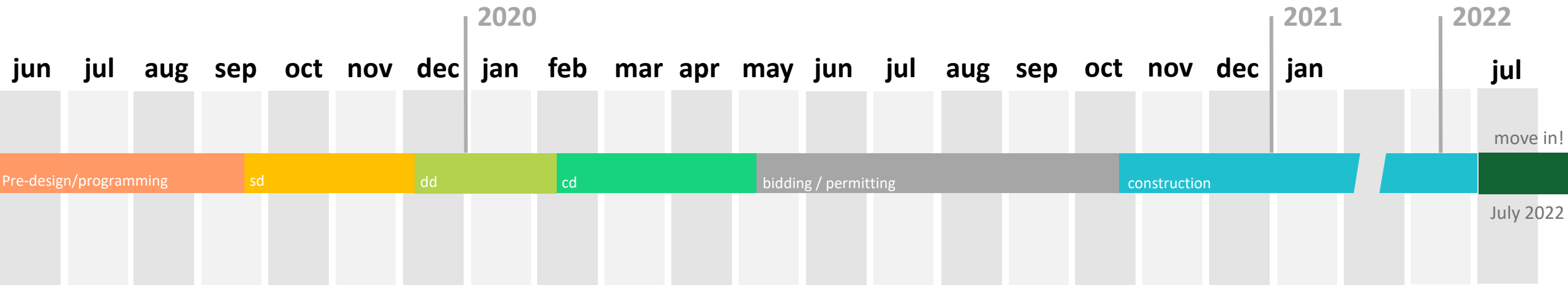

BETTER PROCESS | BETTER RESULTS



- Pre-Design / Programming
- Schematic Design
- Design Development
- Construction Documents
- Permitting
- Construction
- Occupancy

Sheffield ES | Learning Village

CURRENT Learning supported by **today's** classrooms

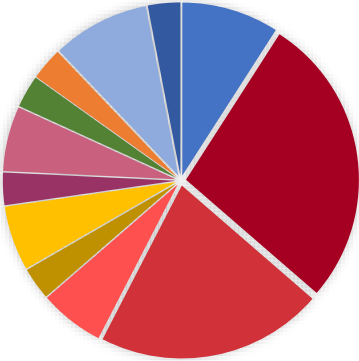

FUTURE Learning Modalities supported by **dynamic** spaces

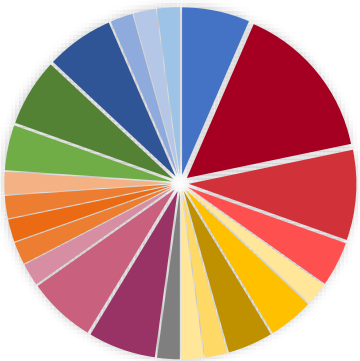

- Teacher Led Activities
- Student Collaboration
- Art-Based and Design Thinking
- Play, Movement & Naturalistic Learning
- Tinkering & Making, Virtual & Blended Learning
- Independent Study, Inquiry-based Learning
- Teacher Inter-Disciplinary Collaboration



Design with the Student in Mind®



Sheffield ES | CFB Elementary Way

3 Teams: Principals, Teachers, Staff
 Elementary School Create Your Own Campus Activity
 Campus Adjacencies
 Circulation Analysis
 Outdoor Utilization & Spaces
 Student Experience
 Community Engagement

Stakeholder Authorship

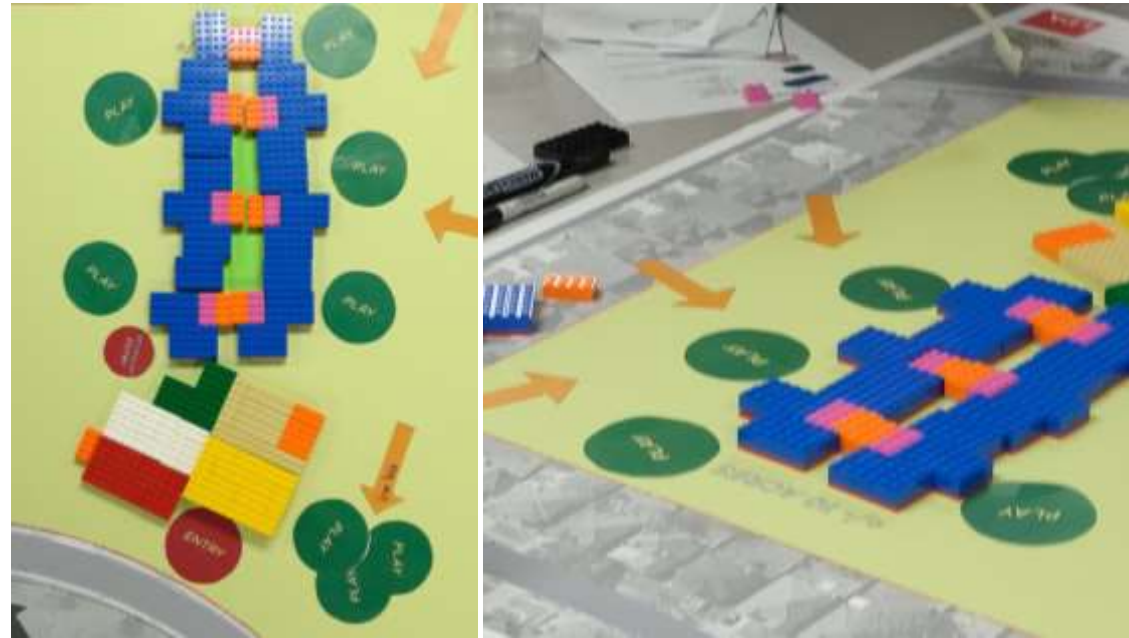

Sheffield ES | Preliminary Site

- **Learn** | seating, tables, outdoor classroom, writable
- **Create** | outdoor art & science, group seating, shade
- **Explore** | service garden, drinking fountain, nature
- **Play** | hardcourts, imaginary play, play structure, mpf
- **Meet** | amphitheater and stage, campus courtyard, dinning and shared spaces off commons



COMMUNITY
OPTION 3 - B - SITE PLAN
SHEFFIELD ELEMENTARY SCHOOL

Floor Plan

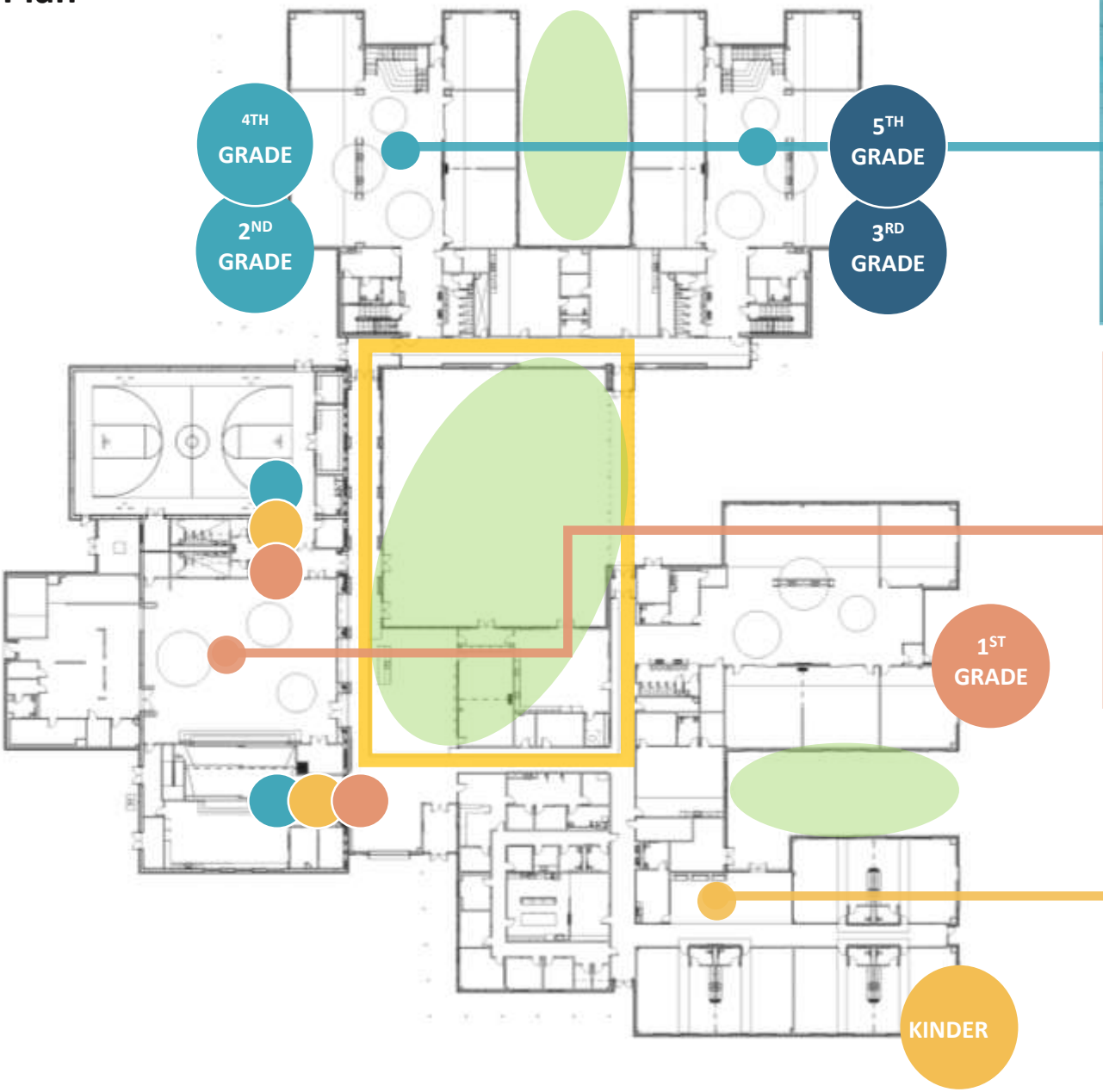

Future Sheffield Elementary School | 22nd Century Learning





MORE

HUCKABEE + JACKSON CONSTRUCTION



CARROLLTON-FARMERS BRANCH ISD
HIGH EXPECTATIONS FOR ALL

MORE THAN ARCHITECTS FOR CARROLLTON-FARMERS BRANCH ISD



ANDRE
HUCKABEE



MATT
JACKSON
CONSTRUCTION





R.L. TURNER + VIVIAN FIELD

Weekly
**CONSTRUCTION
MEETINGS**

Frequent Coordination
+ Jurisdictional
MEETINGS

ONGOING
Board + BAC Updates

60+
STAKEHOLDERS

40+
MEETINGS
Tours + Site Visits

6 CAC
Meetings from
January to July

BAC 8
Members meeting monthly

VIVIAN FIELD MIDDLE SCHOOL

CONSTRUCTION UPDATE

+ PHASING

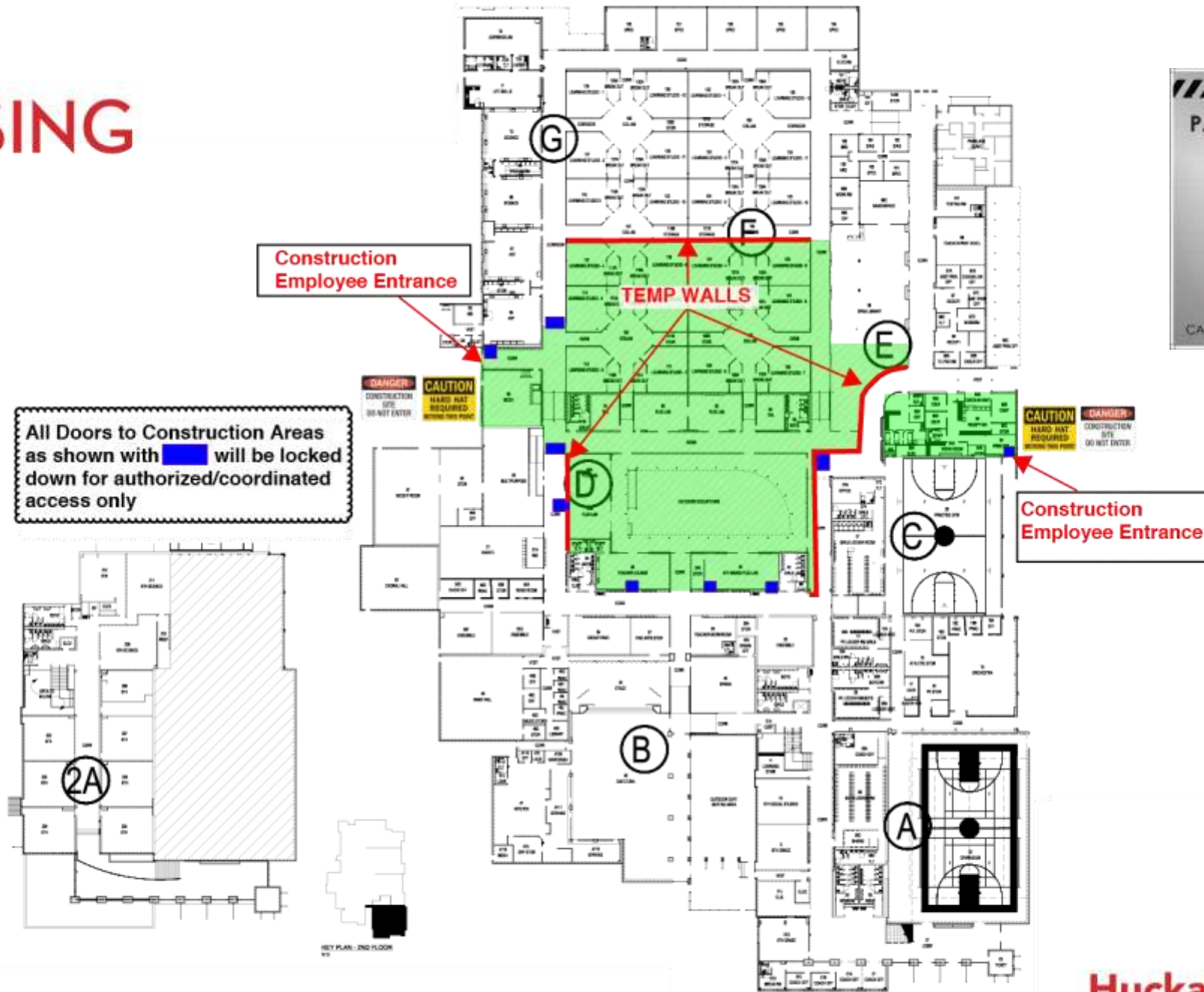

+ ROOF

SUMMER 2020



+ BAND HALL

SUMMER 2020



CLASSROOM



CLASSROOM



+ COURTYARD

FALL 2020

CONSTRUCTION



AFTER



+ QUAD POD

FALL 2020

CONSTRUCTION



AFTER



+ ADMIN SUITE

FALL 2020

CONSTRUCTION



VIVIAN FIELD MIDDLE SCHOOL
ENTRANCE

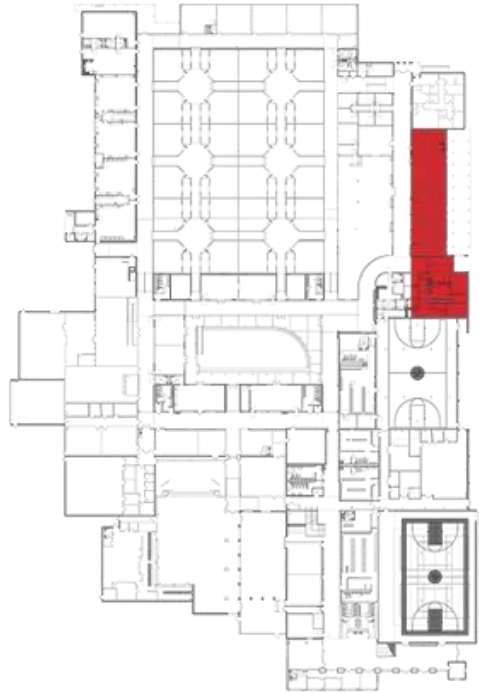

VIVIAN FIELD MIDDLE SCHOOL
ENTRANCE

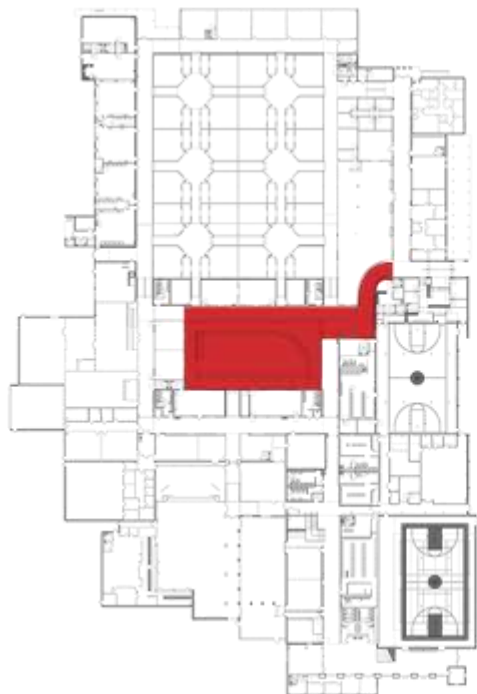

VIVIAN FIELD MIDDLE SCHOOL
LIBRARY CORRIDOR

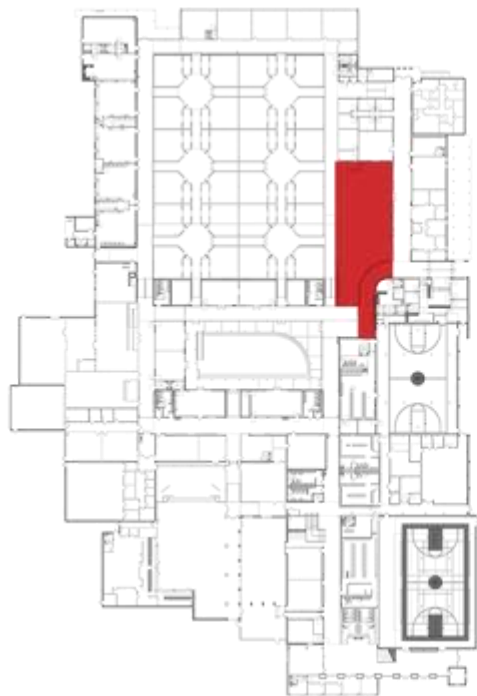

VIVIAN FIELD MIDDLE SCHOOL
QUAD POD

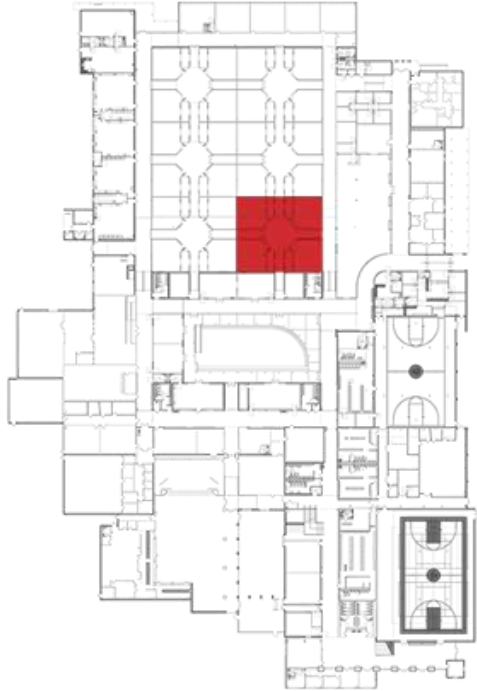

R.L. TURNER HIGH SCHOOL

CONSTRUCTION UPDATE

+ PHASING



CLEAR DIVISION



TEMPORARY WALLS

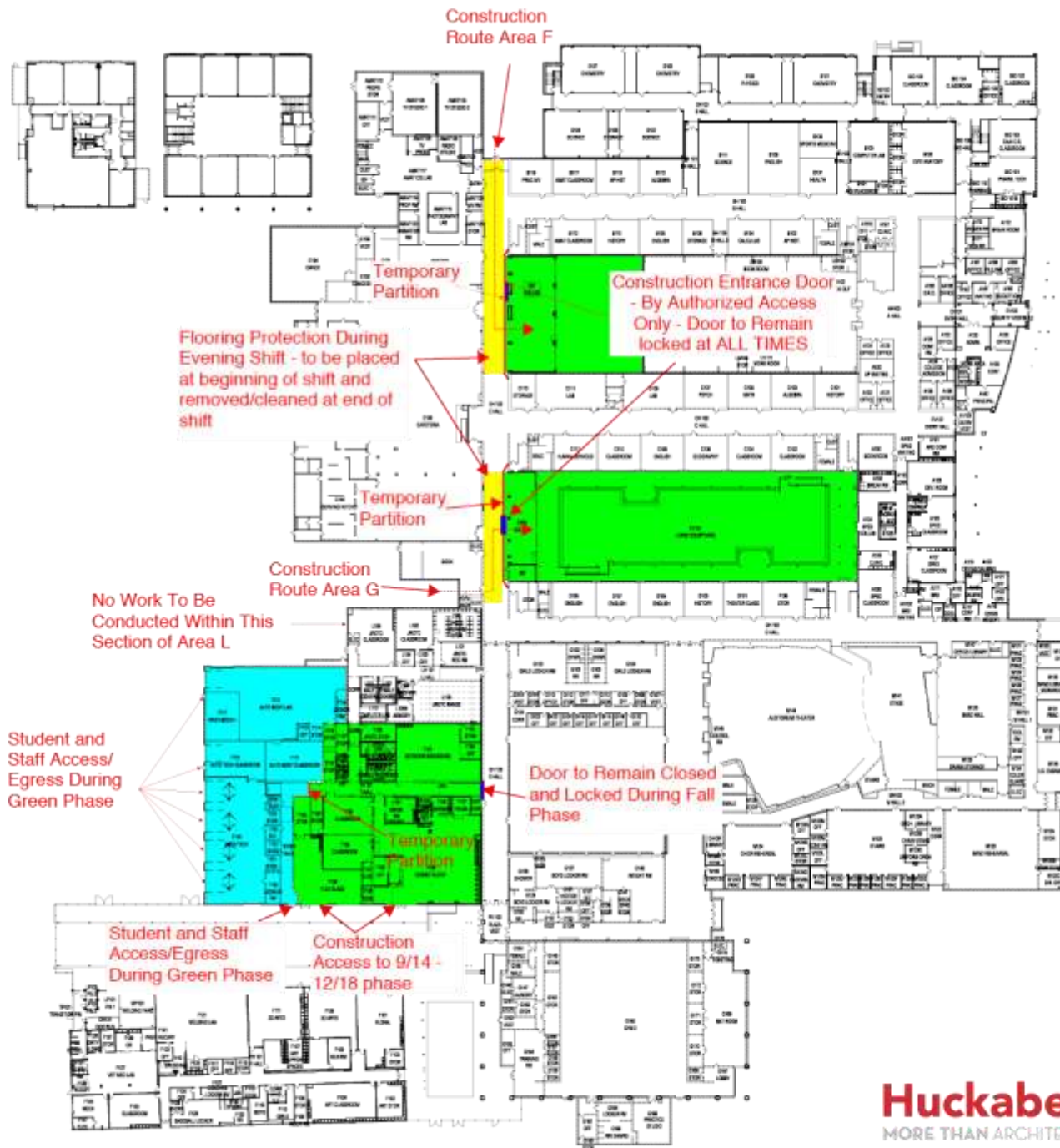

Phase From
9/14 to 12/18

Phase From
11/2 to 12/18



cfb CARROLLTON-FARMERS BRANCH ISD
BONDUPDATES



Huckabee
MORE THAN ARCHITECTS

JACKSON
CONSTRUCTION

+ FRONT ENTRY

SUMMER 2020

DRIVE AND LANDSCAPE



LIONS



+ FRONT ENTRY

SUMMER 2020

ENTRY HALL



RECEPTION



BIO HALL



BIO HALL



BIO 102



BIO 102



SPED CORRIDOR



SPED CLASSROOM



+ ROOF

SETTING UNITS



SUMMER 2020

COMPLETE



+ COLLAB SPACE

FALL 2020

BEFORE



AFTER



PRIDE LAND

FALL 2020

BEFORE



AFTER



BEFORE



AFTER



R.L. TURNER HIGH SCHOOL
ENTRANCE



R.L. TURNER HIGH SCHOOL
PRIDE LAND



R.L. TURNER HIGH SCHOOL
COSMETOLOGY



R.L. TURNER HIGH SCHOOL
COLLABORATION SPACE



WELCOME BACK STUDENTS!

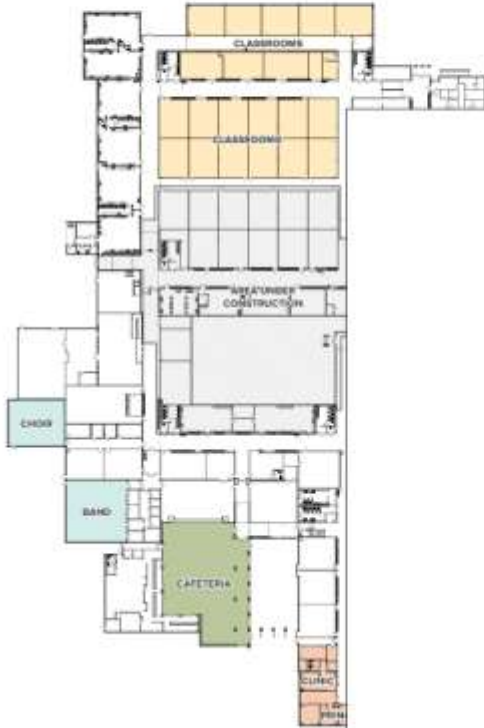

R.L. TURNER HIGH SCHOOL VET MED

The Vet Med renovation creates a real-world learning environment. This space is designed with a central lab space surrounded by different program spaces found in a veterinary clinic. Students will have the ability to experience learning at a check out desk, exam room, interior kennel, exterior livestock pen, exterior dog run, prep/recovery room, and operating room.

Huckabee
2020

JACKSON
2020





CARROLLTON-FARMERS BRANCH ISD
HIGH EXPECTATIONS FOR ALL

HUCKABEE + JACKSON CONSTRUCTION

+ GRAND VISION: TURNER HIGH SCHOOL



PERRY MIDDLE SCHOOL ADDITIONS & RENOVATIONS

— CONCEPTUAL DESIGN UPDATE —

SEP 21, 2020

PERRY MIDDLE SCHOOL ADDITIONS & RENOVATIONS

OUR TEAM



CLINTON SCHIVER
PRINCIPAL-IN-CHARGE



DALANE BOUILLION, Ed.D.
PRINCIPAL OF EDUCATIONAL
PLANNING



CHRISTIAN OWENS
PRINCIPAL - EDUCATION DESIGN
PRACTICE LEADER



MICHAEL VOIT
PROJECT DIRECTOR



CHRIS ORTIZ
PROJECT DESIGNER



KENT LEACH
PROJECT ARCHITECT



CORTNEY ELLIOT
INTERIOR DESIGNER

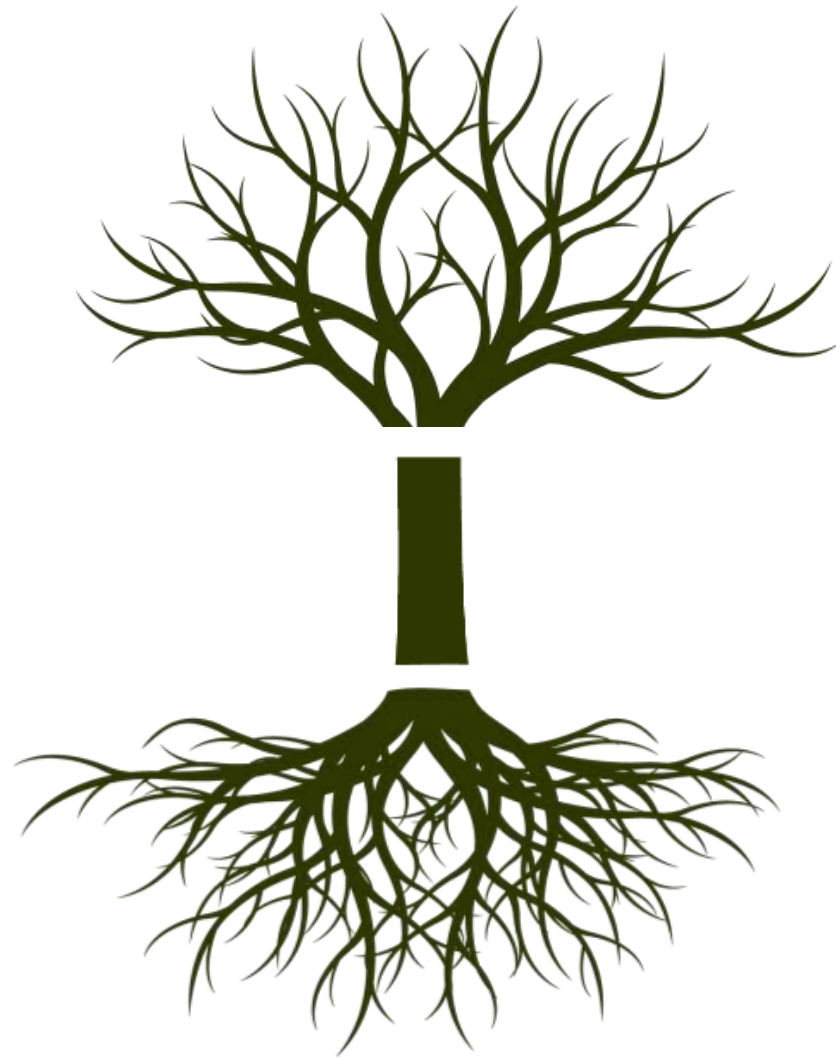

MAJOR BRANCHES

SCHEMATIC DESIGN

- Up to four meetings are planned for Schematic Design
- Focus Groups: TBD, but anticipated to include Admin, Library, Special Ed, Fine Arts, Athletics, Classrooms/Villages

TRUNK

PRE-DESIGN (CONCEPT)

- VLK | Curation – Meeting with District Administration
- Student Voice Meeting – 11 Participants
- VLK | Launch – 33 Participants in Day 1

ROOTS

CAPITAL PLANNING

- BAC – 8 Community members meeting every month
- CAC – 6 Meetings from Jan – July

PROJECT GOALS
WHERE WE'VE BEEN
VLK | CURATION®
TYPOLOGY OF SPACES
STUDENT & COMMUNITY INVOLVEMENT
WHERE WE ARE GOING



PERRY MIDDLE SCHOOL ADDITIONS & RENOVATIONS

PROJECT GOALS

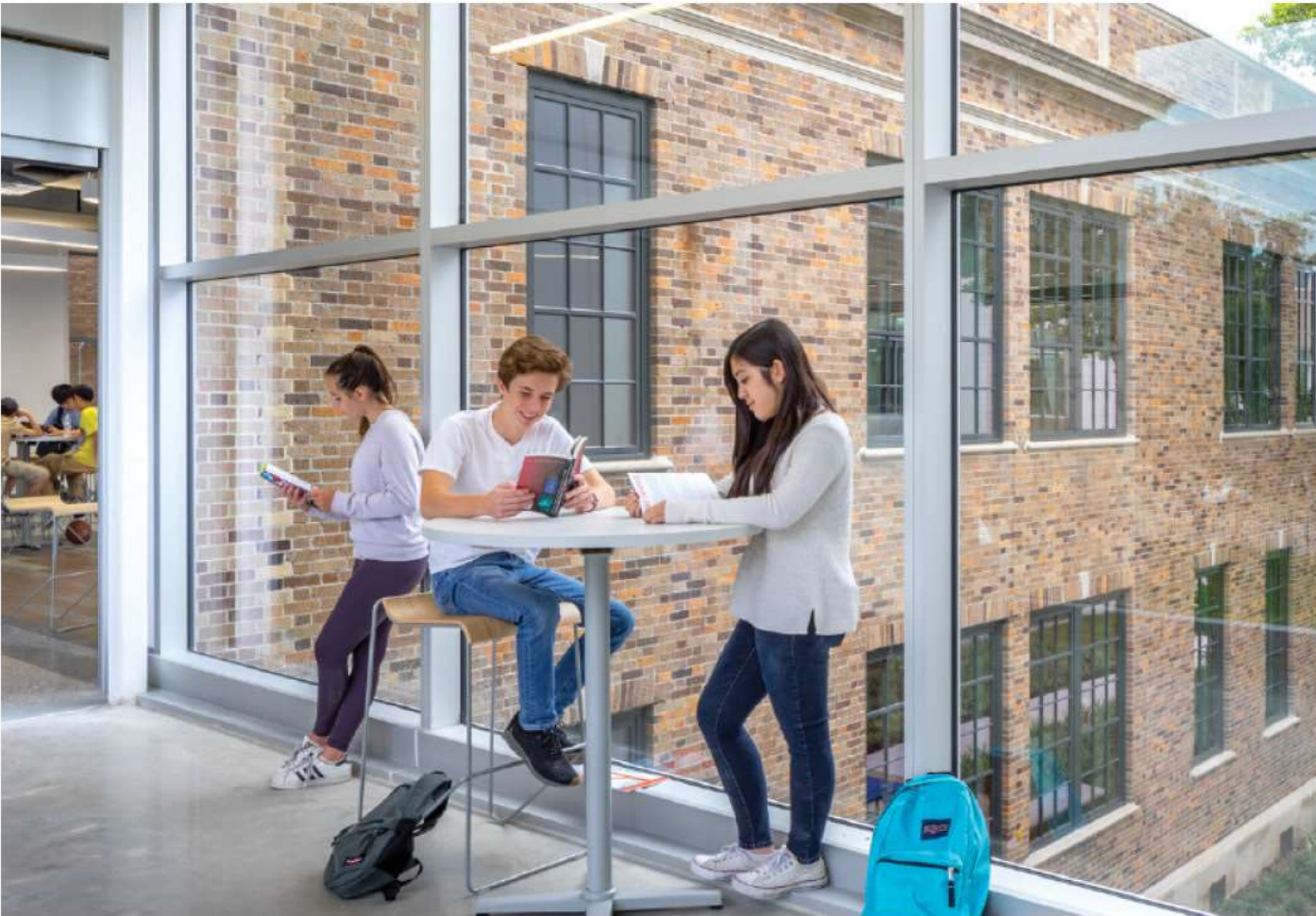

Respecting the History of
the Community

Modernization of the Middle
School Learning Environment

Community and Student
Involvement in the Design
Process

PERRY MIDDLE SCHOOL ADDITIONS & RENOVATIONS

WHERE WE'VE BEEN



VLK CURATION®	APR 15, 2020
STUDENT VOICE MEETING	APR 29, 2020
VLK LAUNCH® DAY 1	SEP 01, 2020
VLK LAUNCH® DAY 2	SEP 18, 2020
SCHEMATIC DESIGN	SEP-OCT 2020
VLK PIXEL® PROCESS	OCT 2020-FEB 2021
DESIGN DEVELOPMENT	OCT 2020-JAN 2021
CONSTRUCTION DOCUMENTS	JAN-MAR 2021
OUT FOR PROPOSALS	APR 2021
START OF CONSTRUCTION	MAY 2021
CONSTRUCTION COMPLETION	FEB 2023

PERRY MIDDLE SCHOOL ADDITIONS & RENOVATIONS

VLK | CURATION® OVERVIEW



VLK | CURATION® is our thorough process of action research with the school district. Our Principal of Educational Planning, Dalane Bouillion, Ed.D. uses district data such as strategic plans, innovative district plans, goals for curriculum and instruction, current instructional methodologies, academic programs, and state data.

Using a district leadership focus group, and a highly collaborative process, we dialogue about teaching and learning via a Curriculum and Instruction Design Planning Questionnaire. We also use a learning organization tool to discern the current status of the district's belief system, as well as the intentions for growth, improvements, and educational changes. VLK Architects also uses a simple teacher observation protocol to study the learning styles of students in the district. Through simple statistics, we can discern the types of spaces that will be most beneficial for learners based on the results of these tools. The outcomes of **VLK | CURATION®** form the foundation that will drive all aspects of design.

PERRY MIDDLE SCHOOL ADDITIONS & RENOVATIONS

VLK | CURATION® STUDENT LEARNING STYLES

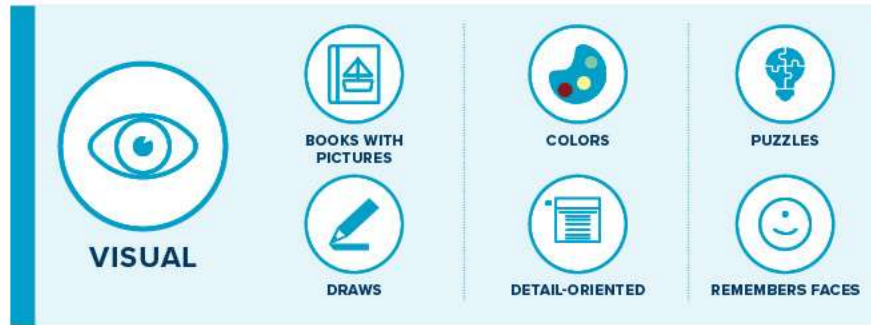

LEARNING STYLES	TOTAL
Visual	16%
Auditory	7%
Tactile/Kinesthetic	10%
Visual & Auditory	18%
Auditory & Tactile/Kinesthetic	7%
Visual & Tactile/Kinesthetic	17%
Visual, Auditory & Tactile/Kinesthetic	25%
T/K Aggregate	59%

1,030 Middle School Students from CFB ISD were Observed

PERRY MIDDLE SCHOOL ADDITIONS & RENOVATIONS

STUDENT & COMMUNITY INVOLVEMENT

VLK | LAUNCH® VLK | CURATION® VLK | PIXEL

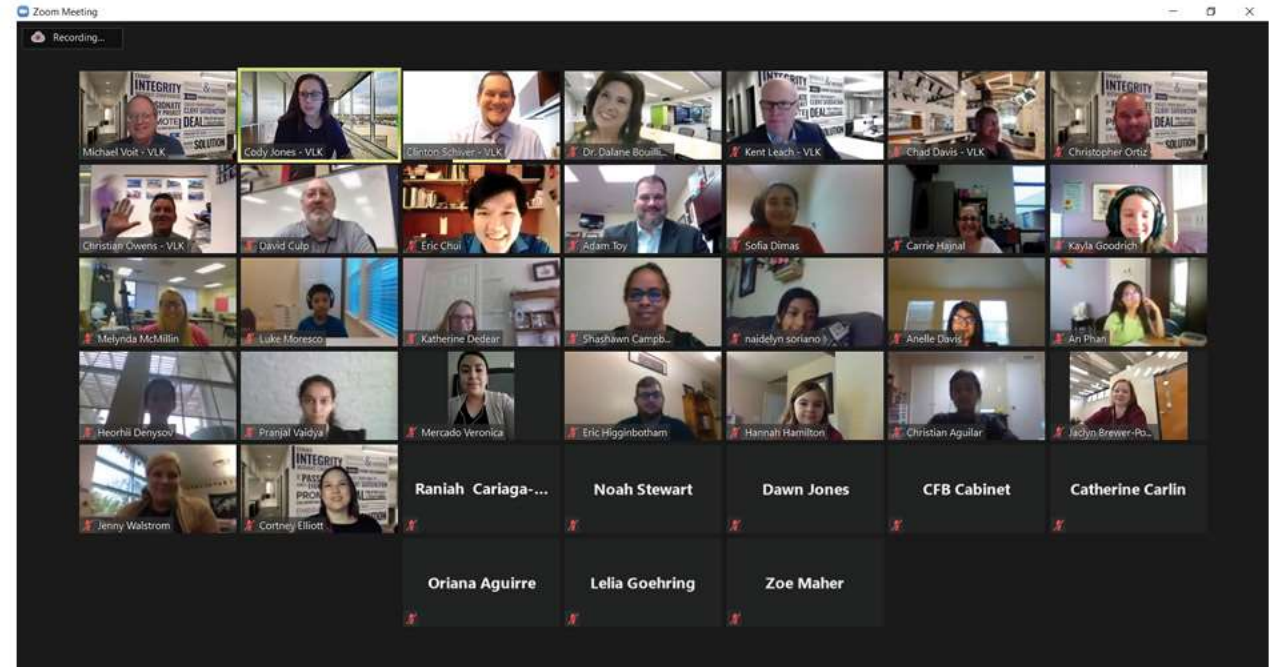

STUDENT VOICE MEETING

Do you prefer to learn on your own, in small groups, or as a large class? How does the classroom design support or prevent your preference?

“Smaller groups, [be-]cause with too many people the ideas could clash and some people aren’t really comfortable with that. Many people and small groups, there’s a specific amount of people you can share and talk. So not too big. It’s nice looking at different perspectives of learning and you can do how you learn.”

I like environments that are comfortable and that allow students to support/interact with each other.

PERRY MIDDLE SCHOOL ADDITIONS & RENOVATIONS

STUDENT & COMMUNITY INVOLVEMENT - STUDENT VOICE



Involved Dr. Chapman's Student Advisory Council Middle School Members

How do you like to learn?

"I think it would be more beneficial if we have more than one board. Just one big board in the center of the room so that way maybe other kids could be trying to explain to other classes on a different board in the corner of the room."

In which classrooms do you learn the most (think physical space)?

"I'm usually sitting individually like at a single desk so I can always lean over and ask a classmate. But I definitely, I like sitting in groups and I like working with other people when I'm doing class."

"I like the idea where I could be able to move around the classroom and learn where I want to learn."

"My favorite setup of a classroom is where it's really spacious and open and I can move around."

Where do you prefer to do classwork?

"So we have this courtyard that's in the center of the school and I love working outside because I like the breeze and sun and it's really nice to have an open sky above you. We hardly ever get to go there to work. Natural light is often a really big factor in keeping morale up because it makes you feel good, so it's nice to work there."

Do you prefer to learn on your own, in small groups, or as a large class? How does the classroom design support or prevent your preference?

"Smaller groups, [be-]cause with too many people the ideas could clash and some people aren't really comfortable with that. Many people and small groups, there's a specific amount of people you can share and talk. So not too big. It's nice looking at different perspectives of learning and you can do how you learn."

PERRY MIDDLE SCHOOL ADDITIONS & RENOVATIONS

STUDENT & COMMUNITY INVOLVEMENT **VLK|LAUNCH**® DAY 1

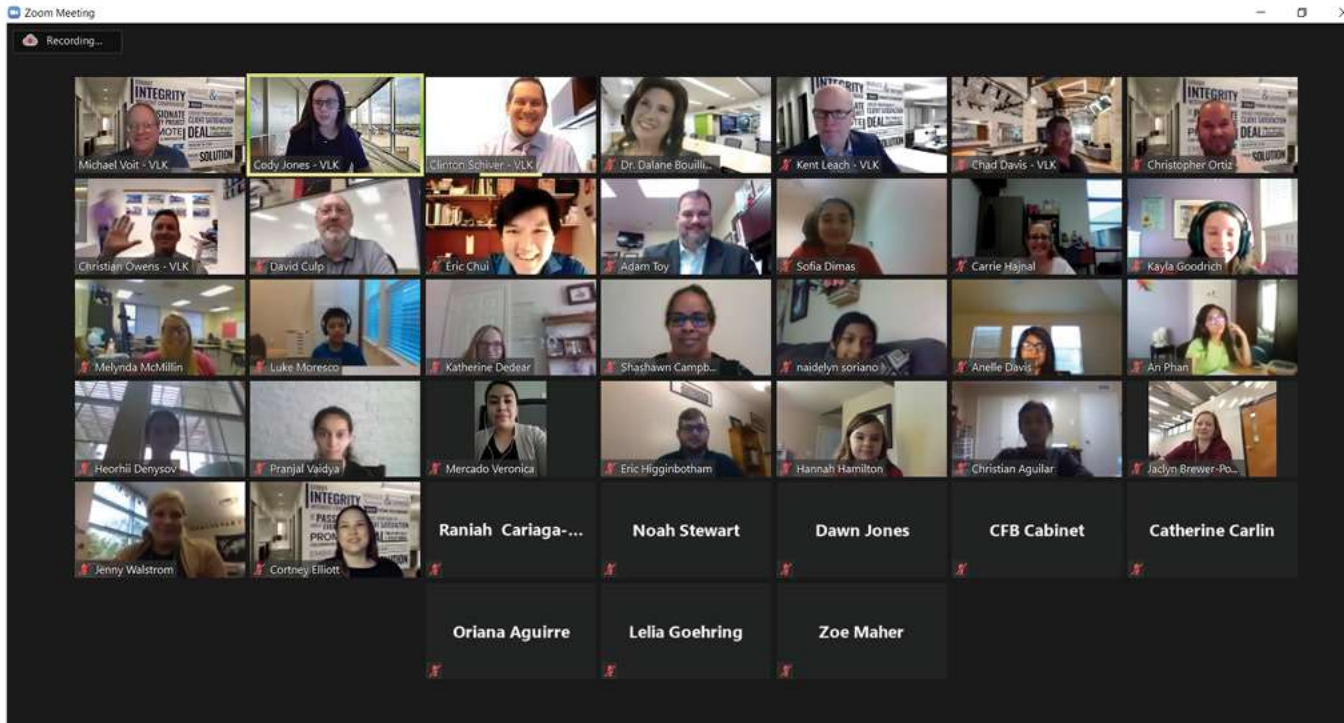

VLK Architects' Virtual **VLK | LAUNCH**® is a two-day process of virtual meetings that CFB ISD students, parents, teachers, administrators, and community leaders participated in through live digital platforms hosted by VLK Architects.

I enjoy the community aspect and the “openness”. I chose the critical thinking because I feel that is something extremely important for Middle School age children to develop.

Spaces for co teaching can open up opportunities for collaboration among all content areas

Can we make the courtyards more “useful” with tables, benches, etc so they can be used for studying and socializing rather than what they are now?

PERRY MIDDLE SCHOOL ADDITIONS & RENOVATIONS

STUDENT & COMMUNITY INVOLVEMENT **VLK|LAUNCH**® DAY 1

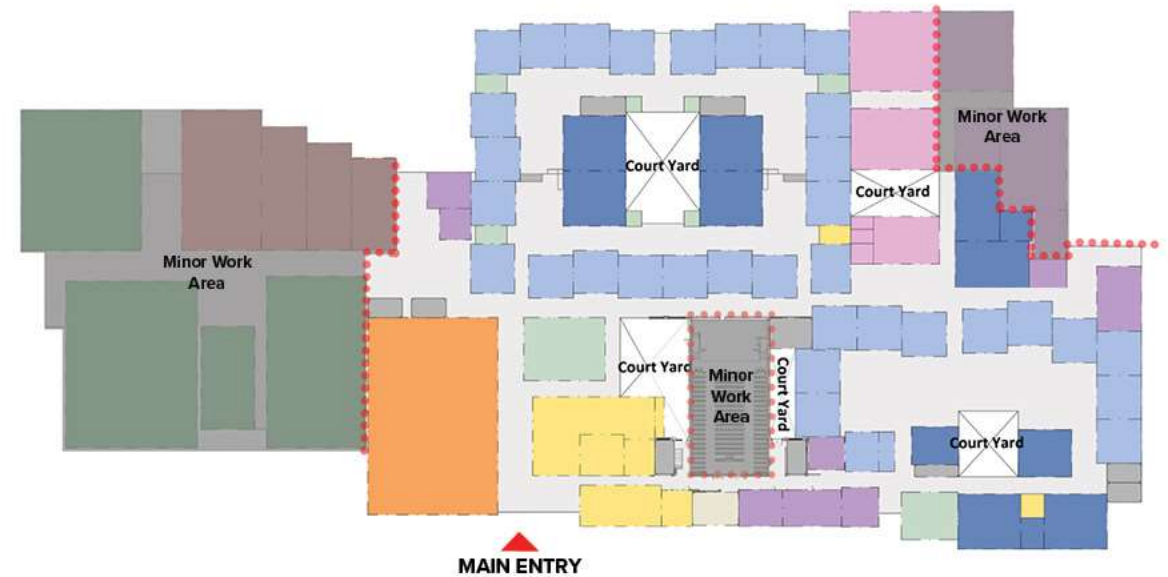
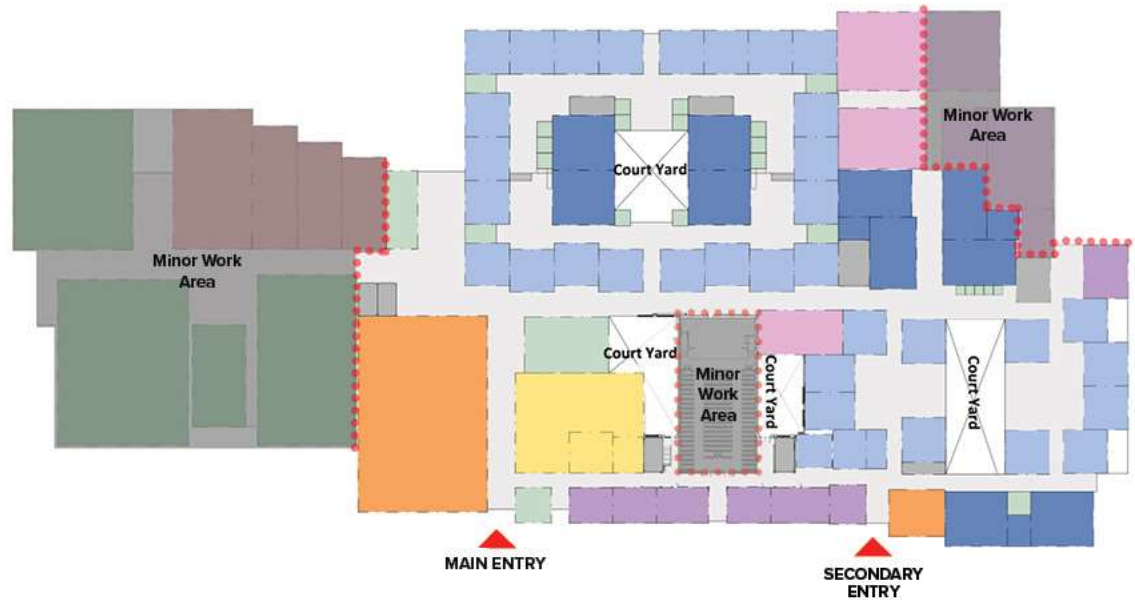

PERRY MIDDLE SCHOOL ADDITIONS & RENOVATIONS

STUDENT & COMMUNITY INVOLVEMENT VLK|LAUNCH[®] DAY 1

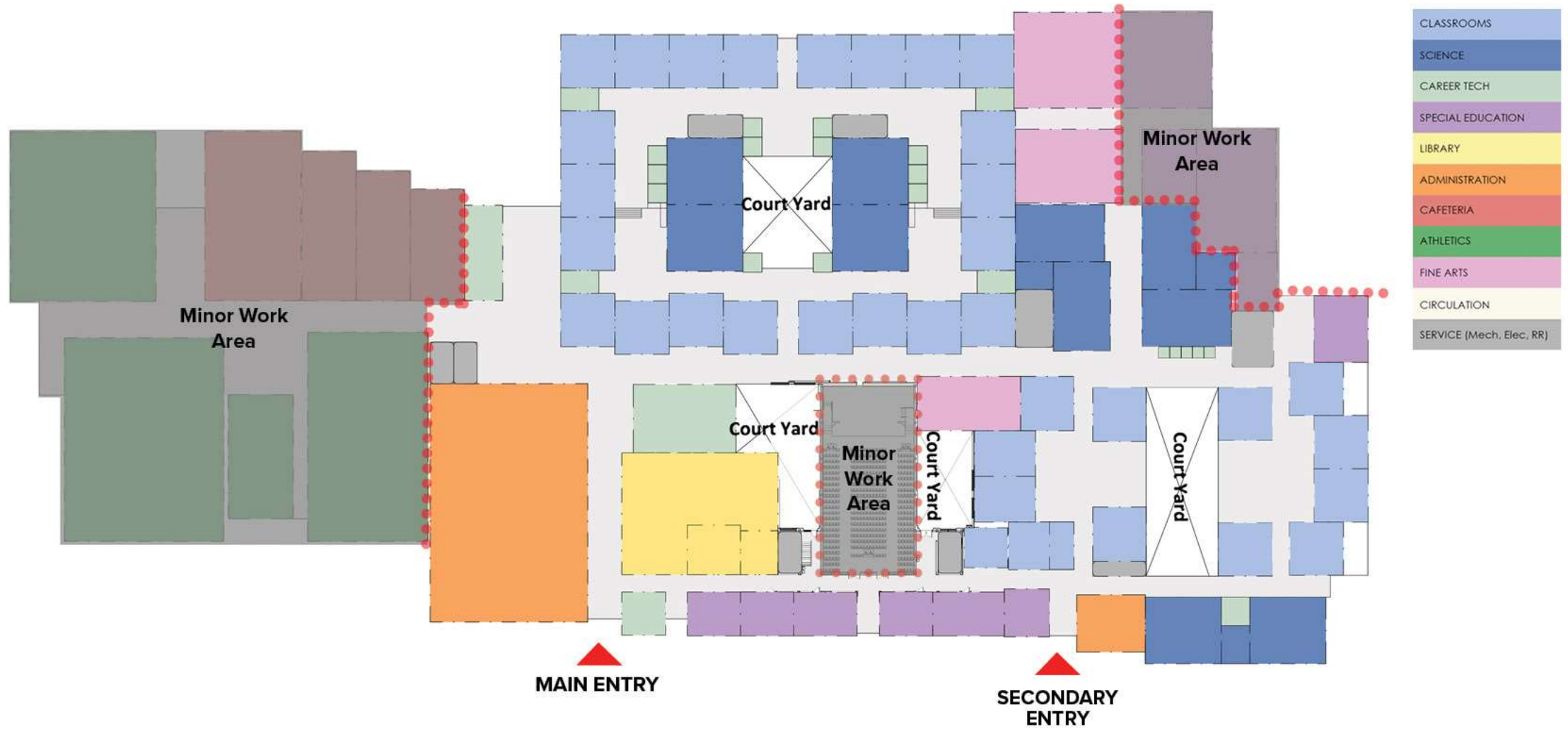

PERRY MIDDLE SCHOOL ADDITIONS & RENOVATIONS

STUDENT & COMMUNITY INVOLVEMENT VLK|PIXEL®

Prior to the first committee meeting, Carrollton-Farmers Branch ISD will determine staff, students, administration, and community members to be involved in the process. Each of the following meetings will last approximately two hours.



Brand Visioning & Research Review

During this meeting the Branding Committee learns about branding, receives project details, and is provided the research information that has been collected. Further discussion regarding the information is completed and committee members are provided research homework to research additional timeline details and artifacts origin.

Community Survey: What does Carrollton HS / DeWitt Perry MS mean to you?



Visual Ideation

During Visual Ideation, committee members report information that they were able to discover through their research. They will determine which artifacts are sacred to their brand and need to be sustained in the new facility. The committee will also discuss district approved components of the graphics package (i.e. Logo, Mascot, Colors).

Committee Survey: Establishing consensus of the brand and visual ideation



Brand Consensus

In this third meeting, the results from surveys are presented to the committee for final decisions and consensus for recommendations and consideration by the district.

PERRY MIDDLE SCHOOL ADDITIONS & RENOVATIONS

WHERE WE ARE GOING



SCHEMATIC DESIGN KICK-OFF

SEP 23, 2020

REVIEW NO. 1

OCT 01, 2020

REVIEW NO. 2

OCT 08, 2020

FINAL SCHEMATIC DESIGN

OCT 20, 2020





CONSTRUCTION

Starting Construction Phase March 2021

10+

DOCUMENTATION (DD & CD) MEETINGS

August 202 – March 2021

2 Design Development Meetings (08/26, 09/10/2020)

6 Focus Group Meetings

- Library, Principal, AV, Auditorium and (3)CTE

9

SCHEMATIC DESIGN WORKSHOPS

June - August 2020

4 Schematic Design Meetings (06/15, 07/06, 07/13, 07/27/2020)

4 Focus Group Meetings

- Library, CTE, Auditorium and Culinary
Structural Review (08/24/2020)

7+

PRE-DESIGN DISCUSSIONS

Kick-Off Meeting (02/27/2020)

2 Programming and Pre-Design Meetings (04/21, 05/12/2020)

1:1 Visioning Meetings (04/30, 05/11, 05/13, 05/19/2020)

- Principle, CTE, Fine Arts, Theater

Scholar and Educator Surveys

Site Walks

14

BAC & CAC PRESENTATIONS

January – July 2019 6 CAC Meetings & 8 Board Meetings

June Board / BAC Workshop

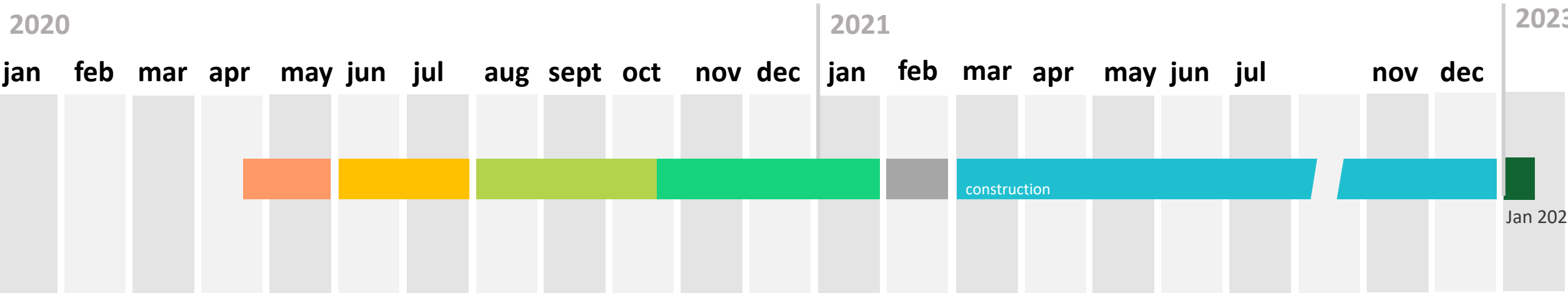

BETTER PROCESS | BETTER RESULTS

Programming Project Schedule



BETTER PROCESS | BETTER RESULTS



-  Pre-Design / Programming
-  Schematic Design
-  Design Development
-  Construction Documents
-  Permitting
-  Construction
-  Occupancy

Scope Areas

- Library / Maker Space(s)
- Auditorium
- CTE (Construction, Culinary Arts)
- Wayfinding
- Security
- Site Improvements
- Exterior – Roofing Replacement
- MEP/Fire Alarm Upgrades
- Technology Infrastructure

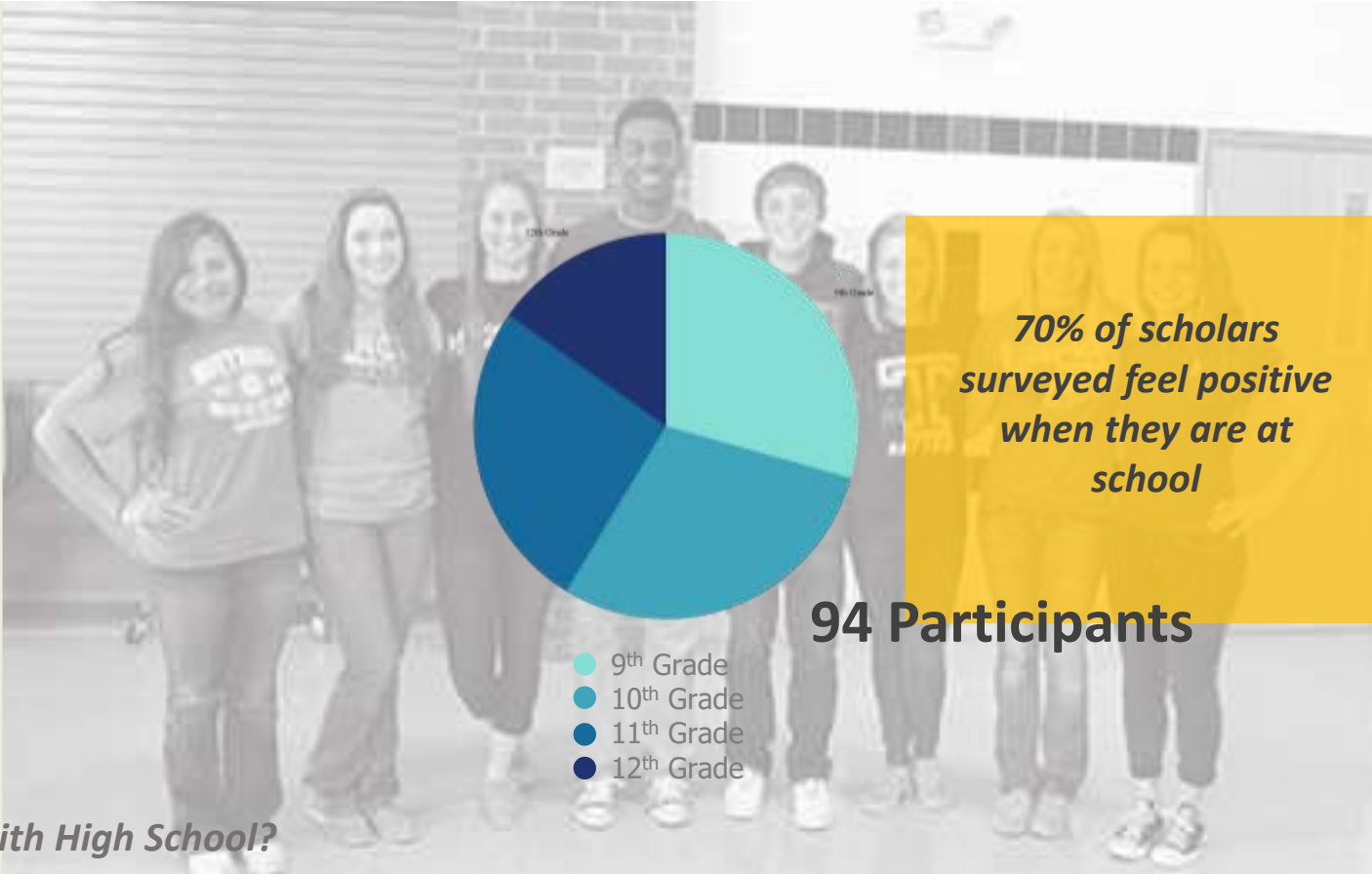

What is unique about Newman Smith High School?

“I think that NSHS is an absolutely wonderful community! I feel like the teachers do what they can to accommodate the students, and the students have great bonds with their teachers! Also, NSHS offers a great variety of resources and classes, so students have a great deal of freedom in their high school careers!”

“Our principal, duh”

On Collaboration & CTE....



“We need more open spaces for collaboration, student gathering and spaces that are different to encourage engagement - making students proud to attend NSHS”

- NSHS teacher

Which CTE programs have you participated in....

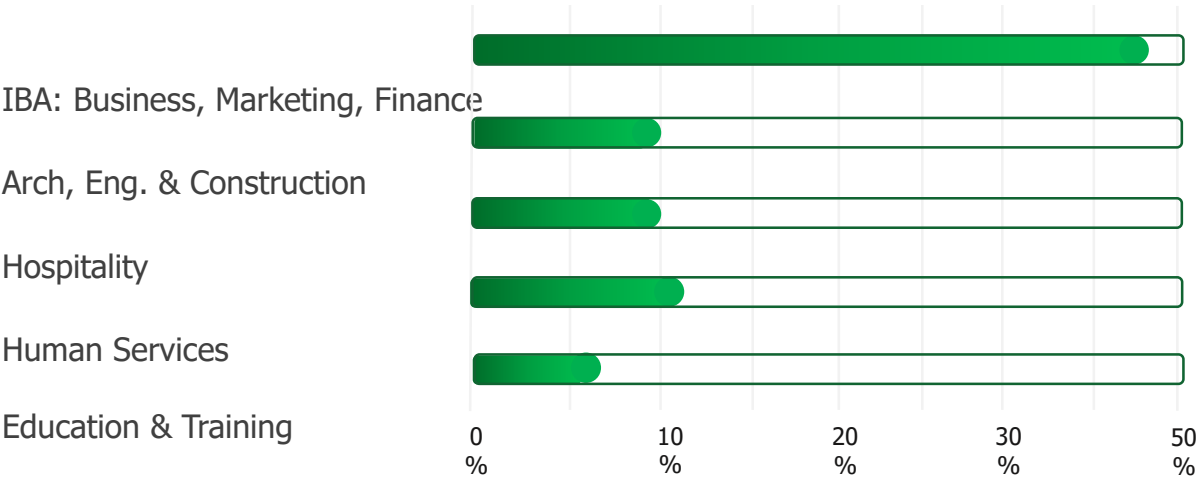

Research shows these 5 key spatial themes categorize how stakeholders understand and utilize learning environments designed for collaboration:

- apparent in purpose
- available in adjacent or proximate location
- attentive to human needs
- agile in the flexibility of use
- well-afforded in terms of building features

Cramer & Phillips (2019). *The Space to Collaborate: A Study of Collaboration in the K12 Physical Learning Environment*. Published by LPARED.

Research Findings – Guiding Principles

- ***S**pirit and Community*
- ***M**ovement & Campus Organization*
- ***I**nnovative & Collaborative CTE Spaces*
- ***T**echnology & Digital Learning*
- ***H**uman Connections with Restorative Spaces*

An environment grounded in inspiration, wellness, human connection and community.



Concept & Big Idea

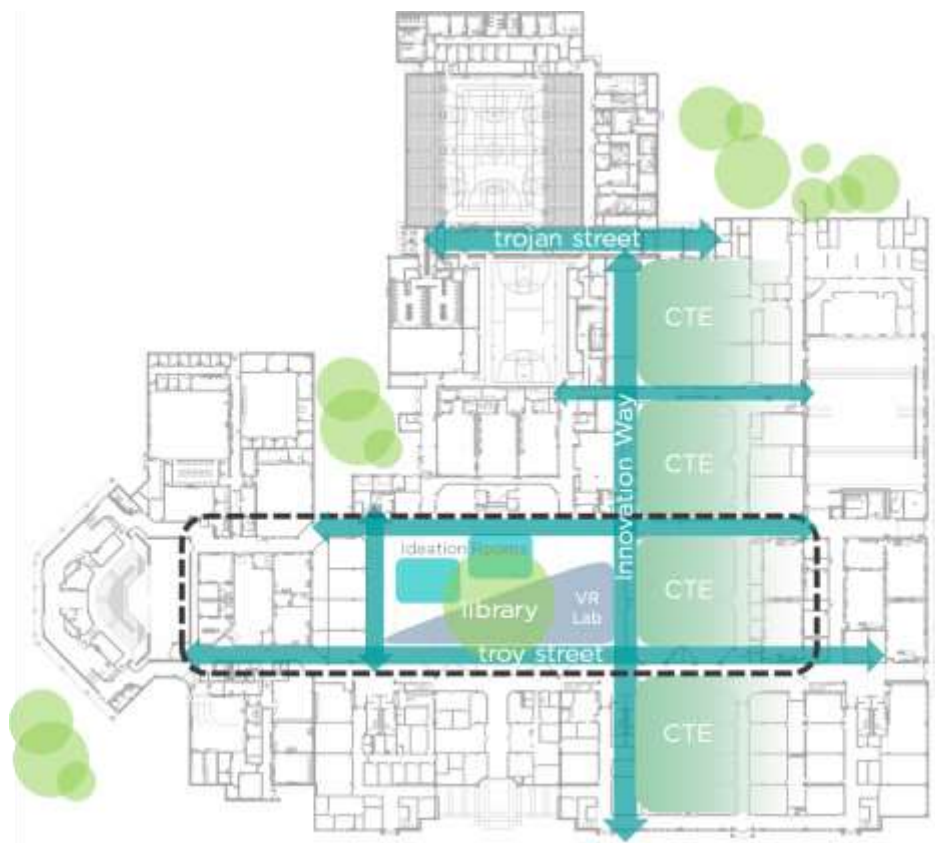

Master Plan Diagram

EXISTING SCHOOL - 2nd FLR

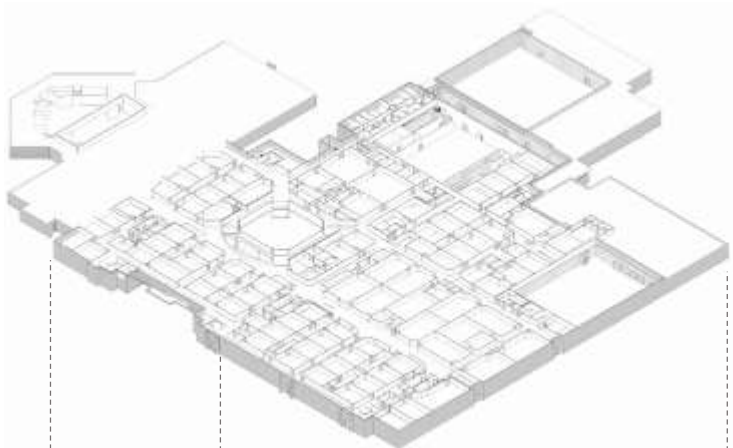

2018 BOND – 2nd FLR

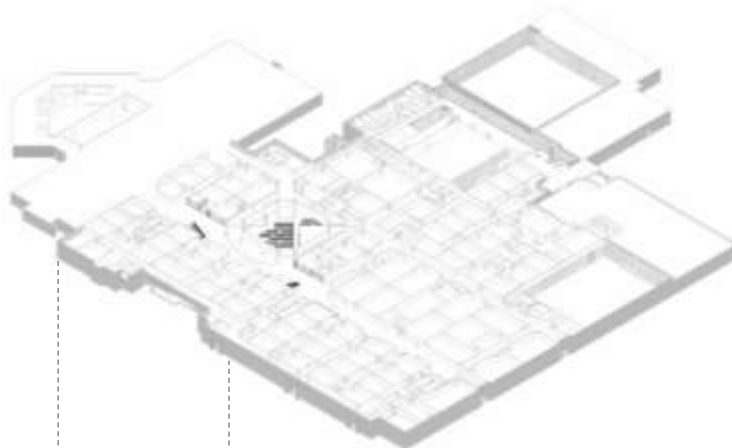

FUTURE BOND – 2nd FLR
(not currently funded)

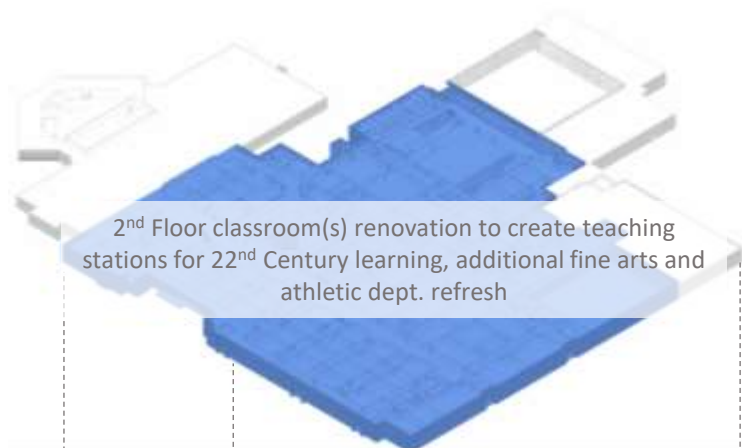

EXISTING SCHOOL - 1st FLR

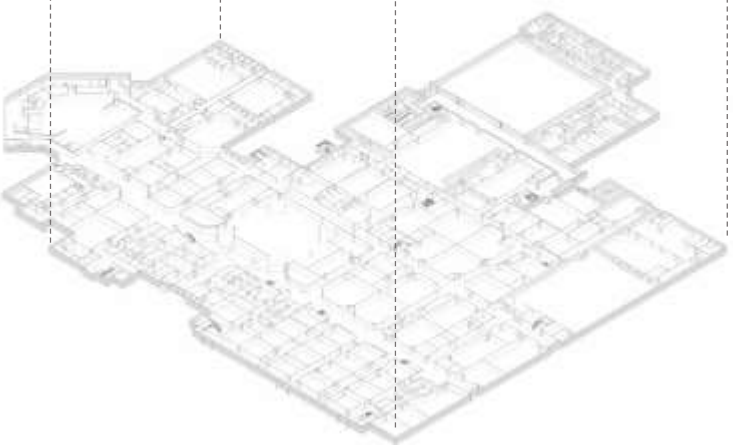

2018 BOND – 1st FLR

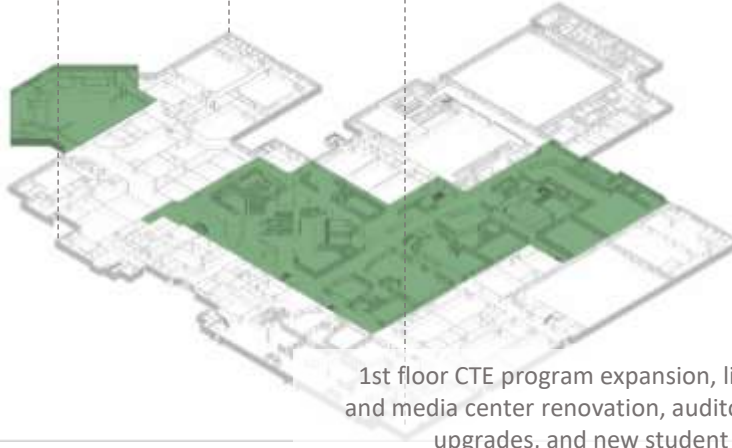

FUTURE BOND – 1st FLR
(not currently funded)

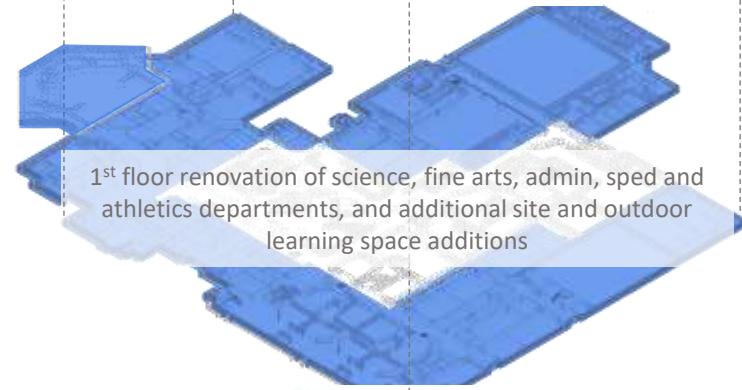

2018 Bond Scope

Building Improvements

- New RTU
- Access Control and Cameras
- Climate-Controlled Server
- Fire Sprinkler System Upgrades
- Low Voltage Replacement
- Student Entry Site Improvements
- Gas Piping
- Cabling
- Wireless Upgrades
- Phone System Upgrades

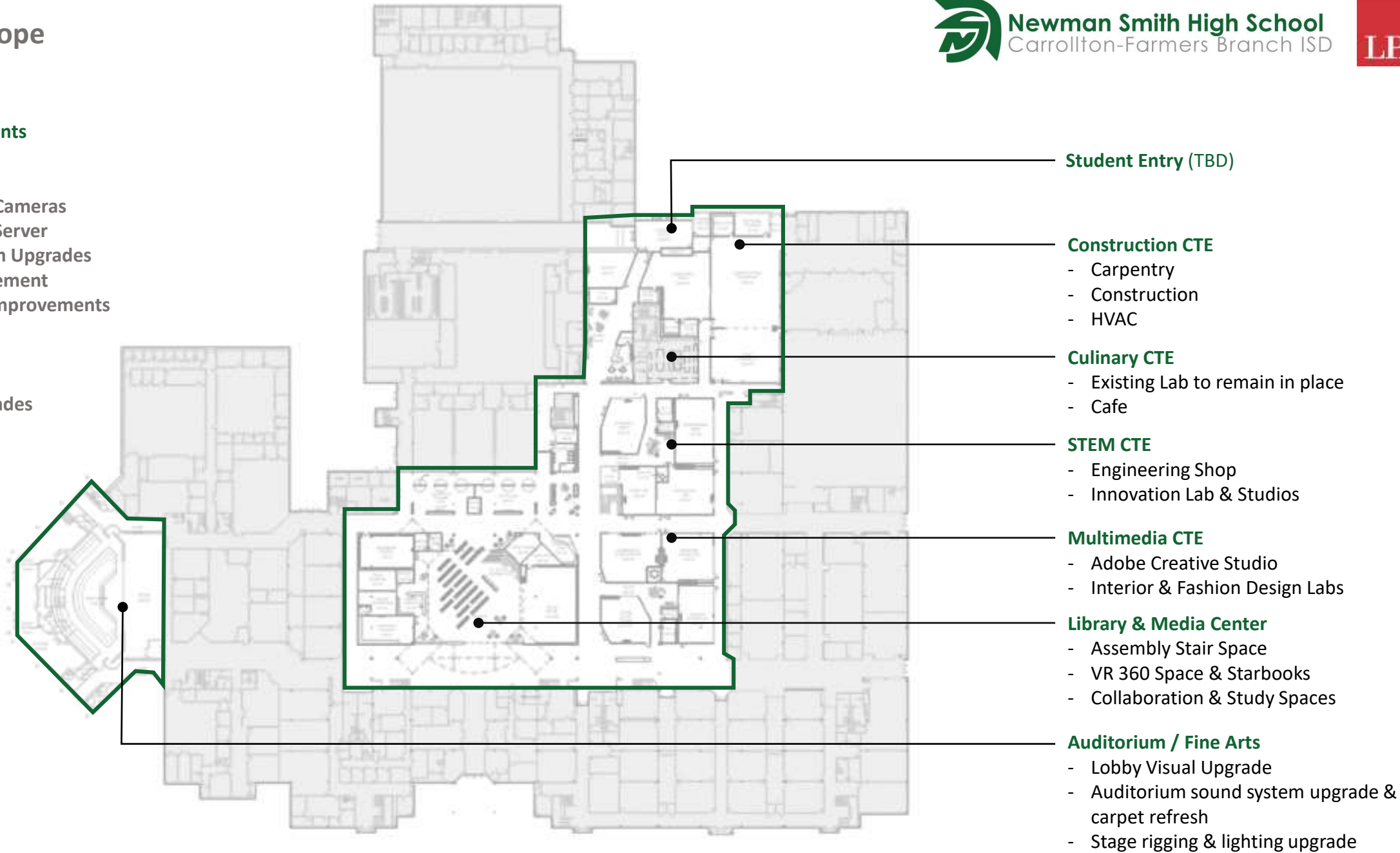

Process of Discovery

Department Led Discussions



- Welcome - lobby**
 - 1. Lobby paint finish refresh
 - 2. New Wayfinding & Signage
 - 3. New LED lighting upgrade
 - 4. New lobby stair flooring
- Experience - theatre**
 - 1. Sound System Upgrade
 - 2. House Lighting Upgrades
 - 3. New carpet/flooring throughout auditorium (seats to remain)
- Perform - stage**
 - 1. Electrical & Theatrical Lighting Upgrades
 - 2. New Stage Curtain(s)
 - 3. New Stage Flooring
- Future Work**
 - 1. Spiral Staircase for Catwalk Access
 - 2. Locking doors at top lobby stairs
 - 3. New acoustic wall panels within auditorium
 - 4. Updated Finishes
 - 5. Removal of lightlock at stage

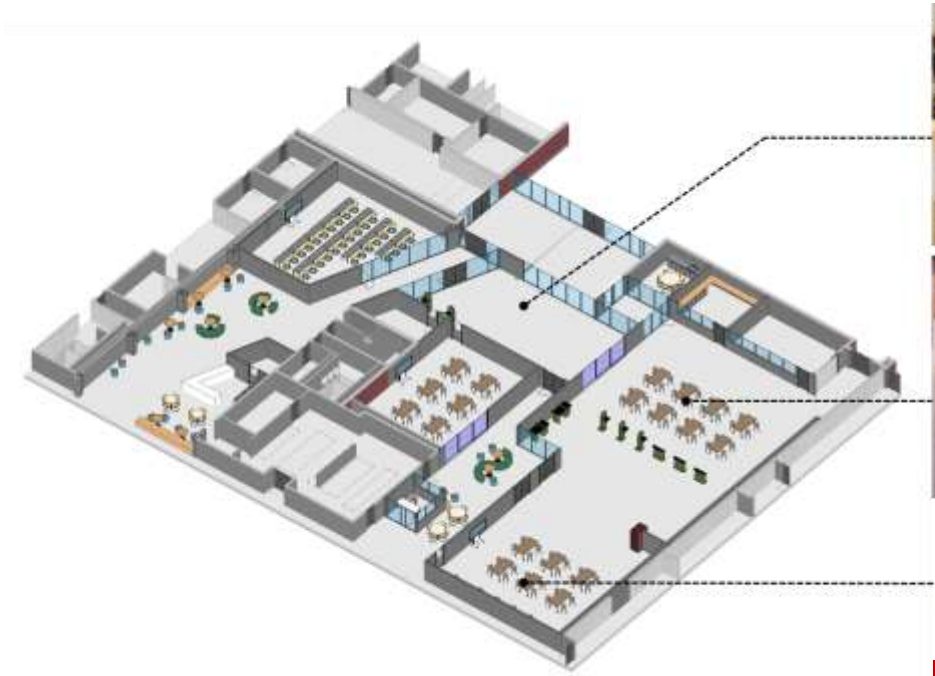

Virtual Tours

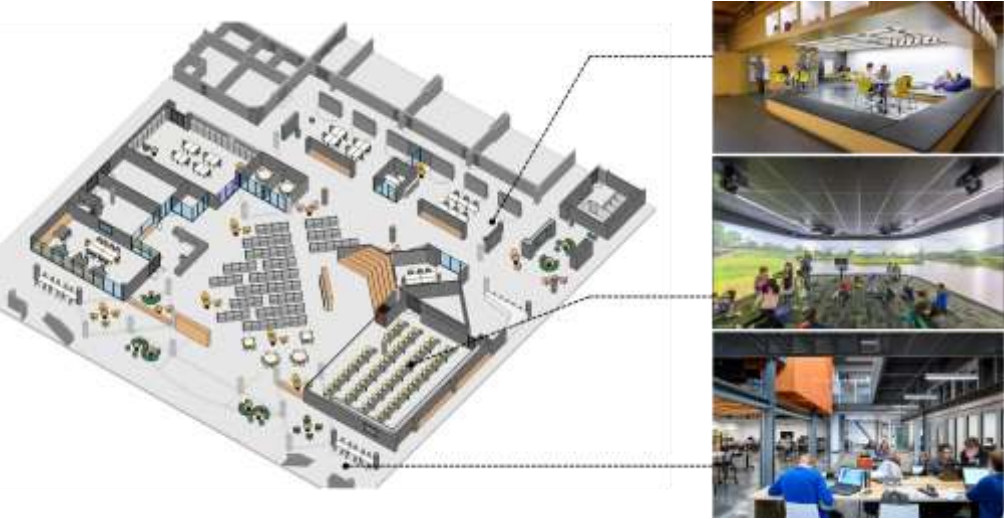

shifted the carpentry shop to the larger shop space. The former carpentry shop will act as a construction flex space

- A new "construction mgmt." space will be utilized for classroom instruction within the program
- We've adjusted the middle corridor space to serve as a collab space

Cyber Lab for collaboration

- Storage room north of existing stair to be utilized for secured storage (i.e. drones, parts and sensitive material needing a lockable space)

and Adobe Suite

- Fashion and Interior Design labs to stay on the 2nd floor, these spaces will serve as more of a flexible instruction space that can be for all CTE programs



Room	Room #	Room Name	Room Type	Room Status	Room Notes
Workshop	101	Workshop	Workshop	Open	
Workshop	102	Workshop	Workshop	Open	
Workshop	103	Workshop	Workshop	Open	
Workshop	104	Workshop	Workshop	Open	
Workshop	105	Workshop	Workshop	Open	
Workshop	106	Workshop	Workshop	Open	
Workshop	107	Workshop	Workshop	Open	
Workshop	108	Workshop	Workshop	Open	
Workshop	109	Workshop	Workshop	Open	
Workshop	110	Workshop	Workshop	Open	



Room	Room #	Room Name	Room Type	Room Status	Room Notes
Workshop	201	Workshop	Workshop	Open	
Workshop	202	Workshop	Workshop	Open	
Workshop	203	Workshop	Workshop	Open	
Workshop	204	Workshop	Workshop	Open	
Workshop	205	Workshop	Workshop	Open	
Workshop	206	Workshop	Workshop	Open	
Workshop	207	Workshop	Workshop	Open	
Workshop	208	Workshop	Workshop	Open	
Workshop	209	Workshop	Workshop	Open	
Workshop	210	Workshop	Workshop	Open	



Room	Room #	Room Name	Room Type	Room Status	Room Notes
Workshop	301	Workshop	Workshop	Open	
Workshop	302	Workshop	Workshop	Open	
Workshop	303	Workshop	Workshop	Open	
Workshop	304	Workshop	Workshop	Open	
Workshop	305	Workshop	Workshop	Open	
Workshop	306	Workshop	Workshop	Open	
Workshop	307	Workshop	Workshop	Open	
Workshop	308	Workshop	Workshop	Open	
Workshop	309	Workshop	Workshop	Open	
Workshop	310	Workshop	Workshop	Open	

Focus Group Engagement

New Student Entry Experience

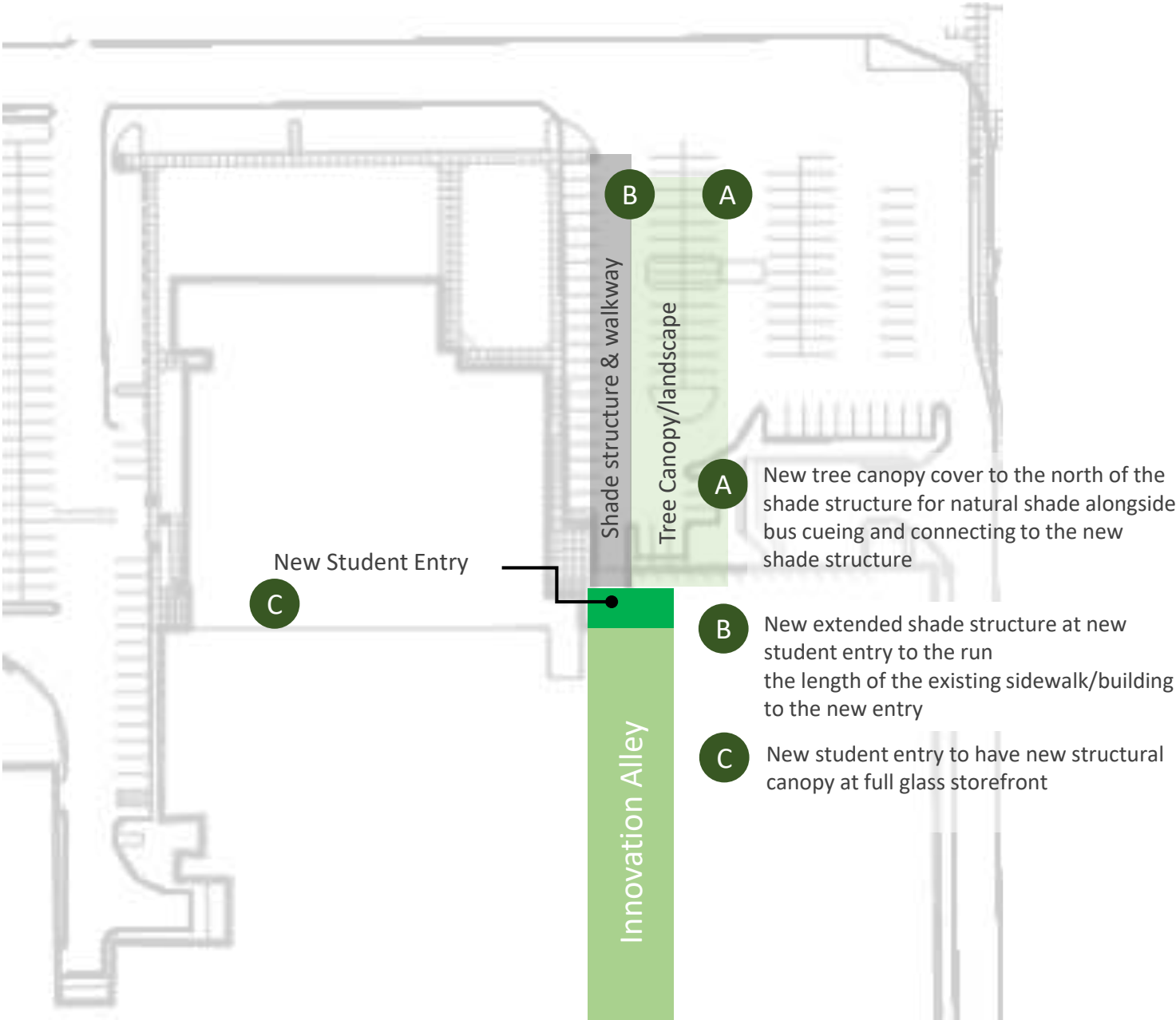

INTERMISSION



CFB – Facilities

- Integrated facilities into the learning experience
- Develop a road map that ensures continued improvement for all our facilities
- Establishes districts standards and equity amongst campuses

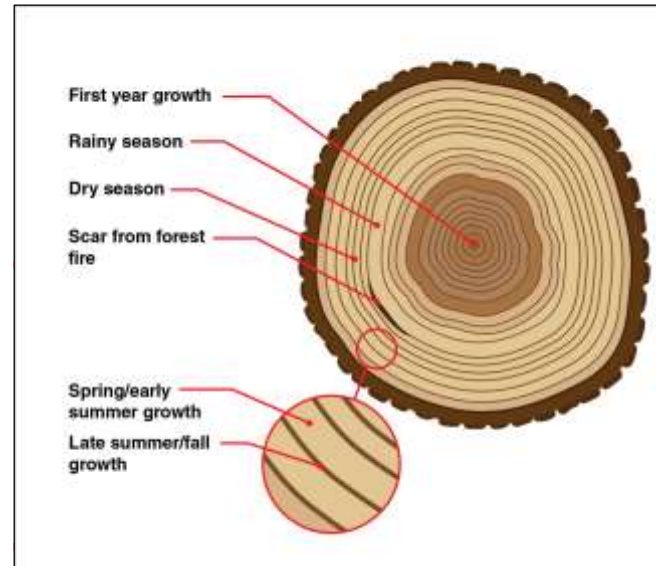

Tree rings show the impact of time

The environmental constraints and outcomes

5 Large projects:

Turner, Field, Sheffield
Smith, Perry

Recapitalize on success of new baseline to maximize rate of growth for smaller projects

**CITIZEN'S FACILITY
ADVISORY COMMITTEE**

Collaborative
VISION 2030

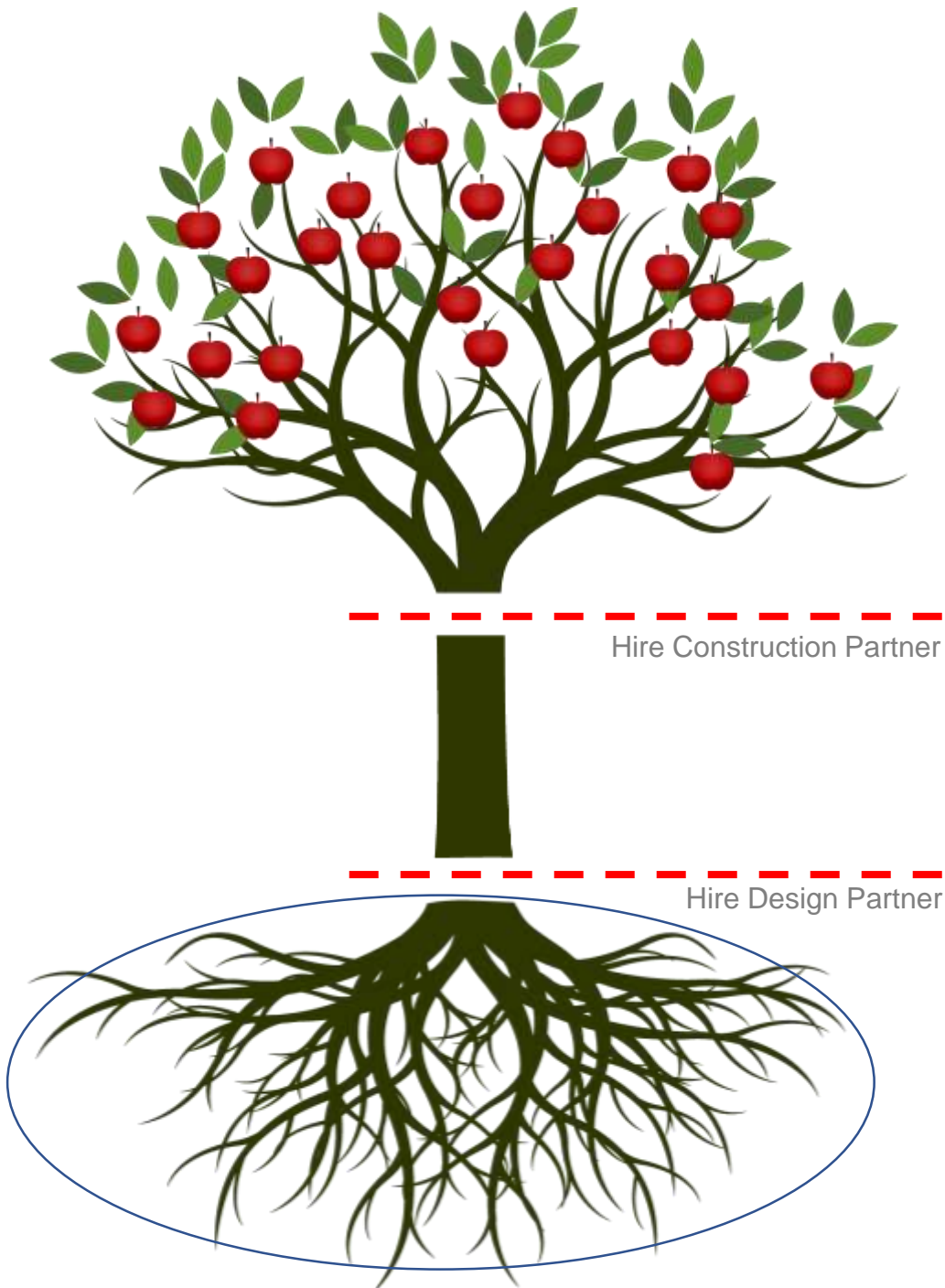

ES Program Study | 22nd Century Learning



BETTER PROCESS | BETTER RESULTS



8

DESIGN GUIDELINE WORKSHOPS

July – August 2019
Overarching Workshops to define:
Goals for 22nd Century Learning
Alignment with Future Learning Modalities
Analysis of Qualitative & Quantitative Design Guidelines
Tours with Librarians across the District

5

PROGRAM DISCUSSIONS

June – July
Understand Program compared to the Facility Condition
How well does the Facility FIT the current and future education goals



COLLABORATIVE FUTURE READY BALANCED INTERCONNECTED STUDENT-CENTERED DYNAMIC

14

BAC & CAC PRESENTATIONS

January – July 2019 6 CAC Meetings & 8 Board Meetings
June Board / BAC Workshop

1



WORKSHOP 1: **DISCOVER**

- Process Overview
- Discovery of Students
- Learning Modalities
- Learning Space Journey

2



WORKSHOP 2: **EXPLORE**

- Our Students Are...
- Instructional Shifts
- Experience Mapping
- Program Opportunity

3



WORKSHOP 3: **PERSONALIZE**

- Guiding Principles
- Student Characteristics
- Program Ed Spec
- Uniquely CFBISD

qualitative + quantitative

LEARNING NEIGHBORHOODS

SHARED CoLABS

SPACE ACTIVITIES OVERVIEW

SIZE RECOMMENDATIONS

DESIGN CONSIDERATIONS

ADJACENT TO CLASSROOMS

DIRECT ACCESS TO OUTDOOR SPACE

SPECIALS

INNOVATION SPACE

SPACE GOALS AND FUNCTION

SIZE RECOMMENDATIONS

SPATIAL ADJACENCIES

DESIGN CONSIDERATIONS

TEA (TX EDUCATION AGENCY) REQUIREMENTS

DIRECT ACCESS TO OUTDOOR SPACE

STORAGE

CONTROL

MAKER SPACE / VR

LOCATED WITHIN COLLABORATION SPACE OR LIBRARY



SPACE LIST			
LEARNING NEIGHBORHOODS	27,800 SF	ADMINISTRATION & HEALTH SERVICES	2,475 SF
K - 1st Classrooms (12) @ 800 SF ea.	9,600 SF	Secure Vestibule	200 SF
Multi-Purpose / Flex Kinder Room	800 SF	Reception	400 SF
Kinder Play Storage	100 SF	Principal Office	150 SF
2nd - 5th Classrooms (24) @ 700 SF ea.	16,800 SF	Assistant Principal	120 SF
Collaboration Flex Space (8) @ 1,200 SF ea.	9,600 SF	Conference	200 SF
Small Group Room (16) @ 100 SF ea.	1,600 SF	Webroom / Copy Room	500 SF
Professional Learning Centers (8) @ 250 SF ea.	2,000 SF	Supply Storage	80 SF
Dispersed Library Media Center (8) @ 300 SF	2,400 SF	Clinic	250 SF
Toilets (8) @ 200 SF ea.	1,600 SF	Treatment & TeleDoc Unit	80 SF
		Nurse Office	100 SF
		Nurse Triage Room & Shower	80 SF
		Records / Cust. Storage	180 SF
		Mothers Room / Quiet Room	80 SF
SPECIAL EDUCATION	7,285 SF	GUIDANCE & COUNSELING	800 SF
Special Education (Self-Contained) (4) @ 800 SF	3,200 SF	Speech	250 SF
Quiet Room	80 SF	Counselor (2) @ 150 SF ea.	300 SF
Therapy Room	125 SF	Mini We Work	250 SF
Resource Rooms / Content Mastery (2) @ 390 SF	780 SF	Behavior Specialist	100 SF
Toilets (4) @ 65 SF	260 SF	Instructional Facilitator Office	100 SF
		ESL Office	180 SF
		Diagnostician Office	100 SF
		Testing	80 SF
VISUAL ARTS	1,150 SF	COMMUNITY	870 SF
Creative Studio	900 SF	Community Room	700 SF
Kin Room	100 SF	Community Room Storage / PTA	100 SF
Storage	150 SF	Family Restroom	70 SF
PERFORMING ARTS	1,100 SF	BUILDING SUPPORT	1,760 SF
Rhythm Studio	900 SF	Electrical Rooms (4) @ 75 SF ea.	300 SF
Mus. Storage	200 SF	Rear Room (2) @ 80 SF ea.	160 SF
		Outdoor Closets (8) @ 80 SF ea.	640 SF
		Telecomms (DF) (4) @ 80 SF ea.	320 SF
		Main Telecomm MDF	300 SF
		Mus. Storage	300 SF
LIBRARY MEDIA CENTER	2,065 SF	OUTDOOR ENVIRONMENTS	
Decentralized Reading & Collection (see above)	0 SF*	Outdoor Learning	
Meeting Rooms (2) @ 300 SF ea.	600 SF	Outdoor Play Ground	
Office / Work Room	200 SF		
Innovation Lab (Maker Space, VR)	800 SF		
Innovation Lab Storage	100 SF		
TV Room - Broadcast	100 SF		
Redroom	85 SF		
Book Room / Library Library	300 SF		
GYMNASIUM	5,965 SF		
Gym	4,800 SF		
Indoor / Outdoor Storage	300 SF		
Community Storage	100 SF		
Afterschool Storage	100 SF		
Office	100 SF		
Staff Shower / Locker / Toilet	140 SF		
Storm Shelter Control Room	175 SF		
Restrooms	250 SF		
FOOD SERVICES	8,850 SF		
Dining Commons	4,250 SF		
Stage / Platform	800 SF		
Chair Storage	250 SF		
Stage Storage	100 SF		
Restrooms	250 SF		
Kitchen	2,500 SF		
Demo Kitchen (detached from main dining commons)	0 SF		



Existing ES Site Visits



19 Campus Walks

Elementary School Educational Suitability | Program Study

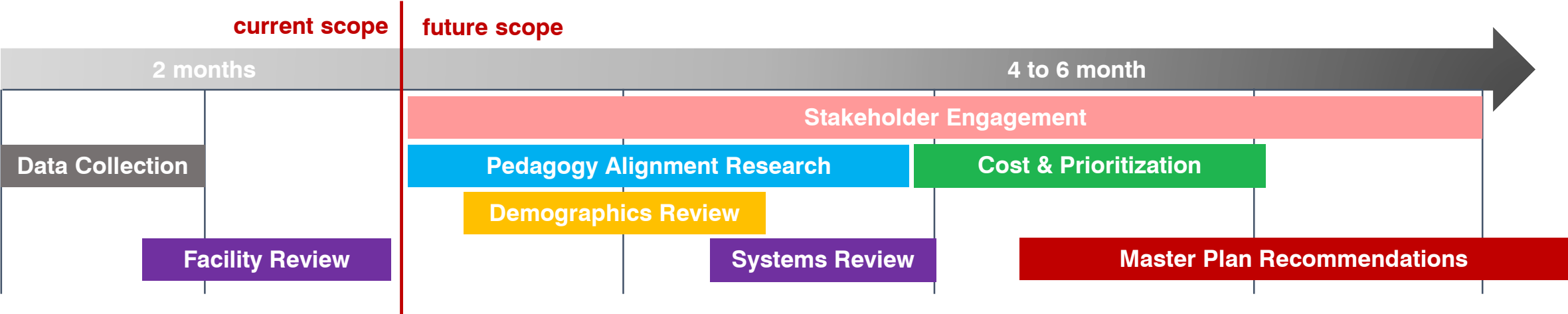

Data Collection

- Obtain Enrollment Data
- As-Built(s) Collection
- Program/Space Ratios
- Record Dwg Scanning

Facility Review

- First Stage Site Survey
- Condition Evaluation
- Spatial Verification
- Plan Modeling or PDF Overlay

Pedagogy Alignment Assessment

- Campus Walk
- Alignment with Guiding Principals
- Program Analysis
- Alignment with Ed Spec
- Conceptual Program Overlay

Systems Review

- MEP & T Survey w/ Engineers & Key Facilities Personnel
- Roofing Survey
- Others TBD

Demographics Overlay

- Existing Utilization
- Site Capacity
- Enrollment Trends
- Student Loading Standards

Master Plan Recommendations

- Alignment with Funding
- Development and Review of FMP Booklet
- Presentations

High School Visioning

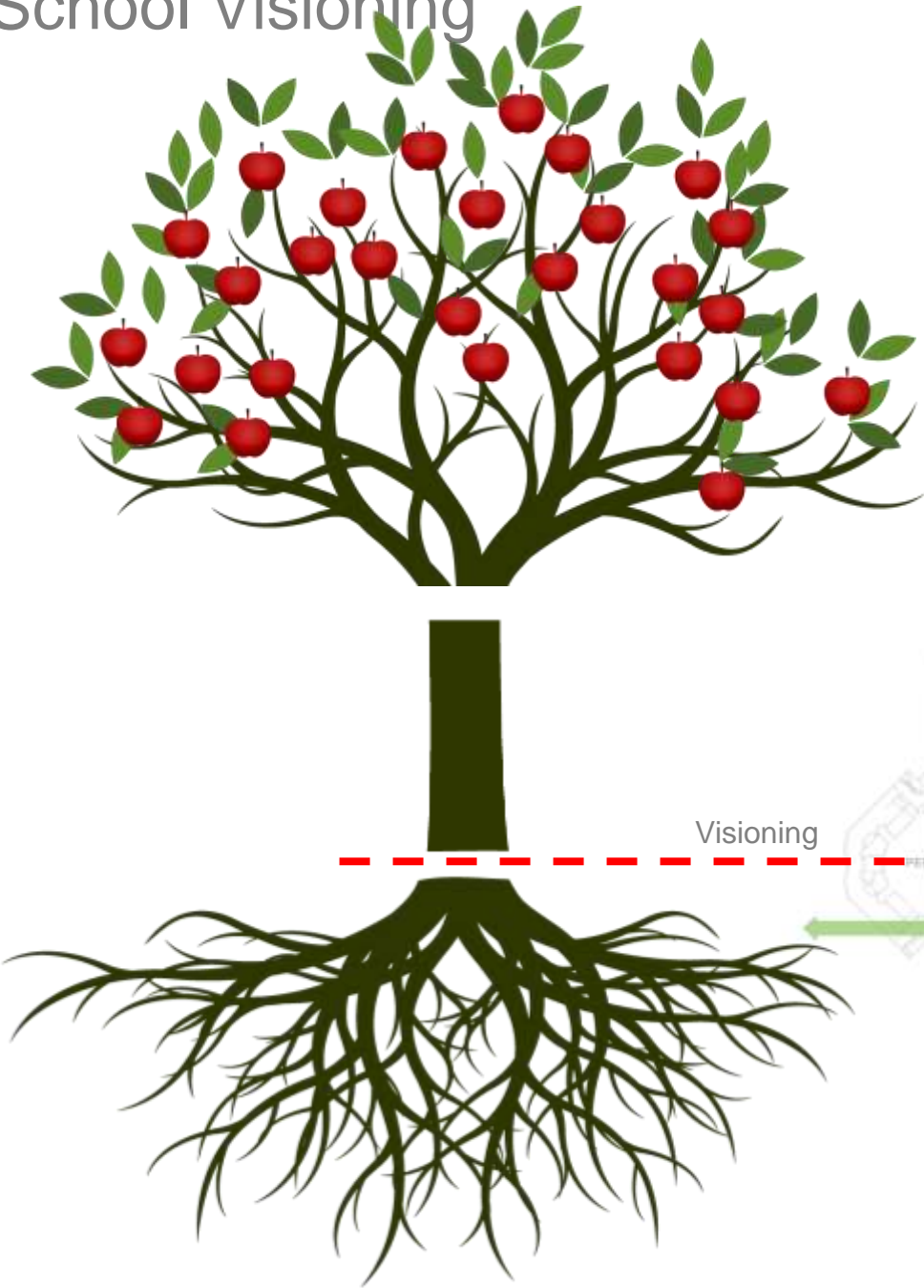

HIGH SCHOOL VISIONING

- LPA – Student and Facility Study
- Meeting with HS Principal
- Meeting with CTE and P-Tech
- One on One with each of the Principals
- Group Follow up Meetings

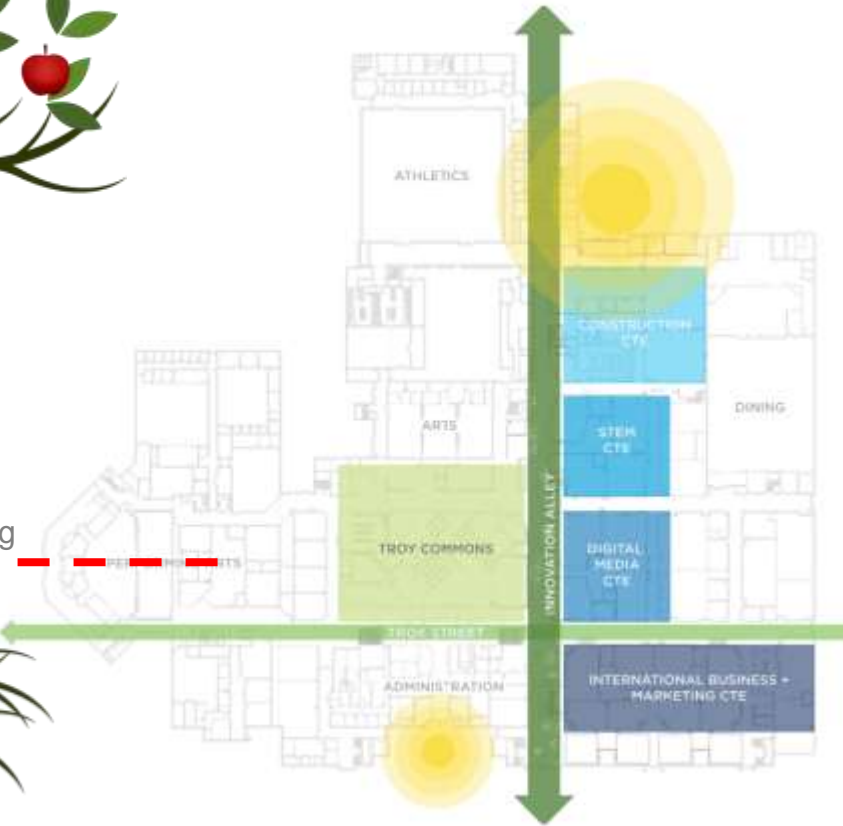

Smith HS – Grand Vision



Turner HS – Grand Vision

SCHOLAR PARTICIPANTS	94
EDUCATOR PARTICIPANTS	59

SCHOLAR PARTICIPANTS	66
EDUCATOR PARTICIPANTS	28

SCHOLAR PARTICIPANTS	139
EDUCATOR PARTICIPANTS	34

Q8

Customize Save as

What social and common spaces do you frequently use at school? This might be for before or after school activities, club activities, to study, to meet with friends, etc.

Answered: 66 Skipped: 0

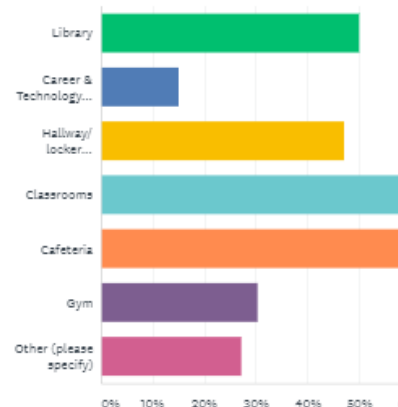

ANSWER CHOICES

- Library
- Career & Technology Education spaces
- Hallway/locker corridors
- Classrooms
- Cafeteria
- Gym
- Other (please specify)

Total Respondents: 66

Q12

Customize Save as

From your perspective, which CTE program is in most need of facility improvements to support academic goals?

Answered: 39 Skipped: 20

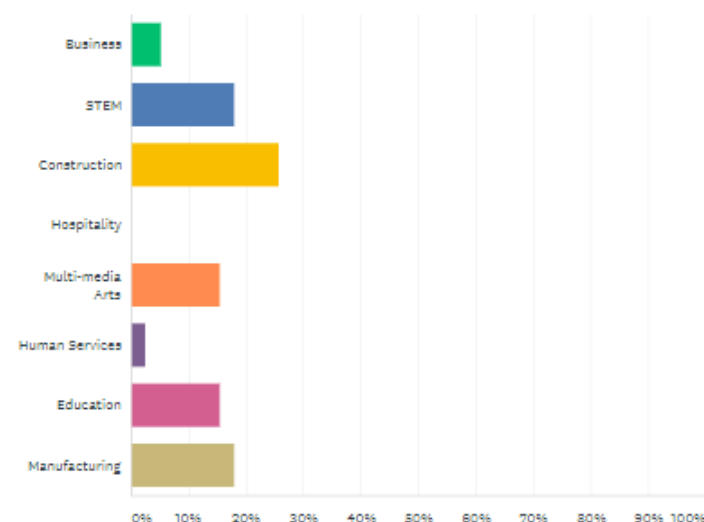

ANSWER CHOICES

ANSWER CHOICES	RESPONSES
Business	5.13% 2
STEM	17.95% 7
Construction	25.64% 10
Hospitality	0.00% 0
Multi-media Arts	15.38% 6
Human Services	2.56% 1
Education	15.38% 6
Manufacturing	17.95% 7

Educator Survey Findings

participant demographics

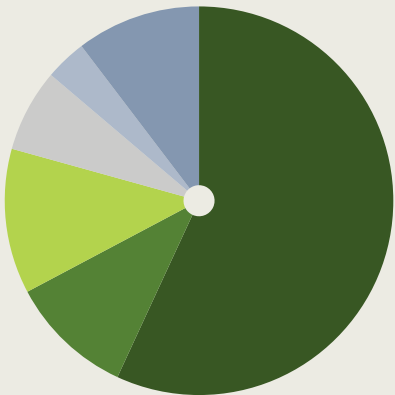

- Classroom / Science
- Fine Arts
- Career Tech Education
- Athletics
- Special Education
- Aid/Counseling/Coordinator

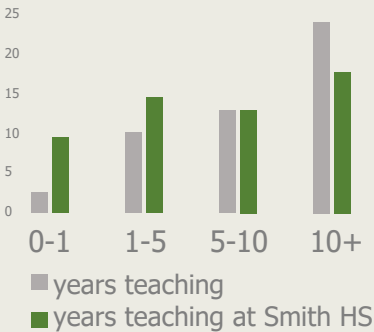

Eyes wide open
towards the future &
realistic about the
outdated facilities

88% of educators surveyed significantly agree that that the **quality of the learning space impacts the learning environment**

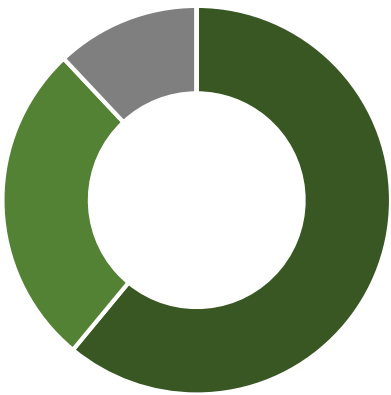

- 61% Strongly Agree
- 27% Agree
- 12% Somewhat Agree
- 0% Somewhat Disagree
- 0% Disagree
- 0% Strongly Disagree

High School students are more engaged when space is designed to support their learning



Learning spaces designed to support student-centered and collaborative approaches have a positive and significant effect on how students view their learning experience and level of engagement.

Learning spaces that utilize flexible furniture, the integration of digital and visual technologies, and multiple teaching and learning focal points were linked to improved student academic performance.

Byers, Imms & Young (2014). *Making the Case for Space: The Effect of Learning Spaces on Teaching and Learning*. In Curriculum and Teaching.

WHAT IS NEXT?

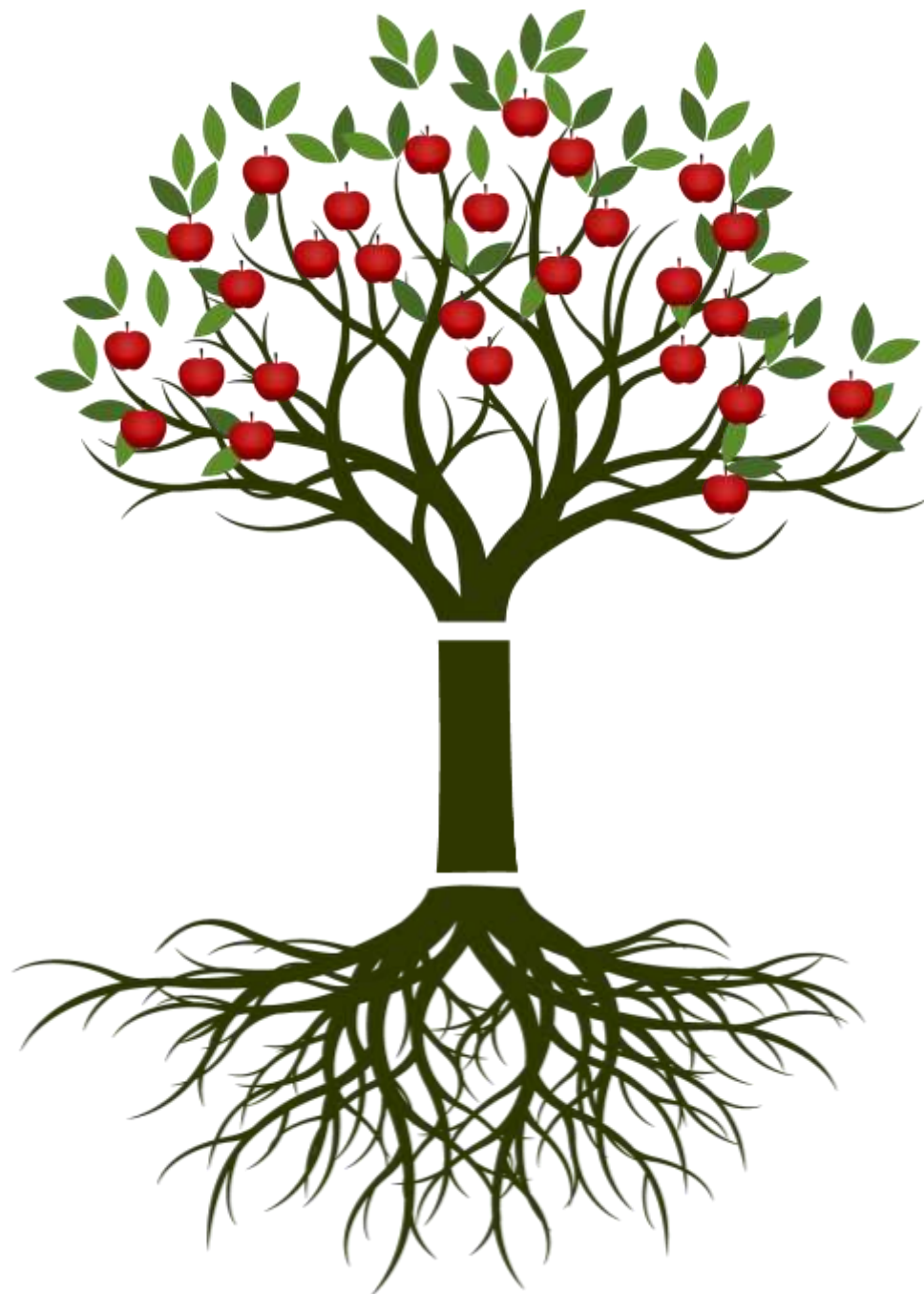

SYSTEMS WORK SECURITY

- BOLLARDS, IMPACT HARDENING, IMPACT RESISTANT HARDENING, STOREFRONT

SITE

- PARKING LOT IMPROVEMENTS, PLAYGROUND REPAIR, LANDSCAPING

SIGNAGE

- MARQUEES – 21 UPCOMING LOCATIONS

ROOFING

- ROOFING – 11 UPCOMING LOCATIONS

FINISHES

- LIMITED FINISH REFRESH – 25 UPCOMING LOCATIONS
- COLLABORATION / MAKER SPACES
- CTE RENOVATION

SYSTEMS

- FIRE ALARM – 15 UPCOMING LOCATIONS
- FIRE SPRINKLERS – 7 UPCOMING LOCATIONS
- MECHANICAL – 20 UPCOMING LOCATIONS
- ELECTRICAL – 25 UPCOMING LOCATIONS
- PLUMBING – 24 UPCOMING LOCATIONS
- SOUND / THEATRE EQUIPMENT

TECHNOLOGY

- ACCESS CONTROLS – 29 UPCOMING LOCATIONS
- PA / BELL / CLOCK – 28 UPCOMING LOCATIONS
- PHONE SYSTEM – 26 UPCOMING LOCATIONS
- STRUCTURED CABLING – 27 UPCOMING LOCATIONS
- STRUCTURED CABLING – 27 UPCOMING LOCATIONS
- VIDEO SURVEILLANCE – 28 UPCOMING LOCATIONS
- WIRELESS UPGRADES – 28 UPCOMING LOCATIONS

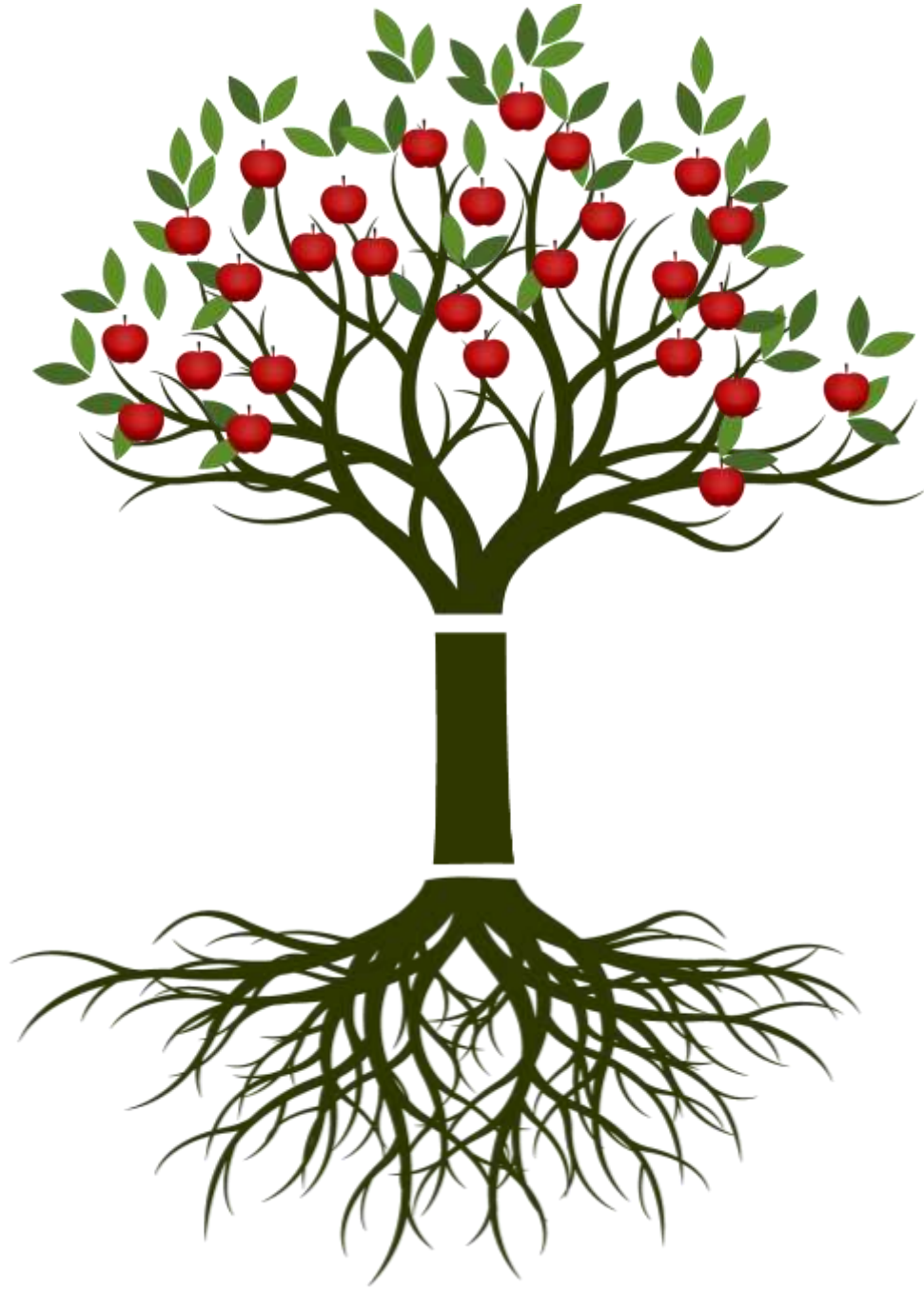



 **CARROLLTON-FARMERS BRANCH ISD**
cfb HIGH EXPECTATIONS FOR ALL

HUCKABEE + JACKSON CONSTRUCTION



THANK YOU!

VLK|ARCHITECTS

 **CARROLLTON-FARMERS BRANCH ISD**
cfb HIGH EXPECTATIONS FOR ALL



Changing Lives by Design™

THANK YOU

