

NHCS - Bring Your Own Device MacBook Instructions

Screenshots taken using Catalina 10.15.5

Step 1) Click the **Wifi icon** at the top of your Mac Menu Bar

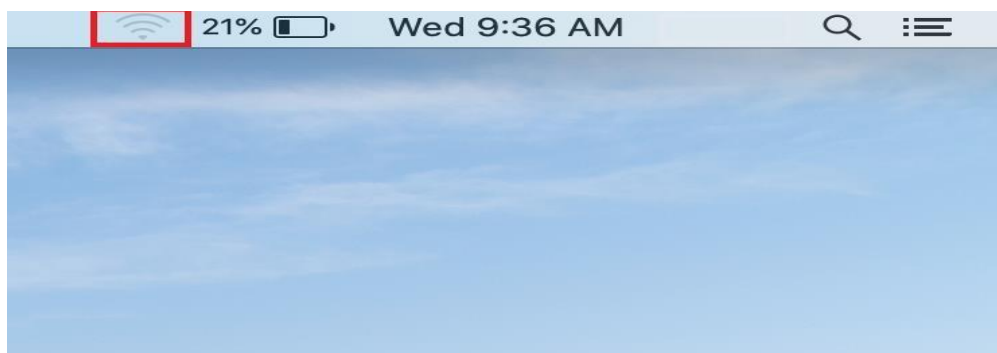

Step 2) Select Join_NHCS_Personal

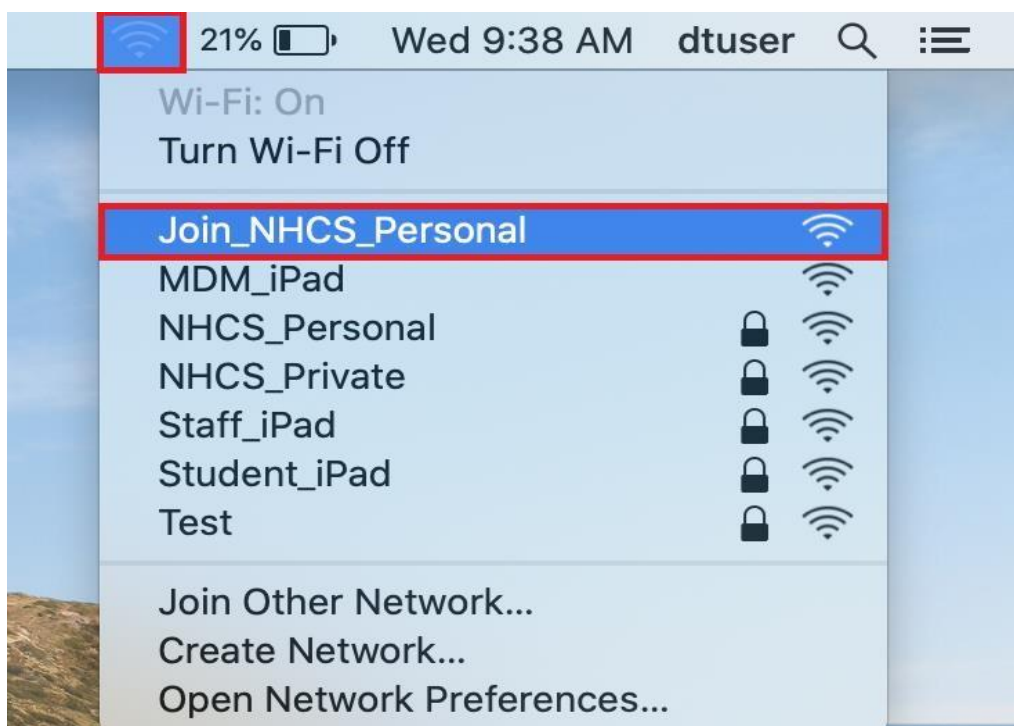

NHCS - Bring Your Own Device

MacBook Instructions

Step 3) Open **Safari** and go to a non-encrypted website such as **neverssl.com**

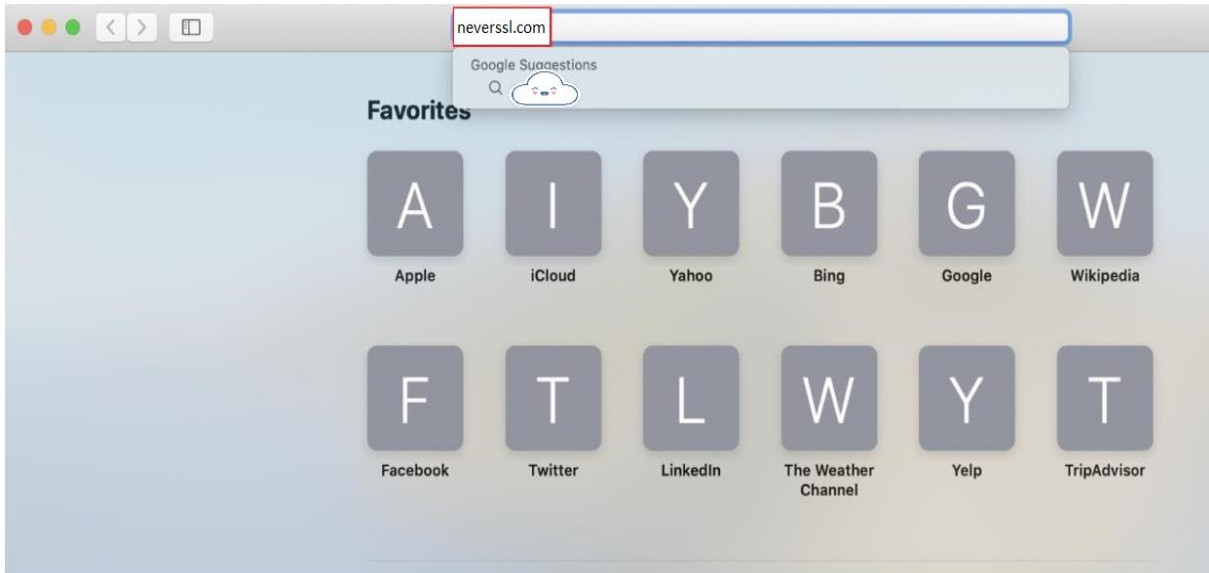

Step 4) You will be redirected to the portal, Login using your **NHCS Username and NHCS Password**

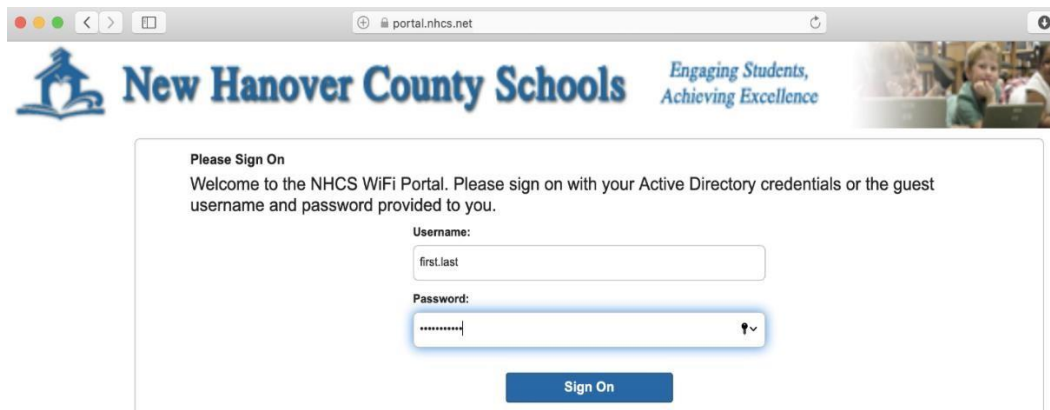

NHCS - Bring Your Own Device MacBook Instructions

Step 5) Click 'Install Certificate' to download the certificate, then Click Done
DO NOT CLICK THE BLUE BUTTON

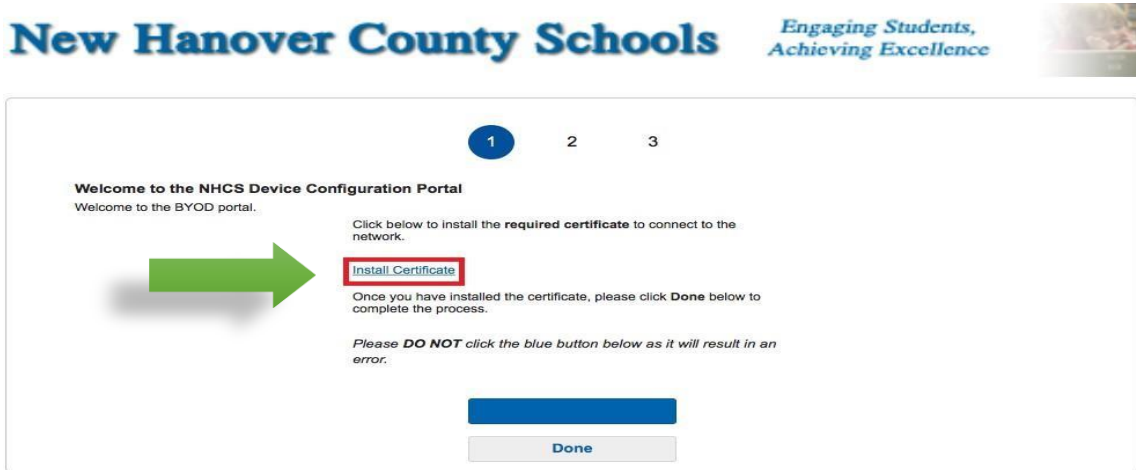

Step 6) Click Finish



Step 7) Click on the Certificate in the downloaded files

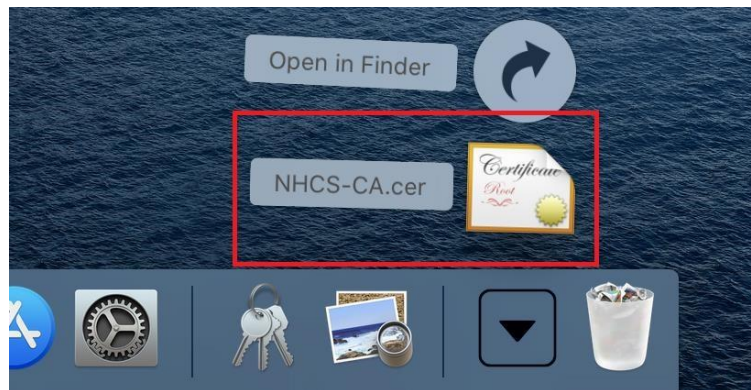

NHCS - Bring Your Own Device

MacBook Instructions

Step 8) Click on the **Keychain Icon** to open the Certificate Manager



Step 9) Double click on **nhcs-CERT-CA**, which is located in the **login** Keychain on the left hand side under **Certificates**.

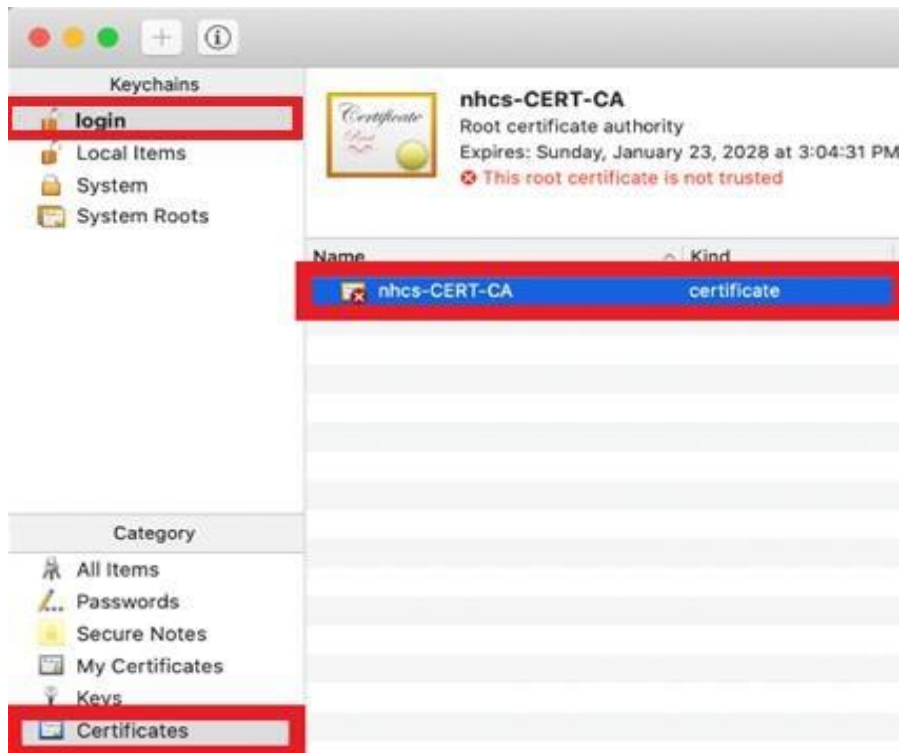

NHCS - Bring Your Own Device

MacBook Instructions

Step 10) Click the **triangle next to Trust** to expand its properties, then select **Always Trust** “When using this certificate”, then **click the Red dot to exit**.



Step 11) You will be prompted to login with your **MacBook Username and Password**



NHCS - Bring Your Own Device

MacBook Instructions

Step 12) Note the mark next to the cert is now a **Blue Plus Sign** instead of Red X

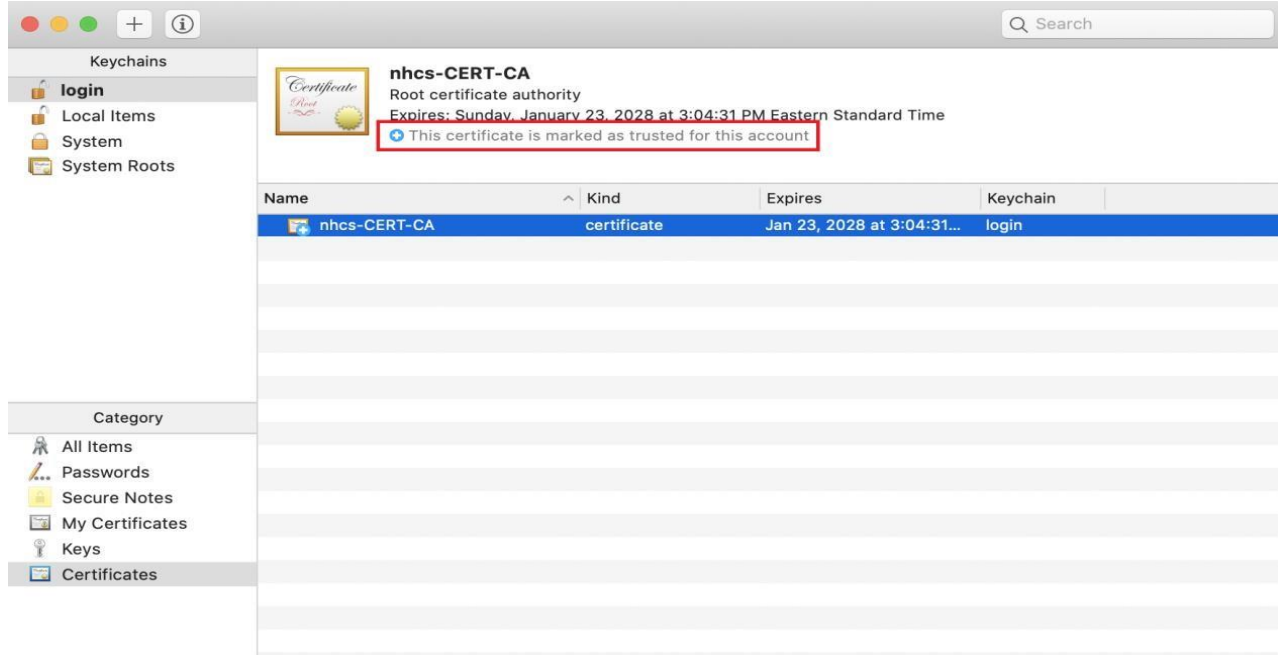

Step 13) Click on the **WiFi** Icon again and click '**Open Network Preferences**'



NHCS - Bring Your Own Device

MacBook Instructions

Step 14) Click on 'Advanced'

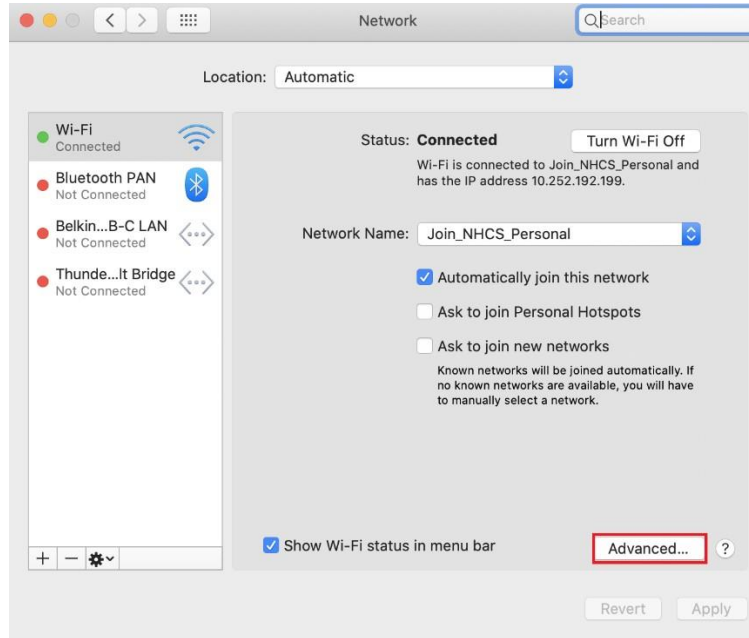

Step 15) Under the **Wi-Fi** tab find **Join_NHCS_Personal** and click the **Minus [-]** button to remove this network from your computer and to prevent it from auto-rejoining by accident.

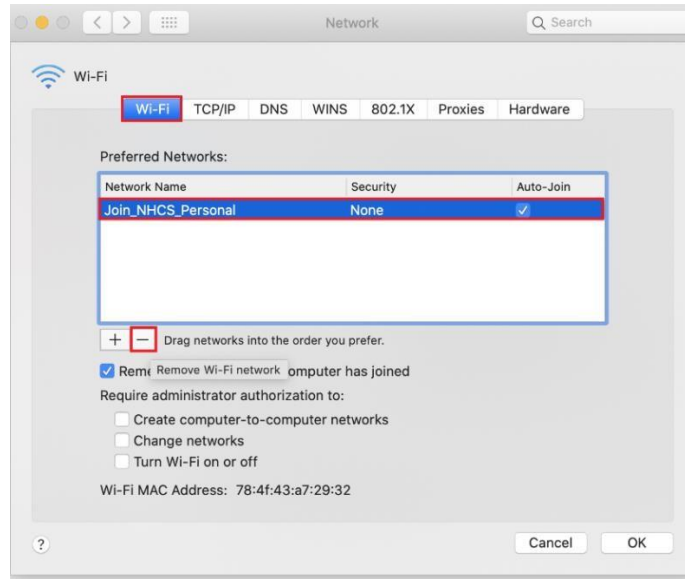

NHCS - Bring Your Own Device

MacBook Instructions

Step 16) Click the **WiFi** Icon again on the Mac Menu Bar and select **NHCS_Personal**



Step 17) Enter your **NHCS Username** and **NHCS Password**

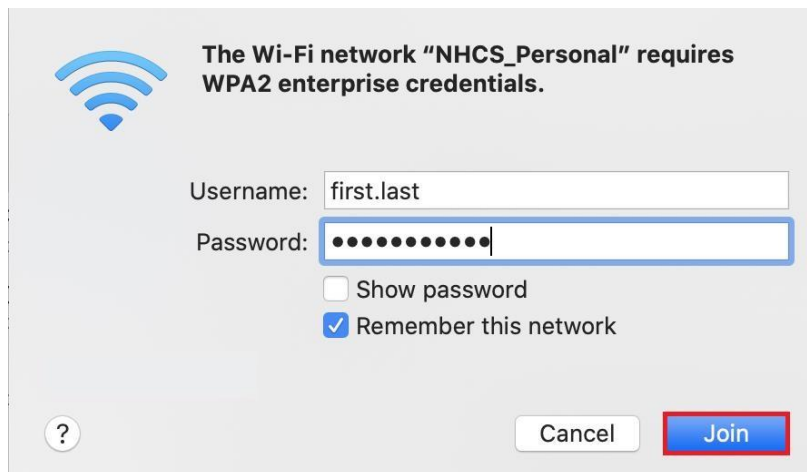

NHCS - Bring Your Own Device

MacBook Instructions

Step 18) Verify you are connected by clicking on the **WiFi** Icon again and click **Open Network Preferences** make sure it says **Authenticated** at the bottom of the network window.

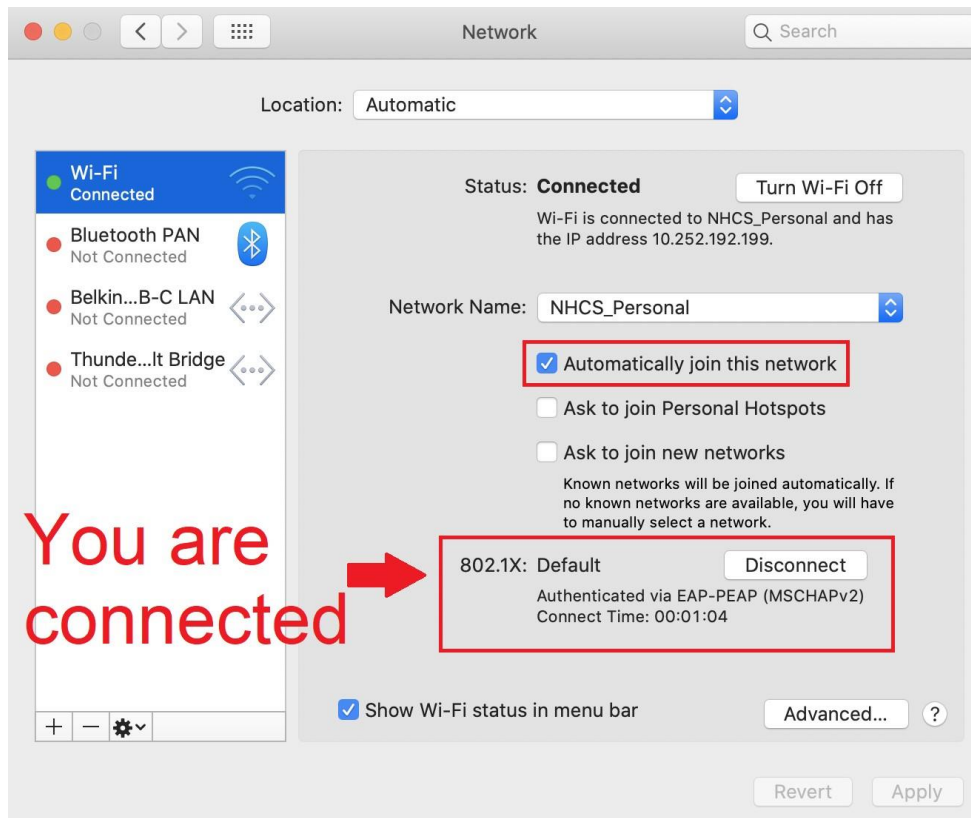

You are
connected