

"Virtual" PAT Mtg #6 Presentation | Introduction / Overview



Spring Branch ISD

- Travis Stanford
- Kris Drosche
- Noel Moreno
- Dana Johnson



Stantec Architects

- Jennifer Henrikson
- Tracy Eich
- Gretchen Diesel
- Gary Dunn



Welcome to the "Virtual PAT Mtg #6"!

We are still not able to meet as a group to present at the scheduled PAT Mtg #6.

Feedback from the PAT is valuable to the continued refinement of the design; therefore, we have created the "Virtual PAT Mtg #6" to communicate the design development and seek your individual feedback.

The objective of the "Virtual PAT Mtg #6" presentation is to:

1. Clarify some design questions on the site plan + floor plans.

We reviewed your PAT Mtg#4/5 feedback and would like to provide some clarification information to some questions raised by the PAT in the web survey.

2. Seek your individual feedback on a few specific questions relating to the 3D images of interior design development for the new Bunker Hill ES.

We want to confirm with the PAT that we are heading in the right direction.

We have provided a hyperlink + QR code to a digital survey to collect individual feedback.

We are asking that you submit your survey response before end of day May 20th.

We hope you stay engaged in the design process for the new BHE!

We know this would be much easier to accomplish if we were in the same room to discuss with each other.

We appreciate your participation in Virtual PAT Mtg #6.

We look forward to the next time we can meet in person!



May 12, 2020

Spring Branch ISD
Bunker Hill Elementary

Project Advisory Team Meeting #6 (Virtual Presentation)





RECAP

Meeting Agenda:

1. **PAT Process / PAT Mtg #1 thru Mtg #4/5 Recap**
PAT Charge
PAT Engagement Process Overview
PAT Design Vision + Educational Vision + Guiding Principles
PAT Mtg #4/5 = PAT Voting Results: Preliminary Exterior Design
2. **PAT Mtg #6 Focus:** Review Current Status of BHE Design
PAT Information = Site + Floor Plan Clarifications
PAT Engagement = 3D Interior Images + Individual Input*
* *Weblink to PAT Individual Input Survey*
3. **Next PAT = TBD** (Virtual Mtg?)

BHE Project Advisory Team (PAT) – Charge

OVERVIEW

A Project Advisory Team (PAT) will be chartered for the planning of a replacement for **Bunker Hill Elementary School** under the school's project in the 2017 Bond Program.

CHARGE

The PAT will work collaboratively and cooperatively with the architect and SBISD Project Manager **to conceptualize, develop and refine the project's goals and design.**

The PAT will advise on recommendations regarding the planning and development of the replacement of Bunker Hill Elementary School.

These recommendations will be presented by the project's architects:

- 1) to the **Superintendent of Schools**, and based on approval from the Superintendent,
- 2) to the **Board of Trustees** for their approval.

The Board of Trustees may act upon the recommendations developed with PAT input by approving, amending, altering or not approving all or any part of the recommendations.

PAT Engagement: Process Overview

January 2020

- 1 Site Influences
- 2 Program Space Types
- 3 Functional Relationships
- 4 Space Type Attributes
- 5 Architectural Expression

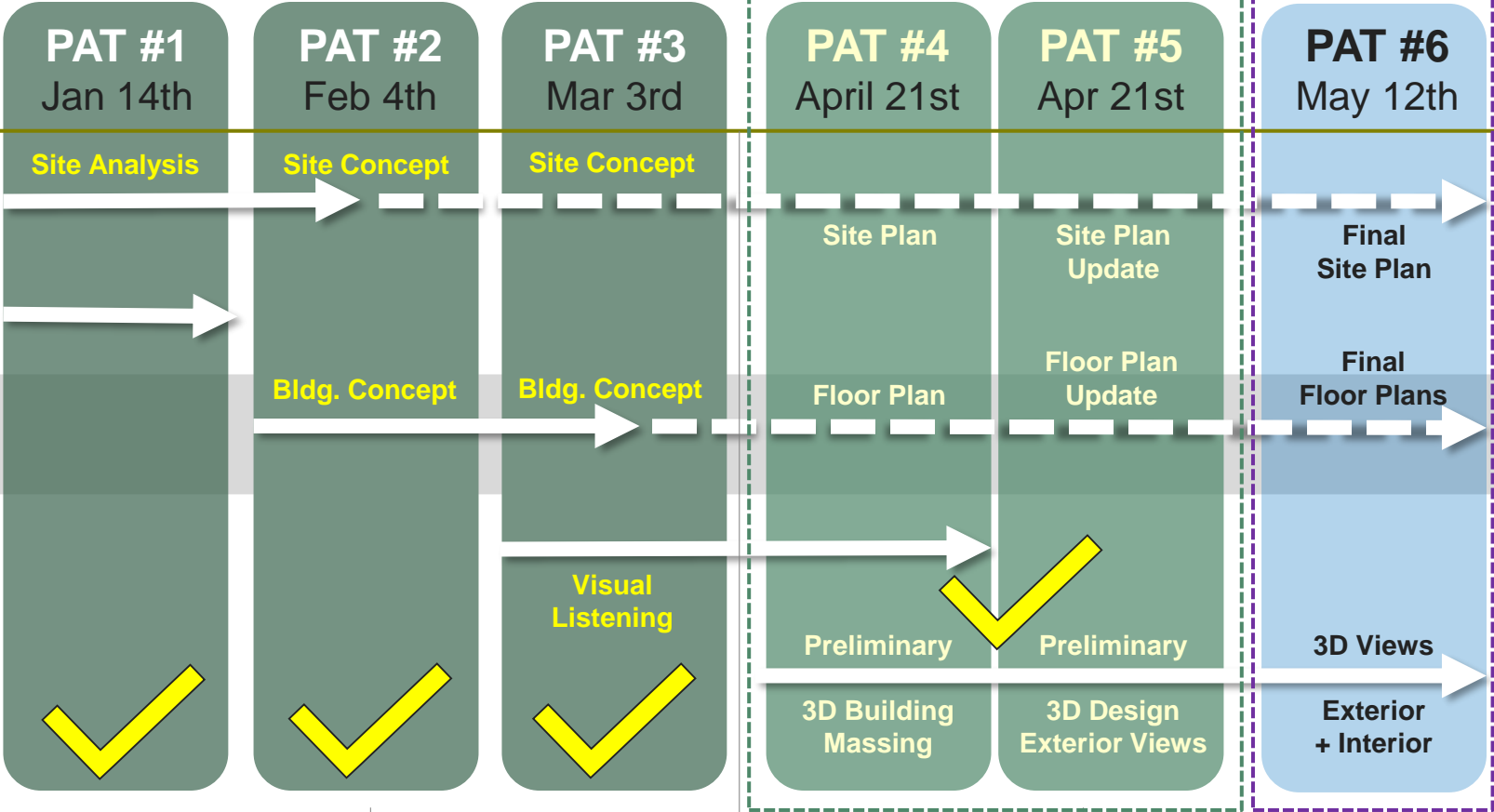

CONCEPTUALIZE

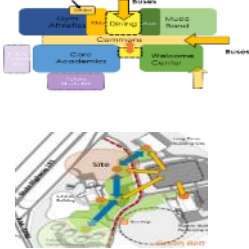

EXPLORE

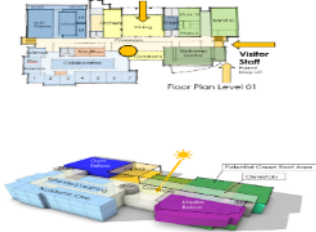

DEVELOP



REFINE



“Virtual” Meeting (4/21)

“Virtual” Meeting

PAT Consensus

May 2020

BHE Personality / Character

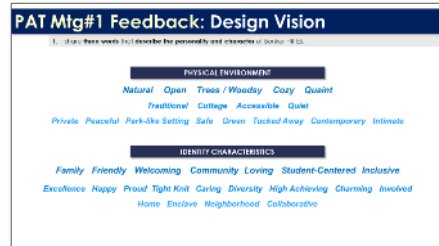

What makes BHE unique



Existing: Favorite/Least Favorite



Bunker Hill ES | Design Vision

Common Themes from PAT:

- Community Oriented / Sense of Closeness
- Embedded in Neighborhood
- Access to Outdoor Learning
- Student Centered / Inclusive
- Natural / Open / Trees / Woodsy
- Welcoming / Family / Friendly

Support Student/Community

PAT Mtg#1 Feedback: Educational Vision		
1. Describe how the building can help support both Student engagement and Community activities.		
FLEXIBILITY Larger and more flexible meeting, learning and work areas Spaces that fit evening programs, performances and community activities Ability to open up public spaces from evening community Spaces with room to work and store Show classrooms / better access	LEARNING ENVIRONMENT Incorporate access to outdoor learning opportunities Library at center of instructional spaces Dedicated areas where students are focused as move about freely Spaces for special learning activities	PHYSICAL ENVIRONMENT Taking advantage of natural environment as an asset More Parking Use of Natural Lighting Well-being Environment

21st Century Learning Environment

PAT Mtg#1 Feedback: Educational Vision		
2. How does the building help create a modern 21st Century teaching & learning environment? How does it support and enhance academic programs?		
LEARNING ENVIRONMENT Technology: Access to / Use of / Adaptable Flexible collaborative spaces for meeting and learning (meeting classrooms) Practical and instructive Platform Equipment advances for their area that encourage learning the process Library at center of instructional spaces Labs with new world applications / environments for future skill sets Dedicated Gifted/Talented space	PHYSICAL ENVIRONMENT Ample Natural Light / Views to Exterior Safety Energy efficient / climate focused "Creative movement" - Creative thought	FLEXIBILITY Flexibility Forward Looking COMMUNITY Conducive for Parent Involvement Building Community

Teaching and Learning

PAT Mtg#1 Feedback: Educational Vision		
3. Describe how teaching and learning have changed at Bunker Hill Community Center to 2025.		
TEACHING STRATEGIES Collaborative Teaching and Learning Observation (not teacher focused to Student focused) Movement from 20's to Thinking Skills More hands on / individualized instructional Approach Team teaching Using evidence into the classroom	TECHNOLOGY Open-changing technology / growth of personal technology Information Availability Science Lab / Edspace/Advances COMMUNITY Safety and Security Design/Architecture More access + better student body	PHYSICAL ENVIRONMENT Classroom spaces / instructional areas use small and large group instruction "No longer 'Choose' - 'Choose'" Open classroom Diverse / Inclusive/Equitable

Bunker Hill ES | Educational Vision Common Themes from PAT:

- Library at Center of Instruction
- Natural Light / Views to Exterior
- Flexible / Collaborative Spaces
- Access to Outdoor Learning
- Safe Environment / Student Movement
- Student Focused / Build Thinking Skills

Bunker Hill ES | Guiding Principles **Design Objectives from PAT:**

- 1. Open and Welcoming feeling.**
Inviting to and inclusive of the diverse community.
- 2. Embedded within Natural setting.**
Connected with views and access to walkable neighborhood.
- 3. Student centered and Parent involved.**
Celebrating excellence, achievement and tradition.
- 4. Flexible, Collaborative and Forward Thinking.**
Responsive to Teaching and Learning objectives over time.

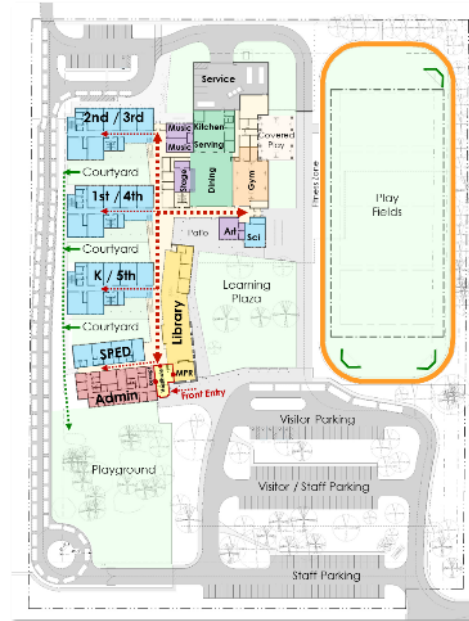

Floor Plan Update:

- We have incorporated the PAT Feedback from PAT Mtg #3 to create a “hybrid” floor plan.

- The “orthogonal” elements of the floor plan are in the Learning Communities and the Dining + Gym spaces.
- The “organic” elements are along the perimeter edge and embrace the front area of the site for the Library, Art and Science spaces with access to outdoor learning.

- a) **Learning Community Courtyards** (Intimate, Protected)
- b) **Learning Plaza** (Educational Patio, Trees, Green Space)
- c) **Outdoor Play** (Gym, Covered Play, Fields, Fitness Zone)
- d) **Playground** (Secure area near front)



Floor Plan Update

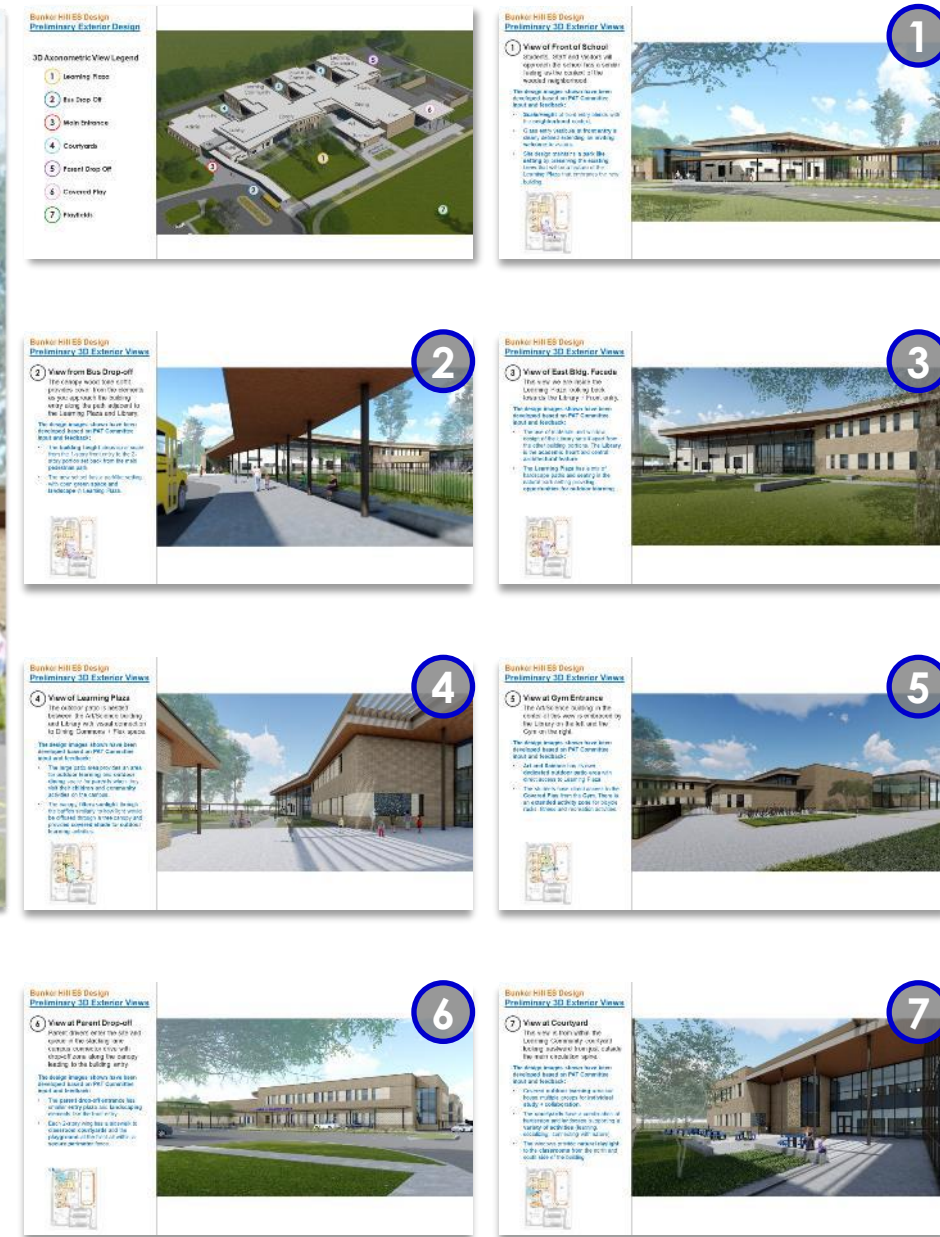

Preliminary 3D Exterior Design Views:

The design team provided preliminary 3D Views showing the Preliminary Exterior Design to seek feedback from the PAT to see if they felt the design development was headed in the right direction.

Q1: Blends into site and neighborhood context?

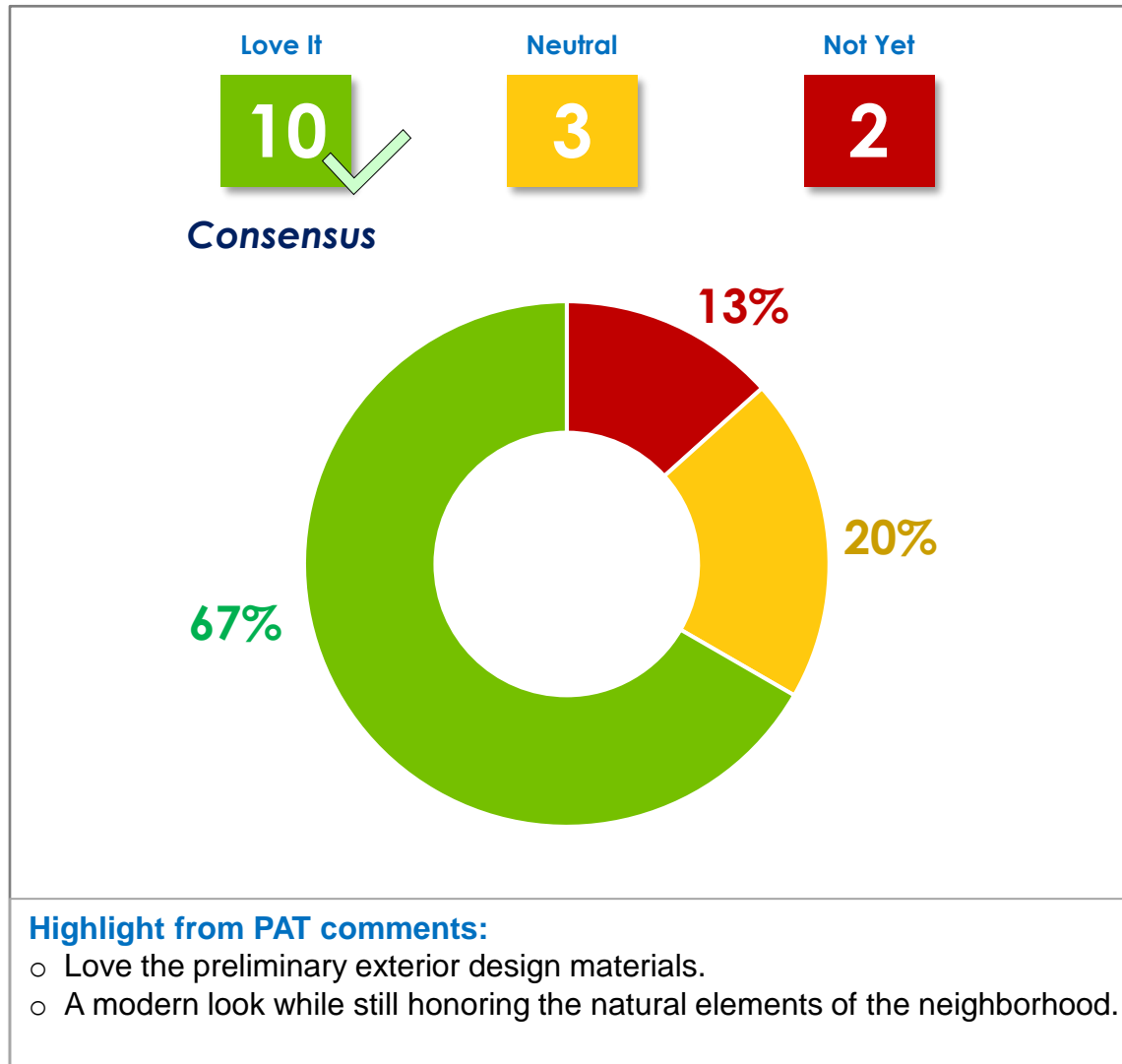

Q2: Communicates an open and welcoming feeling?

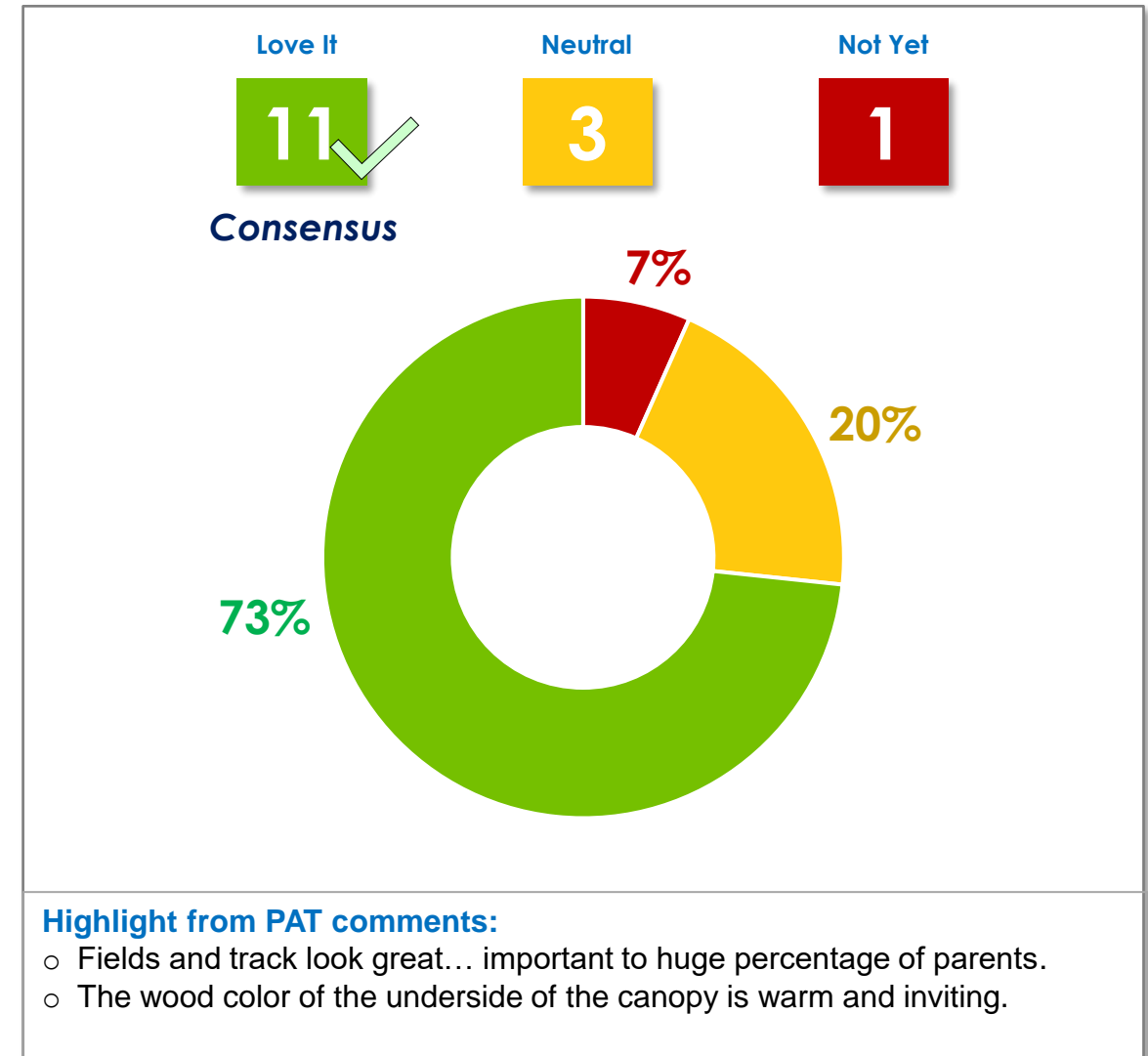

Q3: Allows ample views to exterior and natural lighting?

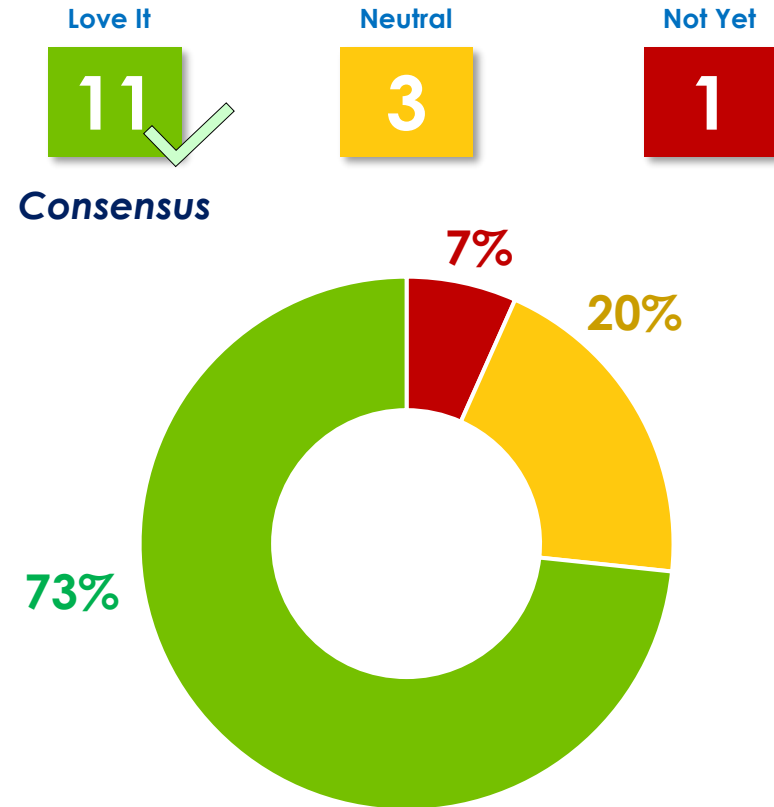

Highlight from PAT comments:

- Makes good use of windows & natural light
- The front, library, and around learning plaza views exterior are awesome.

Q4: Provides multiple outdoor learning and play spaces?

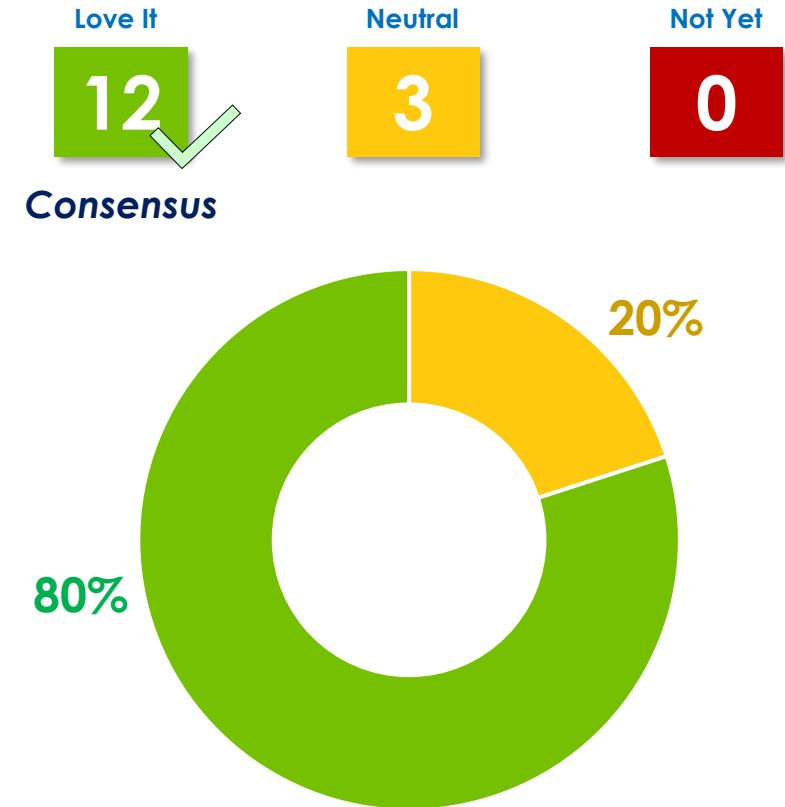

Highlight PAT comments:

- The Athletic Fields and track look great.
- I like the location of the field close to the gym and hardtop.

Comments:

Provide any additional comment you would like to share:

Positive Feedback: PAT general comments about the Design

- Really like how you **blended the organic and orthogonal elements** together. The **hybrid design** makes a better use of space.
- The design itself is a functional design that makes **good use of windows and natural light**.
The **trees** will break up the more modern aesthetic and help it to blend in.
- **Good blending of elements and styles**. It shows modern while still honoring the natural elements of the neighborhood.
- The building feels very modern for a very traditional areas... **brick choices** do soften the modern tones, and **darkened windows** will be a nice touch.
- **Great job!** Love the preliminary exterior design materials.

Need Clarification: PAT general questions about the Design

- **Looks like there are more classrooms on Floor 2:** How will a large 2nd grade class swing in enrollment be handled?
- **Bike Racks – Most of students come from the south:** 90 percent of the bike riders come from the south, only a few from the north.
- **How tall is the fence around the Learning Plaza?** 4 ft might be too low.... 6 ft would be better for safety.

NOT part of the Design / PAT Charge: PAT general comments outside of the PAT Committee Charge

- I am worried about **student enrollment growth + quantity of classrooms**
- **Add bridge access** across drainage from southwest corner at Taylorcrest



Meeting Agenda:

1. **PAT Process / PAT Mtg #1 thru Mtg #4/5 Recap**
PAT Charge
PAT Engagement Process Overview
PAT Design Vision + Educational Vision + Guiding Principles
PAT Mtg #4/5 = PAT Voting Results: Preliminary Exterior Design

NEW INFO

2. **PAT Mtg #6 Focus:** Review Current Status of BHE Design
PAT Information = Site + Floor Plan Clarifications
PAT Engagement = 3D Interior Images + Individual Input*
* *Weblink to PAT Individual Input Survey*

3. **Next PAT = TBD** (Virtual Mtg?)

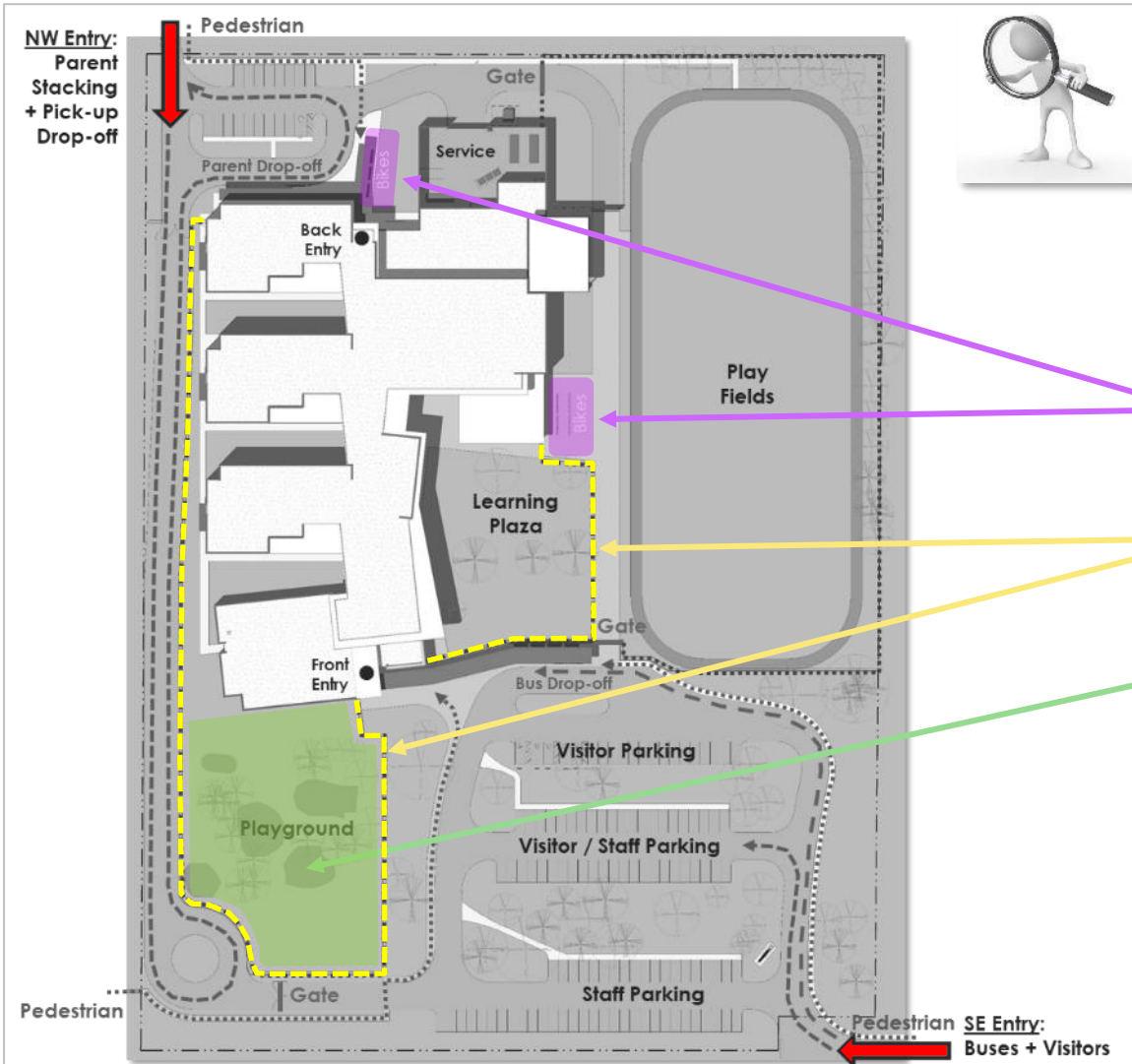

Site Plan Clarification Information:

We continue to work with SBISD on design development.

This slide provides Site Plan clarification information to PAT questions from the web survey that are within PAT Charge.

Site Plan Clarification:

- **Bike Racks:** Design provides racks for 100 Bicycles (80 near Gym + 20 at Parent Drop-off)
- **Fencing:** Learning Community perimeter fence height (6-ft tall fence per SBISD Design Standards)
- **Playground Equipment:** All new playground equipment (Qty/Type to meet SBISD Design Standards)
- **Site Access:** Existing access points to campus remain as is (Northwest Entry: Parent Cars, Stacking Lane) (Southeast Entry: Buses + Visitor Cars) (NW + SW + SE Entry: Pedestrian Sidewalks)

Site Plan Clarification

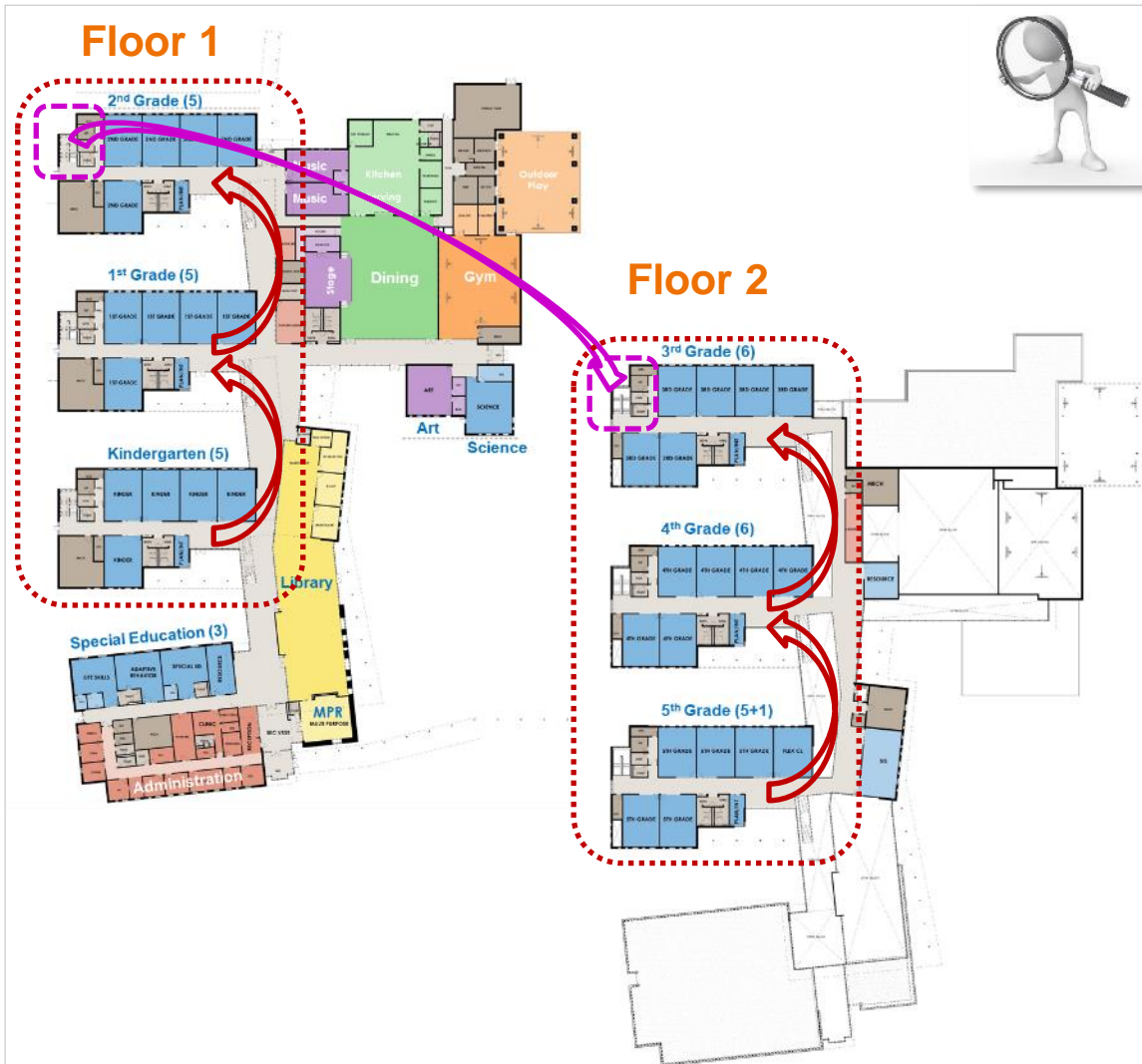

Floor Plan Clarification Information:

We continue to work with SBISD on design development.

This slide provides Site Plan clarification information to PAT questions from the web survey that are within PAT Charge.

Floor Plan Clarification on classroom quantity + location:

- **Demographics:** The District has conducted a 2020 District wide Demographic Study and BHE future enrollment predictions can be accommodated within the number of classrooms in the design.
- **Classroom Quantity:** The design provides one extra classroom than originally planned (32 + 1 flex classroom) as a result of the building design layout. This provides grade level swing space and will also accommodate any future enrollment growth.
- **Grade Level Swings:** The design provides flexibility for grade level classrooms as student enrollment adjusts over time.
 - a. Enrollment changes impacting the number of grade level classrooms can shift between wings on the same floor.
 - b. If K-2nd grade classroom quantity needed exceeds the quantity on floor 1, a 2nd grade classroom can be located on floor 2 near designated stairway for 2nd Grade students use.

Floor Plan Clarification

Bunker Hill ES Design
Preliminary Interior Design

The preliminary interior design 3D views are snapshots of the common spaces to communicate the overall design concept:

- 1 Entry Lobby / Main Corridor
- 2 Library: View to Exterior
- 3 Library: View to Interior
- 4 Learning Community / Intersection
- 5 Dining Commons



PAT Input: 3D Interior Views – Seeking PAT Feedback

PAT Individual Feedback:

Web Survey link: <https://bit.ly/2WdgVIF>

*Use the **web link** above
or **QR code** to the right
to access the Web Survey
to **provide your individual
feedback.***

**Please provide your feedback
before end of day May 20th**



We are not able to meet as a group to present and discuss the development of the new BHE Design.

The Feedback from the PAT is valuable to the continued refinement of the design; therefore, we have compiled the following slides to communicate the design concept and are seeking your individual feedback via “Microsoft Forms” weblink.

Please review the rendering images and submit your “Individual Response” to the survey questions.

Provide your feedback for the 3D Interior Views and if you support the direction the design development is going.

Preliminary Interior 3D Views

Building Shape / Forms + Interior Finish Materials shown in the following 3D images communicate the proposed interior expression of the new BHE design.

You will see how the **proposed interior finish materials** help create a new facility that **compliments and responds** to the exterior expression.

Exterior brick and stone walls **continue into the interior spaces to connect** the students and staff **with the outdoor learning environments.**

The character of the wood tones and color palette recall **organic patterns and textures of sky, water, plants and earth.**

Use of glass provides **natural daylight to the interior and views of the outdoor** park-like setting.

The playful **design of the feature wall** in the main corridor **engages the students** with the Library at the heart of the school.

Decisions made and direction set from PAT Mtgs #1 thru #3 together influenced the Interior Development of the Design you are about to see in the next group of slides.

Bunker Hill ES Design

Interior Design / Concepts



- **Inspiration** was drawn from the site and neighborhood which provide many **views through the trees**.
- The design is a hybrid solution blending **orthogonal and organic** elements.
- The **warmth and inherent visual texture** of wood softens the rigid character of the built environment.
- **Simple platonic shapes** are used to appeal to K-5 students.



Bunker Hill ES Design

Interior Design / Color Palette

The full spectrum of **accent colors** are grounded in rich neutrals. Color is used as a **wayfinding device** to identify different functional areas.



The palette echoes **colors found in nature:**
sky, water, plants and animals.

DESIGN INSPIRATION

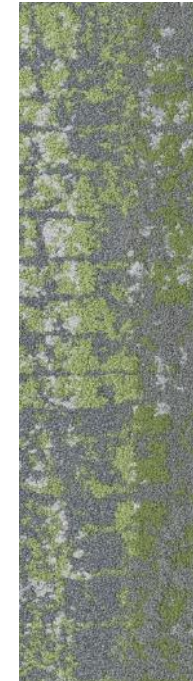
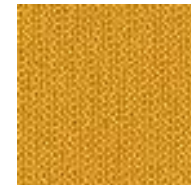
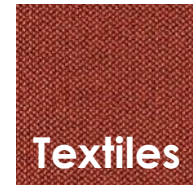
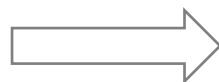

BUILT ENVIRONMENT

Bunker Hill ES Design

Interior Design / Textures and Patterns

Translucent materials **reflect light and color**.

The repetition of shapes with **subtle variation in scale and tone** create visual interest and invite exploration.



The proposed design mimics the **underlying geometry, patterns and variation** found in nature.

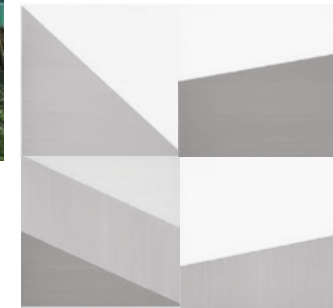

DESIGN INSPIRATION

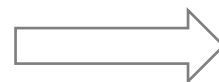

BUILT ENVIRONMENT

Bunker Hill ES Design

Preliminary Interior Design

The preliminary **interior design 3D views** are **snapshots** of the common spaces to **communicate** the **overall design concept**:

- 1 Entry Lobby / Main Corridor
- 2 Library: View to Exterior
- 3 Library: View to Interior
- 4 Learning Community / Intersection
- 5 Dining Commons

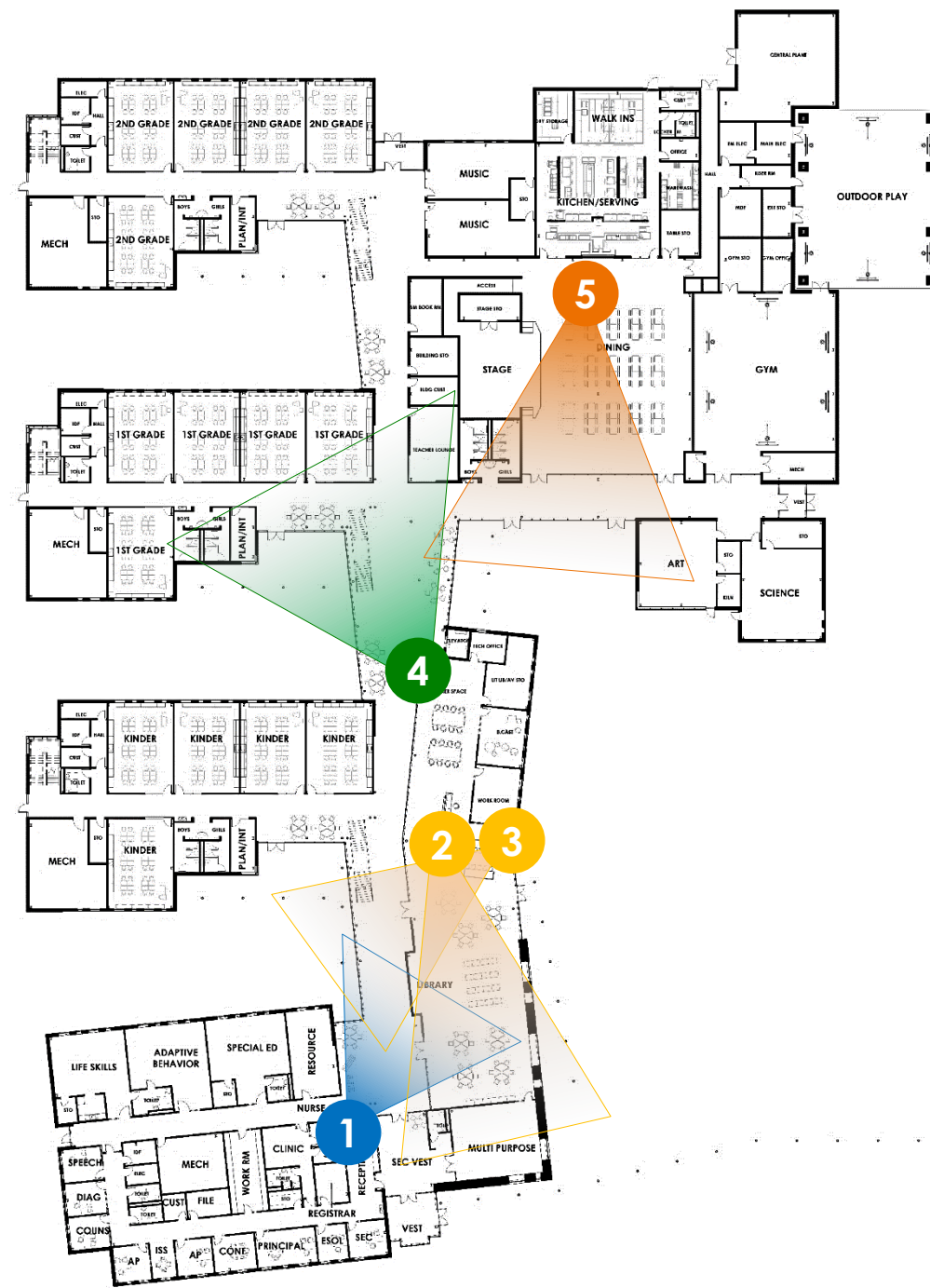

Bunker Hill ES Design

Preliminary 3D Interior Views

1 Lobby / Main Corridor

The School Lobby and Main Corridor are filled with colors found in nature organized in both orthogonal and organic patterns.

The design images shown have been developed based on PAT Committee input and feedback:

- The **artwork** over the existing school main entry is reimagined here against **BHE's school color** to reinforce the **identity** and provide **familiarity** in the new environment.
- The **colorful feature wall** provides an immediate **visual connection** to the Library. The interior **glazing provides views** through the **Library** to the **Learning Plaza**.



Bunker Hill ES Design

Preliminary 3D Interior Views

2 Library: View to Exterior

The connection to the outdoor Learning Plaza is heightened by the large glass view and exterior stone wall with reading nooks.

The design images shown have been developed based on PAT Committee input and feedback:

- **Windows** at exterior wall provide direct views to the outdoors and fills the Library with **natural daylight**.
- **Accent lighting** helps to **define** the genius bar and circulation desk as **unique destinations** within the library.
- The **warm colors** of wood and green accompanied with the **textures and patterns** of the interior finish materials reflect the **natural park like setting** of the Learning Plaza.



Bunker Hill ES Design

Preliminary 3D Interior Views

3 Library: View to Interior

The full-height feature wall provides an engaging and functional centerpiece to the library flanked by views to the Learning Communities.

The design images shown have been developed based on PAT Committee input and feedback:

- The **flexible furniture** and **genius bars** located adjacent to the circulation desk provide a **variety of individual + group spaces** within the Library.
- The large amount of **glazing provides interior views** to the two-story learning community and the learning courtyard beyond, **connecting the library** with the other educational environments.



Bunker Hill ES Design
Preliminary 3D Interior Views

4 Learning Community

Students, teachers and parents are invited to flex zones and collaborative areas along the main circulation path.

The design images shown have been developed based on PAT Committee input and feedback:

- Each **learning community** is identified by a **unique color for wayfinding**. **Vibrant colors** mimic those found in nature, plants and animals.
- **Parents** and their **students** can share lunch during inclement weather at the **collaboration zone** near the dining commons. This space is defined by **earth tones** with **organic textures and patterns** in the flooring and globe shaped **accent lighting**.



Bunker Hill ES Design

Preliminary 3D Interior Views

5 Dining Commons + Stage

The Dining Commons has a direct connection to the Learning Plaza. This large multi-purpose area provides ample space for student dining and large group assembly.

The design images shown have been developed based on PAT Committee input and feedback:

- The **angled form** of the library seen through the **two-story glazing** is traced into the cafeteria **angular shaped ceiling**, visually connecting the indoor / outdoor spaces.
- **Angled fabric wrapped panels** surround the stage to reinforce the school's geometry and **provide acoustic softening** in the large open assembly space.





Please don't forget to
provide your feedback
before end of day May 20th

PAT Individual Feedback:

Web Survey link: <https://bit.ly/2WdgVIE>

Use the *web link* above
or *QR code* to the right
to access the Web Survey
to provide your individual
feedback.

Please provide your feedback
before end of day May 20th



Meeting Agenda:

1. **PAT Process / PAT Mtg #1 thru Mtg #4/5 Recap**
PAT Charge
PAT Engagement Process Overview
PAT Design Vision + Educational Vision + Guiding Principles
PAT Mtg #4/5 = PAT Voting Results: Preliminary Exterior Design
2. **PAT Mtg #6 Focus: Review Current Status of BHE Design**
PAT Information = Site + Floor Plan Clarifications
PAT Engagement = 3D Interior Images + Individual Input*
* *Weblink to PAT Individual Input Survey*

NEXT STEP

3. **Next PAT = TBD** (Virtual Mtg?)