



March 3, 2020

Spring Branch ISD
Bunker Hill Elementary

Project Advisory Team Meeting #3





Spring Branch ISD

- **Travis Stanford**
- **Kris Drosche**
- **Dana Johnson**

Associate Superintendent for Operations
Planning & Construction Project Manager
Bunker Hill Elementary School Principal

Stantec Architects



- **Jennifer Henrikson**
- **Tracy Eich**
- **Gretchen Diesel**
- **Gary Dunn**

Principal - Architect
Principal - Architect
Sr. Associate – Interior Design
Project Manager - Architect



Meeting Agenda:

- **Introductions / PAT Charge**
PAT Process Overview
Program Summary
- **PAT Mtg #2 Recap**
Functional Relationship Diagrams (Site + Building)
Admin / Library Location Follow-up
- **PAT Mtg #3 Focus: Building Organizational Concept**
SD Preliminary Concept: Site Plan, Floor Plan
Guiding Principles for Bunker Hill Design
PAT Input on SD Preliminary Concept
- **Next PAT: March 31st / Closing Remarks**

BHE Project Advisory Team (PAT) – Charge

OVERVIEW

A Project Advisory Team (PAT) will be chartered for the planning of a replacement for **Bunker Hill Elementary School** under the school's project in the 2017 Bond Program.

CHARGE

The PAT will work collaboratively and cooperatively with the architect and SBISD Project Manager **to conceptualize, develop and refine the project's goals and design.**

The PAT will advise on recommendations regarding the planning and development of the replacement of Bunker Hill Elementary School.

These recommendations will be presented by the project's architects:

- 1) to the **Superintendent of Schools**, and based on approval from the Superintendent,
- 2) to the **Board of Trustees** for their approval.

The Board of Trustees may act upon the recommendations developed with PAT input by approving, amending, altering or not approving all or any part of the recommendations.

PAT Engagement: Process Overview

January 2020

- 1 Site Influences
- 2 Program Space Types
- 3 Functional Relationships
- 4 Space Type Attributes
- 5 Architectural Expression

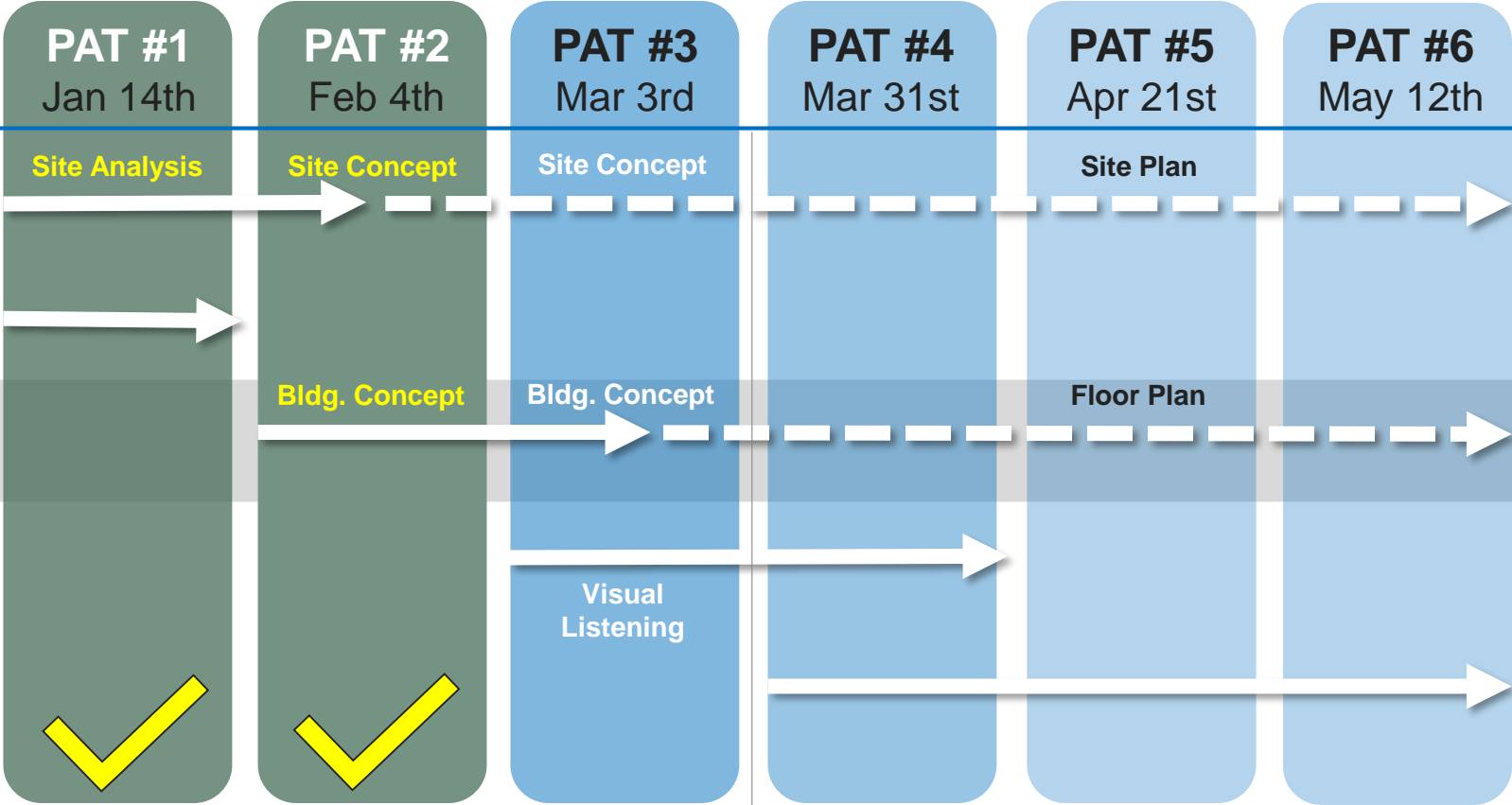

PAT Consensus
May 2020

CONCEPTUALIZE

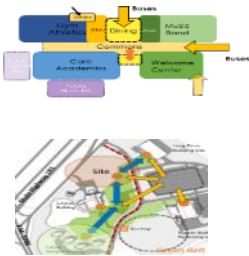

EXPLORE

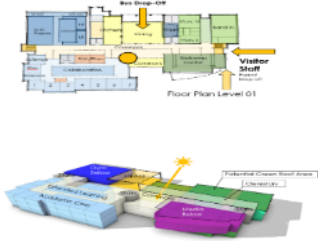

DEVELOP



REFINE



CONCEPTUALIZE



DEVELOP





Meeting Agenda:

- **Introductions / PAT Charge**
PAT Process Overview
Program Summary
- ▶ • **PAT Mtg #2 Recap**
Functional Relationship Diagrams (Site + Building)
Admin / Library Location Follow-up
- **PAT Mtg #3 Focus: Building Organizational Concept**
SD Preliminary Concept: Site Plan, Floor Plan
Guiding Principles for Bunker Hill Design
PAT Input on SD Preliminary Concept
- **Next PAT: March 31st / Closing Remarks**

PAT Mtg #1: PAT Feedback → Design Vision

BHE Personality / Character

PAT Mtg#1 Feedback: Design Vision

1. Share three words that describe the personality and character of Bunker HHS.

PHYSICAL ENVIRONMENT

Natural Open Trees / Woodsy Cozy Quaint
Traditional Cottage Accessible Quiet
Private Peaceful Park-like Setting Safe Green Tucked Away Contemporary Intimate

IDENTITY CHARACTERISTICS

Family Friendly Welcoming Community Loving Student-Centered Inclusive
Excellence Happy Proud Tight Knit Caring Diversity High Achieving Charming Involved
Home Enclave Neighborhood Collaborative

What makes BHE unique

PAT Mtg#1 Feedback: Design Vision

2. Describe what makes Bunker HHS/secondary uniquely Bunker HHS?

PHYSICAL ENVIRONMENT

Natural Environment Embedded in the Neighborhood Access to Outdoor Learning
Intimate Building Quaint/Hidden
Exterior Views/Natural Light Protected Exterior Entries One Story

IDENTITY CHARACTERISTICS

Small Community Oriented Sense of Closeness/Togetherness
Family Oriented Inclusive/Diversity Student/Parent Involvement Welcoming
Traditions Happy Friendly Openness Excellence Core Values Innocence

Existing: Favorite/Least Favorite

PAT Mtg#1 Feedback: Design Vision

3. What is your favorite aspect of the existing campus that you don't want to lose?
What is your least favorite aspect of the existing campus that needs to change?

FAVORITE ASPECTS

Outdoor Spaces Natural Setting Open Space Walkable / Bikeable Views
Play Spaces Hidden Neighborhood Privacy
Art Displays Natural Wood in the Library Old School Contemporary Design Intimate Culture

LEAST FAVORITE ASPECTS

Parking / Lack of Drive Connection Too Many Entrances / Too Far Apart
Safety / Security Concerns Size / Location of Entrance Age / Condition of Building
Technology Need More Outdoor Learning Features Cafeteria Too Small
Lack of Multi-Function Space Outdoor Hallways Stacking Traffic on Strey/Taylorcrest

Common Themes from PAT:

- Community Oriented / Sense of Closeness
- Embedded in Neighborhood
- Access to Outdoor Learning
- Student Centered / Inclusive
- Natural / Open / Trees / Woodsy
- Welcoming / Family / Friendly

PAT Mtg #1: PAT Feedback → Educational Vision

Support Student/Community

PAT Mtg#1 Feedback: Educational Vision		
1. Describe how the building can help support both Student engagement and Community activities.		
FLEXIBILITY Larger and more flexible meeting, learning and work areas Spaces that fit evening programs, performances and community activities Ability to separate public spaces from learning community Spaces with room to work and store More Restrooms / Better access	LEARNING ENVIRONMENT Incorporate access to outdoor learning opportunities Library at center of instructional spaces Connected areas where students are secure to move about freely Spaces for special learning activities	PHYSICAL ENVIRONMENT Taking advantage of natural environment as an asset More Parking Use of Natural Lighting Welcoming Environment

21st Century Learning Environment

PAT Mtg#1 Feedback: Educational Vision		
2. Name three things that help create a modern 21 st Century Teaching & Learning environment that helps to support and foster a successful program.		
LEARNING ENVIRONMENT Technology: Access to / Use of / Adaptable Flexible collaborative spaces for teaching and learning (inviting classrooms) Practical and Interactive Features Equipment adequate for their need that encourage learning the process Library at center of instructional spaces Links with real world application / environments for future skill sets Dedicated Gifted/Talented space	PHYSICAL ENVIRONMENT Ample Natural Light / Views to Exterior Safety Energy efficient / climate focused "Creative environment = Creative thought"	FLEXIBILITY Flexibility Forward Looking COMMUNITY Conducive for Parent Involvement Building Community

Teaching and Learning

PAT Mtg#1 Feedback: Educational Vision		
3. Describe how Teaching and Learning have changed at Burke HS Elementary since the 1950's.		
TEACHING STRATEGIES Collaborative Teaching and Learning Movement from Teacher focused to Student focused Movement from 3 R's to Thinking Skills More Hands on / Individualistic Instructional Approach Team Teaching Helping Students Help Themselves	TECHNOLOGY Ever-changing technology / growth of personal technology Information Availability Science Lab / Makerspace Advances COMMUNITY Safety and Security Demographic changes More diverse + Mobile student body	PHYSICAL ENVIRONMENT Classroom layouts / instructional area use small and large group instruction "No longer Beaver Cleaver" type classrooms Outdoor / Indoor Dynamics

Common Themes from PAT:

- Library at Center of Instruction
- Natural Light / Views to Exterior
- Flexible / Collaborative Spaces
- Access to Outdoor Learning
- Safe Environment / Student Movement
- Student Focused / Build Thinking Skills

PAT Mtg #1: PAT Feedback → Site Plan Anchors



Site Organization Concepts to Explore:

- **Admin** located at Front/Inside
- **Library** central to Learning Community, Exterior Presence
- **Gym** easy access to Fields
- **Dining Space** ability to house Large Events
- **Service Yard** located at Back

PAT Mtg #2: Site Constraints: Existing Conditions

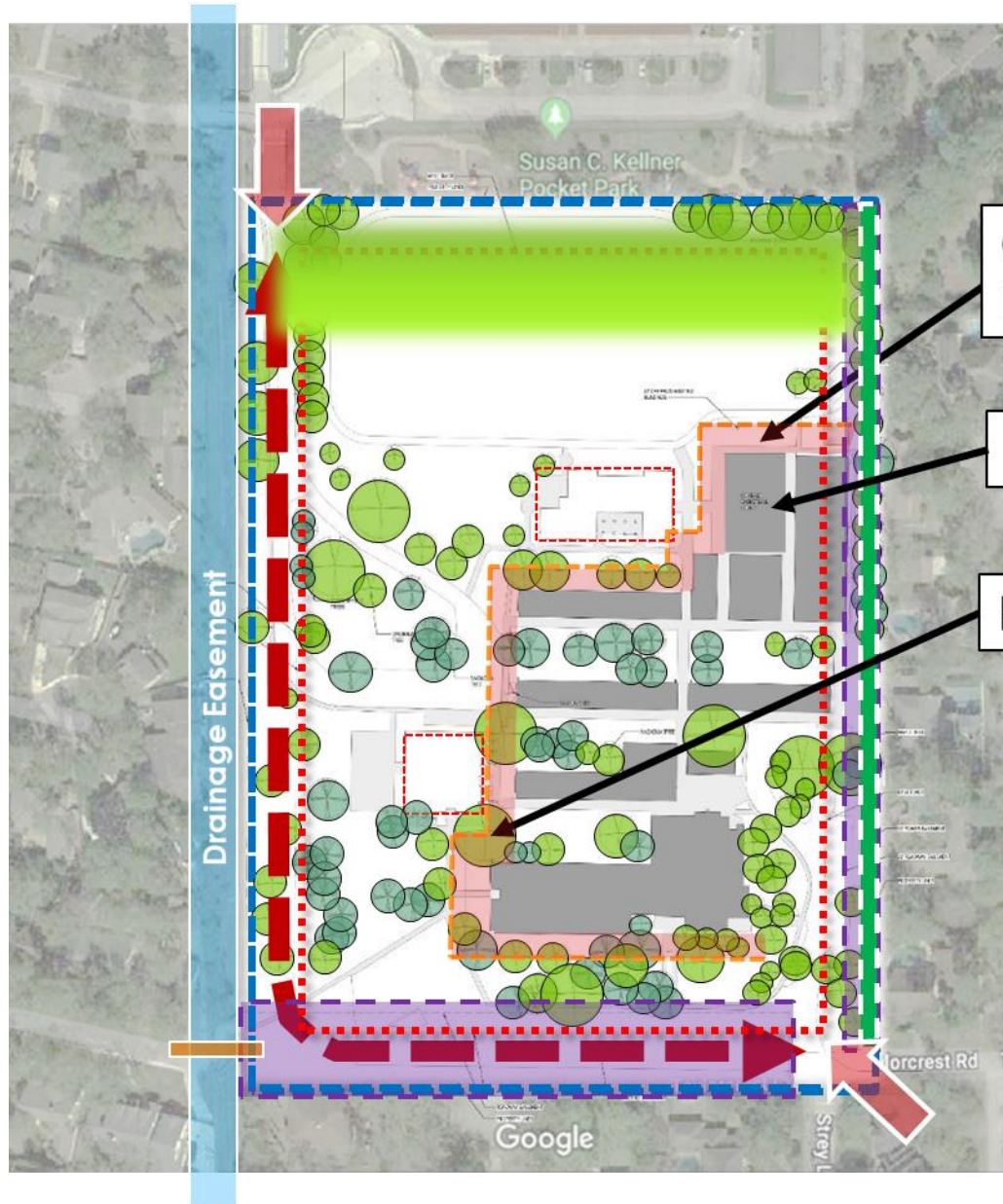

Site Constraints

50' HARRIS COUNTY DRAINAGE EASEMENT

50' BUILDING SETBACK

ROADWAY EASEMENT

UTILITY EASEMENT

Site Access points (internal Connecting road)

2 Story Height Max.

Residential Zones on Three sides

buffer from Apartments Undetermined
future use

Existing Building & Existing Trees-survey



Traffic Patterns and Pedestrian Circulation

Site Constraints: Buildable Area

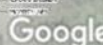

Site Constraints

50' HARRIS COUNTY DRAINAGE EASEMENT

50' BUILDING SETBACK

ROADWAY EASEMENT

UTILITY EASEMENT

Site Access points (internal Connecting road)

2 Story Height Max.

Residential Zones on Three sides

buffer from Apartments Undetermined
future use

Existing Building & Existing Trees-survey



Traffic Patterns and Pedestrian Circulation

PAT Mtg #2: Site Constraints: Functional Layout

Site Plan

Functional Relationships

Parking: Visitor, Staff, Service

Play-Fields

Covered Play

¼ Mile Track

Service

Parent Drop-off

Bus Drop-Off

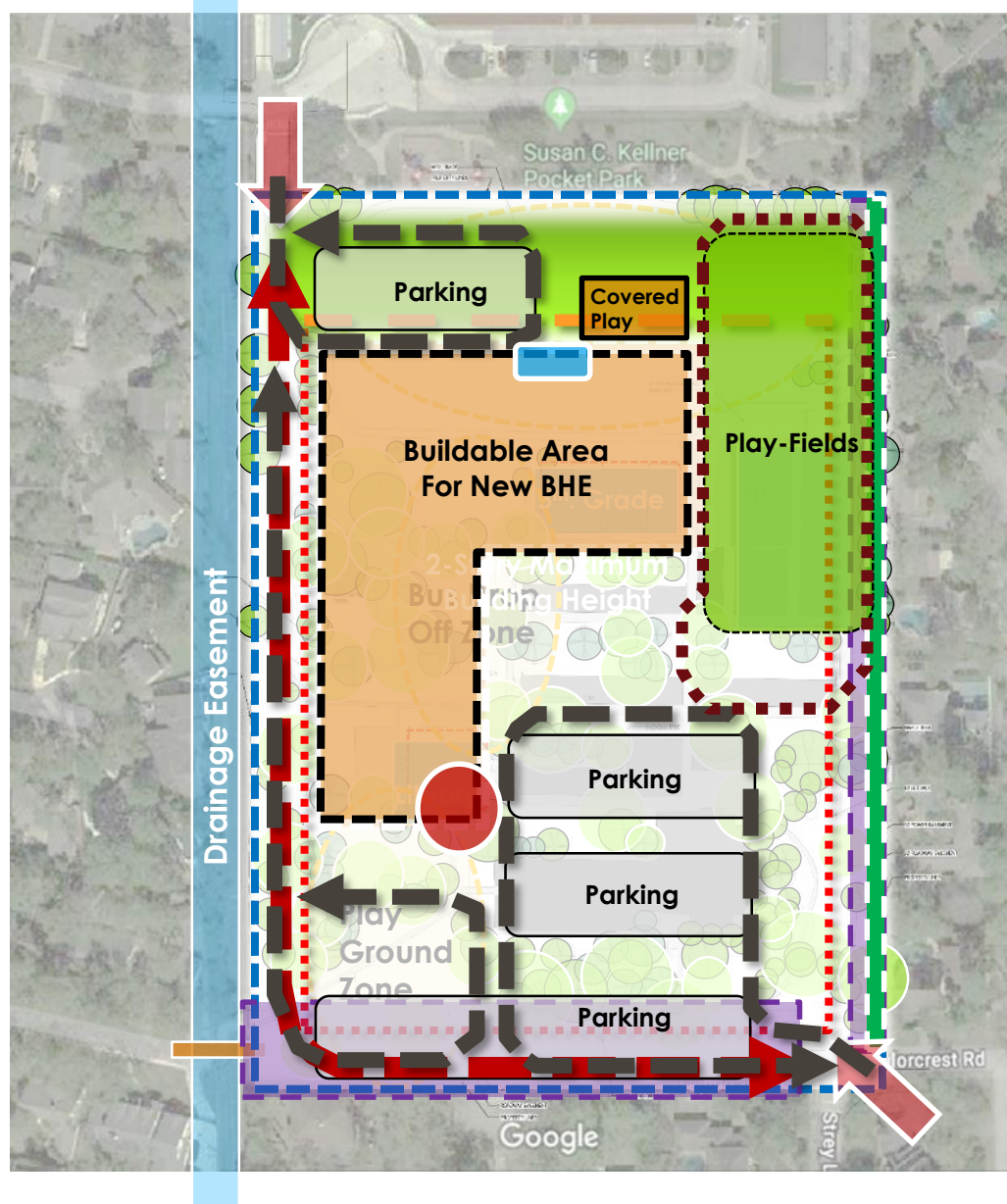

PAT Mtg #2:

Feedback: Building Diagram

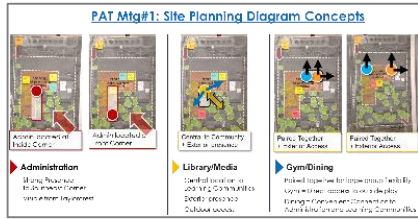

Evaluation Criteria

(5 Tables)

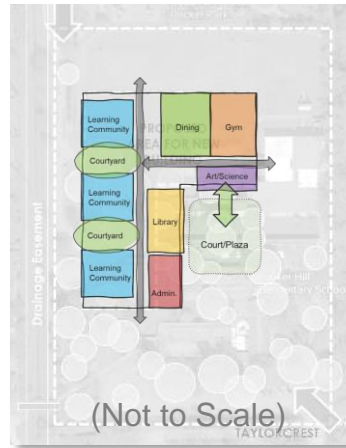

Option A

(5 Tables)

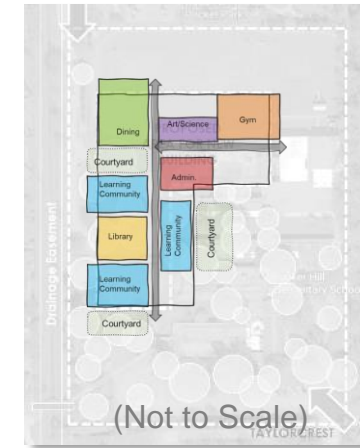

Option B

Administration

Front Door / Community Presence

4

Central + Visible from front of campus. Separated from noisy areas of campus.. Consider flipping with library

1

Central location, proximity to Dining (for Clinic). May be too far into the property

Library

Learning Communities Center / Exterior Access

4

Located at heart of campus / focal point. Accessible from classrooms. Easy access for events, central to the front

1

Central to Learning Communities, easy access. More confined and boxed in feeling.

Learning Communities

Grade Levels / Outdoor Access

5

Liked grade-level flexibility and courtyards. Shielded from entrance. Good views to exterior.

0

Surrounds the library.... Limited exterior views. Close proximity to Dining

Art + Science

Outdoor Access / Learning Communities

5

Liked availability of outdoor access / outdoor plaza. Close proximity to gym/dining..

0

Availability of outdoor access. Only one true courtyard

Dining

Service + Access: Student /Community

5

Service access shielded from connector road. Gym/Dining adjacency allows flexible large space. Good access from gym to outdoors/fields.

0

Easy service access. Dining close to Learning Communities, Possibly more daylight available. Good access from gym to outdoors/fields.

Gym

Covered Play / Play Fields

Preferred Option

5 out of 5 Tables

5

Consensus

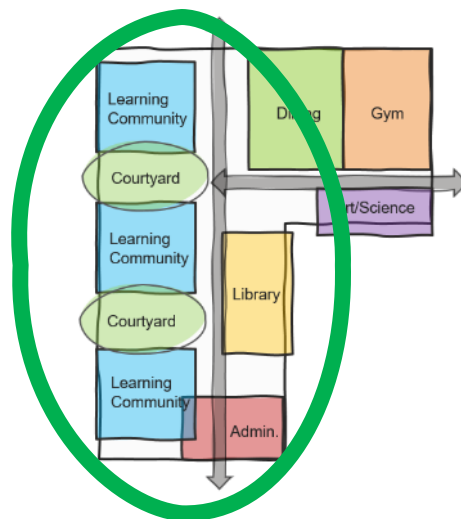

LC Courtyards

Library at the Heart
LC Views to Exterior
Outdoor Learning
Open Feeling
Community Activities

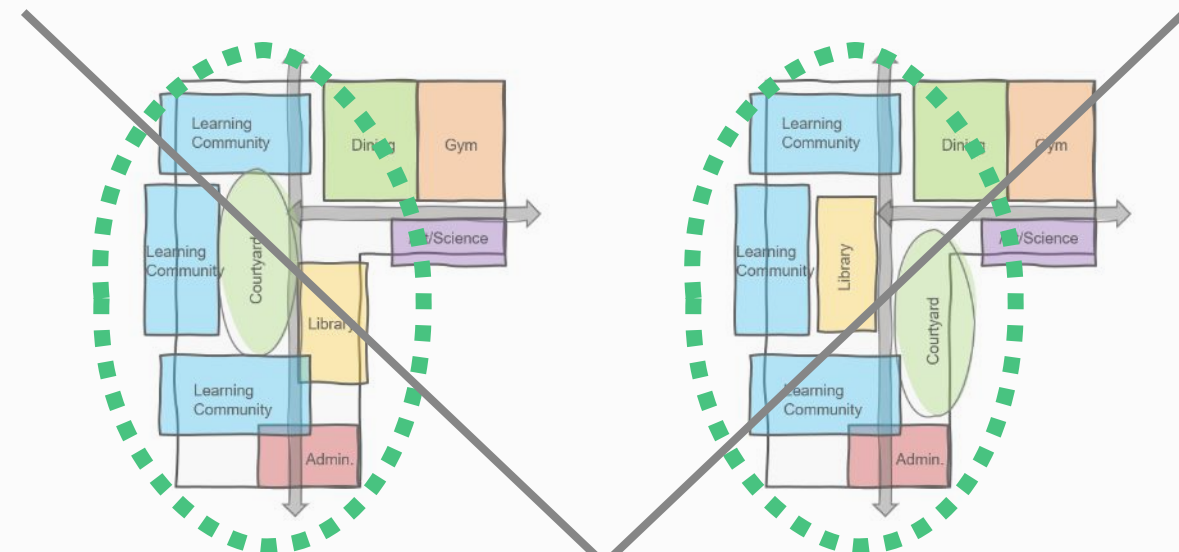

Central Courtyard

Central Library



Follow-up:

Location of Admin / Library

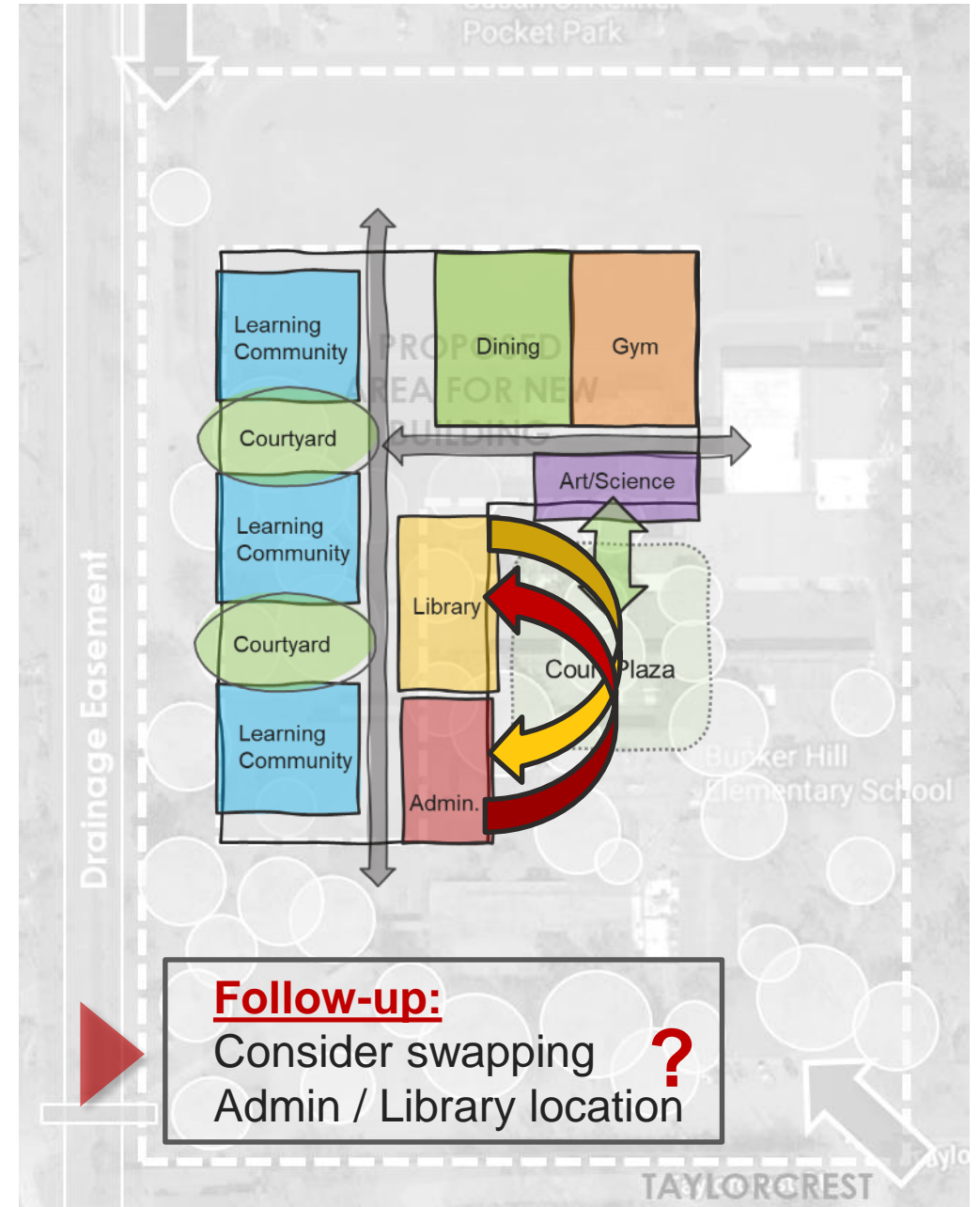
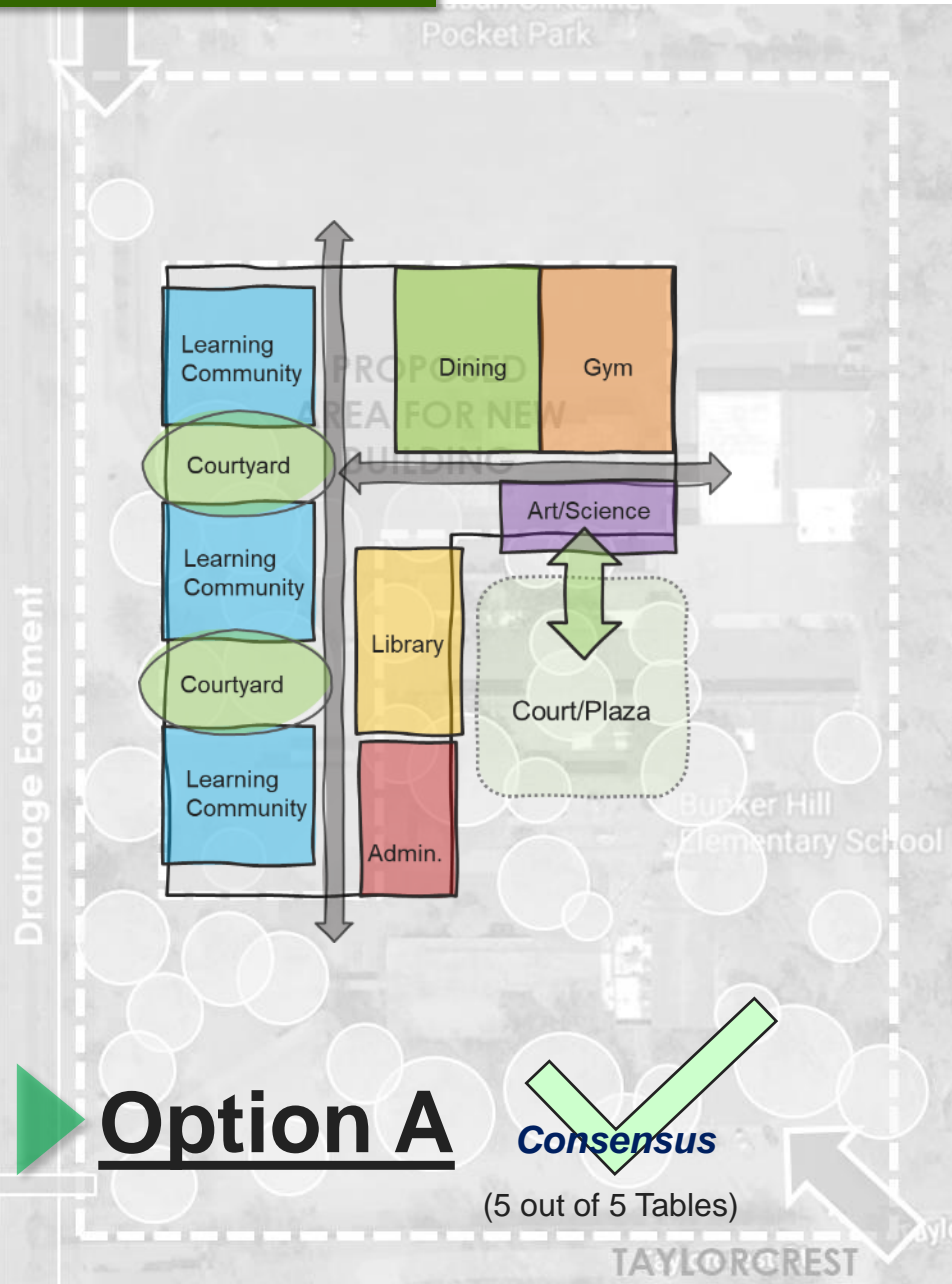

Follow-Up: Parent + Visitor + Bus Approach



Admin at Front Corner

Visitor + Bus

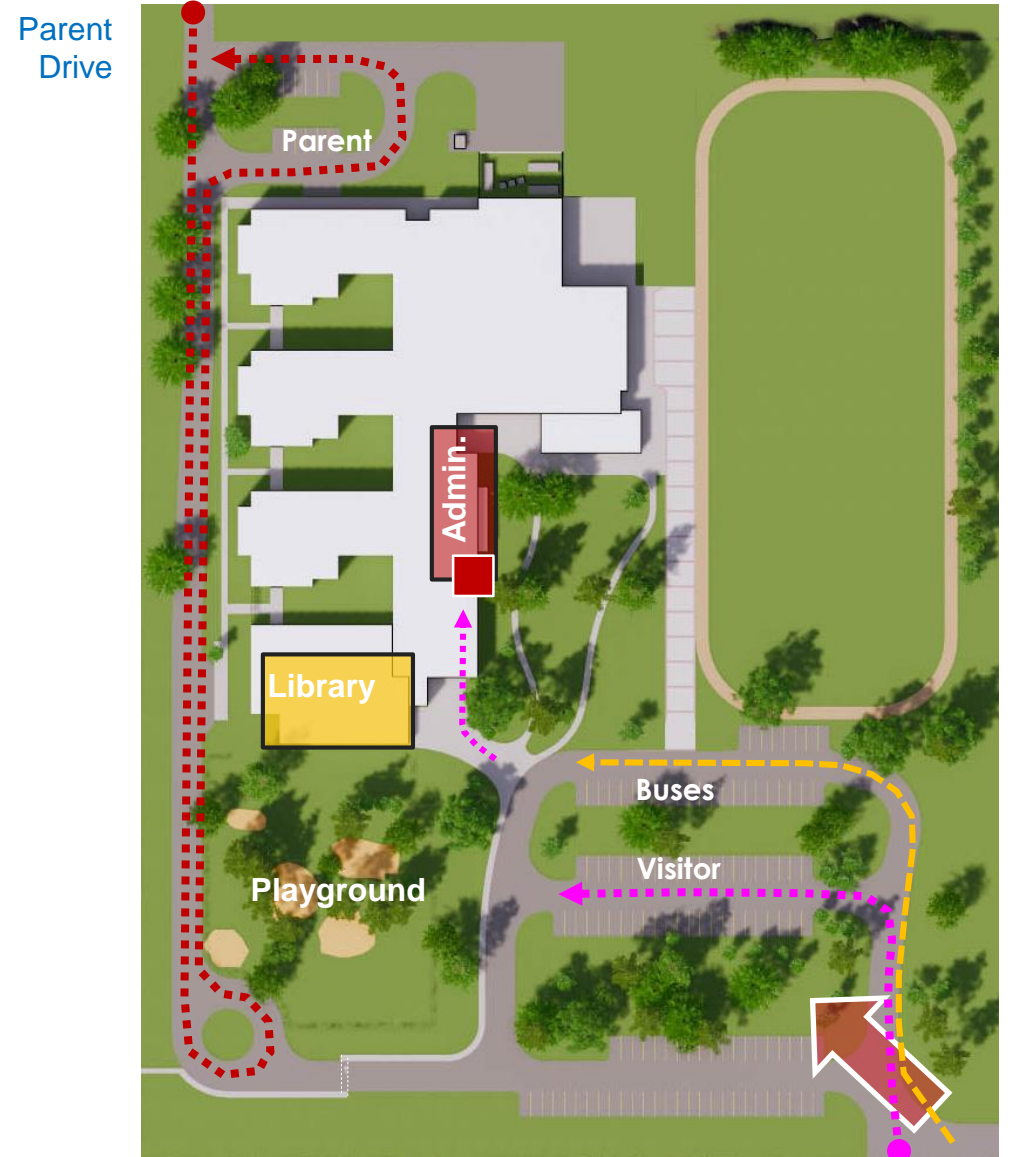

Admin at Center

Visitor + Bus

Follow-Up: Visitor View from Taylorcrest

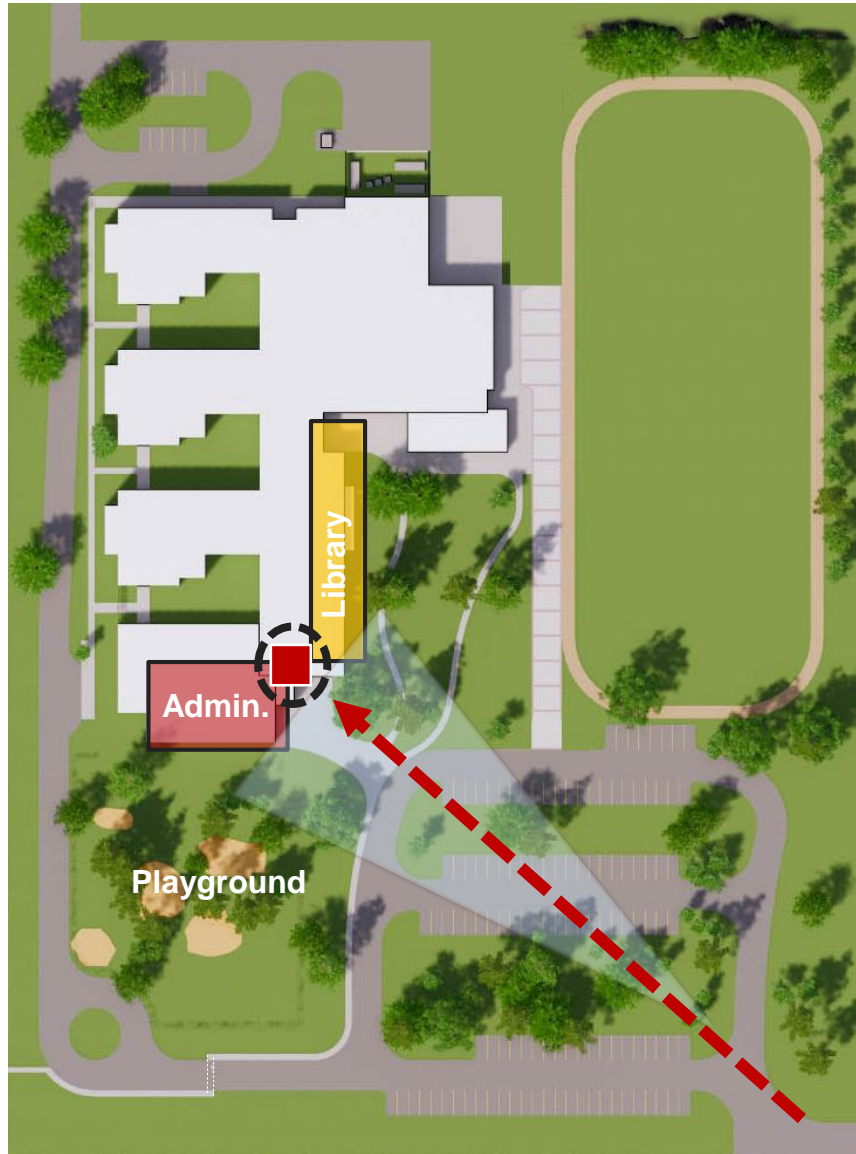

Admin at Front Corner

Centered

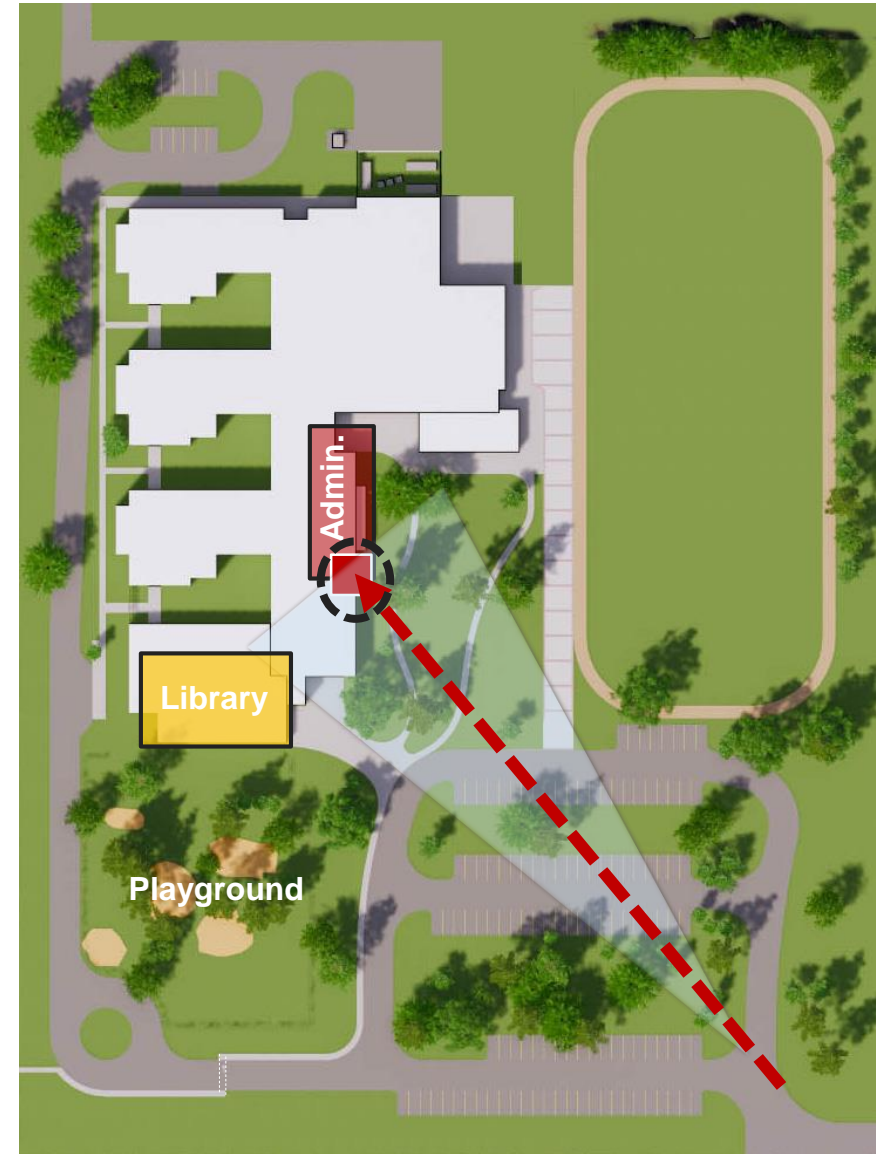

Admin at Center

Off-Center

Follow-Up: View from Entry Vestibule

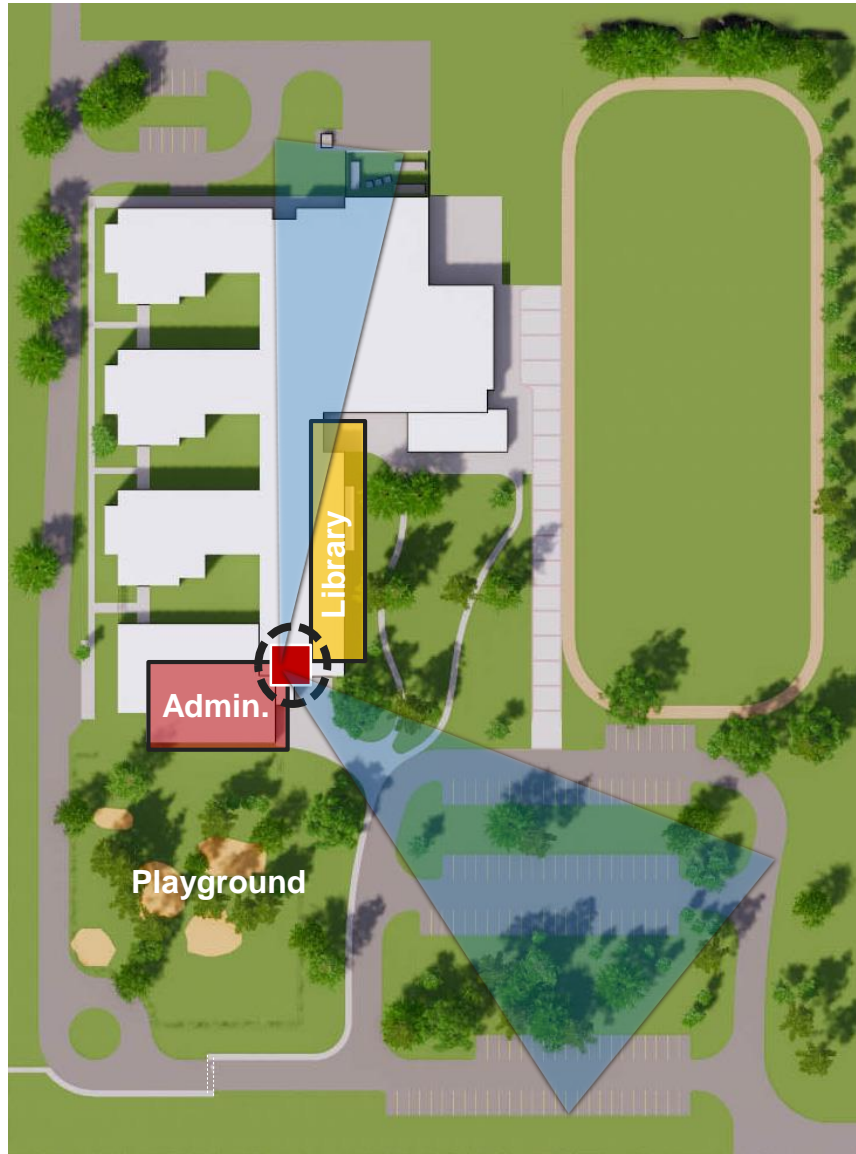

Admin at Front Corner

Parking
Entry Door
Circulation Spine

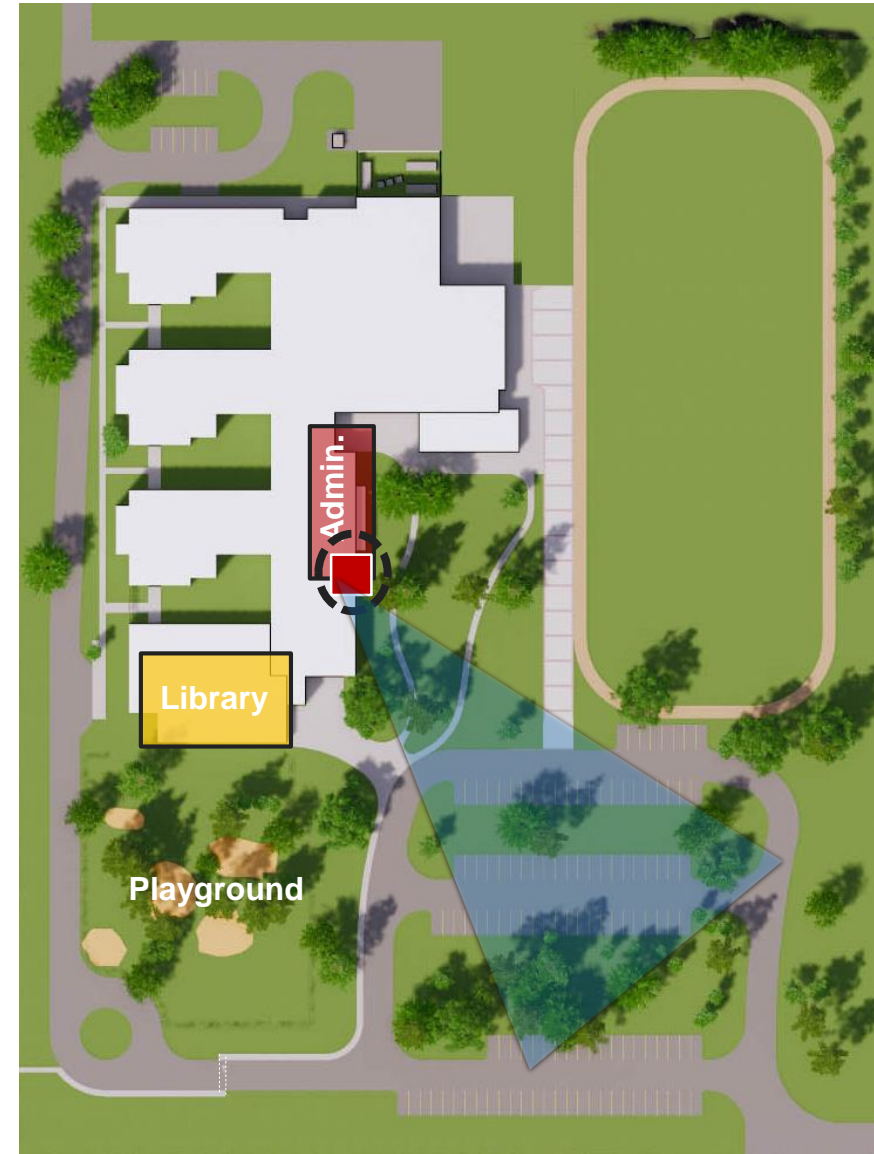

Admin at Center

Parking
Entry Door
Circulation Spine

Follow-Up: **Library at The Heart of Campus**

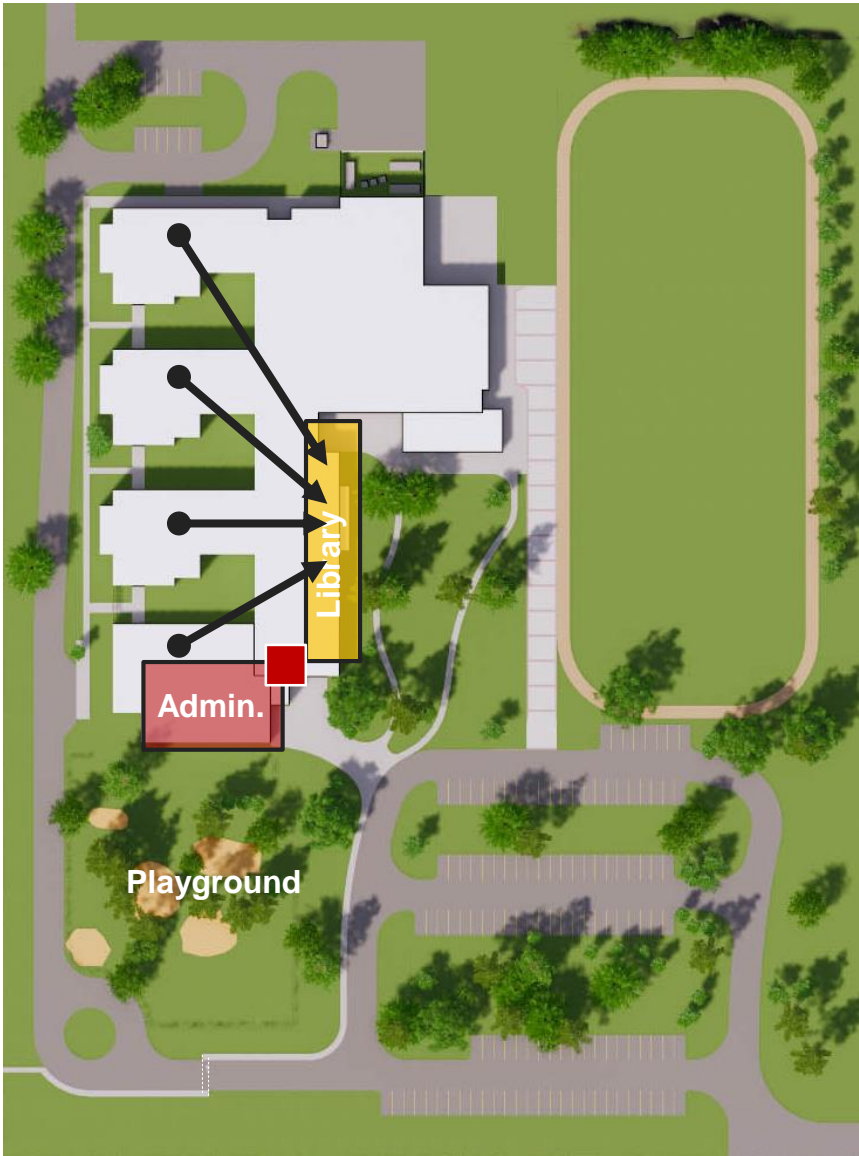

Admin at Front Corner

Heart of
Learning
Community

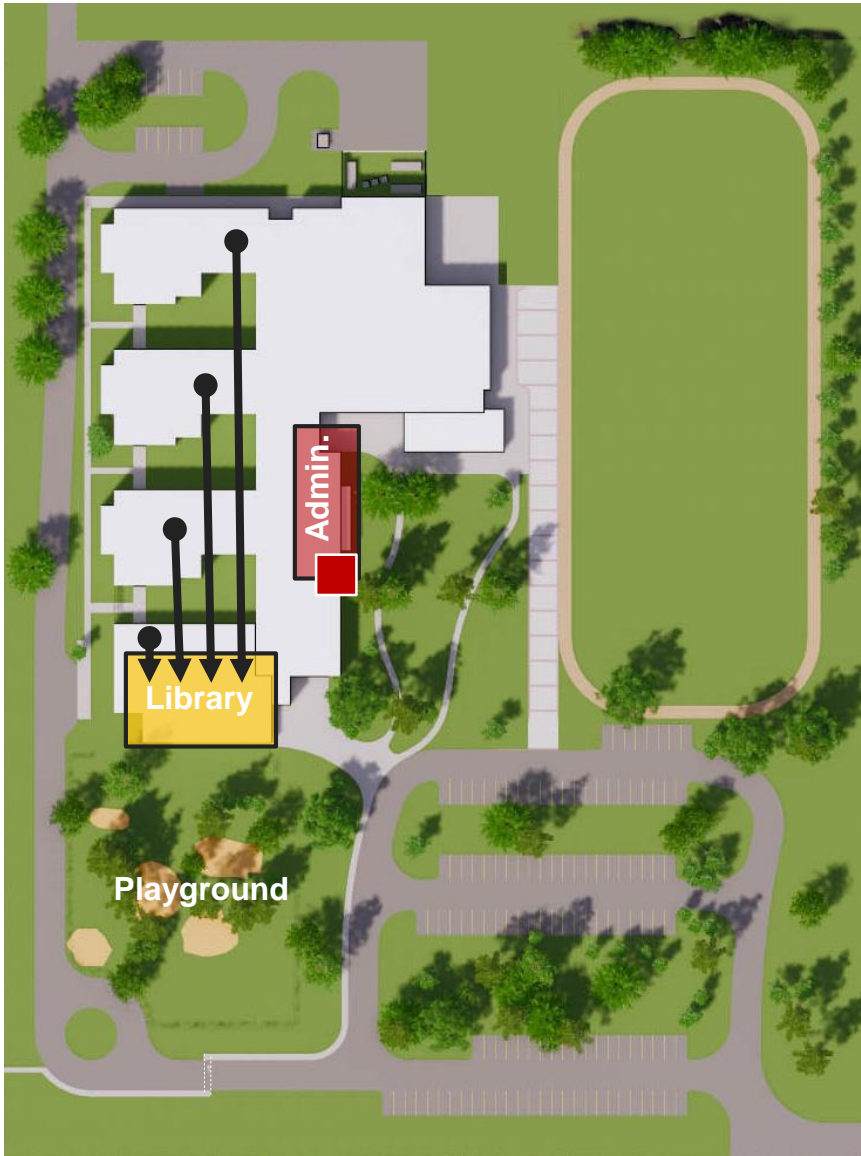

Admin at Center

Not Heart of
Learning
Community

Follow-Up: Outdoor Learning: Library, Art, & Science

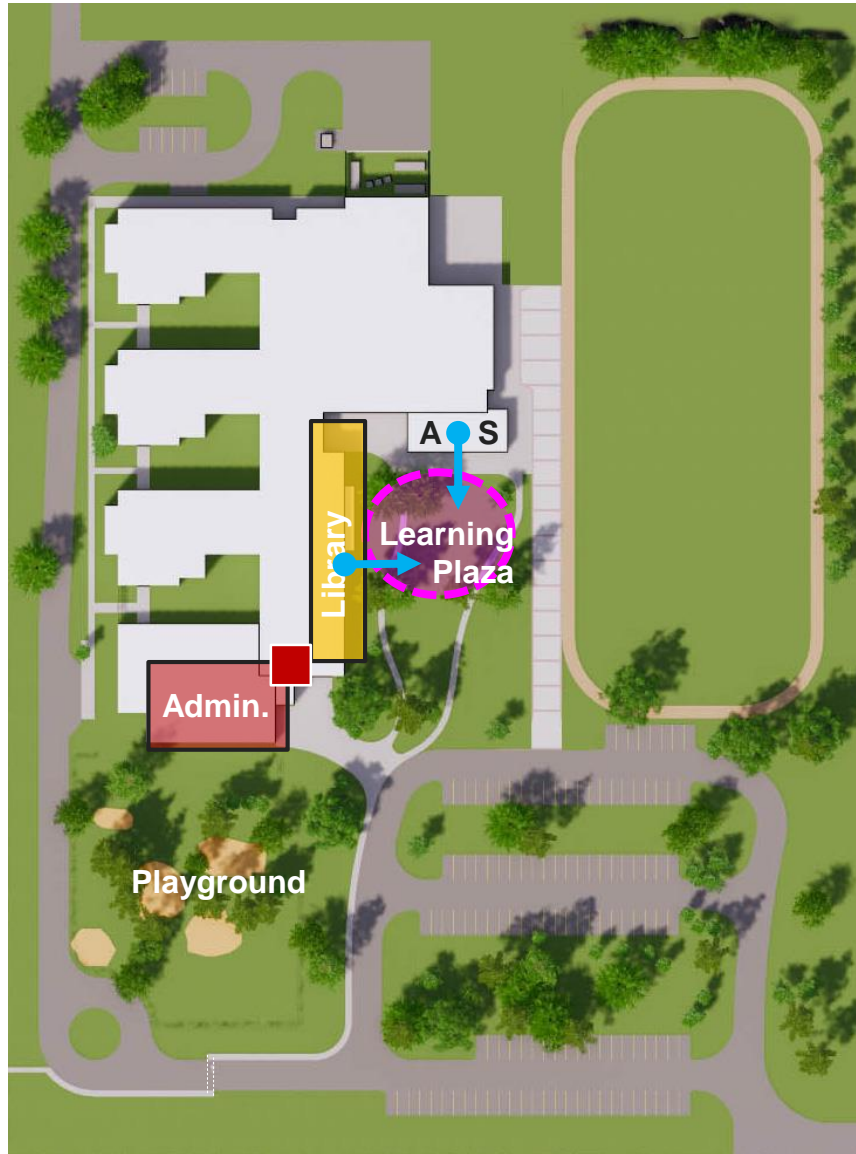

Admin at Front Corner

Art + Science
Library

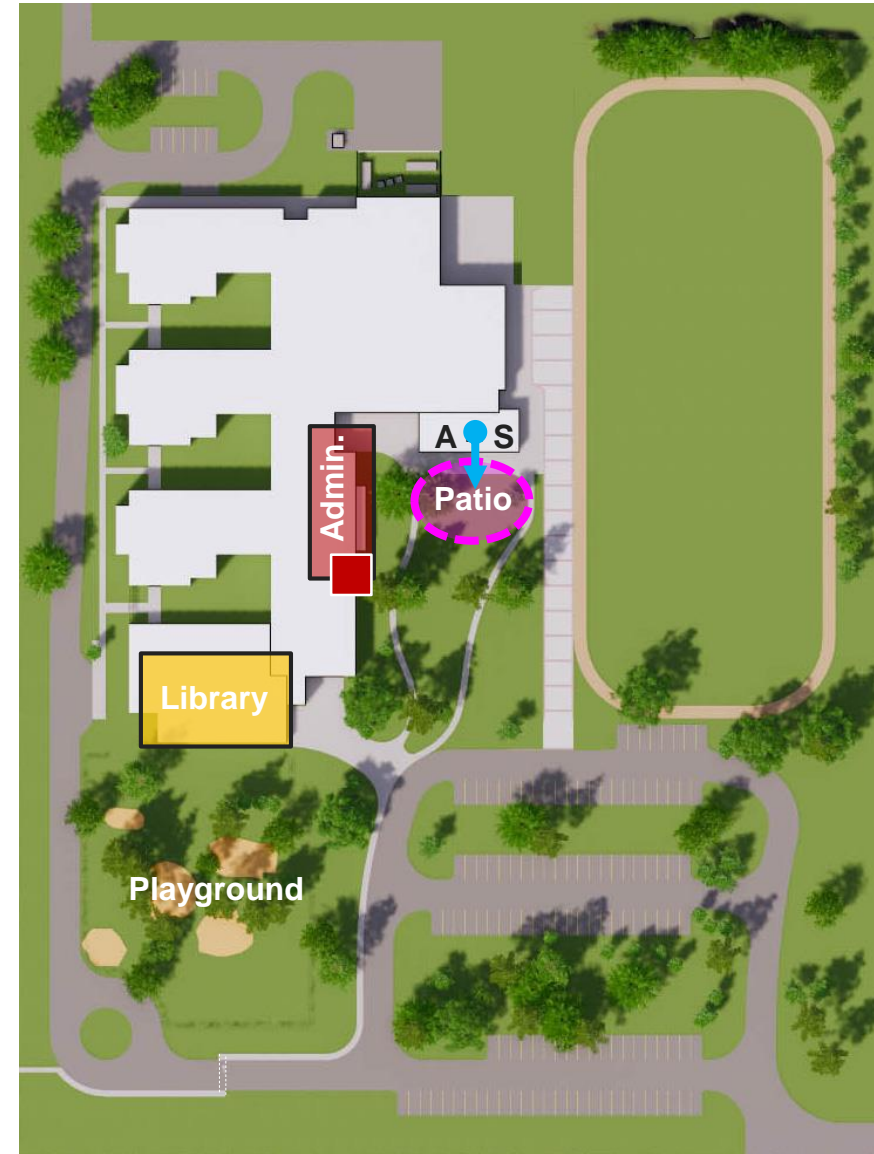

Admin at Center

Art + Science
Library



Meeting Agenda:

- **Introductions / PAT Charge**
PAT Process Overview
Program Summary
- **PAT Mtg #2 Recap**
Functional Relationship Diagrams (Site + Building)
Admin / Library Location Follow-up
- **PAT Mtg #3 Focus: Building Organizational Concept**
SD Preliminary Concept: Site Plan, Floor Plan
Guiding Principles for Bunker Hill Design
PAT Input on SD Preliminary Concept
- **Next PAT: March 31st / Closing Remarks**

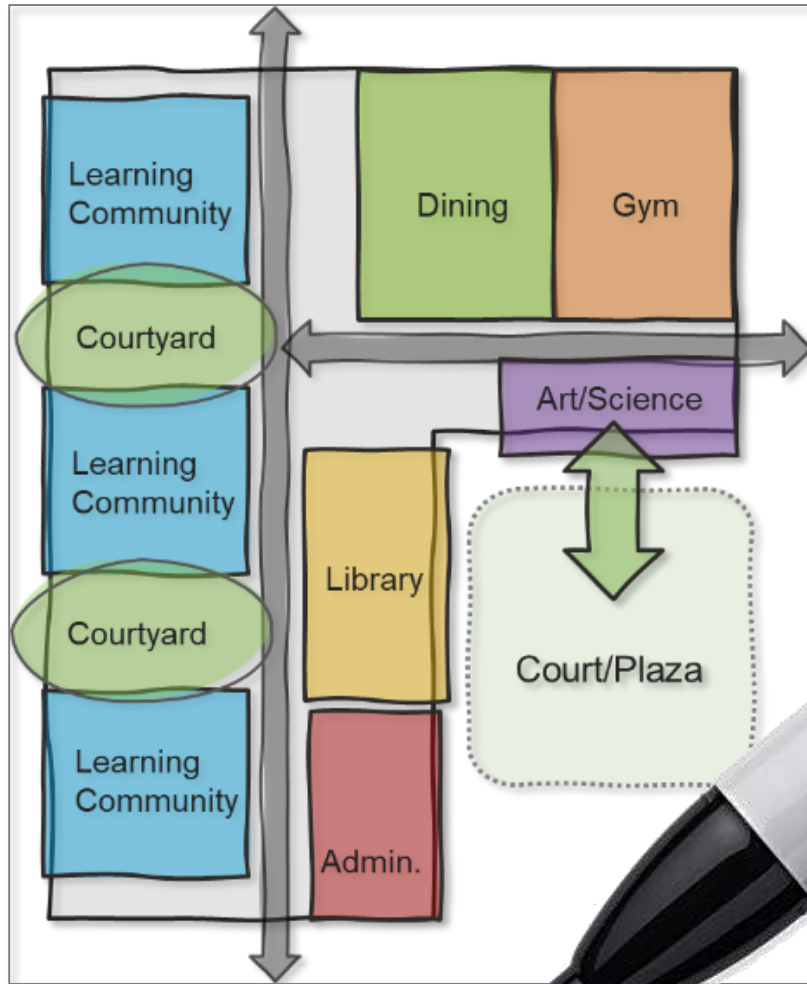

Bubble Diagram
Functional relationships

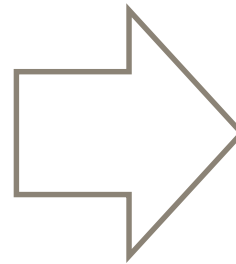

Line Diagram
Spaces shown accurately / scale

Existing Campus Plan



Phasing Plan: Existing Bunker Hill ES

Demolish, Fifth Grade Center & Library



Phasing Plan: Make room for new construction

Build New BHE School



Phasing Plan: Build on occupied campus

Demolish Existing School & Complete Site Work.



Phasing Plan: Demolition + Sitework

Program Distribution



3D Massing Diagram: Program Spaces color coded

Program Distribution



3D Massing Diagram: Traffic Patterns

Floor Plans



Floor Plans

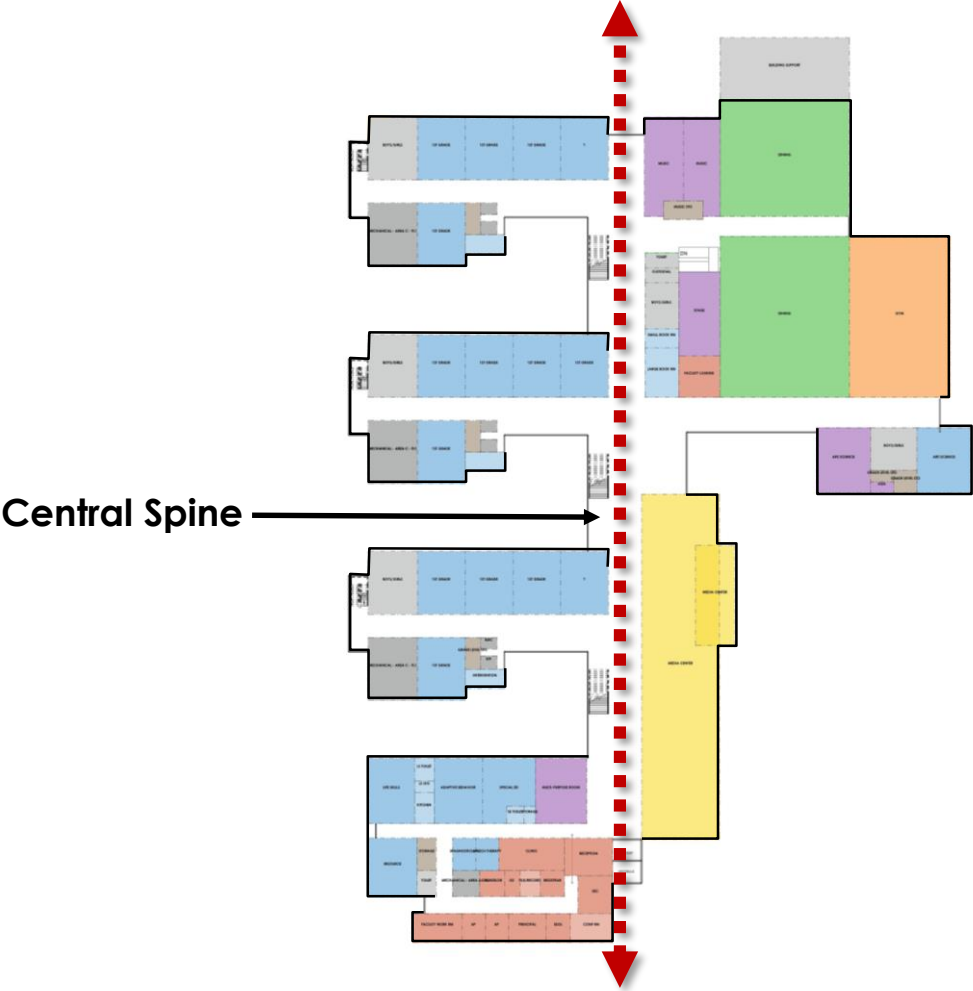

Floor Plans

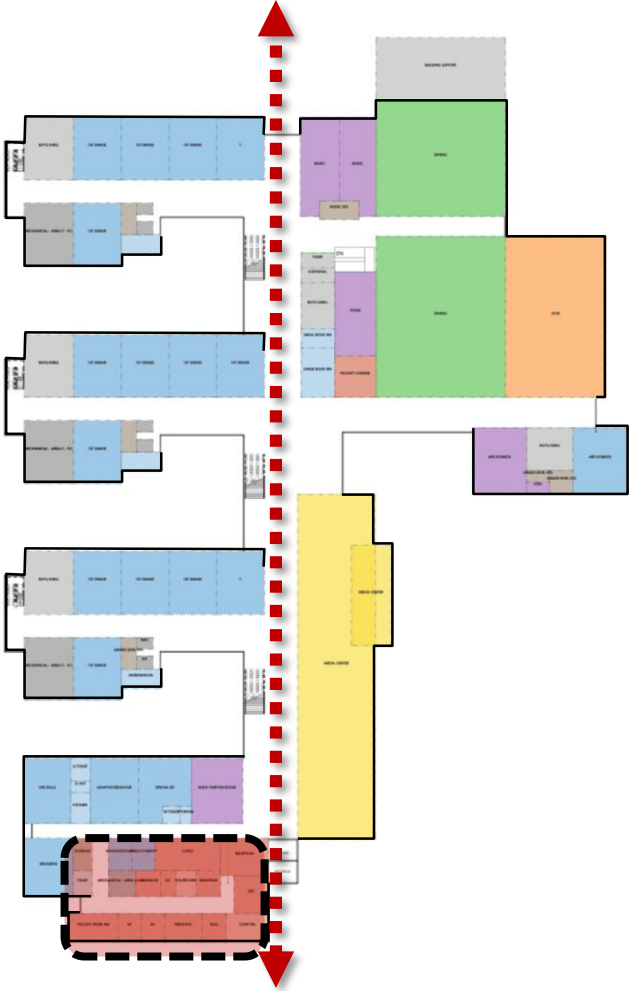

Administration



Floor Plans

Special Ed.
Multi-Purpose

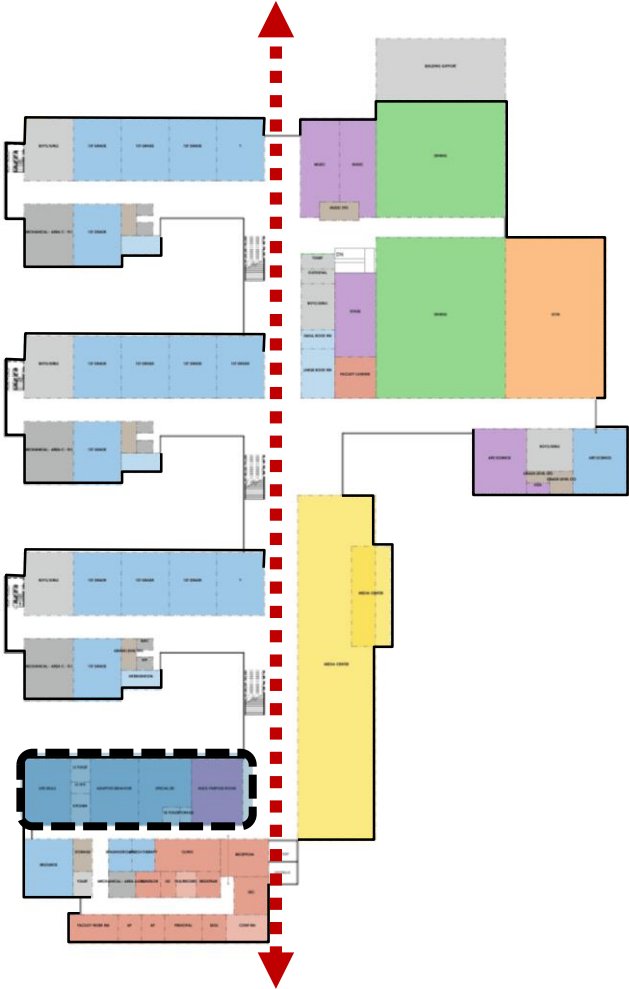

Floor Plans

Second Grade

First Grade

Kindergarten

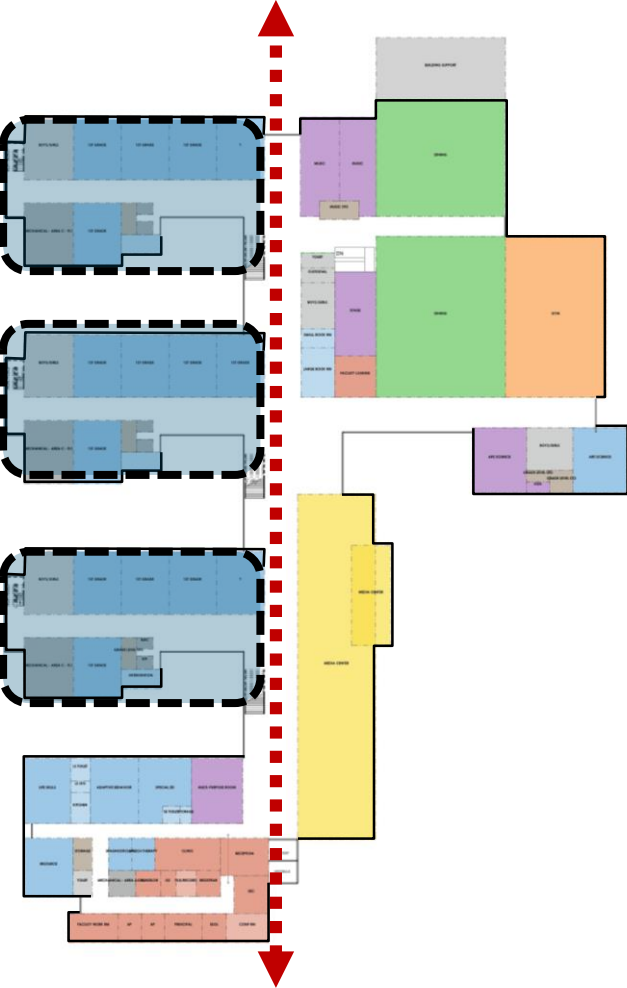



Floor Plans

Second Floor

Third Grade

Fourth Grade

Fifth Grade

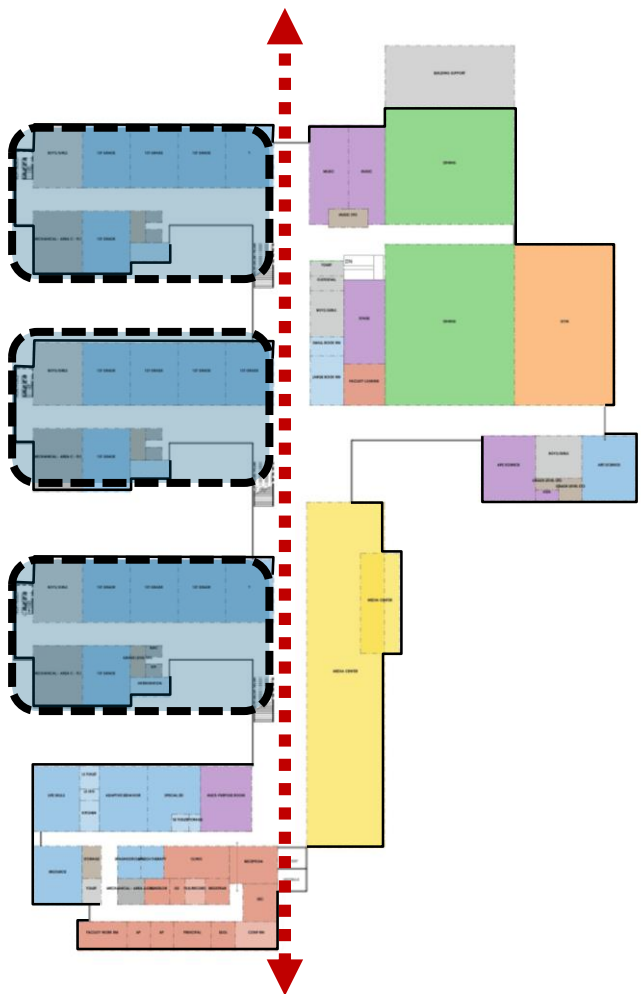

Floor Plans

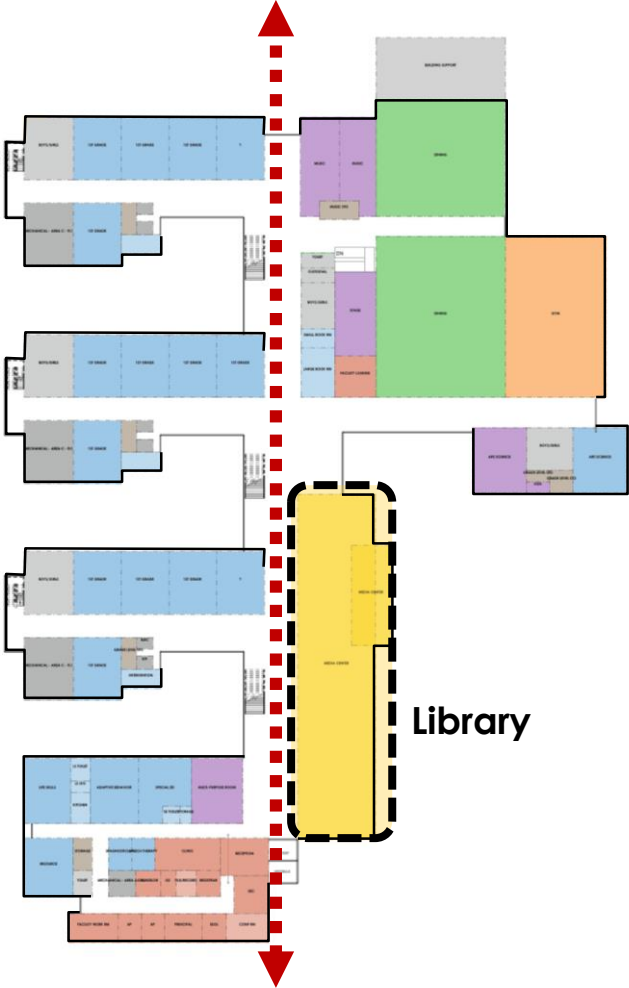

Floor Plans

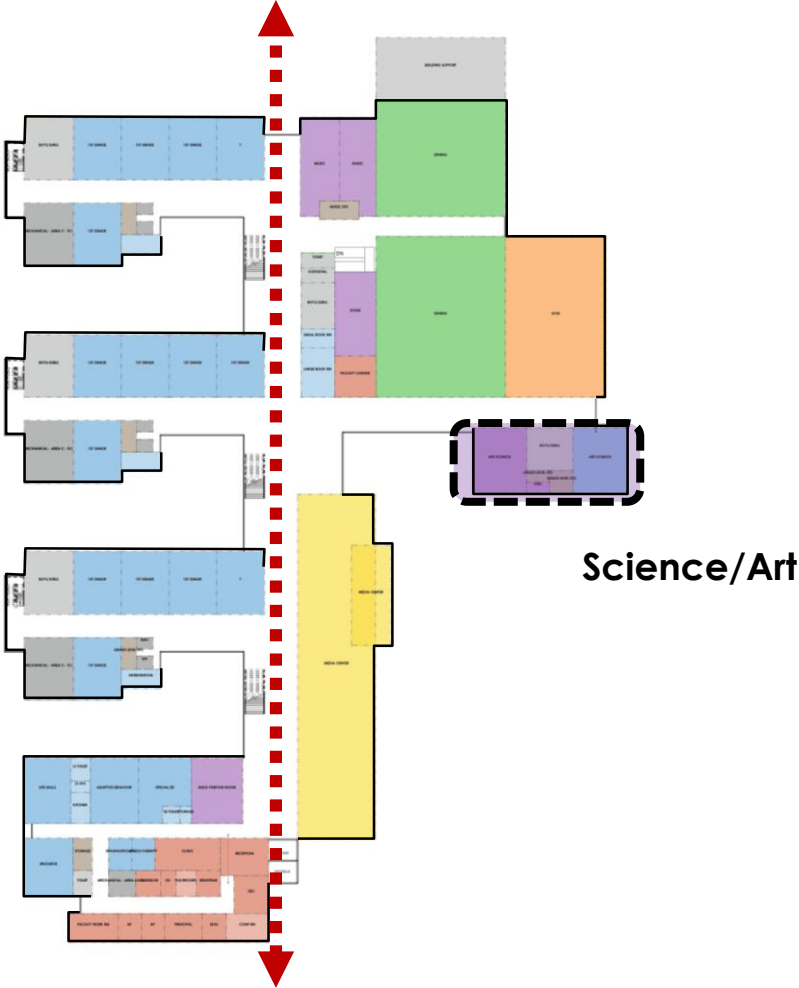

Floor Plans

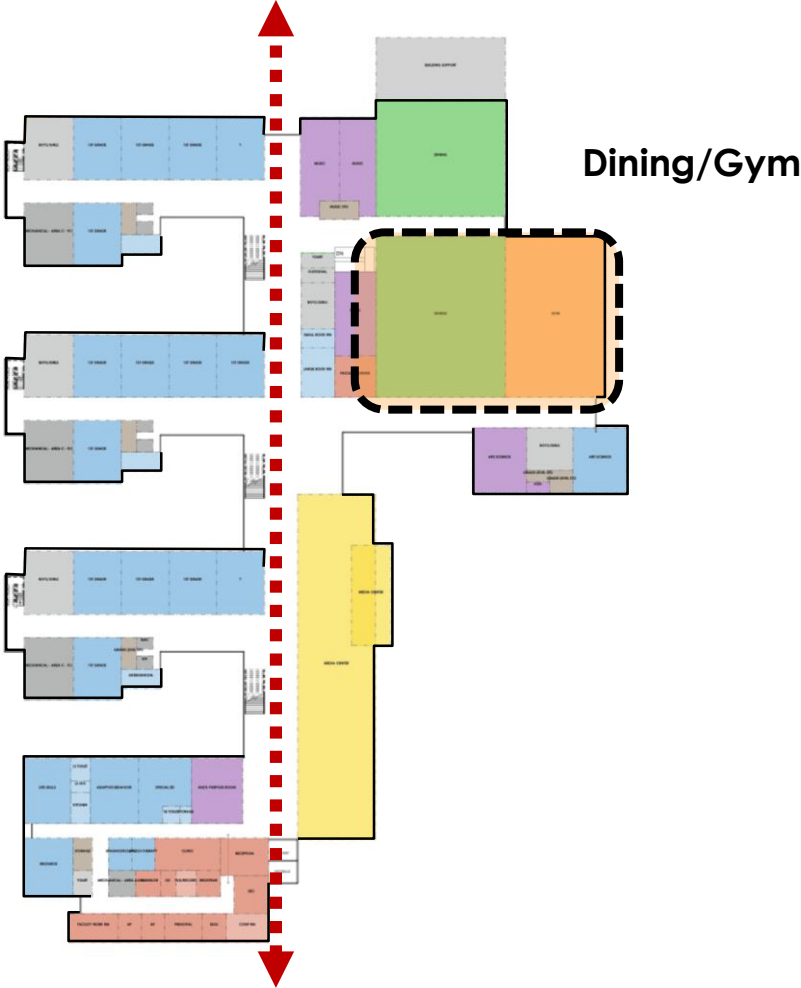

Floor Plans

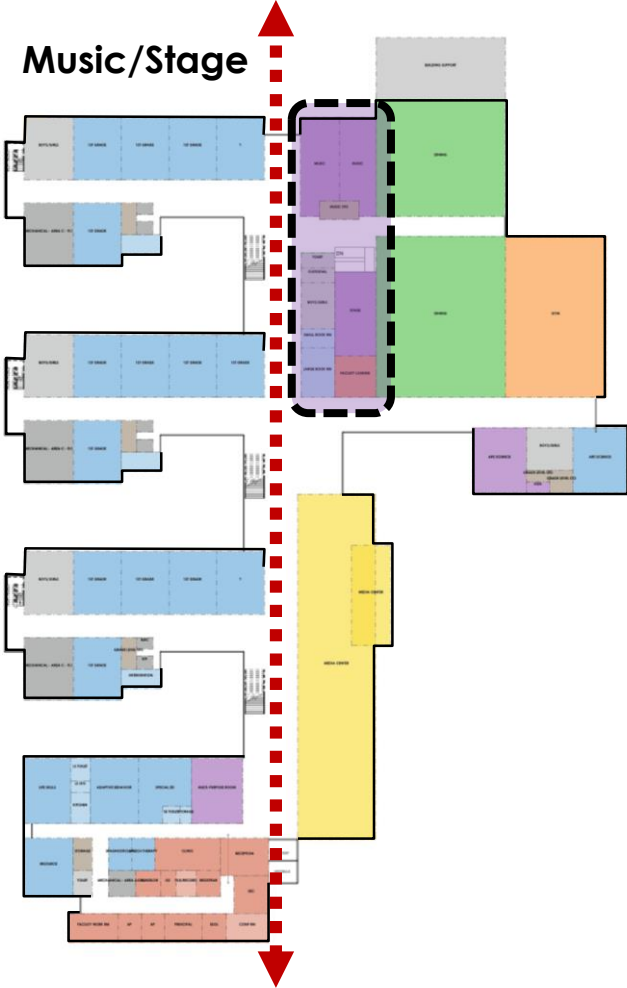

PAT Mtg #3: PAT Input / Engagement

Engagement Activity: 60 minutes

BHE Building Organizational Concept:

- Explore 2 options: Review/Discuss

Options:

Orthogonal
Organic

Review / Discuss Key Areas:

Central Spine
Courtyards
Library
Shared Spaces
Learning Communities

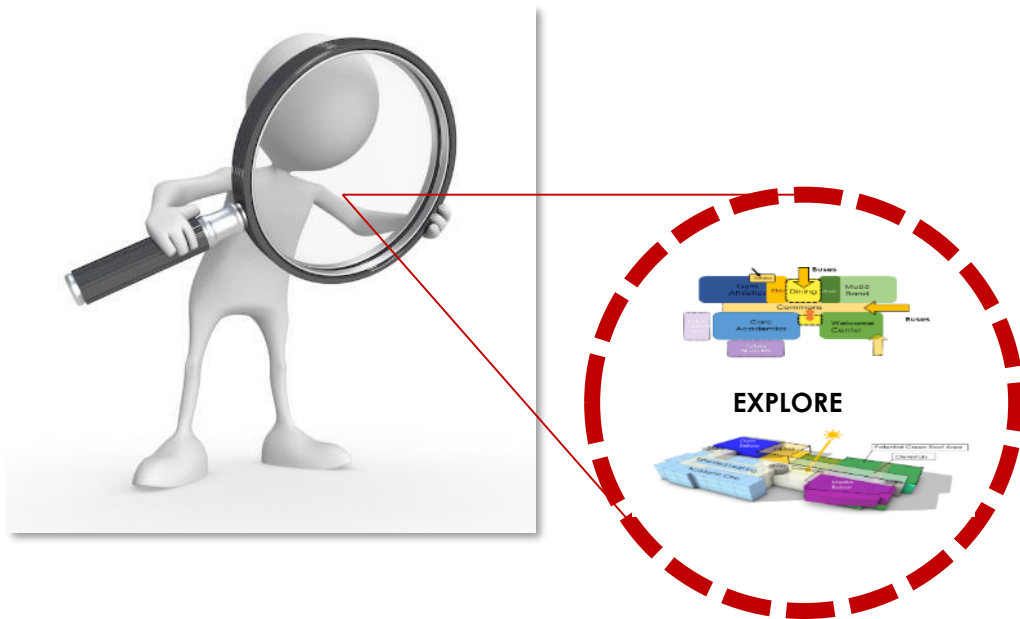

PAT Input / Engagement:

1. **Present/Discuss with GROUP**
2 Organizational Concepts
2. **INDIVIDUAL VOTE for**
“Preferred” Building Organization Concept

PAT Guiding Principles:

- 1. Open and Welcoming feeling.**
Inviting to and inclusive of the diverse community.
- 2. Embedded within Natural setting.**
Connected with views and access to walkable neighborhood.
- 3. Student centered and Parent involved.**
Celebrating excellence, achievement and tradition.
- 4. Flexible, Collaborative and Forward Thinking.**
Responsive to Teaching and Learning objectives over time.

PAT Guiding Principles:

- 1. Open and Welcoming feeling.**
Inviting to and inclusive of the diverse community.
- 2. Embedded within Natural setting.**
Connected with views and access to walkable neighborhood.
- 3. Student centered and Parent involved.**
Celebrating excellence, achievement and tradition.
- 4. Flexible, Collaborative and Forward Thinking.**
Responsive to Teaching and Learning objectives over time.

ORTHOGONAL PLAN

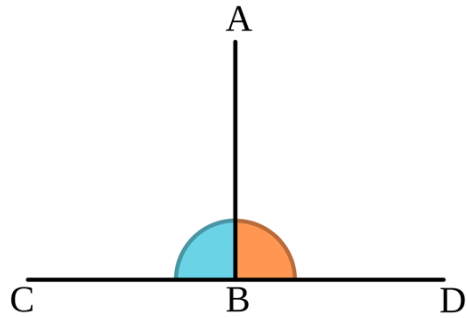

Formal – Rigid - Predictable

ORGANIC PLAN

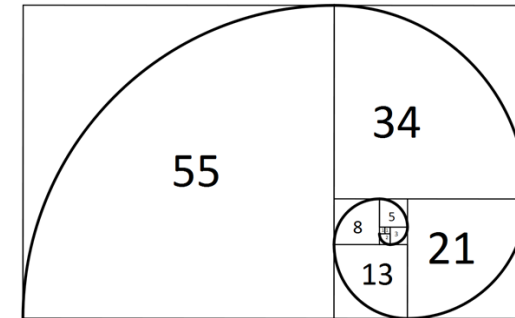
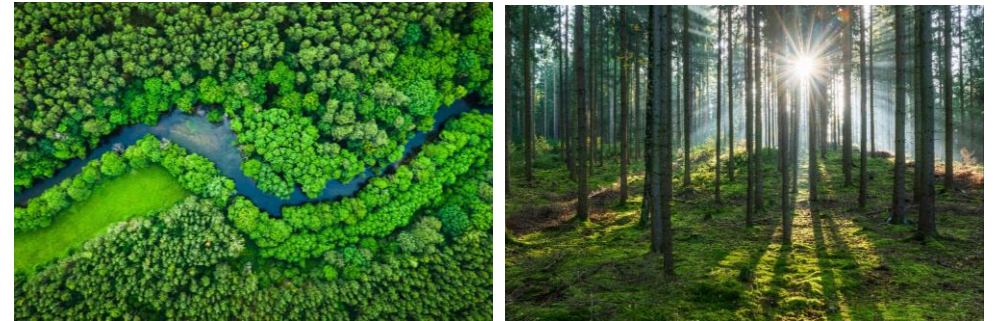

Natural - Relaxed – Free Flowing

ORTHOGONAL PLAN

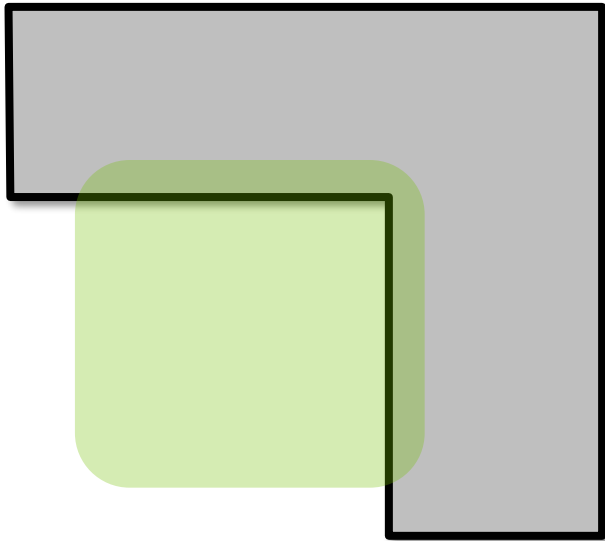

Formal – Rigid - Predictable

ORGANIC PLAN

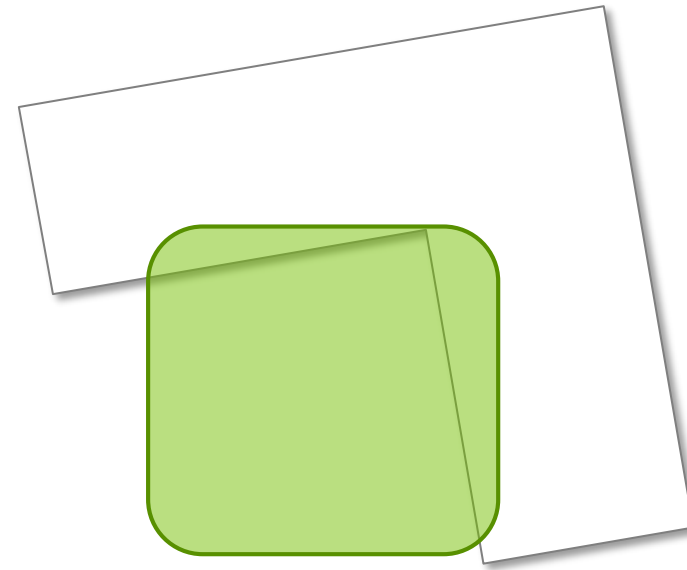

Natural - Relaxed – Free Flowing

ORTHOGONAL

Floor Plans

ORGANIC

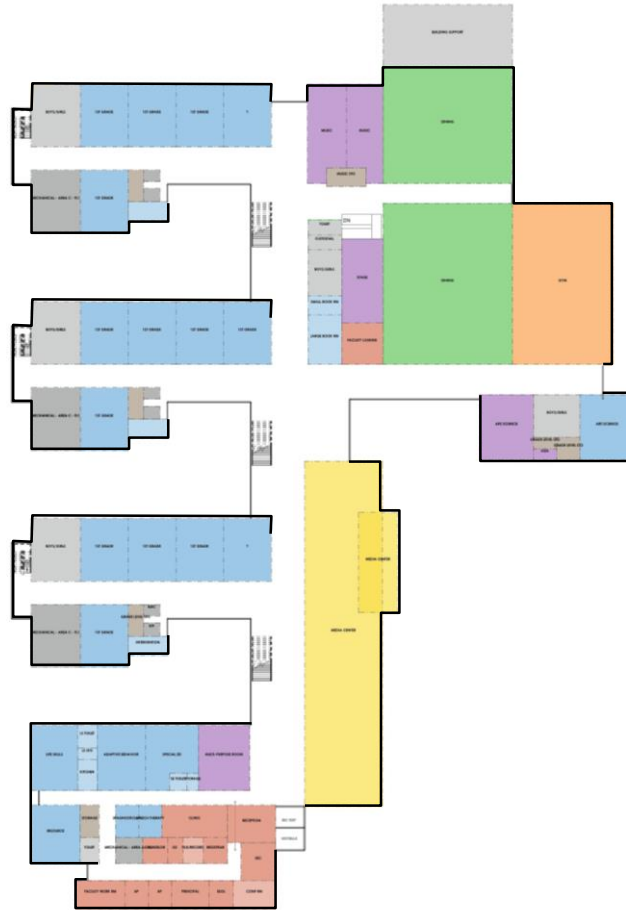

Rational – Structured - Static



Whimsical – Animated - Humanistic

ORTHOGONAL

Central Spine

ORGANIC

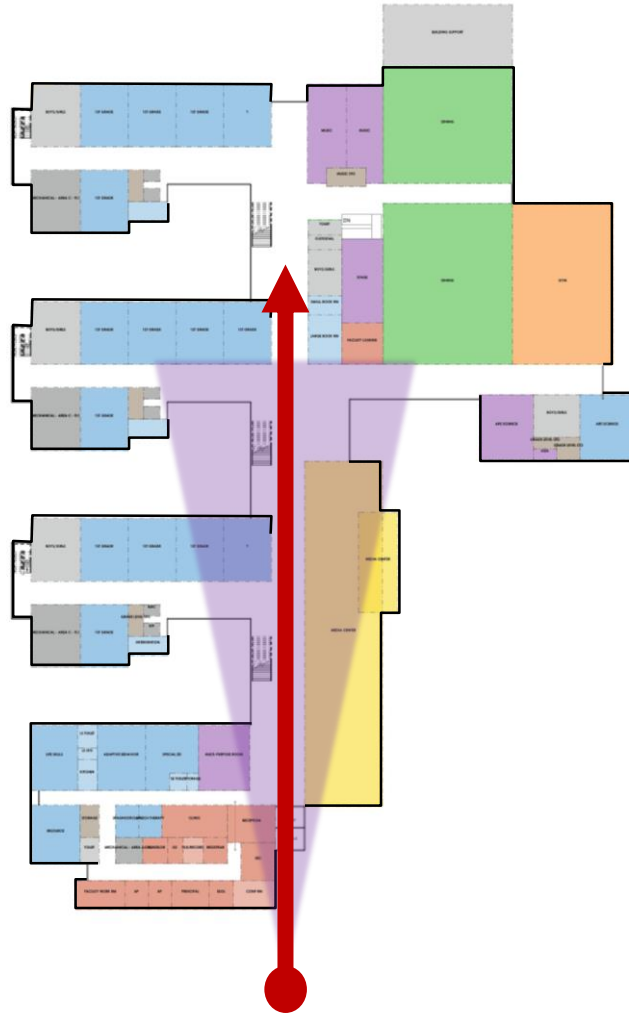

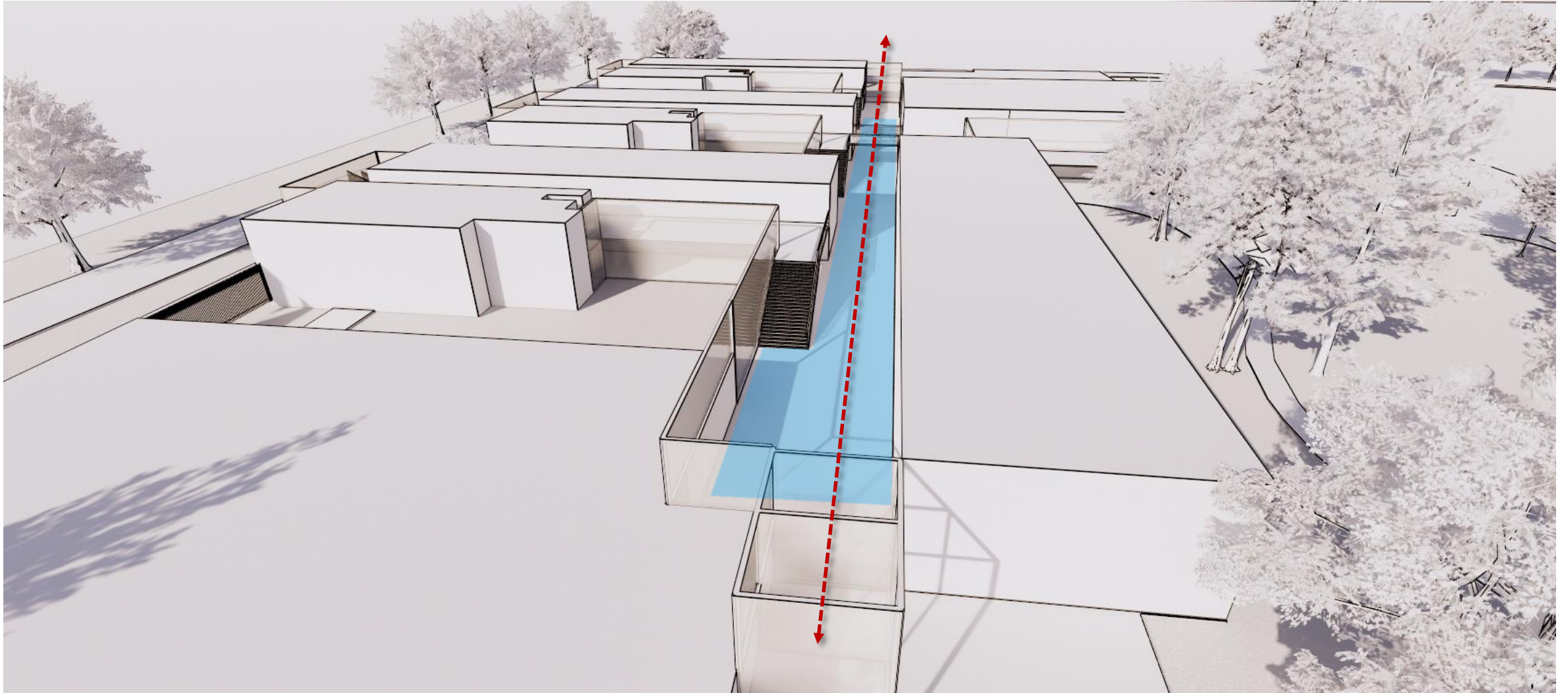

ORTHOGONAL

Linear Path – Clear Sight Lines
Single, Undifferentiated Large Space

Central Spine

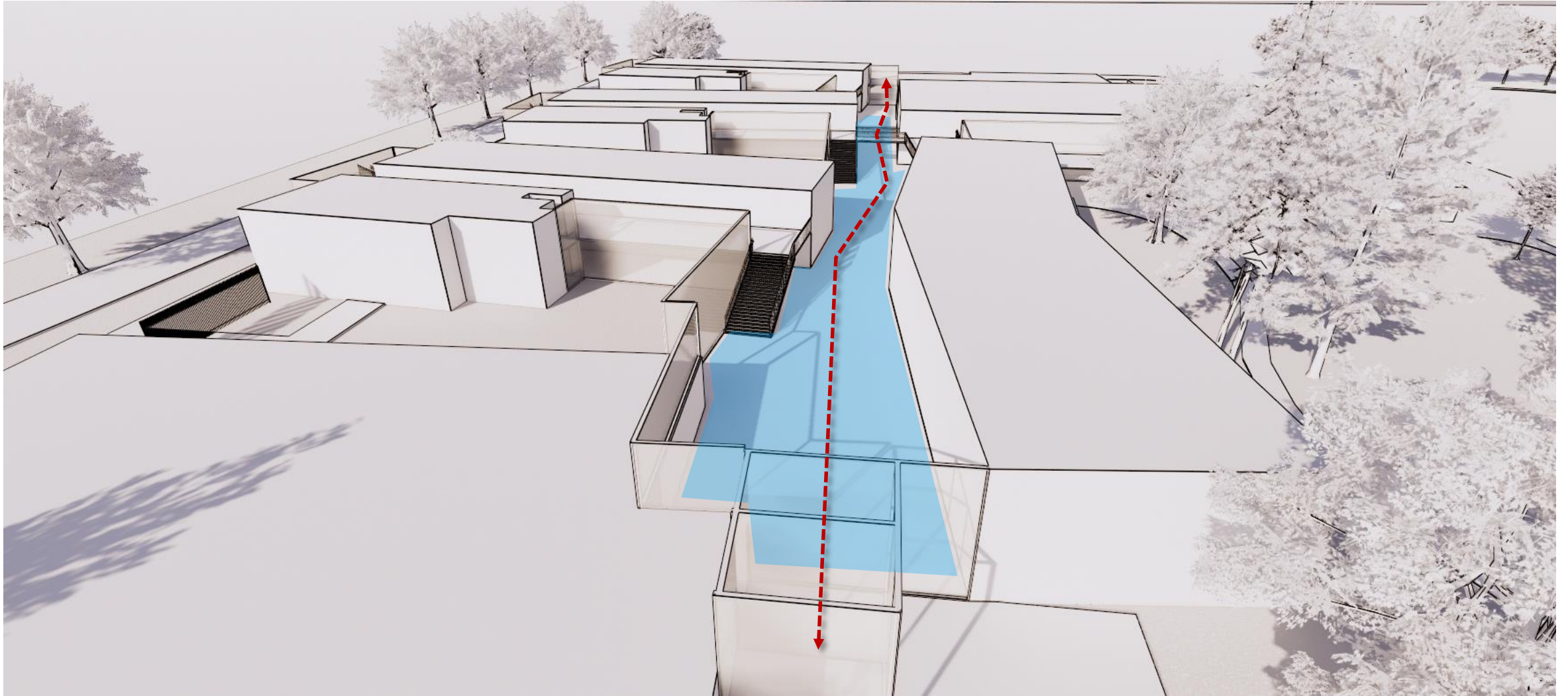

ORGANIC

Meandering Path – Clear Sight Lines
Sequence of Smaller Spaces

Central Spine

ORTHOGONAL

Courtyards

ORGANIC



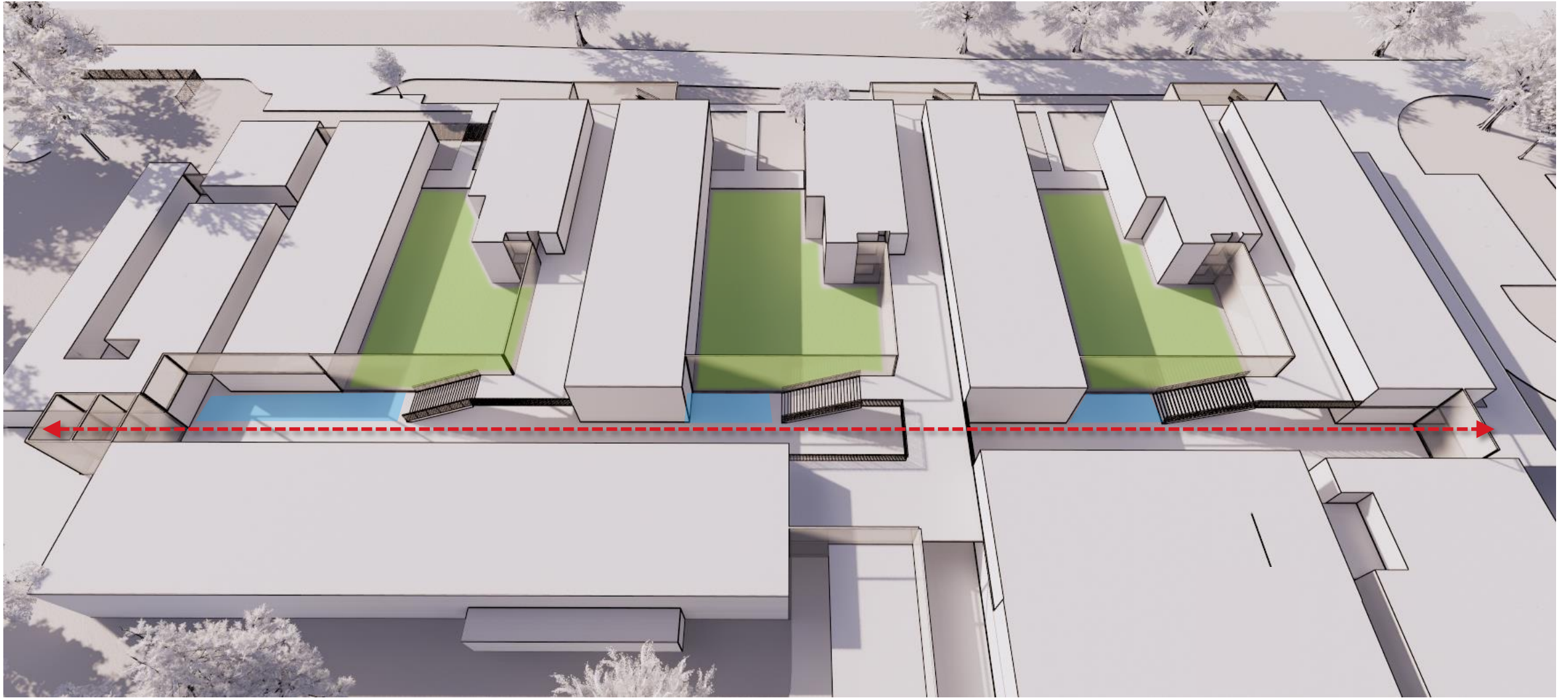

ORTHOGONAL

Single Repeated Experience
Deliberate - Measured - Static

Courtyards / Flex

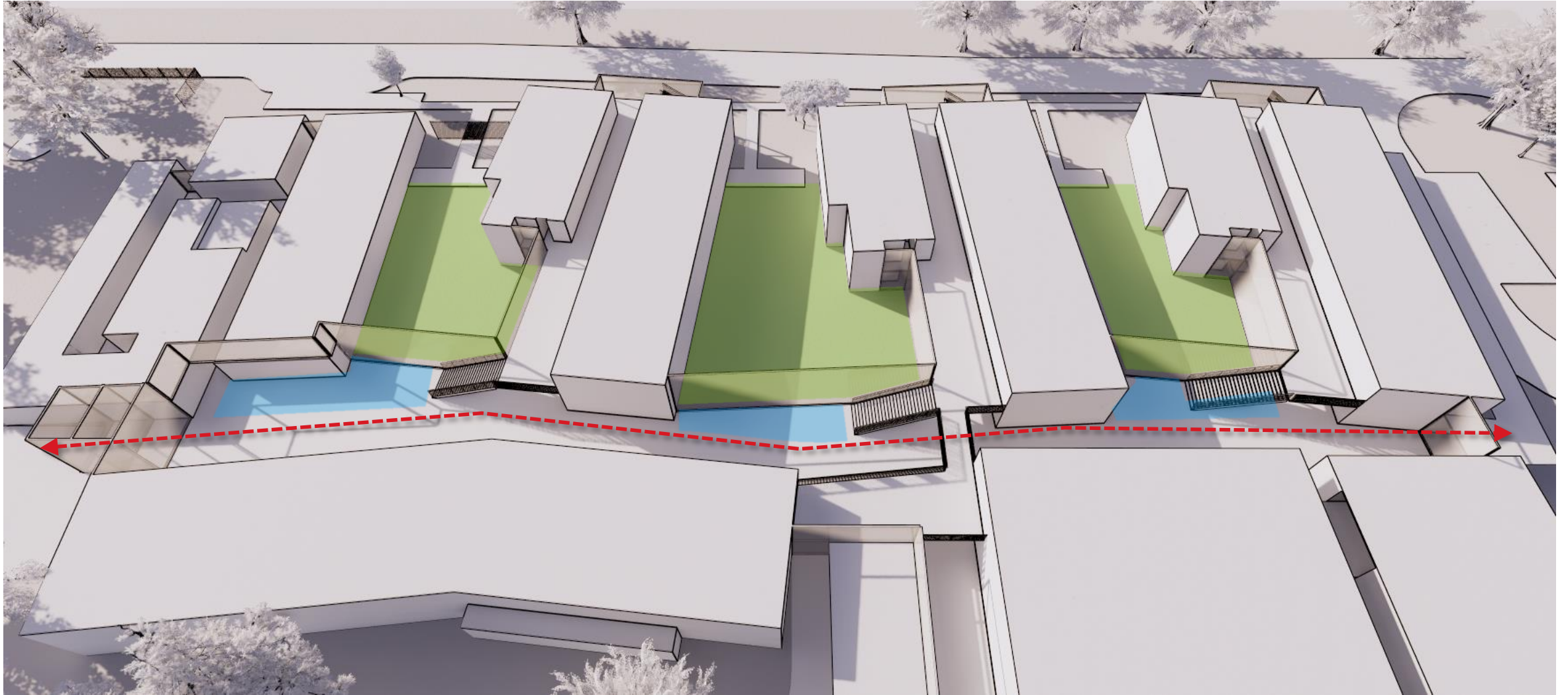

ORGANIC

Varied Evolving Experience
Dynamic – Energetic

Courtyards / Flex

ORTHOGONAL

Library

ORGANIC



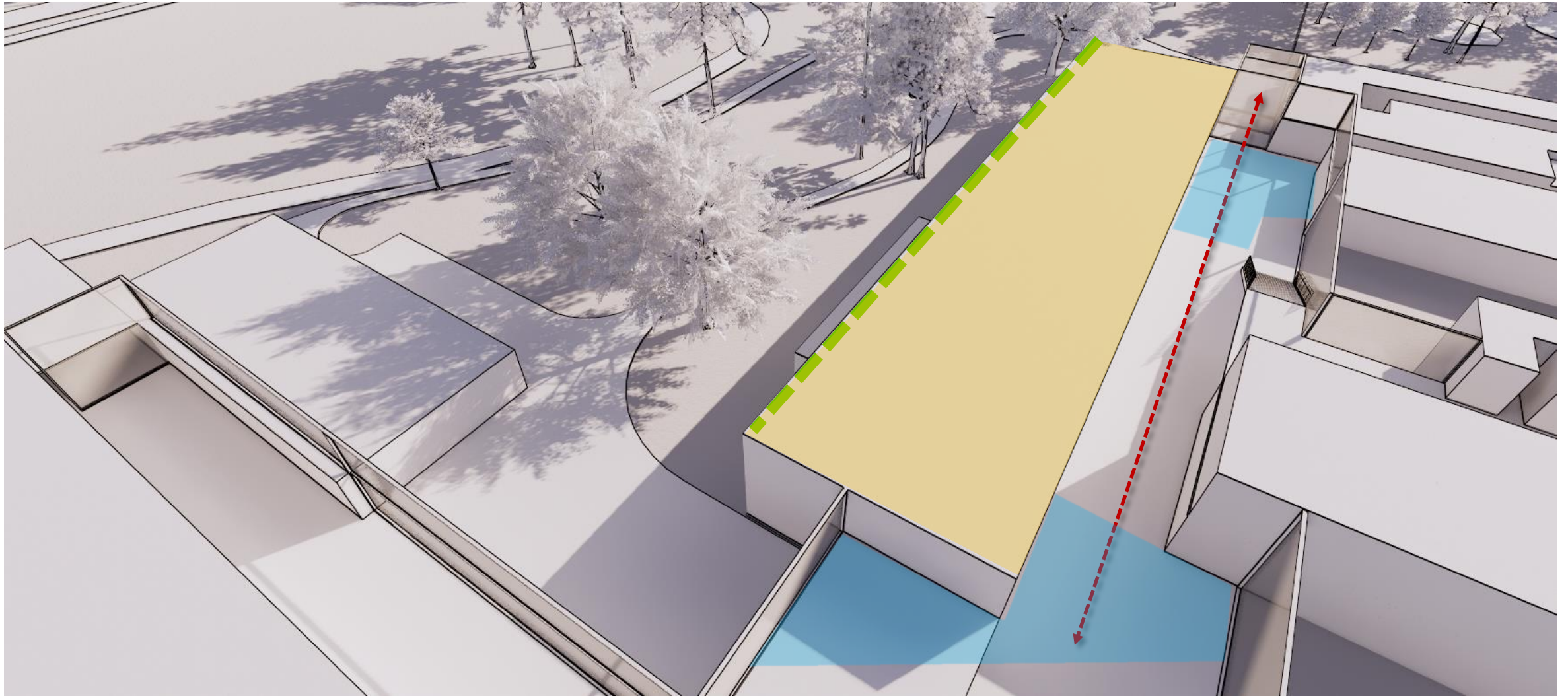

ORTHOGONAL

Bounds Learning Plaza
Contrasts Landscape

Library

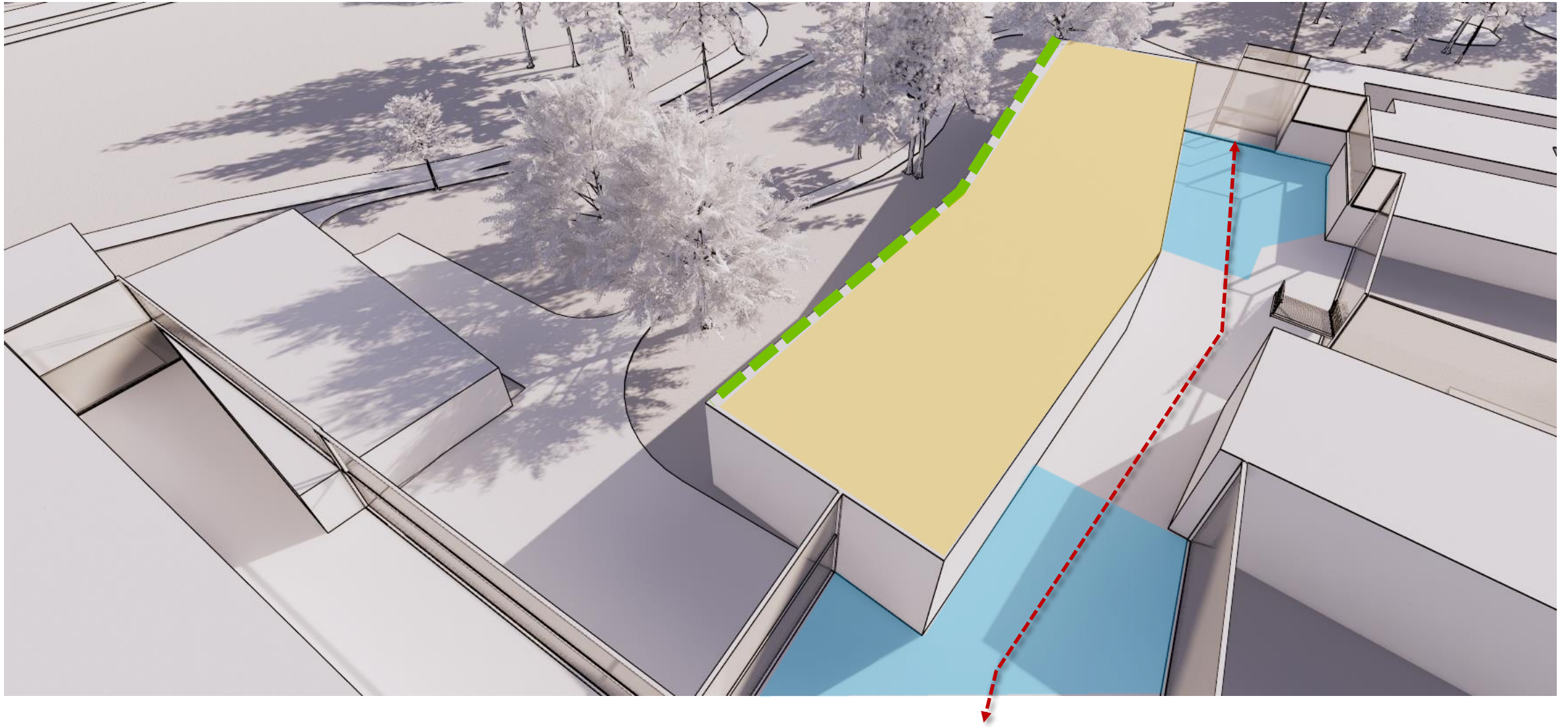

ORGANIC

Embraces Learning Plaza
Responds to Landscape

Library

ORTHOGONAL

Art + Science

ORGANIC

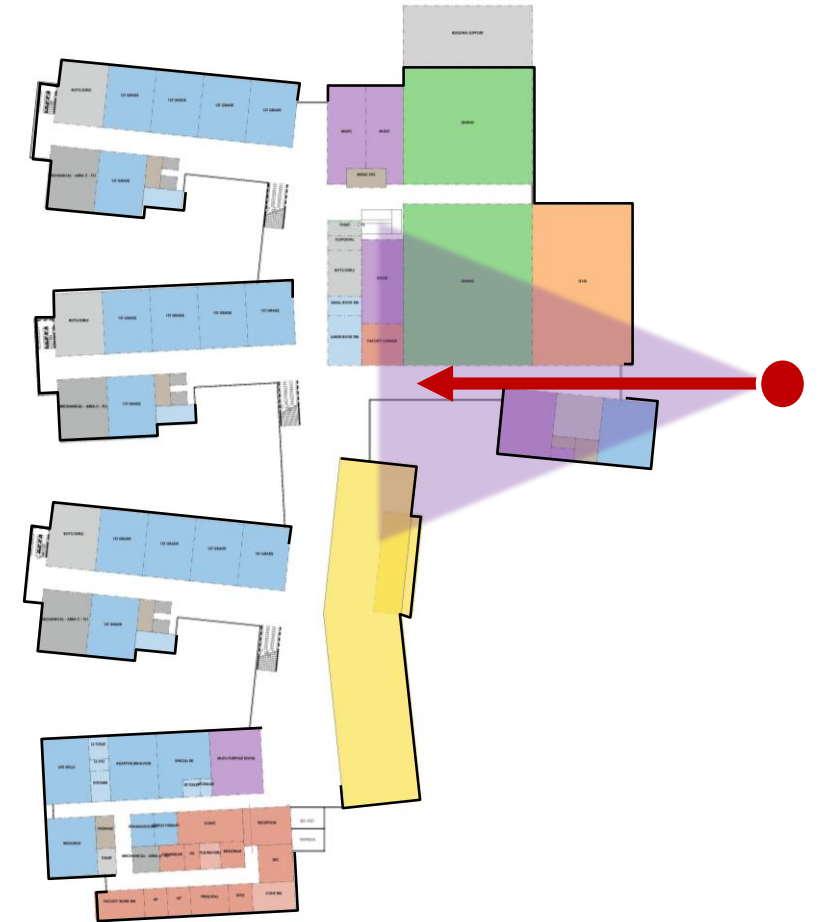
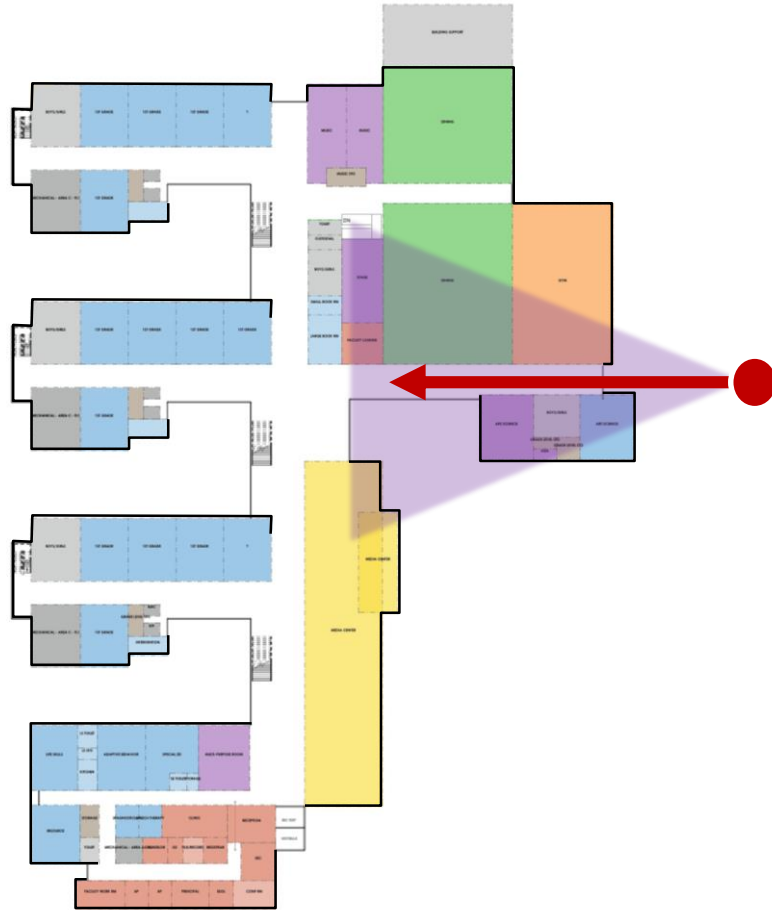

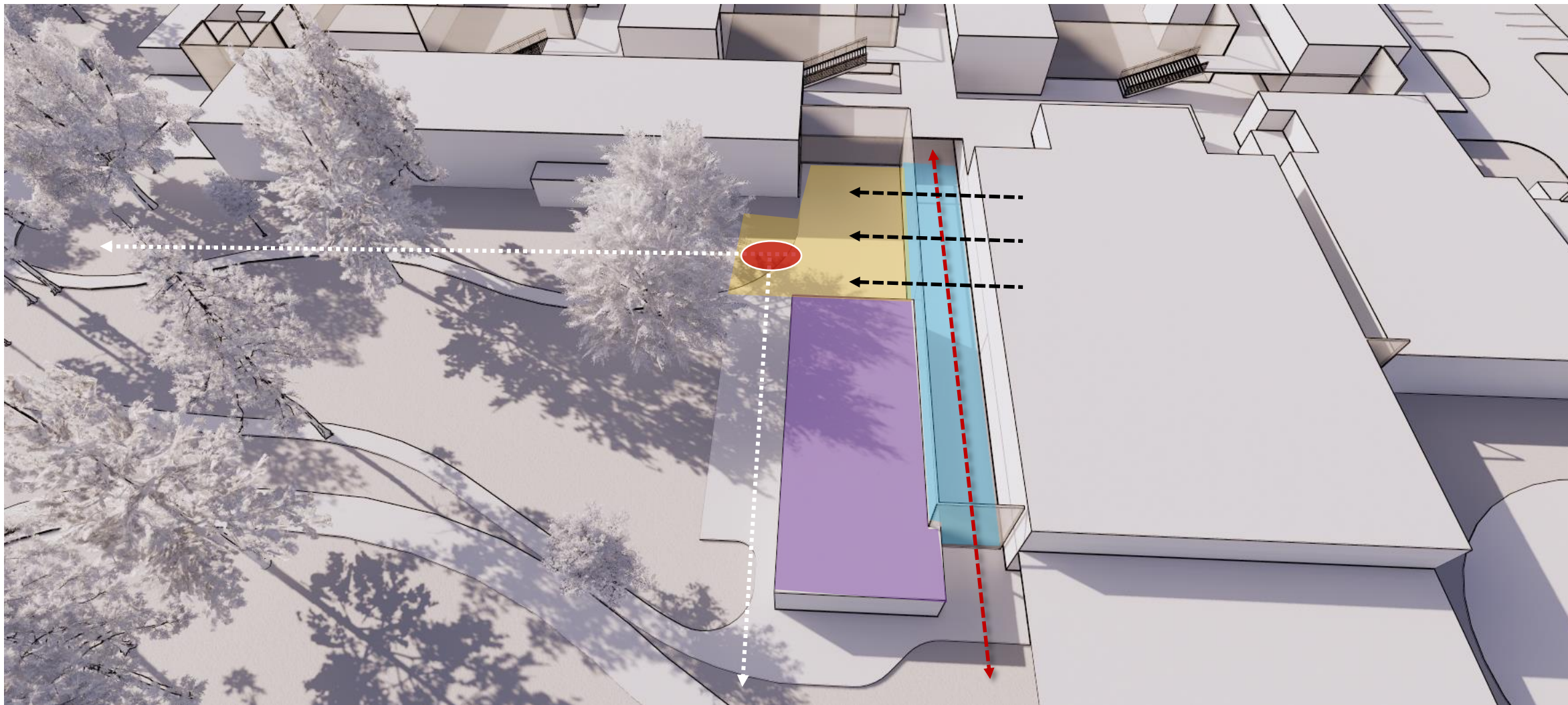

ORTHOGONAL

Rational – Rigid – Deliberate

Art + Science

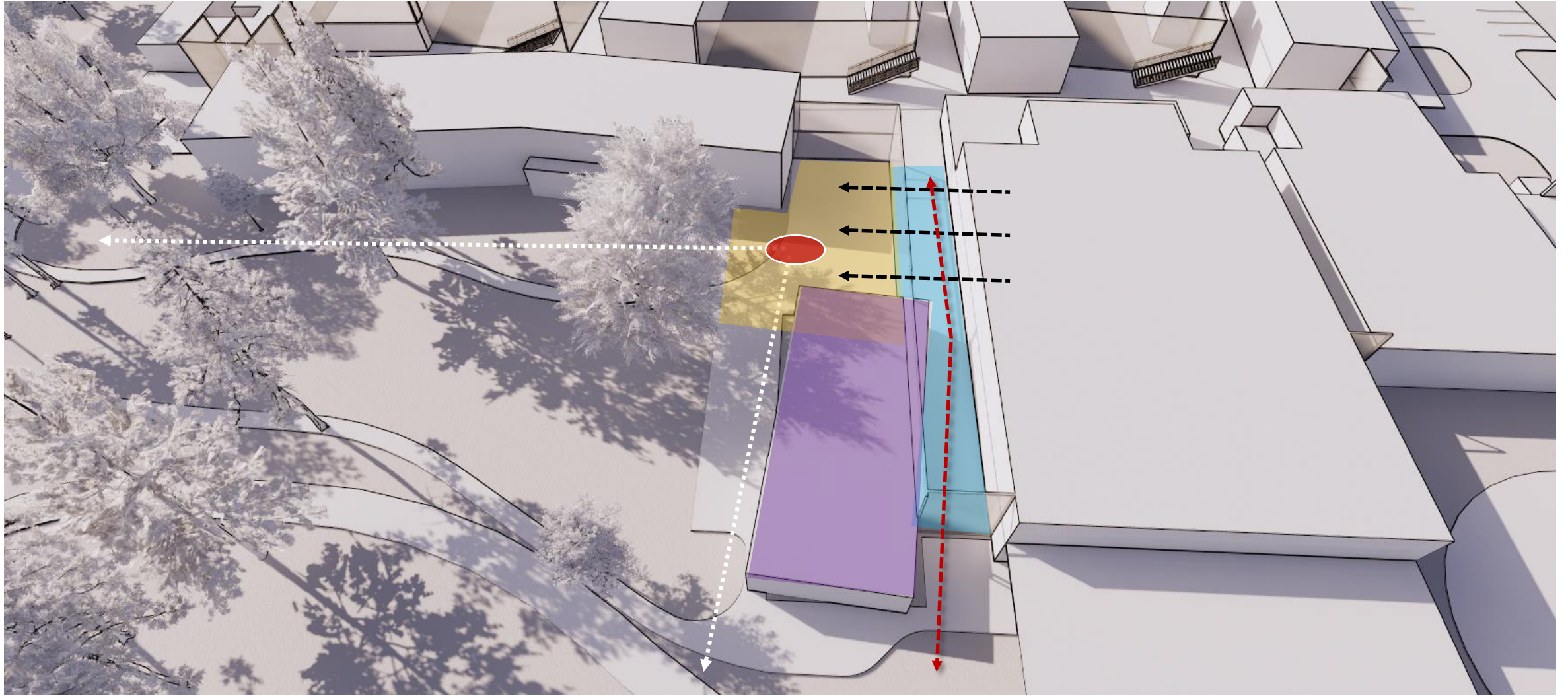

ORGANIC

Relaxed – Welcoming – Dynamic

Art + Science

ORTHOGONAL

Courtyards

ORGANIC



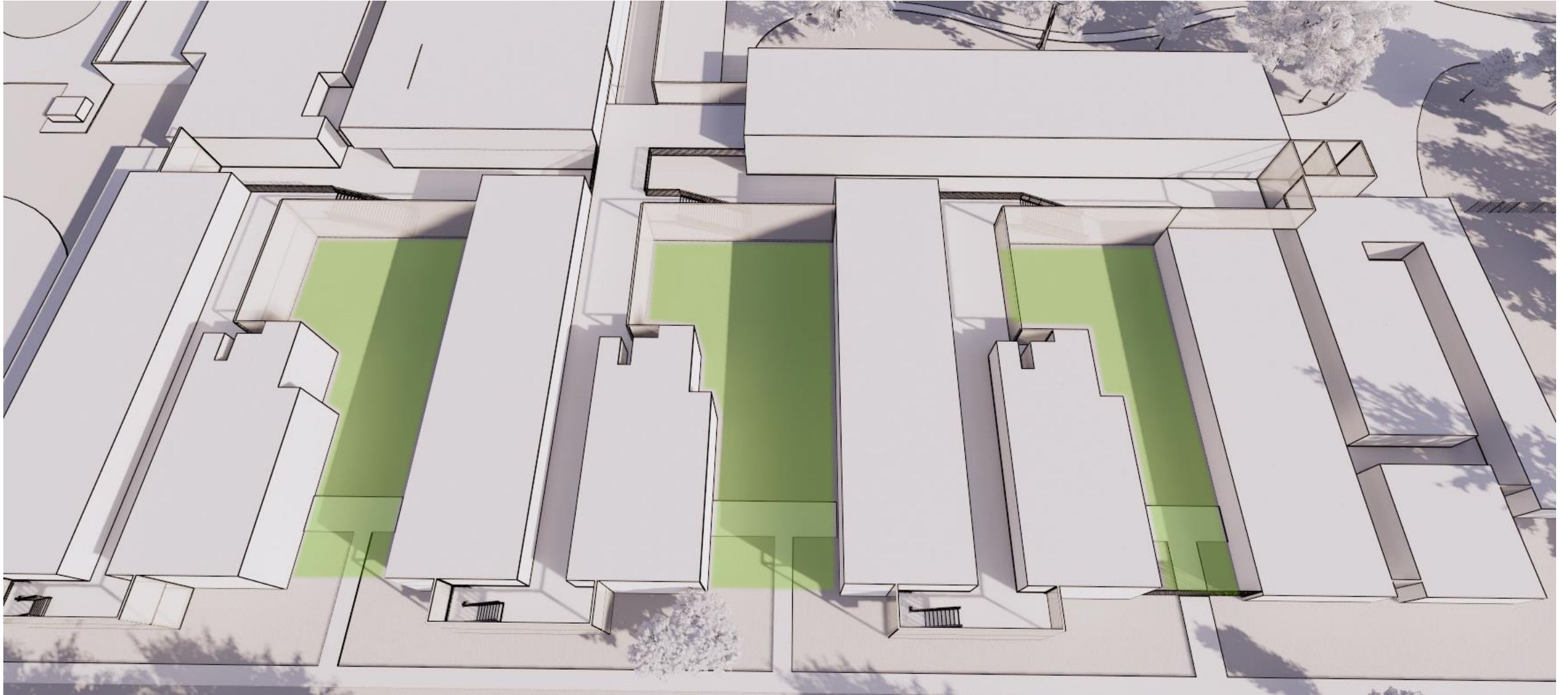

ORTHOGONAL

Structured – Modular – Identical

Courtyards

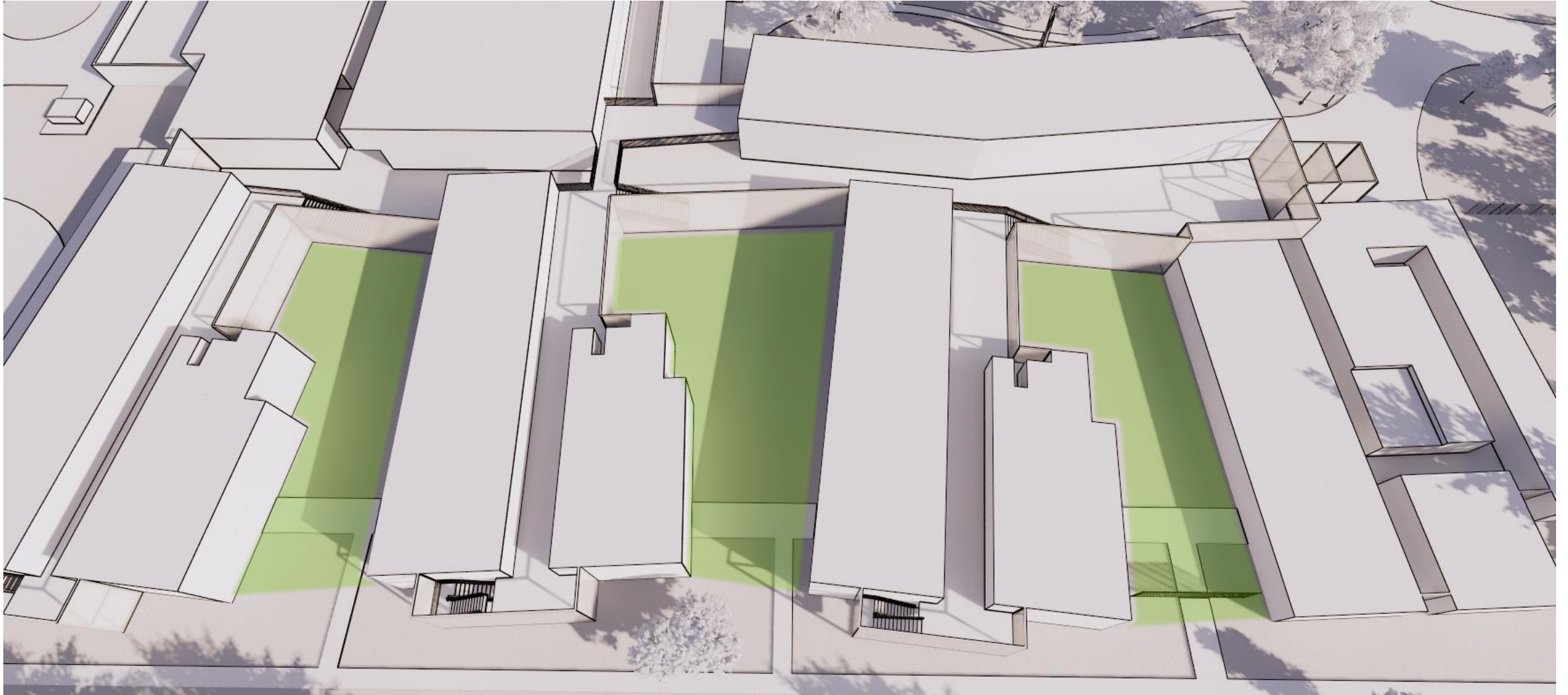

ORGANIC

Diverse – Individual – Distinct

Courtyards

ORTHOGONAL PLAN

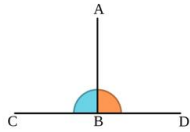

Formal – Rigid - Predictable



PAT Guiding Principles:

- 1. Open and Welcoming feeling.**
Inviting to and inclusive of the diverse community.
- 2. Embedded within Natural setting.**
Connected with views and access to walkable neighborhood.
- 3. Student centered and Parent involved.**
Celebrating excellence, achievement and tradition.
- 4. Flexible, Collaborative and Forward Thinking.**
Responsive to Teaching and Learning objectives over time.

Does the proposed plan meet the objectives of the BHE Guiding Principles?

Meets Objectives

☐☐

Does Not Meet

Preferred Concept for BHE

Orthogonal Plan

☐☐

Organic Plan

ORGANIC PLAN

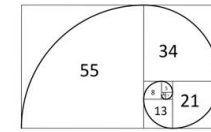

Natural - Relaxed – Free Flowing





Meeting Agenda:

- **Introductions / PAT Charge**
PAT Process Overview
Program Summary
 - **PAT Mtg #2 Recap**
Functional Relationship Diagrams (Site + Building)
Admin / Library Location Follow-up
 - **PAT Mtg #3 Focus: Building Organizational Concept**
SD Preliminary Concept: Site Plan, Floor Plan
Guiding Principles for Bunker Hill Design
PAT Input on SD Preliminary Concept
- • **Next PAT: March 31st / Closing Remarks**