

WELCOME TO WARRIORVILLE

NEW FAMILY GUIDE



LITTLE ROCK
CHRISTIAN
ACADEMY

THE BASICS

PARENT COMMUNICATION AT LRCA

We have multiple ways for you to receive information and stay in the loop!

LittleRockChristian.com: Our website is full of information, from athletic events to school news.

Warrior Weekly newsletter: You will receive a weekly e-newsletter sent every Monday. This will give you important information for the coming week.

- **The Warrior** is the magazine of LRCA, published twice a year. In it, you will find articles that tell the story of our school, from students to faculty to alumni.
- **FACTS Family Portal** is where you can check grades, view student billing accounts, stay current on school events, view food service details, and make payments.
- **New in August 2020!** The Little Rock Christian Academy App will give you all the features of FACTS Family Portal and more for iOS and Android devices. Look for it in the App Store.
- **TEXT ALERTS** are important school announcements sent to parents sent via SMS messaging.

FOOD SERVICE WITH SPROUTS

Elementary school students are offered the choice of the hot meal of the day, chicken nugget pack, or cold sandwich meal. Parents may order in advance through the FACTS app and may do so up to a month at a time. Each morning when class attendance is taken, your elementary student will be asked what they would like to order or if they brought their lunch. Your FACTS account will be charged based on food selections. Orders must be placed by 8:45 a.m.*

5th-8th Grade students will place their lunch selections using a Google order form link on their Chromebooks. Your FACTS account will be charged based on food selections. Orders must be placed by 8:45 a.m.*

High school students may select breakfast items on a first come, first served basis before school. Students will place their lunch selections using a Google order form link on their Chromebooks. Students may also order assorted smoothies, beverages, and snacks on a Google form. Snacks will be available for them to pick up during their break between classes. Your FACTS account will be charged based on food selections. Lunch orders must be placed by 8:45 a.m.*

*Food variety may increase as ADH restrictions are lifted.

We look forward to feeding your families. Should you have any questions, please contact Sprouts Food Service office at 501-975-3446 or email Sprouts@LittleRockChristian.com.

LRCA SOCIAL MEDIA

Join Warriorville on social media and stay connected!

 @lrcawarriors

 @little_rock_christian_academy

 @lrcawarriors

 LRCAWarriors

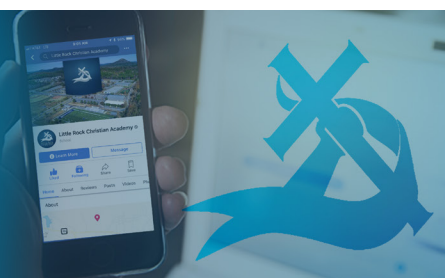

CAMPUS MAP

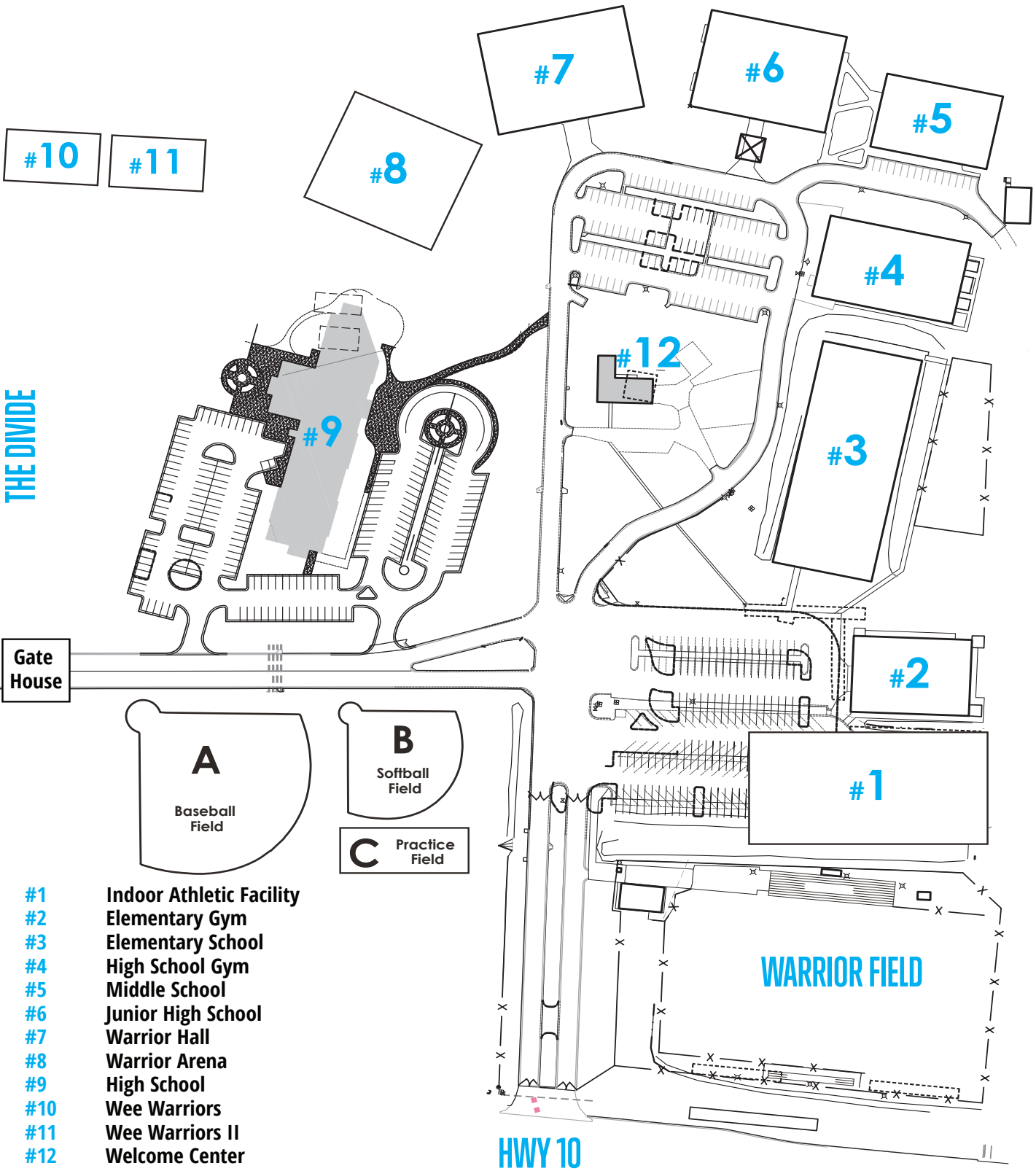

THE DIVIDE

Gate House

A
Baseball Field

B
Softball Field

C
Practice Field

WARRIOR FIELD

HWY 10

- #1 Indoor Athletic Facility
- #2 Elementary Gym
- #3 Elementary School
- #4 High School Gym
- #5 Middle School
- #6 Junior High School
- #7 Warrior Hall
- #8 Warrior Arena
- #9 High School
- #10 Wee Warriors
- #11 Wee Warriors II
- #12 Welcome Center

DIRECTORY

Main Number
868-9822

Elementary Office
410-1465
Tracie.Allred@LittleRockChristian.com

Middle School Office
975-3448
Lori.Kelley@LittleRockChristian.com

Junior High Office
975-3415
Delta.Bost@LittleRockChristian.com

High School Office
975-3425
Kim.Smith@LittleRockChristian.com

Warrior Hall
975-3410
Stephanie.Reeves@LittleRockChristian.com

Athletic Department
975-3432
Tammy.Harris@LittleRockChristian.com

Student Accounts
Lisa.Oden@LittleRockChristian.com

Technology
Technology.Staff@LittleRockChristian.com

Nurses Office
Nurses.Office@LittleRockChristian.com

Registrar
Kelly.South@LittleRockChristian.com



DROP OFF AND PICK UP TIMES:

Elementary School - 8:00 a.m. - 2:59 p.m. **(2:40 p.m. for families with only Elementary Students)**

Students 3 year old - 4th grade can be dropped off as early as 7:30 a.m. In the afternoon, students must be picked up within 30 minutes after school ends or they will be sent to After School Care, and a fee will be applied to your statement.

Middle School - 8:15 a.m. - 3:06 p.m.

Students arriving at 7:40 a.m. will enter through the MS cafeteria doors. At 7:50 a.m., or before if students can no longer be socially distant from one another, students will be dismissed to A1/B1 classrooms. Students arriving after 7:50 a.m. will enter through the south door of the MS or through the east doors of the JH and report immediately to A1/B1 classrooms. In the afternoon, they must be picked up within 30 minutes after school ends or they will be sent to After School Care, and a fee will be applied to your statement.

Junior High - 8:15 a.m. - 3:06 p.m.

Students can be dropped off as early as 30 minutes before school and will report to the Junior High building until being dismissed to their classes. In the afternoon, they must be picked up within 30 minutes after school ends or they will be sent to supervised study hall, and a fee will be applied to your statement.

High School - 8:15 a.m. - 3:15 p.m.

Students 9th-12th grade may arrive as early as 7:30 a.m. and should be picked up within 30 minutes of the end of school.

Students arriving after the morning start time will need to stop in the office and get a pass to class. For absences, please call the building directly, or email the contact for each building (see above under directory.)

PARENT HANDBOOK The Little Rock Christian Academy Handbook is available online (LittleRockChristian.com/Warriorville/Parents). There is a complete guide for school policies and procedures listed for each school.

PARENT COMMUNICATIONS

ADDRESS, E-MAIL, & PHONE NUMBER CHANGES

Families should keep the school updated of any changes in their contact information by emailing Kelly South at Kelly.South@LittleRockChristian.com.

DRESS CODE - Each school has their own dress code.

See these links with specific details:

[Elementary Dress Code](#)

[Middle School Dress Code](#)

[Junior High Dress Code](#)

[High School Dress Code](#)

LUNCH SCHEDULES:

Elementary-

Kindergarten: 11:45-12:05

1st: 12:00-12:20

2nd: 11:30-11:50

3rd: 12:30-12:50

4th: 12:15-12:35

Middle School (5th): 11:30 -11:50

Middle School (6th): 11:35 -11:55

Junior High (7th-8th): 12:00 -12:20

High School (11th-12th): 11:15 -11:45

High School (9th-10th): 11:45 -12:15

FACTS FAMILY PORTAL:

Student schedules, grades, report cards, lesson plans, homework, school directory, and financial information (including pre-paid food service accounts) are all available here: [FACTS Family Portal](#)

For student billing questions, please email Lisa.Oden@LittleRockChristian.com

TECHNOLOGY:

All students in grades 5-12 will receive school issued chromebooks. Technology training will occur either before they start school, or on their first day of school. Please forward any questions to Karen Stotts, Director of Educational Technology.

Karen.Stotts@LittleRockChristian.com

WARRIOR STORE (Located in building #1)

REGULAR STORE HOURS

M-F from 7:45 a.m. - 9 a.m. and 1:30 p.m. - 3:30 p.m.

The Warrior Store is a longstanding project of the Warrior Club. Store profits support LRCA athletic programs. Be sure to follow the Warrior Store on Instagram and Facebook! All major credit cards, cash, and checks are accepted.

And, the Warrior Store is now online! Beat the back to school rush and shop online. Ship directly to your home or take advantage of FREE curbside pick up.

Online Warrior Store Launching 7/27

Check it out today and outfit the Warriors in your family!

FALL 2020 KEY DATES

Key Dates	Event
Wed 8/19	1st Day of School Early Dismissal: EL @ Noon; MS/JH @ 12:06; HS @ 12:15
Mon 9/9	Labor Day-No School
Wed 9/16	Early Dismissal: EL @ 2:00; MS/JH @ 2:06; HS @ 2:15
Mon 10/12-10/13	Upper School Parent Teacher Conferences-No school JH/HS
Wed 10/14	Early Dismissal: EL @ 2:00-MS/7th Grade @ 2:06
Wed 10/14	PSAT Test: 8th-11th Grade: Dismissal at 12:30
Thur 10/15-10/16	Lower School Parent Teacher Conferences-No School EL/MS
Wed 11/11	Early Dismissal: EL @ 2:00; MS/JH @ 2:06; HS @ 2:15
Mon 11/23-11/27	Thanksgiving Break-No School
Wed 12/9	Early Dismissal: EL @ 2:00; MS/JH @ 2:06; HS @ 2:15
Fri 12/18	Last Day of First Semester
Mon 12/21-1/1/2021	Christmas Break

EL DROP OFF & PICK UP

IMPORTANT

The following plan has been **designed with your child's safety in mind**. There will be traffic personnel to direct you. Please follow their instructions and be "safety-minded." Use turn signals when entering parking areas.

Do not use cell phones in moving lines.
ALSO PLEASE REMEMBER WHILE ON CAMPUS THE SPEED LIMIT IS 15 MPH.
 We greatly appreciate your cooperation.

*School Day Hours:

K3-K5 (1/2 day) 8:00-11:45 a.m.
 Elementary (K3-4th grade) 8:00-2:59 p.m.
 (2:40 p.m. for families with only elementary students)
 Middle School/Junior High 8:15-3:06 p.m.
 High School 8:15-3:15 p.m.

K3-K5 Half Day Pick-Up: outside Warrior Gymnasium

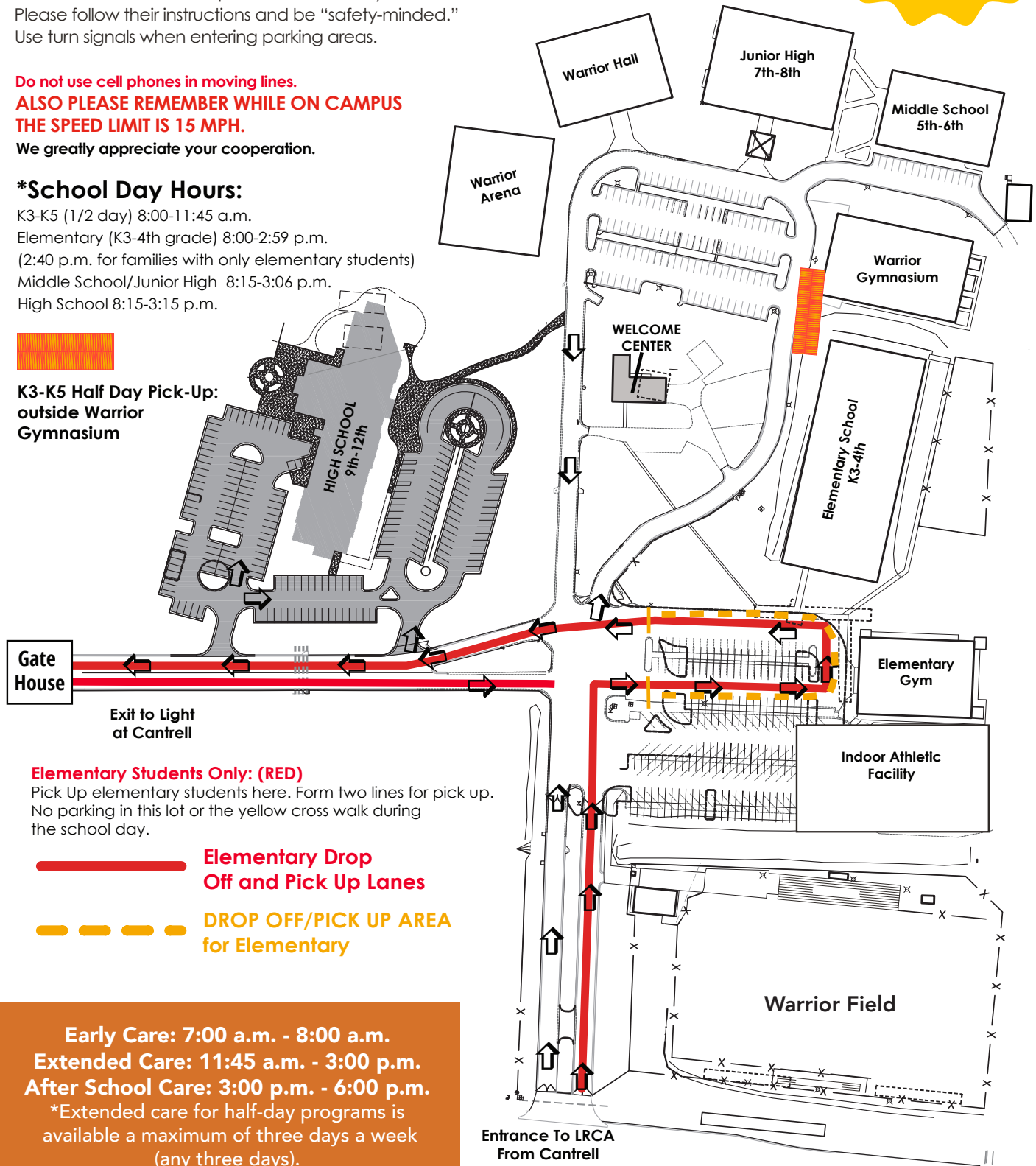

Elementary Students Only: (RED)

Pick Up elementary students here. Form two lines for pick up. No parking in this lot or the yellow cross walk during the school day.

- Elementary Drop Off and Pick Up Lanes**
- DROP OFF/PICK UP AREA for Elementary**

Early Care: 7:00 a.m. - 8:00 a.m.
Extended Care: 11:45 a.m. - 3:00 p.m.
After School Care: 3:00 p.m. - 6:00 p.m.
 *Extended care for half-day programs is available a maximum of three days a week (any three days).

Entrance To LRCA From Cantrell
 (right entrance lanes)

MS DROP OFF & PICK UP



The following plan has been **designed with your child's safety in mind**. There will be traffic personnel to direct you.

Please follow their instructions and be "safety-minded." Use turn signals when entering parking areas.

Do not use cell phones in moving lines.
ALSO PLEASE REMEMBER WHILE ON CAMPUS
THE SPEED LIMIT IS 15 MPH.

We greatly appreciate your cooperation.



MS
Pick-Up and
Drop-off
Pick up by
Advisory Class

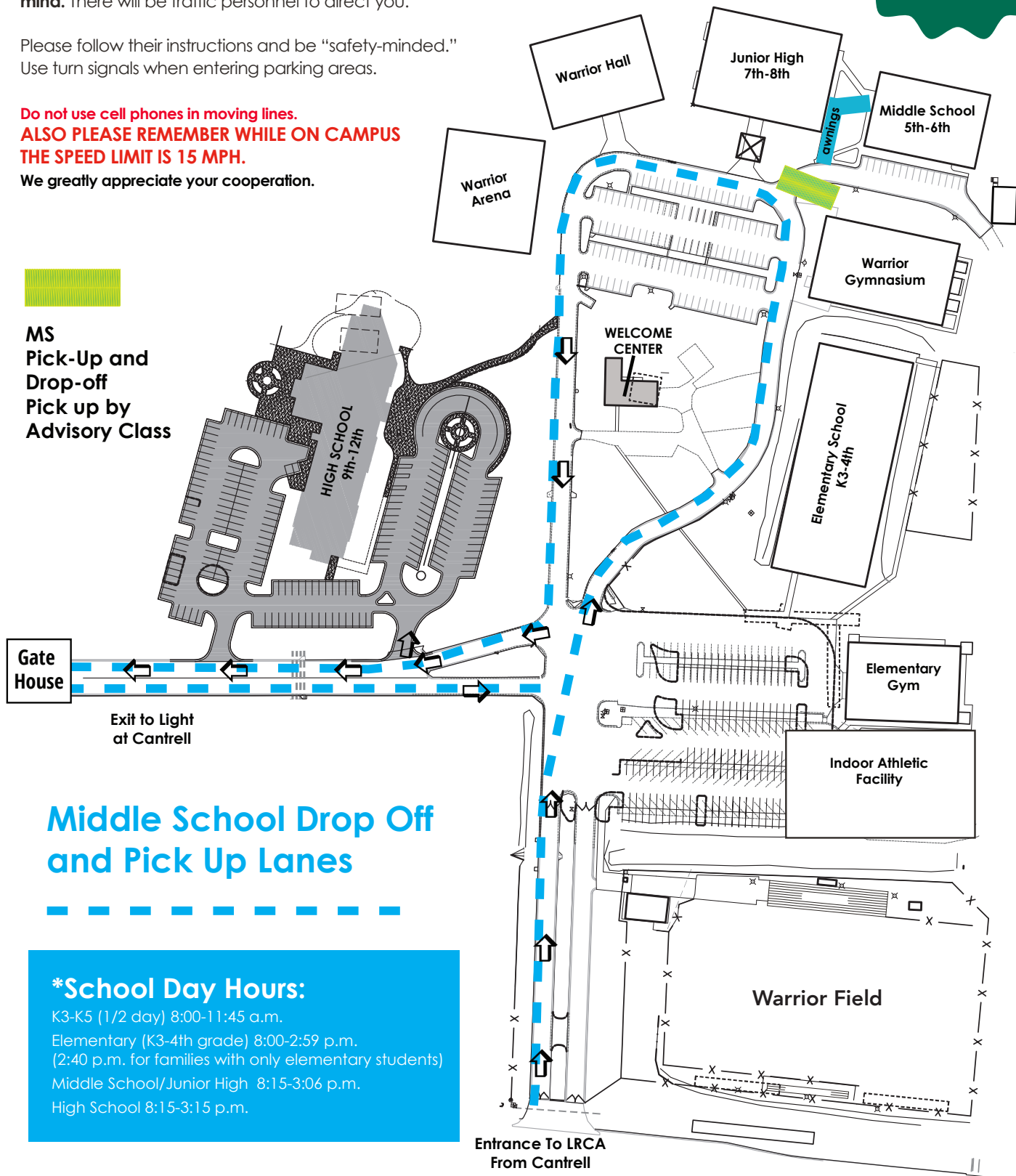

Middle School Drop Off and Pick Up Lanes



*School Day Hours:

- K3-K5 (1/2 day) 8:00-11:45 a.m.
- Elementary (K3-4th grade) 8:00-2:59 p.m.
(2:40 p.m. for families with only elementary students)
- Middle School/Junior High 8:15-3:06 p.m.
- High School 8:15-3:15 p.m.

Entrance To LRCA
From Cantrell

(left entrance lanes)

JH DROP OFF & PICK UP



The following plan has been **designed with your child's safety in mind**. There will be traffic personnel to direct you.

Please follow their instructions and be "safety-minded." Use turn signals when entering parking areas.

Do not use cell phones in moving lines.
ALSO PLEASE REMEMBER WHILE ON CAMPUS THE SPEED LIMIT IS 15 MPH.
 We greatly appreciate your cooperation.

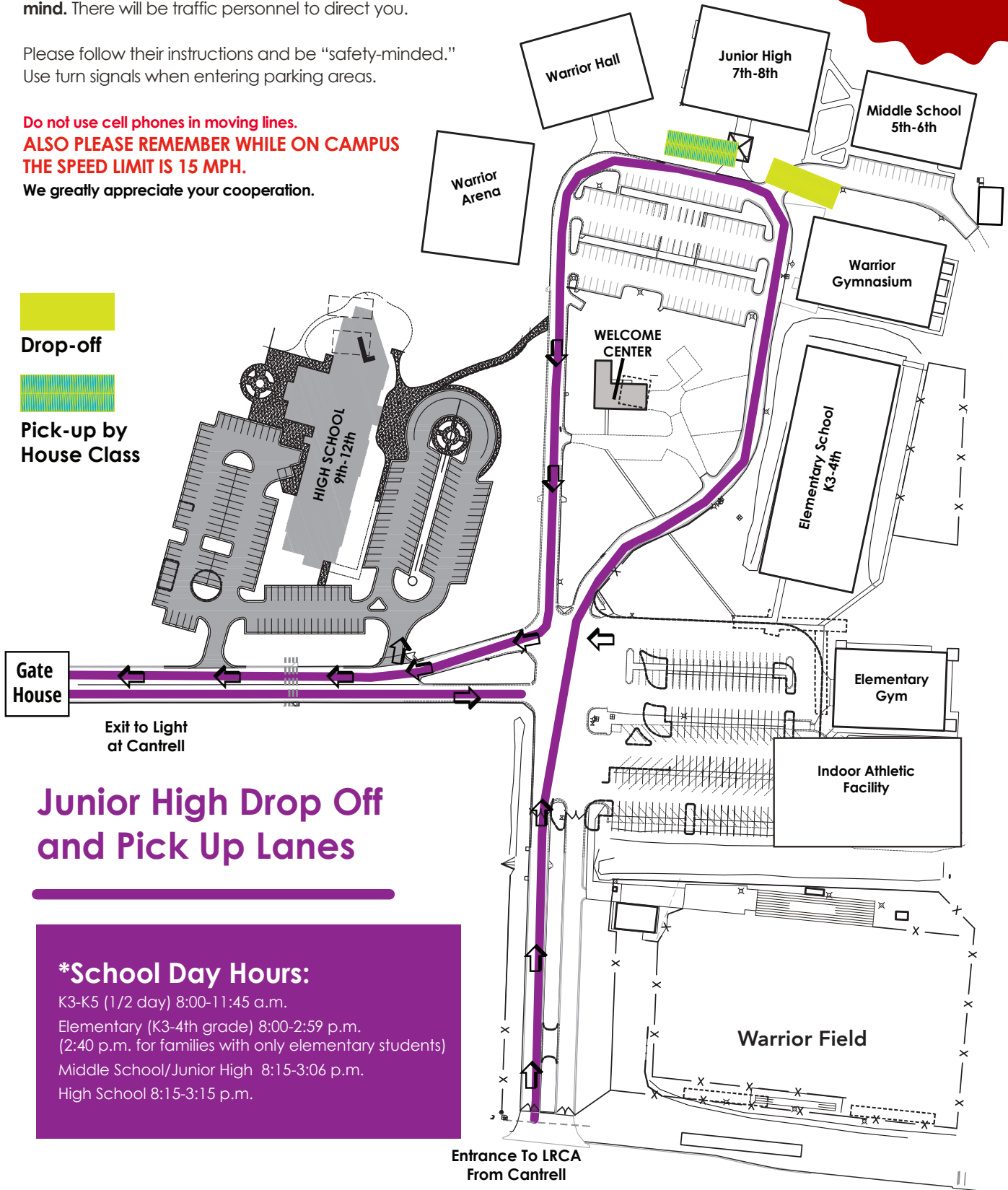

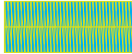
 Drop-off
 Pick-up by House Class

Junior High Drop Off and Pick Up Lanes

***School Day Hours:**
 K3-K5 (1/2 day) 8:00-11:45 a.m.
 Elementary (K3-4th grade) 8:00-2:59 p.m.
 (2:40 p.m. for families with only elementary students)
 Middle School/Junior High 8:15-3:06 p.m.
 High School 8:15-3:15 p.m.

Entrance To LRCA From Cantrell

(left entrance lanes)

HS DROP OFF & PICK UP

IMPORTANT

The following plan has been **designed with your child's safety in mind.** There will be traffic personnel to direct you.

Please follow their instructions and be "safety-minded." Use turn signals when entering parking areas.

Do not use cell phones in moving lines.
ALSO PLEASE REMEMBER WHILE ON CAMPUS
THE SPEED LIMIT IS 15 MPH.

We greatly appreciate your cooperation.

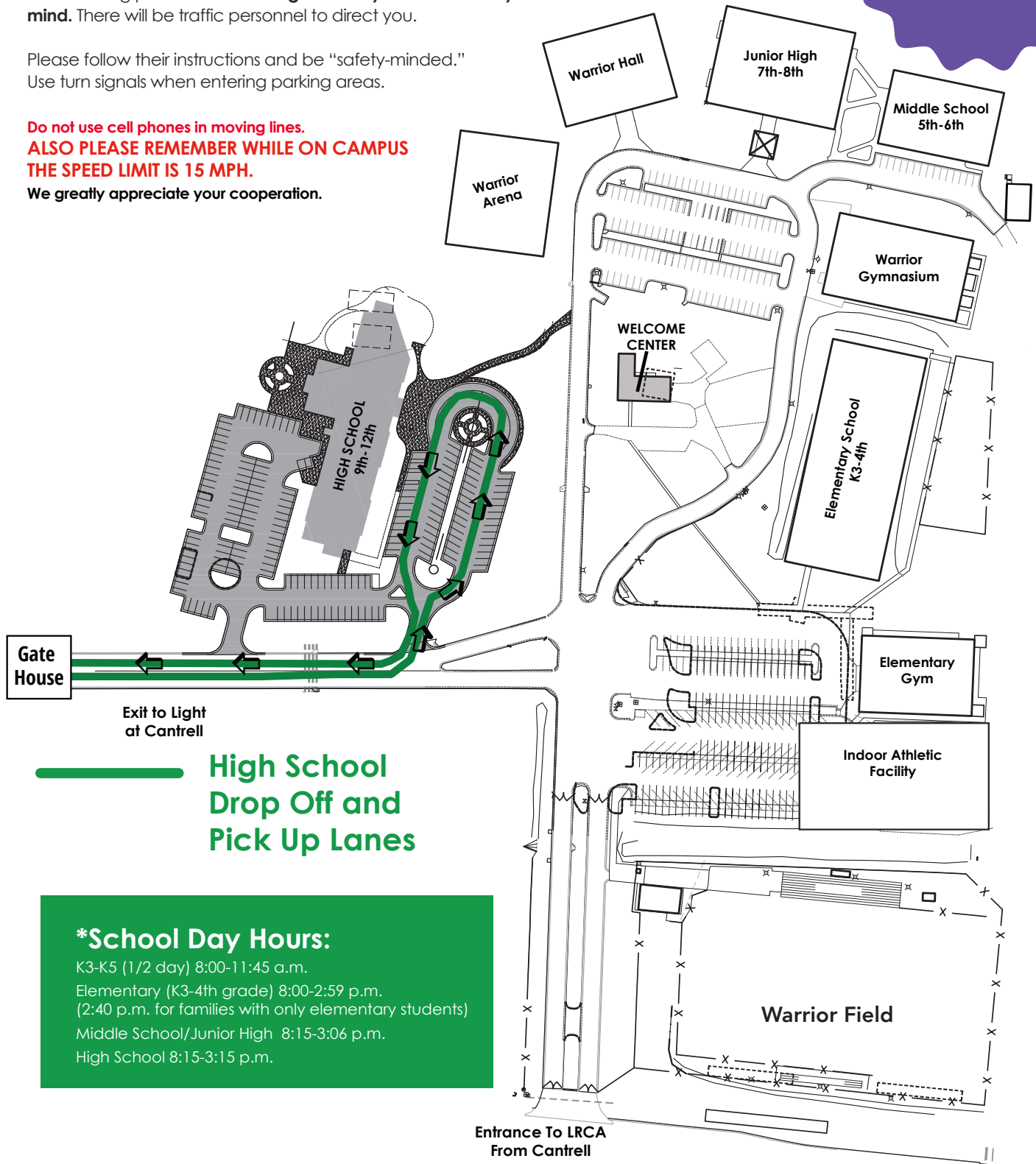

Exit to Light
at Cantrell

**High School
Drop Off and
Pick Up Lanes**

*School Day Hours:

K3-K5 (1/2 day) 8:00-11:45 a.m.
 Elementary (K3-4th grade) 8:00-2:59 p.m.
 (2:40 p.m. for families with only elementary students)
 Middle School/Junior High 8:15-3:06 p.m.
 High School 8:15-3:15 p.m.

Entrance To LRCA
From Cantrell

(left entrance lanes)

PARENT TEACHER FELLOWSHIP

The Parent Teacher Fellowship (PTF) was organized to enhance the relationship between LRCA families and the school. Its membership includes EVERY parent and teacher at LRCA. The PTF officers and committee chairmen serve under the direction of school leadership. Funds raised from PTF programs are given back to the school to enhance the Warrior experience in every grade and in every area of academics. If you would like additional information, please email lrca.ptf@gmail.com

PTF Projects Funded of the 2019-2020 School Year:

- Funding for Tuition Assistance
- Elementary Chapel Equipment
- Funding for necessary changes to security enhancements campus-wide
- Scholarship money to help qualifying families with the cost of Learner Services testing
- New books for K-4th grades
- Professional Development funds for Lower and Upper School faculty
- Gallery Supplies and Service Projects for Elementary Studio Arts
- Travel expenses paid for All-State high school students in Choir, Band, and Orchestra
- 2-Viewsonic interactive boards, Chromebooks and scanners for Learner Services
- Harkness tables and chairs for high school students
- Funding for Senior Capstone student research projects
- Flexible seating for the ARC in High School
- Collaborative learning style tables and chairs for Middle School and Junior High

PTF also joyfully provided many wonderful events and services at LRCA:

- Back to School Staff Fiesta
- Tears & Cheers Back to School Parent Reception
- Staff Christmas luncheons and gifts
- 3rd/4th grade Daddy/Daughter Dance
- 3rd/4th Grade Mom/Son Basketball Event
- Elementary Grandparents Day
- Middle School GLOW
- Middle School End-of-the-Year Event
- Junior High Social
- Junior High Promotion
- High School Donut Days
- Staff Appreciation Lunches
- Social media parent presentation
- Chick-fil-A Week
- Warrior 5K - \$5,000 tuition raffle
- Moms In Prayer
- Box Tops fundraiser
- School Tool Box sales
- Faculty & Staff meals and treats throughout the year

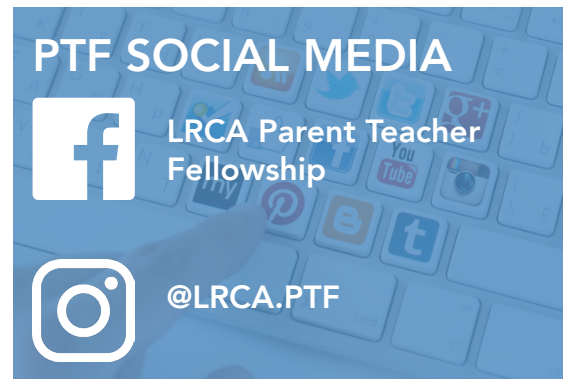

WARRIOR CLUB

The Warrior Fight Song rings through campus all year as 34 junior high and high school teams compete in various sports. All of those programs are supported financially (over and above the school's operating budget) by the Warrior Club.

Advertising, concession sales, and proceeds from the gates go directly to support student athletes. Warrior Club memberships and sponsorships, as well as proceeds from the Warrior Store and the annual golf tournament, also provide the funding required to develop competitive teams in the Arkansas Activities Association 5A classification.

This volunteer board oversees a budget used exclusively to back programs by equipping concession stands, funding bus transportation to athletic events, and training coaches; as well as purchasing uniforms, equipment, awards and celebrations for all sports. The Warrior Club also funds capital projects around campus, such as the new baseball bleachers, and keeps sports facilities up to date.

The Warrior Club board is comprised of dedicated LRCA parents led by President Fred Lord and Athletic Director Johnny Watson.

WARRIOR CLUB BOARD MEMBERS 2020-21

Fred Lord - President
Jared Hankins - Vice President
Mark Jansen - Treasurer
Scott Beardsley
Steve Carleson
Leigh Anne Chrisman
Todd Denton
Schawnee Hightower
Kevin Jones
Tom Lee
Mark McCaslin
Scott McElmurry
Danny Newton
Cedric Pratt
Alice Rogers
Kim Schrader
Jason Smith
Rodney Staggs
Johnny Watson
Chad Wilkerson
Ernie Woodard

WARRIOR STORE HOURS

M-F from 7:45 - 9 a.m.
and 1:30 -3:30 p.m.

Shop the Warrior
Store Online!

**CHEER, CHEER
FOR LRCA, NAVY AND
GREEN WILL GO ALL THE
WAY!**

**FRIDAY NIGHTS WILL
BE THE BEST 'CAUSE
WARRIORS WILL STAND
THE TEST!**

**WE LOVE OUR SCHOOL
AND OUR TEAM; BEING
A WARRIOR IS OUR
BIGGEST DREAM.**

**ALL THE WARRIORS
PROUDLY SAY WE ARE
THE SCHOOL OF THE
WARRIOR WAY!**

