

# Irvin ES, HS Athletics, & Roesler Construction Update

October 15, 2018



# Irvin Elementary School Construction Update





# Area 3 Slab Pour (Irvin ES)



# Area 3 Slab Pour (Irvin ES)





# Crane and Lift Delivery for Steel Erection (Irvin ES)



# Schedule Update Irvin ES

- First delivery of steel joists and deck was on Wednesday 10/10.
- Reminder of north paving will be poured on 10/19 (Friday) weather permitting
- Pour Kitchen slab on 10/18 (Thursday) weather permitting.
- Structural steel erection to begin this week.
- 13 total rain days since August 1.



# Site Drone Photo 10/12/2018





**Completed Concrete (Irvin ES)**

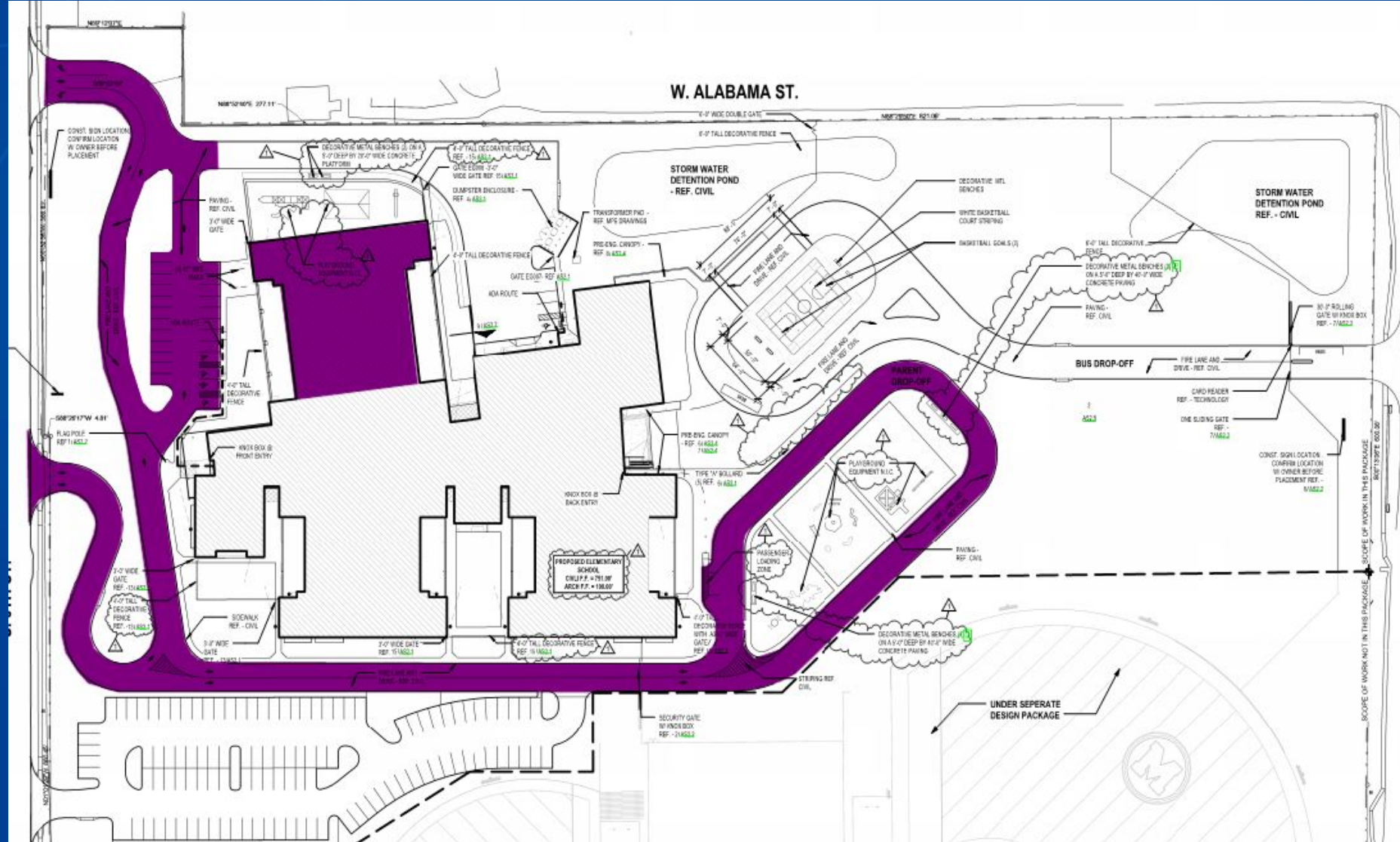



## MISD Drone Video



# High School Athletics Construction Update





# CMU at Field House and Ticket Booth (HS Athletics)



# Baseball Light Poles (HS Athletics)





# Site Drone Photo 10/12/2018





# Look Ahead Schedule HS Athletics

- Continue CMU installation at fieldhouse and ticketbooth.
- Install light poles at softball and baseball fields.
- Install fence posts at softball and baseball fields.
- Installation of drainage system at both fields.



## MISD Drone Video



# Roesler Athletics Construction Update

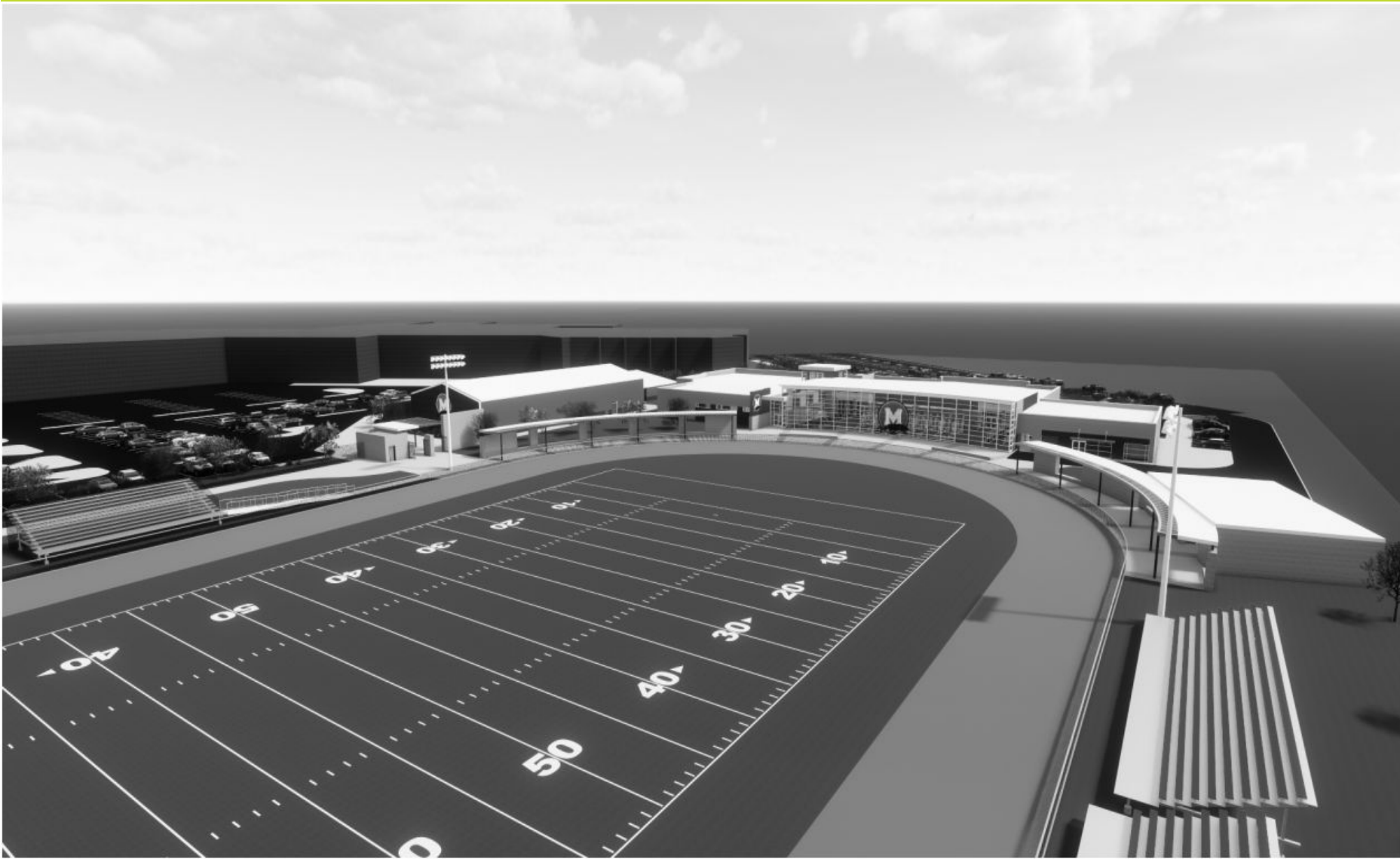



# Primary Electric Service Relocation (Roesler)





## Temporary Fence (Roesler)





# Look Ahead Schedule (Roesler Athletic Complex)

- Site construction fencing is installed.
- Private utility location in progress.
- Site demolition will begin Friday 10/19.
- Earthwork and site utilities will begin at the end of next week.

# Thank You

