

**FARE**

Food Allergy Research & Education

FOOD ALLERGY & ANAPHYLAXIS EMERGENCY CARE PLAN

Name: _____ D.O.B.: _____

Allergy to: _____

Weight: _____ lbs. Asthma: [] Yes (higher risk for a severe reaction) [] No

**PLACE
PICTURE
HERE****NOTE: Do not depend on antihistamines or inhalers (bronchodilators) to treat a severe reaction. USE EPINEPHRINE.****Extremely reactive to the following foods:** _____

THEREFORE:

[] If checked, give epinephrine immediately for ANY symptoms if the allergen was likely eaten.

[] If checked, give epinephrine immediately if the allergen was definitely eaten, even if no symptoms are noted.

FOR ANY OF THE FOLLOWING:

SEVERE SYMPTOMS**LUNG**Short of breath,
wheezing,
repetitive cough**HEART**Pale, blue,
faint, weak
pulse, dizzy**THROAT**Tight, hoarse,
trouble
breathing/
swallowing**MOUTH**Significant
swelling of the
tongue and/or lips**SKIN**Many hives over
body, widespread
redness**GUT**Repetitive
vomiting, severe
diarrhea**OTHER**Feeling
something bad is
about to happen,
anxiety, confusion**OR A
COMBINATION**
of symptoms
from different
body areas.

- 1. INJECT EPINEPHRINE IMMEDIATELY.**
- 2. Call 911.** Tell them the child is having anaphylaxis and may need epinephrine when they arrive.
 - Consider giving additional medications following epinephrine:
 - » Antihistamine
 - » Inhaler (bronchodilator) if wheezing
 - Lay the person flat, raise legs and keep warm. If breathing is difficult or they are vomiting, let them sit up or lie on their side.
 - If symptoms do not improve, or symptoms return, more doses of epinephrine can be given about 5 minutes or more after the last dose.
 - Alert emergency contacts.
 - Transport them to ER even if symptoms resolve. Person should remain in ER for at least 4 hours because symptoms may return.

MILD SYMPTOMS**NOSE**Itchy/runny
nose,
sneezing**MOUTH**

Itchy mouth

**SKIN**A few hives,
mild itch**GUT**Mild nausea/
discomfortFOR **MILD SYMPTOMS FROM MORE THAN ONE
SYSTEM AREA**, GIVE EPINEPHRINE.FOR **MILD SYMPTOMS FROM A SINGLE SYSTEM
AREA**, FOLLOW THE DIRECTIONS BELOW:

1. Antihistamines may be given, if ordered by a healthcare provider.
2. Stay with the person; alert emergency contacts.
3. Watch closely for changes. If symptoms worsen, give epinephrine.

MEDICATIONS/DOSESPlease attach a separate medication
order for each medicine indicated
below that supports this plan:

- Epinephrine [] 0.15mg [] 0.3 mg
- Antihistamine
- Inhaler

PARENT/GUARDIAN AUTHORIZATION SIGNATURE

DATE

PHYSICIAN/HCP AUTHORIZATION SIGNATURE

DATE



EPIPEN® (EPINEPHRINE) AUTO-INJECTOR DIRECTIONS

1. Remove the EpiPen Auto-Injector from the plastic carrying case.
2. Pull off the blue safety release cap.
3. Swing and firmly push orange tip against mid-outer thigh.
4. Hold for approximately 10 seconds.
5. Remove and massage the area for 10 seconds.

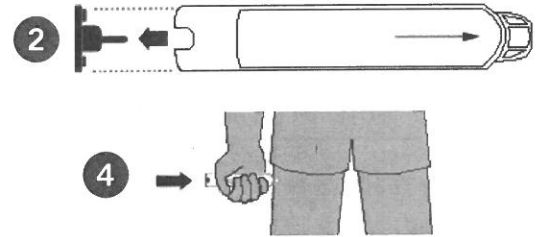

AUVI-Q™ (EPINEPHRINE INJECTION, USP) DIRECTIONS

1. Remove the outer case of Auvi-Q. This will automatically activate the voice instructions.
2. Pull off red safety guard.
3. Place black end against mid-outer thigh.
4. Press firmly and hold for 5 seconds.
5. Remove from thigh.

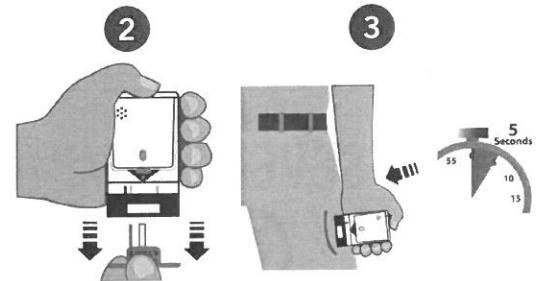

ADRENACLICK®/ADRENACLICK® GENERIC DIRECTIONS

1. Remove the outer case.
2. Remove grey caps labeled "1" and "2".
3. Place red rounded tip against mid-outer thigh.
4. Press down hard until needle penetrates.
5. Hold for 10 seconds. Remove from thigh.



OTHER DIRECTIONS/INFORMATION (may self-carry epinephrine, may self-administer epinephrine, etc.):

Treat the person before calling emergency contacts. The first signs of a reaction can be mild, but symptoms can get worse quickly.

EMERGENCY CONTACTS — CALL 911

RESCUE SQUAD: _____
DOCTOR: _____ PHONE: _____
PARENT/GUARDIAN: _____ PHONE: _____

OTHER EMERGENCY CONTACTS

NAME/RELATIONSHIP: _____
PHONE: _____
NAME/RELATIONSHIP: _____
PHONE: _____

PARENT/GUARDIAN AUTHORIZATION SIGNATURE

DATE



Orange County Department of Education
Instructional Services

PARENT/GUARDIAN AND AUTHORIZED HEALTH CARE PROVIDER REQUEST FOR MEDICATION

Name of Student: Birthdate: School/District: Teachers Name: Grade/Track:

PARENT/GUARDIAN REQUEST FOR THE ADMINISTRATION OF MEDICATION
PRESCRIPTION AND NONPRESCRIPTION

California Education Code Section, 49423 allows the school nurse or other designated non-medical school personnel to assist students who are required to take medication during the school day.

I request that medication be administered to my child in accordance with our authorized health care provider written instructions. I understand that designated non-medical school personnel may assist in carrying out written orders under supervision of a qualified School Nurse.

Emergency medicine such as EpiPen or inhalers may be carried by the student when recommended by an authorized health care provider and parent. Back-up medication should be kept at school for emergency use.

Parent/Guardian Signature: Date:

Telephone: (Work) (Home)

AUTHORIZED HEALTH CARE PROVIDER REQUEST FOR ADMINISTRATION OF MEDICATION

Reason for Medication:

Medication: Dose: mg. Route: Time:

If PRN: Amount of time between doses Maximum number of doses per day.

Possible medication reactions:

Instructions for emergency care

Authorized Health Care Provider Signature:

Authorized Health Care Provider Name (print clearly):

Telephone

Date of Request:

Date to Discontinue Medication:



Office Stamp

Regarding EpiPen/Inhalers: It is my professional opinion that this student should be permitted to carry/self administer this emergency Inhaler/EpiPen. This student has been instructed in, and demonstrates an understanding of proper usage.

Health Care Provider Initials

SCHOOL USE:

Reviewed by: Date:

This request is valid for a maximum of one year.



Orange County Department of Education
Instructional Services

***PARENT NOTIFICATION FOR THE
ADMINISTRATION OF MEDICINE AT SCHOOL***

Name of Student: _____

TO THE PARENT/GUARDIAN:

Medical treatment is the responsibility of the parent/guardian and an authorized health care provider. An authorized health care provider is an individual who is licensed by the State of California to prescribe medication. **Medications, both prescription and over the counter**, may be given at school when it is deemed absolutely necessary by the authorized health care provider that the medication be given during school hours. **The parent/guardian is urged, with the help of your child's authorized health care provider, to work out a schedule of giving medication at home whenever possible.**

California Education Code, Section 49423 allows school personnel to assist in carrying out an authorized health care providers written orders. Designated non-medical school personnel may be assisting with your child's medication. They will be trained and supervised by credentialed school nurses. Medication will be safely stored and locked or refrigerated, if required.

Emergency medicine such as EpiPens or inhalers may be carried by the student **when recommended by a authorized health care provider and parent**. When appropriate, the school nurse will evaluate the student's ability to safely self-administer the medication based on written district guidelines. (Title 5). Back up medication should be kept at school for emergency use. Students who have a serious medical condition (diabetes, epilepsy, etc.) should have an emergency supply of their prescription medication at school with the appropriate consent forms in the event of a disaster.

**IF MEDICATION IS TO BE ADMINISTERED AT SCHOOL, ALL OF THE FOLLOWING
CONDITIONS MUST BE MET:**

1. A written statement signed by the licensed authorized health care provider/dentist specifying the reason for the medication, the name, dosage, time, route, side effect; and specific instructions for emergency treatment must be on file at school.
2. A signed request from the parent/guardian must be on file at school.
3. Medication must be delivered to the school by the parent/guardian or other responsible adult.
4. Medication must be in your child's original, labeled pharmacy container written in English.
5. All liquid medication must be accompanied by an appropriate measuring device.
6. If pill splitting is required to obtain the correct dose of medication to be administered, only pills that are scored may be split, scored pills may be split in half only, and a commercial pill splitting device should be used for correct splitting.
7. Over the counter medication that has been prescribed by an authorized health care provider must be in its original container.
8. A separate form is required for each medication.

NOTE: Whenever there is a change in medication, dosage, time, or route the parent/guardian and authorized health care provider must complete a new form. Please discuss your authorized health care provider's instructions with your child, so that he/she is aware of the time medication is due at school.

This request is valid for a maximum of one year.



Orange County Department of Education
Instructional Services

PARENT/GUARDIAN AND AUTHORIZED HEALTH CARE PROVIDER REQUEST FOR MEDICATION

Name of Student: Birthdate:
School/District: Teachers Name: Grade/Track:

PARENT/GUARDIAN REQUEST FOR THE ADMINISTRATION OF MEDICATION
PRESCRIPTION AND NONPRESCRIPTION

California Education Code Section, 49423 allows the school nurse or other designated non-medical school personnel to assist students who are required to take medication during the school day.

I request that medication be administered to my child in accordance with our authorized health care provider written instructions. I understand that designated non-medical school personnel may assist in carrying out written orders under supervision of a qualified School Nurse.

Emergency medicine such as EpiPen or inhalers may be carried by the student when recommended by an authorized health care provider and parent. Back-up medication should be kept at school for emergency use.

Parent/Guardian Signature: Date:

Telephone: (Work) (Home)

AUTHORIZED HEALTH CARE PROVIDER REQUEST FOR ADMINISTRATION OF MEDICATION

Reason for Medication:

Medication: Dose: mg. Route: Time:

If PRN: Amount of time between doses Maximum number of doses per day.

Possible medication reactions:

Instructions for emergency care

Authorized Health Care Provider Signature:

Authorized Health Care Provider Name (print clearly):

Telephone

Date of Request:

Date to Discontinue Medication:

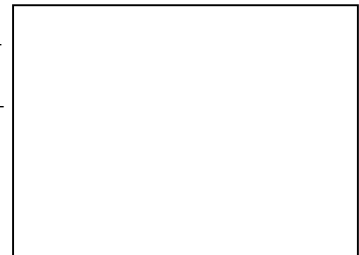

Office Stamp

Regarding EpiPen/Inhalers: It is my professional opinion that this student should be permitted to carry/self administer this emergency Inhaler/EpiPen. This student has been instructed in, and demonstrates an understanding of proper usage.

Health Care Provider Initials

SCHOOL USE:

Reviewed by: Date:

This request is valid for a maximum of one year.



Inhaler

Orange County Department of Education
Instructional Services

PARENT/GUARDIAN AND AUTHORIZED HEALTH CARE PROVIDER REQUEST FOR MEDICATION

Name of Student: Birthdate:
School/District: Teachers Name: Grade/Track:

PARENT/GUARDIAN REQUEST FOR THE ADMINISTRATION OF MEDICATION
PRESCRIPTION AND NONPRESCRIPTION

California Education Code Section, 49423 allows the school nurse or other designated non-medical school personnel to assist students who are required to take medication during the school day.

I request that medication be administered to my child in accordance with our authorized health care provider written instructions. I understand that designated non-medical school personnel may assist in carrying out written orders under supervision of a qualified School Nurse.

Emergency medicine such as EpiPen or inhalers may be carried by the student when recommended by an authorized health care provider and parent. Back-up medication should be kept at school for emergency use.

Parent/Guardian Signature: Date:

Telephone: (Work) (Home)

AUTHORIZED HEALTH CARE PROVIDER REQUEST FOR ADMINISTRATION OF MEDICATION

Reason for Medication:

Medication: Dose: Route: Time:

If PRN: Amount of time between doses Maximum number of doses per day.

Possible medication reactions:

Instructions for emergency care

Authorized Health Care Provider Signature:

Authorized Health Care Provider Name (print clearly):

Telephone

Date of Request:

Date to Discontinue Medication:



Office Stamp

Regarding EpiPen/Inhalers: It is my professional opinion that this student should be permitted to carry/self administer this emergency Inhaler/EpiPen. This student has been instructed in, and demonstrates an understanding of proper usage.

Health Care Provider Initials

SCHOOL USE:

Reviewed by: Date:

This request is valid for a maximum of one year.