



Westport HS

Neighborhood Meeting 01-14-19



Neighborhood Meetings

- 01/14/2019
- 12/03/2018
- 11/05/2018
- 10/01/2018
- 07/09/2018
- 12/19/2017
- 11/14/2017



Parking /
Retail

Existing
WHS
School

Related
Development

Community Green
Space

Neighborhood

Conceptual Rendering

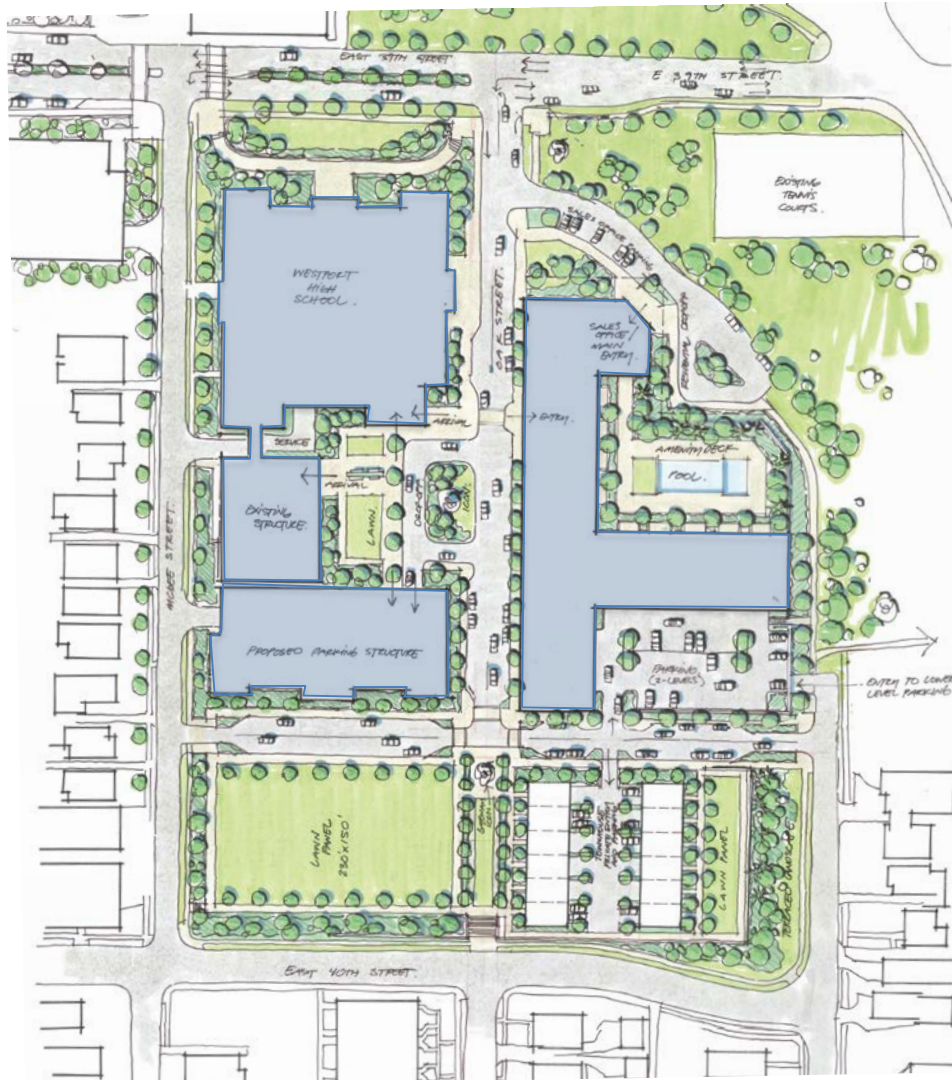



Discussion Items

- Traffic Direction on McGee
- Street Parking on McGee
- Traffic Calming for McGee Street
- Extending New Oak Street Further South
- Limiting or removing the connection at 39th Terrace & McGee

Traffic Direction / Street Parking on McGee Street

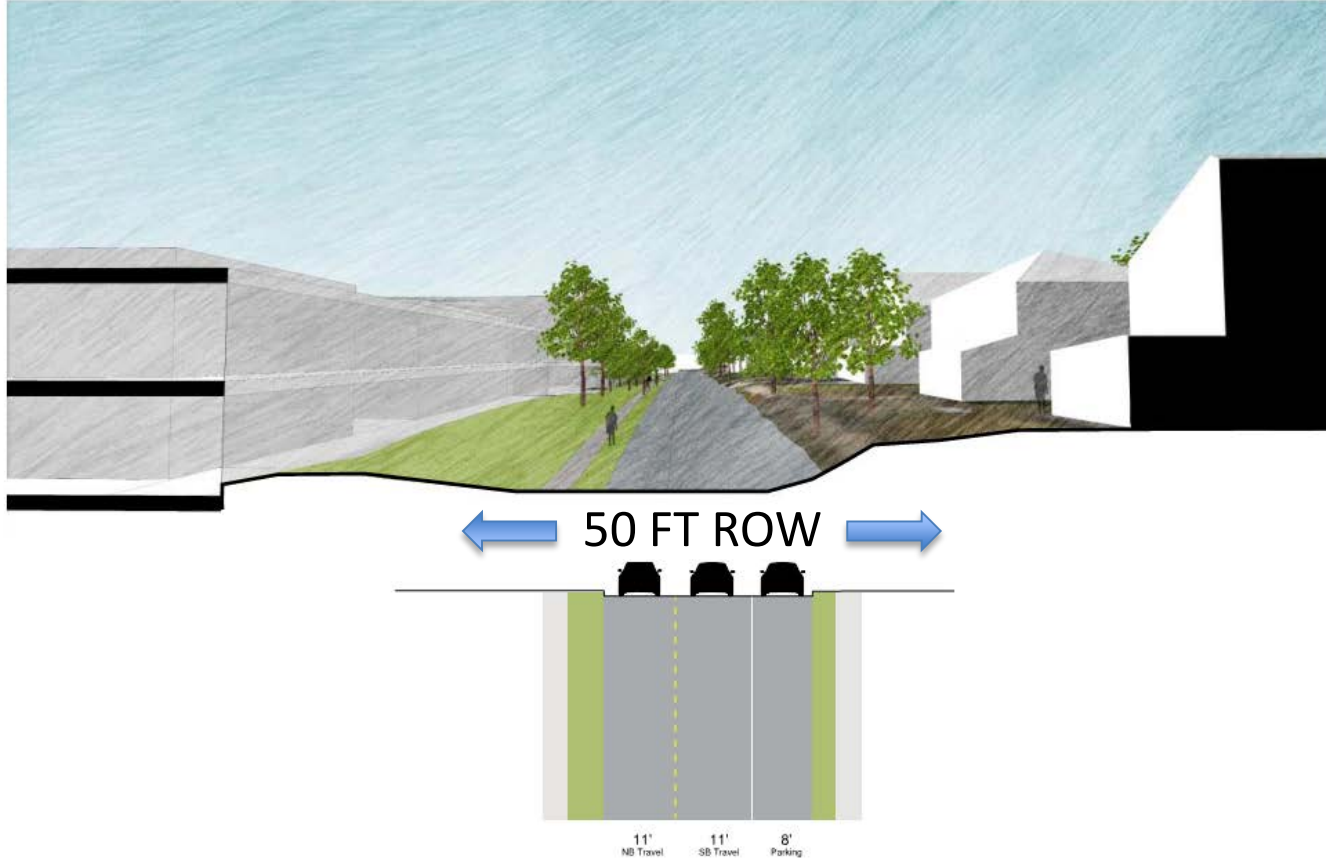

Traffic Direction / Street Parking on McGee Street



The Developer will
vacate its property
as needed for
ROW clearance

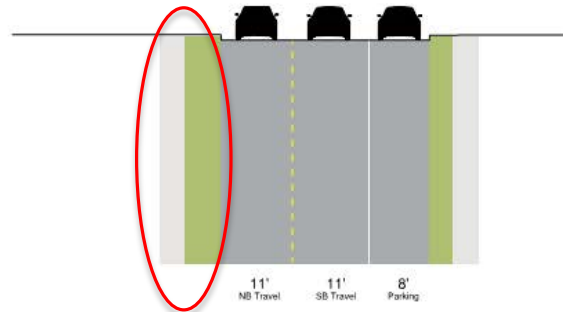

Traffic Calming on McGee

Conceptual
Rendering

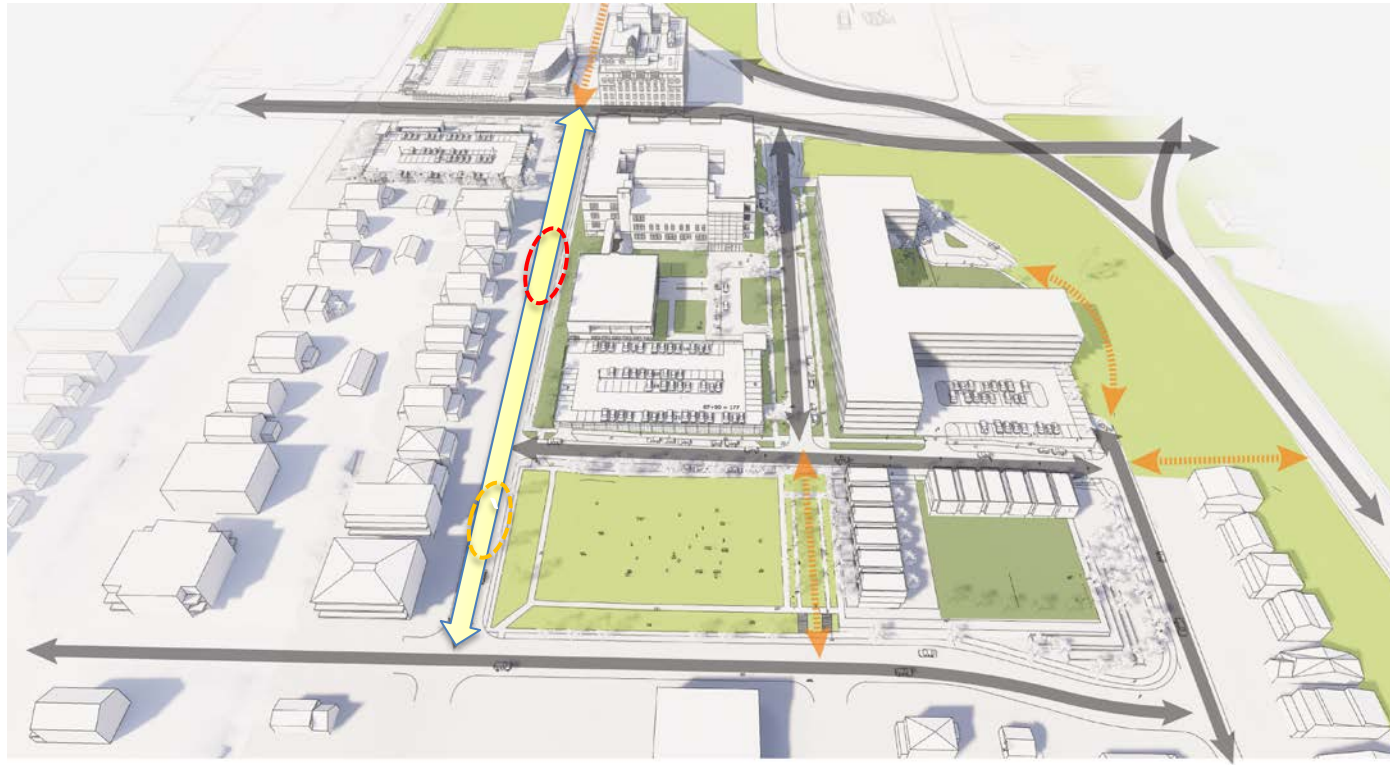

PUBLIC GREENSPACE



PRIVATE GREENSPACE



VEHICULAR CIRCULATION



PEDESTRIAN CIRCULATION

Extend New Oak Street Further South



Challenges & Considerations

- Site Conditions
 - Grade Change
 - Bedrock
- Increase Costs
- Less Desirable Outcome
- Impact Stormwater Retention
- Impact to Adjacent Project Areas

Limit New 39th Terrace Connection to McGee

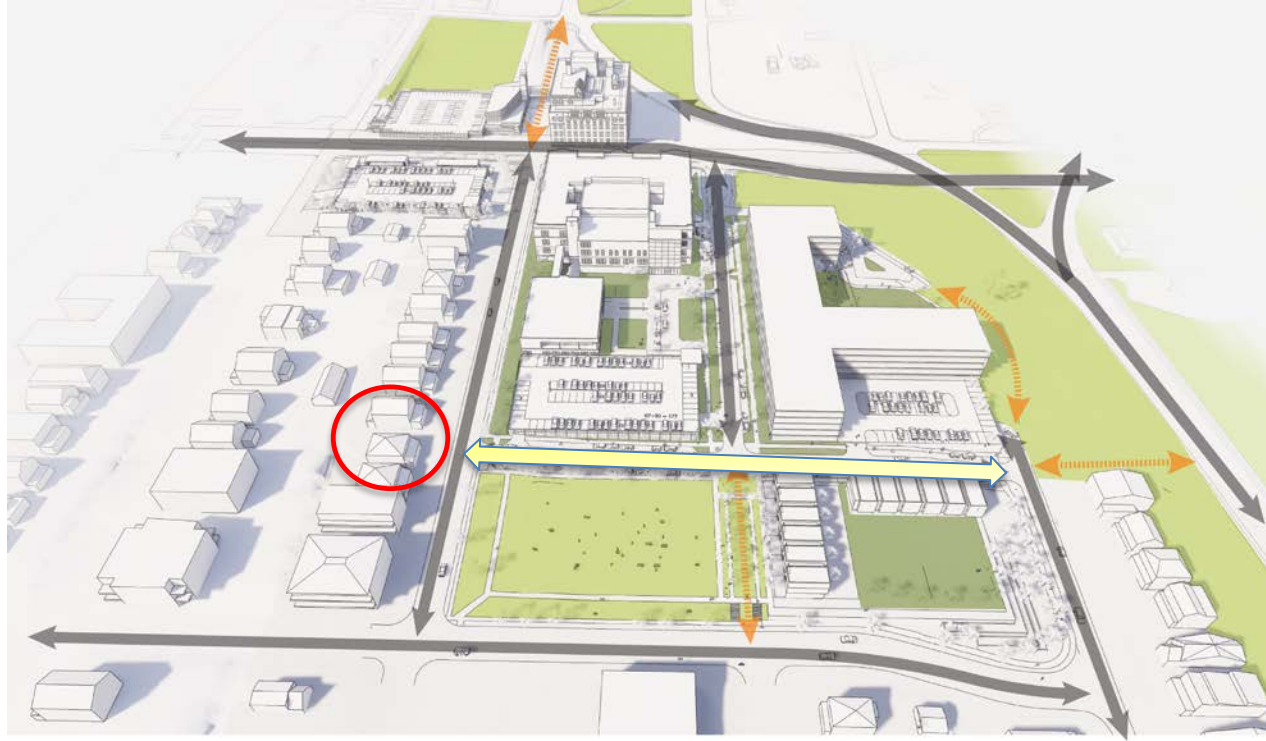

PUBLIC GREENSPACE



PRIVATE GREENSPACE



VEHICULAR CIRCULATION



PEDESTRIAN CIRCULATION

Challenges

- Reduces overall circulation
- Increases Traffic to the South
- Less Desirable Outcome



Westport Commons II

MPD Submittal





CONCEPT RENDERING



CONCEPT RENDERING

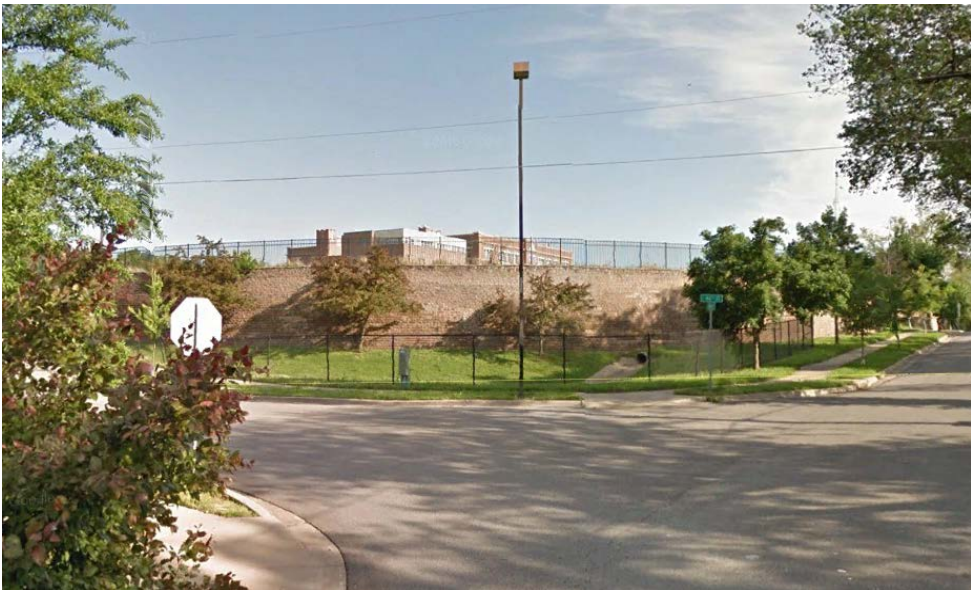



UMKC CONSERVATORY CAMPUS FOR THE ARTS OPPORTUNITY





CONCEPT RENDERING



Westport HS

Neighborhood Meeting 01-14-19