

MINUTES
WEST HARTFORD PEDESTRIAN AND BICYCLE COMMISSION MEETING
MONDAY August 12, 2019
WEST HARTFORD TOWN HALL, ROOM 400
Next Meeting September 9, 2019 @ 7:00PM ROOM 400

Board Members in attendance: Denisse Gutierrez, Dan Firestone, Sandy Fry, Jill Morawski, Paul Hogan, Colin Gillespie. A Quorum was present.

Town Staff in attendance: Duane Martin

Others: Tracy Frankel, Virginia deLima, Ethan Frankel, Ed Pawlak, Keith Feely, Scott Franklin, John Wesson, Laurie Silverman

- 1) Call to order 7:10PM.
- 2) Approval of previous meeting minutes. On a motion by Dan Firestone, seconded by Paul Hogan, the commission voted unanimously to approve the June 2019 minutes.
- 3) Old Business.
 - a. Mountain Road/Albany Avenue, the exception to the Complete Streets policy was approved by Council. The approved exception was for the last plan we had reviewed which included 4 ft. bike lanes. Design will be completed Spring 2020 and then it will go out to bid. Jill asked – with the Mtn/Albany project, are you looking at the impact of this work upon other intersections, ie, will new traffic be attracted, which will affect intersections that are not being improved. Answer – no, it is unclear how much new traffic will be attracted by intersection improvement and how the improvement will affect other intersections..
 - b. North Main Street Bridge: The Town finally got an agreement from the state, executed it on the Town's part and now is waiting for the fully executed document back from the state. Next steps – put out to bid, review bids, award contract some time this year with construction beginning in the spring. Construction is expected to take 18 months. The Town can begin the road diet trial, steps to be taken include: revise the scope, issue an RFP, hire a consultant. Traffic counts and speed studies have already been conducted on North Main, Trout Brook, and Mountain Roads. It is expected that the Trial itself will be conducted over 4 to 6 months. Paul asked what will you look at during the trial besides traffic volume? Duane replied that that is part of the road diet study, deciding what will be measures of success of the road diet – diversion volumes, speeds, safety? Paul pointed out that in a 4 to 6 month trial it will be difficult to measure safety changes. Paul also asked if the town has thought about the UConn development and its impact upon Main Street. Duane responded that the traffic consultant for that development project asked what they should assume regarding road diet. They were told assume existing conditions on the road, but they might need to re-

evaluate later. Paul requested that Duane send him the “before” traffic data (speeds and volumes) for the three roads. Duane will send this to Sandy who will forward it. Mountain/Albany may be under construction during the North Main road diet trial. Question was raised - How will this affect the road diet trial?

- c. Update regarding paving projects: Boulevard – the town plans to restripe the section from Main St. to Raymond Road (see attached plan). The group discussed buffers for the bike lanes – should they be on the traffic side of the bike lane or on the parking side of the bike lane? Because of low parking turnover in the area, the recommendation is that the buffers be on the traffic side. Boulevard from Quaker to Whiting, repave and road markings are complete, likewise Fern from North Main to Trout Brook. Duane explained that he plans to do a repave of Farmington and LaSalle this year, but this will be a thin mill and repave because there is a lot of utility work that will occur on these segments over the next several years. Normally he would wait until all utility work is complete, but the roads need repaving so work will be done now. Just the drive lanes will be repaved. Town will be considering whether Farmington can be realigned, but not as part of this project. The repave schedule is on the engineering web page.
- d. Other projects – Fern Street bridge is in preliminary design
- e. Status Trout Brook Trail – Town is negotiating with DEEP regarding maintenance agreement for the flood channel for the section of stream from Farmington to Duffield. DEEP is insisting on terms that the Town finds unreasonable. If this is not resolved, this section of trail may need to be rethought.
- f. Other – Vanderbilt Park cut through was brought up, it needs signage and maintenance. Duane will look into whose responsibility this is – Engineering – Schools – Parks? Southwest side of Albany/Prospect – sidewalk condition questions.
- g. Planning department matters: Sandy passed around the attached plan of a proposed improvement to the entrance to Elizabeth Park. Regarding the Plan of Conservation and Development, the Commission will be receiving a copy of the draft sections when they are available, should be in a month or two..
- h. Bike share updates: CRCOG received proposals and is currently reviewing to determine if the proposals meet the requirements of the RFP. Colin said he has noticed that with the bike share in Newton Mass, bicycles are arranged very neatly. We may want to look at how they control that.
- i. Following up on Goals/Visioning for Commission – Education in the schools. We have been unable to set up a meeting with the person on staff at the schools (Health and PE) who had been enthusiastic about this idea. Still working on setting up a meeting.

4) New Business –

- a. Report on 10 mile ride yesterday: Scott led the ride, with about 20 people. The ride visited parks: Fern, Westmoor, Miracle Field, Elizabeth, Vanderbilt, Hartford Tennis Club
- b. Do people know about the prohibition of riding bikes on sidewalks in the Center? Is the ordinance specific as to which streets and which blocks? Duane will share a copy of the ordinance that prohibits this riding (see

attached). Doesn't seem like there is much in the way of signing posted in this regard.

- c. Responding to Facebook posts: Sandy suggested that it would be good to have official responses to Facebook posts related to the Commission's work. Ethan is willing to take this on, Sandy and Ethan will get together to figure out how best to do official posting from the west Hartford Bike page.

5) Reports

- a. Update from Bike West Hartford Inc., Center Streets is in good shape. They will need bodies there. Ed will work with Daniel or Scott to send a request for volunteers.

6) Next meeting scheduled for September 9, 2019

Meeting adjourned at 8:30PM

Respectfully submitted,

Sandy Fry, Chair for
Daniel Johnson, Secretary and Board Member
West Hartford Pedestrian and Bicycle Commission

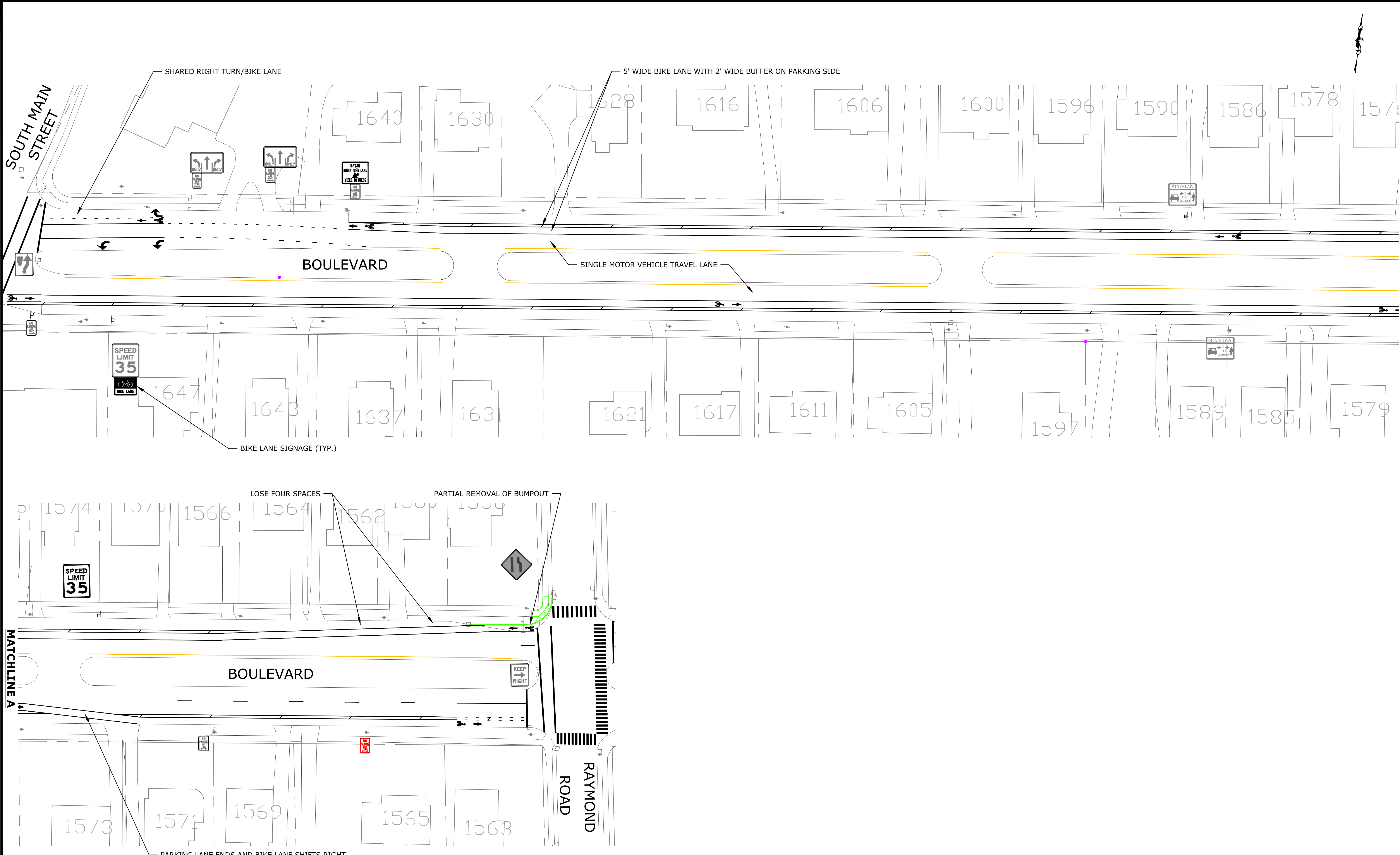

FILE: F:\STREET FILES\Boulevard - S Main to QLS - Bike Lanes RemoveBumpout.dwg
PLOTTED: 07/10/2019

3	11/30/18	REMOVE STALL MARKINGS	JRB
2	6/12/18	ADD STALL MARKINGS	JRB
1	4/3/18	ADD SIGNING, STALL COUNTS	JRB
NO.	DATE	DESCRIPTION	BY



TOWN OF WEST HARTFORD
DEPARTMENT OF COMMUNITY DEVELOPMENT
DIVISION OF ENGINEERING

BOULEVARD
BIKE FACILITIES IMPROVEMENTS
SOUTH MAIN STREET TO TROUT BROOK DRIVE

SCALE: 1"=30'

DESIGNER: JRB

DATE: APR. 2018

SIGNING & MARKING

SHEET **1** OF **1**

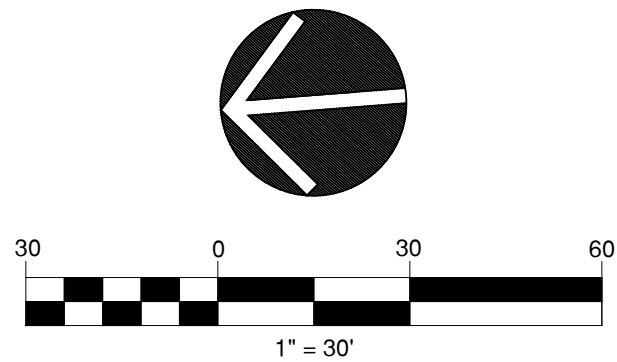
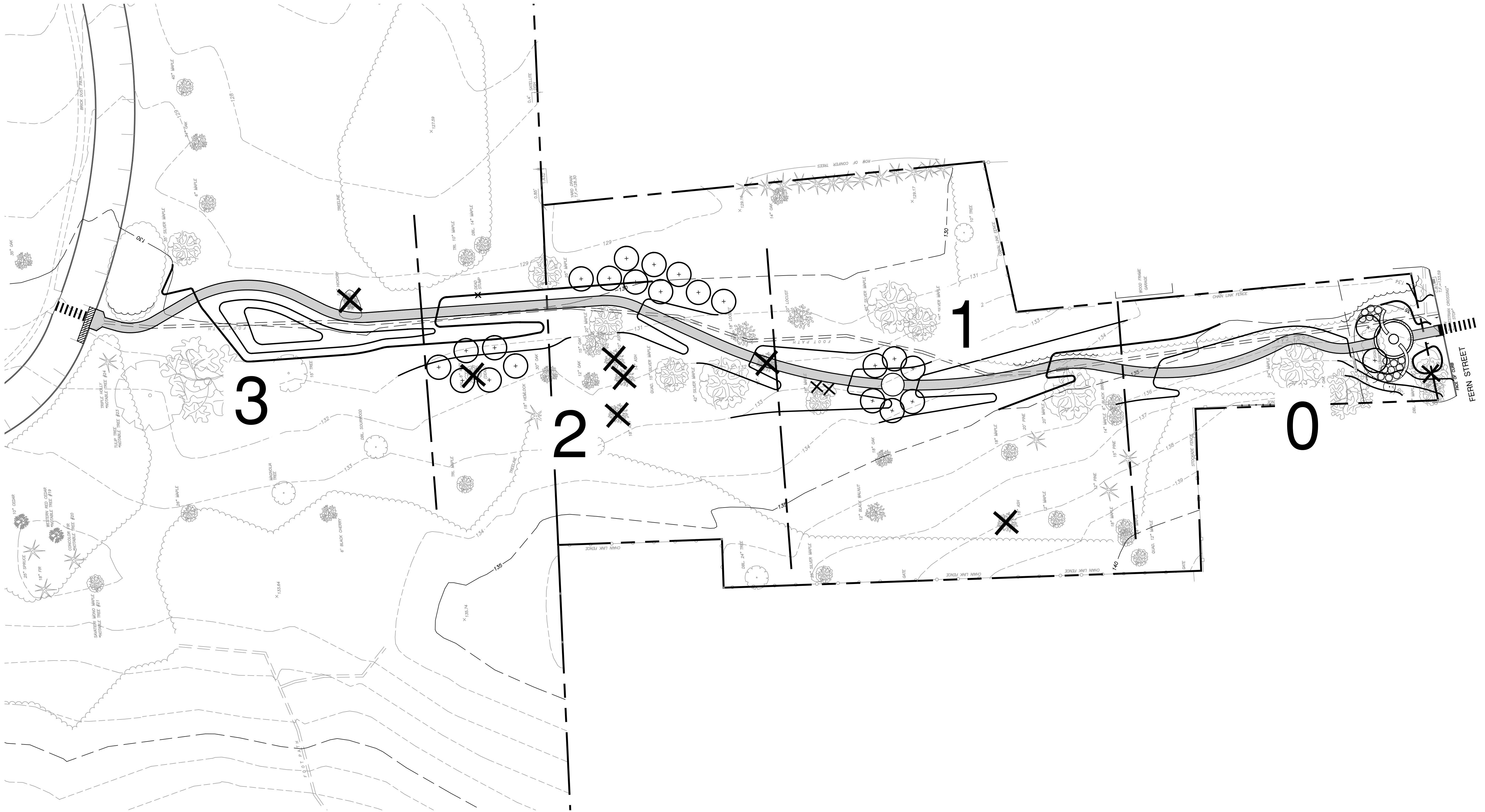

ELIZABETH PARK
FERN STREET PEDESTRIAN
GATEWAY & WALK
204 FERN STREET & 1563 ASYLUM AVENUE WEST HARTFORD, CT

Sheet Description:

Overall
Plan

Rev:

Issue Date:
JULY 16, 2019

Scale:
AS NOTED

Drawn by:
MD

Project number:
6319

Sheet #:

L-0.0

ARTICLE I

Bicycles, Skateboards, Roller Skates and Roller Blades
[Adopted 6-12-1973; amended in its entirety 5-24-1988]

§ 53-1. Restricted locations. [Amended 2-11-2008]

- A. No person shall ride a bicycle (including any forward movement of the bicycle, whether one foot or two feet are on the pedals), a skateboard or roller skates/roller blades on any sidewalk as hereinafter defined:

Name of Street	Side	Location
Burr Street	North	
Ellsworth Road	North	From South Main Street to LaSalle Road
Farmington Avenue	North/ South	From Walden Street easterly to Raymond Road
LaSalle Road	East/ West	From Ellsworth Road northerly to Farmington Avenue
Memorial Drive	North/ South	
North and South Main Street	East	From Loomis Drive (south entrance) southerly to Burr Street
North and South Main Street	West	From Loomis Drive (south entrance) southerly to Ellsworth Road

- B. No person shall ride a skateboard or use roller skates or roller blades anywhere on the municipal property, including the parking lots, known as the "Town Hall," Town Hall Common; the "West Hartford Public Library," 20 South Main Street, including the adjoining municipal property known as "Webster Walk" and "Blue Back Square"; and the "Police/Court facility," 103 Raymond Road.

§ 53-2. Authorization to erect signs.

The proper Town authorities are authorized to erect signs so prohibiting bicycles, skateboards and roller skates/roller blades from being ridden in said business area and in the municipal complex.

§ 53-3. Penalties for offenses.

Any person who violates this chapter shall be fined not more than \$50 for each offense.

§ 53-4. Definitions.

For the purpose of this chapter, certain words and terms shall be defined as follows:

BICYCLE — A vehicle propelled by the person riding the same by foot or hand power or by a helper motor having capacity of less than 50 cubic centimeters' piston displacement and rated not more than two brake horsepower and capable of a maximum speed of not more than 30 miles per hour and equipped with automatic transmission and operable pedals.

ROLLER SKATES/ROLLER BLADES — Any recreational device consisting of a set of two wheeled platforms, whether or not permanently affixed to a pair of shoes or boots, and regardless of the configuration of the wheels thereon, designed to be worn on the user's feet and used to propel the user in a manner similar to ice skates.

SKATEBOARD — Any wheeled device consisting of a platform or seat of metal, wood, plastic or any other material designed for recreational purposes to carry its user in an erect, kneeling, sitting or prone position in a manner similar to that of a true surfboard, whether propelled solely by the physical efforts of its user or users or by the use of a small motor. The term "skateboard" shall not be construed to include a wheelchair or any similar device used to provide transportation for any disabled person.