



8612 Eagle Creek Parkway, Savage, MN 55378

Tel: (952) 746-5880 ♦ Fax: (952) 746-5882

Mailbox@FieldConsultingInc.com

www.FieldConsultingInc.com

Independent School District #197  
1897 Delaware Avenue  
Mendota Heights, MN 55118  
Attn: Mr. Mark Fenton

**RE: Lead in Drinking Water Sampling**  
**SITE: Pilot Knob Elementary**  
**DATE: December 2018**

Dear Mark Fenton,

Field Environmental Consulting, Inc. (FIELD ENVIRONMENTAL) appreciates the opportunity to provide results for lead in drinking water sampling conducted at Pilot Knob Elementary.

Initial sampling ("first draw") was completed on Wednesday, October 3, 2018. Results indicated one (1) fixture, a sink faucet in the hallway near classroom #110, above the action level of 20 ppb (or  $\mu\text{g/L}$ ). Provided with verbal results on October 23, 2018, ISD #197 Operations Department cleaned the aerator for this tap. After aerator cleaning was completed, FIELD ENVIRONMENTAL re-sampled this outlet on Friday, November 16, 2018. The resample had a lead level below the action level. No additional sampling is recommended.

Analysis was conducted by Pace Analytical Services, Inc. of Minneapolis, Minnesota using EPA Method 200.8 ICPMS for determination of trace elements in drinking water.

**PREPARED and REVIEWED BY:**

**Field Environmental Consulting, Inc.**

A handwritten signature in cursive script that reads "Amy Weinzierl".

Amy Weinzierl (CSP #27824)

Environmental Health and Safety Manager

amy@fieldconsultinginc.com

952-746-5880

School Name: Pilot Knob Elementary (PK)

Dates: 10/3/2018 & 11/16/2018

Floor	Room Number	Location	Sample ID	Type DF = Drinking Fountain S = Sink WC = Water Cooler BF = Bottle Filler K=Kettle	Lead Result 10/3/18 (ppb)	Lead Result 11/16/18 (ppb)	Lead Result 30 Sec Flush 11/16/18 (ppb)
First	181	Kitchen	1	K	4.4	-	-
First	181	Kitchen	2	S	12.7	-	-
First	181	Kitchen	3	S	11.4	-	-
First	181	Kitchen	4	S	8.7	-	-
First	181	Kitchen	5	S	2.1	-	-
First	181	Kitchen	6	S	7.3	-	-
First	176	Storage	7	S	19.1	-	-
First	172	SW Corner Gym	8	WC	1.6	-	-
First	113	Classroom	9	S	5.5	-	-
First	-	Hallway	10	WC	0.62	-	-
First	111	Classroom	11	S	5.8	-	-
First	111	Classroom	12	WC	1.3	-	-
First	105	Classroom	13	S	4.7	-	-
First	109	Classroom	14	S	2.7	-	-
First	103	Classroom	15	DF	0.22	-	-
First	103	Classroom	16	S	8.9	-	-
First	100A	Classroom	17	S	3.2	-	-
First	108	Classroom	18	S	4.8	-	-
First	-	Hallway	19	WC	ND	-	-
First	-	Hallway	20	BF	ND	-	-
First	-	Hallway	21	WC	0.65	-	-
First	131	Classroom	22	WC	0.57	-	-
First	131	Classroom	23	S	3.5	-	-
First	131	Classroom	24	S	6.6	-	-
First	129	Classroom	25	WC	1.1	-	-
First	129	Classroom	26	S	5.3	-	-
First	129	Classroom	27	S	4.4	-	-
First	125	Classroom	28	S	7.5	-	-
First	125	Classroom	29	DF	1.5	-	-
First	127	Classroom	30	S	5	-	-
First	127	Classroom	31	DF	1	-	-
First	123	Classroom	32	S	3.5	-	-
First	121	Classroom	33	S	4.8	-	-
First	121	Classroom	34	S	4.2	-	-
First	121	Classroom	35	DF	1.9	-	-
First	119	Classroom	36	DF	1.5	-	-
First	119	Classroom	37	S	11	-	-
First	-	Hallway	38	WC	ND	-	-
First	-	Hallway	39	BF	ND	-	-
First	117	Classroom	40	S	14.9	-	-
First	-	Hallway	41	WC	0.8	-	-
First	-	Hallway	42	WC	0.4	-	-
First	-	Hallway	43	S	4.2	-	-
First	-	Hallway	44	DF	1	-	-
First	110	Classroom	45	S	27.7	9.4	ND
First	108	Classroom	46	DF	0.84	-	-
First	108	Classroom	47	S	6.5	-	-
First	-	Hallway	48	S	4.9	-	-
First	-	Hallway	49	DF	0.68	-	-
First	102	Classroom	50	S	4	-	-
First	132	Classroom	51	S	3.8	-	-
First	-	Hallway	52	S	5.8	-	-
First	-	Hallway	53	DF	0.43	-	-
First	126	Classroom	54	S	9.6	-	-
First	124	Classroom	55	DF	1.8	-	-
First	124	Classroom	56	S	7.7	-	-
First	-	Hallway	57	S	4.7	-	-

School Name: **Pilot Knob Elementary (PK)**

Dates: **10/3/2018 & 11/16/2018**

Floor	Room Number	Location	Sample ID	Type DF = Drinking Fountain S = Sink WC = Water Cooler BF = Bottle Filler K=Kettle	Lead Result 10/3/18 (ppb)	Lead Result 11/16/18 (ppb)	Lead Result 30 Sec Flush 11/16/18 (ppb)
First	-	Hallway	58	DF	1	-	-
First	118	Classroom	59	DF	0.96	-	-
First	118	Classroom	60	S	7.3	-	-
First	116	Classroom	61	DF	0.97	-	-
First	116	Classroom	62	S	7.3	-	-

Pilot Knob Elementary School  
 Main Floor  
 Lead in Drinking Water  
 Project # 19010



First Draw Sampling (October 2018)

- ◆ Lead <= 20 ppb
- ◆ Lead > 20 ppb (Action Level)

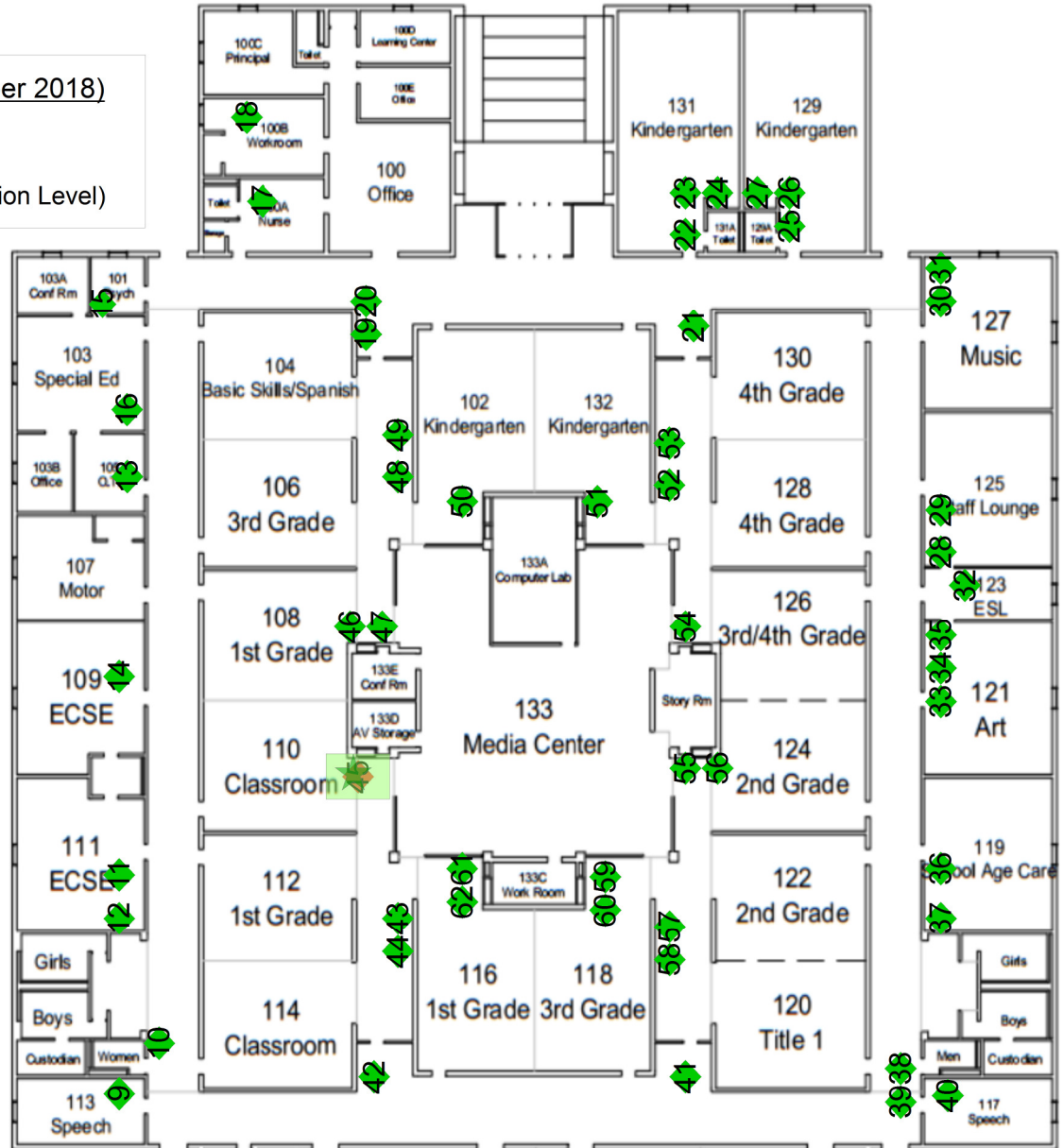

First Draw Sampling (November 2018)

- Lead <= 20 ppb
- Lead > 20 ppb (Action Level)

Flush Sampling (November 2018)

- ★ Lead <= 20 ppb
- ★ Lead > 20 ppb (Action Level)

