



8612 Eagle Creek Parkway, Savage, MN 55378

Tel: (952) 746-5880 ♦ Fax: (952) 746-5882

Mailbox@FieldConsultingInc.com

www.FieldConsultingInc.com

Independent School District #197
1897 Delaware Avenue
Mendota Heights, MN 55118
Attn: Mr. Mark Fenton

RE: Lead in Drinking Water Sampling
SITE: Friendly Hills Middle School
DATE: December 2018

Dear Mark Fenton,

Field Environmental Consulting, Inc. (FIELD ENVIRONMENTAL) appreciates the opportunity to provide results for lead in drinking water sampling conducted at Friendly Hills Middle School.

Initial sampling (“first draw”) was completed on Friday, October 5, 2018. Results indicated one (1) fixture, a sink faucet in the office of classroom #231, above the action level of 20 ppb (or µg/L). ISD #197 Operations Department removed this fixture from service and replaced it. FIELD ENVIRONMENTAL re-sampled the new fixture on Friday, November 16, 2018. The first draw result was still above the action level but the 30-second flush sample was well below this value. Therefore, flushing the water, prior to consumption is an allowable method to reduce lead concentration. The fixture was labeled “flush water prior to consumption.”

Analysis was conducted by Pace Analytical Services, Inc. of Minneapolis, Minnesota using EPA Method 200.8 ICPMS for determination of trace elements in drinking water.

PREPARED and REVIEWED BY:

Field Environmental Consulting, Inc.

Amy Weinzierl (CSP #27824)

Environmental Health and Safety Manager

amy@fieldconsultinginc.com

952-746-5880

School Name: Friendly Hills Middle School (FHS)

Dates: 10/5/2018 & 11/16/2018

Floor	Room Number	Location	Sample ID	Type DF = Drinking Fountain S = Sink WC = Water Cooler BF = Bottle Filler K=Kettle	Lead Result 10/5/18 (ppb)	Lead Result 11/16/18 (ppb)	Lead Result 30 Sec Flush 11/16/18 (ppb)
First	-	Kitchen	1	S	1.1	-	-
First	-	Kitchen	2	K	2.3	-	-
First	-	Kitchen	3	S	0.3	-	-
First	-	Kitchen	4	S	1.9	-	-
First	-	Kitchen	5	Sprayer	4.2	-	-
First	-	Kitchen	6	S	0.45	-	-
First	-	Kitchen	7	Sprayer	1.5	-	-
First	-	Kitchen	8	S	1.2	-	-
First	-	Kitchen	9	S	0.62	-	-
First	161	Classroom	10	S	3.4	-	-
First	-	Hallway	11	WC	0.13	-	-
First	-	Staff	12	S	0.46	-	-
First	162	Classroom	13	DF	1.8	-	-
First	162	Classroom	14	S	0.5	-	-
First	162	Classroom	15	S	4	-	-
First	-	Hallway	16	WC	ND	-	-
First	-	Hallway	17	BF	ND	-	-
First	-	Hallway	18	WC	ND	-	-
First	141	Classroom	19	S	2.6	-	-
First	141	Classroom	20	S	4.6	-	-
First	-	Hallway	21	WC	0.12	-	-
First	-	Staff	22	S	0.71	-	-
First	142	Classroom	23	S	0.78	-	-
First	142	Classroom	24	DF	0.62	-	-
First	145	Classroom	25	S	3.1	-	-
First	-	Hallway	26	WC	0.53	-	-
First	121	Classroom	27	S	1	-	-
First	121	Classroom	28	S	0.76	-	-
First	121	Classroom	29	S	2.8	-	-
First	121	Classroom	30	S	1.7	-	-
First	121	Classroom	31	S	2.1	-	-
First	121	Classroom	32	S	1.6	-	-
First	121	Classroom	33	S	5.1	-	-
First	-	Staff	34	S	0.7	-	-
First	-	Hallway	35	WC	0.15	-	-
First	122	Classroom	36	S	1.4	-	-
First	122	Classroom	37	DF	0.64	-	-
First	125	Classroom	38	S	3.3	-	-
First	116	Classroom	39	S	1.9	-	-
First	-	Hallway	40	WC	ND	-	-
First	-	Hallway	41	BF	ND	-	-
First	-	Hallway	42	WC	0.27	-	-
First	-	Boy's Locker Room	43	S	7.9	-	-
First	-	Boy's Locker Room	44	S	3.7	-	-
First	-	Girl's Locker Room	45	S	6	-	-
First	-	Girl's Locker Room	46	S	8.2	-	-
First	-	Boy's PE	47	S	1.4	-	-
First	-	Girl's PE	48	S	1.4	-	-
First	-	Health	49	S	3.3	-	-
First	-	Health	50	DF	0.73	-	-
First	-	Health Exam	51	S	0.64	-	-
First	-	Staff Lounge	52	S	0.5	-	-
First	-	Staff Lounge	53	BF	0.18	-	-
First	-	Staff Lounge	54	DF	19.4	-	-
First	-	Staff Lounge	55	WC	ND	-	-
Second	222	Classroom	56	S	1.1	-	-
Second	222	Classroom	57	DF	1.6	-	-
Second	224	Classroom	58	S	0.47	-	-
Second	224	Classroom	59	DF	0.8	-	-
Second	226	Classroom	60	S	0.91	-	-
Second	226	Classroom	61	DF	1.4	-	-
Second	228	Classroom	62	S	4	-	-
Second	228	Classroom	63	DF	18	-	-
Second	225	Classroom	64	S	4.6	-	-
Second	223	Classroom	65	S	3.4	-	-
Second	223	Classroom	66	S	1.8	-	-
Second	223	Classroom	67	S	2.7	-	-

ND = none detected

School Name: Friendly Hills Middle School (FHS)

Dates: 10/5/2018 & 11/16/2018

Floor	Room Number	Location	Sample ID	Type DF = Drinking Fountain S = Sink WC = Water Cooler BF = Bottle Filler K=Kettle	Lead Result 10/5/18 (ppb)	Lead Result 11/16/18 (ppb)	Lead Result 30 Sec Flush 11/16/18 (ppb)
Second	221	Classroom	68	S	2.5	-	-
Second	221	Classroom	69	DF	1.2	-	-
Second	221	Classroom	70	S	2.4	-	-
Second	221	Classroom	71	S	1.8	-	-
Second	221	Classroom	72	S	2.9	-	-
Second	-	Staff	73	S	6.9	-	-
Second	231	Classroom	74	WC	0.2	-	-
Second	231	Classroom	75	S	56.3	34.6	2
Second	223	Classroom	76	S	0.48	-	-
Second	242	Classroom	77	S	0.51	-	-
Second	242	Classroom	78	DF	1.2	-	-
Second	224	Classroom	79	S	2.1	-	-
Second	224	Classroom	80	DF	0.33	-	-
Second	246	Classroom	81	S	1.3	-	-
Second	246	Classroom	82	DF	0.33	-	-
Second	248	Classroom	83	S	0.64	-	-
Second	248	Classroom	84	DF	0.35	-	-
Second	245	Classroom	85	DF	2.1	-	-
Second	243	Classroom	86	S	5.1	-	-
Second	243	Classroom	87	S	2.8	-	-
Second	243	Classroom	88	S	4	-	-
Second	243	Classroom	89	S	2.3	-	-
Second	243	Classroom	90	DF	0.42	-	-
Second	241	Classroom	91	S	1.2	-	-
Second	241	Classroom	92	DF	0.44	-	-
Second	241	Classroom	93	S	0.94	-	-
Second	241	Classroom	94	S	1.2	-	-
Second	241	Classroom	95	S	1.6	-	-
Second	-	Staff	96	S	2.5	-	-
Second	271	Classroom	97	WC	1.5	-	-
Second	273	Classroom	98	DF	0.66	-	-
Second	262	Classroom	99	DF	0.44	-	-
Second	262	Classroom	100	S	0.78	-	-
Second	264	Classroom	101	DF	0.46	-	-
Second	264	Classroom	102	S	1.1	-	-
Second	266	Classroom	103	S	0.56	-	-
Second	266	Classroom	104	DF	0.39	-	-
Second	268	Classroom	105	DF	1.5	-	-
Second	268	Classroom	106	DF	0.44	-	-
Second	265	Classroom	107	S	2.7	-	-
Second	263	Classroom	108	S	6.5	-	-
Second	263	Classroom	109	S	1.7	-	-
Second	263	Classroom	110	S	0.57	-	-
Second	263	Classroom	111	S	1.3	-	-
Second	263	Classroom	112	DF	0.72	-	-
Second	261	Classroom	113	S	5.9	-	-
Second	261	Classroom	114	S	2.2	-	-
Second	261	Classroom	115	S	0.59	-	-
Second	261	Classroom	116	DF	0.27	-	-
Second	261	Classroom	117	S	1.4	-	-
Second	-	Staff	118	S	0.93	-	-
First	141	Classroom	119	S	3.6	-	-
First	141	Classroom	120	S	3.1	-	-

Friendly Hills Middle School
 1st Floor
 Lead in Drinking Water
 Project # 19010



First Draw Sampling (October 2018)

- ◆ Lead <= 20 ppb
- ◆ Lead > 20 ppb (Action Level)

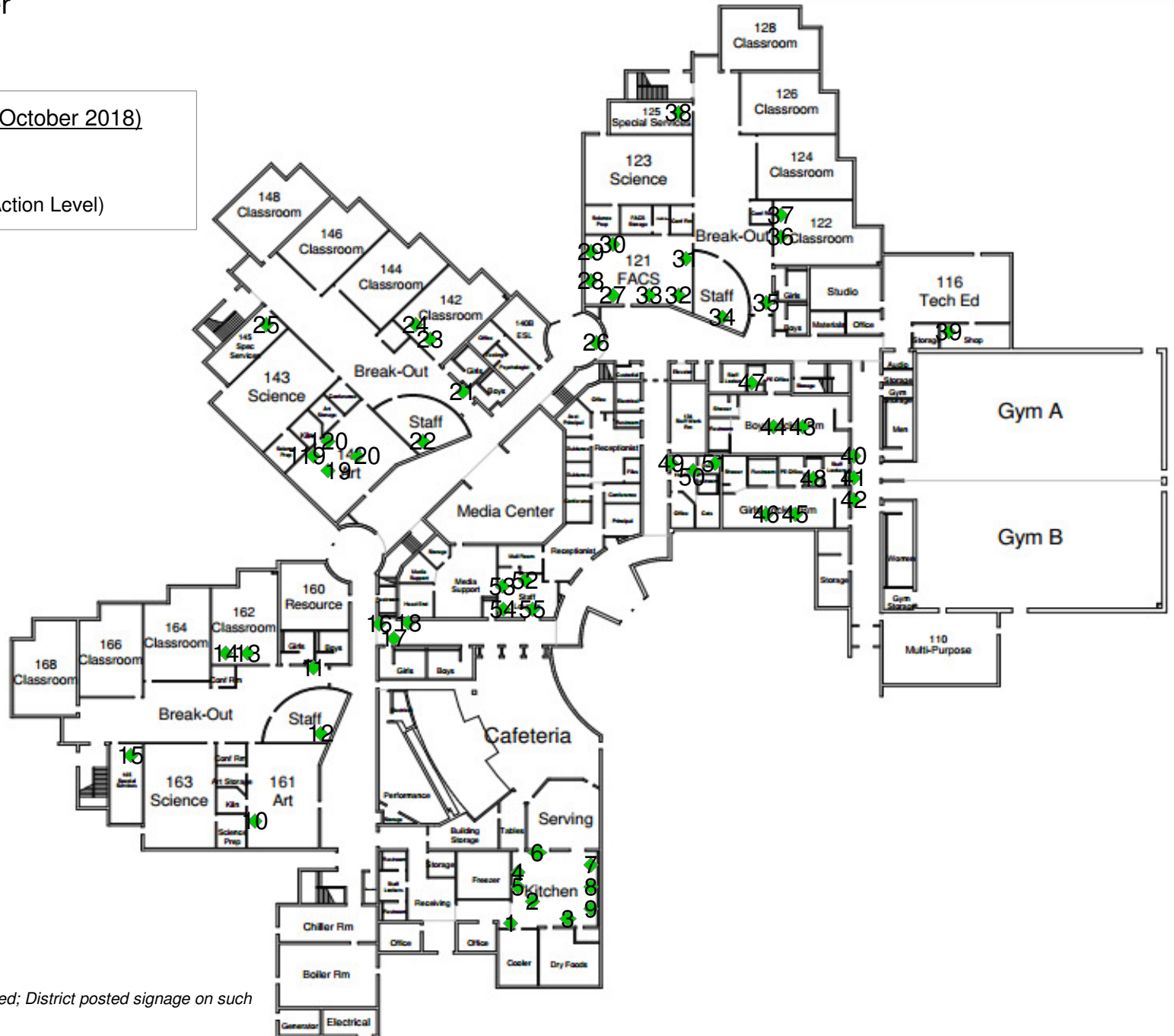

Science laboratory sinks were not tested; District posted signage on such fixtures stating "water not for drinking"

Friendly Hills Middle School
 2nd Floor
 Lead in Drinking Water
 Project # 19010



First Draw Sampling (October 2018)

- ◆ Lead <= 20 ppb
- ◆ Lead > 20 ppb (Action Level)

First Draw Sampling (November 2018)

- Lead <= 20 ppb
- Lead > 20 ppb (Action Level)

Flush Sampling (November 2018)

- ★ Lead <= 20 ppb
- ★ Lead > 20 ppb (Action Level)

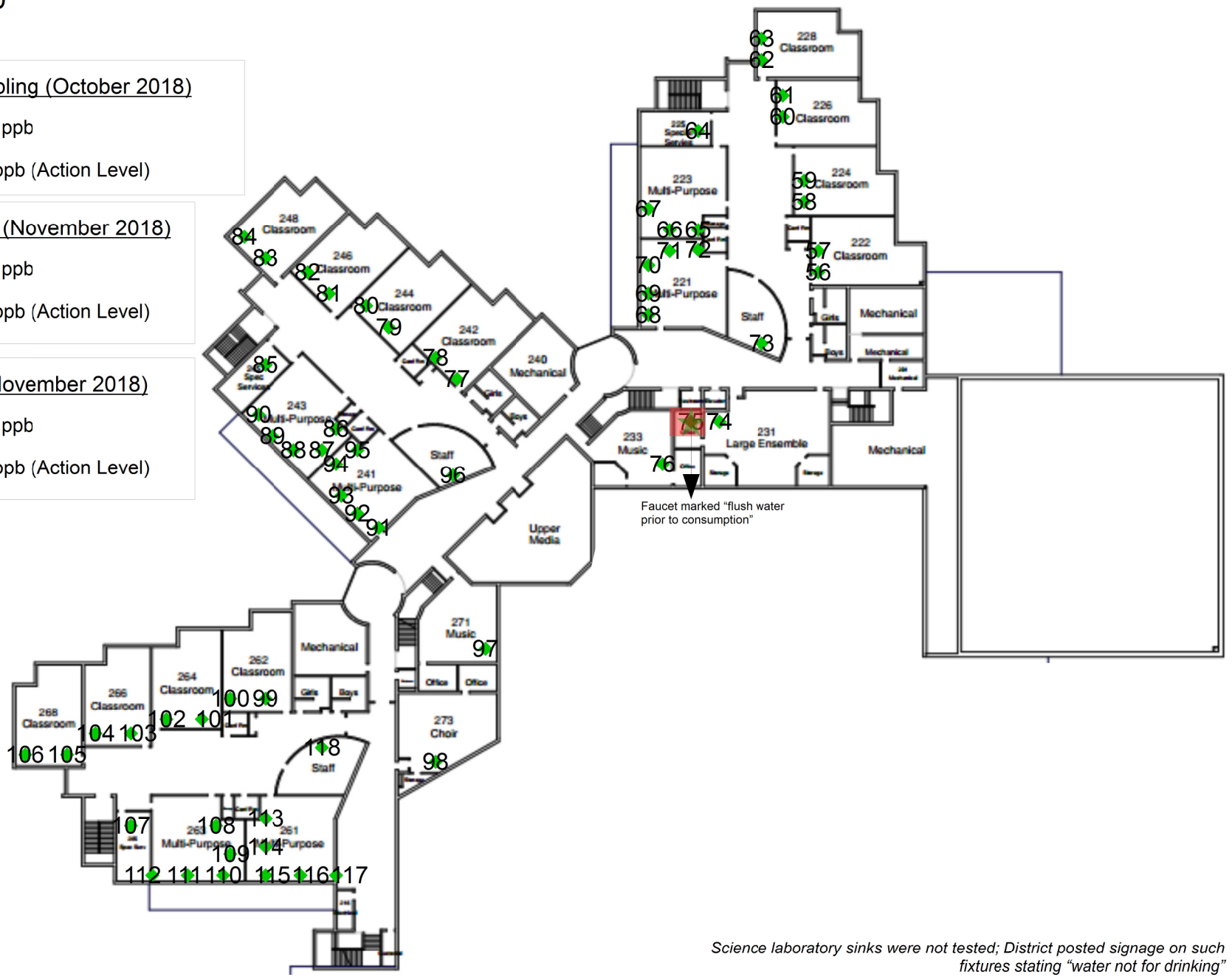

Science laboratory sinks were not tested; District posted signage on such fixtures stating "water not for drinking"