



8612 Eagle Creek Parkway, Savage, MN 55378

Tel: (952) 746-5880 ♦ Fax: (952) 746-5882

Mailbox@FieldConsultingInc.com

www.FieldConsultingInc.com

Independent School District #197  
1897 Delaware Avenue  
Mendota Heights, MN 55118  
Attn: Mr. Mark Fenton

**RE: Lead in Drinking Water Sampling**  
**SITE: Heritage Middle School**  
**DATE: December 2018**

Dear Mark Fenton,

Field Environmental Consulting, Inc. (FIELD ENVIRONMENTAL) appreciates the opportunity to provide results for lead in drinking water sampling conducted at Heritage Middle School.

Initial sampling ("first draw") was completed on Friday, October 5, 2018. Results indicated one (1) fixture, a drinking fountain in the Boys Locker Room near the pool, above the action level of 20 ppb (or µg/L).

This area within Heritage Middle School is to undergo significant construction in the next couple years. As this fixture was infrequently used, ISD #197 Operations Department permanently shut-off water to this fountain.

Analysis was conducted by Pace Analytical Services, Inc. of Minneapolis, Minnesota using EPA Method 200.8 ICPMS for determination of trace elements in drinking water.

**PREPARED and REVIEWED BY:**

**Field Environmental Consulting, Inc.**

A handwritten signature in cursive script that reads "Amy Weinzierl".

Amy Weinzierl (CSP #27824)

Environmental Health and Safety Manager

amy@fieldconsultinginc.com

952-746-5880

School Name: **Heritage Middle School (HMS)**Date: **10/5/2018**

Floor	Room Number	Location	Sample ID	Type DF = Drinking Fountain S = Sink WC = Water Cooler BF = Bottle Filler K=Kettle	Lead Result (ppb)
First	184	Boys Locker Rm	1	DF	<b>260</b>
First	180	Pool Seating	2	DF	5.2
First	194G	Boys PE locker	3	S	0.89
First	194G	Boys PE locker	4	S	0.53
First	192	Boys Athletic Locker	5	S	0.46
First	192	Boys Athletic Locker	6	S	1.9
First	-	East-Hallway Outside 190A	7	WC	ND
First	-	West-Hallway Outside 190A	8	WC	0.11
First	-	Hallway Outside 196D	9	WC	0.4
First	-	West-Hallway Outside 190B	10	WC	0.26
First	-	East-Hallway Outside 190B	11	WC	0.67
First	195	Girls Athletic Locker	12	S	1.3
First	193C	Girls PE Locker	13	S	4.5
First	185	Girls Locker Rm	14	DF	7.1
First	152	Staff Lounge	15	S	0.37
First	152A	Copy Rm	16	S	0.34
First	-	North-Hallway across 170A	17	WC	ND
First	-	North-Hallway across 170A	18	BF	ND
First	-	South-Hallway across 170B	19	WC	ND
First	-	Hallway outside 160	20	WC	ND
First	162	Classroom	21	DF	0.22
First	162	Classroom	22	S	1
First	160	Staff Lounge	23	S	0.18
First	161	Classroom-Westernmost	24	S	1.2
First	161	Classroom-Westernmost	25	S	4.7
First	161	Classroom-East	26	S	0.68
First	161	Classroom-Easternmost	27	S	0.36
First	165	Classroom	28	S	1.9
First	-	Hallway outside 140	29	WC	ND
First	142	Classroom	30	DF	0.19
First	142	Classroom	31	S	0.71
First	140	Staff Lounge	32	S	2.6
First	141	Classroom-Northwest	33	S	0.36
First	141	Classroom-Center	34	S	2
First	141	Classroom-Southeast	35	S	0.62
First	145	Classroom	36	S	0.71
First	-	North-Hallway across 121	37	WC	ND
First	-	South-Hallway across 121	38	WC	0.12
First	-	Hallway outside 120	39	WC	0.16
First	120	Staff Lounge	40	S	0.41
First	121	Classroom-Southeast	41	S	0.31
First	121	Classroom-Southwest	42	S	0.36
First	121	Classroom-West	43	S	0.29
First	121	Classroom-Northwest	44	S	0.51
First	121	Classroom-North	45	S	0.95
First	121	Classroom-Northeast	46	S	1.7
First	121	Classroom-East	47	S	0.61
First	125	Classroom	48	S	0.67
First	103	Health	49	S	0.11

Water has been permanently shut-off to fountain

School Name: **Heritage Middle School (HMS)**Date: **10/5/2018**

Floor	Room Number	Location	Sample ID	Type DF = Drinking Fountain S = Sink WC = Water Cooler BF = Bottle Filler K=Kettle	Lead Result (ppb)
First	103	Health	50	DF	0.38
First	103A	Health back room	51	S	0.38
Second	231	Classroom	52	DF	0.2
Second	231A	Office	53	S	4.3
Second	220	Staff Lounge	54	S	1
Second	221	Classroom-Northwest	55	S	5.7
Second	221	Classroom-Northwest	56	DF	0.32
Second	221	Classroom-North	57	S	0.73
Second	221	Classroom-Northeast	58	S	1.4
Second	221	Classroom-Northwest	59	S	1.8
Second	223	Classroom-Southwest	60	S	2.8
Second	223	Classroom-Northwest	61	S	1.3
Second	223	Classroom-North	62	S	0.46
Second	223	Classroom-Northeast	63	S	0.87
Second	223	Classroom-Northeast	64	DF	0.11
Second	225	Classroom	65	S	0.56
Second	228	Classroom	66	S	0.47
Second	228	Classroom	67	DF	0.14
Second	226	Classroom	68	DF	0.15
Second	226	Classroom	69	S	0.99
Second	224	Classroom	70	DF	0.19
Second	224	Classroom	71	S	0.44
Second	222	Classroom	72	DF	0.26
Second	222	Classroom	73	S	0.71
Second	233	Classroom	74	DF	0.16
Second	240	Staff Lounge	75	S	0.94
Second	241	Classroom-West	76	S	0.94
Second	241	Classroom-West	77	DF	0.11
Second	241	Classroom-North	78	S	0.63
Second	241	Classroom-Northeast	79	S	2.1
Second	241	Classroom-East	80	S	1.4
Second	243	Classroom-South	81	S	0.61
Second	243	Classroom-West	82	S	0.82
Second	243	Classroom-Northwest	83	S	0.46
Second	243	Classroom-North	84	S	2.6
Second	243	Classroom-North	85	DF	0.2
Second	245	Classroom	86	S	0.55
Second	248	Classroom	87	S	1.2
Second	248	Classroom	88	DF	ND
Second	246	Classroom	89	S	0.57
Second	246	Classroom	90	DF	ND
Second	244	Classroom	91	DF	0.13
Second	244	Classroom	92	S	0.57
Second	242	Classroom	93	DF	0.21
Second	242	Classroom	94	S	0.27
Second	271	Classroom	95	WC	0.84
Second	273	Classroom	96	WC	0.18
Second	260	Staff Lounge	97	S	0.52
Second	261	Classroom-Southwest	98	S	0.82
Second	261	Classroom-Southwest	99	DF	ND

School Name: **Heritage Middle School (HMS)**Date: **10/5/2018**

Floor	Room Number	Location	Sample ID	Type DF = Drinking Fountain S = Sink WC = Water Cooler BF = Bottle Filler K=Kettle	Lead Result (ppb)
Second	261	Classroom-West	100	S	0.34
Second	261	Classroom-Northwest	101	S	1.5
Second	261	Classroom-Northeast	102	S	2
Second	263	Classroom-Southeast	103	S	0.88
Second	263	Classroom-Southwest	104	S	0.24
Second	263	Classroom-West	105	S	0.63
Second	263	Classroom-Northwest	106	DF	ND
Second	263	Classroom-Northwest	107	S	0.38
Second	265	Classroom	108	S	0.59
Second	268	Classroom	109	S	0.9
Second	268	Classroom	110	DF	0.1
Second	266	Classroom	111	DF	ND
Second	266	Classroom	112	S	0.36
Second	264	Classroom	113	DF	0.78
Second	264	Classroom	114	S	0.25
Second	262	Classroom	115	S	0.14
Second	262	Classroom	116	DF	0.38
First	122	Classroom	117	DF	0.45
First	122	Classroom	118	S	0.47
Skipped sample 119					
First	177A	Kitchen-across from 179	120	S	0.47
First	177A	Kitchen-North	121	S	3
First	177A	Kitchen-Northeast	122	K	0.77
First	177A	Kitchen-East	123	S	2.2
First	177A	Kitchen-Southeast	124	K	0.39
First	177A	Kitchen-South	125	S	2.3
First	177A	Kitchen-Southwest	126	S	0.29
First	177A	Kitchen-West	127	S	1.9

Heritage Middle School  
 1<sup>st</sup> Floor  
 Lead in Drinking Water  
 Project # 19010



First Draw Sampling (October 2018)

- ◆ Lead <= 20 ppb
- ◆ Lead > 20 ppb (Action Level)

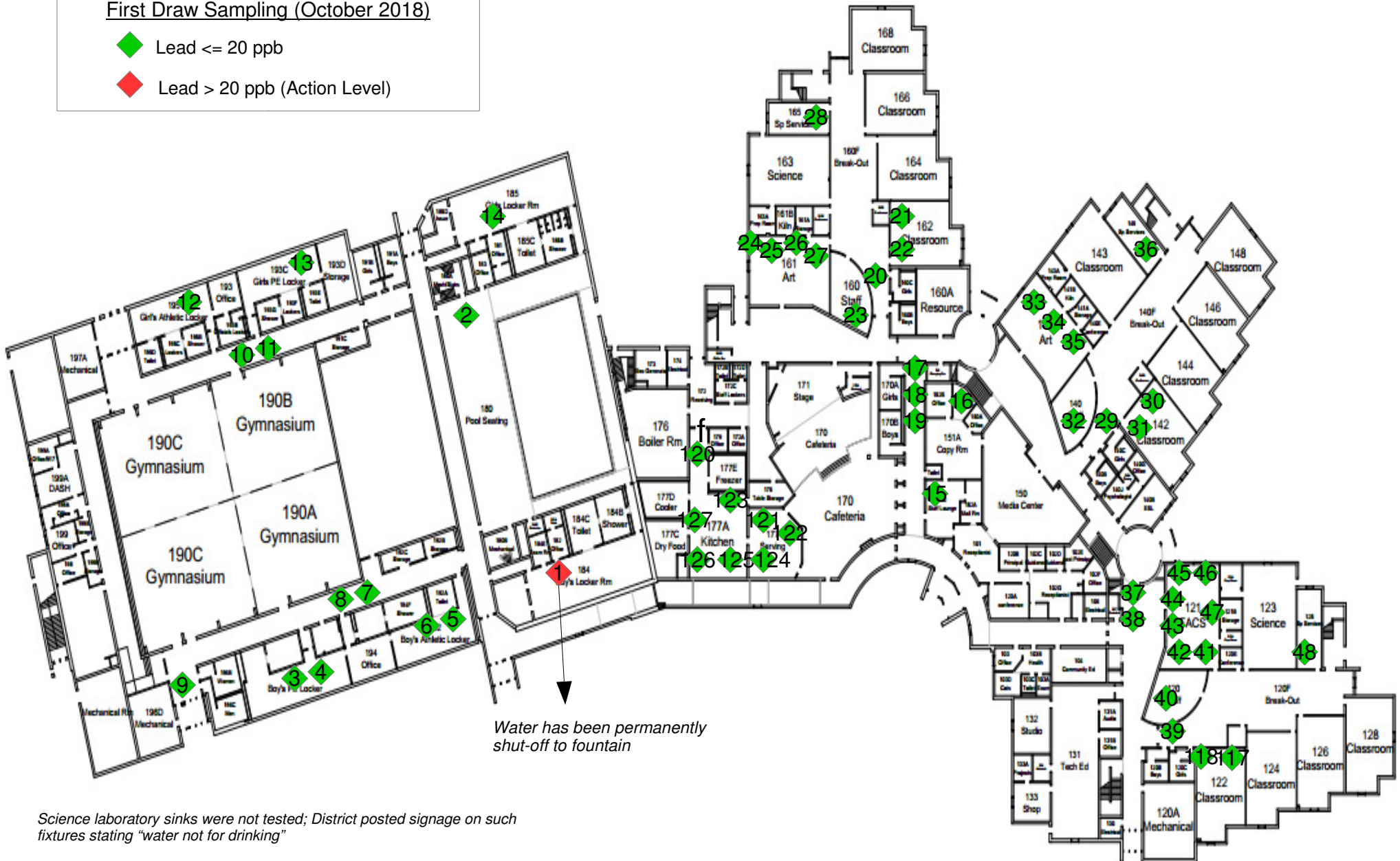

Water has been permanently shut-off to fountain

Science laboratory sinks were not tested; District posted signage on such fixtures stating "water not for drinking"

Heritage Middle School  
 2<sup>nd</sup> Floor  
 Lead in Drinking Water  
 Project # 19010



First Draw Sampling (October 2018)

- ◆ Lead <= 20 ppb
- ◆ Lead > 20 ppb (Action Level)

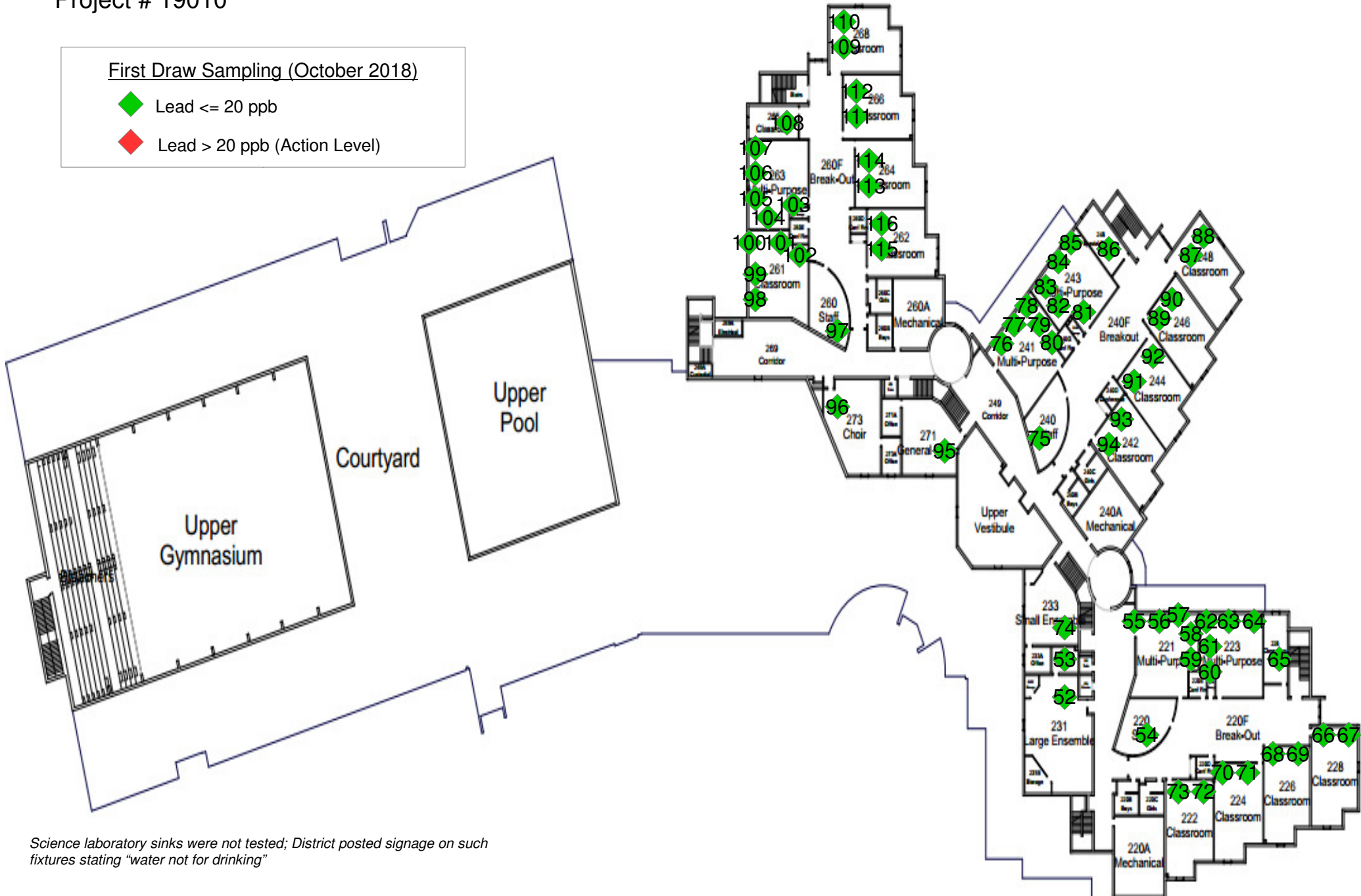

Science laboratory sinks were not tested; District posted signage on such fixtures stating "water not for drinking"