

**LODI UNIFIED SCHOOL DISTRICT**

**2020 Paving Project(s) – Phase II**

**PROJECT NUMBER: 0940-8240  
DSA #:02-118113  
Christa McAuliffe Middle School**

**PROJECT NUMBER: 0951-8251  
DSA #:02-118115  
Westwood Elementary School**

**ADDENDUM NO. 1**

March 06, 2020

Owner: Lodi Unified School District  
1305 E. Vine Street  
Lodi, CA 95240

Engineer: Warren Consulting Engineers, Inc.  
1117 Windfield Way  
El Dorado Hill, CA 95762

Project Manager: Capital Program Management, Inc.  
1851 Heritage Lane, Suite 210  
Sacramento, CA 95815

This Addendum has been prepared to clarify, modify, delete, or add to the drawings and/or specifications for the above referenced project, and revisions to items listed here shall supersede description thereof prior to the above stated date. All conditions not specifically referenced here shall remain the same. It is the obligation of the Prime Contractor to make subcontractors aware of any items herein that may affect submitted bids.

Acknowledge receipt of this addendum by inserting its number and date in the bidding documents. Failure to do so may subject bidder to disqualification.

All addenda items refer to the plans and specifications unless specifically noted otherwise.

TOTAL PAGES IN THIS ADDENDUM (including attachments): 12

## LODI UNIFIED SCHOOL DISTRICT

### 2020 Paving Project(s) – Phase II

PROJECT NUMBER: 0940-8240  
DSA #:02-118113  
Christa McAuliffe Middle School

PROJECT NUMBER: 0951-8251  
DSA #:02-118115  
Westwood Elementary School

## ADDENDUM NO. 1

### PART A - BIDDING AND CONTRACT REQUIREMENTS

- 1.1 The bid date has not changed. Bids are due, March 12, 2020 by 2:00:00 p.m. at the District Office, 1305 E. Vine Street Lodi California 95240.
- 1.2 Refer to Project Manual Title Page, Document 00 01 01-1.
  - 1.2.1 **Replace** in its entirety with Project Manual Title Page, Document 00 01 01-1, Add #1

### PART B - TECHNICAL REQUIREMENTS

- 1.3 N/A

### PART C - DRAWINGS

- 1.4 Westwood Elementary School - Project #0951-8251 – DSA #02-118115. Refer to Drawing Sheet C4.1 Striping and Signage Plan. **Replace** in its entirety with Drawing Sheet C4.1 Striping and Signage, dated 03/04/2020.
- 1.5 Westwood Elementary School - Project #0951-8251 – DSA #02-118115. Refer to Drawing Sheet C5.1 Frontage Improvements. **Delete** sheet C5.1. (Reference new added sheets C6.1, C6.2 and C6.3).
- 1.6 Westwood Elementary School - Project #0951-8251 – DSA #02-118115. Refer to new Drawing Sheet C6.1 Cover Sheet, dated 03/04/2020. **Add** to drawing set.
- 1.7 Westwood Elementary School - Project #0951-8251 – DSA #02-118115. Refer to new Drawing Sheet C6.2 General Notes, dated 03/04/2020. **Add** to drawing set.
- 1.8 Westwood Elementary School - Project #0951-8251 – DSA #02-118115. Refer to new Drawing Sheet C6.3 Frontage Improvements, dated 03/04/2020. **Add** to drawing set.

**LODI UNIFIED SCHOOL DISTRICT**

**2020 Paving Project(s) – Phase II**

**PROJECT NUMBER: 0940-8240**

**DSA #:02-118113**

**Christa McAuliffe Middle School**

**PROJECT NUMBER: 0951-8251**

**DSA #:02-118115**

**Westwood Elementary School**

**ADDENDUM NO. 1**

**PART D – RESPONSES TO CONTRACTOR QUESTIONS**

- 1.9 **Question:** (Christa McAuliffe Middle School Paving Phase II) Per demolition plan sheet C1.1, some of the islands show concrete curb removal, but do not have call outs associated. Please clarify that the only curb to be removed/ installed is the curb around the northwest island, only around the area where the ADA stall is to be installed and where the call outs are associated to the dashed line.

**Response:** Yes, only the curb shown at the ADA stalls are to be removed.

- 1.10 **Question:** (Christa McAuliffe Middle School Paving Phase II) Per grading plan sheet C2.1 and paving plan sheet C3.1 (at the new sidewalk improvements to the northwest), there is a callout for 6" barrier curb to be placed where an existing curb and gutter is located. The demolition plan sheet C1.1 does not show the limits of curb and gutter removal to the extent of the new 6" barrier curb installation. Please confirm a 6" curb and gutter per detail 6 on C3.1 is not to be placed in lieu of the 6" curb that is shown in areas that contain an existing curb and gutter.

**Response:** The note 11 barrier curb is to be constructed behind the existing curb and gutter. Where note 15 is shown it is to replace the existing curb and gutter.

- 1.11 **Question:** (Christa McAuliffe Middle School Paving Phase II) Per demolition plan sheet C1.1, the existing striping is not shown to be removed. Please confirm the existing striping does not need to be removed in any way prior to seal coat.

**Response:** The striping does not need to be removed. It is being restriped in the current configuration.

- 1.12 **Question:** (Westwood El School Paving Phase II) Per grading plan sheet C2.1, construction notes 4, 5, 6, and 7 describe the installation of a CONTECH unit, but there no specs or details provided. Please clarify which type of CONTECH unit is to be installed and provide a detail.

**Response:** Contact Contech Representative (Sara Merrill @ 503-258-3150) for the unit information.

**LODI UNIFIED SCHOOL DISTRICT**

**2020 Paving Project(s) – Phase II**

**PROJECT NUMBER: 0940-8240**

**DSA #:02-118113**

**Christa McAuliffe Middle School**

**PROJECT NUMBER: 0951-8251**

**DSA #:02-118115**

**Westwood Elementary School**

**ADDENDUM NO. 1**

**PART E – List of Attachments**

- 1.13 Project Manual Title Page Document 00 01 01-1, Add #1 (1 Page)
- 1.14 Pre-bid Conference & Site Visit Agenda. (1 Page)
- 1.15 Pre-Bid Conference & Site Visit - Sign-In Sheet for projects 0940-8240 & 0951-8251 (2 Pages)
- 1.16 Drawing Sheet C4.1 Striping and Signage Plan, dated 03/04/2020 (1 Page)
- 1.17 Drawing Sheet C6.1 Cover Sheet, dated 03/04/2020 (1 Page)
- 1.18 Drawing Sheet C6.2 General Notes, dated 03/04/2020 (1 Page)
- 1.19 Drawing Sheet C6.3 Frontage Improvements, dated 03/04/2020 (1 Page)

**End of Addendum**

# PROJECT MANUAL

## 2020 Paving Project(s) – Phase II

**PROJECT NUMBER:** 0940-8240

**DSA #:** 02-118113

**Christa McAuliffe Middle School  
3880 Iron Canyon Circle  
Stockton, CA 95209**

**PROJECT NUMBER:** 0951-8251

**DSA #:** 02-118115

**Westwood Elementary School  
9444 Caywood Drive  
Stockton, CA 95210**

**February 11, 2020**

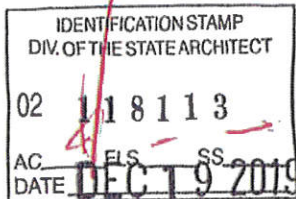

**Lodi Unified School District  
2020 Paving Project(s)  
Christa McAuliffe MS & Westwood ES Paving Project  
Project No. 0940-8240 & 0951-8251**

**PRE-BID CONFERENCE & SITE VISIT AGENDA**

**Date:** Thursday, February 20, 2020 **Time:** 3:00 p.m.  
**Schools:** Christa McAuliffe Middle School and Westwood Elementary School  
**Bid Date:** Thursday, March 12, 2020 by 2:00:00 p.m. at the LUSD Office





- I. **Meeting Called to Order**
- II. **Introduction of Project Team**
  - A. District Representative, Vicki Brum, Katie Madzier, & Joe Patty Planning & Facilities
  - B. Capital Program Management, Craig Dooling and Dany Mendez
  - C. Tom Fassbender, Warren Consulting Engineering, Inc., Civil Engineer
- III. **Bidding Documents:** Available from District <https://www.lodiusd.net/district/departments/business-services/facilities-and-planning/fp-projects>. Also available at Builder's Exchange of Sac and Stockton and Valley Builder's Exchange.
- IV. **Contracting Format:** (1) Prime Contract
- V. **Scope of Work Descriptions:** Document 01 11 00 Part 1.02 Summary of Work and Drawings
- VI. **Engineer's Estimated Construction Budget:** Christa McAuliffe MS (\$96,000.00), Westwood EI (\$850,000.00)
- VII. **Bidding and Contract Award Requirements:**
  - A. License requirement(s): A or B
  - B. Bid Bond or Certified Check, 10% of bid
  - C. Prevailing Wages - certified payrolls, payroll records and other documents shall be required along with your progress billings: [www.dir.ca.gov/dlsr/DPreWageDetermination.htm](http://www.dir.ca.gov/dlsr/DPreWageDetermination.htm)
  - D. DIR Registration of Contractor & Subcontractors (See General Conditions, Section 0072 13)
  - E. Disabled Veterans Business Enterprise (DVBE – Section 00 45 46.02)
  - F. Bond and Insurance Requirements (See General Conditions, Section 00 72 13)
  - G. Pre-Qualified Bid Requirements – <https://pqbids.com/lodi/>
  - H. Bid Form (See Bid Form, Section 00 41 13):
    1. Completed Forms
    2. No Iran Contra Document required
    3. No faxes, phone or email bids
    4. Bids good for 90 days
- VIII. **Inspection Procedures:** DSA Project Inspector: Jim Girard
- IX. **Project Schedule:** See Document 00 01 20 List of Schedules. Start date of Construction is June 1, 2020 and completion date is July 31, 2020.
- X. **Department of Justice (DOJ) Clearance, Badges and Security:** District Protocols. DOJ clearance for Supervisors and Visitor Badges for work crew.
- XI. **Site Information:**
  - A. Contact: Dany Mendez C: 916-779-5921
  - B. Site access, temporary facilities, staging areas and parking
  - C. Conduct on school premises: No dialogue or contact with students, no smoking or tobacco and all employees on site are to conduct themselves professionally.
  - D. Contractor's working hours: 7:00 am - 3:30 pm
  - E. Contractor's supervision: The designated Superintendent must be present at all times when subcontractors or self-performance work is taking place.
  - F. Tribal monitoring for cultural artifacts – Westwood Elementary Only. (See Special Conditions, 00 73 13)
- XII. **Owner Meetings:** Weekly. At site and room TBD
- XIII. **Questions**
- XIV. **Adjournment**

**Important note:** Responses to inquiries and discussions occurring at this pre-bid walk-through shall in no way change or modify the bid documents. The bid documents will be affected only by addenda issued prior to the bid date.

Send written inquiries by EOB February 27, 2020 to: Dany Mendez: [danym@capitalpm.com](mailto:danym@capitalpm.com) and Craig Dooling: [craigd@capitalpm.com](mailto:craigd@capitalpm.com).



Lodi Unified School District  
 PRE-BID CONFERENCE AND SITE VISIT SIGN-IN SHEET FOR  
 Project No. 0940-8240 & 0951-8251  
 Christa McAuliffe MS & Westwood ES Paving Project  
 Thursday, February 20, 2020  
 3:00 PM

Company Name & Representative Name	Company Street Address	Phone #	E-Mail	Initials Christa McAuliffe MS	Initials Westwood ES
George Reed, Inc. Steve Geneaux	146 Empire Ave. Modesto, CA 95354	(510) 714 5596	Steve.geneaux@georgereed.com		
Operating Engineers Local 3	Stockton, CA	(209) 420-8014	jcurtin@oe3.org		
McEwen Const. Inc	3763269 Switzer Rd Loomis CA 95650	(916) 275-6107	cdales@mceweninc.com		

Lodi Unified School District  
 PRE-BID CONFERENCE AND SITE VISIT SIGN-IN SHEET FOR  
 Project No. 0940-8240 & 0951-8251  
 Christa McAuliffe MS & Westwood ES Paving Project  
 Thursday, February 20, 2020  
 3:00 PM

Company Name & Representative Name	Company Street Address	Phone #	E-Mail	Initials Christa McAuliffe MS	Initials Westwood ES
McFadden construction Dustin Kettering	7707 Murray Pr Stockton CA 95210	209 4787407	DustinK@McFaddenconstruction.com	DK	DK
BRCO Constructors, Inc Ameer Omary	3650 Cincinnati Ave. Rocklin, CA 95765	(916)253-9373	AOmary@90brc.com	AO	AO
WESTERN ENGINEERING Scott Rogers	3171 RIPPEY ROAD LOOMIS, CA 95650	916-873-7344	srogers@westeng.com	SR	SR
GOODLAND CONSTRUCTION JOSH HEBERT	2455 N. NABLEE #402 TRACY CA 95304	(209)835-9956	jhebert@goodlandca.com	JH	JH



PROVIDE ACCESSIBLE SIGNAGE MOUNTED ON 2" SCH 40 GALV MTL POLE STALL SIGN W/ VAN ACCESSIBLE SIGN SEE DETAIL

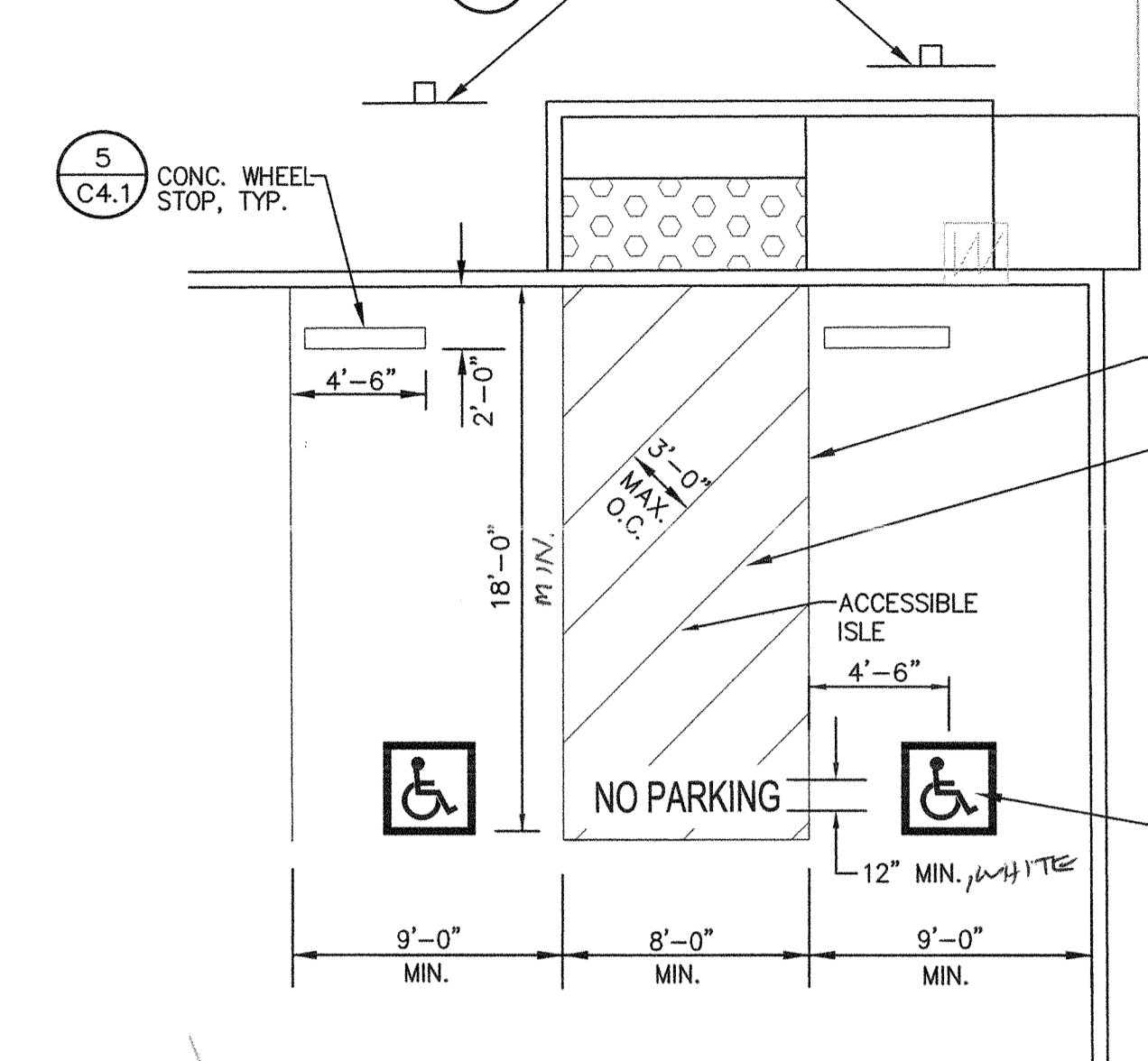

1 ACCESSIBLE PARKING A  
C4.1 NO SCALE

PROVIDE ACCESSIBLE SIGNAGE MOUNTED ON 2" SCH 40 GALV MTL POLE STALL SIGN W/ VAN ACCESSIBLE SIGN SEE DETAIL

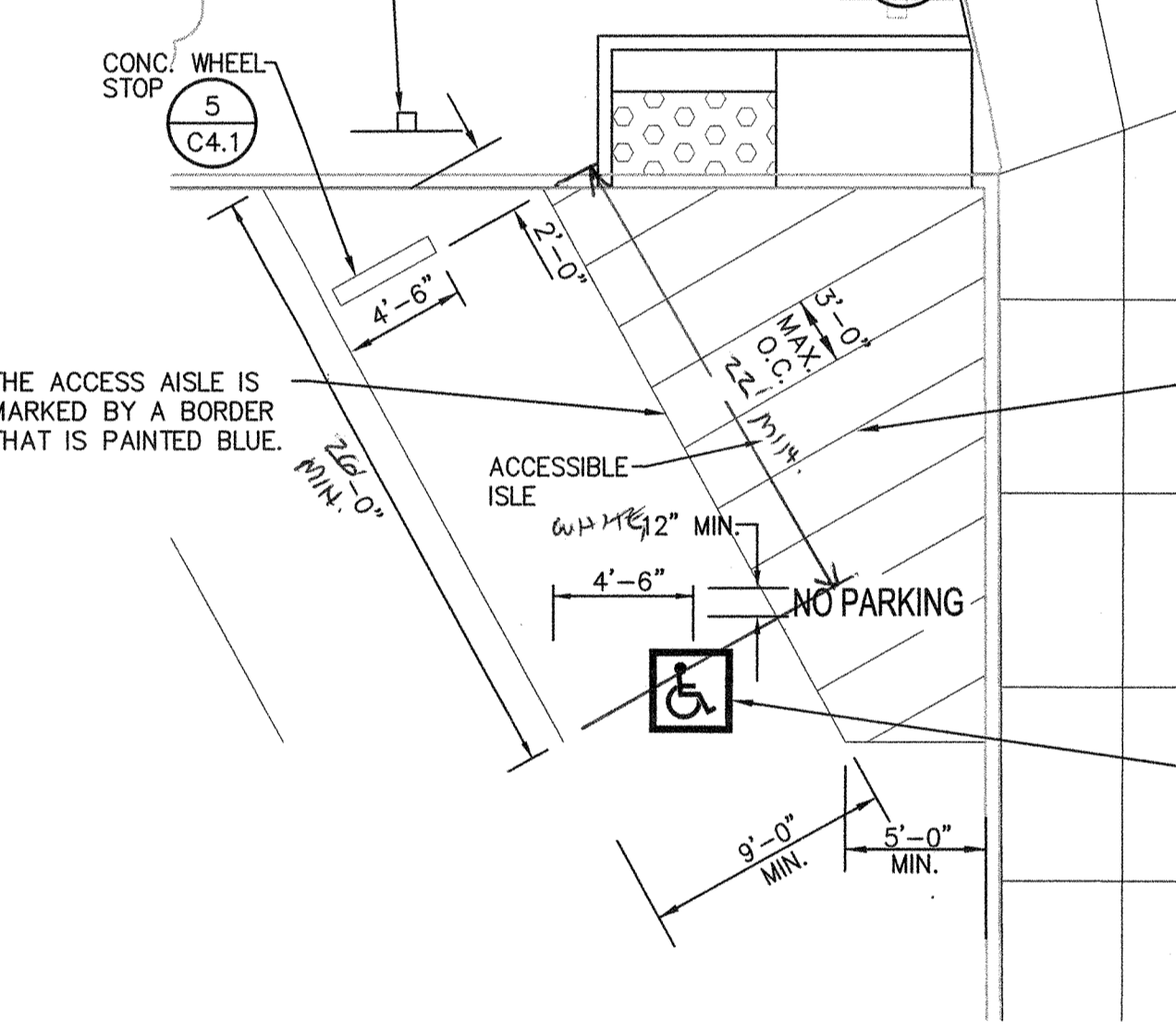

2 ACCESSIBLE PARKING B  
C4.1 NO SCALE

PROVIDE ACCESSIBLE SIGNAGE MOUNTED ON 2" SCH 40 GALV MTL POLE STALL SIGN W/ VAN ACCESSIBLE SIGN SEE DETAIL

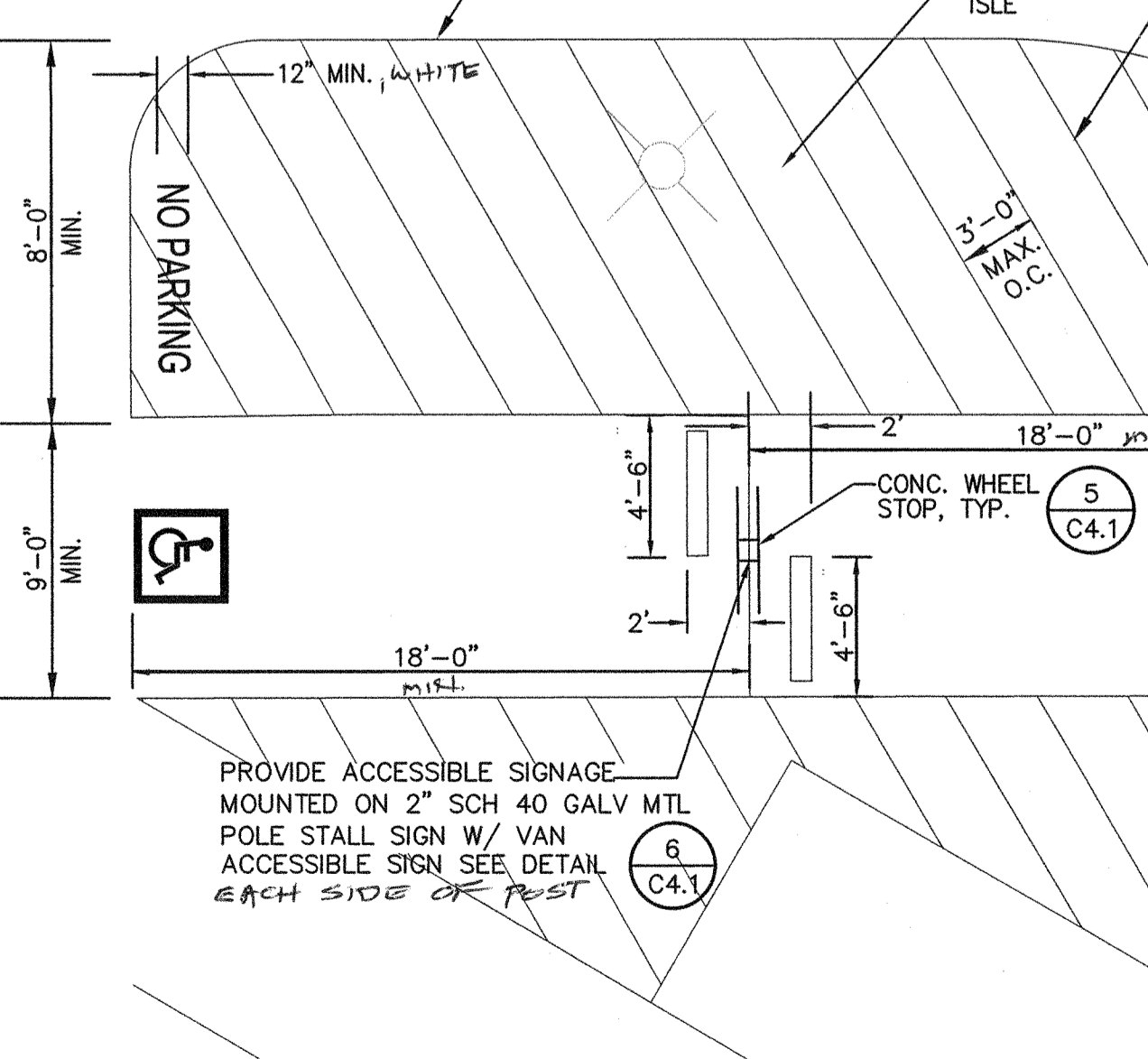

3 ACCESSIBLE PARKING C  
C4.1 NO SCALE

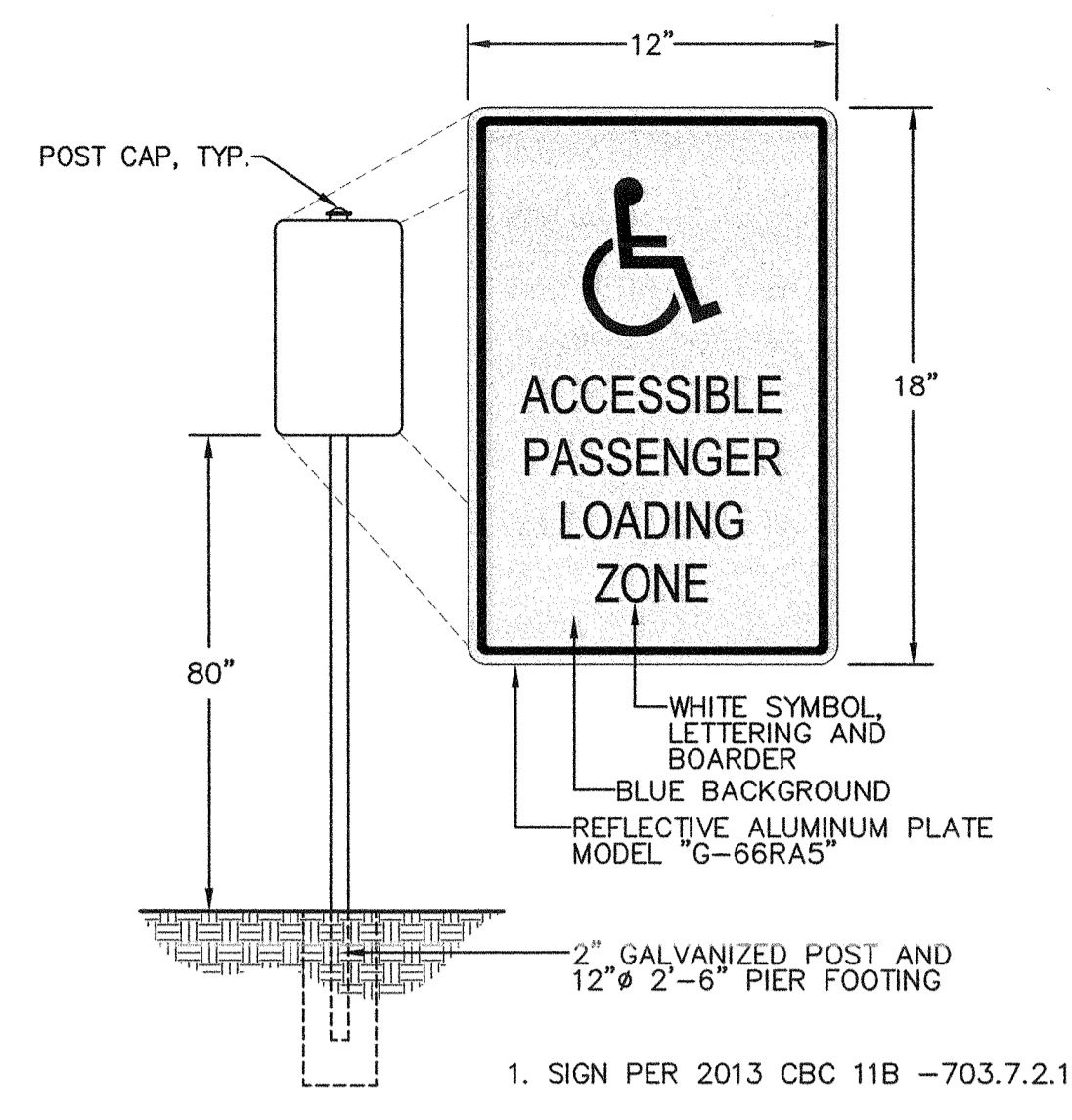

4 ACCESSIBLE LOADING ZONE SIGN  
C4.1 G-66RA5 NO SCALE

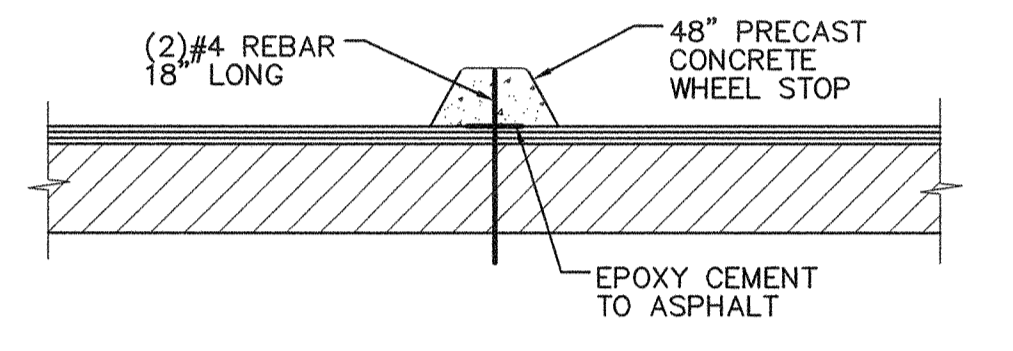

5 CONCRETE WHEEL STOP  
C4.1 NO SCALE

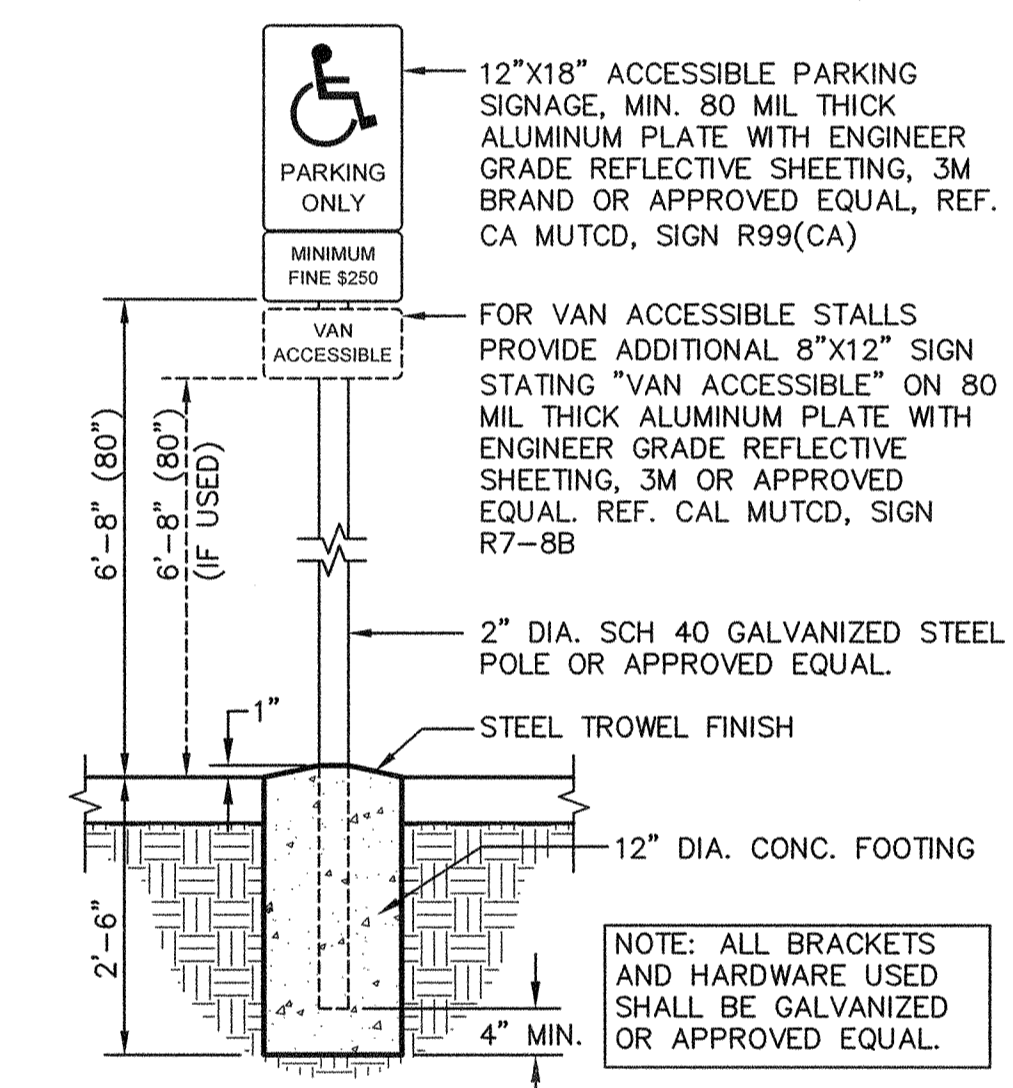

6 PARKING SIGNAGE  
C4.1 ACCESSIBLE STALLS (CALIFORNIA ONLY) NO SCALE

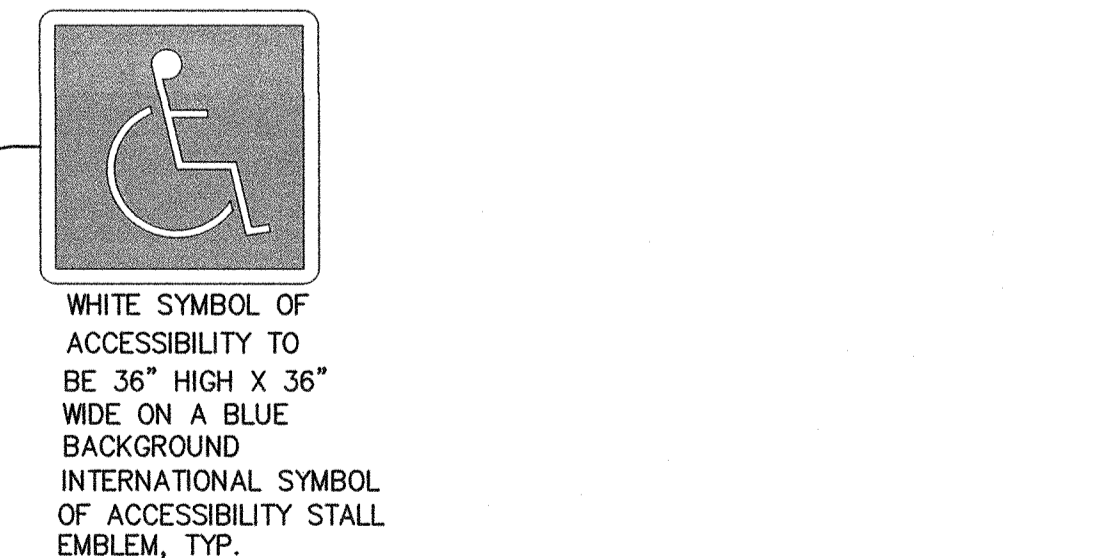

7 PARKING AREA SIGN  
C4.1 (CALIFORNIA ONLY) NO SCALE

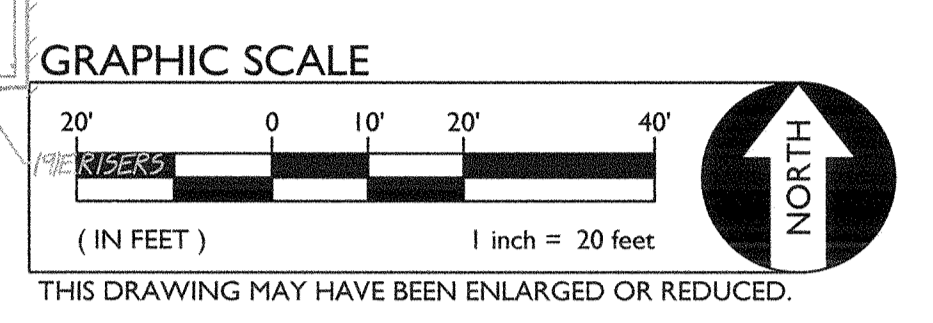
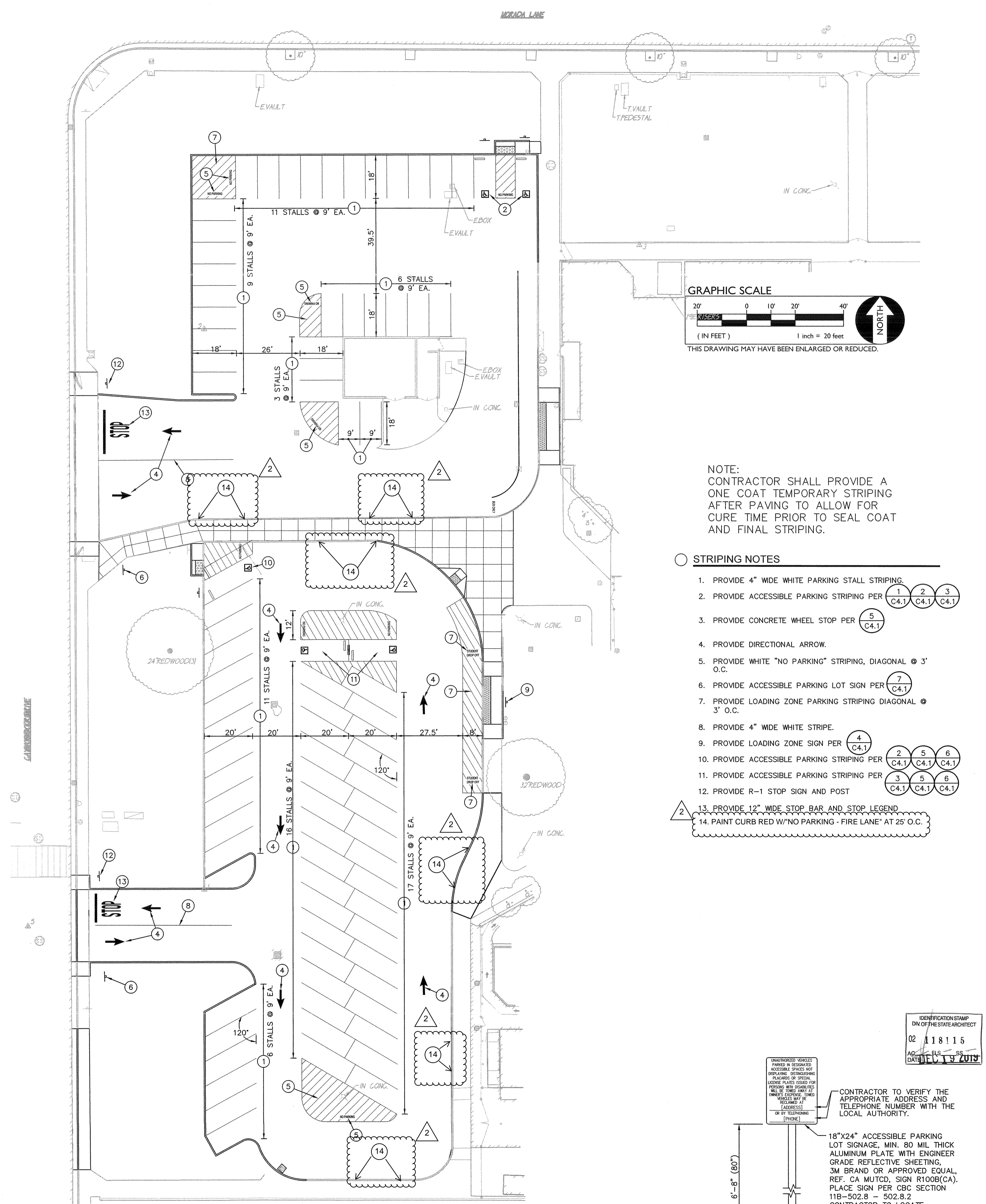

NOTE: CONTRACTOR SHALL PROVIDE A ONE COAT TEMPORARY STRIPING AFTER PAVING TO ALLOW FOR CURE TIME PRIOR TO SEAL COAT AND FINAL STRIPING.

- STRIPING NOTES
- PROVIDE 4" WIDE WHITE PARKING STALL STRIPING
  - PROVIDE ACCESSIBLE PARKING STRIPING PER (1, 2, 3) (C4.1, C4.1, C4.1)
  - PROVIDE CONCRETE WHEEL STOP PER (5) (C4.1)
  - PROVIDE DIRECTIONAL ARROW
  - PROVIDE WHITE "NO PARKING" STRIPING, DIAGONAL @ 3' O.C.
  - PROVIDE ACCESSIBLE PARKING LOT SIGN PER (7) (C4.1)
  - PROVIDE LOADING ZONE PARKING STRIPING DIAGONAL @ 3' O.C.
  - PROVIDE 4" WIDE WHITE STRIPE
  - PROVIDE LOADING ZONE SIGN PER (4) (C4.1)
  - PROVIDE ACCESSIBLE PARKING STRIPING PER (2, 5, 6) (C4.1, C4.1, C4.1)
  - PROVIDE ACCESSIBLE PARKING STRIPING PER (3, 5, 6) (C4.1, C4.1, C4.1)
  - PROVIDE R-1 STOP SIGN AND POST
  - PROVIDE 12" WIDE STOP BAR AND STOP LEGEND
  - PAINT CURB RED W/NO PARKING - FIRE LANE AT 25' O.C.

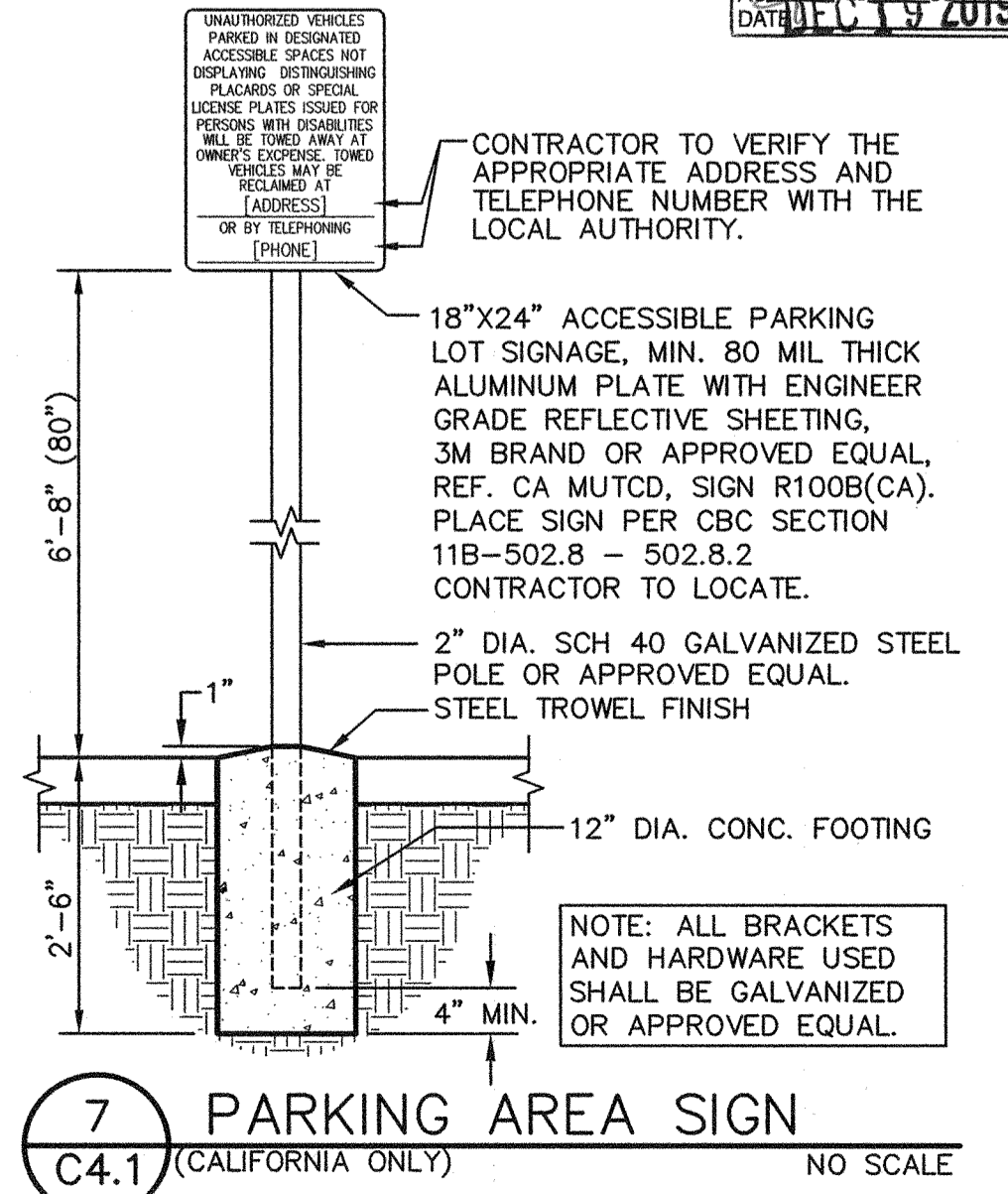

FILENAME: \\19-095\DWG\DWG\19-095-C4.1.DWG PLOTTED: Wednesday, December 18, 2019

DESIGNED BY	DATE	03/04/20
DRAWN BY	DATE	
CHECKED BY	DATE	
IN CHARGE	DATE	
AGENCY APPROVAL	DATE	
AS NOTED	DATE	
VERTICAL SCALE	AS NOTED	
HORIZONTAL SCALE	AS NOTED	
BENCHMARK NO.		
ELEV.		
JOB NO.	19-095	
TITLE	STRIPING AND SIGNAGE PLAN	
PROJECT	WESTWOOD ELEMENTARY SCHOOL PAVING PHASE II LODI USD	
SHEET NO.	C4.1	

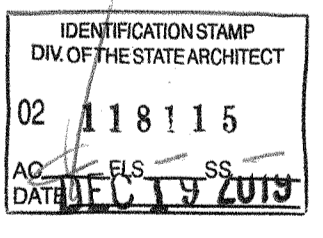
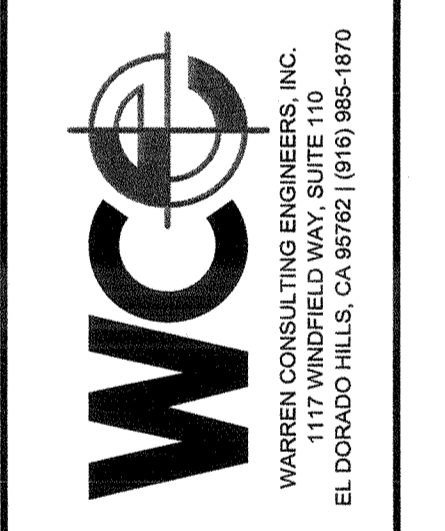
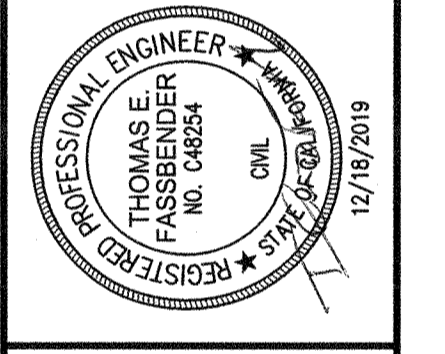



**ABBREVIATIONS**  
NOTE: NOT ALL ABBREVIATIONS MAY BE USED ON THESE PLANS.

- AB AGGREGATE BASE
- AC ASPHALTIC CONCRETE
- AD AREA DRAIN
- APN ASSESSOR'S PARCEL NUMBER
- ARV AIR RELEASE VALVE
- ASB AGGREGATE SUB-BASE
- BO BLOW-OFF VALVE
- BV BUTTERFLY VALVE
- BW BACK OF WALK
- C/L CENTERLINE
- CB ATCH BASIN
- CL CLASS
- CMP CORRUGATED METAL PIPE
- CATV CABLE TELEVISION
- CO CLEANOUT
- COMM COMMUNICATION
- CONC. CONCRETE
- CONSTR. CONSTRUCT
- CR CURB RETURN
- CS CONCRETE SURFACE
- DC DOUBLE CHECK VALVE
- DDC DOUBLE DETECTOR CHECK VALVE
- DG DECOMPOSED GRANITE
- DI DROP INLET
- DIA DIAMETER
- DIP DUCTILE IRON PIPE
- DWG DRAWING
- DS DOWNSPOUT
- E ELEVATION
- EP EDGE OF PAVEMENT
- ESMT EASEMENT
- EX EXISTING
- FS FIRE SERVICE LINE
- FD FIRE DEPARTMENT CONNECTION
- FL FLOWLINE
- FM SANITARY SEWER FORCE MAIN
- FF FINISHED FLOOR ELEVATION
- FH FIRE HYDRANT
- G GAS
- GR GRATE ELEVATION
- GRD GRADE ELEVATION
- GV GATE VALVE
- HB HOSE BIBB
- HBD HEADER BOARD
- HDPD HIGH DENSITY POLYETHYLENE PIPE
- HP HIGH POINT
- INV PIPE INVERT ELEVATION
- JP JOINT UTILITY POLE
- LF LINEAL FEET
- LIP LIP OF GUTTER
- LT LEFT
- MS MOWSTRIP
- NTS NOT TO SCALE
- OH OVERHEAD
- PCC PORTLAND CEMENT CONCRETE
- PD PLANTER DRAIN
- PIV POST INDICATOR VALVE
- P/L PROPERTY LINE
- PP POWER POLE
- PUE PUBLIC UTILITY EASEMENT
- PVC POLYVINYL CHLORIDE
- RCP REINFORCED CONCRETE PIPE
- R RADIUS
- RIM MANHOLE RIM ELEVATION (SOLID COVER)
- RP REDUCED PRESSURE BACKFLOW PREVENTER
- RRFD RECTANGULAR RAPID FLASH BEACON
- RW RIGHT OF WAY
- SCH SCHEDULE
- SD STORM DRAIN
- SDMH STORM DRAIN MANHOLE
- SG SUBGRADE ELEVATION
- SS SANITARY SEWER
- SSMH SANITARY SEWER MANHOLE
- STD STANDARD
- S/W SIDEWALK
- T TELEPHONE
- TC TOP OF CURB
- TD TRENCH DRAIN
- TDCB TRENCH DRAIN CATCH BASIN
- TP TELEPHONE POLE
- TRW TOP OF RETAINING WALL
- TSW TOP OF SEAT WALL
- TW TOP OF WALK ELEVATION
- U UTILITY
- UG UNDERGROUND
- UN UNLESS OTHERWISE NOTED
- VCP VITRIFIED CLAY PIPE
- W WATER
- W WITH
- W/O WITHOUT
- WV WATER VALVE

**LEGEND**  
NOTE: NOT ALL SYMBOLS MAY BE USED ON THESE PLANS.

- PROPOSED GRADING & DRAINAGE SYMBOLS:**
- STORM DRAIN LINE (SIZE AND FLOW SHOWN)
  - STORM DRAIN MANHOLE (SDMH)
  - CATCH BASIN (CB)
  - DROP INLET (DI)
  - AREA DRAIN (AD)
  - PLANTER DRAIN (PD) OR FLOOR DRAIN (FD)
  - STORM DRAIN CLEANOUT
  - FINISHED FLOOR ELEVATION
  - BUILDING PAD ELEVATION
  - CONCRETE SIDEWALK
  - GRADED DIRECTION FOR DRAINAGE FLOW
  - SWALE
  - SLOPE
  - TREE TO BE REMOVED

# WESTWOOD ELEMENTARY SCHOOL

## FRONTAGE IMPROVEMENTS

9444 CAYWOOD DRIVE  
STOCKTON, CA. 95210

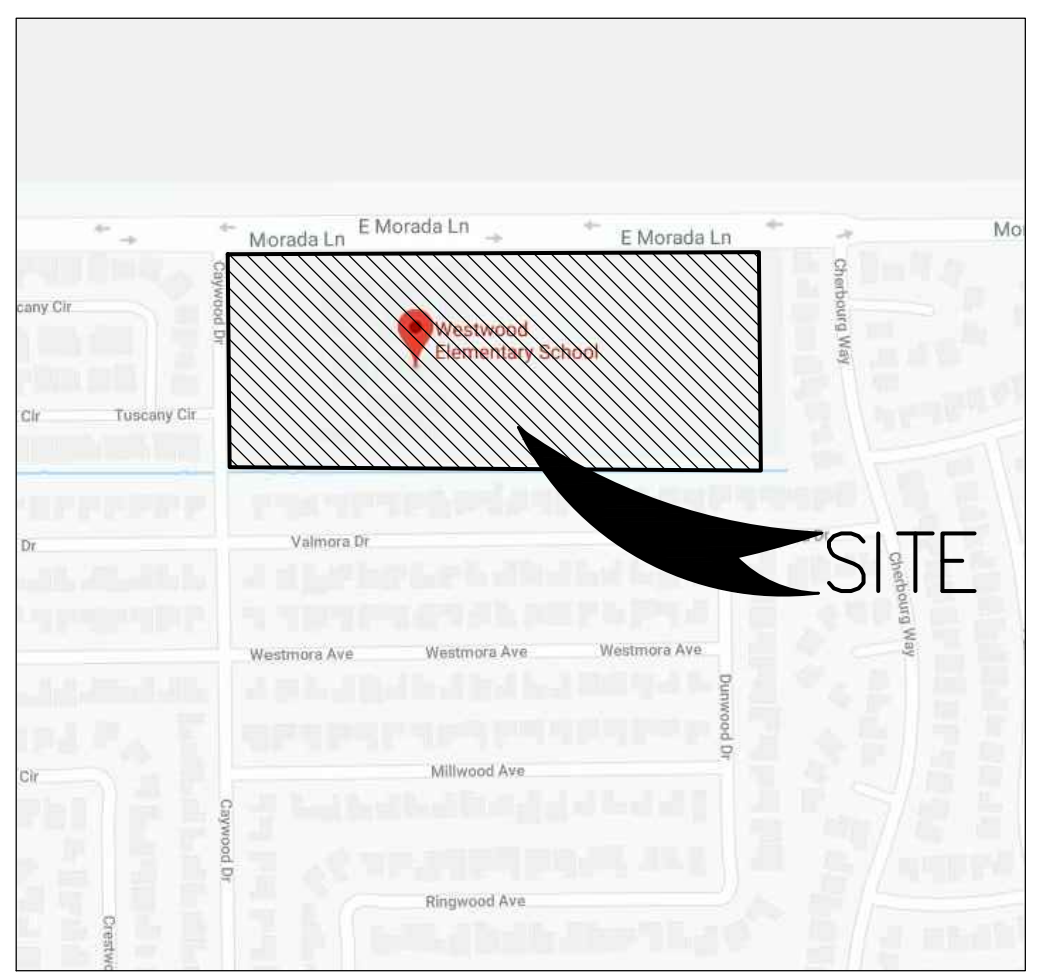
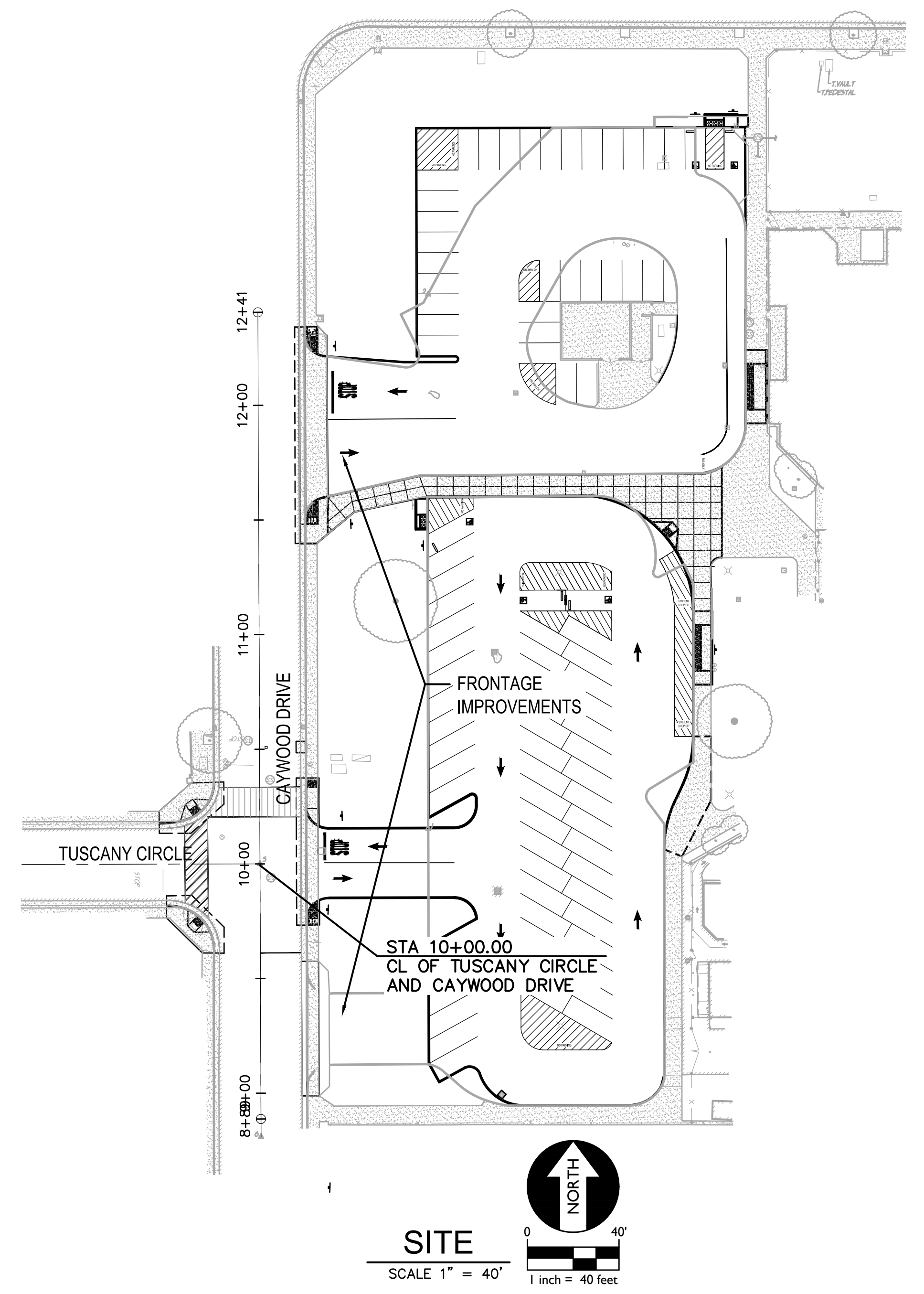

**SHEET INDEX**

C6.1	COVER SHEET
C6.2	GENERAL NOTES
C6.3	GRADING AND DEMOLITION PLAN

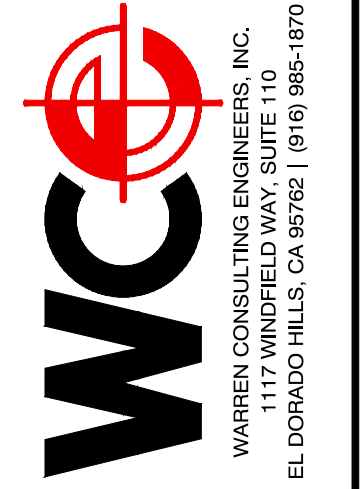
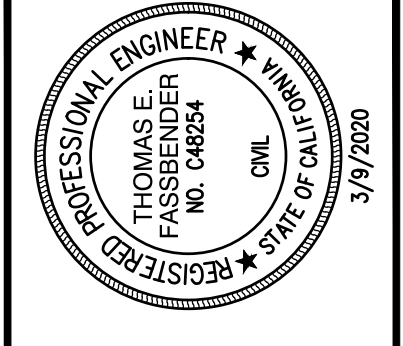

COVER SHEET  
**WESTWOOD ELEMENTARY SCHOOL**  
9444 CAYWOOD DRIVE  
STOCKTON, CALIFORNIA

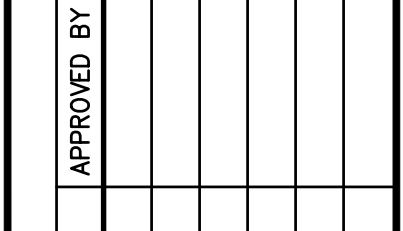

A.P.N. 090-590-010  
BENCHMARK NO. - ELEV. -  
\*\*ASSUMED\*\*



**NOTE:**  
THE TYPES, LOCATIONS, SIZES AND/OR DEPTHS OF EXISTING UNDERGROUND UTILITIES AS SHOWN ON THESE PLANS WERE OBTAINED FROM SOURCES OF VARYING RELIABILITY. THE CONTRACTOR IS CAUTIONED THAT ONLY ACTUAL EXCAVATION WILL REVEAL THE TYPES, EXTENT, SIZES, LOCATIONS, AND DEPTHS OF SUCH UNDERGROUND UTILITIES. A REASONABLE EFFORT HAS BEEN MADE TO LOCATE AND DELINEATE ALL KNOWN UNDERGROUND UTILITIES. HOWEVER, WARREN CONSULTING ENGINEERS CAN ASSUME NO RESPONSIBILITY FOR THE COMPLETENESS OR ACCURACY OF ITS DELINEATION OF SUCH UNDERGROUND UTILITIES, NOR FOR THE EXISTENCE OF OTHER BURIED OBJECTS OR UTILITIES WHICH MAY BE ENCOUNTERED BUT WHICH ARE NOT SHOWN ON THESE DRAWINGS.

WESTWOOD ELEMENTARY SCHOOL 9444 CAYWOOD DRIVE STOCKTON, CALIFORNIA 95210		
<b>COVER SHEET</b>		
DEPARTMENT OF PUBLIC WORKS CITY OF STOCKTON, CALIFORNIA		
SCALE: AS NOTED	APPROVED BY: DATE:	SHEET NO. <b>C6.1</b>
DESIGNED BY: TF	CITY ENGINEER STOCKTON, CA.	PROJECT NO. 19-095
DRAWN BY: TB		
CHECKED BY: TF		

REVISIONS	
NO.	DESCRIPTION

TITLE: PROJECT: SHEET NO.	COVER SHEET <b>WESTWOOD ELEMENTARY SCHOOL</b> PAVING PHASE II LODI USD	A.P.N. BENCHMARK NO. - ELEV. - JOB NO.: 19-095	DESIGNED: TF DRAWN: ML CHECKED: TF DATE: 12-19-19 REVISIONS: NO. DESCRIPTION 1 ADDENDUM 1 DATE 03/07/20
---------------------------------	---	--	--

FILENAME: \\19-095\CVL\DWG\19-095-C6.1-C6.3.DWG PLOTTED: Monday, March 09, 2020



### GENERAL NOTES

1. ALL IMPROVEMENTS SHALL BE CONSTRUCTED IN STRICT ACCORDANCE WITH THE FOLLOWING: CITY OF STOCKTON STANDARD SPECIFICATIONS AND PLANS ADOPTED SEPTEMBER 27, 2016, AND ALL AMENDMENTS THERETO TO DATE, CALIFORNIA DEPARTMENT OF TRANSPORTATION STANDARD SPECIFICATIONS (CALTRANS) LATEST EDITION AND CA MUTGD LATEST EDITION, WHERE APPLICABLE. WHERE THERE IS A CONFLICT BETWEEN THE PLANS AND THE CITY'S STANDARD SPECIFICATIONS AND PLANS, THE CITY OF STOCKTON STANDARD SPECIFICATIONS AND PLANS SHALL PREVAIL. ALL WORK SHALL BE UNDER THE INSPECTION OF THE CITY OF STOCKTON.
2. PRIOR TO THE SCHEDULING OF A PRE-CONSTRUCTION MEETING OR THE ISSUANCE OF AN ENCROACHMENT PERMIT THE DEVELOPER OR CONTRACTOR SHALL OBTAIN A GRADING PERMIT FROM THE CITY OF STOCKTON'S COMMUNITY DEVELOPMENT DEPARTMENT, BUILDING DIVISION.
3. THE CONTRACTOR SHALL CONTACT JASON ENDER (209) 937-8381 OF THE CITY OF STOCKTON FOR PRE-CONSTRUCTION CONFERENCE A MINIMUM OF THREE (3) WORKING DAYS PRIOR TO THE COMMENCEMENT OF WORK.
4. THE CONTRACTOR SHALL BE RESPONSIBLE FOR ALL PERMITS AND LICENSES REQUIRED FOR THE CONSTRUCTIONS AND COMPLETION OF THE PROJECT, AND SHALL PERFORM ALL WORK IN ACCORDANCE WITH THE REQUIREMENTS AND CONDITIONS OF ALL PERMITS AND APPROVALS APPLICABLE TO THIS PROJECT. THE CONTRACTOR SHALL ENSURE THAT THE NECESSARY RIGHTS- OF-WAY, EASEMENTS, AND/OR PERMITS ARE SECURED PRIOR TO CONSTRUCTION.
5. CONTRACTOR SHALL OBTAIN AN ENCROACHMENT PERMIT WHERE APPLICABLE FOR ANY WORK DONE WITHIN RIGHTS-OF-WAY OR EASEMENTS FROM CITY OF STOCKTON. CONTRACTOR SHALL NOTIFY CITY, 3 WORKING DAYS IN ADVANCE OF COMMENCING THE WORK OR AS REQUIRED BY SAID PERMITS.
6. ALL STATIONS REFER TO DISTANCE ALONG STREET CENTERLINE, UNLESS OTHERWISE NOTED. ALL STATIONS OFF CENTERLINE ARE PERPENDICULAR TO OR RADIIALLY OPPOSITE CENTERLINE STATIONS.
7. THE CONTRACTOR SHALL PROVIDE ALL LIGHTS, BARRICADES, SIGNS, FLAGMEN OR OTHER DEVICES NECESSARY FOR PUBLIC SAFETY.
8. CONTRACTOR SHALL SUBMIT A TRAFFIC CONTROL AND/OR DETOUR PLAN FOR APPROVAL BY THE CITY OF STOCKTON TRAFFIC ENGINEER PRIOR TO THE START OF CONSTRUCTION.
9. THE CONTRACTOR SHALL BE HELD RESPONSIBLE FOR ANY FIELD CHANGES MADE WITHOUT PRIOR WRITTEN AUTHORIZATION FROM THE OWNER AND THE CITY ENGINEER.
10. DUST CONTROL SHALL BE PROVIDED AT ALL TIMES, AT THE CONTRACTOR'S EXPENSE, TO MINIMIZE ANY DUST NUISANCE AND SHALL BE IN ACCORDANCE WITH SECTION 10 OF CALTRANS STANDARD SPECIFICATIONS AND THE REQUIREMENTS OF THE CITY OF STOCKTON. CONTRACTOR SHALL OBTAIN A PERMIT FROM THE CITY OF STOCKTON MUNICIPAL UTILITIES DEPARTMENT (CALIFORNIA WATER SERVICE COMPANY) FOR USE OF WATER FROM FIRE HYDRANTS FOR CONSTRUCTION PURPOSES. THE PERMIT SHALL BE APPROVED BY THE CITY OF STOCKTON FIRE DEPARTMENT.
11. WHENEVER EXISTING FACILITIES ARE REMOVED, DAMAGED, BROKEN OR CUT IN THE INSTALLATION OF WORK COVERED BY THESE PLANS OR SPECIFICATIONS, SAID FACILITIES SHALL BE REPLACED AT THE CONTRACTOR'S EXPENSE, AFTER PROPER BACKFILLING AND/OR CONSTRUCTION, WITH MATERIALS EQUAL TO OR BETTER THAN THE MATERIALS USED IN THE ORIGINAL EXISTING FACILITIES. THE FINISHED PRODUCT SHALL BE SUBJECT TO THE APPROVAL OF THE OWNER, THE ENGINEER, AND THE RESPECTIVE REGULATORY AGENCY.
12. THE CONTRACTOR SHALL MAINTAIN A NEATLY MARKED SET OF FULL-SIZE AS-BUILT RECORD DRAWINGS SHOWING THE FINAL LOCATION AND LAYOUT OF ALL MECHANICAL, ELECTRICAL AND INSTRUMENTATION EQUIPMENT; PIPING AND CONDUITS; STRUCTURES AND OTHER FACILITIES. THE AS-BUILT RECORD SHALL INCLUDE THE STREET LIGHT LAYOUT PLAN SHOWING LOCATION OF LIGHTS, CONDUITS, CONDUCTORS, POINTS OF CONNECTIONS TO SERVICES, PULLBOXES, AND WIRE SIZES. AS-BUILT RECORD DRAWINGS SHALL REFLECT CHANGE ORDERS, ACCOMMODATIONS, AND ADJUSTMENTS TO ALL IMPROVEMENTS CONSTRUCTED. WHERE NECESSARY, SUPPLEMENTAL DRAWINGS SHALL BE PREPARED AND SUBMITTED BY THE CONTRACTOR. PRIOR TO ACCEPTANCE OF THE PROJECT, THE CONTRACTOR SHALL DELIVER TO THE ENGINEER, ONE SET OF NEATLY MARKED AS-BUILT RECORD DRAWINGS SHOWING THE INFORMATION REQUIRED ABOVE. AS-BUILT RECORD DRAWINGS SHALL BE REVIEWED AND THE COMPLETE AS-BUILT RECORD DRAWING SET SHALL BE CURRENT WITH ALL CHANGES AND DEVIATIONS REDLINED AS A PRECONDITION TO THE FINAL PROGRESS PAYMENT APPROVAL AND/OR FINAL ACCEPTANCE.
13. THIS SUBDIVISION WILL NOT BE IN THE CITY FOR ACCEPTANCE OF IMPROVEMENTS UNTIL ALL STREET LIGHTS ARE INSTALLED AND ENERGIZED. COMPLETE AS-BUILT PLANS ARE ALSO REQUIRED PRIOR TO INSPECTION.
14. PRIOR TO COMMENCING ANY WORK, IT SHALL BE THE CONTRACTOR'S RESPONSIBILITY TO HAVE EACH UTILITY COMPANY LOCATE IN THE FIELD THEIR MAIN AND SERVICE LINES. THE CONTRACTOR SHALL NOTIFY MEMBERS OF THE UNDERGROUND SERVICE ALERT (U.S.A.) 48 HOURS IN ADVANCE OF PERFORMING EXCAVATION WORK BY CALLING THE TOLL-FREE NUMBER (800) 227-2600.
15. THE CONTRACTOR SHALL PROVIDE ALL SHORING, BRACING, SLOPING OR OTHER PROVISIONS NECESSARY TO PROTECT WORKMEN FOR ALL AREAS TO BE EXCAVATED TO A DEPTH OF 5 FEET OR MORE. EXCAVATIONS OF 5 FEET OR MORE IN DEPTH WILL REQUIRE AN EXCAVATIONS PERMIT FROM THE STATE OF CALIFORNIA DEPARTMENT OF INDUSTRIAL SAFETY FOR TRENCHES 5 FEET OR MORE IN DEPTH. THE CONTRACTOR SHALL COMPLY WITH SECTION 5-102A OF THE CALTRANS STANDARDS, SECTION 6705 OF THE STATE OF CALIFORNIA LABOR CODE, AND ANY OTHER LOCAL CODES OR ORDINANCES.
16. THE PROPERTY OWNERS, DEVELOPER, AND/OR SUCCESSORS IN INTEREST SHALL COMPLY WITH THE PROVISIONS OF THE CALIFORNIA GENERAL CONSTRUCTION ACTIVITY STORM WATER PERMIT AND STATE WATER RESOURCES CONTROL BOARD ORDER NUMBER 2009-0009-DWQ. COMPLIANCE IS MANDATORY PER THE CITY OF STOCKTON'S GRADING AND EROSION CONTROL ORDINANCE CHAPTER 15, SECTIONS 15.48.010 THROUGH 15.48.140 OF THE STOCKTON MUNICIPAL CODE.
17. LOCATION OF SAW CUTTING AS REPRESENTED ON THESE PLANS SHALL BE DETERMINED IN THE FIELD WITH THE CITY INSPECTOR. IF THE EXISTING SECTION REQUIRES GRINDING OR OVERLAYING OF AC, IT SHALL BE DETERMINED IN THE FIELD WITH THE CITY INSPECTOR.
18. CONTRACTOR SHALL PRESERVE ALL EXISTING SURVEY MONUMENTS, PROPERTY PINS ETC., AFFECTED BY PROJECT IN ACCORDANCE WITH SECTION 8771 OF THE PROFESSIONAL LAND SURVEYORS ACT IN BUSINESS AND PROFESSIONS CODE OF THE STATE OF CALIFORNIA. LOCATIONS OF EXISTING MONUMENTATION KNOWN TO THE ENGINEER THAT ARE WITHIN THE AREA OF PROJECT HAVE BEEN INDICATED ON THE PLANS. CONTRACTOR'S LICENSED SURVEYOR SHALL TIE DOWN EXISTING MONUMENTS AND SUBMIT THE INFORMATION TO THE ENGINEER. A NEW RECORD OF SURVEY SHALL BE FILED AT COUNTY'S RECORDER'S OFFICE.
19. THESE PLANS ARE HEREBY MADE PART OF THE CONTRACT SPECIFICATIONS FOR THIS PROJECT.
20. PROVISIONS OF THE CITY OF STOCKTON, DEPT. OF PUBLIC WORKS, STANDARD SPECIFICATIONS AND PLANS, AND THE LATEST EDITIONS OF CALTRANS STANDARD PLANS AND SPECIFICATIONS.
21. CONTRACTOR SHALL RETURN ALL EXISTING & SALVAGEABLE EQUIPMENT AND SIGNS TO THE CITY OF STOCKTON CORPORATION YARD AT 1465 SOUTH LINCOLN STREET, STOCKTON, CALIFORNIA, 95206. CONTRACTOR SHALL NOTIFY THE CORP. YARD AT (209)937-8534 A MINIMUM OF 3 WORKING DAYS IN ADVANCE OF DELIVERY.
22. CONTRACTOR SHALL BACKFILL WITH CUTBACK EACH NIGHT ANY AREAS NOT COMPLETED TO ITS FINISHED STATE. ALL EXCAVATED AREAS SHALL BE PROTECTED FROM PEDESTRIAN AND VEHICULAR TRAFFIC AT ALL TIMES.
23. SIDEWALK REMOVAL SHALL BE TO THE NEAREST SCORE MARK OR AS DETERMINED BY THE ENGINEER. CONTRACTOR SHALL NEATLY SAW-CUT CONCRETE WHERE PULL BOXES ARE TO BE PLACED AND SHALL RESTORE THE SLAB TO MATCH THE EXISTING CONCRETE.
24. ALL PULL BOXES SHALL BE STATE STANDARD NUMBER 5 UNLESS OTHERWISE NOTED ON PLAN.
25. THE CONTRACTOR SHALL BE RESPONSIBLE TO NOTIFY P.G. & E. AND OTHER UTILITY COMPANIES PRIOR TO START OF WORK. THE CONTRACTOR SHALL CALL USA (800-227-2600) 48 HOURS PRIOR TO ANY EXCAVATION.
26. CONTRACTOR SHALL COORDINATE WITH PG&E AND OBTAIN A POLE NUMBER FOR THE NEW STREET LIGHT.
27. CONTRACTOR SHALL, BY HAND, POTHOLE EXISTING UTILITIES TO VERIFY LOCATION PRIOR TO CONSTRUCTION.
28. THESE PLANS SHALL BE ACCOMPANIED BY SEPARATE SET OF SPECIAL PROVISIONS.
29. THE CONTRACTOR SHALL NOT PROCEED WITH ANY WORK CALLED FOR ON THESE PLANS UNTIL ALL APPLICABLE PERMITS HAVE BEEN OBTAINED. AN APPROVED SET OF PLANS SHALL BE ON THE JOB SITE DURING ANY CONSTRUCTION.
30. THE CONTRACTOR SHALL BE RESPONSIBLE FOR REPORTING ALL CONFLICTS, ERRORS, OMISSIONS, ETC. TO THE ENGINEER IMMEDIATELY UPON DISCOVERY. IF SO DIRECTED BY THE ENGINEER, THE CONTRACTOR SHALL STOP WORK UNTIL REMEDIAL ACTION CAN BE TAKEN. ANY COSTS RESULTING FROM THE CONTRACTOR'S FAILURE TO REPORT OR FAILURE TO STOP WORK AS DIRECTED WILL BE THE RESPONSIBILITY OF THE CONTRACTOR.
31. THE CONTRACTOR SHALL ASSUME SOLE AND COMPLETE RESPONSIBILITY FOR JOB SITE CONDITIONS DURING THE COURSE OF CONSTRUCTION OF THIS PROJECT, INCLUDING SAFETY OF ALL PERSONS AND PROPERTY; THAT THIS REQUIREMENT SHALL APPLY CONTINUOUSLY AND NOT BE LIMITED TO NORMAL WORKING HOURS; AND THAT THE CONTRACTOR SHALL DEFEND, INDEMNIFY AND HOLD THE OWNER AND ENGINEER HARMLESS FROM ANY AND ALL LIABILITY, REAL OR ALLEGED IN CONNECTION WITH THE PERFORMANCE OF WORK ON THIS PROJECT, EXCEPTING FOR LIABILITY ARISING FROM THE SOLE NEGLIGENCE OF THE OWNER OR ENGINEER.
32. THE LOCATIONS OF ALL UNDERGROUND FACILITIES SHOWN ON THIS PLAN ARE APPROXIMATE. A REASONABLE EFFORT HAS BEEN MADE TO LOCATE AND DELINEATE ALL UNDERGROUND FACILITIES; HOWEVER, KD ANDERSON TRANSPORTATION ENGINEERS ASSUMES NO LIABILITY FOR THE ACCURACY OR COMPLETENESS OF THE EXISTING FACILITIES SHOWN HEREON OR FOR THE EXISTENCE OF OTHER UNDERGROUND UTILITIES OR OBJECTS WHICH MAY BE DISCOVERED BUT ARE NOT SHOWN ON THESE PLANS. THE CONTRACTOR SHALL VERIFY THE LOCATION OF ALL EXISTING FACILITIES AND IMMEDIATELY NOTIFY THE ENGINEER IF ANY SUCH FACILITIES INTERFERE WITH THE CONSTRUCTION OF IMPROVEMENTS. CALL U.S.A. 1-800-227-2600. THE CONTRACTOR SHALL STOP WORK AROUND THE AREA OF CONFLICT UNTIL HE IS DIRECTED BY THE CITY ENGINEER TO CONTINUE.
33. THE CONTRACTOR SHALL COMPLY WITH THE REQUIREMENTS OF THE STATE WATER RESOURCES CONTROL BOARD (SWRCB) ORDER NO. 2009-0009-DWQ. THE CONTRACTOR SHALL IMPLEMENT AND MONITOR A STORM WATER POLLUTION PREVENTION PLAN IN ACCORDANCE WITH THE SWRCB REGULATIONS.
34. ATTENTION IS CALLED TO: SECTION 1540(A) (1) OF THE CONSTRUCTION SAFETY ORDERS (TITLE 8 CALIFORNIA ADMINISTRATION CODE SECTION 1540) ISSUED BY THE OCCUPATIONAL SAFETY AND HEALTH STANDARDS BOARD PURSUANT TO THE CALIFORNIA OCCUPATIONAL SAFETY AND HEALTH ACT OF 1973, AS AMENDED, WHICH STATES:  
 "PRIOR TO OPENING AN EXCAVATION, EFFORT SHALL BE MADE TO DETERMINE WHETHER UNDERGROUND INSTALLATION I.E., SEWER, WATER, FUEL, ELECTRIC LINES, ETC., WILL BE ENCOUNTERED AND, IF SO, WHETHER SUCH UNDERGROUND INSTALLATIONS ARE LOCATED. WHEN THE EXCAVATION APPROACHES THE APPROXIMATE LOCATION OF SUCH AN INSTALLATION, THE EXACT LOCATION SHALL BE DETERMINED BY CAREFUL PROBING OR HAND DIGGING AND WHEN IT IS UNCOVERED, ADEQUATE PROTECTION SHALL BE PROVIDED FOR THE EXISTING INSTALLATION. ALL KNOWN OWNERS OF UNDERGROUND FACILITIES IN THE AREA CONCERNED SHALL BE ADVISED OF PROPOSED WORK AT LEAST 48 HOURS PRIOR TO THE START OF ACTUAL EXCAVATION."

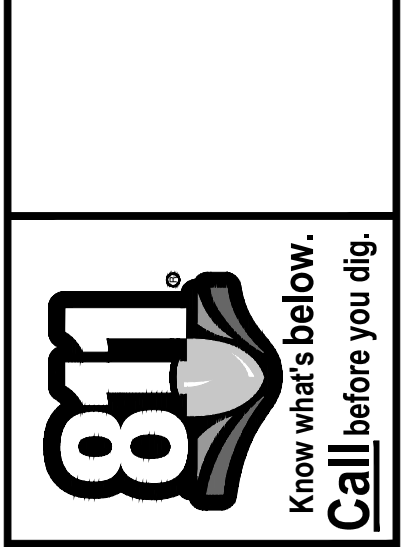
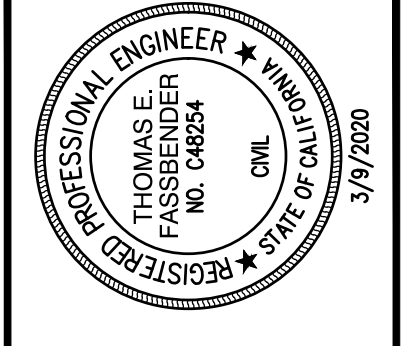

**GENERAL NOTES**  
**WESTWOOD ELEMENTARY SCHOOL**  
**9444 CAYWOOD DRIVE**  
 STOCKTON, CALIFORNIA

NO.	DESCRIPTION	REVISIONS	
		DATE	APPROVED BY

WESTWOOD ELEMENTARY SCHOOL 9444 CAYWOOD DRIVE STOCKTON, CALIFORNIA 95210		
<b>GENERAL NOTES</b>		
DEPARTMENT OF PUBLIC WORKS CITY OF STOCKTON, CALIFORNIA		
SCALE: AS NOTED	APPROVED BY: DATE:	SHEET NO.
DESIGNED BY: TF		<b>C6.2</b>
DRAWN BY: TB		PROJECT NO.
CHECKED BY: TF	CITY ENGINEER STOCKTON, CA.	19-095

TITLE:	GENERAL NOTES	A.P.N.	BENCHMARK NO.	ELEV.
PROJECT:	WESTWOOD ELEMENTARY SCHOOL PAVING PHASE II LODI USD	HORIZONTAL SCALE:	AS NOTED	VERTICAL SCALE: AS NOTED
SHEET NO.	C6.2	AGENCY APPROVAL:	DATE:	JOB NO.: 19-095
		BY:		
		DATE:	03/07/20	

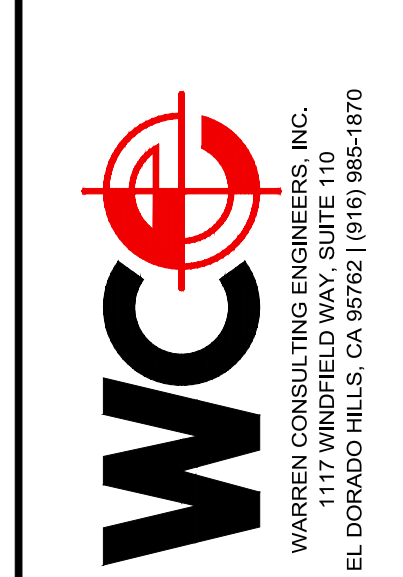
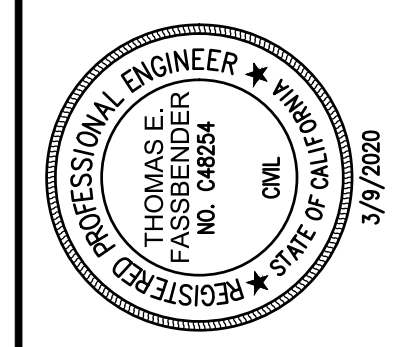



FILENAME: \\P-095\CV\DWG\19-095-C6.1-C6.3.DWG PLOTTED: Monday, March 09, 2020

FILENAME: \\P-095\CV\DWG\19-095-C6.1-C6.3.DWG PLOTTED: Monday, March 09, 2020

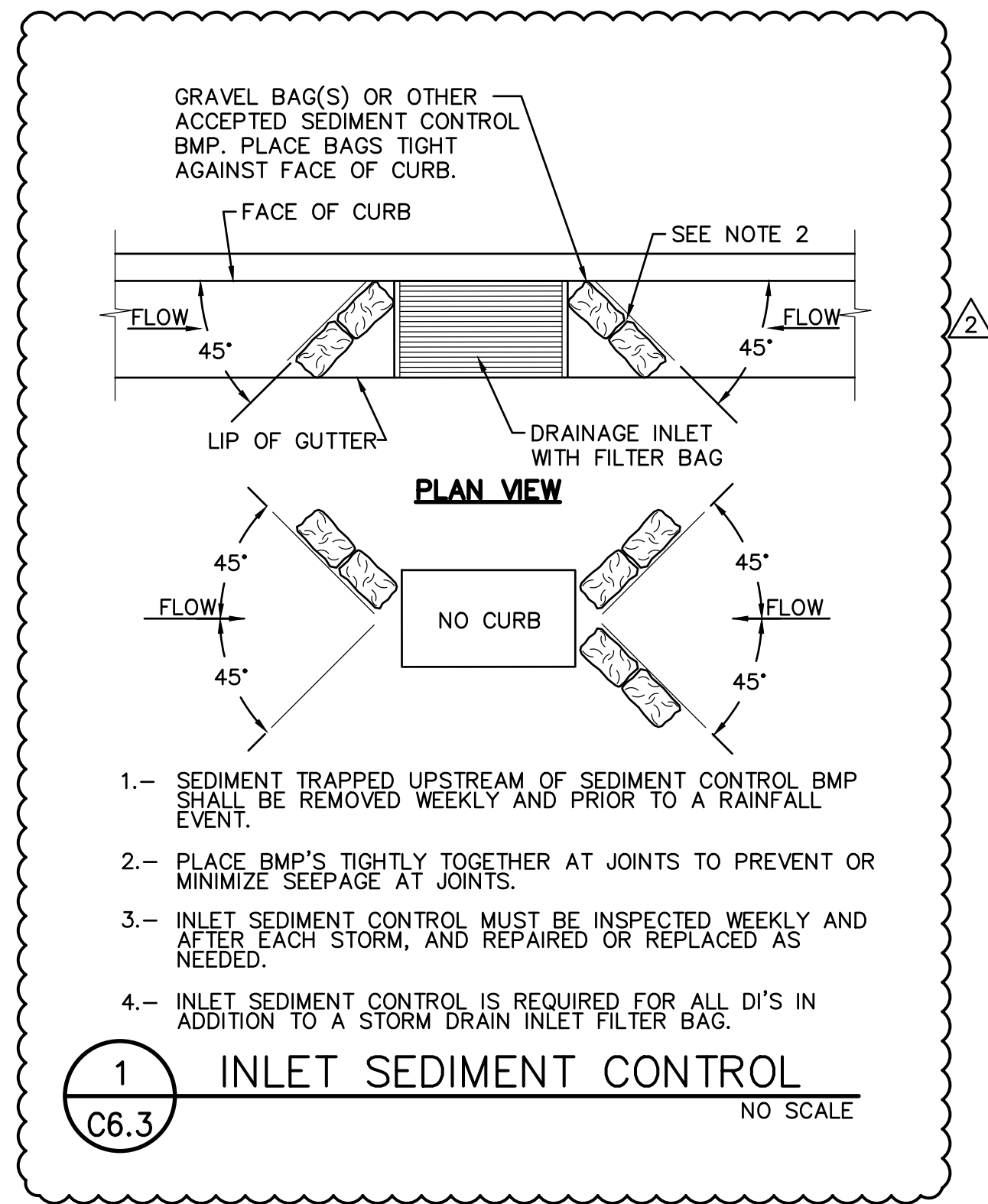
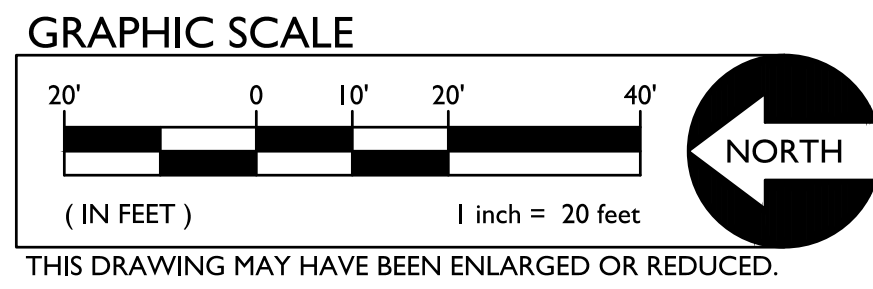
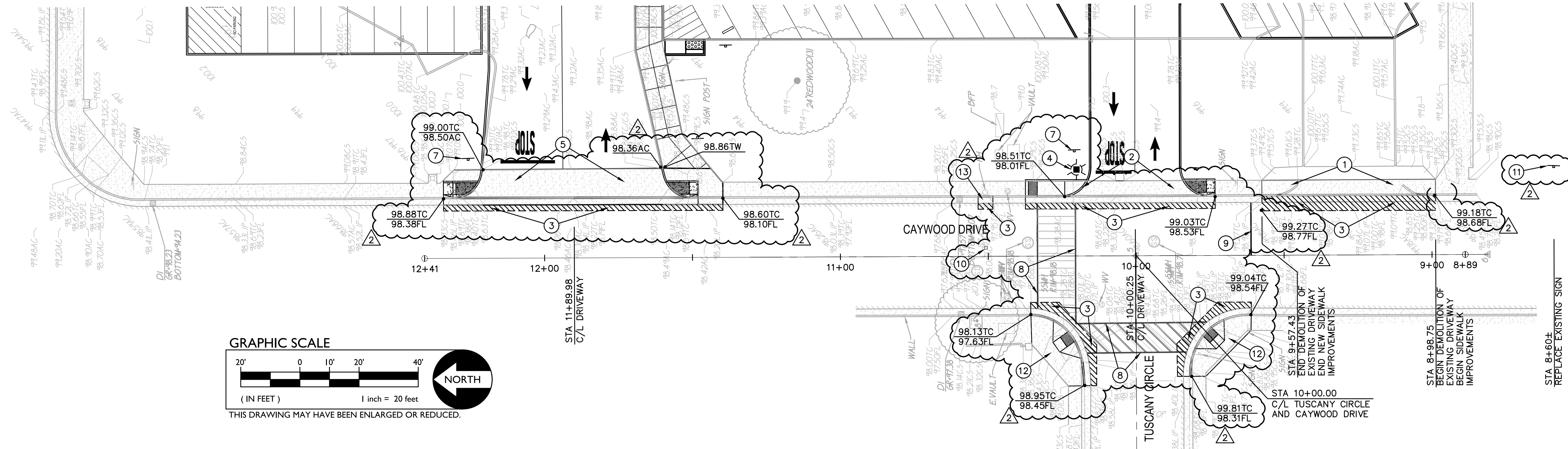

**CONSTRUCTION NOTES**

1. REMOVE EXISTING DRIVEWAY AND CONSTRUCT VERTICAL CURB, GUTTER AND 5' SIDEWALK PER CITY OF STOCKTON STD. DWG. R-52.
2. REMOVE EXISTING VERTICAL CURB, GUTTER AND SIDEWALK AND REPLACE WITH 30' COMMERCIAL DRIVEWAY PER CITY OF STOCKTON STD. DWG R-59. CENTERLINE OF DRIVEWAY SHALL ALIGN WITH TUSCANY CIRCLE.
3. SAWCUT REMOVE AND REPLACE EXISTING AC PAVING FOR CONCRETE INSTALLATION. REPLACE WITH MINIMUM 8" AC.
4. RELOCATE EXISTING STREET LIGHT TO 5' NORTH OF DRIVEWAY. REMOVE EXISTING FOUNDATION, PLACE NEW FOUNDATION PER CITY OF STOCKTON STD. DWG R-59. INSTALL NEW CONDUIT FROM EXISTING LIGHT TO NEW AND PULL NEW CONDUCTORS.
5. REMOVE EXISTING DRIVEWAY AND REPLACE WITH 60' COMMERCIAL DRIVEWAY PER CITY OF STOCKTON STD. DWG R-59.
6. PROVIDE DRAIN INLET EROSION/SEDIMENT CONTROL AT INLET PER C6.3.
7. INSTALL R-1 AND (4)R-1-3D SIGN AND POST.
8. PROVIDE 12" WIDE YELLOW THERMOPLASTIC CROSSWALK STRIPING.
9. PROVIDE 12" WIDE WHITE THERMOPLASTIC STOP BAR PER STD. DWG. R113.
10. INSTALL BLUE MARKER PER
11. REPLACE EXISTING SIGN WITH NEW SW29-1(CA).
12. REMOVE AND REPLACE EXISTING RAMP, CURB AND GUTTER WITH NEW PER CITY OF STOCKTON STD. DWG. R-64.
13. REMOVE AND REPLACE DEPRESSED CURB AND GUTTER.

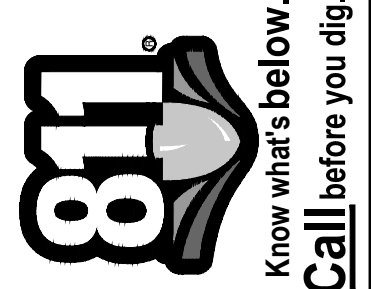
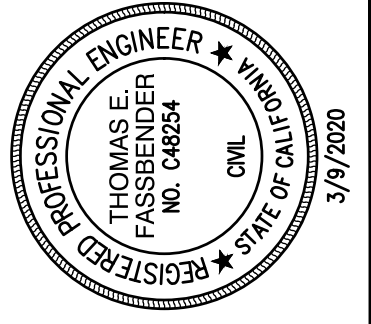

FRONTAGE IMPROVEMENTS  
**WESTWOOD ELEMENTARY SCHOOL**  
**9444 CAYWOOD DRIVE**  
 STOCKTON, CALIFORNIA

NO.	DESCRIPTION	DATE	APPROVED BY

WESTWOOD ELEMENTARY SCHOOL  
 9444 CAYWOOD DRIVE  
 STOCKTON, CALIFORNIA 95210

FRONTAGE IMPROVEMENTS

DEPARTMENT OF PUBLIC WORKS  
 CITY OF STOCKTON, CALIFORNIA

SCALE: AS NOTED    APPROVED BY:    DATE:    SHEET NO.  
 DESIGNED BY: TF    DRAWN BY: TB    CHECKED BY: TF    CITY ENGINEER STOCKTON, CA.

**C6.3**

PROJECT NO. 19-095

TITLE: PROJECT: SHEET NO.	WESTWOOD ELEMENTARY SCHOOL PAVING PHASE II LODI USD		A.P.N. BENCHMARK NO. AS NOTED AS NOTED JOB NO.: 19-095
	HORIZONTAL SCALE:	AS NOTED	
	VERTICAL SCALE:	AS NOTED	
ELEV. -	WESTWOOD ELEMENTARY SCHOOL 9444 CAYWOOD DRIVE STOCKTON, CALIFORNIA		ELEV. -

**C6.3**