

THE POWER OF LBUSD



Welcome Back 2019-20 Back to School Report



September 24, 2019





Vision

*We take ownership of each child's learning
in our schools, accepting no limits on
potential.*



Mission

Each student gains the knowledge, experience, world perspectives, and skills needed to become a lifelong learner and producer in a competitive and interconnected world.

Our Ongoing Commitments for 2019-20

- **Every Student Every Day**
- **Continuous Improvement**
- **Relationships Matter**



Current Enrollment

Top of the World Elementary: 580

El Morro Elementary: 459

Thurston Middle School: 687

Laguna Beach High School: 1,055

Total- 2,781

Recent Accomplishments

- **No. 1 in Best School District in Orange County, *Niche***
- **AP[®] District Honor Roll, *College Board***
- **Spotlight District, *Equality California's Safe and Supportive Schools Report Card***
- **2018-2019 Educational Partnership Honor Roll (Laguna Beach High School and Top of the World)**
- **Civic Learning Award of Merit from the CA Courts System (Laguna Beach High School)**
- **2018 California Distinguished School (Thurston Middle School)**
- **Destination Imagination[®] Tournament Global Finals**
- **2018 38% of graduating seniors received Seal of Biliteracy (county avg. 22%, the state 12%)**

Recent Accomplishments continued

- **2018 U.S. Department of Education Green Ribbon School (Top of the World Elementary)**
- **2019 U.S. Department of Education Blue Ribbon School (El Morro Elementary *Pending)**
- **6 Year WASC Accreditation Designation (Laguna Beach High School)**
- **2018 School to Watch Designation (Thurston Middle School)**
- **2018-19 *Spotlight School* for the ADL "No Place for Hate" program (El Morro)**
- **"No Place for Hate" District Designation**
- **Two National Merit Semifinalist (Laguna Beach High School)**

Ongoing Continuous Improvement

- **Increasing our Course Offerings**
 - **IVC Concurrent Enrollment and CCA Classes**
 - **AER Class, Creative Writing, Yoga, App Design**
 - **TMS Elective Wheel**
- **Enhancing Community Communications**
 - **Audio/visual system for broadcasting and closed captioning**
 - **Online Board agendas**
 - **ThoughtExchange**
 - **Parent Square**
 - **Superintendent Column**
 - **LCAP Committee, MTSS Committee, CAC, DELAC**
 - **Parent Mentor Program**
- **Facilities**
 - **Capital Improvement Project Update - Thurston Middle School Field & Classroom Modernization**
 - **Proactive school site renovations/maintenance**
 - **OCLAC Safety Upgrades**

Every Student, Every Day

- **Focus on Student Attendance**
 - **Proactive attendance systems**
 - **Significant improvement in all schools absenteeism rates**
- **School Resource Officer**
 - **Ongoing support for students**
- **Ongoing Teaching from Strengths**
 - **Staff trained at all sites**
 - **5th Grade use of Thrively**
 - **6th Grade StrengthsFinder**
 - **AER Class Staff Mentors**
- **Social Emotional Supports Implementation**
 - **Universal Social-Emotional Learning Screening K-12**
 - **Second Step**
 - **Suicide/Self-Harm Intervention Training**

Relationships Matter

- ***School Climate and Culture***

- ***No Place for Hate: Anti-Defamation League***
- **Activities include:**
 - **Link Crew, WEB Day, Character Counts, Respectability Month**

- ***Student Leadership and Voice***

- **Student Focus Groups**
 - **WASC, LCAP**
- **Student Board Representatives**
- **Student Senate**
- **Student Athletic Advisory**
- **Challenge Success**
- **AER Class**
- **CAC Student Reps**

Fiscal Strength

- *Fiscally Sound with Solid Revenue Growth*

- Reserves total \$34.4 million
- Per pupil spending for 2018-19 was \$21,462
- The total revenue is projected to increase by \$1.6 million this year over last
- Property tax revenue for 2019-20 is estimated at \$57.7 million
- The total budget for this year is roughly \$64 million



Nutrition Services

- *All Organic Produce*
 - Locally sourced for meal prep and in our salad bars offered at each school
- *Environmentally Conscious*
 - No plastic straws and utensils are biodegradable
- *Increased Options*
 - This year we're incorporating more vegan and vegetarian meal options
- *Exploring New Programs*
 - Piloting new breakfast program at TOW



Business - Facilities

- *Laguna Beach High School*
 - **Artists Theatre & Breezeway/Restrooms**
- *Thurston Middle School*
 - **Door Hardware Re-key and Signage**
- *Top of the World Elementary School*
 - **Kindergarten Fence and Access Gate**
- *El Morro Elementary School*
 - **MPR Renovation**



Business - Facilities

Thurston Middle School

○ Field & Classroom Modernization Project

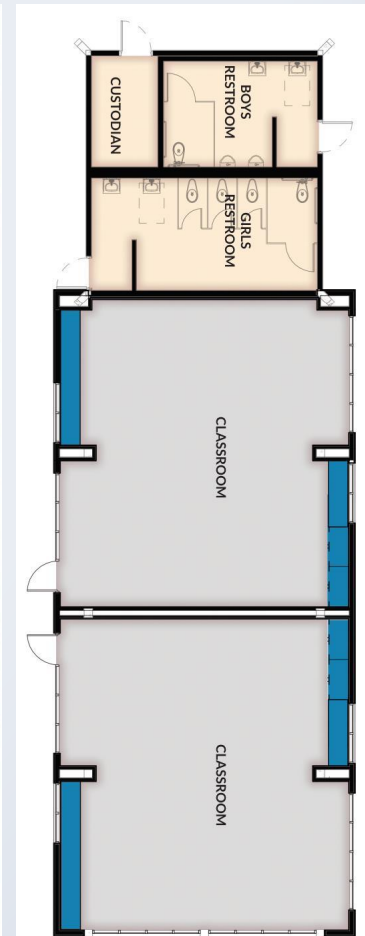

Instructional Focus Areas

- **Multi-tiered Systems of Support (MTSS)**
- **Professional Learning Community (PLC)**
- **NGSS Pathways & Curriculum**
- **Strengths-Based Learning & Leadership**
- **Career Education**
- **Co-teaching**



Data Highlights

Chronic Absenteeism Rate (10% or more absences)

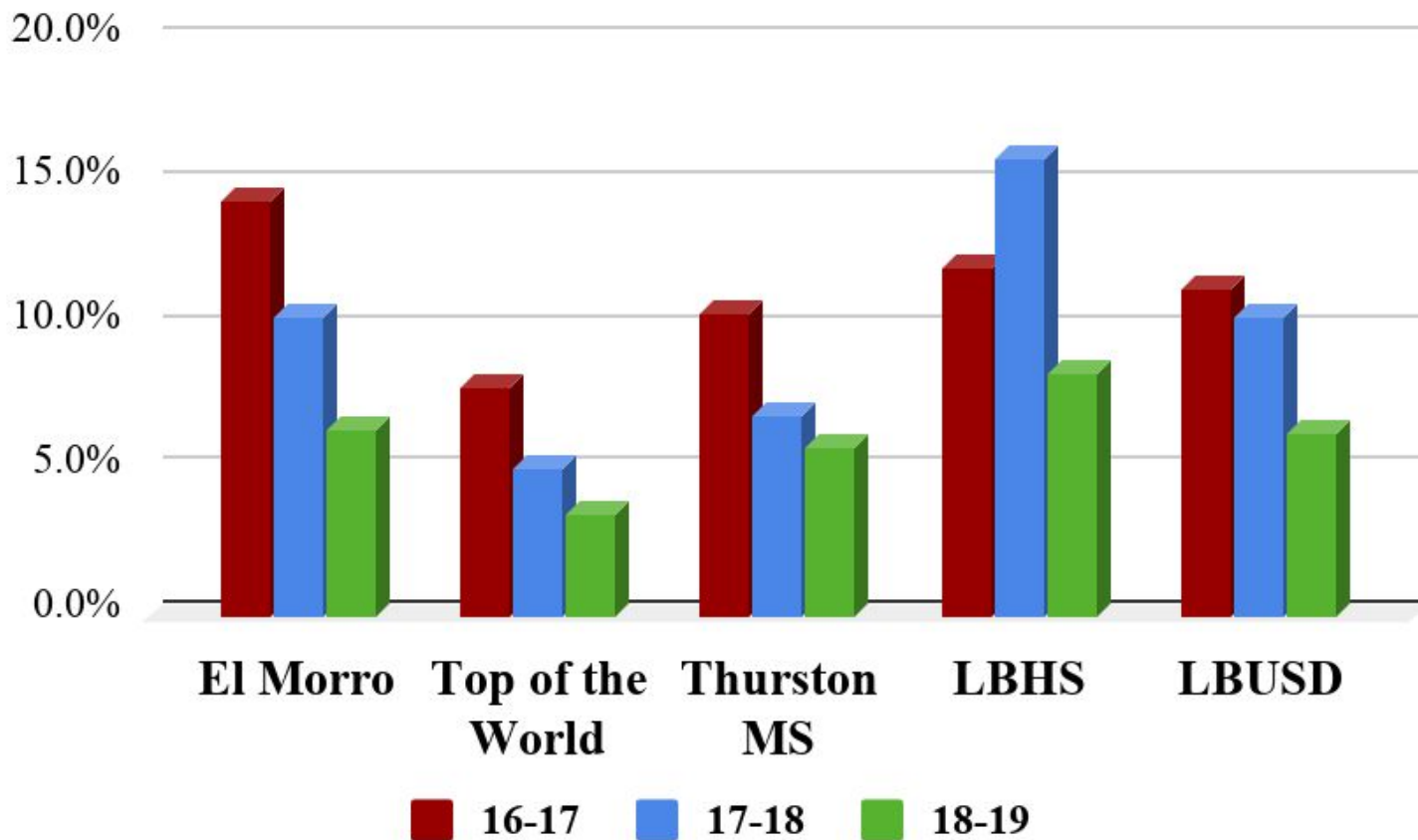

Data Highlights

California Assessment of Student Progress and Performance (CAASPP) - Percent of Students Meeting or Exceeding Standards

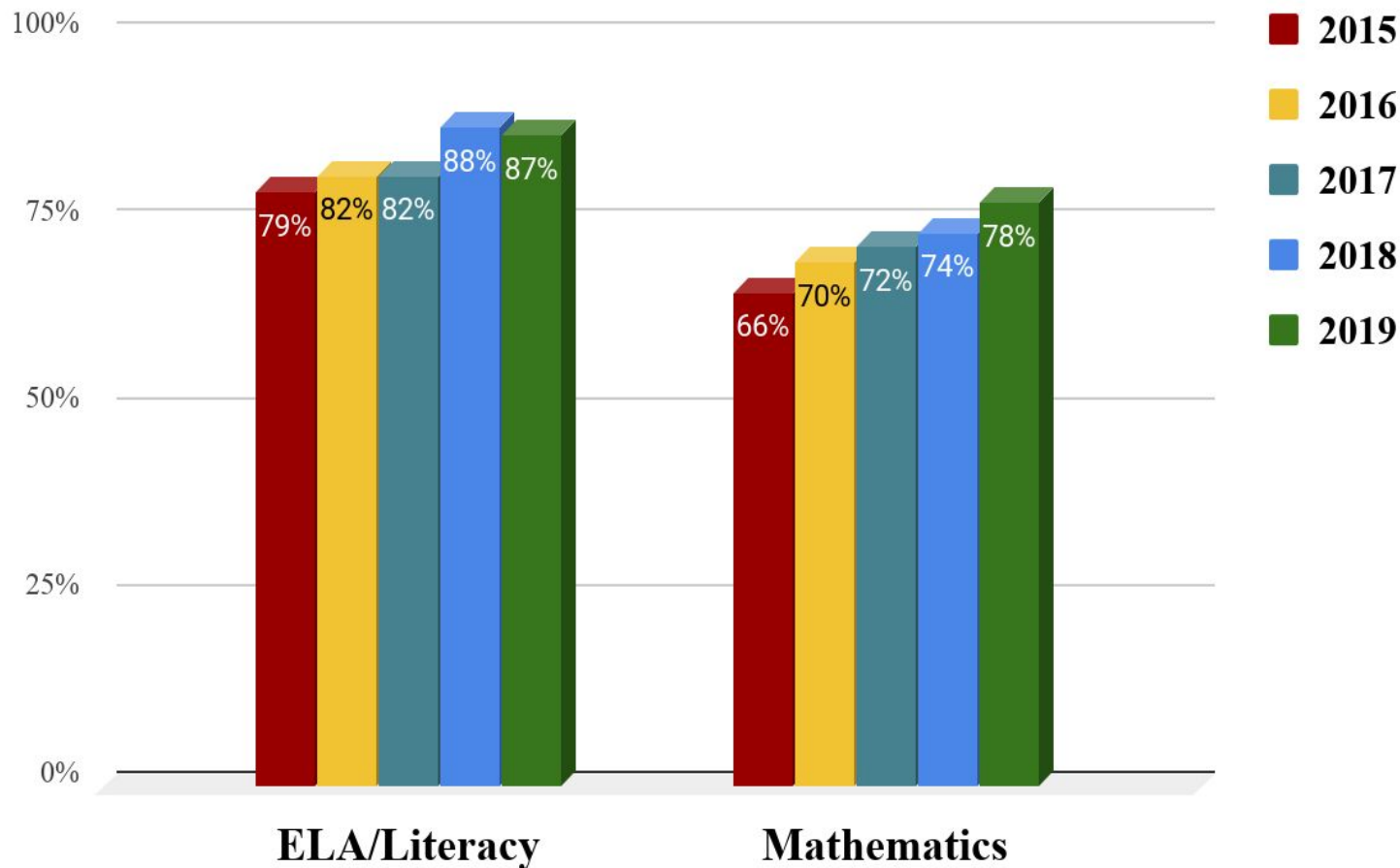

Data Highlights

California Assessment of Student Progress and Performance (CAASPP) - Percent of Student Groups Meeting or Exceeding Standards

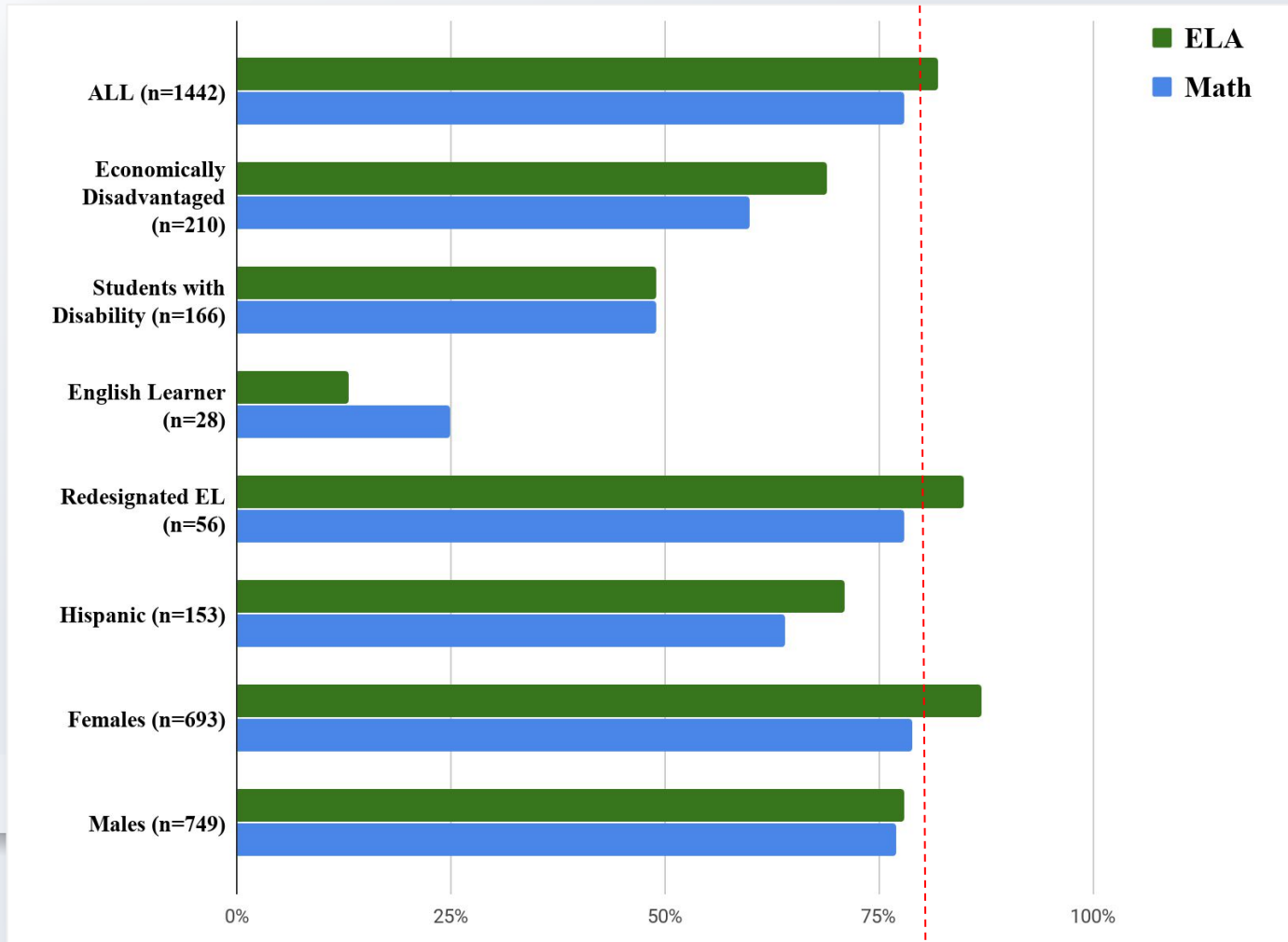

**Grades
3-8, and 11**

Data Highlights



Advanced Placement (AP) Test Results

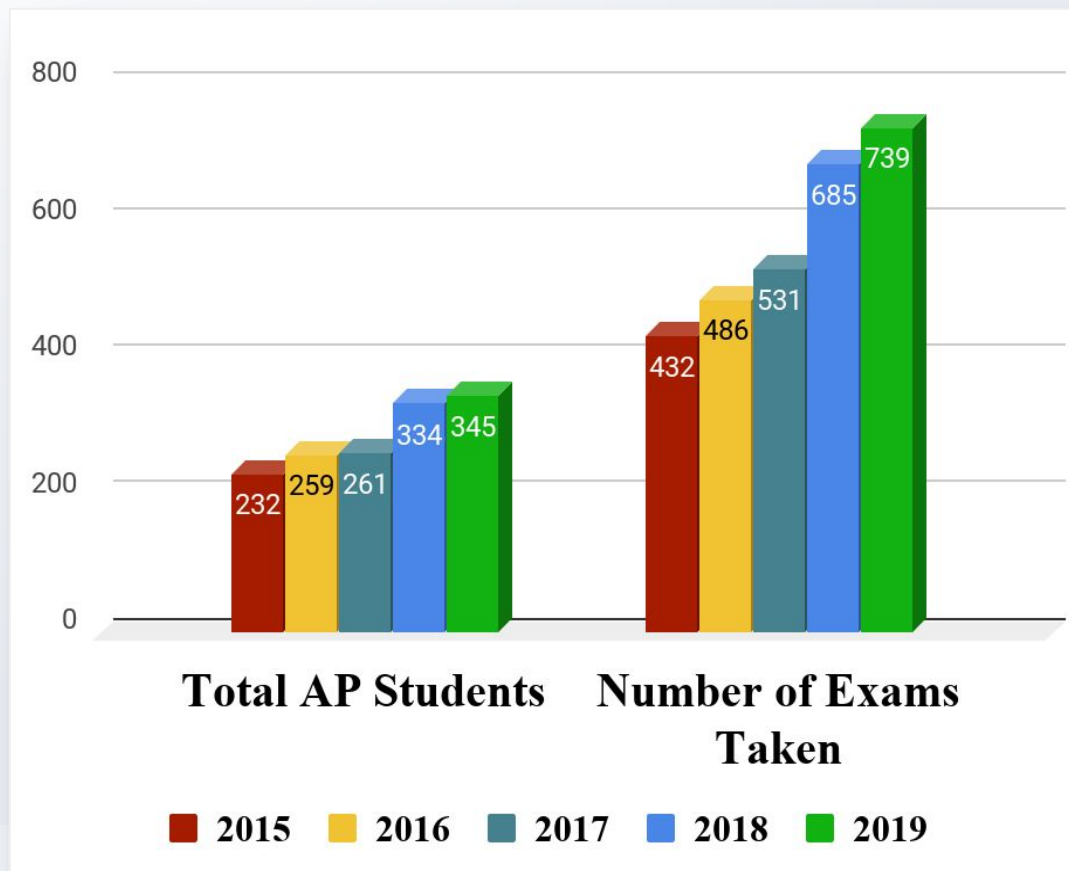

AP Test Pass Rate

<u>2015</u>	<u>2016</u>	<u>2017</u>	<u>2018</u>	<u>2019</u>
90%	88%	92%	90%	89%

Data Highlights



Advanced Placement (AP) Courses = 21

Arts

AP Art History*
AP Music Theory
AP Studio Art 2-D Design (Photo)
AP Studio Art 3-D Design (Ceramics)
AP Studio Art-Drawing

Foreign Language

AP French Language and
Culture
AP Spanish Language
AP Spanish Literature

Science

AP Biology
AP Physics 1
AP Computer Science
Principles*

ELA

AP English Language and Comp
AP English Literature and Comp

Math

AP Calculus AB
AP Calculus BC
AP Statistics*
AP Computer Science A*

Social Science

AP European History
AP Government
AP Macroeconomics
AP US History

**New courses added the last two years.*

Social & Emotional Support

- All students will ***thrive*** in school and in life
- Focus on ***Whole child***
- Increase students' social and emotional strengths and decrease distress through integrated prevention and intervention services

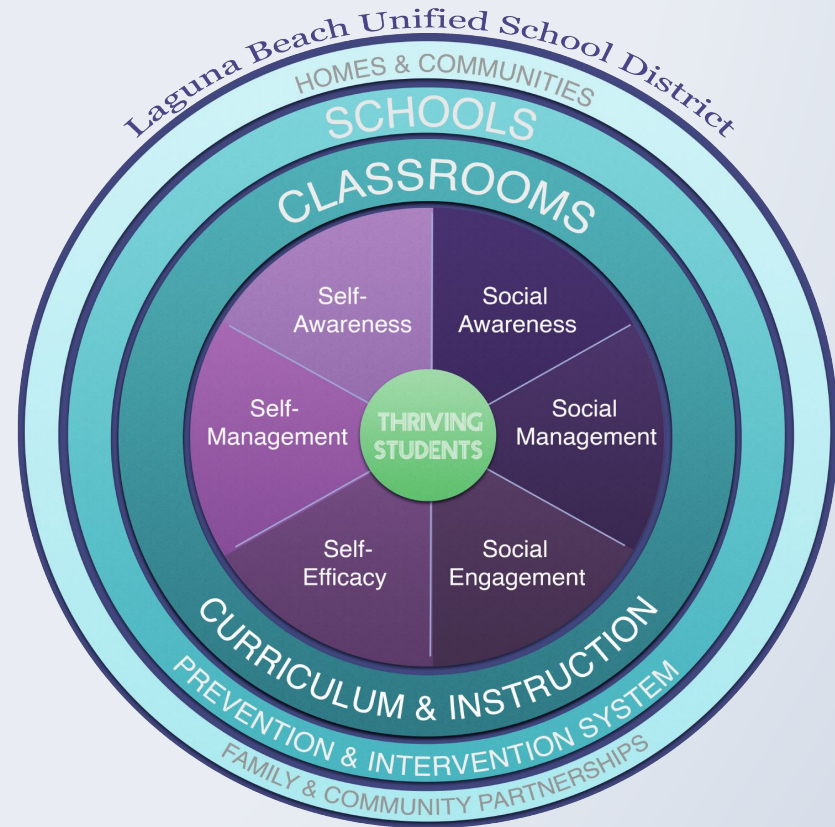

Our Way



DATA



KNOWLEDGE



ACTION

Social Emotional Learning (SEL) Universal Screeners 2019-20

K-3

Student Risk Screening Scale

4-12

CoVitality

CHALLENGE STUDENTS

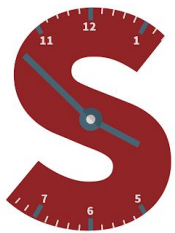

STUDENTS' SCHEDULE
& USE OF TIME

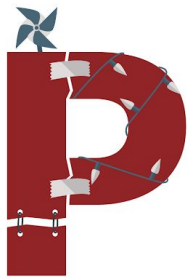

PROJECT & PROBLEM-BASED
LEARNING



ALTERNATIVE & AUTHENTIC
ASSESSMENT

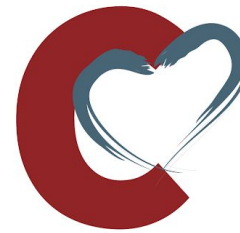

CLIMATE OF CARE

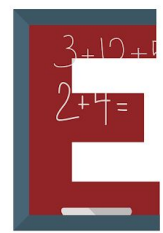

EDUCATION FOR THE
WHOLE COMMUNITY

Stanford
GRADUATE SCHOOL OF
EDUCATION

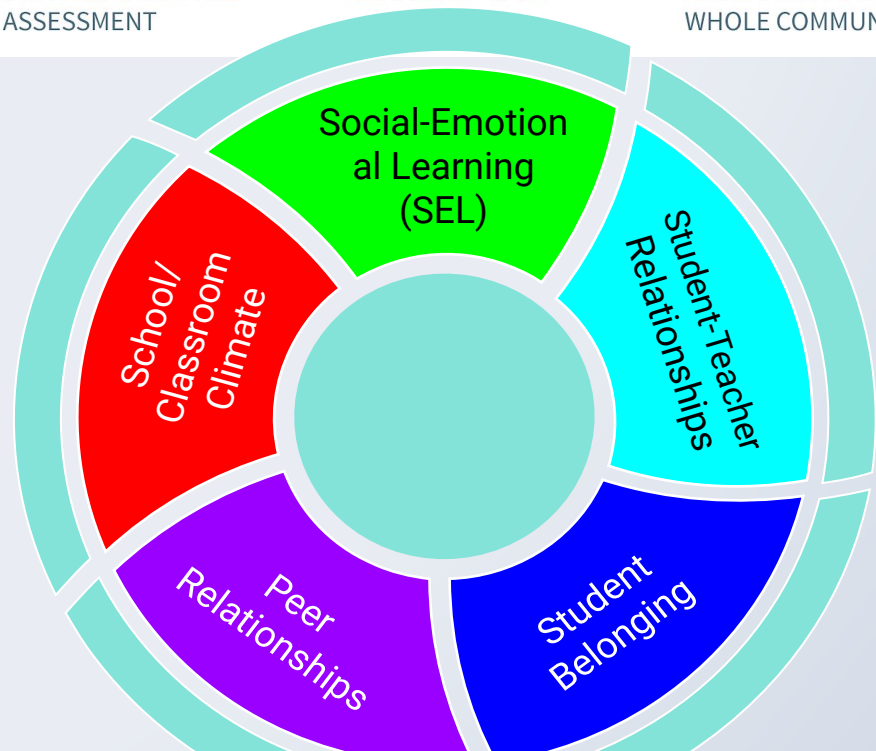

Parent & Staff Education

Spring 2018

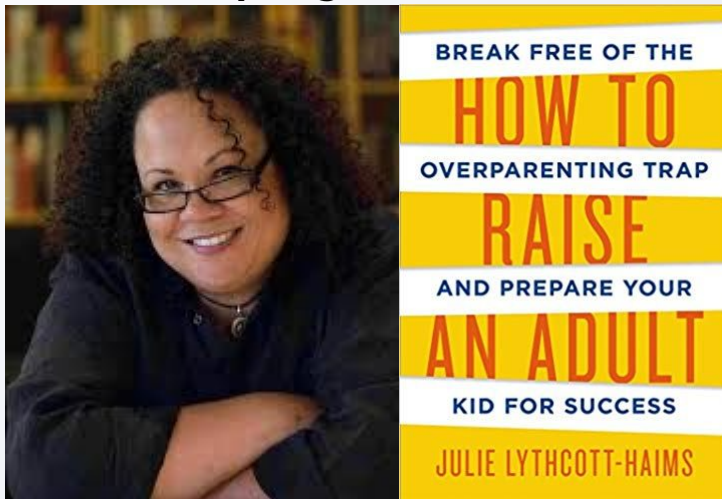

Spring 2019



Spring 2020

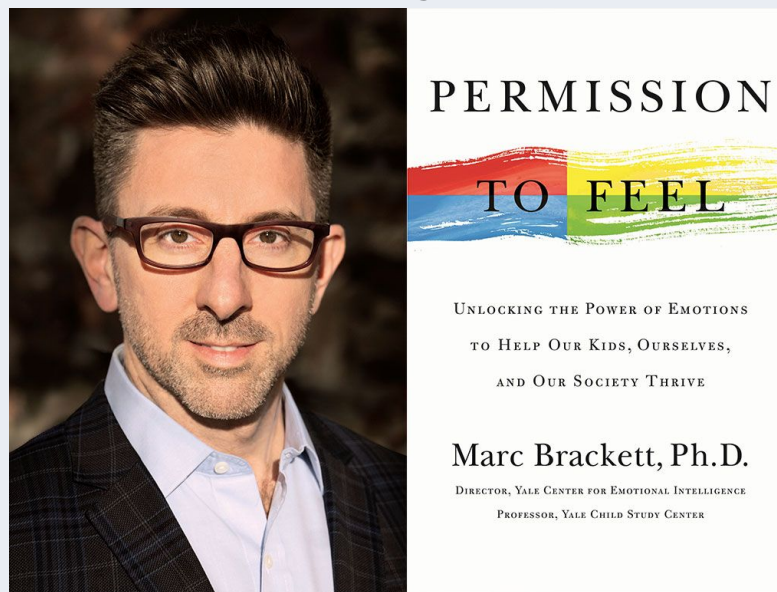

Save the Date:

Marc Brackett, Ph.D.

March 12, 2020

5:30-7pm

LBHS

Artists' Theatre

Human Resources Update

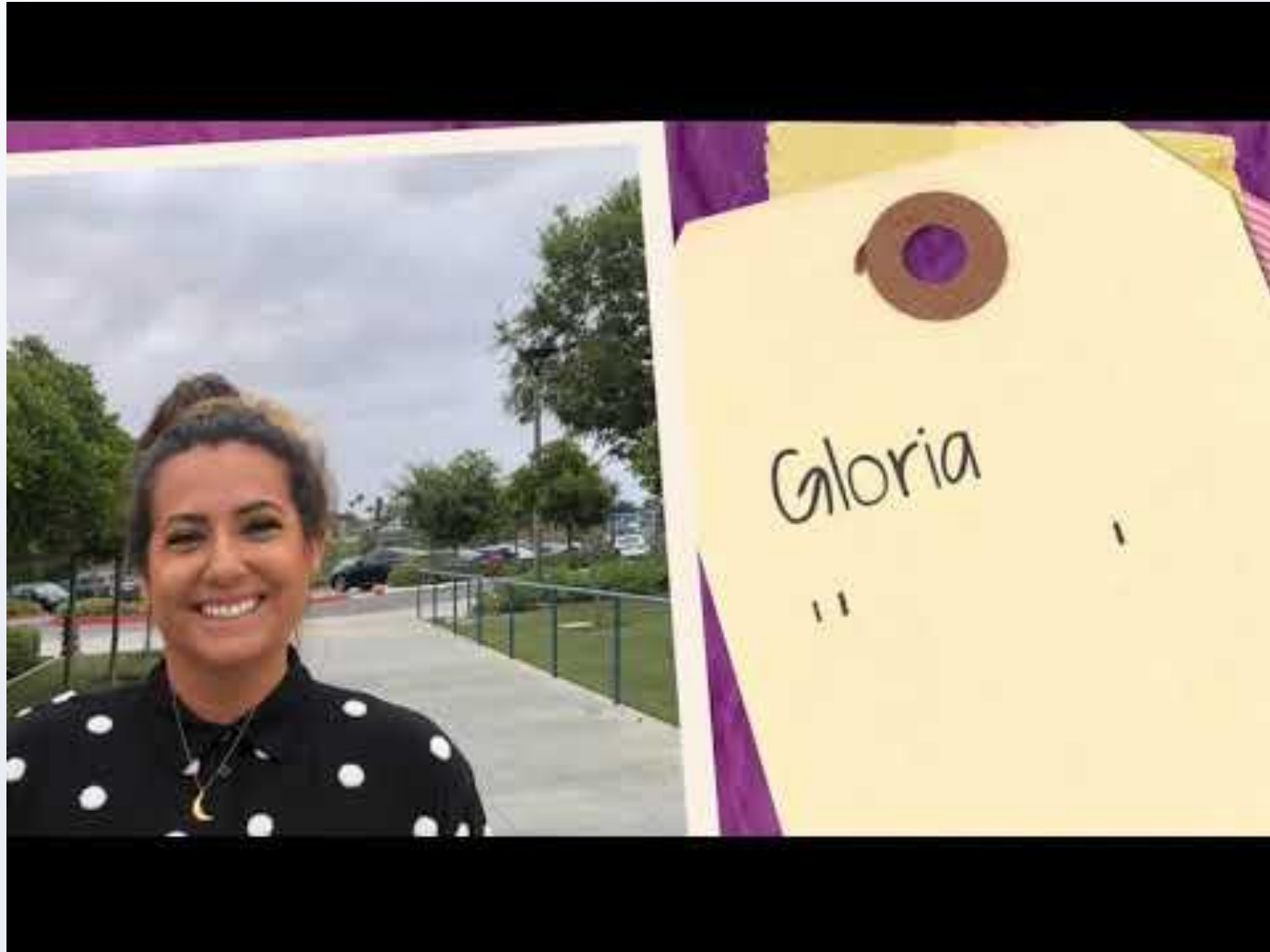

4CLE 4c's Learning Environment



TOW - 2nd Grade

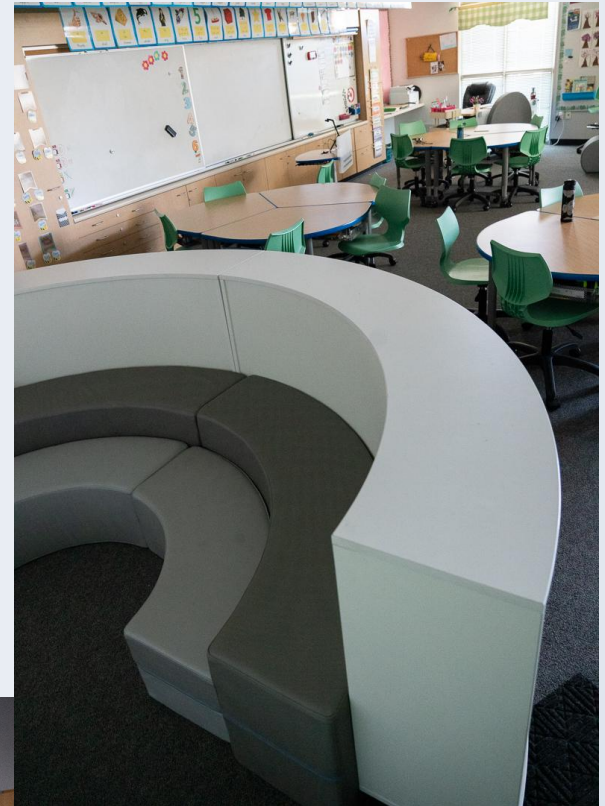

LBHS Science Electives



<div>LBHS</div> <div>1</div>	Electives
	Science
	Library
	SPED
	English
	Math
	Social Studies

<div>TOW</div> <div>5</div>	K
	1
	2
	3
	4
	5
	Library

<div>TMS</div> <div>0</div>	Electives
	Science
	Library
	SPED
	English
	Math
	Social Studies

<div>EMS</div> <div>11</div>	K
	1
	2
	3
	4
	5
	Library

76%

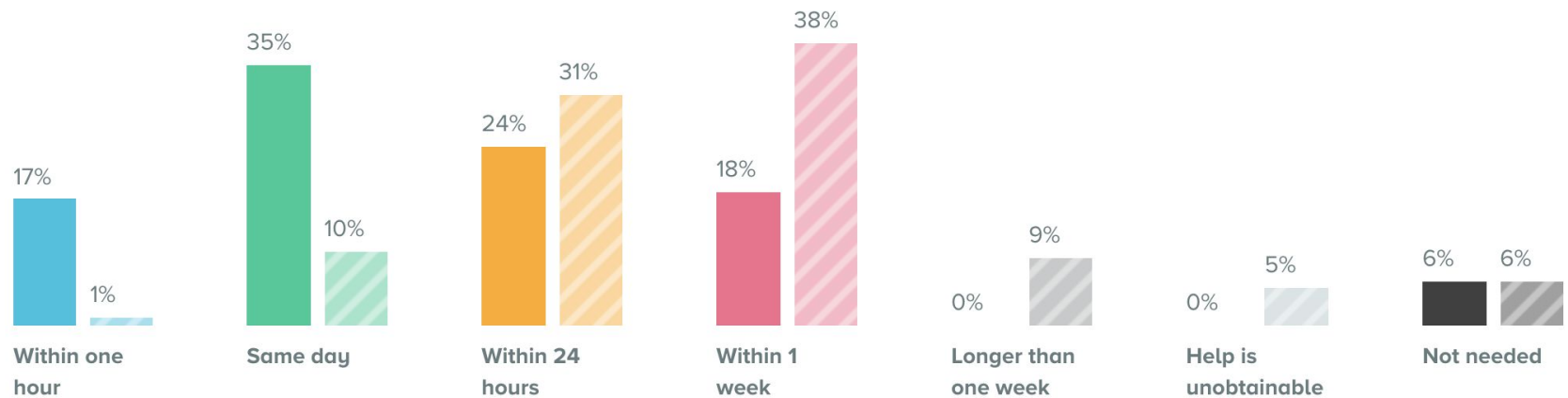

COMPARE



Jan 1, 2019 to Jun 30, 2019
Solids



Jan 1, 2014 to Jun 30, 2014 ▼
Stripes



Authentic Exploratory Research (AER)

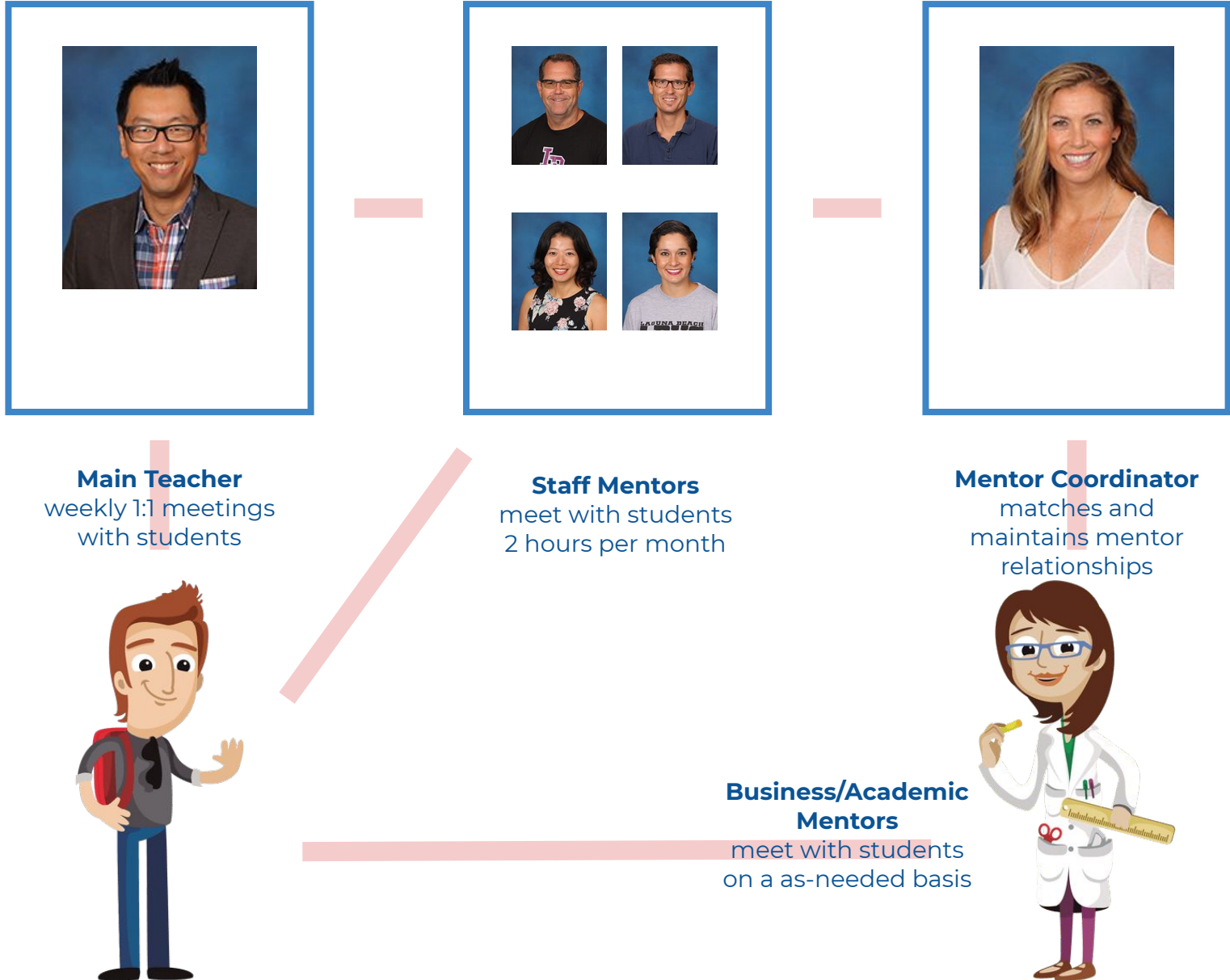

**Thank you for your
ongoing support of our
students and staff**