

Grade 4 – Slab Box with Lid



Clay Form

What do you see?



Lapita Pot, Oceania, 1500-500 B.C.

Artistic Focus: Clay Form



Lapita Pot, Oceania Region, 1500-500 B.C.

FORM is a three-dimensional object that has height, length, width, and depth.

Today's objective:

1. To construct a clay slab box with lid
2. To demonstrate the subtractive and additive techniques

WA State Visual Arts Standard

When making works of art, utilize and care for materials, tools, and equipment in a manner that prevents danger to oneself and others. (VA:Cr2.2.4)

Region - Oceania

- Oceania covers thousands of islands in the east-central Pacific Ocean.
- The earliest ceramic pieces from this region were crafted by the Lapita culture and found to date back to 1500-500 B.C. showing carved designs.
- Lapita artisans engraved many designs into their ceramic vessels and often used them for cooking, serving and storage of food.



Techniques – Additive and Subtractive

Additive process –

Involves adding a form to a surface.



Subtractive process –

Involves taking away, carving, or cutting from a surface.



Subtractive Example: Contemporary Art



Molly Morning-Glory



Molly Morning-Glory
North Carolina, USA

The rural wilderness of my youth was marked by great solitude which provided room for creative expression. Dreams helped my ideas.

Subtractive Example: Contemporary Art



Red & Tan Water Jar with Eagle & Fish,
Nathan Youngblood



Nathan Youngblood
New Mexico, USA

He has become known for his creative designs and the outstanding quality of his works.

Additive Example: Contemporary Art



Black Line Diamond Shaped
Ceramic Footed Pillow Box



Vaughan Nelson
California, USA

“With vibrant colors and interesting patterns, I stimulate the senses and create interest.”

Example of Today's Project



Materials

Clay



Slip



Water



Pattern



½ in. Thickness guide sticks



Scraper



Scorer
(wired texture tool)



Wooden modeling tool



Roller



Sponge



Work surface



Tool Safety Guidelines

To avoid injury, please follow these basic guidelines:

- Move the tools **slowly**.
- Avoid touching **the end** of the tools.
- **Watch** where your tools are when they are in your hands.
- Keep the tools flat on the **top of your desk** when not in use.
- **Do not walk** with the tools.

If you handle tools responsibly, you'll get to use them.

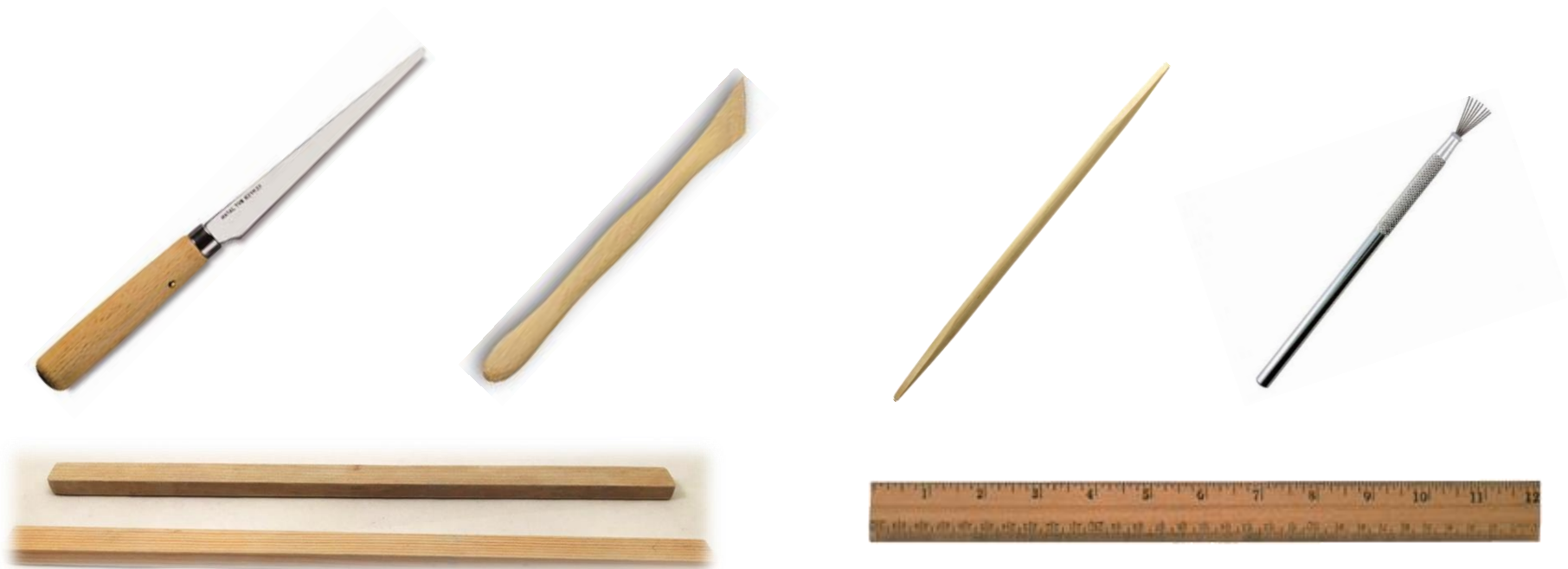

Step 1

- Place clay between guide sticks
- Roll out clay until it is the same thickness as the sticks

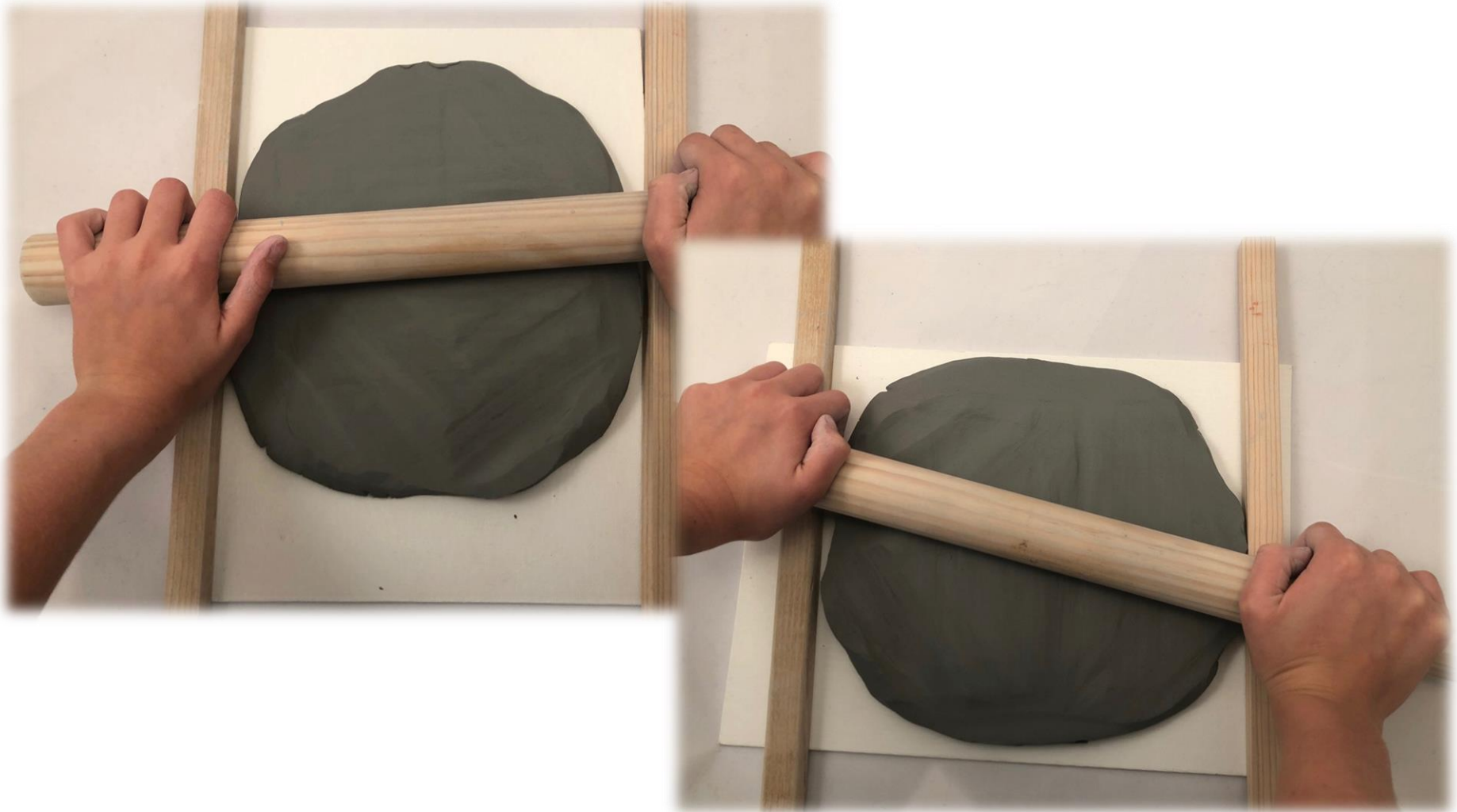

Step 2

- Use the pattern to see if it fits on your slab.
- Take a Fettling knife or needle tool and holding it vertically, cutting around the pattern.

TIP –

Start in the corner and slide tip of knife downward



Step 3

- Carefully remove extra clay around your piece and set it to the side.
- You will be using the extra slab to make your lid

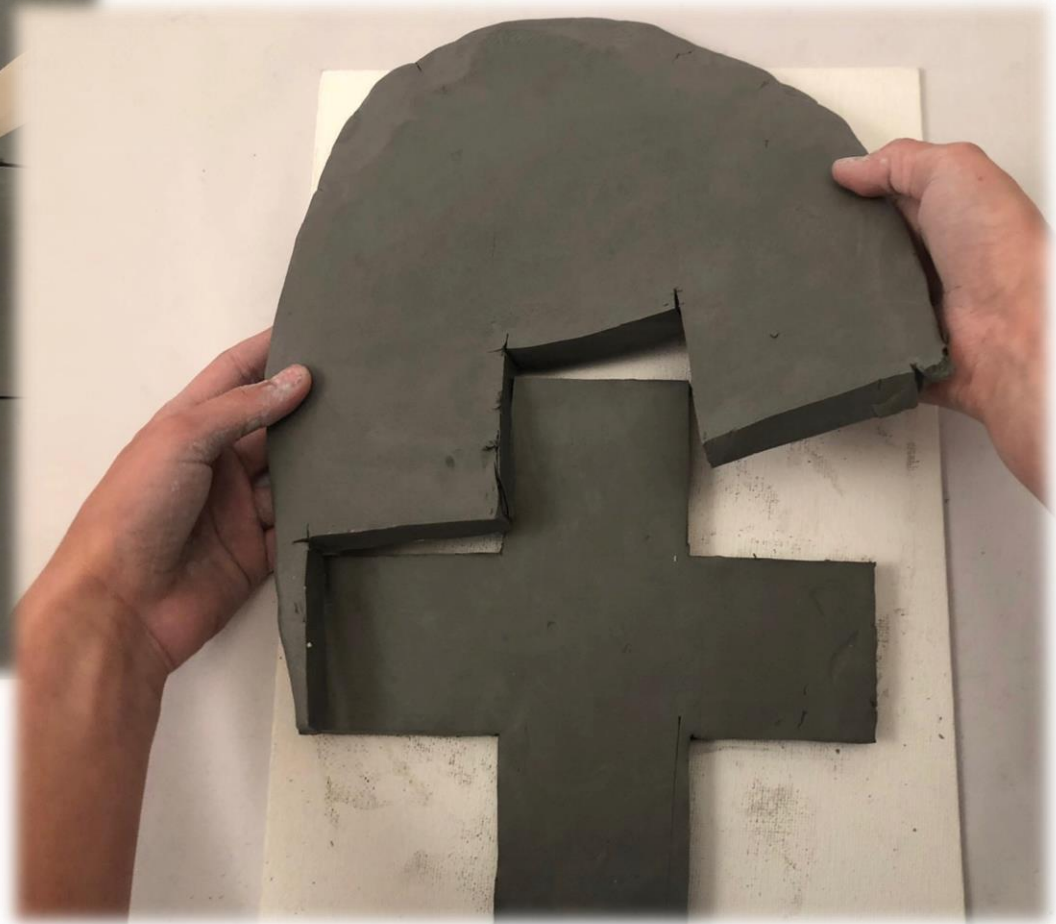

Review of Steps 1-3

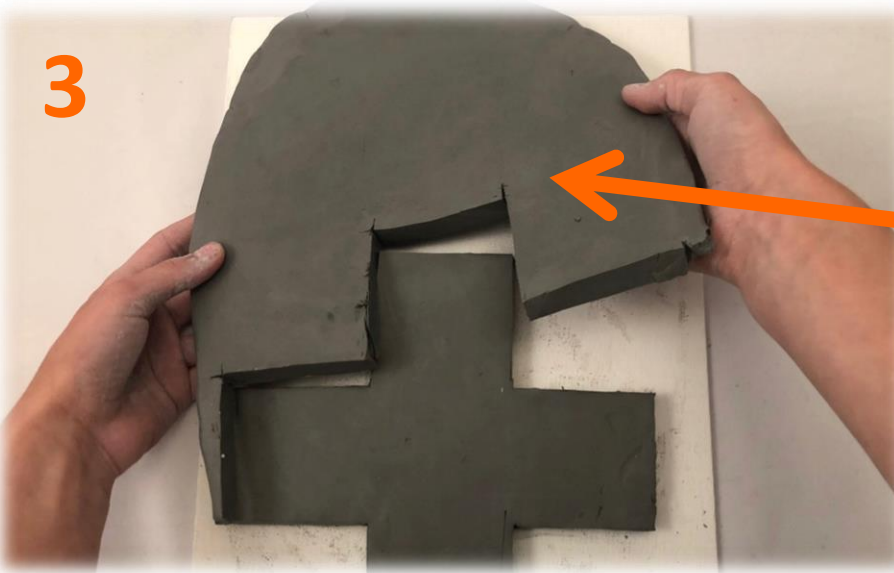
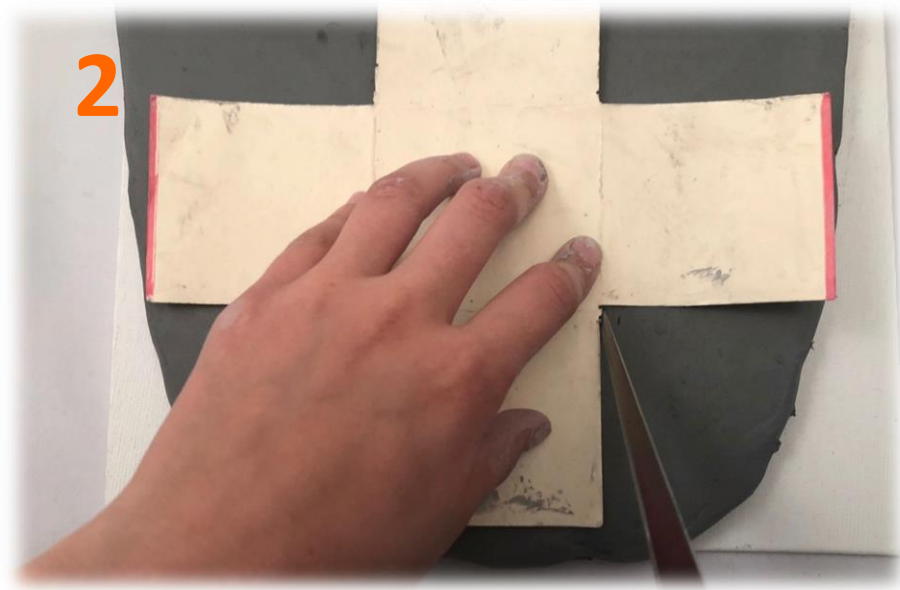

Save extra clay
for a later step

Step 4

- Pick two sides and fold them up to see where they will touch
- **Score** the areas that will be touching



Step 5

- Add **slip** or water to the scored area. This will act as a “glue” to join the pieces together.

TIP –

If your box is too slippery, you may have added too much slip/water. Wait for it to dry out a bit.

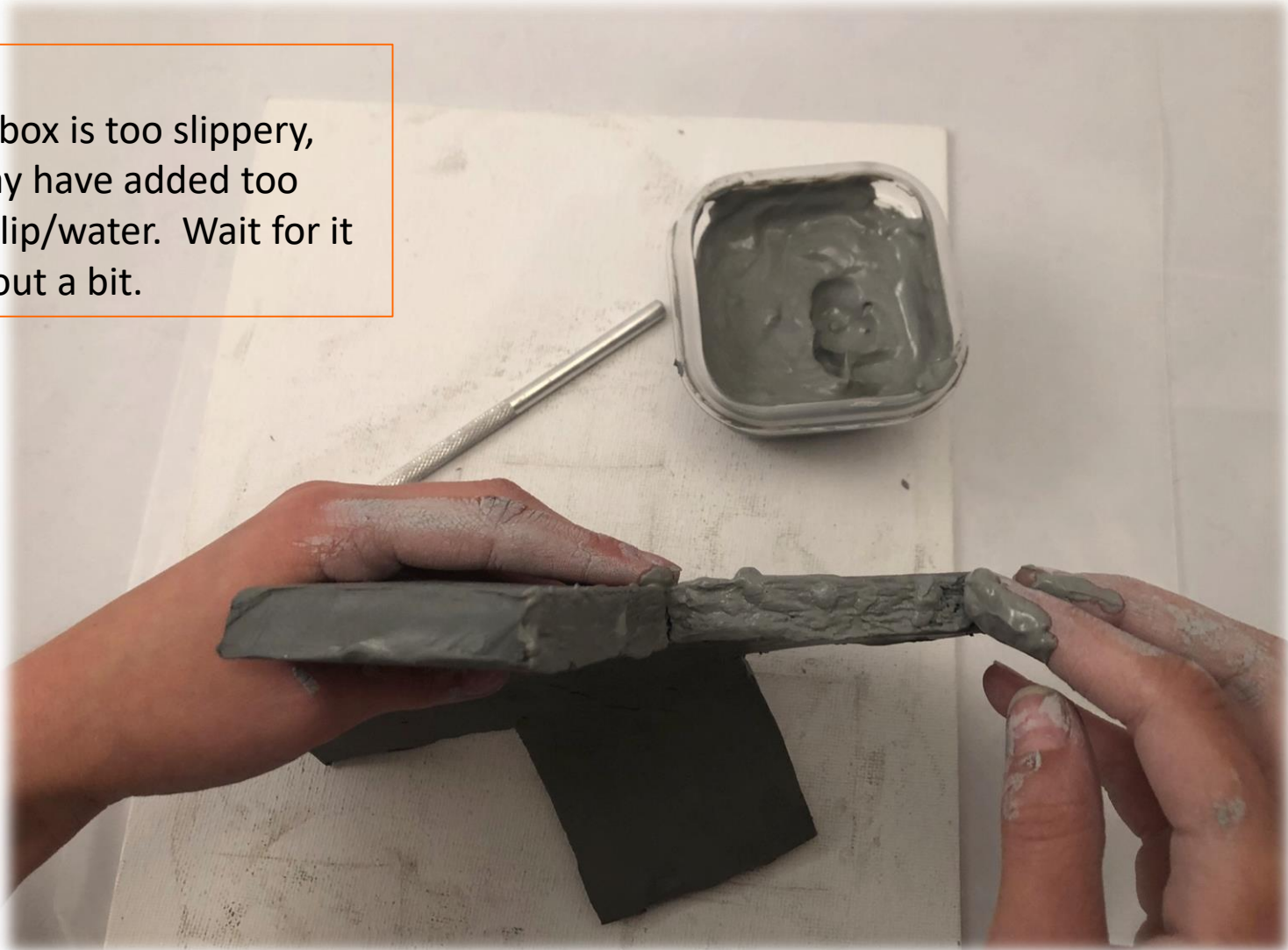

Step 6

- **Stick** the two edges together.
- With your thumb, **blend** the two sides together.



Review of Steps 4-6

1



2



3 & 4



The 4 S's

1. Score
2. Slip (or water)
3. Stick
4. Smooth

Repeat For All 4 Sides.

Step 7

- Smooth your box with your finger and then choose a tool: wood modeling tool, metal scraper, wood guide stick, etc.
- Then with a slightly wet sponge, smooth the edges and the whole box.
- With the curved part of your modeling tool, smooth the inside corners



TIP –

Get your sponge wet, then squeeze **all** water out!

Step 8

- Place your box upside down on your extra slab of clay.
- With your needle tool, lightly trace around the box making the lid about $\frac{1}{4}$ of an inch bigger around the box. Don't cut it out yet!
- Remove your box and use a Fettling knife to cut where you made your outline.

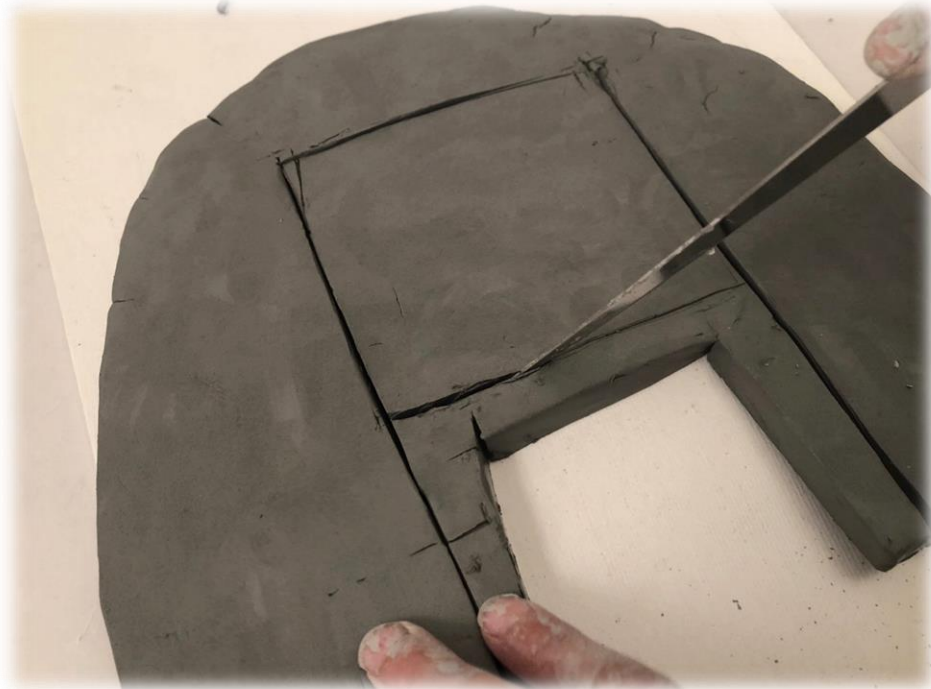

Step 9

Make a “catch-base”

- Cut a smaller square that will fit in box opening.
- **SCORE** the small square and the center of the lid.
- Put **SLIP** or water on the scored area.
- **STICK** smaller square on the inside of the lid and **SMOOTH**.

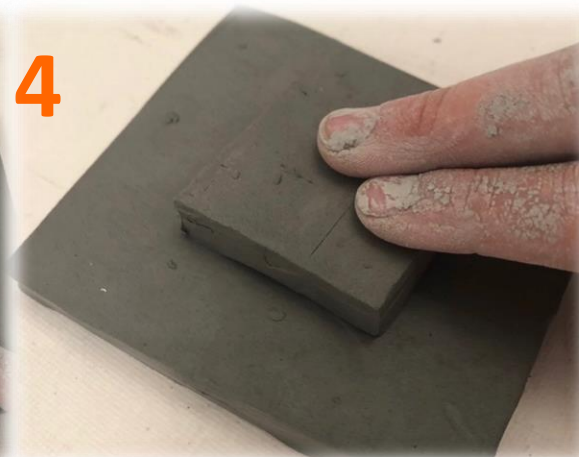
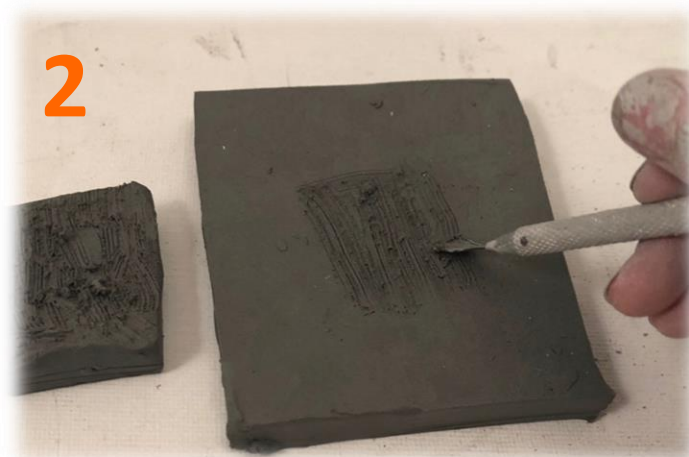

Step 10

- Smooth out the lid and box with your sponge



TIP –

Remember to get your sponge wet, then squeeze **all** water out!

Review of Steps 7-10

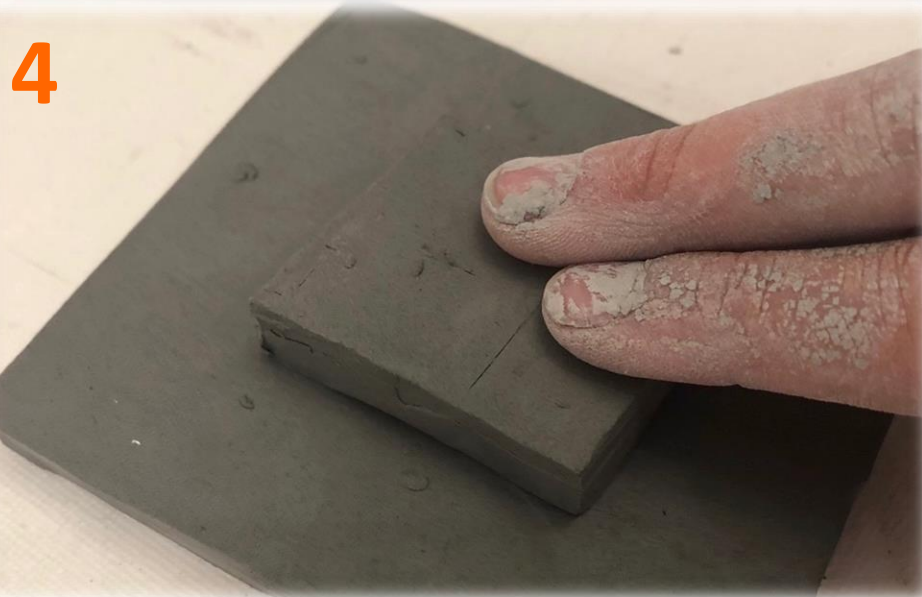

Step 11

Decorate your box by using the **additive** and **subtractive** techniques.

Pick two main decorations:

- **Add** a decorated handle or knob to the top of your lid
- **Add** shapes
- **Add** feet (Roll four small round balls to attach to corners)
- **Subtract** parts of the clay by: drawing designs with a tool, pressing a tool into the clay, subtracting shapes from the sides with a shape cutter, etc.

Remember to do the **4 S's**!

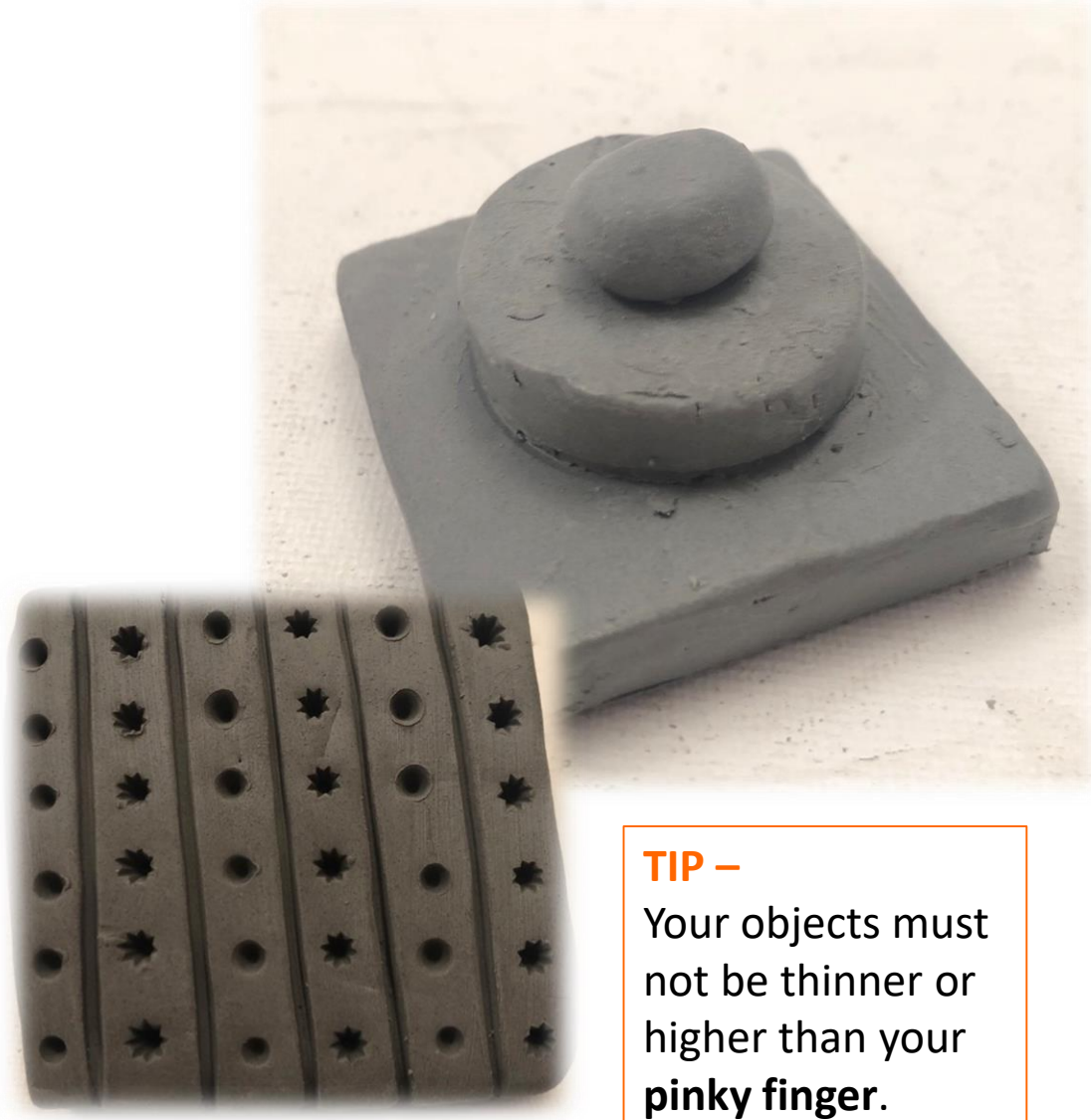

TIP –

Your objects must not be thinner or higher than your pinky finger.

Additive and Subtractive Ideas

Here are some ideas from other students to help spark your creativity!



Add Initials

On the bottom of your box and inside your lid:

1. Write your **teacher's last initial** with a needle tool.
2. Write **your 2 initials** (the first letter of your first and last names).

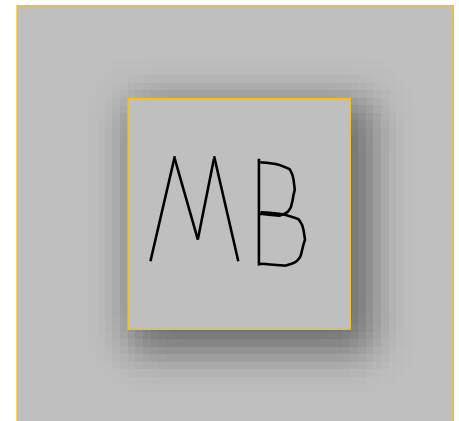
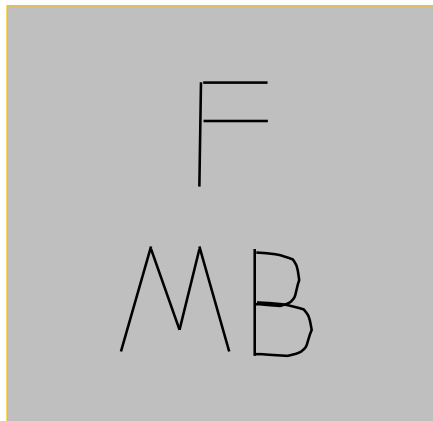

Complete

Your project is complete!

- Check that your **initials** are still on the bottom of your pot.
- Raise your hand to tell the teacher you are done.



Reflection

- What do you think about building your clay form?
- What two techniques did we learn about today?
- What did you think about the techniques we learned?
- What did you find challenging?
- What was your favorite part of our project today?



Credits

1. https://en.wikipedia.org/wiki/Pottery#Early_pottery History
2. <https://geology.com/world/> World map
3. <https://conversationsincreativecultures.wordpress.com/2016/07/31/lapita-pottery/> (Picture and Information)
4. https://www.metmuseum.org/toah/hd/lapi/hd_lapi.htm (information)
5. <https://kinggalleries.com/product/youngblood-nathan-red-tan-water-jar-eagle-fish/>, <https://www.blueraingallery.com/artists/nathan-youngblood> Nathan Youngblood Vessel
6. <https://www.mollymceramics.com/for-the-wall> Molly Morning-Glory
7. <https://www.artfulhome.com/artist/One-Blue-Marble/8438> Vaughan Nelson
8. Original LWSD sample art, used with permission.