

HAMILTON SCHOOL

Suggested Route to School

The key elements of this plan are as follows:

1. That the students living south of Fargo Avenue, west of Fernwood Drive, north of Fairview Place, and east of Neill Way walk to the bus stop at Fargo Avenue and Neill Way.
2. That the students living south of Fairview Place, west of Fernwood Drive and 9 ¼ Avenue, and north of Lacey Boulevard and Terrace Drive, and east of Neill Way walk to Hamilton School.
3. That the students living south of Fargo Avenue, west of 9-1/4 Avenue, north of Leland Way, and east of Fernwood Drive walk to the bus stop at Fargo Avenue and 9-1/4 Avenue.
4. That the students living south of Terrace Drive, west of Harrison Avenue, north of Grangeville Boulevard, and east of the extension of Candlewood Lane walk to the bus stop at Grangeville Boulevard and Harrison Avenue.
5. That the students living south of Leland Way, west of 8-1/2 Avenue, north of Grangeville Boulevard, and east of Harrison Avenue walk to Hamilton School.
6. That the students living south of Grangeville Boulevard, west of 9-1/4 Avenue, and north of Florinda Street walk to the bus stop at Richmond School/Kennedy Jr. High School.
7. That the students living south of Grangeville Boulevard, west of Highway 43, north of Lacey Boulevard, and east of 9-1/4 Avenue walk to the bus stop at Lacey Boulevard, west of Carolyn Avenue.
8. That the students living south of Grangeville Boulevard, west of Highway 43, north of Lacey Boulevard, and east of Carolyn Avenue walk to the bus stop at Lacey Boulevard east of Sierra Avenue.





HAMILTON SCHOOL

SUGGESTED ROUTE PLAN

PAGE 1 OF 2



LEGEND

	BUS STOP
	SUGGESTED SCHOOL ROUTE
	CROSSWALK
	SCHOOL BOUNDARY
	SIGNAL

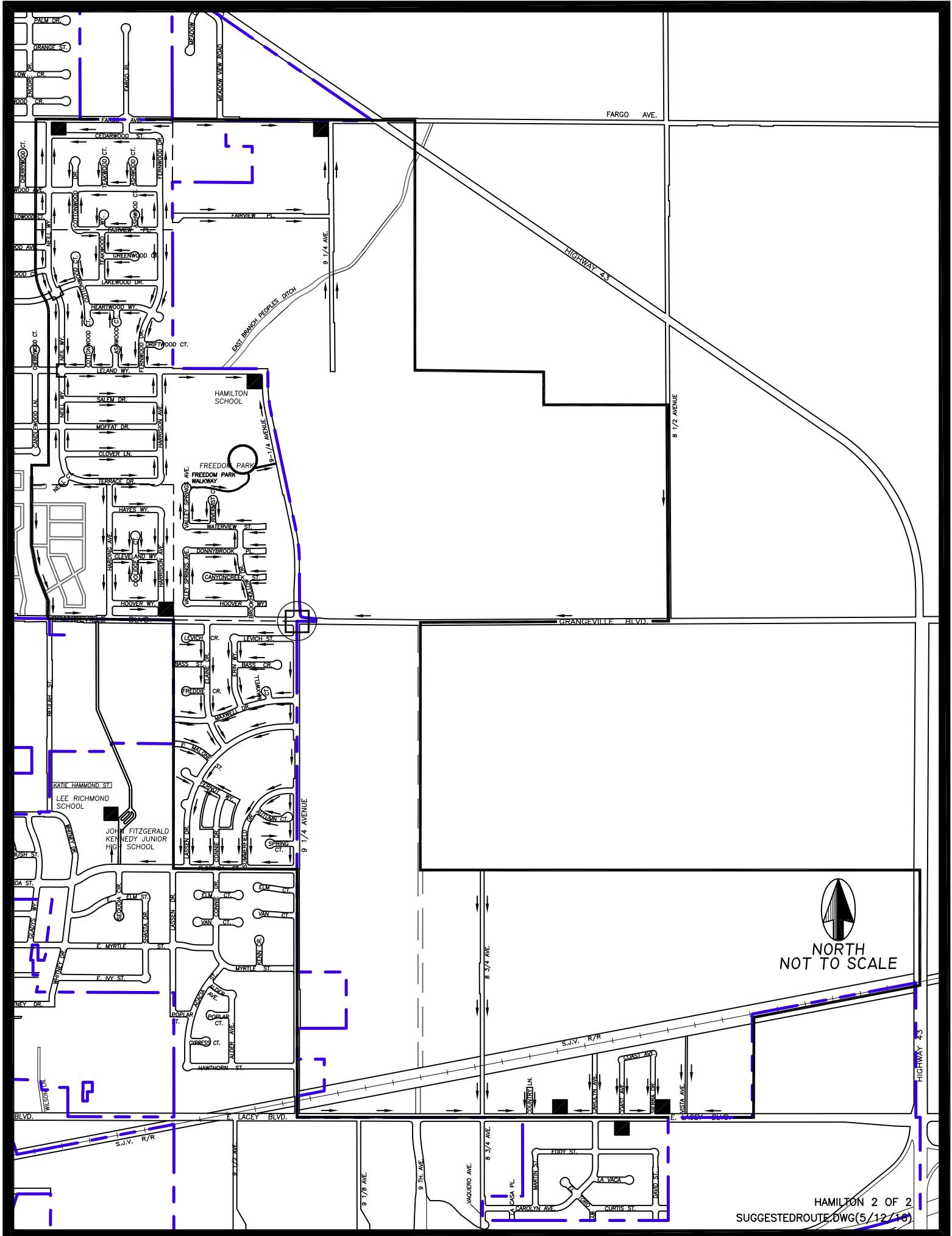

NORTH
NOT TO SCALE

MARTIN LUTHER KING JR. SCHOOL

Suggested Routes to School

The key elements of this plan are as follows:

1. That the students living south of Hanford-Armona Road, west of the extension of Country Place/Kimball Avenue/Butternut Drive, north of Hume Avenue, east of 12th Avenue, south of Osprey Street, and east of Peoples Ditch/Centennial Park walk to the bus stop at Hanford-Armona Road and Centennial Park.
2. That the students living south of Hanford-Armona Road, west of 11th Avenue, north of Millerton Street, and east of the extension of Butternut Drive/Kimball Avenue/Country Place walk to King School.
3. That the students living south of Millerton Street, west of 11th Avenue, north of Houston Avenue, and east of the extension of Butternut Drive/Kimball Avenue/Country Place walk to King School.
4. That the students living south of Thompson Drive, west of Santa Fe Railroad tracks, north of Houston Avenue, and east of 11th Avenue walk to King School.





MARTIN LUTHER KING JR. SCHOOL

SUGGESTED ROUTE PLAN

PAGE 1 OF 2



LEGEND

	BUS STOP
	SUGGESTED SCHOOL ROUTE
	CROSSWALK
	SCHOOL BOUNDARY
	SIGNAL

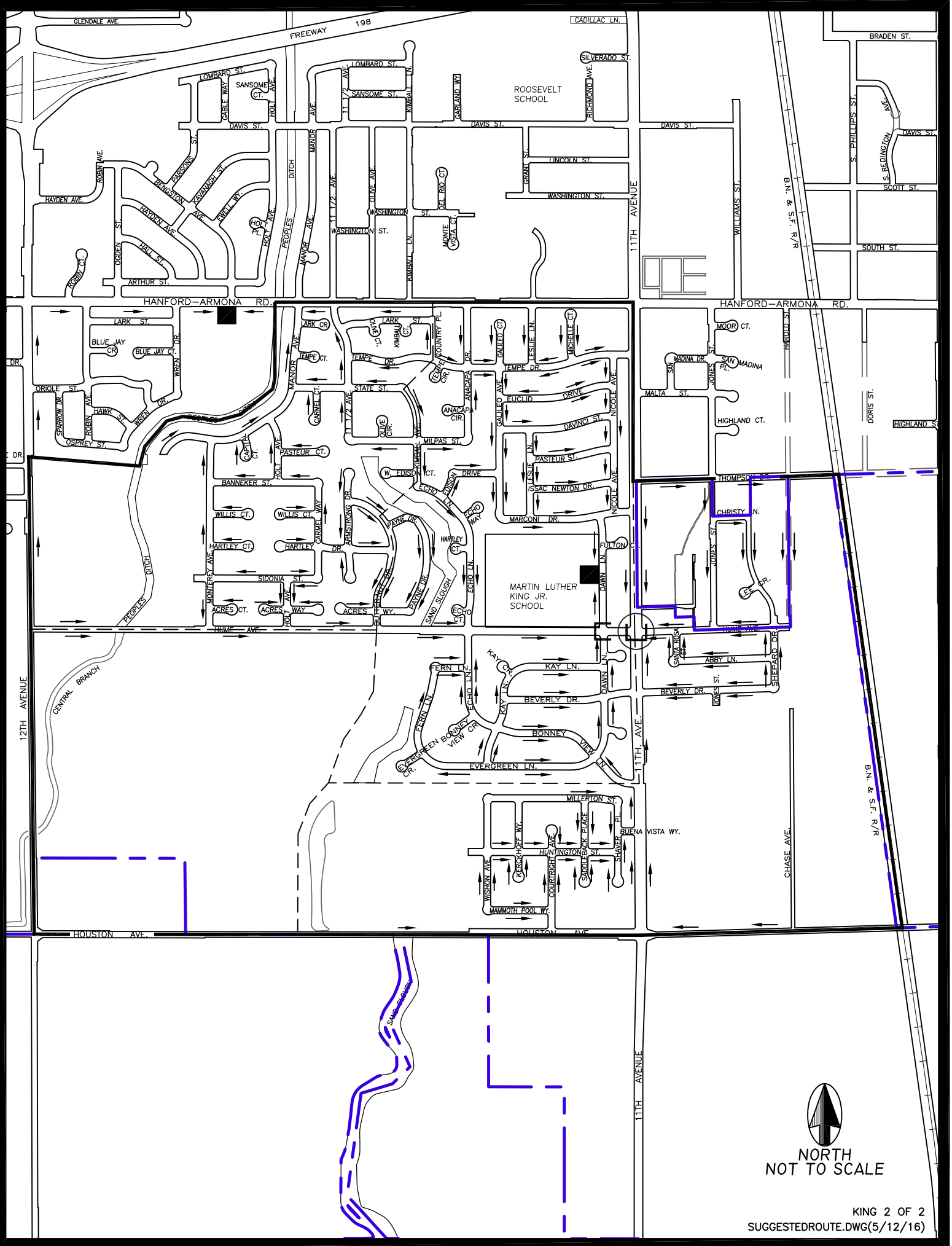

NORTH
NOT TO SCALE

LINCOLN SCHOOL

Suggested Routes to School

The key elements of this plan are as follows:

1. That the students living south of Freeway 198, west of 10th Avenue, north of Hanford-Armona Road, and east of Santa Fe Railroad tracks walk to Lincoln School.
2. That the students living south of Freeway 198, west of 9-1/2 Avenue, north of Hanford-Armona Road, and east of 10th Avenue walk to the bus stop at Third Street and 9-1/2 Avenue.
3. That the students living south of Hanford-Armona Road, west of Santa Fe Railroad tracks, north of Thompson Drive, and east of 11th Avenue walk to the bus stop at 11th Avenue and Thompson Drive.
4. That the students living south of Hanford-Armona Road, west of 10-1/2 Avenue, north of Houston, and east of Santa Fe Railroad tracks walk to the bus stop at Hanford-Armona Road and 10-1/2 Avenue and the bus stop on 10-1/2 Avenue north of Houston Avenue.
5. That the students living south of Hanford-Armona Road, west of Foggy Bottom Road, north of Orchard Drive, and east of 10-1/2 Avenue walk to the bus stop at Hanford-Armona Road and Jordan Way and the bus stop on 10th Avenue south of Hanford-Armona Road at Faria's Bakery.





LINCOLN SCHOOL

SUGGESTED ROUTE PLAN

PAGE 1 OF 2



LEGEND

	BUS STOP
	SUGGESTED SCHOOL ROUTE
	CROSSWALK
	SCHOOL BOUNDARY
	SIGNAL

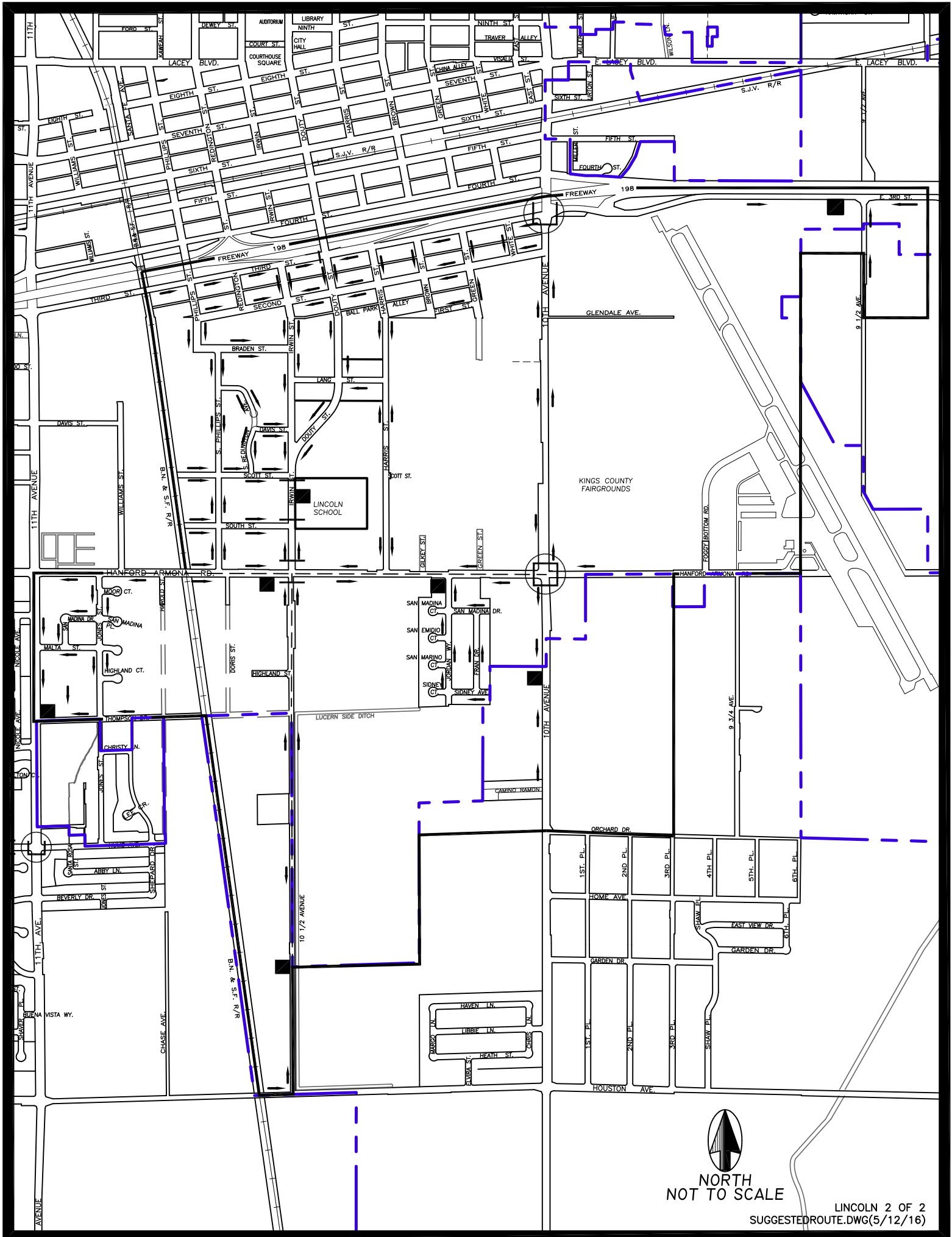

NORTH
NOT TO SCALE

MONROE SCHOOL

Suggested Route to School

The key elements of this plan are as follows:

1. That the students living south of Fargo Avenue, west of 11th Avenue, north of Mussel Slough, west of Mussel Slough, north of Yosemite Drive, and east of Santa Fe Railroad tracks walk to the bus stop at Fargo Avenue and Fountain Plaza Drive.
2. That the students living south of Mussel Slough, west of 11th Avenue, north of Cortner Street, east of Santa Fe Railroad tracks, south of Muir Way and east of Mussel Slough walk to the bus stop on Glacier Way and Cortner Street.
3. That the students living south of Cortner Street, west of Douty Street, north of Grangeville Boulevard, and east of 11th Avenue walk to Monroe School.
4. That the students living south of Cortner Street, west of 11th Avenue, north of Grangeville Boulevard, and east of Santa Fe Railroad tracks walk to the bus stop at Rodgers Road and Conquistador Street.
5. That the students living south of Grangeville Boulevard, west of 11th Avenue, and east of Santa Fe Railroad tracks walk to the bus stop at Rodgers Road and Water Street and the bus stop at Rodgers Road and Cameron Street.
6. That the students living south of Grangeville Boulevard, west of Douty Street, north of Florinda Street, and east of 11th Avenue walk to the bus stop at Jefferson School.
7. That the students living south of Florinda Street, west of Douty Street, north of Highway 198, and east of 11th Avenue walk to the bus stop at Woodrow Wilson School.





MONROE SCHOOL

SUGGESTED ROUTE PLAN

PAGE 1 OF 2



LEGEND

	BUS STOP
	SUGGESTED SCHOOL ROUTE
	CROSSWALK
	SCHOOL BOUNDARY
	SIGNAL

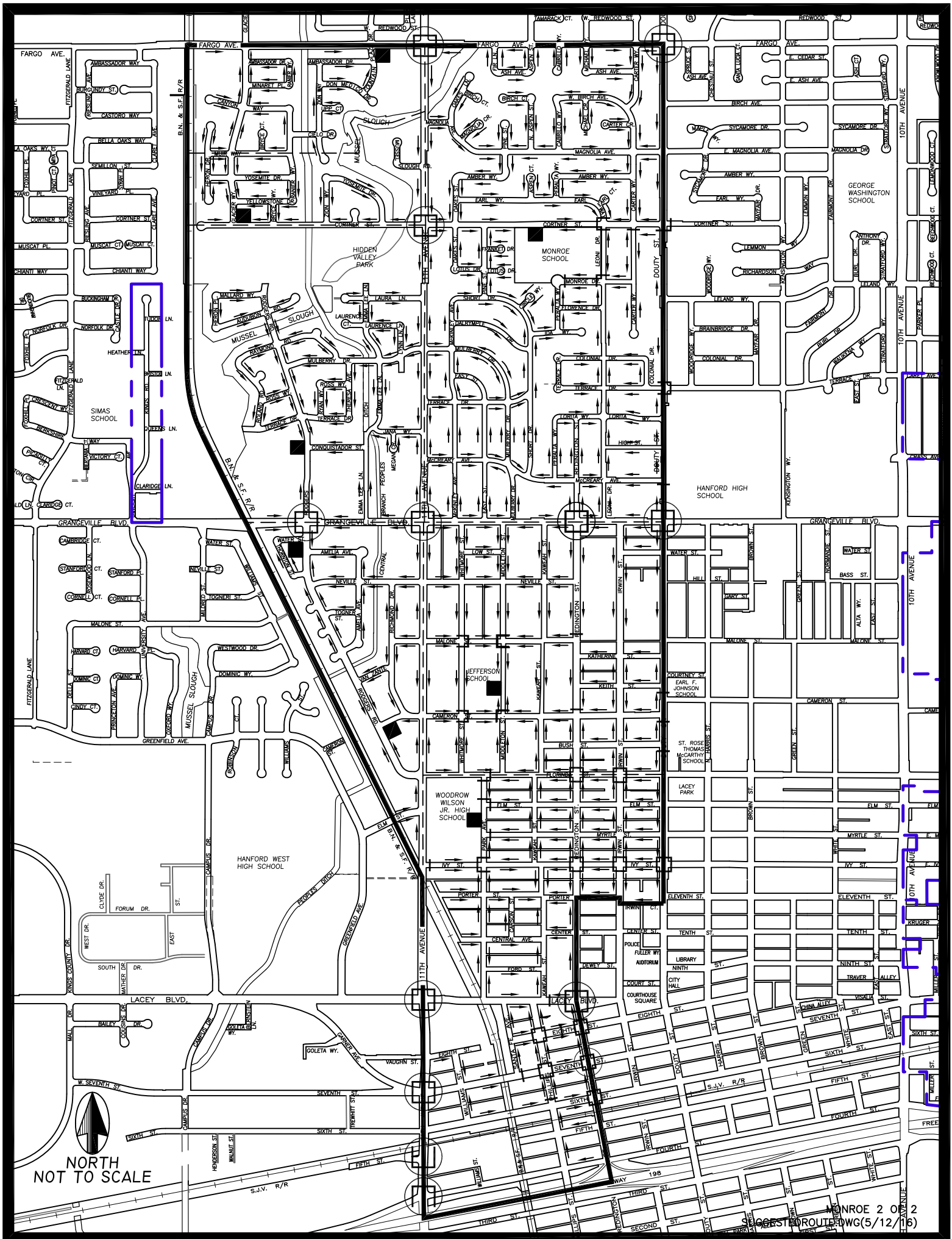

RICHMOND SCHOOL

Suggested Route to School

The key elements of this plan are as follows:

1. That the students living south of Grangeville Boulevard, west of 9¼ Avenue, north of San Joaquin Valley Railroad tracks, east of Lassen Drive, north of Kruger Avenue, and east of 10th Avenue walk to Richmond School.
2. That the students living south of Kruger Avenue, west of Lassen Drive, north of Lacey Boulevard, and east of 10th Avenue walk to the bus stop at Lacey Boulevard and Jessie Street for pick-up and Lacey Boulevard and Miller Street for drop-off.
3. That the students living south of Lacey Boulevard, west of 9¼ Avenue, north of Freeway 198, east of Peoples Ditch, north of San Joaquin Valley Railroad tracks, and east of 10th Avenue walk to the bus stop at Lacey Boulevard and Lacey Inn.
4. That the students living south of San Joaquin Valley Railroad tracks, west of Peoples Ditch, north of Freeway 198, and east of 10th Avenue walk to the bus stop at 10th Avenue and Fifth Street.
5. That the students living south of Florinda Street, west of 10th Avenue, north of Seventh Street, and east of Redington Street walk to the bus stop at Tenth Street and Brown Street.
6. That the students living south of Seventh Street, west of 10th Avenue, north of Freeway 198, and east of n Street, walk to the bus stop at 10th Avenue and Fifth Street.





RICHMOND SCHOOL

SUGGESTED ROUTE PLAN

PAGE 1 OF 2



LEGEND

	BUS STOP
	SUGGESTED SCHOOL ROUTE
	CROSSWALK
	SCHOOL BOUNDARY
	SIGNAL

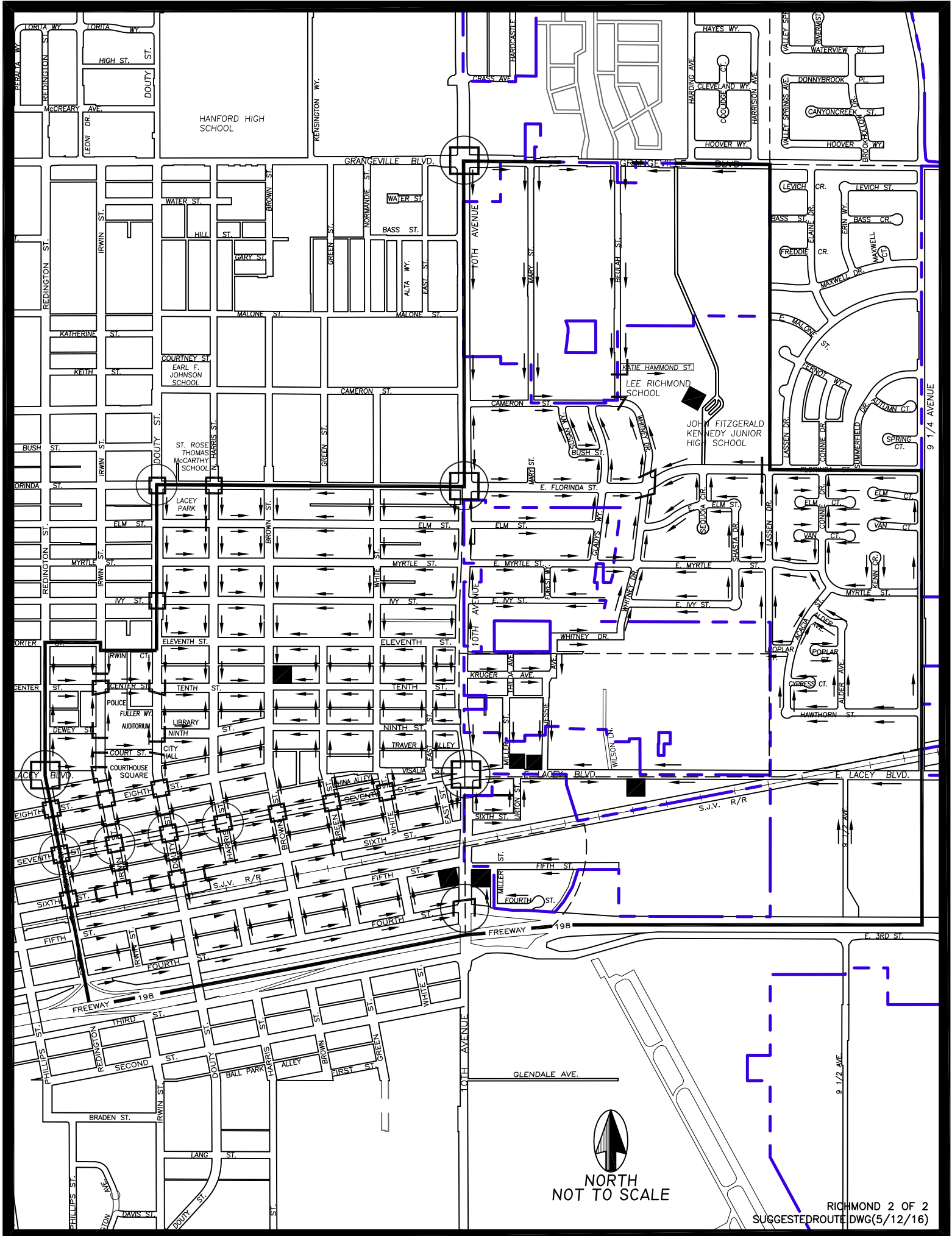

ROOSEVELT SCHOOL

Suggested Route to School

The key elements of this plan are as follows:

1. That the students living east of 12th Avenue, south of Lacey Boulevard, west of 11th Avenue, and north of Freeway 198 walk to the bus stop in the parking lot at 11th Avenue and Seventh Street. (old movie theater parking lot.)
2. That the students living south of Freeway 198, west of Bengston Avenue, north of Hanford-Armona Road and east of 12th Avenue walk to the bus stop at Hanford-Armona Road and Ogden Street.
3. That the students living south of Freeway 198, west of 11th Avenue north of Hanford-Armona Road, and east of Bengston Avenue walk to Roosevelt School.
4. That the students living south of Freeway 198, west of Santa Fe Railroad tracks, north of Hanford-Armona Road, and east of 11th Avenue walk to Roosevelt School and the bus stop at Hanford-Armona Road and Williams Street.
5. That the students living south of Hanford-Armona Road, west of Peoples Ditch/Centennial Park, north of Osprey Street, and east of 12th Avenue walk to the bus stop at Hanford-Armona Road and Centennial Park.





ROOSEVELT SCHOOL

SUGGESTED ROUTE PLAN

PAGE 1 OF 2



LEGEND

	BUS STOP
	SUGGESTED SCHOOL ROUTE
	CROSSWALK
	SCHOOL BOUNDARY
	SIGNAL

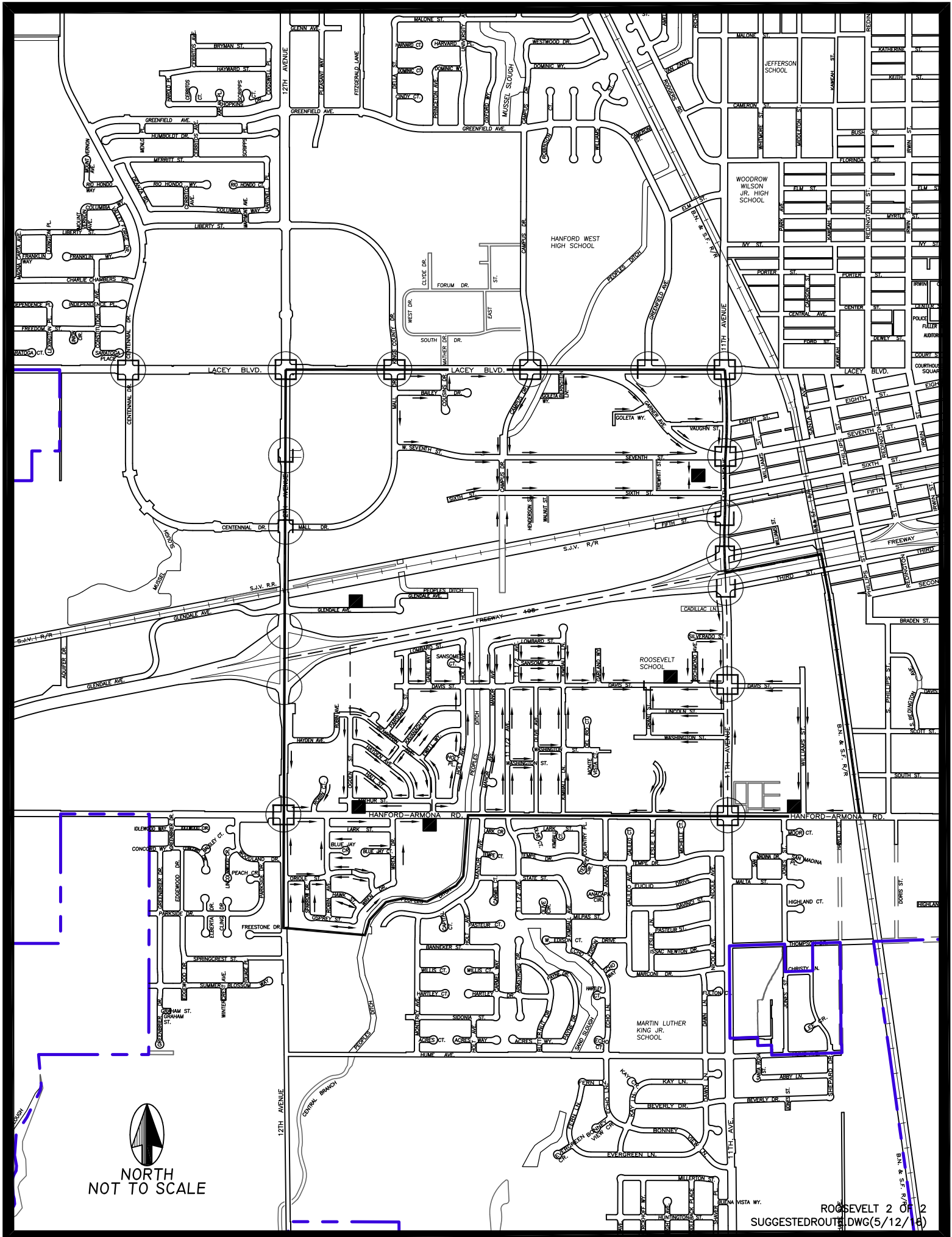

NORTH
NOT TO SCALE

SIMAS SCHOOL

Suggested Route to School

The key elements of this plan are as follows:

1. That the students living south of Fargo Avenue, west of Santa Fe Railroad tracks, north of Bella Oaks Way, and east of 12th Avenue walk to the bus stop on Fargo Avenue and Syrah Place.
2. That the students living south of Bella Oaks Way, west of Santa Fe Railroad tracks, north of Grangeville Boulevard, and east of 12th Avenue walk to Simas School.
3. That the students living south of Grangeville Boulevard, west of Centennial Drive, north of Lacey Boulevard, and east of 13th Avenue walk to the bus stop at Centennial Drive and Charlie Chambers Drive, the bus stop at Lacey Boulevard and 13th Avenue (mobile home park).
4. That the students living south of Lacey Boulevard, west of Centennial Drive, north of the San Joaquin Valley Railroad tracks and east of 13th Avenue walk to the bus stop at Lacey Boulevard and Hofman's Nursery.
5. That the students living south of Merritt Street, west of 12th Avenue, north of Lacey Boulevard, and east of Centennial Drive walk to the bus stop at Liberty Street and Marymont Avenue.
6. That the students living south of Grangeville Boulevard, west of 12th Avenue, north of Greenfield Avenue, and east of Centennial Drive walk to the bus stop at Greenfield Avenue and Kaplin Place.
7. That the students living south of Greenfield Avenue, west of 12th Avenue, north of Merritt Street and east of Centennial Drive walk to the bus stop at Greenfield Avenue and Cerritos Avenue.
8. That the students living south of Grangeville Boulevard, west of University Avenue, north of Glenn Avenue, and east of 12th Avenue walk to the bus stop at Grangeville Boulevard and Rosewood Lane.
9. That the students living east of 12th Avenue, south of Glenn Avenue, west of University Avenue, and north of Greenfield Avenue walk to the bus stop at Greenfield Avenue east of Pleasant Way.
10. That the students living south of Grangeville Boulevard, west of Santa Fe Railroad tracks, north of Dominic Way, west of Campus Drive, north of Greenfield Avenue, and east of University Avenue walk to the bus stop at Grangeville Boulevard and Mildred Street.

Simas School, Suggested Route to School, continued

11. That the students living south of Dominic Way, west of Santa Fe Railroad tracks and 11th Avenue, north of Lacey Boulevard, and east of Campus Drive walk to the bus stop at Elm Street and Greenfield Avenue.





SIMAS SCHOOL

SUGGESTED ROUTE PLAN

PAGE 1 OF 2



LEGEND

	BUS STOP
	SUGGESTED SCHOOL ROUTE
	CROSSWALK
	SCHOOL BOUNDARY
	SIGNAL

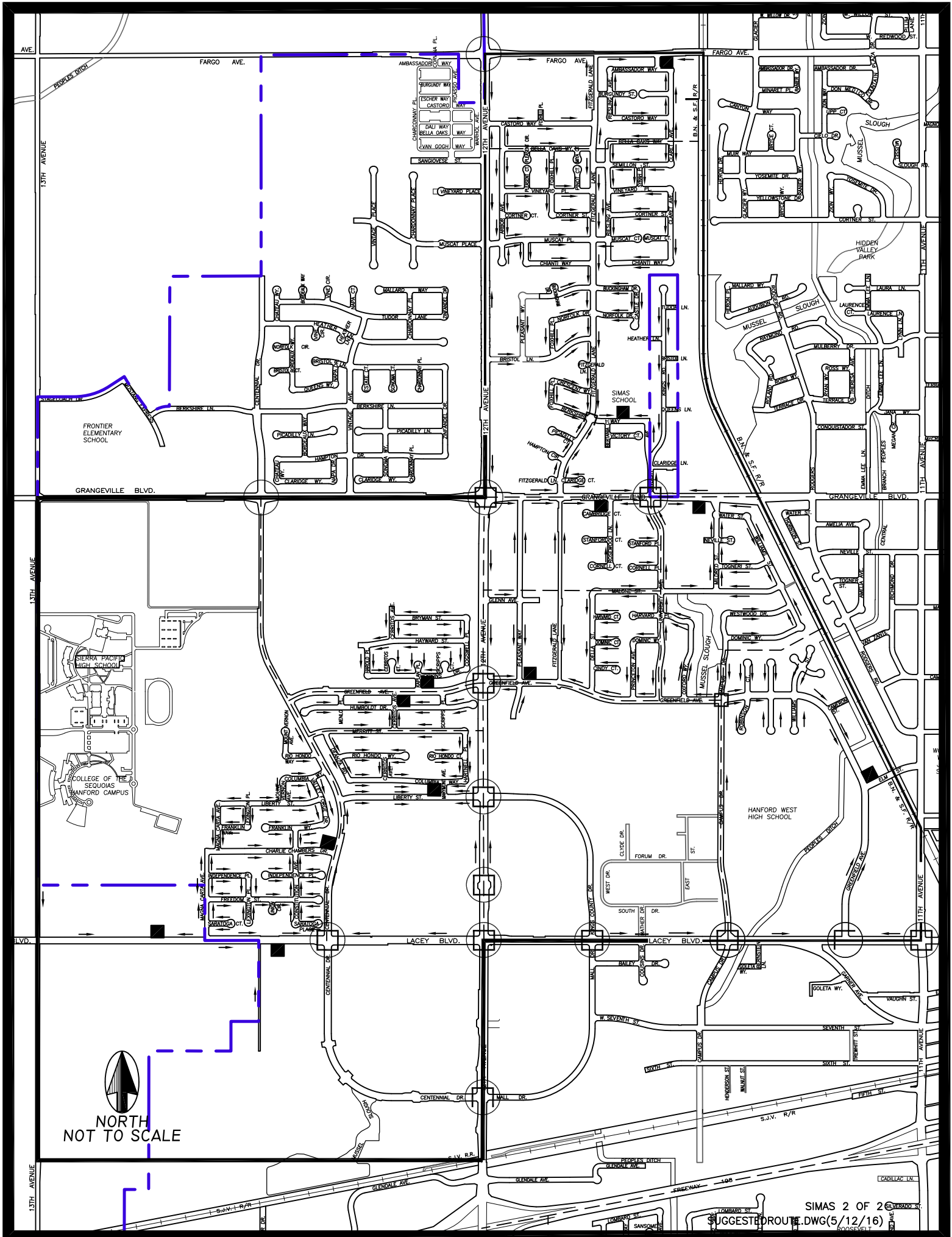

WASHINGTON SCHOOL

Suggested Route to School

The key elements of this plan are as follows:

1. That the students living south of Fargo Avenue, west of 10th Avenue, north of Grangeville Boulevard, and east of Douty Street walk to Washington School.
2. That students living south of Fargo Avenue, west of Neill Way, north of Leland Way, and east of 10th Avenue walk to the bus stop at Fargo Avenue and Cedarwood Street.
3. That the students living south of Leland Way, west of Neill Way, north of Grangeville Boulevard, and east of 10th Avenue walk to the bus stop on Parker Place at Moffat Drive.
4. That the students living south of Grangeville Boulevard, west of 10th Avenue, north of Florinda Street, and east of Douty Street walk to the bus stop at Harris Street and Cameron Street for pick-up and Douty Street and Cameron Street for drop-off.





WASHINGTON SCHOOL

SUGGESTED ROUTE PLAN

PAGE 1 OF 2



LEGEND

	BUS STOP
	SUGGESTED SCHOOL ROUTE
	CROSSWALK
	SCHOOL BOUNDARY
	SIGNAL

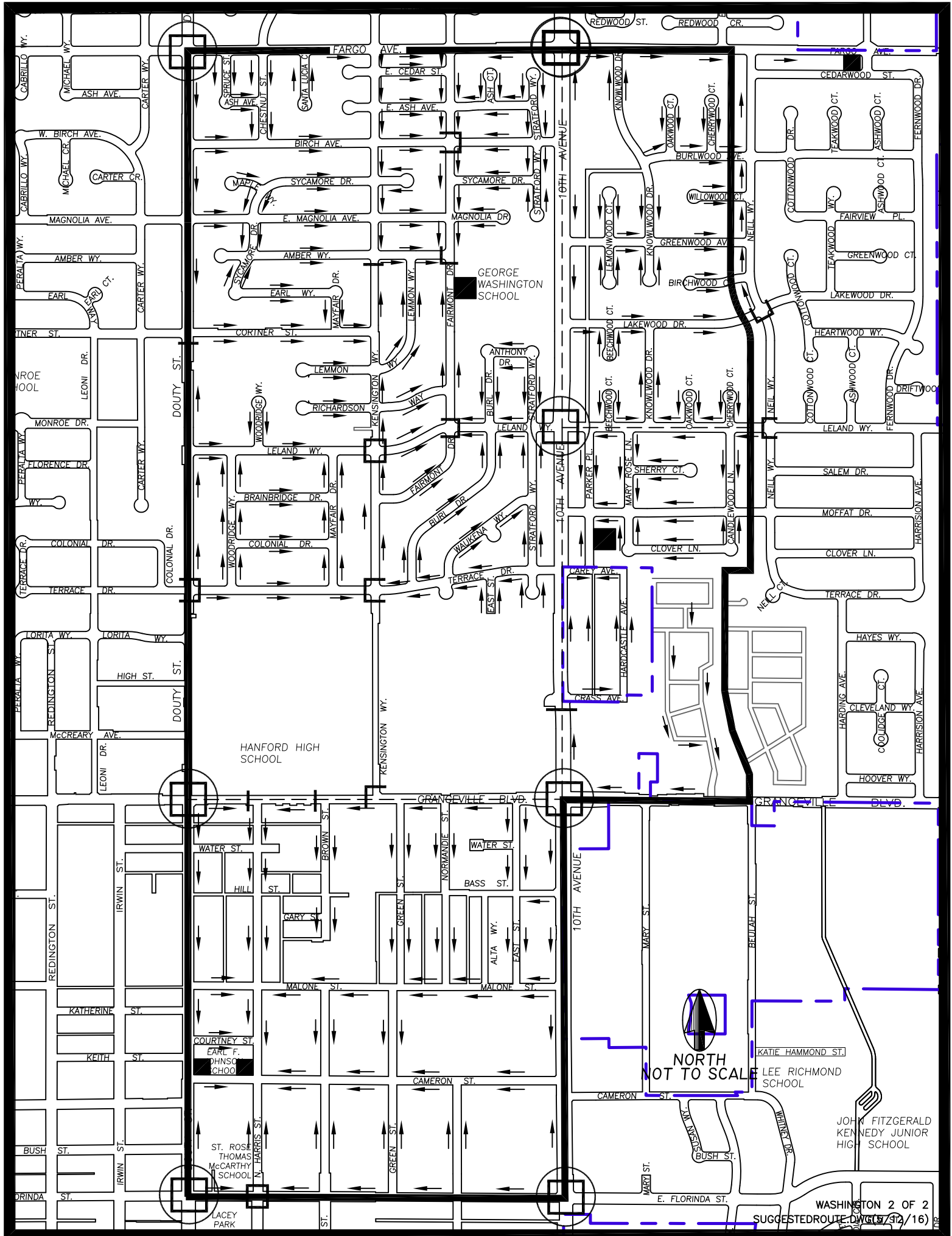

NORTH
NOT TO SCALE

KENNEDY JR. HIGH SCHOOL

Suggested Route to School

The key elements of this plan are as follows:

1. That the students living south of Fargo Avenue, west of 10th Avenue, north of Grangeville Boulevard, and east of Douty Street walk to the bus stop at Washington School.
2. That the students living south of Fargo Avenue, west of Fernwood Drive, north of Burlwood Avenue, and east of 10th Avenue walk to the bus stop at Fargo Avenue and Neill Way.
3. That the students living south of Fargo Avenue, west of 9¼ Avenue, north of Leland Way, and east of Fernwood Drive walk to the bus stop at Fargo Avenue and 9¼ Avenue.
4. That the students living south of Burlwood Avenue, west of Fernwood Drive, south of Leland Way, west of 8 ½ Avenue, north of Lacey Boulevard and east of 10th Avenue walk to the bus stop at Hamilton School.
5. That the students living south of Grangeville Boulevard, west of 9¼ Avenue, north of Freeway 198, east of Douty Street, walk to Kennedy Jr. School.
6. That the students living south of Florinda Street, east of 9 ¼ Avenue, west of Vista Avenue, and north of Lacey Boulevard walk to the bus stop at Lacey Boulevard, west of Carolyn Avenue.
7. That the students living south of Freeway 198, west of 10th Avenue, north of Hanford-Armona Road, and east of 11th Avenue walk to the bus stop at Lincoln School.
8. That the students living south of Hanford-Armona Road, west of Santa Fe Railroad tracks, north of Houston Avenue, east of 11th Avenue walk to the bus stop at 11th Avenue and Thompson Drive.
9. That the students living south of Hanford-Armona Road, west of 10½ Avenue, north of Houston Avenue, and east of Santa Fe Railroad tracks walk to the bus stop at Hanford-Armona Road and 10½ Avenue.
10. That the students living south of Hanford-Armona Road, west of Foggy Bottom Road, north of Orchard Drive, and east of 10½ Avenue walk to the bus stop at Hanford-Armona Road and Jordan Way and the bus stop at 10th Avenue south of Hanford-Armona Road at Faria's Bakery.
11. That the students living south of Hume Avenue, west of 11th Avenue, north of Houston Avenue and east of 12th Avenue walk to the bus stop at MLK School.

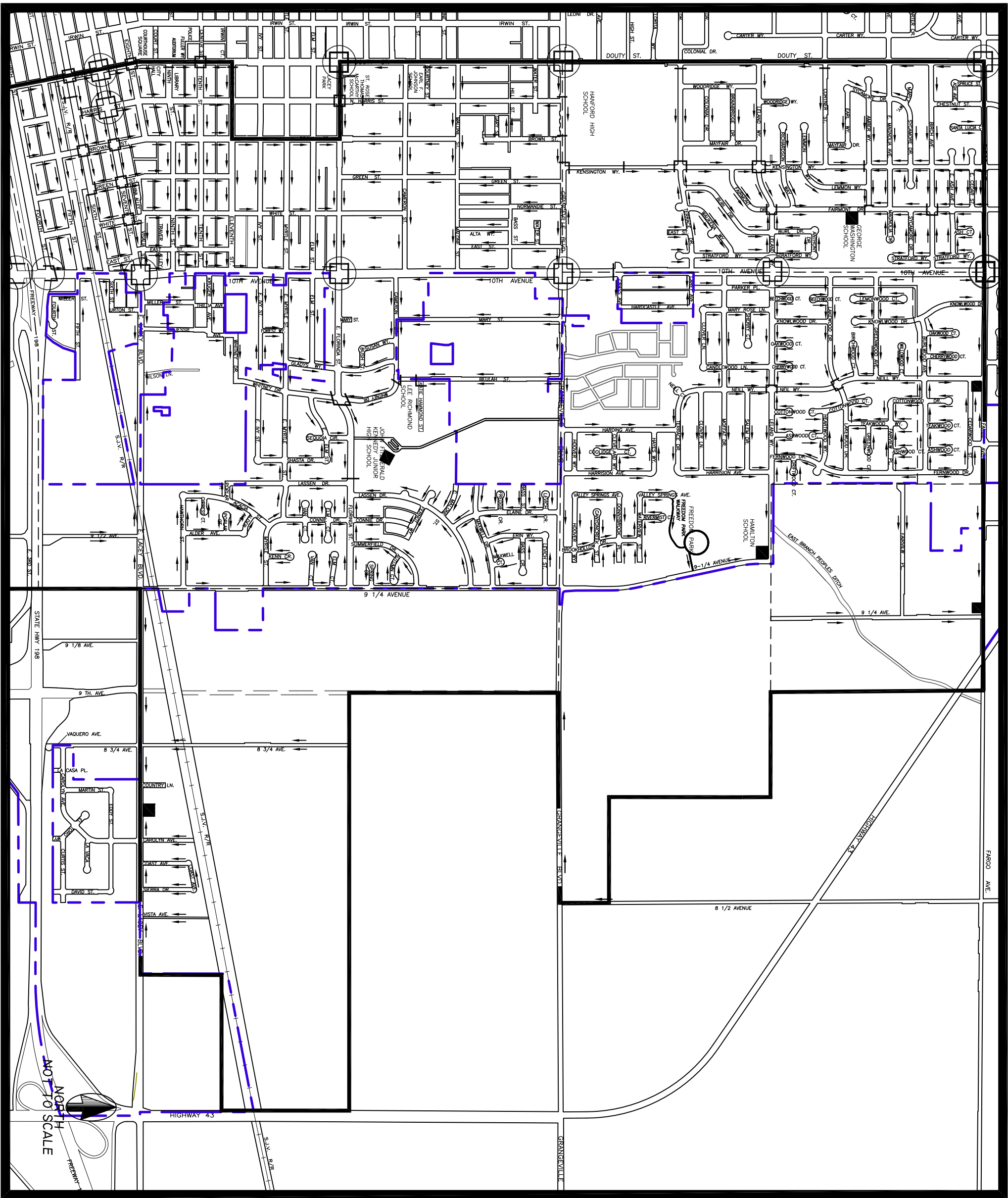





KENNEDY JR. HIGH SCHOOL

SUGGESTED ROUTE PLAN

PAGE 1 OF 2



LEGEND

-  BUS STOP
-  SUGGESTED SCHOOL ROUTE
-  CROSSWALK
-  SCHOOL BOUNDARY
-  SIGNAL

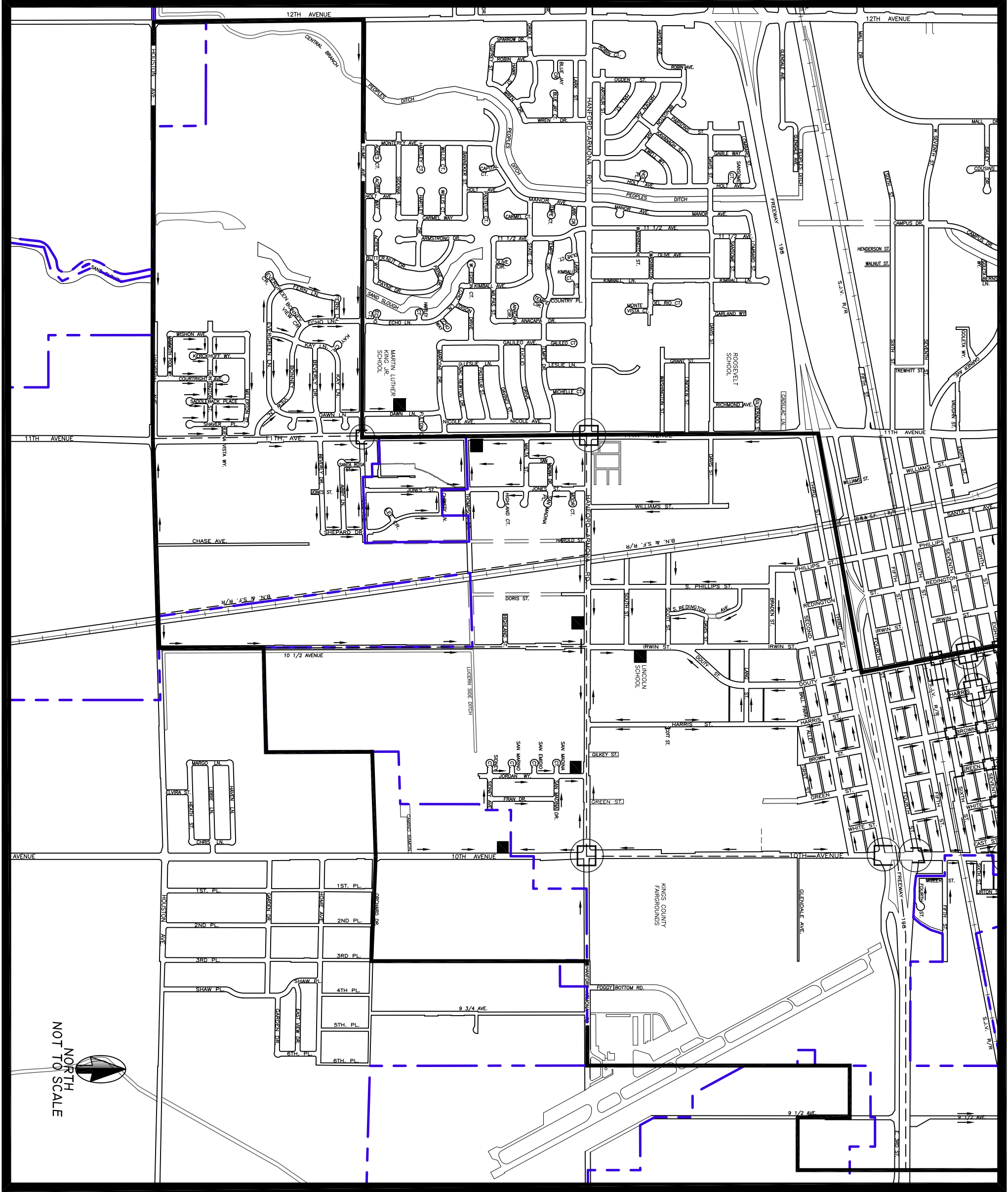





KENNEDY JR. HIGH SCHOOL

SUGGESTED ROUTE PLAN

PAGE 2 OF 2



LEGEND

-  BUS STOP
-  SUGGESTED SCHOOL ROUTE
-  CROSSWALK
-  SCHOOL BOUNDARY
-  SIGNAL

WILSON JR. HIGH SCHOOL

Suggested Route to School

The key elements of this plan are as follows:

1. That the students living south of Fargo Avenue, west of Santa Fe Railroad tracks, north of Grangeville Boulevard, and east of 12th Avenue walk to the bus stop at Simas School.
2. That the students living south of Fargo Avenue, west of 11th Avenue, north of Cortner Street, and east of Santa Fe Railroad tracks walk to the bus stop at Fargo Avenue and Fountain Plaza Drive.
3. That the students living south of Cortner Street, west of 11th Avenue, north of Grangeville Boulevard, and east of the Santa Fe Railroad tracks walk to Wilson Jr. High School.
4. That the students living south of Fargo Avenue, west of Douty Street, north of Grangeville Boulevard, and east of 11th Avenue walk to the bus stop at Monroe School.
5. That the students living south of Grangeville Boulevard, west of Centennial Drive, north of Lacey Boulevard, and east of 13th Avenue walk to the bus stop at Centennial Drive and Charlie Chambers Drive, the bus stop at 13th Avenue and Lacey Boulevard (mobile home park), and the bus stop at Grangeville Boulevard and Centennial Drive.
6. That the students living south of Greenfield Avenue, west of 12th Avenue, north of Lacey Boulevard, and east of Centennial Drive walk to the bus stop at Liberty Street and Marymont Avenue.
7. That the students living south of Grangeville Boulevard, west of 12th Avenue, north of Greenfield Avenue, and east of Centennial Drive walk to the bus stop at 12th Avenue and Greenfield Avenue.
8. That the students living south of Malone Street, west of University Avenue, north of Greenfield Avenue, and east of 12th Avenue walk to the bus stop at Pleasant Way and Greenfield Avenue.
9. That the students living south of Grangeville Boulevard, west of Santa Fe Railroad tracks, north of Dominic Way, west of Campus Drive, north of Greenfield Avenue, and east of 12th Avenue walk to the bus stop at Grangeville Boulevard and Mildred Street.
10. That the students living south of Grangeville Boulevard, west of Douty Street, north of Florinda Street, west of Brown Street, north of Eleventh Street, west of Douty Street, north of Lacey Boulevard, east of Campus Drive, south of Dominic Way, and east of Santa Fe Railroad tracks walk to Wilson Jr. High School.

Wilson Jr. High School, Suggested Route to School, continued

11. That the students living south of Lacey Boulevard, west of 12th Avenue, north of San Joaquin Valley Railroad tracks, and east of 13th Avenue walk to the bus stop at Lacey Boulevard and Hofman's Nursery.
12. That the students living south of Lacey Boulevard, west of Douty Street, north of Freeway 198, and east of 12th Avenue walk to Wilson Jr. High School.
13. That the students living south of Freeway 198, west of Ogden Street, south and west of Bengston Avenue, north of Hanford-Armona Road, and east of 12th Avenue walk to the bus stop at Hanford-Armona Road and Ogden Street.
14. That the students living south of Freeway 198, west of 11th Avenue, north of Hanford-Armona Road, and east of Bengston Avenue walk to the bus stop at Roosevelt School.
15. That the students living south of Hanford-Armona Road, west of the extension of Country Place/Kimball Avenue/Butternut Drive, north of Hume Avenue, and east of 12th Avenue walk to the bus stop at Hanford-Armona Road and Centennial Park.
16. That the students living south of Hanford-Armona Road, west of 11th Avenue, north of Hume Avenue, and east of the extension of Butternut Drive/Kimball Avenue/Country Place walk to the bus stop at King School.

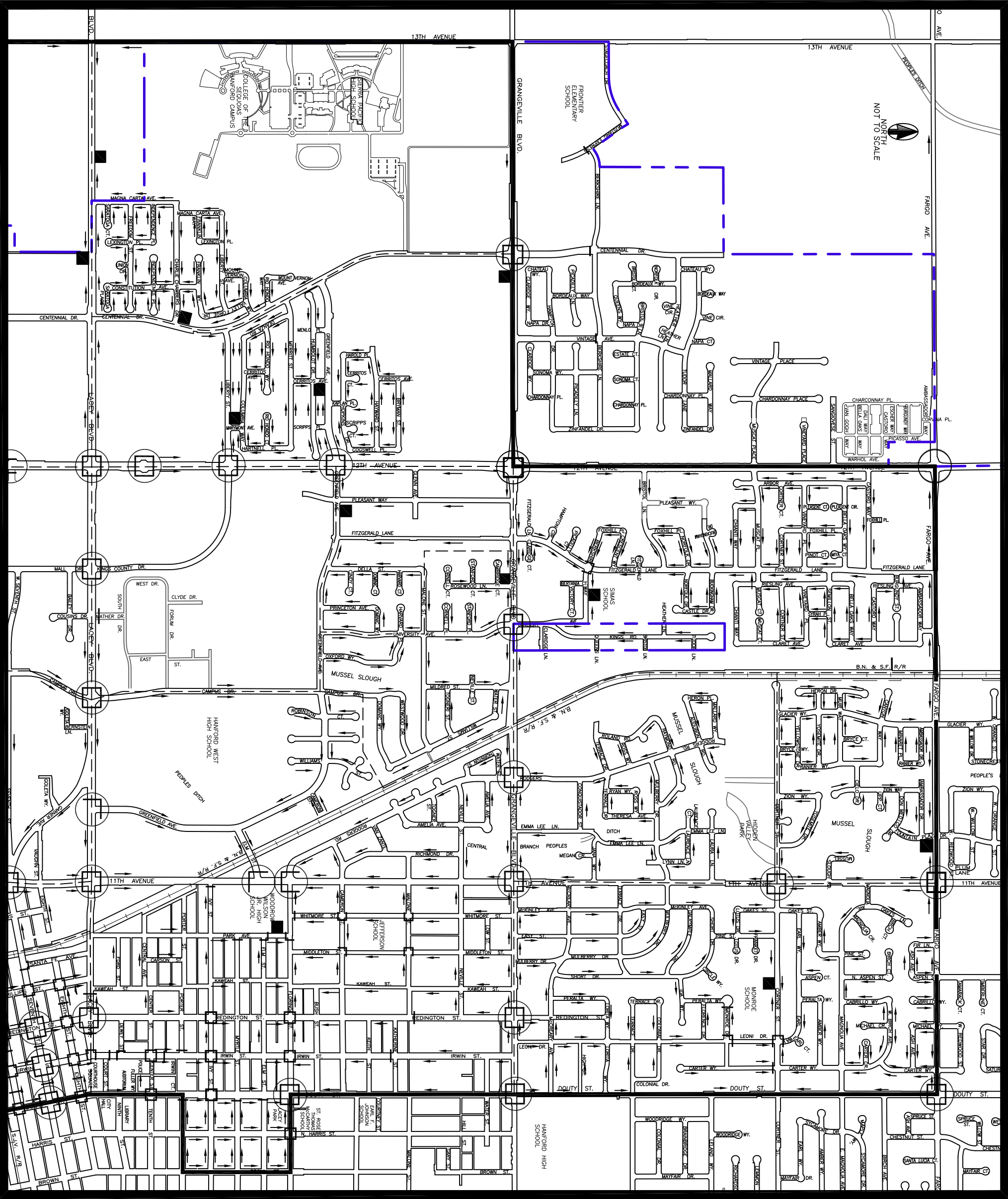

WILSON JR. HIGH SCHOOL

SUGGESTED ROUTE PLAN

PAGE 1 OF 2



LEGEND

- BUS STOP
- SUGGESTED SCHOOL ROUTE
- CROSSWALK
- SCHOOL BOUNDARY
- SIGNAL

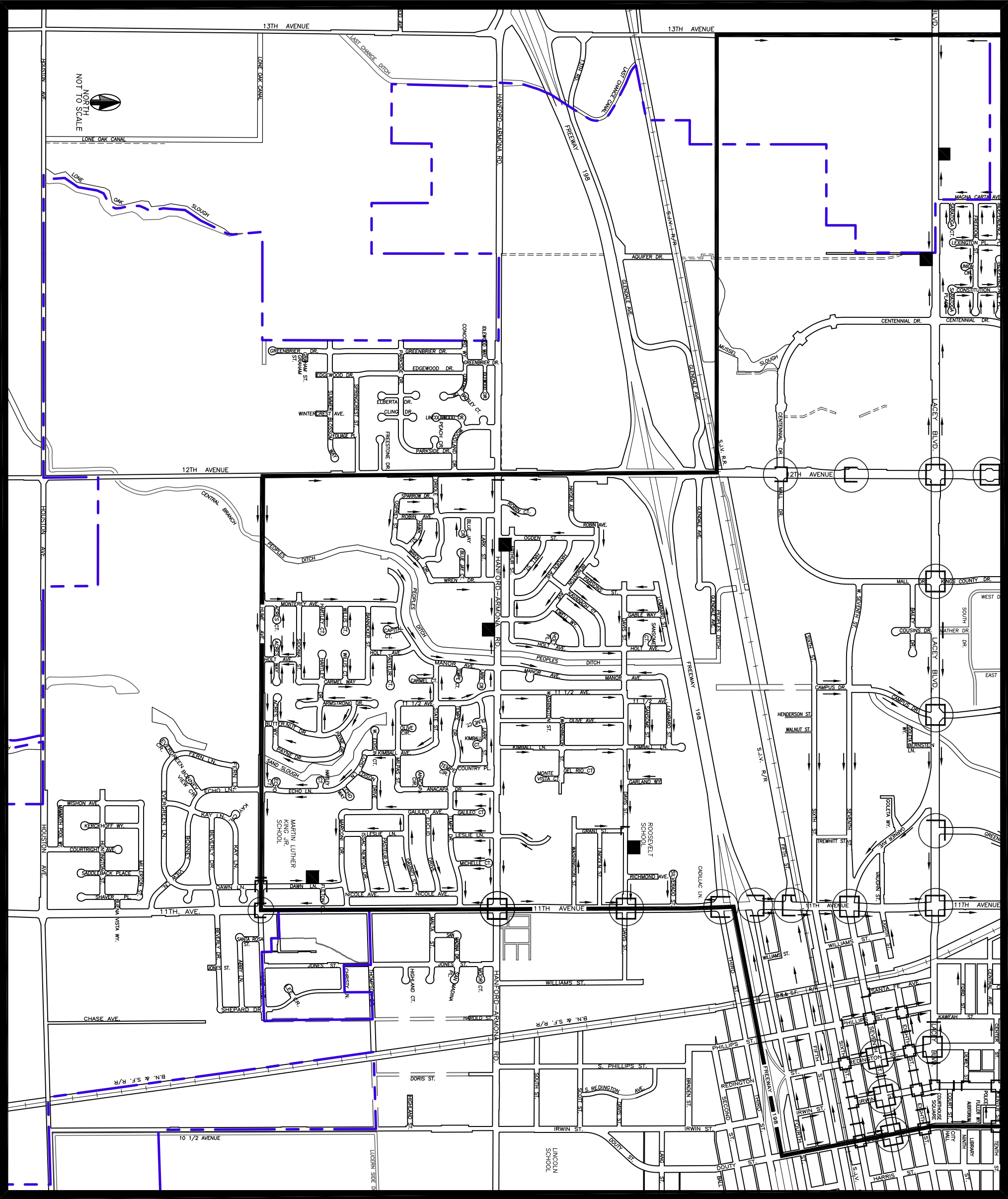





WILSON JR. HIGH SCHOOL

SUGGESTED ROUTE PLAN

PAGE 2 OF 2



LEGEND

-  BUS STOP
-  SUGGESTED SCHOOL ROUTE
-  CROSSWALK
-  SCHOOL BOUNDARY
-  SIGNAL

JEFFERSON SCHOOL

Suggested Route to School

The key elements of this plan are as follows:

1. That the students living south of Fargo Avenue, east of 12th Avenue, west of Santa Fe Railroad tracks, north of Grangeville Boulevard, walk to the bus stop at Simas School.
2. That the students living south of Fargo Avenue, east of Santa Fe Railroad, west of Peoples Ditch, north of Cortner Street walk to the bus stop at Cortner Street and Glacier Way.
3. That the students living south of Fargo Avenue, east of 11th Avenue, west of Peoples Ditch, north of Cortner Street walk to the bus stop at Fargo Avenue and Fountain Plaza Drive.
4. That the students living south of Fargo Avenue, west of Douty Street, north of Grangeville Boulevard, east of 11th Avenue walk to the bus stop at Monroe School.
5. That the students living south of Cortner Street, west of Douty Street, north of Grangeville Boulevard, east of Santa Fe Railroad walk to the bus stop at Rodgers Road and Conquistador Street.
6. That the students living south of Grangeville Boulevard, west of 12th Avenue, north of Greenfield Avenue, east of Centennial Drive walk to the bus stop at Greenfield Avenue and Kaplan Place.
5. That the students living south of Greenfield Avenue, west of 12th Avenue, north of Merritt Street, east of Centennial Drive walk to the bus stop at Cerritos Avenue and Greenfield Avenue.
6. That the students living south of Merritt Street, west of 12th Avenue, north of Liberty Street, east of Centennial Drive walk to the bus stop at Liberty Street and Marymont Avenue.
9. That the students living south of Greenfield Avenue, west of Centennial Drive, north of Independence Place, east of Magna Carta Avenue walk to the bus stop at Centennial Drive and Charlie Chambers Drive.
10. That the students living south of south of Independence Place, west of Centennial Drive, north of Lacey Boulevard, east of 13th Avenue walk to the bus stop at Lacey Boulevard and Magna Carta Avenue.
11. That the students living south of Malone Street, west of University Avenue, north of Greenfield Avenue, east of 12th Avenue walk to the bus stop at Greenfield Avenue and Pleasant Way.

Jefferson School, Suggested Route to School, continued

12. That the students living south of Grangeville Boulevard, west of Santa Fe Railroad, north of Greenfield Avenue, east of Fitzgerald Lane walk to the bus stop at Grangeville Boulevard and Mildred Street.
13. That the students living south of Dominic Way, west of Santa Fe Railroad, north of Lacey Boulevard, east of Campus Drive walk to the bus stop at Greenfield Avenue and Elm Street.
14. That the students living south of Grangeville Boulevard, west of Douty Street, north of Ivy Street, east of 11th Avenue walk to Jefferson School.
15. That the students living south of Ivy Street, west of Douty Street, north of Seventh Street, east of Santa Fe Railroad walk to the bus stop at Kaweah Street and Ford Street.
16. That the students living south of Fargo Avenue, west of 10th Avenue, north of Grangeville Boulevard, east of Douty Street walk to the bus stop at George Washington School.
17. That the students living south of Fargo Avenue, west of Fernwood Drive, north of Leland Way, east of 10th Avenue walk to the bus stop at Neill Way and Cedarwood Street.
18. That the students living south of Fargo Avenue, west of Highway 43, north of Leland Way, east of Fernwood Drive walk to the bus stop at Fargo Avenue and 9 ¼ Avenue.
19. That the students living south of Leland Way, west of 9 ¼ Avenue, north of Grangeville Boulevard, east of 10th Avenue walk to the bus stop at Hamilton School.
20. That the students living south of Grangeville Boulevard, west of 10th Avenue, north of Seventh Street, west of Douty Street walk to the bus stop at Tenth Street and Brown Street.
21. That the student living south of Grangeville Boulevard, west of Beulah Street, north of Whitney Drive, east of 10th Avenue walk to the bus stop at John F. Kennedy Jr. High School.
22. That the students living south of Grangeville Boulevard, west of 9 ¼ Avenue, north of Lacey Boulevard, east of Whitney Drive walk to the bus stop at John F. Kennedy Jr. High School.
23. That the students living south of San Joaquin Railroad, west of Vista Avenue, north of Lacey Boulevard, east of Coast Avenue walk to the bus stop at Sierra Drive.
24. That the students living south of Florinda Street, west of Coast Avenue, north of Lacey Boulevard, east of 9 ¼ Avenue walk to the bus stop at Lacey Boulevard and Carolyn Avenue.

Jefferson School, Suggested Route to School, continued

25. That the students living south of Whitney Drive, west of Lassen Drive, north of Lacey Boulevard, east of 10th Avenue walk to the bus stop at Lacey Boulevard and Wilson Lane.
26. That the students living south of Lacey Boulevard, west of 11th Avenue, north of Highway 198, east of 12th Avenue walk to the bus stop at 10th Avenue and Sixth Street.
27. That the student living south of Seventh Street, west of Douty Street, north of Highway 198, east of 11th Avenue walk to the bus stop at Fourth Street and Phillips Street.
28. That the students living south of Seventh Street, west of 10th Avenue, north of Highway 198, east of Douty Street walk to the bus stop at 10th Avenue and Fifth Street.
29. That the students living south of Lacey Boulevard, west of 9 ¼ Avenue, north of San Joaquin Railroad, east of 10th Avenue walk to the bus stop at Lacey Boulevard and Wilson Lane.
30. That the students living south of San Joaquin Railroad, west of Wilson Lane, north of Highway 198, east of 10th Avenue walk to the bus stop at 10th Avenue and Fifth Street.
31. That the students living south and west of Bengston Avenue, north of Hanford-Armona Road, east of 12th Avenue walk to the bus stop at Hanford-Armona Road and Ogden Street.
32. That the students living south of Highway 198, west of 11th Avenue, north of Hanford-Armona Road, east of Bengston Avenue walk to the bus stop at Roosevelt School.
33. That the students living south of Highway 198, west of 10th Avenue, north of Hanford-Armona Road, east of Santa Fe Railroad walk to the bus stop at Harris Street and First Street.
34. That the students living south of Hanford-Armona Road, west of Butternut Drive, north of Hume Avenue, east of 13th Avenue walk to the bus stop at Hanford-Armona Road and Bengston Avenue.
35. That the students living south of Hanford-Armona Road, west of 11th Avenue, north of Houston Avenue, east of Butternut Drive walk to the stop at M.L.K. School.
36. That the students living south of Hanford-Armona Road, west of Santa Fe Railroad, north of Buena Vista Way, east of 11th Avenue walk to the bus stop at 11th Avenue and Thompson Drive.
37. That the students living south of Hanford-Armona Road, west of 10 ½ Avenue, north of Thompson Drive, east of Santa Fe Railroad walk to the bus stop at Hanford-Armona Road and 10 ½ Avenue.

Jefferson School, Suggested Route to School, continued

38. The students living south of Hanford-Armona Road, west of 10 ½ Avenue, north of Houston Avenue, east of Santa Fe Railroad walk to the bus stop at 10 ½ Avenue north of Houston Avenue.
39. That the student living south of Hanford-Armona Road, west of Fran Drive, north of Houston Avenue, east of 10 ½ Avenue walk to the stop at Hanford-Armona Road and Jordan Way.
40. That the students living south of Hanford-Armona Road, west of 10th Avenue, north of Camino Ramon, east of Fran Drive walk to the bus stop at 10th Avenue south of Hanford-Armona Road.

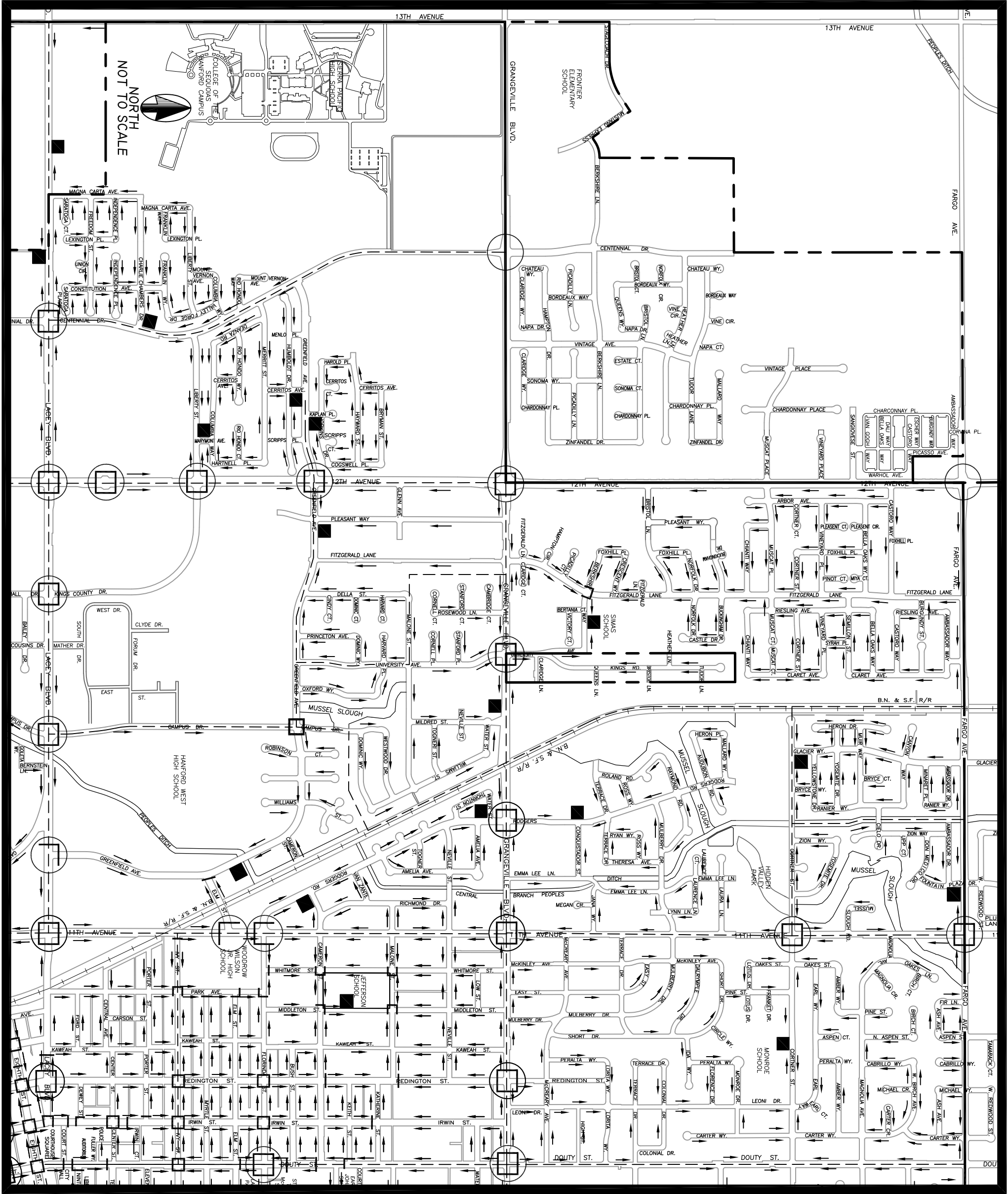





JEFFERSON SCHOOL

SUGGESTED ROUTE PLAN

PAGE 1 OF 3



LEGEND

-  BUS STOP
-  SUGGESTED SCHOOL ROUTE
-  SCHOOL BOUNDARY
-  CROSSWALK
-  SIGNAL

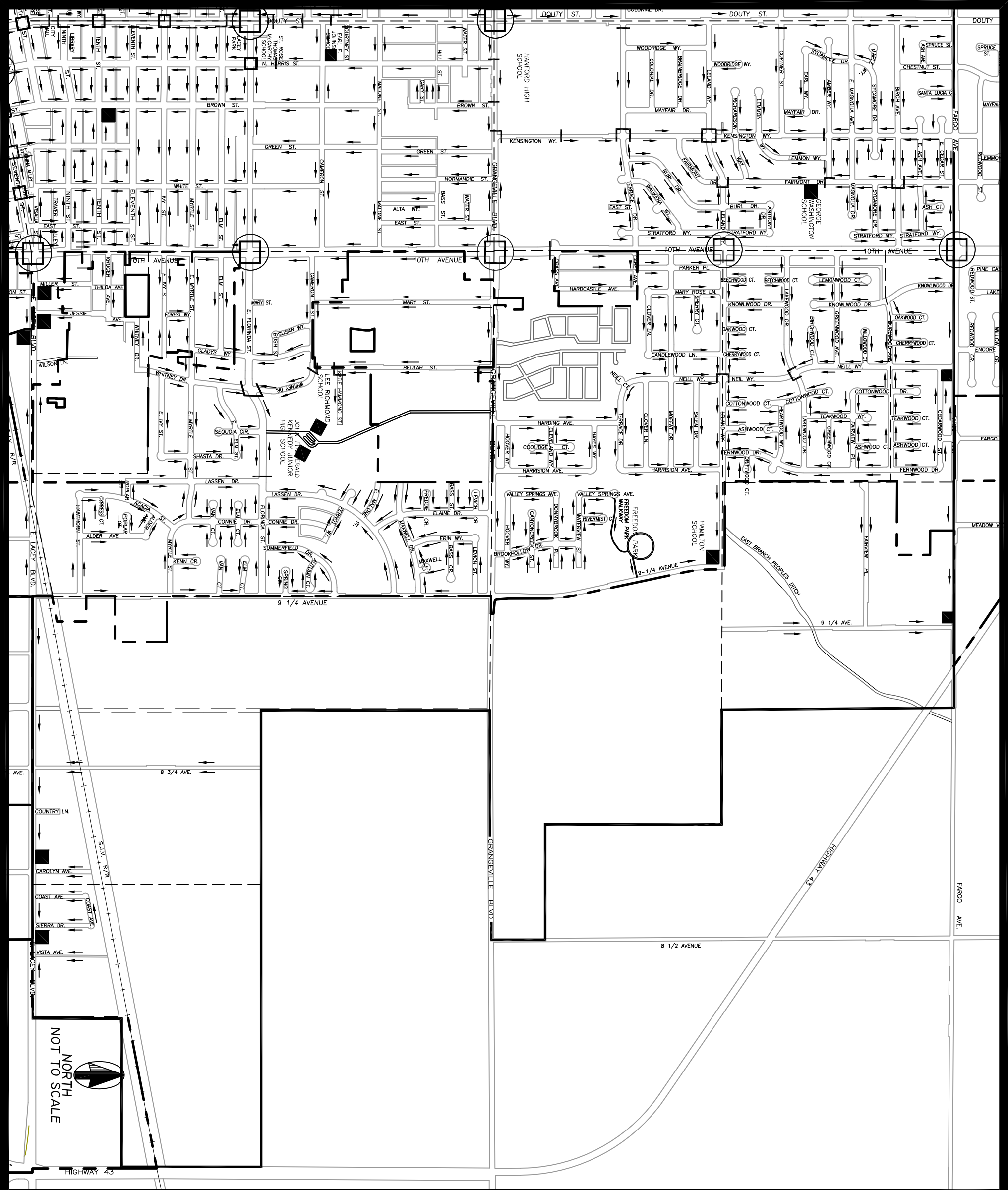

JEFFERSON SCHOOL
SUGGESTED ROUTE PLAN
PAGE 2 OF 3



LEGEND

- BUS STOP
- SUGGESTED SCHOOL ROUTE
- CROSSWALK
- SCHOOL BOUNDARY
- SIGNAL

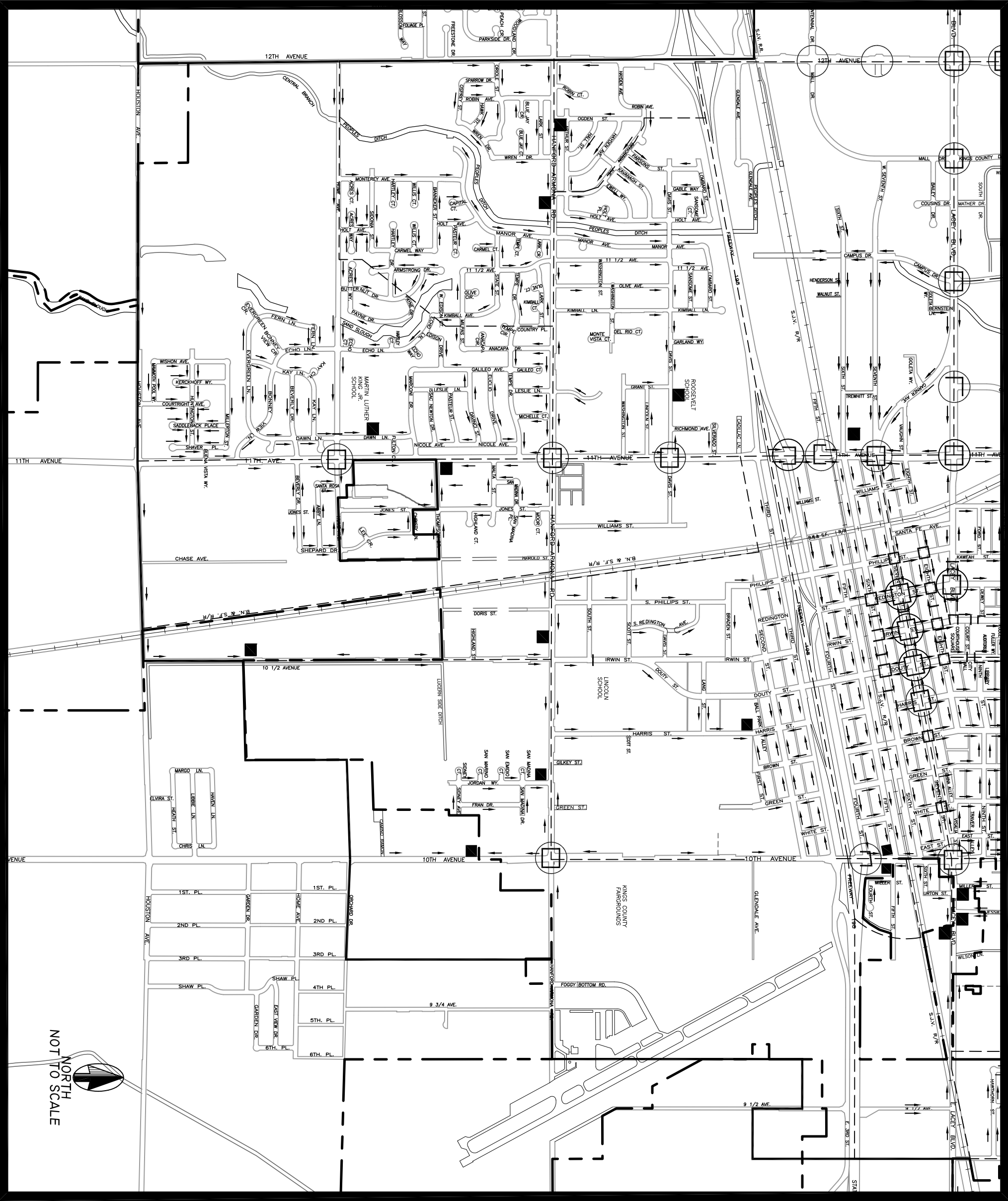





JEFFERSON SCHOOL

SUGGESTED ROUTE PLAN

PAGE 3 OF 3



LEGEND

-  BUS STOP
-  SUGGESTED SCHOOL ROUTE
-  CROSSWALK
-  SCHOOL BOUNDARY
-  SIGNAL